

NEW MEXICO OIL CONSERVATION COMMISSION

Well Location and Acreage Dedication Plat

SECTION A.

Date April 24, 1963

Operator Skelly Oil Company Lease Navajo "M"
 Well No. 9 Unit Letter A Section 34 Township 32 North Range 17 West NMPM
 Located 660 Feet From North Line, 660 Feet From East Line
 County San Juan G. L. Elevation 5931 Dedicated Acreage 40 Acres
 Name of Producing Formation Gallup Pool Undesignated Gallup

1. Is the Operator the only owner* in the dedicated acreage outlined on the plat below? Yes x No _____
2. If the answer to question One is "No," have the interests of all the owners been consolidated by communitization agreement or otherwise? Yes _____ No _____. If answer is "Yes," Type of Consolidation _____
3. If the answer to question Two is "No," list all the owners and their respective interests below:

OWNER

LAND DESCRIPTION

SECTION B.

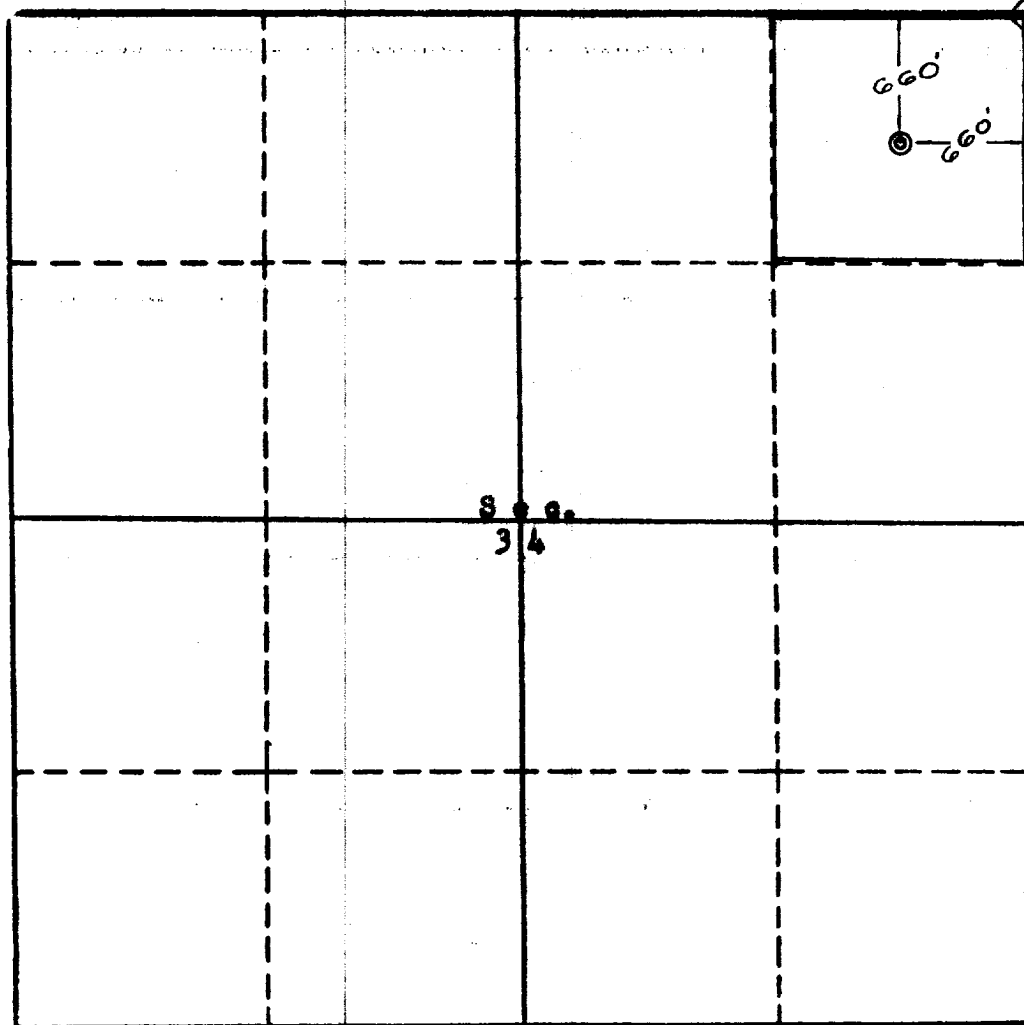

This is to certify that the information in Section A above is true and complete to the best of my knowledge and belief.

SKELLY OIL COMPANY

(OPERATOR)

J. W. George
 (REPRESENTATIVE)

Box 38, Hobbs, New Mexico

(ADDRESS)

This is to certify that the well location shown on the plat in Section B was plotted from field notes of actual surveys made by me or under my supervision and that the same is true and correct to the best of my knowledge and belief.

Date Surveyed April 23, 1963Four States Engineering Co.

FARMINGTON, NEW MEXICO

Edward V. Cavanaugh
 REGISTERED ENGINEER OR
 LAND SURVEYOR

Certificate No. 3602