

(SUBMIT IN TRIPLICATE)

UNITED STATES
DEPARTMENT OF THE INTERIOR
GEOLOGICAL SURVEY

Budget Bureau No. 42-13300-1
Approval expires 12-31-60.
Indian Agency Albuquerque

Allottee Manejo
Lease No. 24-20-403-7013

SUNDRY NOTICES AND REPORTS ON WELLS

NOTICE OF INTENTION TO DRILL	<input checked="" type="checkbox"/>	SUBSEQUENT REPORT OF WATER SHUT-OFF	
NOTICE OF INTENTION TO CHANGE PLANS		SUBSEQUENT REPORT OF SHOOTING OR ACIDIZING	
NOTICE OF INTENTION TO TEST WATER SHUT-OFF		SUBSEQUENT REPORT OF ALTERING CASING	
NOTICE OF INTENTION TO REDRILL OR REPAIR WELL		SUBSEQUENT REPORT OF REDRILLING OR REPAIR	
NOTICE OF INTENTION TO SHOOT OR ACIDIZE		SUBSEQUENT REPORT OF ABANDONMENT	
NOTICE OF INTENTION TO PULL OR ALTER CASING		SUPPLEMENTARY WELL HISTORY	
NOTICE OF INTENTION TO ABANDON WELL			

(INDICATE ABOVE BY CHECK MARK NATURE OF REPORT, NOTICE, OR OTHER DATA)

November 15, 1963

Well No. 12 is located 940 ft. from N line and 2100 ft. from W line of sec. 34

12 (4 Sec. and Sec. No.) 34 (Twp.) 12N (Range) 12W (Meridian)
Manejo (Field) San Juan (County or Subdivision) New Mexico (State or Territory)

The elevation of the derrick floor above sea level is 5100 ft. (est. KB)

DETAILS OF WORK

(State names of and expected depths to objective sands; show sizes, weights, and lengths of proposed casings; indicate mudding jobs, cementing points, and all other important proposed work)

It is our intention to drill Well No. 12 to around 1315' to test Gallup formation

Our casing program is as follows:

- 20' - 4-1/2" OD 17.5 lb Spiral Weld Casing - to be cemented with 25 sacks regular cement.
- 1315' - 4-1/2" OD 9.25 lb Casing - to be cemented with 75 sacks regular cement w/6 gal and 250 gallons per sack and 25 sacks regular w/25 calcium chloride.



I understand that this plan of work must receive approval in writing by the Geological Survey before operations may be commenced.

Company SHILEY OIL COMPANY

Address Box 770

Albuquerque, New Mexico

By J. M. George
Title Assistant District Superintendent

NEW MEXICO OIL CONSERVATION COMMISSION

Well Location and Acreage Dedication Plat

SECTION A.

Date November 15, 1963

Operator Skelly Oil Company Lease Navajo "M"
Well No. 12 Unit Letter C Section 34 Township 32 North Range 17 West NMPM
Located 560 Feet From North Line, 2180 Feet From West Line
County San Juan G. L. Elevation 5467 Dedicated Acreage 40 Acres
Name of Producing Formation Gallup Pool Many Rocks Gallup

1. Is the Operator the only owner* in the dedicated acreage outlined on the plat below? Yes X No
2. If the answer to question One is "No," have the interests of all the owners been consolidated by communitization agreement or otherwise? Yes No If answer is "Yes," Type of Consolidation
3. If the answer to question Two is "No," list all the owners and their respective interests below:

OWNER

LAND DESCRIPTION

SECTION B.

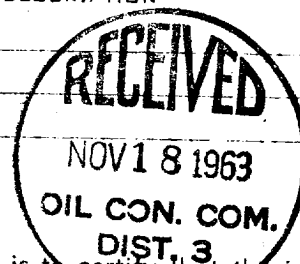
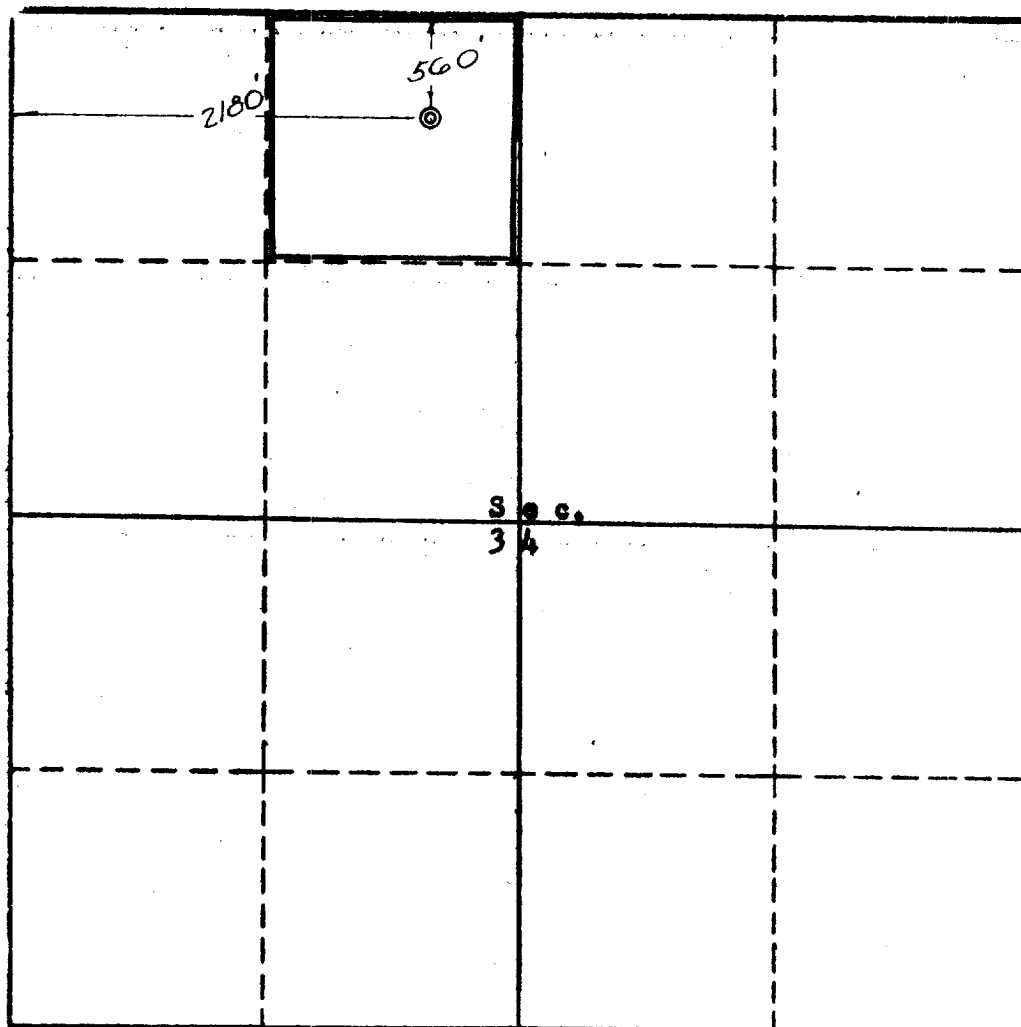

This is to certify that the information in Section A above is true and complete to the best of my knowledge and belief.

SKELLY OIL COMPANY

(OPERATOR)

J. W. George
(REPRESENTATIVE)

Box 730, Hobbs, New Mexico

(ADDRESS)

This is to certify that the well location shown on the plat in Section B was plotted from field notes of actual surveys made by me or under my supervision and that the same is true and correct to the best of my knowledge and belief.

Date Surveyed Oct. 15, 1963

Four States Engineering Co.
FARMINGTON, NEW MEXICO

Carl W. Echols
REGISTERED ENGINEER OR
LAND SURVEYOR

Certificate No. 3602

