

District I
P.O. Box 1880, Hobbs, NM

District II
P.O. Drawer DD, Aztec, NM 88413

District III
1000 Rio Brazos Rd, Aztec, NM 87413

State of New Mexico
Energy, Minerals and Natural Resources Department

OIL CONSERVATION DIVISION

2040 South Pacheco Street
Santa Fe, New Mexico 87505

SUBMIT COPY TO
APPROPRIATE
DISTRICT OFFICE
AND 1 COPY TO
SANTA FE OFFICE

RECEIVED
JUL 30 1999

OIL CON. DIV.
DIST. 3

PIT REMEDIATION AND CLOSURE REPORT

Operator: PNM Gas Services (Burlington) Telephone: 324-3764

Address: 603 W. Elm Street Farmington, NM 87401

Facility or Well Name: Culpepper Martin #13

Location: Unit N Sec 29 T 32 N R 12 W County San Juan

Pit Type: Separator ☒ Dehydrator ☐ Other

Land Type: BLM ☐ State ☐ Fee ☒ Other

Pit Location: Pit dimensions: length 20' width 20' depth 4'

(Attach diagram) Reference: wellhead ☒ other

Footage from reference: 81'

Direction from reference: 5 Degrees ☒ East North ☒
of ☐ West South ☐

Depth to Ground Water:

(Vertical distance from contaminants to
seasonal high water elevation of ground
water)

Less than 50 feet (20 points)
50 feet to 99 feet (10 points)
Greater than 100 feet (0 points) 0

Wellhead Protection Area:

(Less than 200 feet from a private
domestic water source, or, less than 1,000
feet from all other water sources)

Yes (20 points)
No (0 points) 0

Distance to Surface Water:

(Horizontal distance to perennial lakes,
ponds, rivers, streams, creeks, irrigation
canals and ditches)

Less than 200 feet (20 points)
200 feet to 1,000 feet (10 points)
Greater than 1,000 feet (0 points) 0

RANKING SCORE (TOTAL POINTS): 0

Culpepper Martin #13

Date Remediation Started: 05/04/1999

Date Completed: 05/05/1999

Remediation Method:

Excavation ☒

Approx. Cubic Yard 739

(Check all appropriate sections)

Landfarmed ☒

Amount Landfarmed (cubic yds) 739

Other _____

Remediation Location:

Onsite ☒

Offsite _____

(i.e. landfarmed onsite, name and location of offsite facility)

Backfill Material Location: _____

General Description of Remedial Action:

Excavated contaminated soil to a pit size of 43' X 58' X 8' and landfarmed soil onsite within a bermed area at a depth of 6" to 12". Soil was aerated by disking/plowing until soil met regulatory levels.

Ground Water Encountered:

No ☒

Yes ☐

Depth _____

Final Pit Closure Sampling:

Sample Location

5 pt. composite - bottom.

(if multiple samples, attach sample result and diagram of sample locations and depths.)

Sample depth

8'

Sample date

05/05/1999

Sample time

1:20:00 PM

Sample Results

Benzene (ppm) < 0.025

Total BTEX (ppm) 2.07

Field headspace (ppm) _____

TPH (ppm)

27.00

Method

8015B

Vertical Extent (ft) _____

Risk Analysis form attached Yes ☐

No ☒

Ground Water Sample:

Yes ☐

No ☒

(If yes, see attached Groundwater Site Summary Report)

I HEREBY CERTIFY THAT THE INFORMATION ABOVE IS TRUE AND COMPLETE TO THE BEST OF MY KNOWLEDGE AND MY BELIEF

DATE July 27, 1999

SIGNATURE

Maureen Gannon

PRINTED NAME Maureen Gannon
AND TITLE Project Manager

Culpeper Martin #13

(N) 29-52N-12W

Burlington

5-4-44

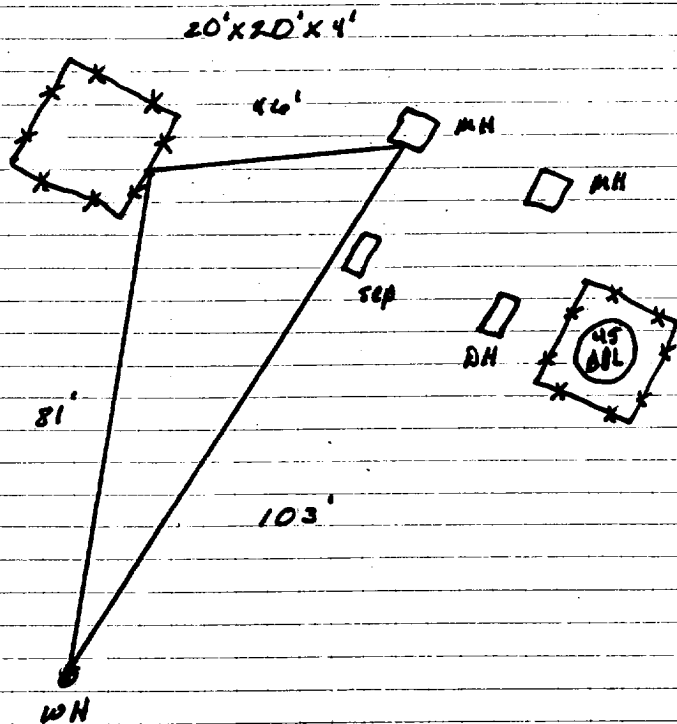
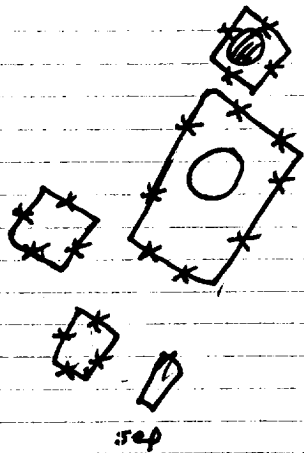

Excavation Sampling

PTD readings

5' - 1743 ppm

6' - 1117 ppm

8' - 1400 ppm

west wall head space
at 8' - 0 ppm

5 point bottom composite head space
at 8' - 15 1/4 ppm

north wall head space
at 8' - 131 ppm

east wall head space
at 8' - 0 ppm

south wall head space
at 8' - 0 ppm

no to seal

OFF: (505) 325-5667



LAB: (505) 325-1556

On Site Technologies, LTD.

Date: 18-May-99

CLIENT: PNM - Public Service Company of NM

Project: Culpepper Martin #13

Lab Order: 9905026

CASE NARRATIVE

- Samples were analyzed using the methods outlined in the following references:

Test Methods for Evaluating Solid Waste, Physical/Chemical Methods, SW846, 3rd Edition

All method blanks, laboratory spikes, and/or matrix spikes met quality assurance objectives.

Ray

OFF: (505) 325-5667



LAB: (505) 325-1556

ANALYTICAL REPORT

Date: 18-May-99

Client:	PNM - Public Service Company of NM	Client Sample Info:	Culpepper Martin #13
Work Order:	9905026	Client Sample ID:	9905051320; 5pt Bottom Comp
Lab ID:	9905026-01A	Matrix:	SOIL
Project:	Culpepper Martin #13	Collection Date:	5/5/99 1:20:00 PM
		COC Record:	7188

Parameter	Result	PQL	Qual	Units	DF	Date Analyzed
DIESEL RANGE ORGANICS		SW8015B				Analyst: DC
T/R Hydrocarbons: C10-C28	27	25		mg/Kg	1	5/17/99
AROMATIC VOLATILES BY GC/PID		SW8021B				Analyst: DC
Benzene	ND	25		µg/Kg	25	5/11/99
Toluene	430	50		µg/Kg	25	5/11/99
Ethylbenzene	110	25		µg/Kg	25	5/11/99
m,p-Xylene	1200	50		µg/Kg	25	5/11/99
o-Xylene	330	25		µg/Kg	25	5/11/99

2070
2.070 ppm

Qualifiers:	PQL - Practical Quantitation Limit	S - Spike Recovery outside accepted recovery limits
	ND - Not Detected at Practical Quantitation Limit	R - RPD outside accepted recovery limits
	J - Analyte detected below Practical Quantitation Limit	E - Value above quantitation range
	B - Analyte detected in the associated Method Blank	Surr: - Surrogate

P.O. BOX 2606 • FARMINGTON, NM 87499

1 of 1

- TECHNOLOGY BLENDING INDUSTRY WITH THE ENVIRONMENT -

OFF: (505) 325-5667



LAB: (505) 325-1556

ANALYTICAL REPORT

Date: 18-May-99

Client:	PNM - Public Service Company of NM	Client Sample Info:	Culpepper Martin #13
Work Order:	9905026	Client Sample ID:	9905051325; 4 Wall Comp
Lab ID:	9905026-02A	Matrix:	SOIL
Project:	Culpepper Martin #13	Collection Date:	5/5/99 1:25:00 PM
		COC Record:	7188

Parameter	Result	PQL	Qual	Units	DF	Date Analyzed
DIESEL RANGE ORGANICS		SW8015B				Analyst: DC
T/R Hydrocarbons: C10-C28	26	25		mg/Kg	1	5/10/99

Qualifiers:

- PQL - Practical Quantitation Limit
- ND - Not Detected at Practical Quantitation Limit
- J - Analyte detected below Practical Quantitation Limit
- B - Analyte detected in the associated Method Blank

- S - Spike Recovery outside accepted recovery limits
- R - RPD outside accepted recovery limits
- E - Value above quantitation range
- Surr: - Surrogate

1 of 1

P.O. BOX 2606 • FARMINGTON, NM 87499

- TECHNOLOGY BRIDGING INDUSTRY WITH THE ENVIRONMENT -

Calpepper Martin #13
Sec-29 T-32N R-12W UL-N
Burlington

Landfarm Drawing

App 738 cu yds

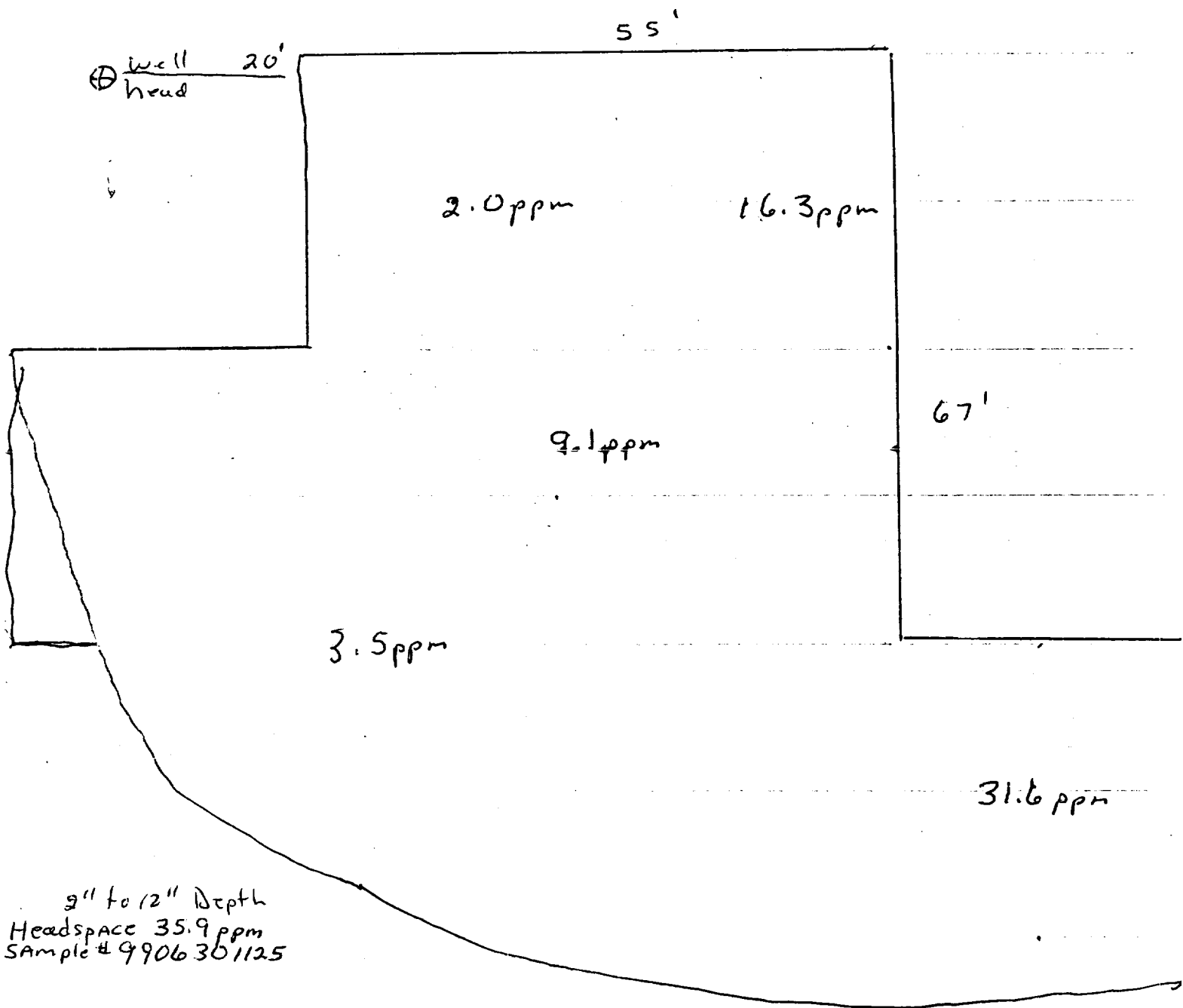

Not to Scale

OFF: (505) 325-5667



LAB: (505) 325-1556

On Site Technologies, LTD.

Date: 19-Jul-99

CLIENT: PNM - Public Service Company of NM

Project: Culpepper Martin Landfarms

Lab Order: 9907002

CASE NARRATIVE

Samples were analyzed using the methods outlined in the following references:

Test Methods for Evaluating Solid Waste, Physical/Chemical Methods, SW846, 3rd Edition

All method blanks, laboratory spikes, and/or matrix spikes met quality assurance objectives.

OFF: (505) 325-5667



LAB: (505) 325-1556

ANALYTICAL REPORT

Date: 19-Jul-99

Client:	PNM - Public Service Company of NM	Client Sample Info:	Culpepper Martin #13 LF
Work Order:	9907002	Client Sample ID:	9906301125; 5pt. Composite
Lab ID:	9907002-04A	Matrix:	SOIL
Project:	Culpepper Martin Landfarms	Collection Date:	6/30/99 11:25:00 AM
		COC Record:	7727

Parameter	Result	PQL	Qual	Units	DF	Date Analyzed
DIESEL RANGE ORGANICS		SW8015B				Analyst: DC
T/R Hydrocarbons: C10-C28	34	25		mg/Kg	1	7/14/99

Qualifiers:

PQL - Practical Quantitation Limit

ND - Not Detected at Practical Quantitation Limit

J - Analyte detected below Practical Quantitation Limit

B - Analyte detected in the associated Method Blank

S - Spike Recovery outside accepted recovery limits

R - RPD outside accepted recovery limits

E - Value above quantitation range

Surr: - Surrogate

1 of 1

P.O. BOX 2606 • FARMINGTON, NM 87499

- TECHNOLOGY BLENDING INDUSTRY WITH THE ENVIRONMENT -