

(SUBMIT IN TRIPLICATE)

Indian Agency **Navajo Tribal**

UNITED STATES
DEPARTMENT OF THE INTERIOR
GEOLOGICAL SURVEY

Allottee _____

Lease No. **14-20-603-5012**

	27	
		X

SUNDRY NOTICES AND REPORTS ON WELLS

NOTICE OF INTENTION TO DRILL	<input checked="" type="checkbox"/>	SUBSEQUENT REPORT OF WATER SHUT-OFF	RECEIVED JAN 10 1963 U. S. GEOLOGICAL SURVEY FARMINGTON, NEW MEXICO
NOTICE OF INTENTION TO CHANGE PLANS		SUBSEQUENT REPORT OF SHOOTING OR ACIDIZING	
NOTICE OF INTENTION TO TEST WATER SHUT-OFF		SUBSEQUENT REPORT OF ALTERING CASING	
NOTICE OF INTENTION TO REDRILL OR REPAIR WELL		SUBSEQUENT REPORT OF REDRILLING OR REPAIR	
NOTICE OF INTENTION TO SHOOT OR ACIDIZE		SUBSEQUENT REPORT OF ABANDONMENT	
NOTICE OF INTENTION TO PULL OR ALTER CASING		SUPPLEMENTARY WELL HISTORY	
NOTICE OF INTENTION TO ABANDON WELL			

(INDICATE ABOVE BY CHECK MARK NATURE OF REPORT, NOTICE, OR OTHER DATA)

January 4, 19**63**

Navajo
Well No. **3-27-X** is located **625** ft. from **{N}** line and **2000** ft. from **{E}** line of sec. **27**
SW SE 27 **32N 17W NMP**
(1/4 Sec. and Sec. No.) (Twp.) (Range) (Meridian)
Undesignated San Juan New Mexico
(Field) (County or Subdivision) (State or Territory)

The elevation of the derrick floor above sea level is **5915** ft.

DETAILS OF WORK

(State names of and expected depths to objective sands; show sizes, weights, and lengths of proposed casings; indicate mudding jobs, cementing points, and all other important proposed work)

Objective Horizon: Gallup sandstone at 1715'.
Anticipated TD: 1765' in Sanostee formation.
Will drill 9 3/4" surface hole and set 1 joint (approximately 30') of 8 5/8" surface casing and cement to surface.
Plan to run 1750' of 5" oil string in the 6 3/4" hole and cement with 35 sz. and sand-oil frac with 20,000 gallons oil and 20,000 lbs. sand.

I understand that this plan of work must receive approval in writing by the Geological Survey before operations may be commenced.

Company **Curtis J. Little**
 Address **2929 Monte Vista, NE**
Albuquerque, New Mexico

By *Curtis J. Little*
 Title **Operator**

NEW MEXICO OIL CONSERVATION COMMISSION

Well Location and Acreage Dedication Plat

SECTION A.

Date **January 7, 1963**

Operator **Curtis J. Little** Lease **27 Navajo**
 Well No. **3-X** Unit Letter **0** Section **27** Township **32 North** Range **17 West** NMFM
 Located **625** Feet From **South** Line, **2000** Feet From **East** Line
 County **San Juan** G. L. Elevation **5915** Dedicated Acreage **40** Acres
 Name of Producing Formation **Gallup (Horseshoe)** Pool **Wildcat**

1. Is the Operator the only owner* in the dedicated acreage outlined on the plat below? Yes ☒ No
2. If the answer to question One is "No," have the interests of all the owners been consolidated by communization agreement or otherwise? Yes _____ No _____. If answer is "Yes," Type of Consolidation _____
3. If the answer to question Two is "No," list all the owners and their respective interests below:

OWNER

LAND DESCRIPTION

SECTION B.

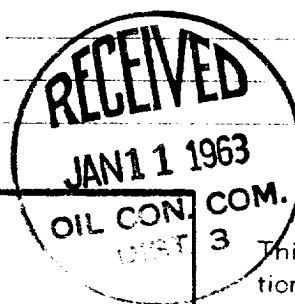
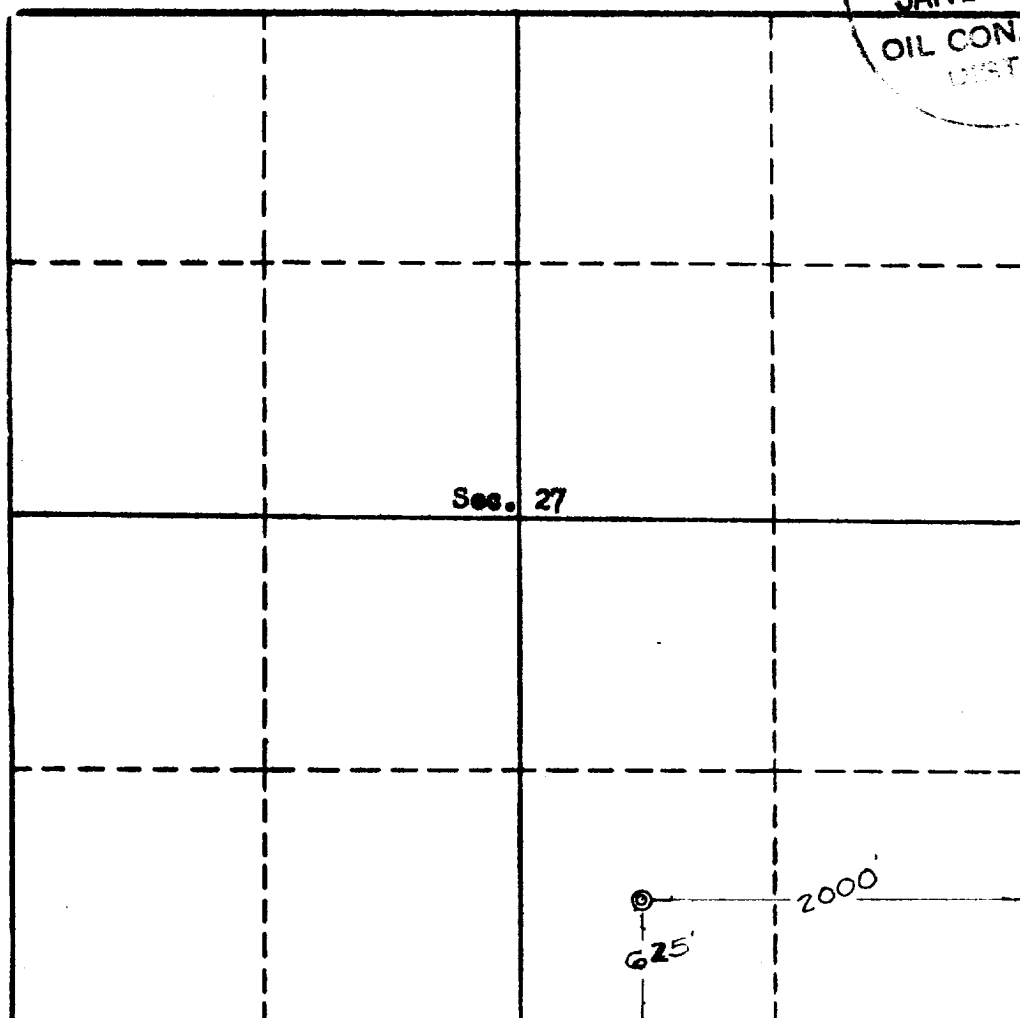

RECEIVED

JAN 10 1963

U. S. GEOLOGICAL SURVEY
FARMINGTON, NEW MEXICO

This is to certify that the information in Section A above is true and complete to the best of my knowledge and belief.

Curtis J. Little
(OPERATOR)

(REPRESENTATIVE)
2929 Monte Vista NE
Albuquerque, New Mexico
(ADDRESS)

This is to certify that the well location shown on the plat in Section B was plotted from field notes of actual surveys made by me or under my supervision and that the same is true and correct to the best of my knowledge and belief.

Date Surveyed **Jan. 7, 1963**Four States Engineering Co.
FARMINGTON, NEW MEXICO

REGISTERED ENGINEER OR
LAND SURVEYOR
Certificate No. **3602**