

(SUBMIT IN TRIPLICATE)

Indian Agency Navajo Tribal

UNITED STATES
DEPARTMENT OF THE INTERIOR
GEOLOGICAL SURVEY

Allottee _____

Lease No. 14-20-603-1058

SUNDRY NOTICES AND REPORTS ON WELLS

NOTICE OF INTENTION TO DRILL _____	<input checked="" type="checkbox"/>	SUBSEQUENT REPORT OF WATER SHUT-OFF _____	
NOTICE OF INTENTION TO CHANGE PLANS _____		SUBSEQUENT REPORT OF SHOOTING OR ACIDIZING _____	
NOTICE OF INTENTION TO TEST WATER SHUT-OFF _____		SUBSEQUENT REPORT OF ALTERING CASING _____	
NOTICE OF INTENTION TO REDRILL OR REPAIR WELL _____		SUBSEQUENT REPORT OF REDRILLING OR REPAIR _____	
NOTICE OF INTENTION TO SHOOT OR ACIDIZE _____		SUBSEQUENT REPORT OF ABANDONMENT _____	
NOTICE OF INTENTION TO PULL OR ALTER CASING _____		SUPPLEMENTARY WELL HISTORY _____	
NOTICE OF INTENTION TO ABANDON WELL _____			

(INDICATE ABOVE BY CHECK MARK NATURE OF REPORT, NOTICE, OR OTHER DATA)

August 29, 1956

Blitz Peak
Well No. 2 is located 1750 ft. from N line and 1738 ft. from E line of sec. 26
NE/4 Section 26 32N 21W 108W
(34 Sec. and Sec. No.) (Twp.) (Range) (Meridian)
Wildcat San Juan New Mexico
(Field) (County or Subdivision) (State or Territory)

The elevation of the derrick floor above sea level is 5030 ft.

DETAILS OF WORK

(State names of and expected depths to objective sands; show sizes, weights, and lengths of proposed casings; indicate mudding jobs, cementing points, and all other important proposed work)

It is intended to drill a well using rotary tools to an estimated T.D. of 5595'. Production casing will be run and all possible producing zones in the **Paradox Formation** will be perforated and acidized.

Casing Program:

13 3/8" at 230' with 200 sacks circulated to the surface.
9 5/8" at 1920' with 700 sacks circulated to the surface.
5 1/2" at 5595' with 700 sacks cement.



I understand that this plan of work must receive approval in writing by the Geological Survey before operations are commenced.

Company El Paso Natural Gas Company

Address Box 997

Farmington, New Mexico

By W. F. Covak

Title Petroleum Engineer



2000-01-01

NEW MEXICO
OIL CONSERVATION COMMISSION

WELL LOCATION AND/OR GAS PRODUCTION PLAT

AUGUST 24, 1956

EL PASO NATURAL GAS COMPANY

BITA PEAK

NAV. TRIBAL 14-20-603-1058

2

26

32-N

21-W

1750

NORTH

1738

EAST

SAN JUAN

5020

WILDCAT

160 ACRES
(1951 PLAT)

Note: All distances must be true to the boundaries of the section.

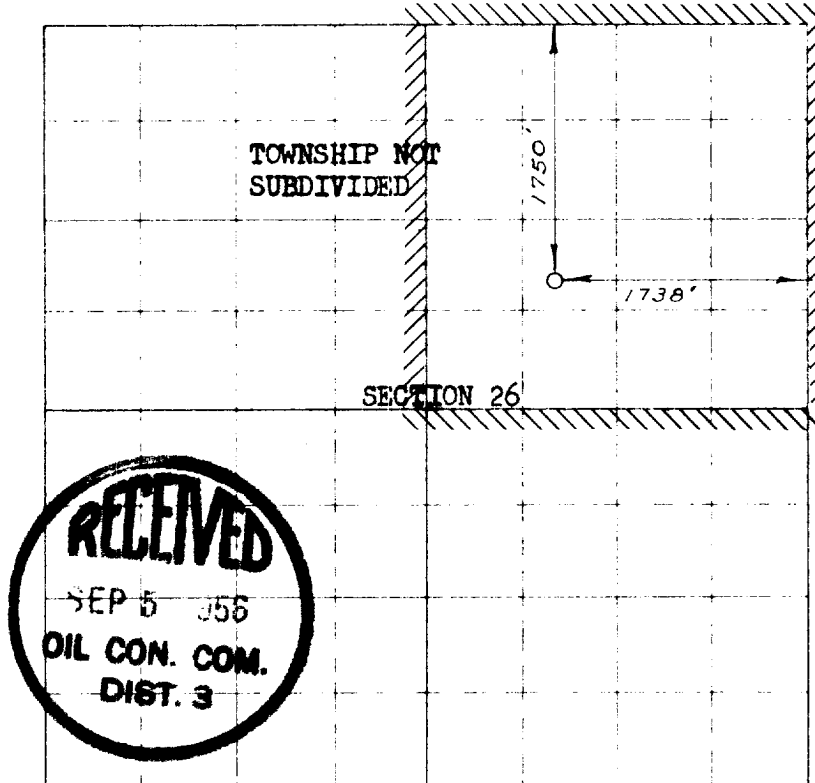

RECEIVED
AUG 29 1956
U. S. GEOLOGICAL SURVEY
FARMINGTON, NEW MEXICO

NOTE

This section of
form is to be used
for gas wells only

Scale 4 inches equal 1 mile

I hereby certify that the above plat was prepared from
field notes of actual surveys made by me or under my
supervision and that the same are true and correct to the
best of my knowledge and belief.

Date surveyed: AUGUST 23, 1956

E. O. Tracker
Registered Professional Engineer and/or Land Surveyor

1. Is this well a Dual Comp.

Yes _____ No X _____

2. If the answer to Question 1
is yes, are there any other land-
completed wells within the
dedicated acreage.

Yes _____ No _____

Name W. F. Dorset

Position Petroleum Engineer

Representing El Paso Natural Gas Co.

Address Box 997, Farmington, N.M.

(Seal)

Farmington, New Mexico