

## NEW MEXICO OIL CONSERVATION COMMISSION

## Well Location and Acreage Dedication Plat

## SECTION A.

Date January 16, 1963

Operator Curtis J. Little Lease Navajo  
 Well No. 3-28 Unit Letter H Section 28 Township 32 North Range 17 West NMPM  
 Located 1950 Feet From North Line, 715 Feet From East Line  
 County San Juan G. L. Elevation 5848 Dedicated Acreage 40 Acres  
 Name of Producing Formation Gallego Pool Undesignated

1. Is the Operator the only owner\* in the dedicated acreage outlined on the plat below? Yes ☒ No ☐
2. If the answer to question One is "No," have the interests of all the owners been consolidated by communitization agreement or otherwise? Yes ☐ No ☐ If answer is "Yes," Type of Consolidation \_\_\_\_\_
3. If the answer to question Two is "No," list all the owners and their respective interests below:

OWNER

LAND DESCRIPTION

## SECTION B.

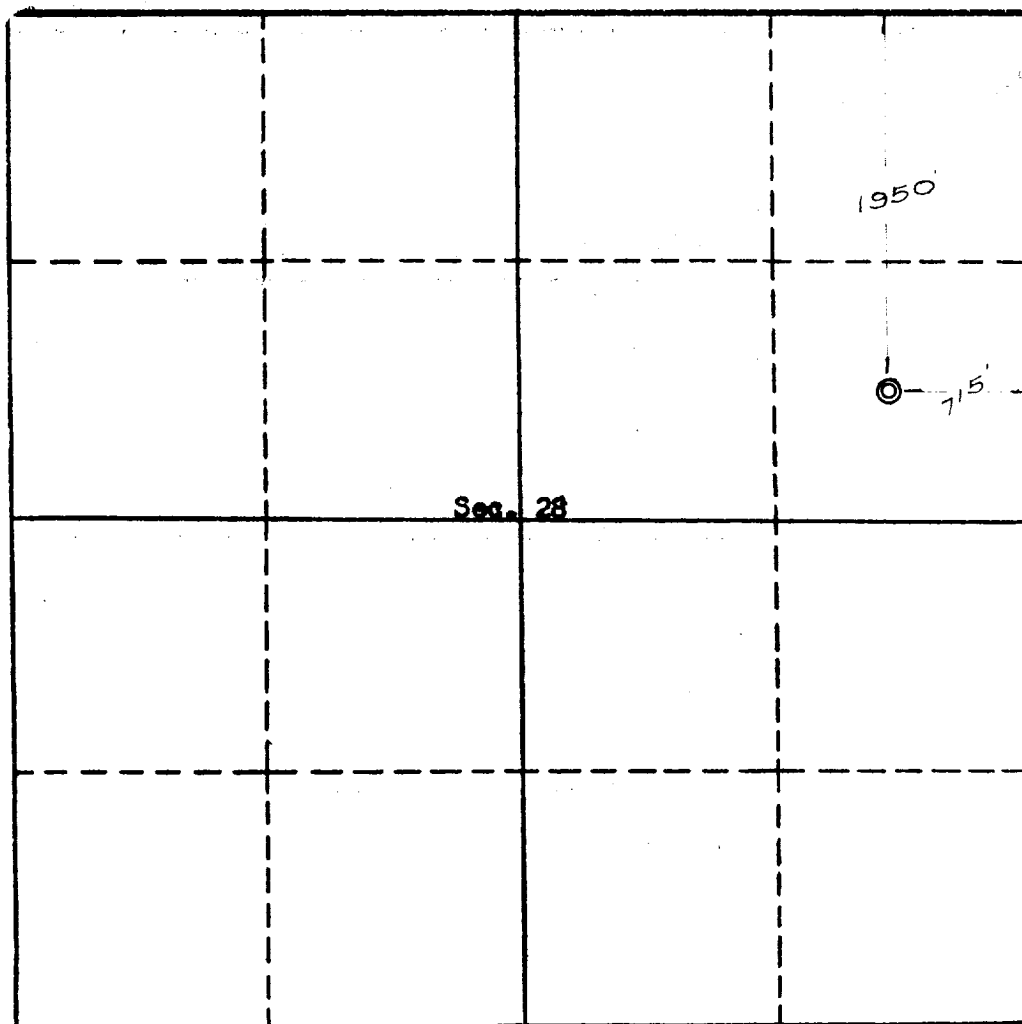

This is to certify that the information in Section A above is true and complete to the best of my knowledge and belief.

*Curtis J. Little*  
**RECEIVED**  
 JAN 21 1963  
 (REPRESENTATIVE)  
 2929 Monte Vista NE  
 Albuquerque, New Mexico  
 (ADDRESS)

**STATE OF NEW MEXICO**  
 This is to certify that the well location shown on the plat in Section B was plotted from field notes of actual surveys made by me or under my supervision and that the same is true and correct to the best of my knowledge and belief.

Date Surveyed Jan. 12, 1963

**Four States Engineering Co.**  
 FARMINGTON, NEW MEXICO

*Emmett J. Cook*  
 REGISTERED ENGINEER OR  
 LAND SURVEYOR

Certificate No. 3602