

NEW MEXICO OIL CONSERVATION COMMISSION

Well Location and Acreage Dedication Plat

Section A.

Date April 23, 1963

Operator THE MURPHY CORPORATION Lease Navajo "AA"
 Well No. 2 Unit Letter N Section 17 Township 32 NORTH Range 17 WEST NMPM
 Located 615 Feet From the SOUTH Line, 1945 Feet From the WEST Line
 County San Juan G. L. Elevation 5761 Dedicated Acreage 4.0 Acres
 Name of Producing Formation Lower Gallup Pool Wildcat

1. Is the Operator the only owner in the dedicated acreage outlined on the plat below?
 Yes ☒ No ☐
2. If the answer to question one is "no", have the interests of all the owners been consolidated by communitization agreement or otherwise? Yes ☐ No ☐ If answer is "yes", Type of Consolidation.
3. If the answer to question two is "no", list all the owners and their respective interests below:

OwnerLand Description

Section B.

This is to certify that the information in Section A above is true and complete to the best of my knowledge and belief.

Murphy Corporation

(Operator)

L. L. Dunson

(Representative)

200 Jefferson Avenue

(Address)

El Dorado, Arkansas

Note: All distances must be from outer boundaries of section.

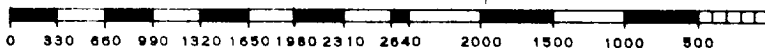
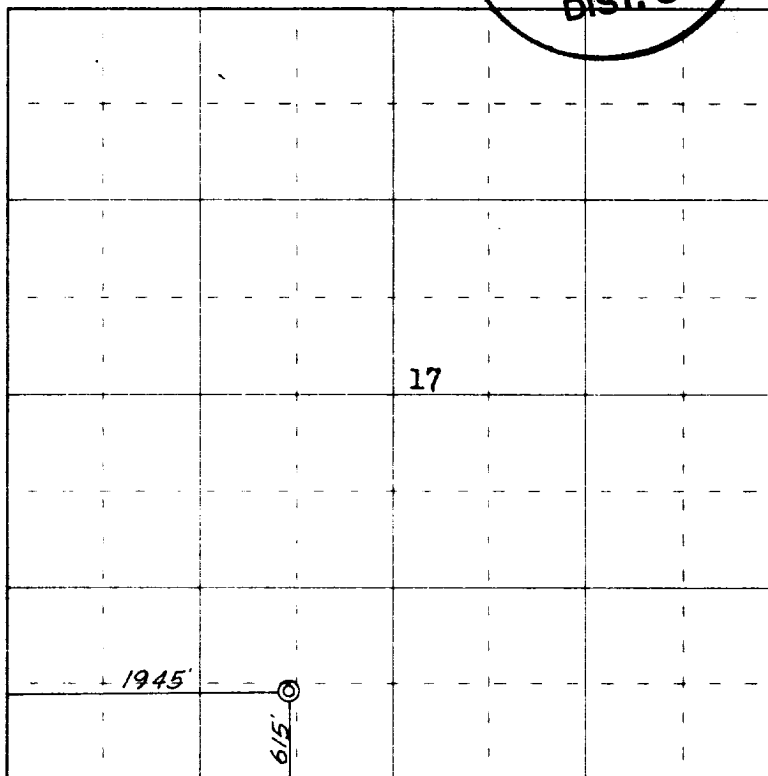

Scale 4 inches equal 1 mile

This is to certify that the above plat was prepared from field notes of actual surveys made by me or under my supervision and that the same are true and correct to the best of my knowledge and belief.

Date Surveyed 11 April 1963

James P. Leese
 Registered Professional Engineer and/or Land Surveyor
 James P. Leese, N. Mex. Reg. No. 1463
 San Juan Engineering Company

Farmington, New Mexico