

(SUBMIT IN TRIPLICATE)

Indian Agency Savage

UNITED STATES
DEPARTMENT OF THE INTERIOR
GEOLOGICAL SURVEY

Allottee _____

Lease No. 14-30-600-3538

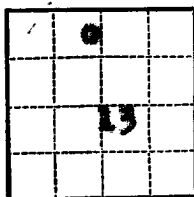

SUNDRY NOTICES AND REPORTS ON WELLS

NOTICE OF INTENTION TO DRILL _____	<input checked="" type="checkbox"/> SUBSEQUENT REPORT OF WATER SHUT-OFF _____
NOTICE OF INTENTION TO CHANGE PLANS _____	SUBSEQUENT REPORT OF SHOOTING OR ACIDIZING _____
NOTICE OF INTENTION TO TEST WATER SHUT-OFF _____	SUBSEQUENT REPORT OF ALTERING CASING _____
NOTICE OF INTENTION TO REDRILL OR REPAIR WELL _____	SUBSEQUENT REPORT OF REDRILLING OR REPAIR _____
NOTICE OF INTENTION TO SHOOT OR ACIDIZE _____	SUBSEQUENT REPORT OF ABANDONMENT _____
NOTICE OF INTENTION TO PULL OR ALTER CASING _____	SUPPLEMENTARY WELL HISTORY _____
NOTICE OF INTENTION TO ABANDON WELL _____	

(INDICATE ABOVE BY CHECK MARK NATURE OF REPORT, NOTICE, OR OTHER DATA)

September 25, 19 64

Well No. 1 is located 660 ft. from N line and 1980 ft. from W line of sec. 13

SENECA Sec. 13 32 North 17 West N.M.P.M.
(Of Sec. and Sec. No.) (Twp.) (Range) (Meridian)
Adiant San Juan County New Mexico
(Field) (County or Subdivision) (State or Territory)

The elevation of the derrick floor above sea level is _____ ft.

DETAILS OF WORK

(State names of and expected depths to objective sands; show sizes, weights, and lengths of proposed casings; indicate mudding jobs, cementing points, and all other important proposed work)

It is intended to drill a 3750' Dakota test in the following manner: Drill 11" hole to 200' and cement 8 5/8" casing with 60 sacks. Drill 7 7/8" hole to total depth with mud. If commercial production is encountered, set 4 1/2" casing and fluid frac with chemicals. Put well on production.

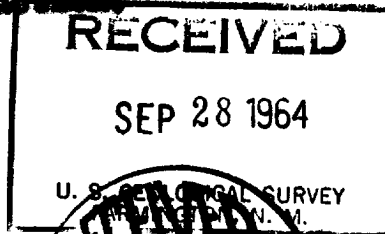

I understand that this plan of work must receive approval in writing by the Geological Survey before operation of the well is commenced.

Company Miami Oil Producers, Inc.

Address P.O. Box 2040

Abilene, Texas

By Howard L. Kennedy
Title Agent

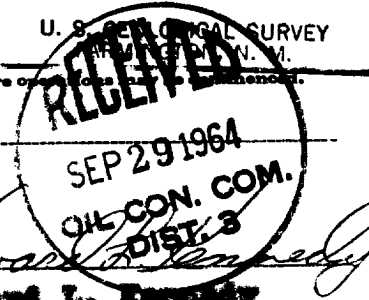

*Hold C-110 for C-128
Rel'd to open 9-30-64
al*

NEW MEXICO OIL CONSERVATION COMMISSION

Well Location and Acreage Dedication Plat

Date September 25, 1964

Section A.

Operator MIAMI OIL PRODUCER, INC. Lease 14-20-600-3538
 Well No. 1 Unit Letter C Section 13 Township 32 NORTH Range 17 WEST NMPM
 Located 990 Feet From NORTH Line 1980 Feet From WEST Line
 County SAN JUAN G. L. Elevation 6837 G.L. Dedicated Acreage 40 Acres
 Name of Producing Formation Dakota Pool Wildcat

1. Is the Operator the only owner in the dedicated acreage outlined on the plat below?

Yes X No

2. If the answer to question one is "no", have the interests of all the owners been consolidated by communitization agreement or otherwise? Yes No If answer is "yes", type of Consolidation.

2. If the answer to question two is "no", list all the owners and their respective interests below:

Owner

Land Description

Section B.

This is to certify that the information in Section A above is true and complete to the best of my knowledge and belief.

Miami Oil Prod., Inc.

(Operator)

Howard L. Kennedy

(Representative)

Box 3348

Durango, Colo.

Note: All distances must be from outer boundaries of section.

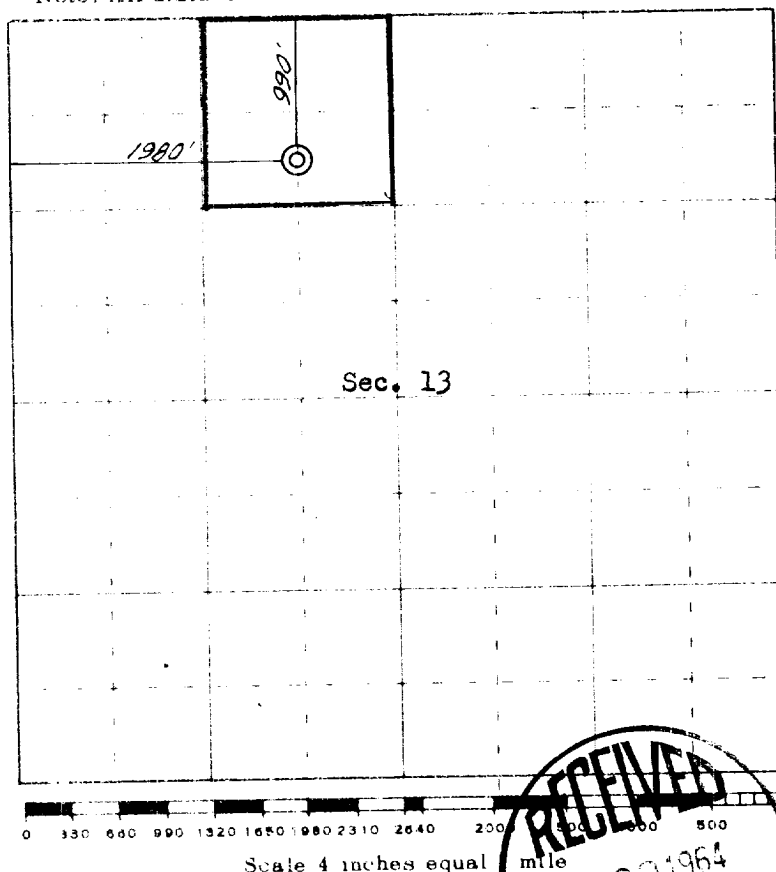

Ref: GLO plat dated unsurveyed

This is to certify that the above plat was prepared from field notes of actual surveys made by me or under my supervision and that the same are true and correct to the best of my knowledge and belief.

Date Surveyed September 25, 1964

James P. Leese
 Registered Professional Engineer and/or Land Surveyor
 James P. Leese, N. Mex. Reg. No. 1463
 San Juan Engineering Co.