

District I  
P.O. Box 1980, Hobbs, NM 88240

District II  
P.O. Drawer DD, Lordsburg, NM 88000

District III  
1000 Rio Brazos Rd, Aztec, NM 87410

*Denny E. Frost*  
**DEPUTY OIL & GAS INSPECTOR**

State of New Mexico  
Energy, Minerals and Natural Resources Department

OIL CONSERVATION DIVISION

2040 South Pacheco Street  
Santa Fe, New Mexico 87505

SEP 03 1999

CV  
SUBMIT 1 COPY TO  
APPROPRIATE  
DISTRICT OFFICE  
AND 1 COPY TO  
SANTA FE OFFICE  
**RECEIVED**  
JUL 30 1999  
OIL CON. DIV.  
DIST. 3

**PIT REMEDIATION AND CLOSURE REPORT**

*Approved*

Operator: PNM Gas Services (Burlington) Telephone: 324-3764

Address: 603 W. Elm Street Farmington, NM 87401

Facility or Well Name: Culpepper Martin #10

Location: Unit K Sec 32 T 32N R 12W County San Juan

Pit Type: Separator ☐ Dehydrator ☒ Other \_\_\_\_\_

Land Type: BLM ☐ State ☐ Fee ☒ Other \_\_\_\_\_

Pit Location: Pit dimensions: length 20' width 20' depth 3'

(Attach diagram) Reference: wellhead ☒ other \_\_\_\_\_

Footage from reference: 50'

Direction from reference: 45 Degrees ☐ East ☒ North ☒ of ☒ West ☐ South ☐

<b>Depth to Ground Water:</b>  (Vertical distance from contaminants to seasonal high water elevation of ground water)	Less than 50 feet	(20 points)	
	50 feet to 99 feet	(10 points)	
	Greater than 100 feet	(0 points)	<u>0</u>
<b>Wellhead Protection Area:</b>  (Less than 200 feet from a private domestic water source, or, less than 1,000 feet from all other water sources)	Yes	(20 points)	
	No	(0 points)	<u>20</u>
<b>Distance to Surface Water:</b>  (Horizontal distance to perennial lakes, ponds, rivers, streams, creeks, irrigation canals and ditches)	Less than 200 feet	(20 points)	
	200 feet to 1,000 feet	(10 points)	
	Greater than 1,000 feet	(0 points)	<u>0</u>
<b>RANKING SCORE (TOTAL POINTS):</b>			<u>20</u>

Culpepper Martin #10

Date Remediation Started: 05/11/1999

Date Completed: 05/12/1999

Remediation Method: Excavation ☒

Approx. Cubic Yard 1107

(Check all appropriate sections)

Landfarmed ☒

Amount Landfarmed (cubic yds) 1007

Other 100 cu yds overburden

Remediation Location:

Onsite ☒Offsite ☐

(i.e., landfarmed onsite, name and location of offsite facility)

Backfill Material Location: \_\_\_\_\_

## General Description of Remedial Action:

Excavated contaminated soil to a pit size of 61' X 35' X 14' and landfarmed soil onsite within a bermed area at a depth of 6" to 12". Soil was aerated by disking/plowing until soil met regulatory levels.

Ground Water Encountered:

No ☒Yes ☐

Depth \_\_\_\_\_

## Final Pit Closure Sampling:

Sample Location

5 pt. composite - bottom.

(if multiple samples, attach sample result and diagram of sample locations and depths.)

Sample depth

14'

Sample date

05/12/1999

Sample time

8:10:00 AM

## Sample Results

Benzene (ppm)

0.021

Total BTEX (ppm)

0.626

Field headspace (ppm)

TPH (ppm)

26.00

Method

8015B

Vertical Extent (ft) \_\_\_\_\_

Risk Analysis form attached Yes ☐No ☒

Ground Water Sample:

Yes ☐No ☒

(If yes, see attached Groundwater Site Summary Report)

I HEREBY CERTIFY THAT THE INFORMATION ABOVE IS TRUE AND COMPLETE TO THE BEST OF MY KNOWLEDGE AND MY BELIEF

DATE July 27, 1999

SIGNATURE

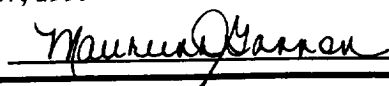

PRINTED NAME Maureen Gannon  
AND TITLE Project Manager

Culpeper- Martin #10  
Burlington  
Sec. 32, 32N, 12W, R

5/11/99

↑  
N

Site diagram:

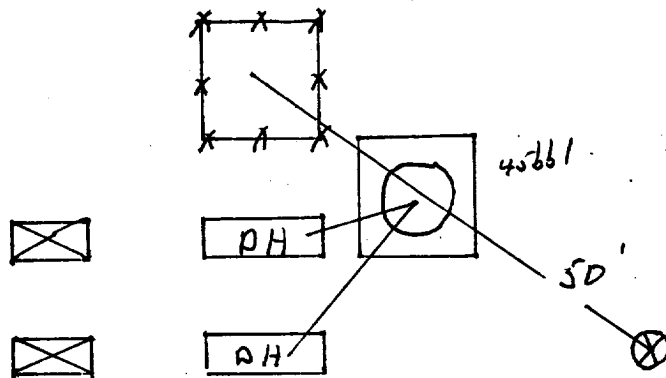

End of excavation:

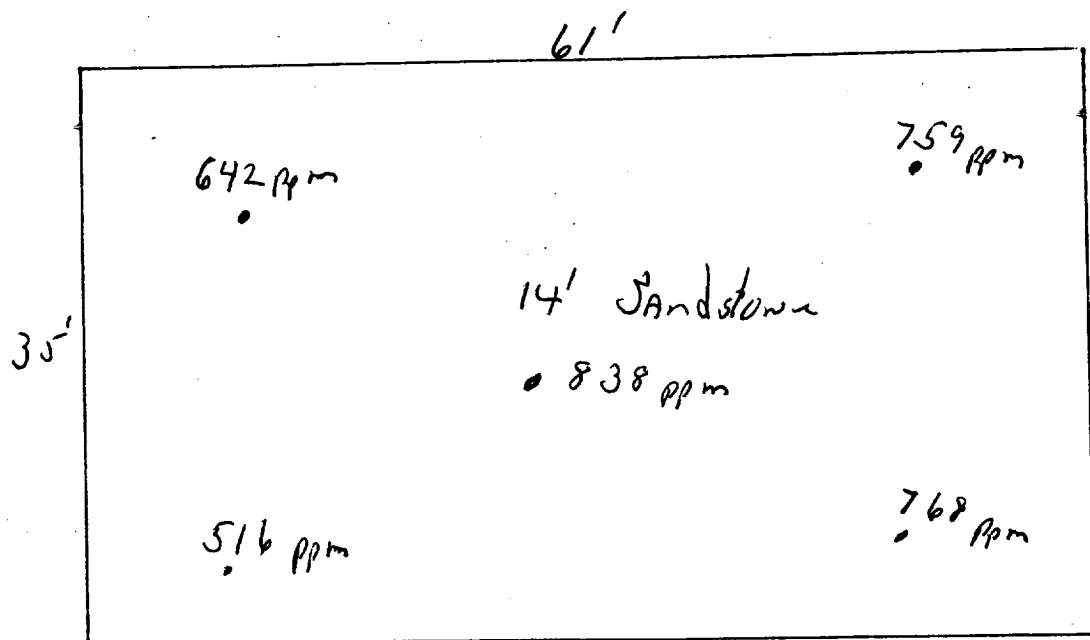

OFF: (505) 325-5667



LAB: (505) 325-1556

---

**On Site Technologies, LTD.**

**Date:** 25-May-99

---

**CLIENT:** PNM - Public Service Company of NM  
**Project:** Culpepper Martin #10  
**Lab Order:** 9905050

---

**CASE NARRATIVE**

Samples were analyzed using the methods outlined in the following references:

Test Methods for Evaluating Solid Waste, Physical/Chemical Methods, SW846, 3rd Edition

All method blanks, laboratory spikes, and/or matrix spikes met quality assurance objectives.



## ANALYTICAL REPORT

Date: 25-May-99

Client: PNM - Public Service Company of NM  
 Work Order: 9905050  
 Lab ID: 9905050-01A Matrix: SOIL  
 Project: Culpepper Martin #10

Client Sample Info: Culpepper Martin #10  
 Client Sample ID: 9905120810; Bottom @ 14ft.  
 Collection Date: 5/12/99 8:10:00 AM  
 COC Record: 7597

Parameter	Result	PQL	Qual	Units	DF	Date Analyzed
<b>DIESEL RANGE ORGANICS</b>		<b>SW8015B</b>				Analyst: DC
T/R Hydrocarbons: C10-C28	26	25		mg/Kg	1	5/20/99
<b>AROMATIC VOLATILES BY GC/PID</b>		<b>SW8021B</b>				Analyst: DM
Benzene	21	2		µg/Kg	2	5/19/99
Toluene	57	4		µg/Kg	2	5/19/99
Ethylbenzene	28	2		µg/Kg	2	5/19/99
m,p-Xylene	400	4		µg/Kg	2	5/19/99
o-Xylene	120	2		µg/Kg	2	5/19/99

626  
 626 ppm

**Qualifiers:** PQL - Practical Quantitation Limit  
 ND - Not Detected at Practical Quantitation Limit  
 J - Analyte detected below Practical Quantitation Limit  
 B - Analyte detected in the associated Method Blank

S - Spike Recovery outside accepted recovery limits  
 R - RPD outside accepted recovery limits  
 E - Value above quantitation range  
 Surr: - Surrogate

1 of 1

P.O. BOX 2606 • FARMINGTON, NM 87499

- TECHNOLOGY BLENDING INDUSTRY WITH THE ENVIRONMENT -

**ANALYTICAL REPORT**

Date: 25-May-99

**Client:** PNM - Public Service Company of NM  
**Work Order:** 9905050  
**Lab ID:** 9905050-02A     **Matrix:** SOIL  
**Project:** Culpepper Martin #10

**Client Sample Info:** Culpepper Martin #10  
**Client Sample ID:** 9905120815; Walls @ 9ft.  
**Collection Date:** 5/12/99 8:15:00 AM  
**COC Record:** 7597

Parameter	Result	PQL	Qual	Units	DF	Date Analyzed
<b>DIESEL RANGE ORGANICS</b>		<b>SW8015B</b>				Analyst: DC
T/R Hydrocarbons: C10-C28	ND	25		mg/Kg	1	5/20/99
<b>AROMATIC VOLATILES BY GC/PID</b>		<b>SW8021B</b>				Analyst: DM
Benzene	ND	1		µg/Kg	1	5/18/99
Toluene	ND	2		µg/Kg	1	5/18/99
Ethylbenzene	ND	1		µg/Kg	1	5/18/99
m,p-Xylene	ND	2		µg/Kg	1	5/18/99
o-Xylene	ND	1		µg/Kg	1	5/18/99

**Qualifiers:** PQL - Practical Quantitation Limit  
 ND - Not Detected at Practical Quantitation Limit  
 J - Analyte detected below Practical Quantitation Limit  
 B - Analyte detected in the associated Method Blank

S - Spike Recovery outside accepted recovery limits  
 R - RPD outside accepted recovery limits  
 E - Value above quantitation range  
 Surr: - Surrogate

P.O. BOX 2606 • FARMINGTON, NM 87499

- TECHNOLOGY BLENDING INDUSTRY WITH THE ENVIRONMENT -

Culpepper Martin #10  
Sec-32 T-32NR-12W UL-K  
Burlington

App 1007 cu yds

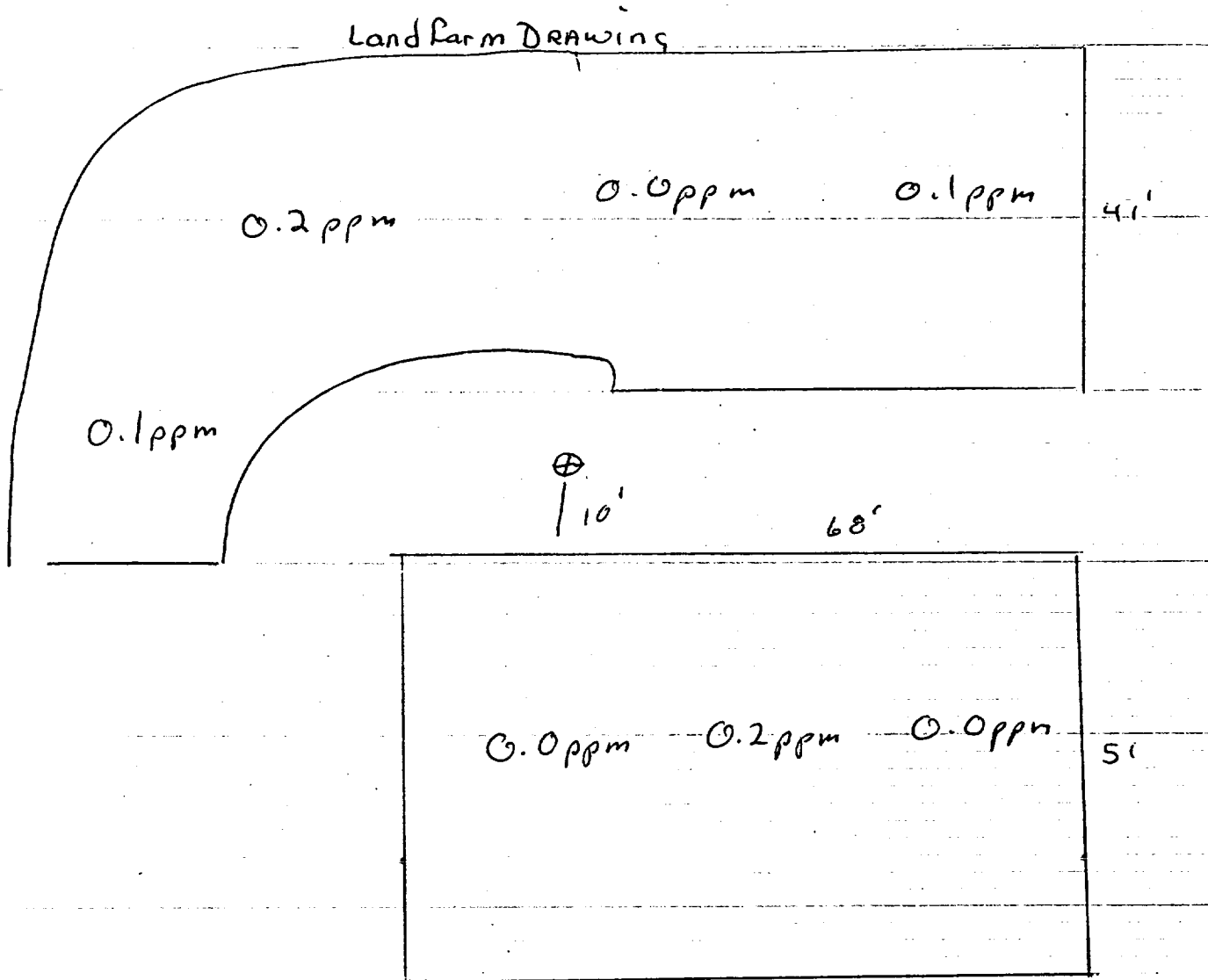

2" to 12" Depth  
Headspace 1.6 ppm  
Sample # 9907011000

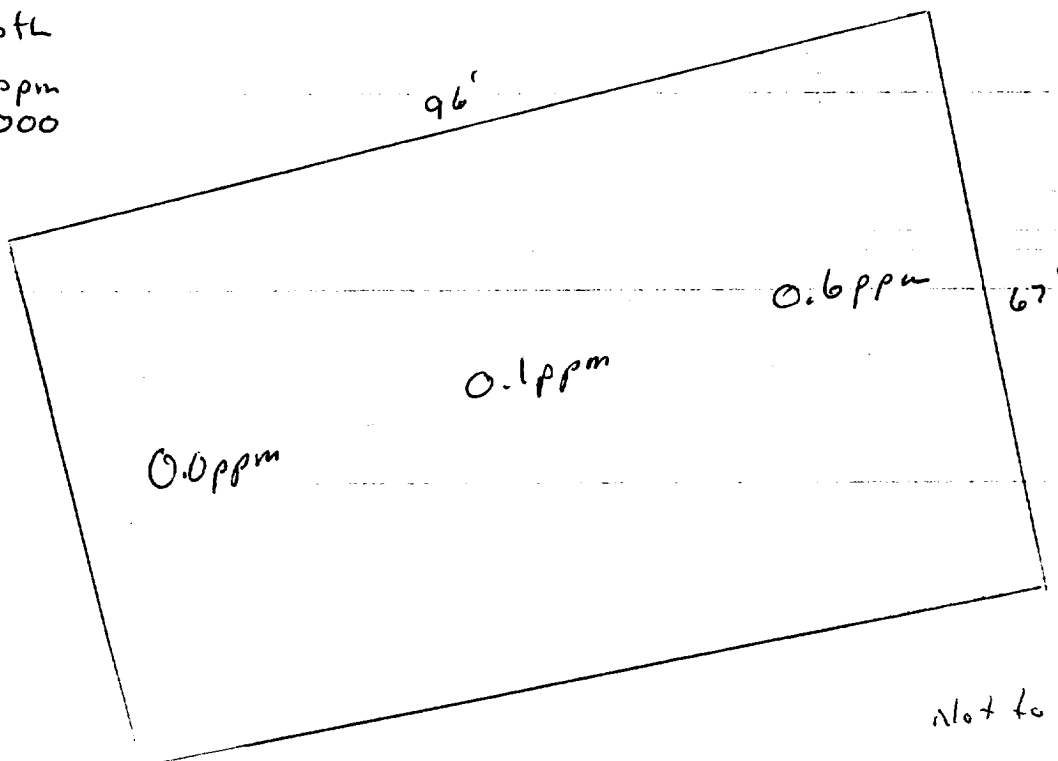

Not to Scale

OFF: (505) 325-5667



LAB: (505) 325-1556

**On Site Technologies, LTD.**

**Date:** 19-Jul-99

---

**CLIENT:** PNM - Public Service Company of NM  
**Project:** PNM Pit Remediation Landfarms  
**Lab Order:** 9907006

---

**CASE NARRATIVE**

Samples were analyzed using the methods outlined in the following references:

Test Methods for Evaluating Solid Waste, Physical/Chemical Methods, SW846, 3rd Edition

All method blanks, laboratory spikes, and/or matrix spikes met quality assurance objectives.



OFF: (505) 325-5667



LAB: (505) 325-1556

## ANALYTICAL REPORT

Date: 19-Jul-99

<b>Client:</b>	PNM - Public Service Company of NM	<b>Client Sample Info:</b>	Culpepper Martin #10 LF
<b>Work Order:</b>	9907006	<b>Client Sample ID:</b>	9907011000; 10pt. Composite
<b>Lab ID:</b>	9907006-01A	<b>Matrix:</b>	SOIL
<b>Project:</b>	PNM Pit Remediation Landfarms	<b>Collection Date:</b>	7/1/99 10:00:00 AM
		<b>COC Record:</b>	7726

Parameter	Result	PQL	Qual	Units	DF	Date Analyzed
<b>DIESEL RANGE ORGANICS</b>		<b>SW8015B</b>				Analyst: DC
T/R Hydrocarbons: C10-C28	ND	25		mg/Kg	1	7/14/99

**Qualifiers:**

- PQL - Practical Quantitation Limit
- ND - Not Detected at Practical Quantitation Limit
- J - Analyte detected below Practical Quantitation Limit
- B - Analyte detected in the associated Method Blank

- S - Spike Recovery outside accepted recovery limits
- R - RPD outside accepted recovery limits
- E - Value above quantitation range
- Surr: - Surrogate

1 of 1

P.O. BOX 2606 • FARMINGTON, NM 87499

- TECHNOLOGY BLENDING INDUSTRY WITH THE ENVIRONMENT -