

(SUBMIT IN TRIPLICATE)

Indian Agency

Navajo

UNITED STATES  
DEPARTMENT OF THE INTERIOR  
GEOLOGICAL SURVEY

Allottee

Lease No. 14-20-603-588

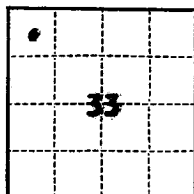

19W

## SUNDRY NOTICES AND REPORTS ON WELLS

NOTICE OF INTENTION TO DRILL	X	SUBSEQUENT REPORT OF WATER SHUT-OFF
NOTICE OF INTENTION TO CHANGE PLANS		SUBSEQUENT REPORT OF SHOOTING OR ACIDIZING
NOTICE OF INTENTION TO TEST WATER SHUT-OFF		SUBSEQUENT REPORT OF ALTERING CASING
NOTICE OF INTENTION TO REDRILL OR REPAIR WELL		SUBSEQUENT REPORT OF REDRILLING OR REPAIR
NOTICE OF INTENTION TO SHOOT OR ACIDIZE		SUBSEQUENT REPORT OF ABANDONMENT
NOTICE OF INTENTION TO PULL OR ALTER CASING		SUPPLEMENTARY WELL HISTORY
NOTICE OF INTENTION TO ABANDON WELL		

(INDICATE ABOVE BY CHECK MARK NATURE OF REPORT, NOTICE, OR OTHER DATA)

August 28, 1962

Compass Exploration, Inc.

Sun Oil Company

Well No. Indian 1-33 located 660 ft. from [N] line and 660 ft. from [W] line of sec. 33

NW NW Section 33

32 North 19 West

NMPM

(1/4 Sec. and Sec. No.)

(Twp.)

(Range)

(Meridian)

Wildcat

San Juan

New Mexico

(Field)

(County or Subdivision)

(State or Territory)

The elevation of the derrick floor above sea level is 5074' G.L.

## DETAILS OF WORK

(State names of and expected depths to objective sands; show sizes, weights, and lengths of proposed casings; indicate mudding jobs, cementing points, and all other important proposed work)

Compass Exploration, Inc., as Operator, proposes to drill a well to test the oil and/or gas producing capabilities of all formations through the first porosity in the Mississippian formation at an approximate total depth of 8200'.

Drilling procedure as follows:

1. Drill to approximately 250' and run 13-3/8" surface casing, cementing with sufficient cement to circulate.
  2. Drill a 7-7/8" hole to total depth testing and/or coring any hydrocarbon shows of apparent commercial value encountered.
  3. Log well with GRS & IES.
  4. If commercial production is encountered completion will be affected.
- All operations will be conducted in a manner acceptable by the Federal and State regulatory bodies.

I understand that this plan of work must receive approval in writing by the Geological Survey before operations may begin.

Company Compass Exploration, Inc.

Address 101 University Boulevard

Denver 6, Colorado

By

Manager, Exploration &amp; Production

Verbal approval received August 24, 1962

RECEIVED

AUG 20 1965

U.S. TECHNICAL SERVICE  
WASHINGTON, D.C. 20540

# NEW MEXICO OIL CONSERVATION COMMISSION Well Location and Acreage Dedication Plat

Date August 30, 1962

Operator Continental Exploration Company

Lease San Juan

Section 33

Township 32 North

Range 19 West

NMSPM

Feet From North

Line 640

Feet From West

Line

G. L. Elevation 5074

Dedicated Acreage 40

Acres

Producing Formation San Juan

Pool San Juan

Is the operator the only owner\* in the dedicated acreage outlined on the plat below? Yes ☒ No ☐

If the answer to question One is "No," have the interests of all the owners been consolidated by communization agreement or otherwise? Yes ☒ No ☐ If answer is "Yes," Type of Consolidation Communitization Agreement

If the answer to question Two is "No," list all the owners and their respective interests below:

OWNER

LAND DESCRIPTION

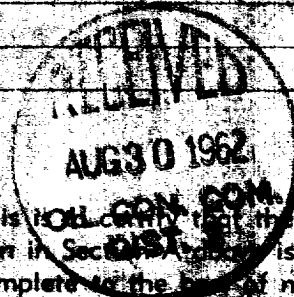
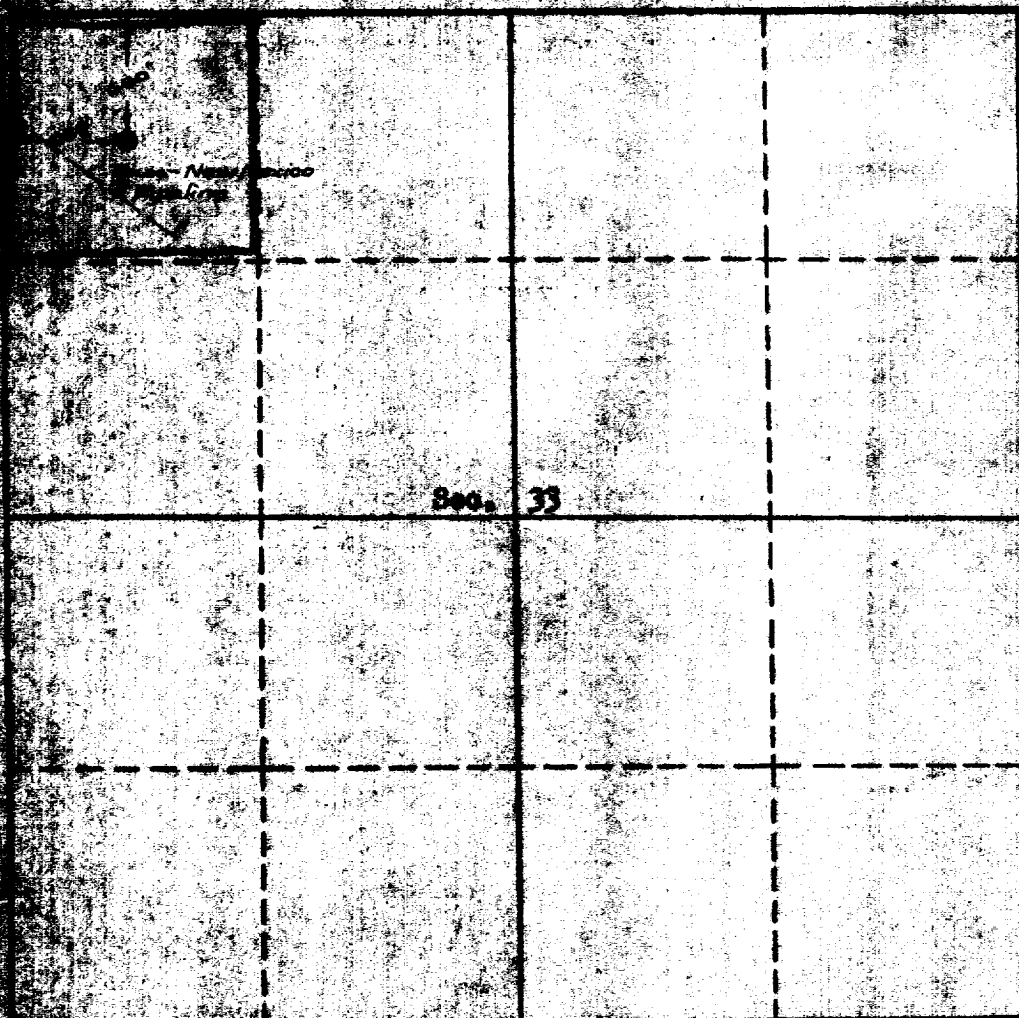

This is to certify that the information in Section 33 is true and complete to the best of my knowledge and belief.

Operator Continental Exploration Company  
101 Continental Building  
Denver 2, Colorado  
(ADDRESS)

This is to certify that the well location shown on the plat in Section 33 was plotted by the use of actual survey measurements and under my supervision and that the same is true and correct to the best of my knowledge and belief.

No. 3602

Date Surveyed Aug 30, 1962  
Continental Exploration Co.  
101 Continental Building  
Denver 2, Colorado

Continental Exploration Co.  
REGISTERED ENGINEER IN  
LAND SURVEYING

Certificate No. 3602

