

NO. OF COPIES RECEIVED	6
DISTRIBUTION	
SANTA FE	1
FILE	1
U.S.G.S.	2
LAND OFFICE	1
OPERATOR	1

# NEW MEXICO OIL CONSERVATION COMMISSION

Form C-101  
Revised 1-1-65 <sup>045</sup> 30-047 20019

5A. Indicate Type of Lease	
STATE <input checked="" type="checkbox"/>	FEE <input type="checkbox"/>
5. State Oil & Gas Lease No.	
E-3151-1	

## APPLICATION FOR PERMIT TO DRILL, DEEPEN, OR PLUG BACK

1a. Type of Work		7. Unit Agreement Name	
b. Type of Well OIL WELL <input type="checkbox"/> GAS WELL <input checked="" type="checkbox"/> OTHER <input type="checkbox"/>		--	
2. Name of Operator Pubco Petroleum Corporation		8. Farm or Lease Name State Com. AJ	
3. Address of Operator P. O. Box 869, Albuquerque, New Mexico 87103		9. Well No. 34	
4. Location of Well UNIT LETTER D LOCATED 790 FEET FROM THE north LINE AND 790 FEET FROM THE west LINE OF SEC. 36 TWP. 32N RGE. 12W NMPM		10. Field and Pool, or Wildcat Basin Dakota	
12. County San Juan			
19. Proposed Depth 7900		19A. Formation Dakota	
20. Rotary or C.T. Rotary			
21. Elevations (Show whether DF, RT, etc.) 6404 GR		21A. Kind & Status Plug. Bond Blanket	
21B. Drilling Contractor Circle "A"		22. Approx. Date Work will start 2/15/67	

23.

### PROPOSED CASING AND CEMENT PROGRAM

SIZE OF HOLE	SIZE OF CASING	WEIGHT PER FOOT	SETTING DEPTH	SACKS OF CEMENT	EST. TOP
15"	10-3/4"	32.75	300 ft.	Circ. to	Surface
9-7/8"	7-5/8"	26.4	3300 ft.	Circ. to	Surface
6-3/4"	4-1/2"	10.5	7850 ft.	Tie back to	3200 ft.

Propose to drill a development Dakota well using fresh water mud thru the Pictured Cliffs to set 7-5/8" csg. at  $\pm$  3300 ft. 10-3/4 and 7-5/8 strings will be cemented to surface. Will gas drill to 7900 ft. TD in basal Dakota sand and set 4-1/2" csg. thru Dakota. Will cement 4-1/2" csg. back into 7-5/8" csg. Will multi-stage frack the Dakota with water and sand.

APPROVAL VALID  
FOR 90 DAYS UNLESS  
DRILLING COMMENCED,  
EXPIRES May 11, 1967

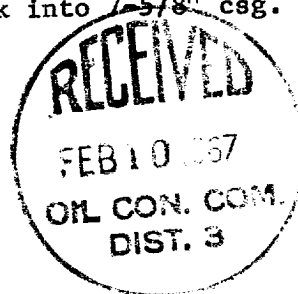

IN ABOVE SPACE DESCRIBE PROPOSED PROGRAM: IF PROPOSAL IS TO DEEPEN OR PLUG BACK, GIVE DATA ON PRESENT PRODUCTIVE ZONE AND PROPOSED NEW PRODUCTIVE ZONE. GIVE BLOWOUT PREVENTER PROGRAM, IF ANY.

I hereby certify that the information above is true and complete to the best of my knowledge and belief.

Signed Charles E. Ramsey Title Area Production Manager Date February 8, 1967

(This space for State Use)

APPROVED BY [Signature] TITLE Asst. Dir. PD DATE 2-10-67

CONDITIONS OF APPROVAL, IF ANY:

**NEW MEXICO OIL CONSERVATION COMMISSION  
WELL LOCATION AND ACERAGE DEDICATION PLAT**

All distances must be from the outer boundaries of the Section

Operator PUBCO PETROLEUM CORP. Lease State Com. AJ Well No 34  
 Unit Letter D Section 36 Township 32 N Range 12 W County SAN JUAN  
 Actual Footage Location of Well 790 feet from the north end of the 790 feet from the west end  
 Ground Level 6104 DAKOTA BASIN Dedicated Average WUST 1 1/2 320 Acres

- Outline the acreage dedicated to the subject well by colored pencil or hash/line marks on the plat below.
- If more than one lease is dedicated to the well, outline each and enter the ownership interest, both as to working interest and royalty.
- If more than one lease of different ownership is dedicated to the well, have the interests of all owners been consolidated by common carrier, unitization, force-pooling, etc?

**Communitization**

☒ Yes ☐ No If answer is yes, list type of communitization

If answer is "No," list the owners and tract descriptions which have actually communitized. (Use reverse side of this form if necessary)

No allowable will be assigned to the well until all interests have been communitized, unitized, forced-pooling, or otherwise, or until a prior standard unit, allocating such interests, has been approved by the Commission

**CERTIFICATION**

I hereby certify that the information contained herein is true and complete to the best of my knowledge and belief.

*Charles E. Ramsey, Jr.*  
**Charles E. Ramsey, Jr.**  
 Area Production Manager

Pubco Petroleum Corp.  
Box 1419 869  
Albuquerque, New Mexico

February 6, 1967

I hereby certify that the well location shown on this plat was plotted from field notes of actual surveys made by me or under my supervision, and that the same is true and correct to the best of my knowledge and belief.

February 6, 1967  
 Date Surveyed *Stephen H. Kinney*  
**Stephen H. Kinney**  
 Registered Professional Engineer  
 and/or Land Surveyor

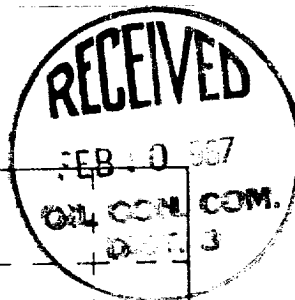
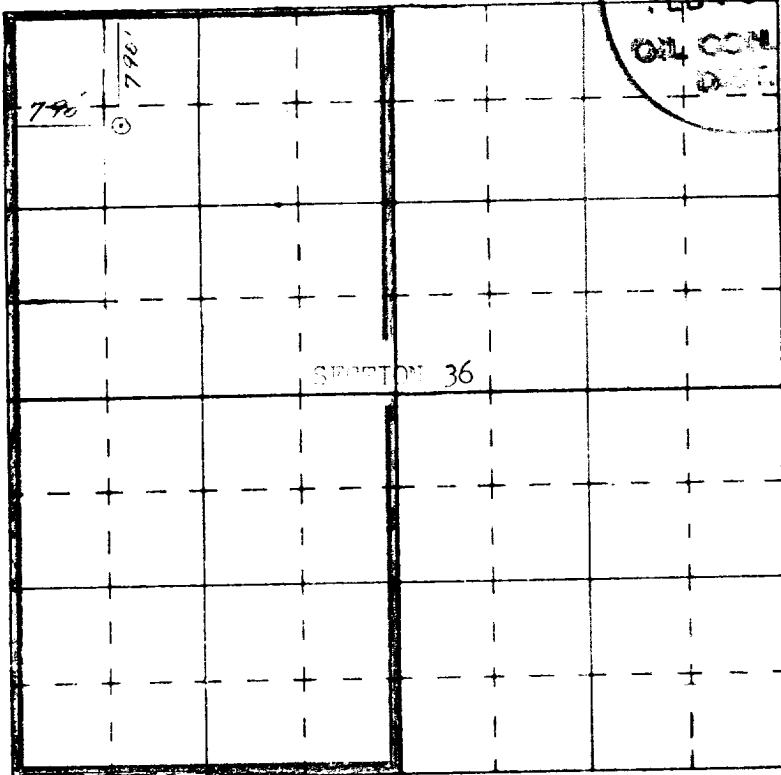

N

