

NO. OF COPIES RECEIVED	5
DISTRIBUTION	
SANTA FE	1
FILE	1
U.S.G.S.	2
LAND OFFICE	
OPERATOR	1

NEW MEXICO OIL CONSERVATION COMMISSION

30-045-22317
Form C-101
Revised 1-1-65

5A. Indicate Type of Lease STATE <input type="checkbox"/> FEE <input checked="" type="checkbox"/>
5. State Oil & Gas Lease No.
7. Unit Agreement Name
8. Farm or Lease Name Culpepper Martin
9. Well No. #1-A
10. Field and Pool, or Wildcat Blanco Mesa Verde
12. County San Juan
19. Proposed Depth 5022'
19A. Formation Mesa Verde
20. Rotary or C.T. Rotary
21. Elevations (Show whether DF, RT, etc.) 5996' GR
21A. Kind & Status Plug. Bond
21B. Drilling Contractor
22. Approx. Date Work will start

APPLICATION FOR PERMIT TO DRILL, DEEPEN, OR PLUG BACK

1a. Type of Work	DRILL <input checked="" type="checkbox"/>	DEEPEN <input type="checkbox"/>	PLUG BACK <input type="checkbox"/>
b. Type of Well	OIL WELL <input type="checkbox"/>	GAS WELL <input checked="" type="checkbox"/>	OTHER <input type="checkbox"/>
2. Name of Operator	Aztec Oil & Gas Company		
3. Address of Operator	P. O. Drawer 570, Farmington, New Mexico		
4. Location of Well	UNIT LETTER C LOCATED 990 FEET FROM THE North LINE AND 1650 FEET FROM THE West LINE OF SEC. 21 TWP. 32N RGE. 12W NMPM		
19. Proposed Depth	5022'		
19A. Formation	Mesa Verde		
20. Rotary or C.T.	Rotary		
21. Elevations (Show whether DF, RT, etc.)	5996' GR		
21A. Kind & Status Plug. Bond			
21B. Drilling Contractor			
22. Approx. Date Work will start			

PROPOSED CASING AND CEMENT PROGRAM

SIZE OF HOLE	SIZE OF CASING	WEIGHT PER FOOT	SETTING DEPTH	SACKS OF CEMENT	EST. TOP
13-3/4"	9-5/8"	36#	200'	190 sxs	Surface
8-3/4"	7"	23#	2685'	165 sxs	Cover Ojo Alamo
6-1/4"	4-1/2"	10.50#	2535'-5022'	240 sxs	To liner top
	2-3/8"	4.7#	5000'		

Surface formation is Nacimiento.

Top of Ojo Alamo sand is at 1267'.

Top of Pictured Cliffs sand is at 2385'.

A fresh water mud system will be used for drilling to intermediate casing point.

An air system will be used for drilling to total depth.

It is anticipated that IES and Density logs will be run at total depth.

No abnormal pressures or poisonous gases are anticipated in this well.

It is expected that this well will be drilled before June, 1977. This depends on time required for approvals, rig availability and the weather.

GAS IS DEDICATED

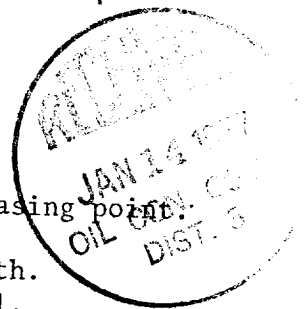

APPROVAL VALID
FOR 90 DAYS UNLESS
DRILLING COMMENCED,

4-14-77

IN ABOVE SPACE DESCRIBE PROPOSED PROGRAM: IF PROPOSAL IS TO DEEPEN OR PLUG BACK, GIVE DATA ON PRESENT PRODUCTION ZONE AND PROPOSED NEW PRODUCTION ZONE. GIVE BLOWOUT PREVENTER PROGRAM, IF ANY.

I hereby certify that the information above is true and complete to the best of my knowledge and belief.

Signed [Signature] Title District Production Manager Date January 11, 1977

(This space for State Use)

PETROLEUM ENGINEER DIST. NO. 3

APPROVED BY [Signature] TITLE DATE

CONDITIONS OF APPROVAL, IF ANY:

**NEW MEXICO OIL CONSERVATION COMMISSION
WELL LOCATION AND ACREAGE DEDICATION PLAT**

Form C-102
Supersedes C-128
Effective 1-1-65

All distances must be from the outer boundaries of the Section.

Operator Aztec Oil & Gas Company			Lease Culpepper-Martin		Well No. 1A
Unit Letter C	Section 21	Township 32N	Range 12W	County San Juan	
Actual Footage Location of Well: 990 feet from the North line and 1650 feet from the West line					
Ground Level Elev. 5996	Producing Formation Mesa Verde		Pool Blanco		Dedicated Acreage: W/ 320 Acres

1. Outline the acreage dedicated to the subject well by colored pencil or hachure marks on the plat below.
2. If more than one lease is dedicated to the well, outline each and identify the ownership thereof (both as to working interest and royalty).
3. If more than one lease of different ownership is dedicated to the well, have the interests of all owners been consolidated by communitization, unitization, force-pooling, etc?

☐ Yes ☐ No If answer is "yes," type of consolidation _____

If answer is "no," list the owners and tract descriptions which have actually been consolidated. (Use reverse side of this form if necessary.) _____

No allowable will be assigned to the well until all interests have been consolidated (by communitization, unitization, forced-pooling, or otherwise) or until a non-standard unit, eliminating such interests, has been approved by the Commission.

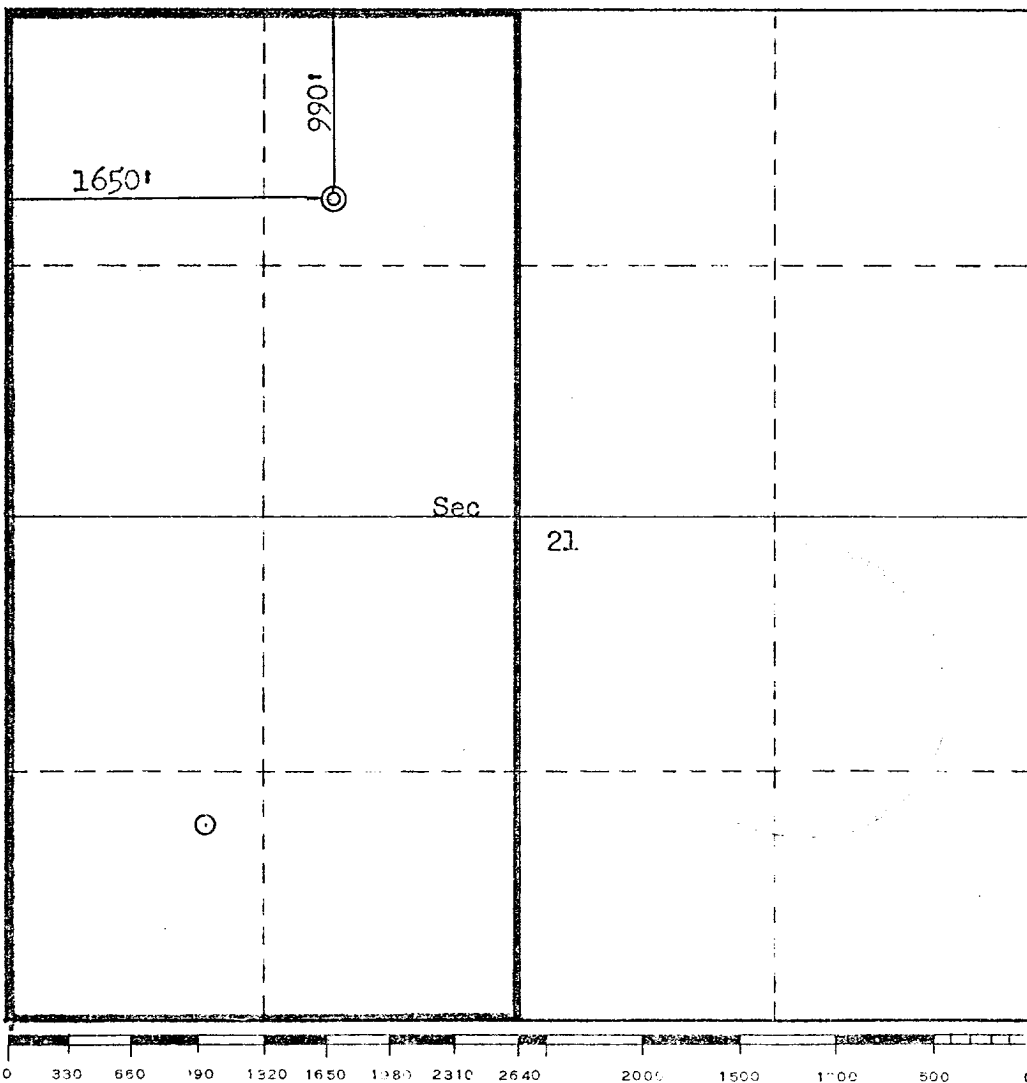

CERTIFICATION

I hereby certify that the information contained herein is true and complete to the best of my knowledge and belief.

Name _____

Position _____

District Production Manager

Company _____

Aztec Oil & Gas Company

Date _____

January 11, 1977

I hereby certify that the well location shown on this plat was plotted from field notes of actual surveys made by me or under my supervision, and that the same is true and correct to the best of my knowledge and belief.

Date Surveyed _____

December 18, 1976

Registered Professional Engineer
and/or Land Survey

Fred B. Kerr Jr.

Certificate No. _____

3950