

UNITED STATES
DEPARTMENT OF THE INTERIOR
GEOLOGICAL SURVEY

APPLICATION FOR PERMIT TO DRILL, DEEPEN, OR PLUG BACK

1a. TYPE OF WORK

DRILL ☐DEEPEN ☐PLUG BACK ☐

b. TYPE OF WELL

OIL
WELL ☒GAS
WELL ☐

OTHER

SINGLE
ZONE ☐MULTIPLE
ZONE ☐

2. NAME OF OPERATOR

JAMES P. WOOSLEY

3. ADDRESS OF OPERATOR

P. O. Box 1227, Cortez, Colorado 81321

4. LOCATION OF WELL (Report location clearly and in accordance with any State requirements.)

At surface

178' from South Line and

2040' from West line of Section 17

At proposed prod. zone

Same

14. DISTANCE IN MILES AND DIRECTION FROM NEAREST TOWN OR POST OFFICE*

20 miles

15. DISTANCE FROM PROPOSED*

LOCATION TO NEAREST

PROPERTY OR LEASE LINE, FT.

(Also to nearest drlg. unit line, if any)

200 feet

18. DISTANCE FROM PROPOSED LOCATION*
TO NEAREST WELL, DRILLING, COMPLETED,
OR APPLIED FOR, ON THIS LEASE, FT.

600 feet

16. NO. OF ACRES IN LEASE

19. PROPOSED DEPTH

1710 feet

17. NO. OF ACRES ASSIGNED
TO THIS WELL

10 40 joint

20. ROTARY OR CABLE TOOLS

Rotary

21. ELEVATIONS (Show whether DF, RT, GR, etc.)

5,788.6 GL

22. APPROX. DATE WORK WILL START*

As soon as approved

23.

PROPOSED CASING AND CEMENTING PROGRAM

SIZE OF HOLE	SIZE OF CASING	WEIGHT PER FOOT	SETTING DEPTH	QUANTITY OF CEMENT
9"	7"	22#	30'	Cement to surface
6 1/4"	4 1/2"	11.60#	1485'	30 sks.

Plan to drill 9" hole and set 30' of 7" surface casing and cement to surface. Drill a 6 1/4" hole through the Lower Gallup SS with air. Run 4 1/2" casing; cement with sufficient amount of cement to cover 250' above producing zone' log, perforate and s.o.f. if necessary. Estimated top of Lower Gallup SS 1661 feet.

See Administrative Order NSL-853 hereto attached granting authorization for non-standard location.

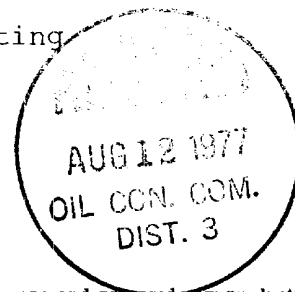

IN ABOVE SPACE DESCRIBE PROPOSED PROGRAM: If proposal is to deepen or plug back, give data on present productive zone and proposed new productive zone. If proposal is to drill or deepen directionally, give pertinent data on subsurface locations and measured and true vertical depths. Give blowout preventer program, if any.

24.

SIGNED

William G. Waldeck
WILLIAM G. WALDECK

TITLE Co-Owner of Lease

DATE August 9, 1977

(This space for Federal or State office use)

PERMIT NO.

APPROVAL DATE

APPROVED BY

TITLE

DATE

CONDITIONS OF APPROVAL, IF ANY:

Chap

*See Instructions On Reverse Side

RECEIVED

AUG 11 1977

U. S. GEOLOGICAL SURVEY
FAD

WELL LOCATION AND ACREAGE DEDICATION PLAT

All distances must be from the outer boundaries of the Section.

Operator James P. Woosley		Lease Navajo "AA"		Well No. 27	
Unit Letter	Section 17	Township 32 N	Range 17 W	County San Juan	
Actual Footage Location of Well: 2040 feet from the West line and 178 feet from the South line.					
Ground Level Elev. 5788.6	Producing Formation Gallup	Pool North Many Rocks, Lower Gallup	Dedicated Acreage: 40 Acres		

1. Outline the acreage dedicated to the subject well by colored pencil or hachure marks on the plat below.
2. If more than one lease is dedicated to the well, outline each and identify the ownership thereof (both as to working interest and royalty),
3. If more than one lease of different ownership is dedicated to the well, have the interests of all owners been consolidated by communitization, unitization, force-pooling, etc.?

() Yes () No If answer is "yes", type of consolidation

If answer is "no," list the owners and tract descriptions which have actually consolidated. (Use reverse side of this form is necessary.)

No allowable will be assigned to the well until all interests have been consolidated (by communitization, unitization, forced-pooling, or otherwise) or until a non standard unit, eliminating such interests, has been approved by the Commission.

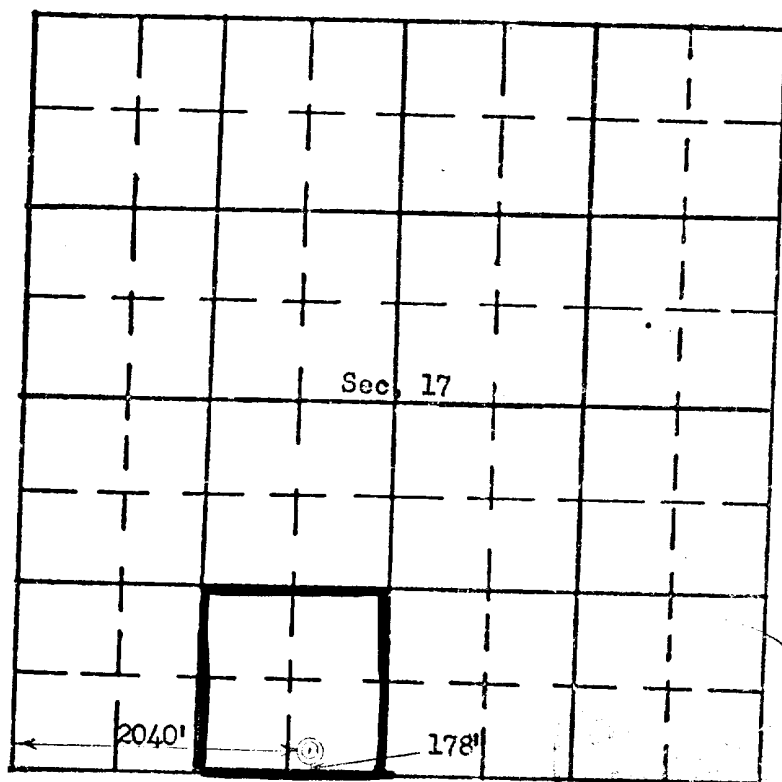

CERTIFICATION

I hereby certify that the information contained herein is true and complete to the best of my knowledge and belief.

William B. Walden
Name

Co-owner of Lease
Position

Company
8/9/77
Date

I hereby certify that the well location shown on this plat was platted from field notes of actual surveys made by me or under my supervision, and that the same is true and correct to the best of my knowledge and belief.

8-Sept 4, 1974
Date Surveyed
Richard G. Clark
Richard G. Clark, Reg. L.S.
New Mexico # 4452

OIL CONSERVATION COMMISSION

STATE OF NEW MEXICO
P. O. BOX 2088 - SANTA FE
87501



STATE GEOLOGIST
EMERY C. ARNOLD

DIRECTOR
JOE D. RAMEY

LAND COMMISSIONER
PHIL R. LUCERO

May 23, 1977

Mr. William G. Waldeck
Attorney at Law
P. O. Box 2188
Grand Junction, Colorado 81501

Administrative Order NSL-853

Dear Mr. Waldeck:

Reference is made to your application on behalf of James P. Woosley for approval of a non-standard location for his Navajo "AA" Well No. 27 to be located 178 feet from the South line and 2040 feet from the West line of Section 17, Township 32 North, Range 17 West, NMPM, North Many Rocks-Lower Gallup Pool, San Juan County, New Mexico.

Since there are no offsetting operators, the waiting period prescribed by Rule 104 F may be dispensed with in this instance.

By authority granted me under the provisions of Rule 104 F of the Commission Rules and Regulations, the above-described unorthodox location is hereby approved.

Very truly yours,

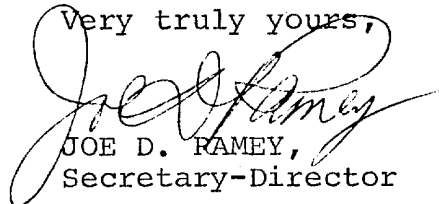

JOE D. RAMEY,
Secretary-Director

JDR/JEK/dr

cc: Oil Conservation Commission - Aztec
Oil & Gas Engineering Committee - Hobbs
U. S. Geological Survey - Farmington

SURFACE USE AND OPERATIONS PLAN

1. Attached to this Surface Use and Operations Plan is a map ("Map 1") locating the proposed well site with reference other locatable reference points. Map 1 indicates the proposed route from U. S. Highway 666 to the location. No other access roads than those presently in existence as shown on the attached map will be required. All additional existing roads within a radius of three miles are shown on the attached map. The roads consist of dirt roads along dry washes.

2. There will be no need for constructing access roads. The proposed location will be served by the roads presently existing as shown on the attached map.

3. The location of existing wells are portrayed on Map 1.

4. The existing tank batteries, production facilities and production, gathering, or service lines within a one-mile radius of the proposed location which are owned or controlled by the lessee are shown on "Map 2" attached hereto. These existing tank batteries and flow lines as portrayed on the map will be utilized if the well is successful. Also if other wells are drilled which prove productive, the same battery and flow lines as portrayed on Map 2 will be utilized.

5. The proposed well will not be drilled with mud and therefore a very small amount of water will be used. The only need for such water will be in connection with the cement required for surface and, if productive, a production casing string of pipe. The water needed for such purposes will be hauled in trucks from Cortez, Colorado. No water lines will be needed.

6. No construction materials will be needed for the proposed well.

7. Waste, cuttings, garbage, trash, etc. will be disposed of as in a pit as shown on the drawing attached to this plan identified as "Map 3." The pit will be located at the end of the Blewey Line to catch the drillings and when the drilling is completed the pit will be leveled and covered with the same top soil which was removed for such pit.

8. No ancillary facilities such as camps and air strips will be required in connection with the drilling of the well.

9. A plat of the well site layout appears on Map 2 attached to this plan. The well location will not be compacted except for the compaction which accrues from normal traffic and use.

10. The plans for restoring the drill site location are as shown on the attached maps. The entire location will be leveled and reseeded if the well is non-productive. The area needed for the location is shown on the maps attached to this plan. The top soil will be left at the end of the cuttings and waste pit to be used again in covering the waste and for reseeding. The seed required for this particular area and the mixture thereof which is needed will be utilized for reseeding.

11. The area surrounding the location consists of mesas formed from the Mesa Verde Formation with valleys and washes eroded into the underlying Mancos shale. The washes or valleys represent a terrain relief of some 200 to 300 feet with steep and rocky cliffs leading to the mesa tops. No cuts and fills will be required because the location selected is essentially level.

12. The name, address and telephone number of the operator who is responsible for assuring compliance with this surface use and operations plan is James P. Woosley, P. O. Box 1227, Cortez, Colorado 81321 and his telephone number is (303) 565-8245.

13. I hereby certify that I, or persons under my direct supervision, have inspected the proposed drill site and access route; that I am familiar with the conditions that presently exist; that the statements made in this Plan are to the best of my knowledge true and correct; and that the operations associated with the operations proposed herein will be performed by James P. Woosley, dba Woosley Oil Company and his contractors and subcontractors in conformity with this plan and the terms and conditions under which it is approved.

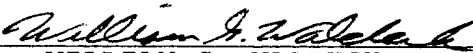
WILLIAM G. WALDECK
Co-Owner

Dated: August 9, 1977

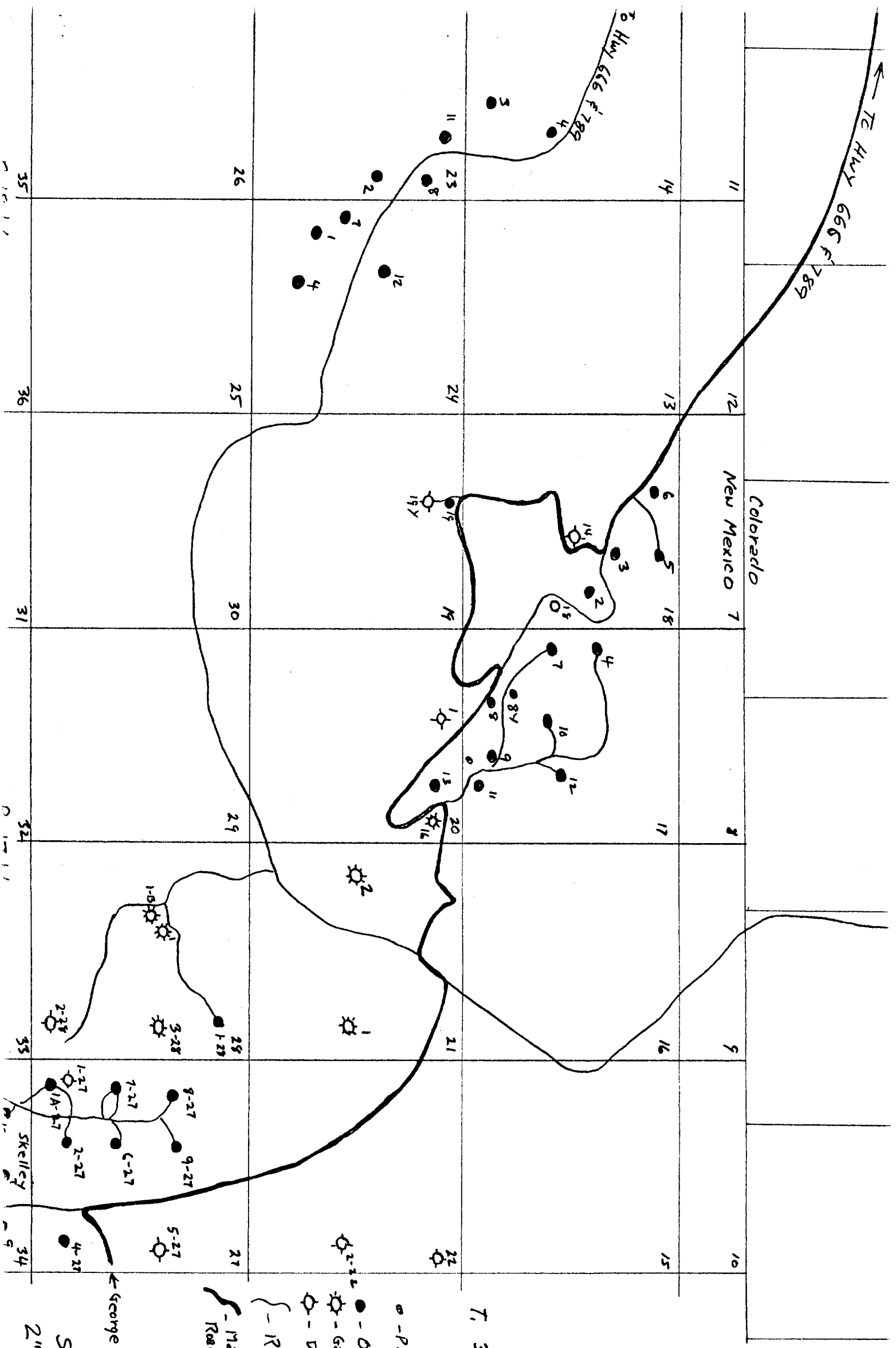

T. 32 N.

● - Proposed Location

● - Oil well

☼ - Gas well

☼ - Dry Hole

{ - Roads

~ Main Access Road in Vicinity

← George's Pass Road

Scale

2" = 1 mile

COLORADO
New Mexico

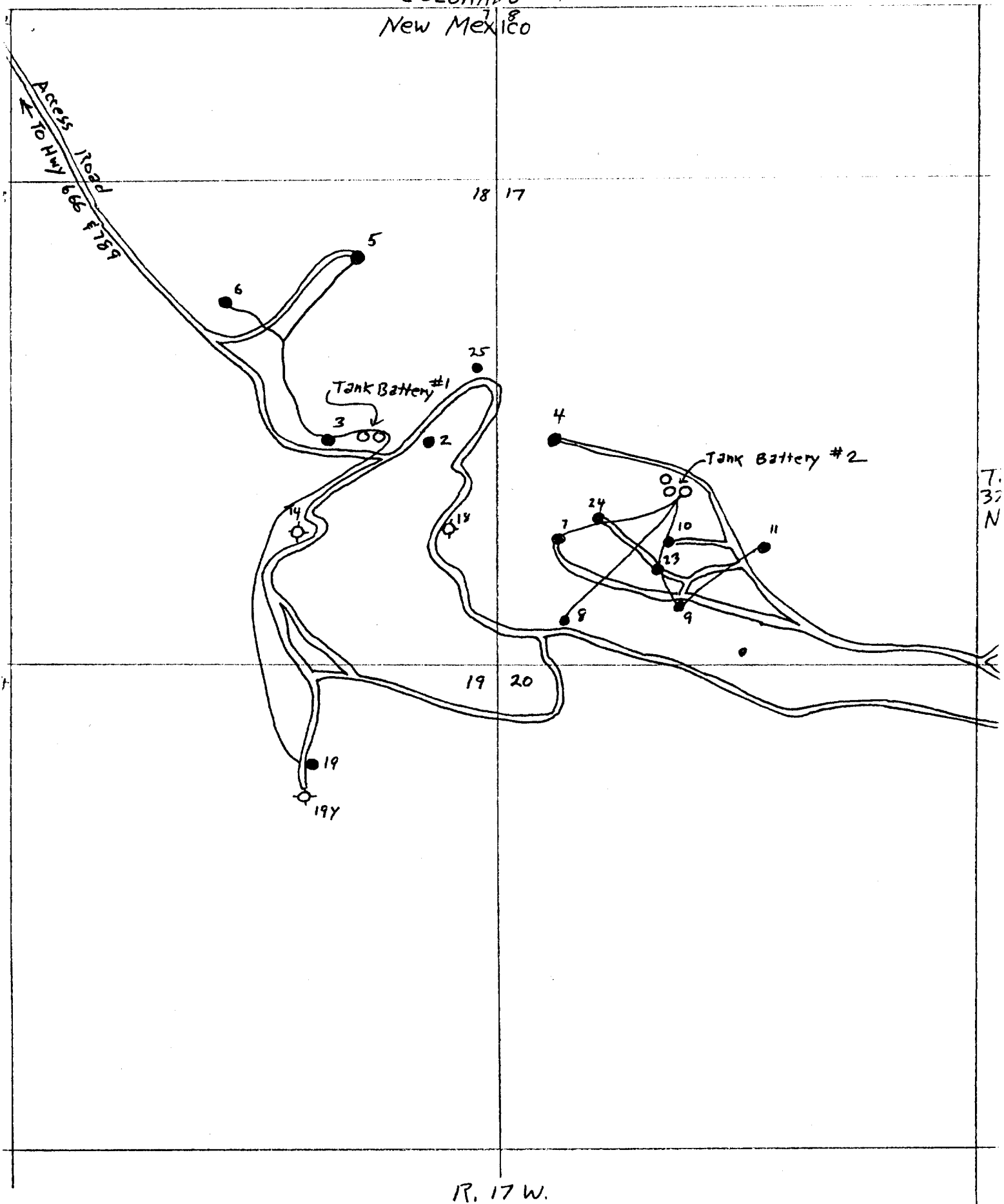

• - Proposed Location
- Flow lines

Scale
4" = 1 mile

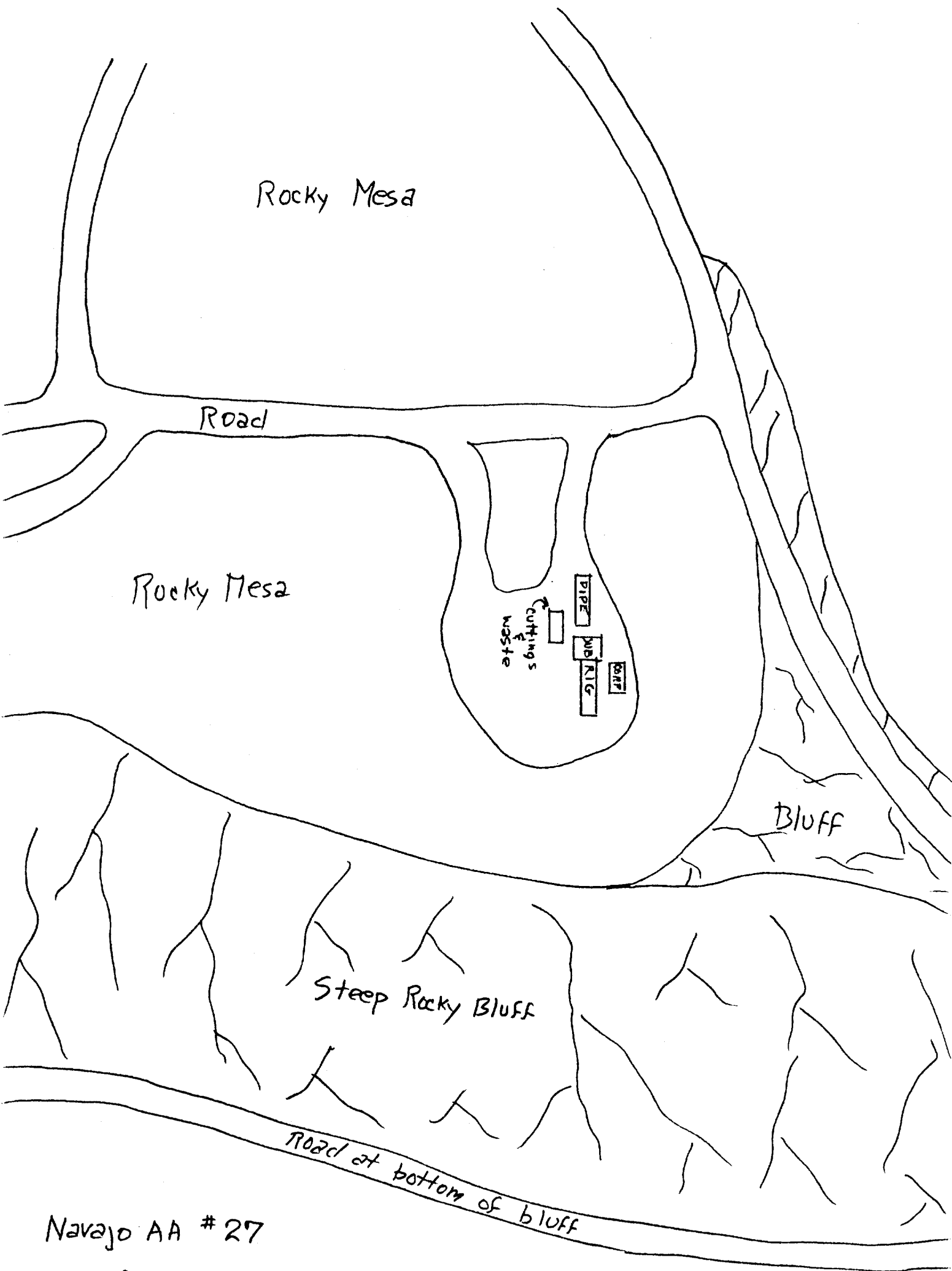

Navajo AA #27

Scale

1" = 50'

R. 17 W.

Tp. 32 N.

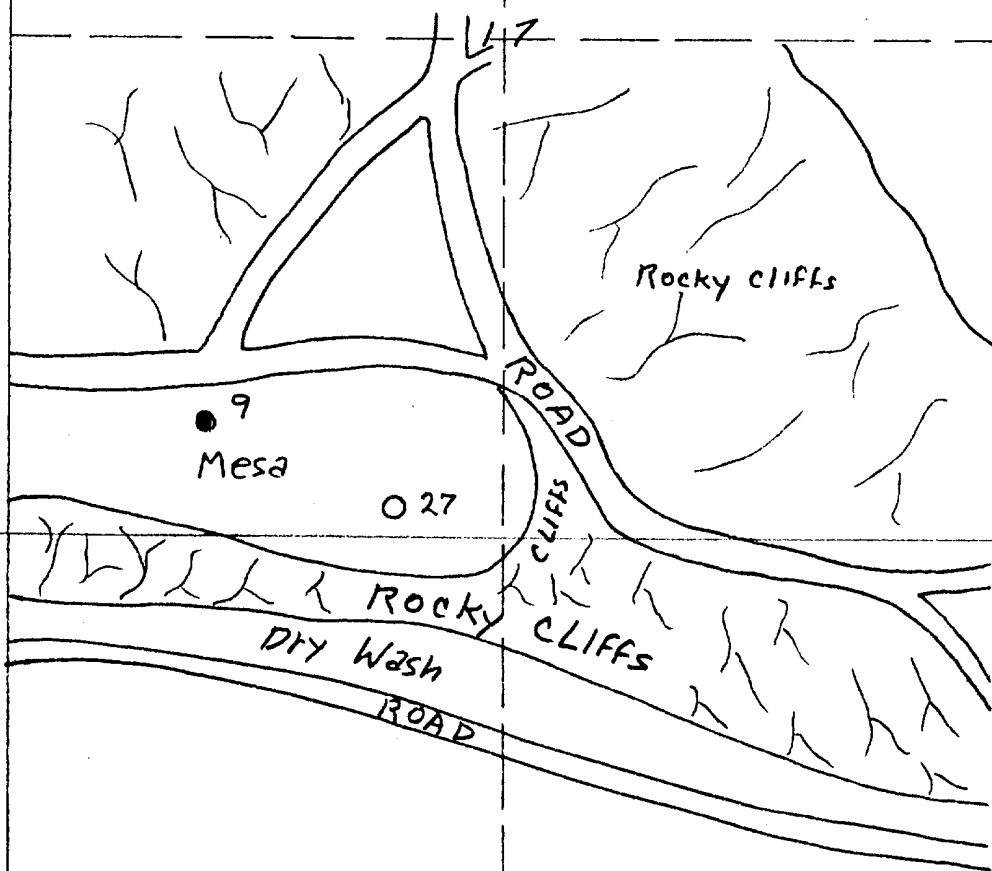

Terrain surrounding Proposed Navajo AA #27

Scale: 1" = 1060'