

UNITED STATES  
DEPARTMENT OF THE INTERIOR  
GEOLOGICAL SURVEY

30-045-22852

5. LEASE DESIGNATION AND SERIAL NO.  
SF-078147

6. IF INDIAN, ALLOTTEE OR TRIBE NAME

7. UNIT AGREEMENT NAME

8. FARM OR LEASE NAME  
Decker

9. WELL NO.  
#2A

10. FIELD AND POOL, OR WHELCAT  
Blanco Mesa Verde

11. SEC., T., R., M., OR BLK. AND SURVEY OR AREA  
Section 26, T32N, R12W

12. COUNTY OR PARISH  
San Juan

13. STATE  
New Mexico

APPLICATION FOR PERMIT TO DRILL, DEEPEN, OR PLUG BACK

1a. TYPE OF WORK  
DRILL  DEEPEN  PLUG BACK

b. TYPE OF WELL  
OIL WELL  GAS WELL  OTHER   
SINGLE ZONE  MULTIPLE ZONE

2. NAME OF OPERATOR  
Aztec Oil & Gas Company

3. ADDRESS OF OPERATOR  
P. O. Drawer 570, Farmington, New Mexico 87401

4. LOCATION OF WELL (Report location clearly and in accordance with any State requirements.)\*  
At surface 1700' FSL & 1075' FEL  
At proposed prod. zone

14. DISTANCE IN MILES AND DIRECTION FROM NEAREST TOWN OR POST OFFICE\*

15. DISTANCE FROM PROPOSED\* LOCATION TO NEAREST PROPERTY OR LEASE LINE, FT. (Also to nearest drlg. unit line, if any)

16. NO. OF ACRES IN LEASE

17. NO. OF ACRES ASSIGNED TO THIS WELL  
320

18. DISTANCE FROM PROPOSED LOCATION\* TO NEAREST WELL, DRILLING, COMPLETED, OR APPLIED FOR, ON THIS LEASE, FT.

19. PROPOSED DEPTH  
5650'

20. ROTARY OR CABLE TOOLS  
Rotary

21. ELEVATIONS (Show whether DF, RT, GR, etc.)  
6489' GR

22. APPROX. DATE WORK WILL START\*  
January 15, 1978

23. PROPOSED CASING AND CEMENTING PROGRAM

SIZE OF HOLE	SIZE OF CASING	WEIGHT PER FOOT	SETTING DEPTH	QUANTITY OF CEMENT
12-1/4"	9-5/8"	36#	200'	130 cu. ft.
8-3/4"	7"	20#	3328'	344 cu. ft.
6-1/4"	4-1/2"	10.50#	3178'-5650'	4 cu. ft.
	2-3/8"	4.7#	5600'	

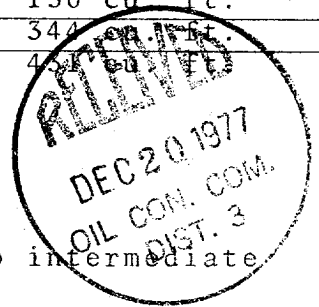

Surface formation is San Jose.  
Top of Ojo Alamo is at 1802'.  
Top of Pictured Cliffs is at 3028'.  
Fresh water mud will be used to drill from surface to intermediate casing point.  
An air system will be used to drill from intermediate casing point to TD. It is anticipated that a IES and a Gamma Ray Density be run at intermediate depth.  
It is anticipated that a Gamma Ray Density and a Gamma Ray Induction log be run at total depth.  
No abnormal pressures or poisonous gases are anticipated in this well. It is expected this well be drilled before 6-1-78. This depends on time required for approvals, rig availability and the weather.  
Gas is dedicated.

IN ABOVE SPACE DESCRIBE PROPOSED PROGRAM: If proposal is to deepen or plug back, give data on present productive zone and proposed new productive zone. If proposal is to drill or deepen directionally, give pertinent data on subsurface locations and measured and true vertical depths. Give blowout preventer program, if any.

24. SIGNED [Signature] TITLE District Production Mgr. DATE Dec. 14, 1977

(This space for Federal or State office use)

PERMIT NO. \_\_\_\_\_ APPROVAL DATE \_\_\_\_\_

APPROVED BY \_\_\_\_\_ TITLE \_\_\_\_\_ DATE \_\_\_\_\_

CONDITIONS OF APPROVAL, IF ANY:

[Signature]

NEW MEXICO OIL CONSERVATION COMMISSION  
WELL LOCATION AND ACREAGE DEDICATION PLAT

Form C-102  
Supersedes C-128  
Effective 1-1-65

All distances must be from the outer boundaries of the Section.

Operator <b>Aztec Oil &amp; Gas Company</b>		Lease <b>Decker</b>			Well No. <b>2A</b>
Unit Letter <b>I</b>	Section <b>26</b>	Township <b>32N</b>	Range <b>12W</b>	County <b>San Juan</b>	
Actual Footage Location of Well:					
<b>1700</b>	feet from the <b>South</b>	line and	<b>1075</b>	feet from the <b>East</b>	line
Ground Level Elev. <b>6489</b>	Producing Formation <b>Mesa Verde</b>	Pool <b>Blanco</b>	Dedicated Acreage: <b>320</b> Acres		

1. Outline the acreage dedicated to the subject well by colored pencil or hachure marks on the plat below.
2. If more than one lease is dedicated to the well, outline each and identify the ownership thereof (both as to working interest and royalty).
3. If more than one lease of different ownership is dedicated to the well, have the interests of all owners been consolidated by communitization, unitization, force-pooling, etc?

Yes  No If answer is "yes," type of consolidation \_\_\_\_\_

If answer is "no," list the owners and tract descriptions which have actually been consolidated. (Use reverse side of this form if necessary.) \_\_\_\_\_

No allowable will be assigned to the well until all interests have been consolidated (by communitization, unitization, forced-pooling, or otherwise) or until a non-standard unit, eliminating such interests, has been approved by the Commission.

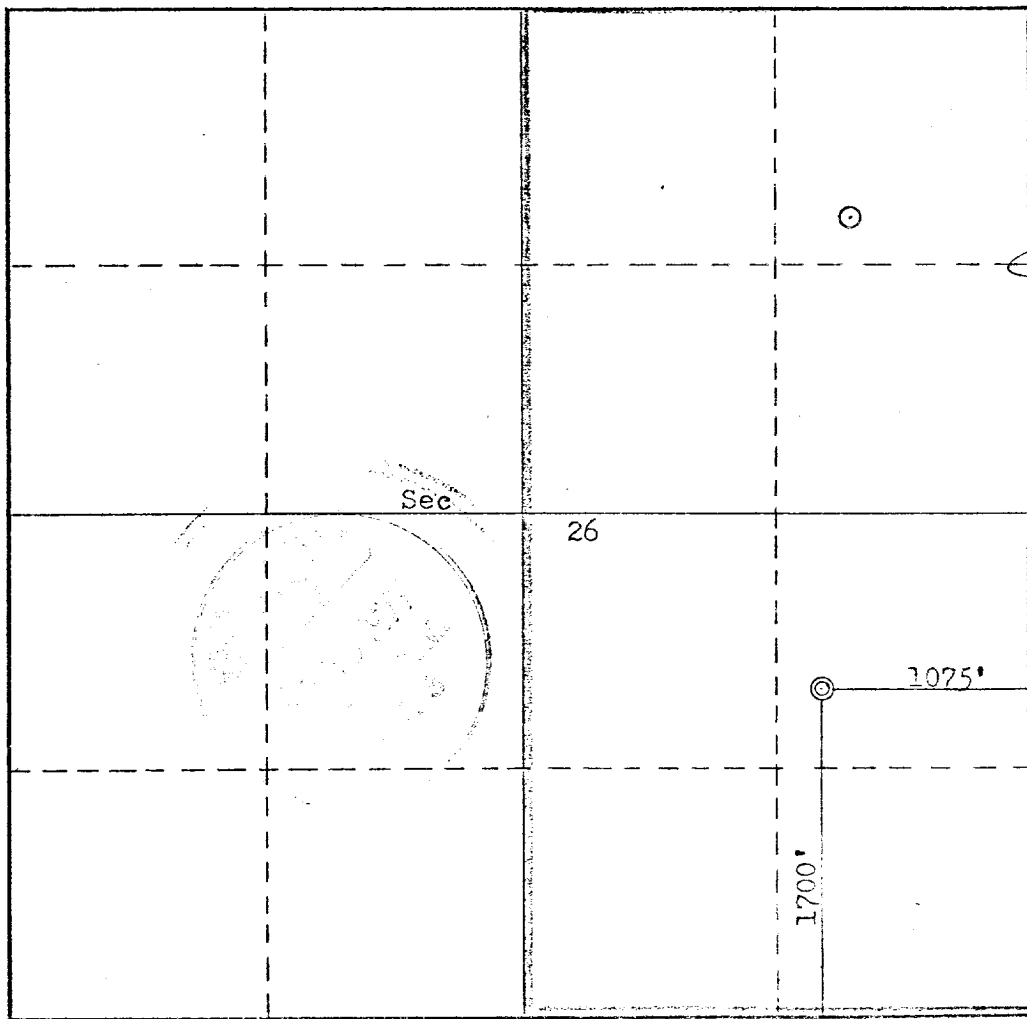

CERTIFICATION

I hereby certify that the information contained herein is true and complete to the best of my knowledge and belief.

Name: *San Ryan*  
 Position: District Production Mgr.  
 Company: Aztec Oil & Gas Company  
 Date: December 14, 1977

I hereby certify that the well location shown on this plat was plotted from field notes of actual surveys made by me or under my supervision, and that the same is true and correct to the best of my knowledge and belief.

Date Surveyed: October 29, 1977  
 Registered Professional Engineer and/or Land Surveyor: *Fred B. Kerr Jr.*  
 Certificate No.: 3950

