

NO. OF COPIES RECEIVED	6
DISTRIBUTION	
SANTA FE	1
FILE	1
U.S.G.S.	2
LAND OFFICE	1
OPERATOR	1

NEW MEXICO OIL CONSERVATION COMMISSION

30-045-23009
Form C-101
Revised 1-4-65

5A. Indicate Type of Lease	
STATE <input checked="" type="checkbox"/>	FEE <input type="checkbox"/>
5. State Oil & Gas Lease No.	
NM-E-8445	

APPLICATION FOR PERMIT TO DRILL, DEEPEN, OR PLUG BACK.

1a. Type of Work		7. Unit Agreement Name	
b. Type of Well OIL WELL <input type="checkbox"/> GAS WELL <input checked="" type="checkbox"/> OTHER <input type="checkbox"/>		8. Farm or Lease Name	
DRILL <input checked="" type="checkbox"/> DEEPEN <input type="checkbox"/> PLUG BACK <input type="checkbox"/>		Pan Am State Com	
2. Name of Operator		9. Well No.	
Consolidated Oil & Gas, Inc.		1-A	
3. Address of Operator		10. Field Pool or Wildcat	
1860 Lincoln Street, Lincoln Tower Building, Denver, Colorado 80295		Mesaverde	
4. Location of Well		12. County	
UNIT LETTER <u>14</u> LOCATED <u>1450</u> FEET FROM THE <u>North</u> LINE		San Juan	
AND <u>790</u> FEET FROM THE <u>West</u> LINE OF SEC. <u>36</u> TWP. <u>32 North</u> RGE. <u>13 West</u> NMPM			
19. Proposed Depth		19A. Formation	20. Rotary or C.T.
4800'		Mesaverde	Rotary
21. Elevations (Show whether DF, RT, etc.)	21A. Kind & Status Plug. Bond	21B. Drilling Contractor	22. Approx. Date Work will start
5806'	Blanket bond in	NA	June 15, 1978

PROPOSED CASING AND CEMENT PROGRAM

SIZE OF HOLE	SIZE OF CASING	WEIGHT PER FOOT	SETTING DEPTH	SACKS OF CEMENT	EST. TOP
12-1/4"	8-5/8"	24	250'	200	Circ.
7-7/8"	4-1/2"	10.5	4800'	300	2000'

1. Drill 12-1/4" hole to \pm 250'. Set 8-5/8" casing. Circulate cement to surface.
2. WOC 12 hours.
3. Install blowout preventers. Pressure test surface casing and blowout preventers to 1000#.
4. Drill 7-7/8" hole to \pm 4800' with fresh water gel mud. Log.
5. Run 4-1/2" casing and cement same with approximately 300 sx.
6. Selectively perforate and stimulate the Mesaverde and complete as required by rules and regulations.

IN ABOVE SPACE DESCRIBE PROPOSED PROGRAM: IF PROPOSAL IS TO DEEPEN OR PLUG BACK, GIVE DATA ON PRESENT PRODUCTIVE ZONE AND PROPOSED NEW PRODUCTIVE ZONE. GIVE BLOWOUT PREVENTER PROGRAM, IF ANY.

I hereby certify that the information above is true and complete to the best of my knowledge and belief.

Signed Charles M. Parham Title Senior Production Engineer Date April 19, 1978

(This space for State Use)

APPROVED BY Frank S. Dargatzis TITLE DEPUTY COMMISSIONER DATE April 19, 1978

CONDITIONS OF APPROVAL, IF ANY:

NEW MEXICO OIL CONSERVATION COMMISSION

WELL LOCATION AND ACERAGE DEDICATION PLAT

All distances must be from the outer boundaries of the Section

Operator CONSOLIDATED OIL AND GAS, INC.		Lease PAN AM STATE Com		Well No. 1-A
Unit Letter H E	Section 36	Township 32 NORTH	Range 13 WEST	County SAN JUAN
Actual Footage Location of Well: <div style="display: flex; justify-content: space-between;"> 1450 feet from the NORTH line and 790 feet from the WEST line </div>				
Ground Level Elev. 5806	Producing Formation Mesaverde	Pool Blanco Mesaverde ✓	Dedicated Acreage: 320 ✓ Acres	

1. Outline the acreage dedicated to the subject well by colored pencil or hatchure marks on the plat below.
2. If more than one lease is dedicated to the well, outline each and identify the ownership thereof (both as to working interest and royalty),
3. If more than one lease of different ownership is dedicated to the well, have the interests of all owners been consolidated by communitization, unitization, force-pooling, etc?

Yes ☐ No ☐ If answer is "yes," type of consolidation

If answer is "no" list the owners and tract descriptions which have actually consolidated. (Use reverse side of this form if necessary)

No allowable will be assigned to the well until all interests have been consolidated (by communitization, unitization, forced-pooling, or otherwise) or until a non standard unit, eliminating such interests, has been approved by the Commission.

CERTIFICATION

I hereby certify that the information contained herein is true and complete to the best of my knowledge and belief.

Charles M. Parham
Name

Charles M. Parham

Position

Sr. Production Engineer

Company

Consolidated Oil & Gas, Inc.

Date

April 19, 1978

I hereby certify that the well location shown on this plat was plotted from field notes of actual surveys made by me or under my supervision, and that the same is true and correct to the best of my knowledge and belief.

30 March, 1978

Date Surveyed

James B. Lease
Registered Professional Engineer
and/or Land Surveyor

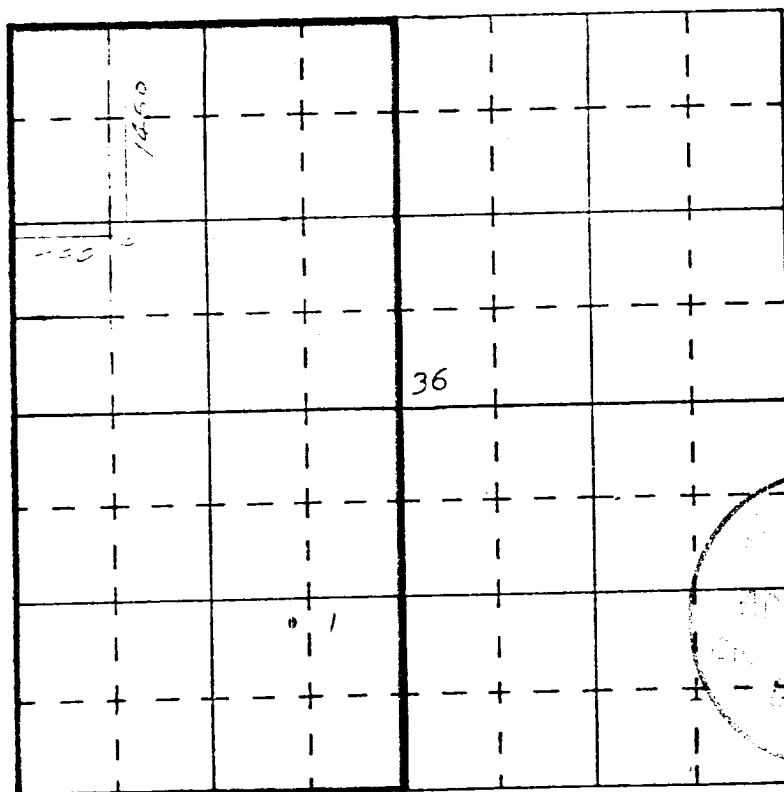

SCALE—4 INCHES EQUALS 1 MILE

SAN JUAN ENGINEERING COMPANY, FARMINGTON, N. M.

1463
Certificate No.