

| | | |
|------------------------|--|--|
| NO. OF COPIES RECEIVED | | |
| DISTRIBUTION | | |
| SANTA FE | | |
| FILE | | |
| U.S.G.S. | | |
| LAND OFFICE | | |
| OPERATOR | | |

NEW MEXICO OIL CONSERVATION COMMISSION

30-045-23745
Form C-101
Revised 1-1-65

5A. Indicate Type of Lease
STATE FEE

5. State Oil & Gas Lease No.
E453, E5152, E3151

APPLICATION FOR PERMIT TO DRILL, DEEPEN, OR PLUG BACK

| | | | | | |
|---|--|-------------------------------------|--|--|------------------------------|
| 1a. Type of Work b. Type of Well DRILL <input checked="" type="checkbox"/> DEEPEN <input type="checkbox"/> PLUG BACK <input type="checkbox"/> OIL WELL <input type="checkbox"/> GAS WELL <input checked="" type="checkbox"/> OTHER _____ SINGLE ZONE <input checked="" type="checkbox"/> MULTIPLE ZONE <input type="checkbox"/> | | | 7. Unit Agreement Name | | |
| 2. Name of Operator MESA PETROLEUM CO | | | 8. Farm or Lease Name STATE COM AJ | | |
| 3. Address of Operator 1660 Lincoln, 2800 Lincoln Center, Denver, Colorado 80264 | | | 9. Well No. 34E | | |
| 4. Location of Well UNIT LETTER N LOCATED 1185 FEET FROM THE SOUTH LINE AND 1485 FEET FROM THE WEST LINE OF SEC. 36 TWP. 32N RGE. 12W NMPM | | | 10. Field and Pool, or Wildcat BASIN DAKOTA | | |
| 21. Elevations (Show whether DF, RT, etc.) 6309' GL | | | 19. Proposed Depth 7600 | 19A. Formation MORRISON | 20. Rotary or C.T. ROTARY |
| 21A. Kind & Status Plug. Bond STATE WIDE | | 21B. Drilling Contractor UNKNOWN | | 22. Approx. Date Work will start September 15, 1979 | |

PROPOSED CASING AND CEMENT PROGRAM

| SIZE OF HOLE | SIZE OF CASING | WEIGHT PER FOOT | SETTING DEPTH | SACKS OF CEMENT | EST. TOP SURFACE |
|--------------|----------------|-----------------|---------------|-----------------|------------------|
| 13 3/4 | 9 5/8 | 36 | 400 | 250 | SURFACE |
| 7 7/8 | 5 1/2 | 15.5 | 7600' | 800 | 1450 |

A 10" 900 Series BOP will be installed and operable for all drilling below the surface casing. A choke line will be installed and sufficient mud products kept at the site to contain any normal blowout situation.

Gas under this lease is committed to a contract.

APPROVED FOR THE COMMISSION
11-27-79



IN ABOVE SPACE DESCRIBE PROPOSED PROGRAM; IF PROPOSAL IS TO DEEPEN OR PLUG BACK, GIVE DATA ON PRESENT PRODUCTIVE ZONE AND PROPOSED NEW PRODUCTIVE ZONE. GIVE BLOWOUT PREVENTER PROGRAM, IF ANY.

I hereby certify that the information above is true and complete to the best of my knowledge and belief.

Signed John Alexander Title AGENT Date August 10, 1979
(This space for State Use)

APPROVED BY W. Kendrick TITLE SUPERVISOR DISTRICT # 3 DATE AUG 29 1979
CONDITIONS OF APPROVAL, IF ANY:

All distances must be from the outer boundaries of the Section.

| | | | | | |
|--|--------------------------------------|-----------------------------|---------------------------------|---------------------------|-------------------------|
| Operator MESA PETROLEUM COMPANY | | | Lease STATE COM "AJ" | | Well No. 34-E |
| Unit Letter N | Section 36 | Township 32N | Range 12W | County San Juan | |
| Actual Footage Location of Well: 1185 feet from the South line and 1485 feet from the West line | | | | | |
| Ground Level Elev. 6309 | Producing Formation Dakota | Pool Basin Dakota | Dedicated Acreage 320 | | Acres |

1. Outline the acreage dedicated to the subject well by colored pencil or hachure marks on the plat below.
2. If more than one lease is dedicated to the well, outline each and identify the ownership thereof (both as to working interest and royalty).
3. If more than one lease of different ownership is dedicated to the well, have the interests of all owners been consolidated by communitization, unitization, force-pooling, etc?

Yes No If answer is "yes," type of consolidation COMMUNITIZATION

If answer is "no," list the owners and tract descriptions which have actually been consolidated. (Use reverse side of this form if necessary.)

No allowable will be assigned to the well until all interests have been consolidated (by communitization, unitization, forced-pooling, or otherwise) or until a non-standard unit, eliminating such interests, has been approved by the Commission.

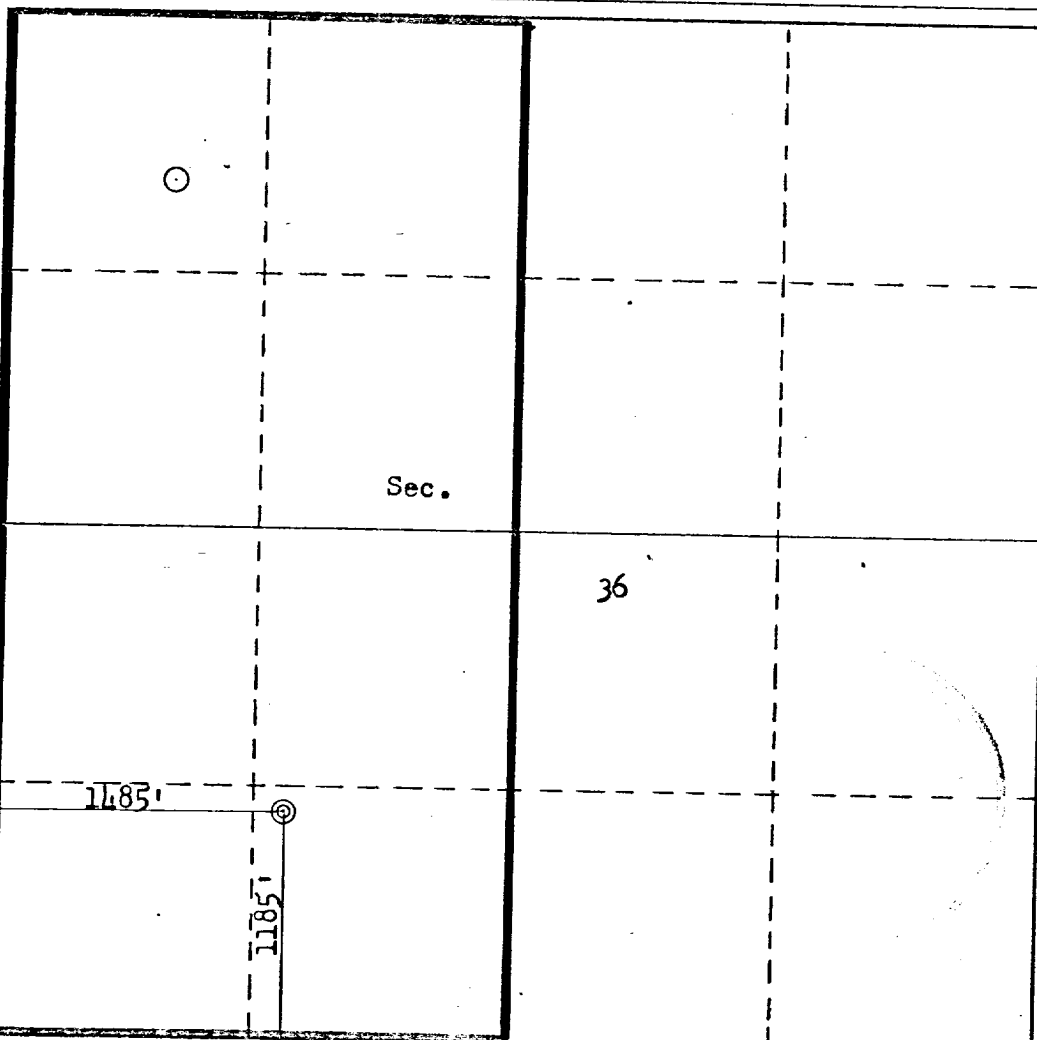

CERTIFICATION

I hereby certify that the information contained herein is true and complete to the best of my knowledge and belief.

John Alexander

Name
JOHN ALEXANDER

Position
AGENT

Company
MESA PETROLEUM CORP.

Date
August 27, 1979

I hereby certify that the well location shown on this plat was plotted from field notes of actual surveys made by me or under my supervision, and that the same is true and correct to the best of my knowledge and belief.

Date Surveyed
July 28, 1979
Registered Professional Engineer and/or Land Surveyor

Fred B. Kerr Jr.
Fred B. Kerr Jr.

Certificate No.
3950