

MEXICO OIL CONSERVATION COMMISSION  
WELL LOCATION AND ACREAGE DEDICATION PLAT

Form C-102  
Supersedes C-120  
Effective 1-1-65

EXHIBIT "A"

All distances must be from the outer boundaries of the Section.

Location & Elevation Plat

Operator John H. Hill & Gordon L. Llewellyn		Lease SF-078818 A		Well No. #1 USA	
Unit Letter P	Section 24	Township 32N	Range 13W	County San Juan	
Actual Portage Location of Well:					
812 feet from the South line and		804 feet from the East line			
Ground Level Elev. 5925'	Producing Formation Mesa Verde	Pool Blanco Mesa Verde	Dedicated Acreage 320 Acres		

1. Outline the acreage dedicated to the subject well by colored pencil or hachure marks on the plat below.
2. If more than one lease is dedicated to the well, outline each and identify the ownership thereof (both as to working interest and royalty).
3. If more than one lease of different ownership is dedicated to the well, have the interests of all owners been consolidated by communitization, unitization, force-pooling, etc?

☐ Yes ☐ No If answer is "yes," type of consolidation \_\_\_\_\_

If answer is "no," list the owners and tract descriptions which have actually been consolidated. (Use reverse side of this form if necessary.) \_\_\_\_\_

No allowable will be assigned to the well until all interests have been consolidated (by communitization, unitization, forced-pooling, or otherwise) or until a non-standard unit, eliminating such interests, has been approved by the Commission.

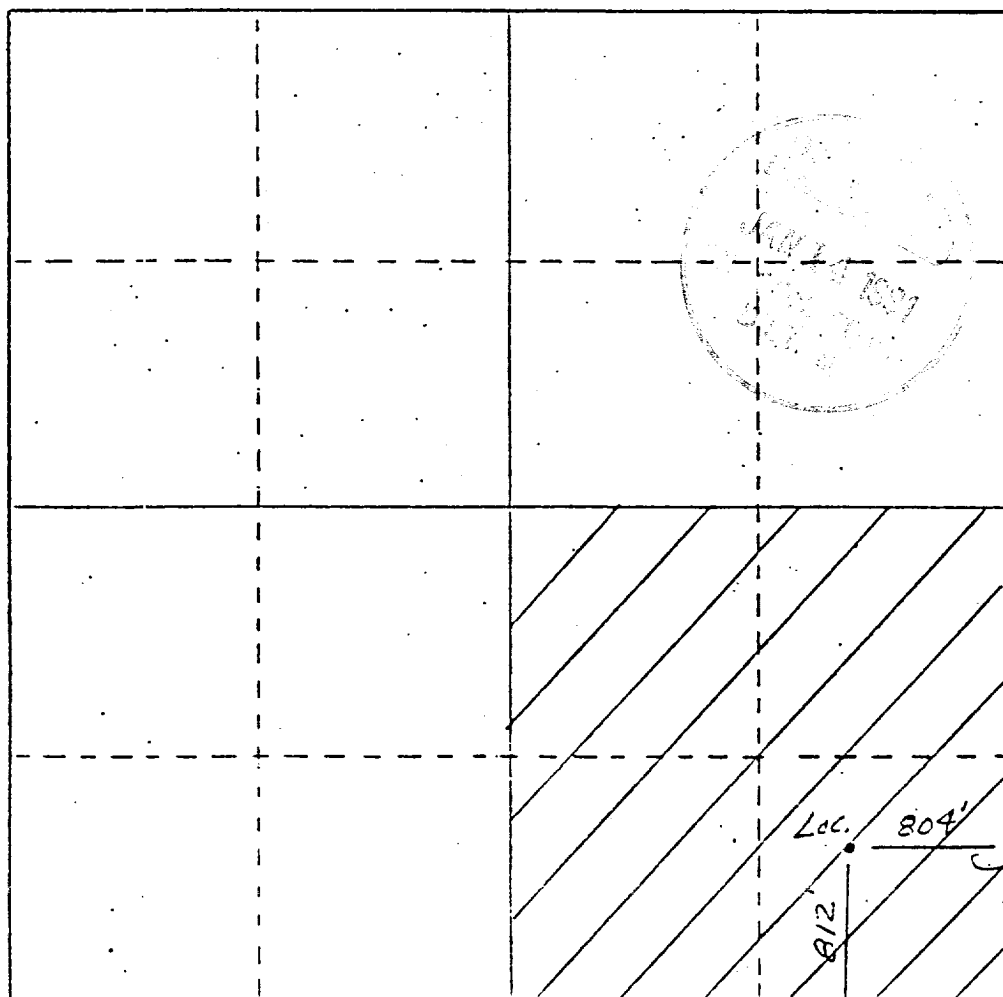

CERTIFICATION

I hereby certify that the information contained herein is true and complete to the best of my knowledge and belief.

*George Lapaseotes*

Name George Lapaseotes

V. Pres. Powers Elevation

Position

Agent Consultant for

Company John H. Hill & Gordon L. Llewellyn

Date November 1, 1979

I hereby certify that the well location shown on this plat was noted from field notes of actual surveys made by me or under my supervision, and that the same is true and correct to the best of my knowledge and belief.

*NEALE C. EDWARDS*

10-26-79

Date Surveyed

Registered Professional Engineer and or Land Surveyor

6857

Certificate No.

