

| | |
|------------------------|--|
| NO. OF COPIES RECEIVED | |
| DISTRIBUTION | |
| SANTA FE | |
| FILE | |
| U.S.G.S. | |
| LAND OFFICE | |
| OPERATOR | |

NEW MEXICO OIL CONSERVATION COMMISSION

Form C-101
Revised 1-1-65

30-045-24514

| | |
|--------------------------------|---|
| 5A. Indicate Type of Lease | |
| STATE <input type="checkbox"/> | FEE <input checked="" type="checkbox"/> |

5. State Oil & Gas Lease No.

APPLICATION FOR PERMIT TO DRILL, DEEPEN, OR PLUG BACK

| | | | |
|--|--|--|--|
| 1a. Type of Work | | 7. Unit Agreement Name | |
| b. Type of Well OIL WELL <input type="checkbox"/> GAS WELL <input checked="" type="checkbox"/> OTHER <input type="checkbox"/> | | 8. Farm or Lease Name Moore | |
| 2. Name of Operator Southland Royalty Company | | 9. Well No. #3 | |
| 3. Address of Operator P. O. Drawer 570, Farmington, NM 87401 | | 10. Field and Pool, or Wildcat Blanco Pictured Cliffs | |
| 4. Location of Well UNIT LETTER J LOCATED 1825 FEET FROM THE South LINE AND 1650 FEET FROM THE East LINE OF SEC. 35 TWP. 32N RGE. 12W NMPM | | 12. County San Juan | |
| 19. Proposed Depth 3050' | | 19A. Formation Pict. Cliffs | |
| 20. Rotary or C.T. Rotary | | 21. Elevations (Show whether DF, RT, etc.) 6378' GR | |
| 21A. Kind & Status Plug. Bond | | 21B. Drilling Contractor | |
| 22. Approx. Date Work will start September 30, 1980 | | | |

PROPOSED CASING AND CEMENT PROGRAM

| SIZE OF HOLE | SIZE OF CASING | WEIGHT PER FOOT | SETTING DEPTH | SACKS OF CEMENT | EST. TOP |
|--------------|----------------|-----------------|---------------|----------------------|-----------|
| 12 1/4" | 8 5/8" | 24# | 140' | 100 sx | Surface |
| 6 3/4" | 2 7/8" | 6.5# | 3050' | 295 sx | Ojo Alamo |
| | | | | sufficient to cement | |

Surface formation is Nacimiento.

Top of Ojo Alamo sand is at 1667'.

Top of Pictured Cliffs sand is at 2839'.

Fresh water mud will be used to drill from surface to total depth.

It is anticipated that an IES and a GR-Density log will be run at total depth.

No abnormal pressures or poisonous gases are anticipated in this well.

It is expected that this well will be drilled before March 31, 1981. This depends on time required for approvals, rig availability and the weather.

Gas is dedicated.

APPROVAL VALID
FOR 90 DAYS UNLESS
DRILLING COMMENCED,

EXPIRES 11-13-80



IN ABOVE SPACE DESCRIBE PROPOSED PROGRAM: IF PROPOSAL IS TO DEEPEN OR PLUG BACK, GIVE DATA ON PROPOSED PRODUCTION ZONE AND PROPOSED NEW PRODUCTION ZONE. GIVE BLOWOUT PREVENTER PROGRAM, IF ANY.

I hereby certify that the information above is true and complete to the best of my knowledge and belief.

Signed R. E. Fields Title District Engineer Date 8-15-80

(This space for State Use)

APPROVED BY John E. Carey TITLE SUPERVISOR DISTRICT # 3 DATE AUG 15 1980

CONDITIONS OF APPROVAL, IF ANY:

note cementing change

OIL CONSERVATION DIVISION

STATE OF NEW MEXICO
ENERGY AND MINERALS DEPARTMENTP. O. BOX 2088
SANTA FE, NEW MEXICO 87501Form C-102
Revised 10-1-78

All distances must be from the outer boundaries of the Section.

| | | | | | |
|--|---|------------------------|-----------------------|---------------------------|--|
| Operator SOUTHLAND ROYALTY COMPANY | | | Lease MOORE | | Well No. 3 |
| Unit Letter J | Section 35 | Township 32N | Range 12W | County San Juan | |
| Actual Footage Location of Well: 1825' feet from the South line and 1650' feet from the East line | | | | | |
| Ground Level Elev. 6378 | Producing Formation Pictured Cliffs | | Pool Blanco | | Dedicated Acreage: 160 Acres |

1. Outline the acreage dedicated to the subject well by colored pencil or hatchure marks on the plat below.
2. If more than one lease is dedicated to the well, outline each and identify the ownership thereof (both as to working interest and royalty).
3. If more than one lease of different ownership is dedicated to the well, have the interests of all owners been consolidated by communitization, unitization, force-pooling, etc?

☐ Yes ☐ No If answer is "yes," type of consolidation _____

If answer is "no," list the owners and tract descriptions which have actually been consolidated. (Use reverse side of this form if necessary.) _____

No allowable will be assigned to the well until all interests have been consolidated (by communitization, unitization, forced-pooling, or otherwise) or until a non-standard unit, eliminating such interests, has been approved by the Commission.

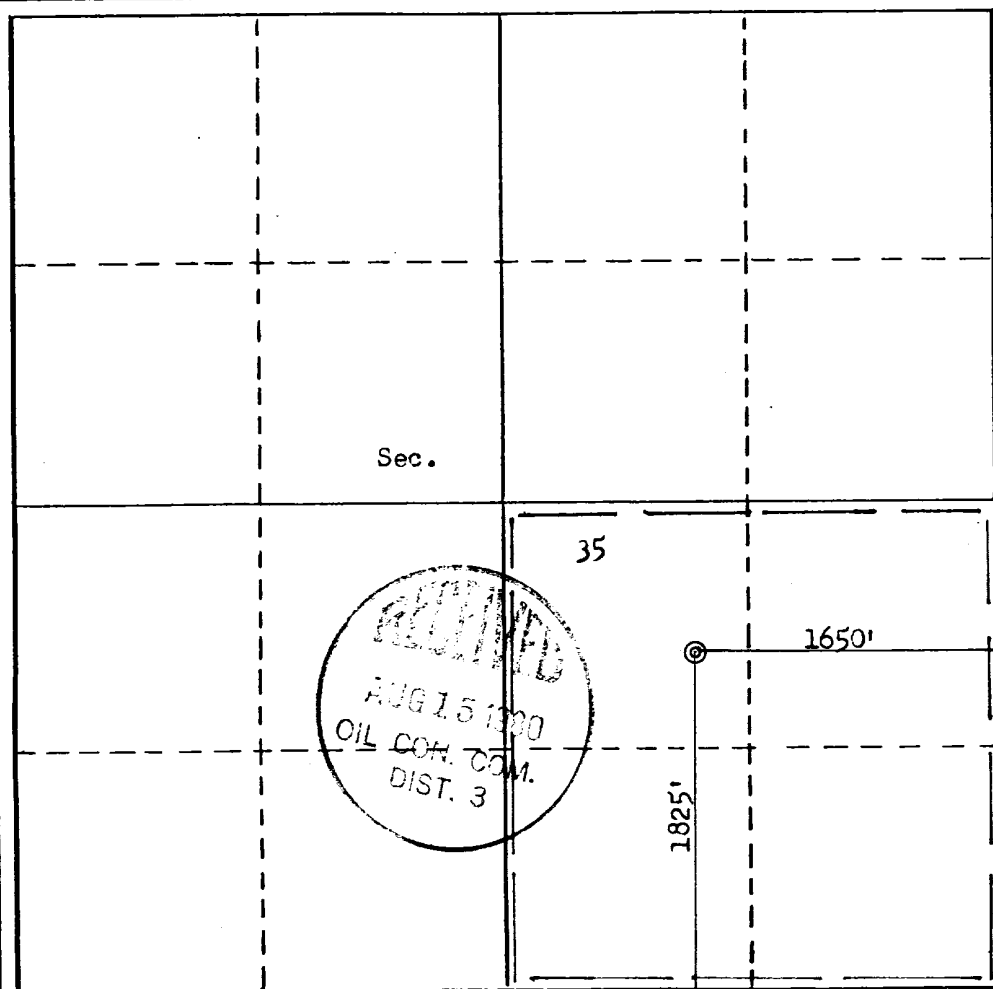

CERTIFICATION

I hereby certify that the information contained herein is true and complete to the best of my knowledge and belief.

R. E. Fielder

Name

Robert E. Fielder

Position

District Engineer

Company

Southland Royalty Company

Date

August 15, 1980

I hereby certify that the well location shown on this plat was plotted from field notes of actual surveys made by me or under my supervision, and that the same is true and correct to the best of my knowledge and belief.

Date Surveyed

May 30, 1980

Registered Professional Engineer and/or Land Surveyor

Frederick B. Kerr Jr.

Certificate No. KERR, INC.

3950

DRILLING SCHEDULE - MOORE #3

Location: 1825' FSL & 1650' FEL, Section 35, T32N, R12W
San Juan County, NM

Field: Blanco Pictured Cliffs

Elevation: 6378' GR
6390' KB

Geology:

| | | |
|-----------------|-----------------|-------|
| Formation Tops: | Ojo Alamo | 1667' |
| | Fruitland | 2440' |
| | Pictured Cliffs | 2839' |
| | Total Depth | 3050' |

Logging Program: IES and GR-Density at Total Depth.

Coring Program : None

Natural Gauges : None

Drilling

Contractor:

SRC Representative:

Mud Program: Fresh water mud from surface to Total Depth.

Tool Pusher:
SRC Answering Service: 325-184
Dispatch Number: 325-7391

Materials

| Casing Program: | Hole Size | Depth | Casing Size | Wt. & Grade | |
|-----------------|-----------|-------|-------------|-------------|------|
| | 12 1/4" | 140' | 8 5/8" | 24# | K-55 |
| | 6 3/4" | 3050' | 2 7/8" | 6.5# | K-55 |

Float Equipment

8-5/8" Surface Casing: Pathfinder cement guide shoe (#1003-1-010).

2-7/8" Production Casing: Sawtooth collar guide shoe. Howco 2 7/8" latch down baffle (PR 60). Two 3 1/16" rubber balls and one 2 7/8" Omega latching plug (PR 59). Use 3 1/4" plug container head. Six B & W stabilizers on bottom 6 joints.

Wellhead Equipment: 8 5/8" X 2 7/8", EUE, screwed head.

Page #2

Cementing

8-5/8" Surface Casing: 118 cu. ft. (100 sx) Class "B" with 1/4# gel
flake per sack and 3% CaCl_2 . (100% excess.)

2-7/8" Production Casing: 422 cu. ft. (245 sx) of 50/50 Class "B" Poz
with 6% gel mixed with 7.2 gals water per sack
to weigh 12.85 ppg. Tail in with (50 sx) Class
"B" with 2% CaCl_2 . If lost circulation occurs,
add 1/4 cu. ft. of fine gilsonite per sack.
(50% excess to cover Ojo Alamo). Displace cement
with 50 gallons of 7 1/2% acetic acid. Run
temperature survey after 12 hours.

L. O. Van Ryan
District Production Manager

REF _____
Date _____



Southland Royalty Company

August 15, 1980

Oil Conservation Division
Mr. Frank Chavez
1000 Rio Brazos Road
Aztec, NM 87410

RE: Blowout Preventer Plan

Dear Mr. Chavez:

All drilling and completion rigs will be equipped with 6" or larger double gate hydraulic blowout preventers and a hydraulic operated closing unit with steel lines.

The preventer is 3000# working pressure and 6000# test pressure.

All crews will be thoroughly trained in the operation of this preventer. The preventer will be tested frequently enough to ensure proper operation.

Sincerely,

SOUTHLAND ROYALTY COMPANY

R. E. Fielder
Robert E. Fielder
District Engineer

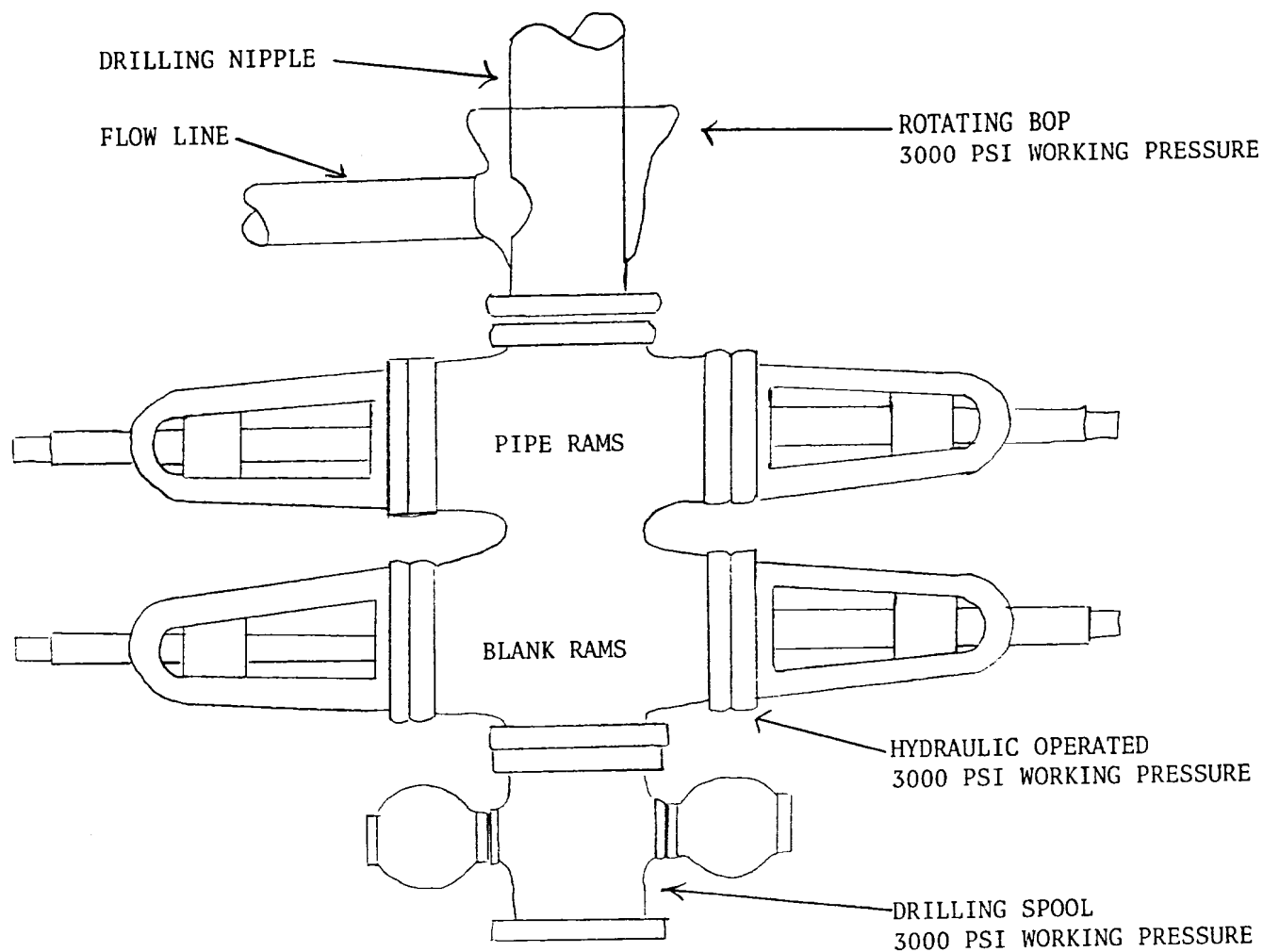

PREVENTERS AND SPOOLS ARE TO HAVE
THROUGH BORE OF 6" - 3000 PSI OR LARGER

Southland Royalty Company
Moore #3
1825' FSL & 1650' FEL
Section 35, T32N, R12W
San Juan County, NM

Location Profile for
 SOUTHLAND ROYALTY COMPANY #3 MOORE
 1825'FSL 1650'FEL Sec. 35-T32N-R12W
 SAN JUAN COUNTY, NEW MEXICO

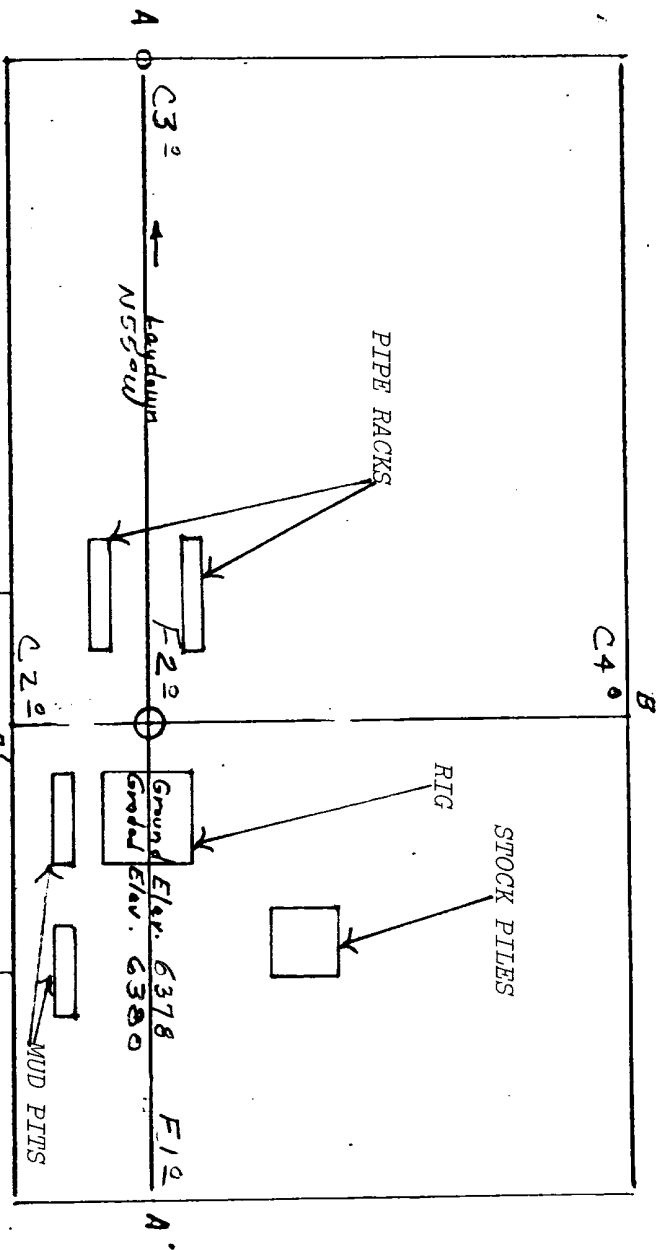
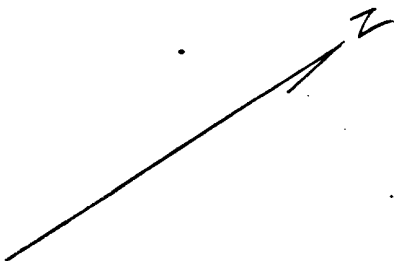

Vert. 1"=40'

A-A' ±

Horiz: 1"=100'



B-B' ±

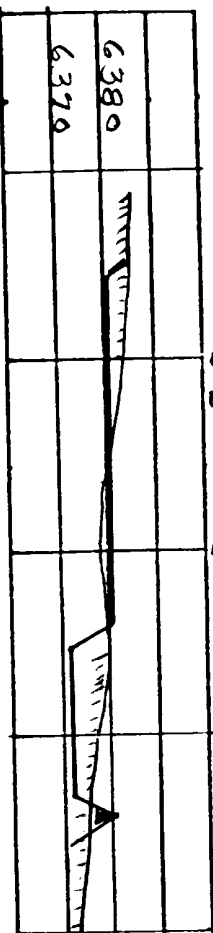

Reserve

Pt

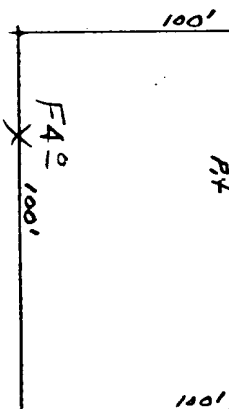

Vert: 1"=40'

C-C' ±

Horiz: 1"=100'

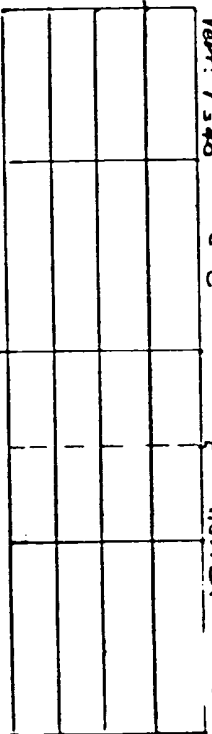

D-D' ±

