

30-145-24826

NO. OF COPIES RECEIVED	
DISTRIBUTION	
SANTA FE	
FILE	
U.S.G.S.	
LAND OFFICE	
OPERATOR	

NEW MEXICO OIL CONSERVATION COMMISSION

Form C-101
Revised 1-1-65

5A. Indicate Type of Lease
STATE <input checked="" type="checkbox"/> FEE <input type="checkbox"/>
5. State Oil & Gas Lease No.
E-3157, E-1198

APPLICATION FOR PERMIT TO DRILL, DEEPEN, OR PLUG BACK

1a. Type of Work		7. Unit Agreement Name	
b. Type of Well DRILL <input checked="" type="checkbox"/> DEEPEN <input type="checkbox"/> PLUG BACK <input type="checkbox"/> OIL WELL <input type="checkbox"/> GAS WELL <input checked="" type="checkbox"/> OTHER <input type="checkbox"/> SINGLE ZONE <input type="checkbox"/> MULTIPLE ZONE <input type="checkbox"/>		8. Farm or Lease Name STATE COM "S"	
2. Name of Operator MESA PETROLEUM CO.		9. Well No. 16	
3. Address of Operator 1660 Lincoln, 2800 Lincoln Center, Denver, Colorado 80264		10. Field and Pool, or Wellbore BLANCO PICTURED CLIFFS	
4. Location of Well UNIT LETTER <u>H</u> LOCATED <u>1600</u> FEET FROM THE <u>NORTH</u> LINE AND <u>1120</u> FEET FROM THE <u>EAST</u> LINE OF SEC. <u>36</u> TWP. <u>32N</u> RGE. <u>12W</u> NMMP		12. County SAN JUAN	
19. Proposed Depth 3250		19A. Formation FRUITLAND PICTURED CLIFFS	
20. Rotary or C.T. ROTARY		21. Elevations (Show whether DF, RT, etc.) 6408 GL	
21A. Kind & Status Plug. Bond STATEWIDE		21B. Drilling Contractor UNKNOWN	
22. Approx. Date Work will start February 25, 1981			

23.

PROPOSED CASING AND CEMENT PROGRAM

SIZE OF HOLE	SIZE OF CASING	WEIGHT PER FOOT	SETTING DEPTH	SACKS OF CEMENT	EST. TOP
12 1/4	8 5/8	24.0	200	150	SURFACE
7 7/8	4 1/2	10.5	3250	500	SURFACE

A double-ram BOP, 10"-900 series, will be installed and operational for all drilling below surface casing. Adequate mud and weight material will be stocked on location. Mud weight will be increased to control any blowout situation.

Gas under this lease is dedicated to a contract.

APPROVAL VALID
FOR 90 DAYS
DRILLING COMMENCEMENT

EXPIRES 7-22-81

IN ABOVE SPACE DESCRIBE PROPOSED PROGRAM; IF PROPOSAL IS TO DEEPEN OR PLUG BACK, GIVE DATA ON PRESENT PRODUCTIVE ZONE AND PROPOSED NEW PRODUCTIVE ZONE, GIVE BLOWOUT PREVENTER PROGRAM, IF ANY.

I hereby certify that the information above is true and complete to the best of my knowledge and belief.

Signed John Alexander Title AGENT Date January 16, 1981

(This space for State Use)

SUPERVISOR DISTRICT # 3

APPROVED BY Frank T. Gray TITLE

DATE

JAN 22 1981

CONDITIONS OF APPROVAL, IF ANY:

OIL CONSERVATION DIVISION

P. O. BOX 7088

Form C-107
Revised 10-1-7

STATE OF NEW MEXICO

ENERGY AND MINERALS DEPARTMENT

SANTA FE, NEW MEXICO 87501

All distances must be from the outer boundaries of the Section.

Operator MESA PETROLEUM COMPANY			Lease STATE COM "S"		Well No. 16
Unit Letter H	Section 36	Township 32N	Range 12W	County San Juan	
Actual Footage Location of Well:					
1600 feet from the North line and		1120 feet from the East line			
Ground Level Elev. 6408	Producing Formation FRUITLAND PICTURED CLIFFS	Foot UNDESIGNATED FRUITLAND BLANCO PICTURED CLIFFS		Dedicated Acreage: 160	Acres

1. Outline the acreage dedicated to the subject well by colored pencil or hachure marks on the plat below.
2. If more than one lease is dedicated to the well, outline each and identify the ownership thereof (both as to working interest and royalty).
3. If more than one lease of different ownership is dedicated to the well, have the interests of all owners been consolidated by communitization, unitization, force-pooling, etc?

☒ Yes ☐ No If answer is "yes," type of consolidation COMMUNITIZED

If answer is "no," list the owners and tract descriptions which have actually been consolidated. (Use reverse side of this form if necessary.) _____

No allowable will be assigned to the well until all interests have been consolidated (by communitization, unitization, forced-pooling, or otherwise) or until a non-standard unit, eliminating such interests, has been approved by the Commission.

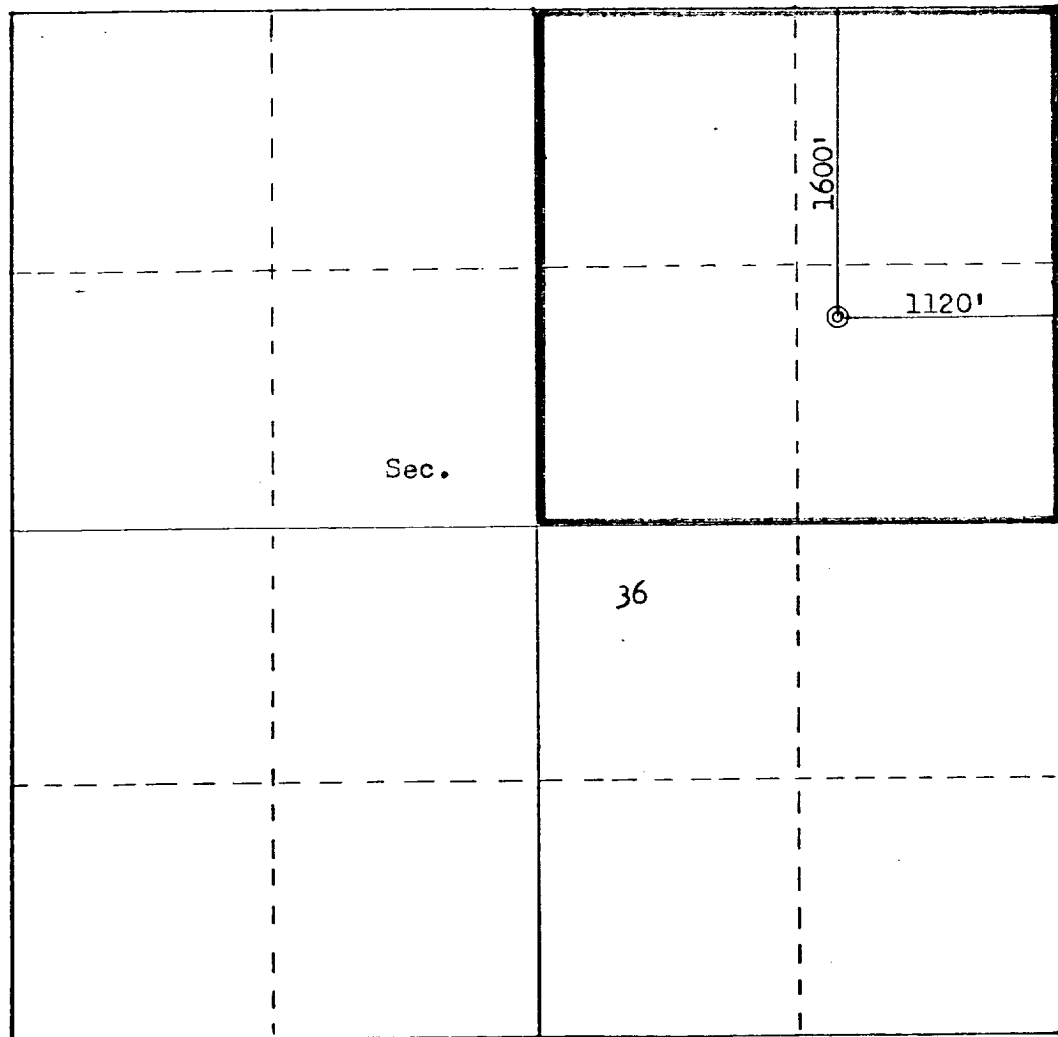

Scale: 1"=1000'

CERTIFICATION

I hereby certify that the information contained herein is true and complete to the best of my knowledge and belief.

Name

JOHN ALEXANDER

Position

AGENT

Company

MESA PETROLEUM CO.

Date

January 16, 1981

I hereby certify that the well location shown on this plat was plotted from field notes of actual surveys made by me or under my supervision and that the same is correct to the best of my knowledge and belief.

Date Surveyed

December 19, 1980

Registered Professional Engineer and Land Surveyor

Fred B. Kerr, Jr.

Certificate No. 3950

3950