



BRUCE KING
GOVERNOR

STATE OF NEW MEXICO
ENERGY AND MINERALS DEPARTMENT
OIL CONSERVATION DIVISION

June 29, 1982

POST OFFICE BOX 2088
STATE LAND OFFICE BUILDING
SANTA FE, NEW MEXICO 87501
(505) 827-2434

Woosley Oil Company
P. O. Box 1227
Cortez, Colorado 81321

Attention: James P. Woosley

Administrative Order NSL-1555

Gentlemen:

Reference is made to your application for a non-standard location for your Navajo Well No. 27 to be located 766 feet from the East line and 3278 feet from the South line of Section 20, Township 32 North, Range 17 West, NMPM, Lower Gallup Field, San Juan County, New Mexico.

By authority granted me under the provisions of Rule 104 F of the Division Rules and Regulations, the above-described unorthodox location is hereby approved.

Sincerely,

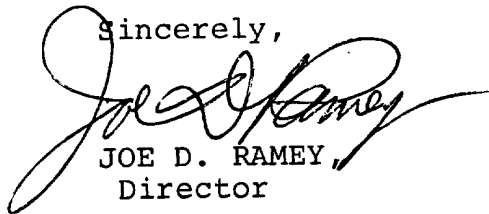
JOE D. RAMEY,
Director

JDR/RLS/dr

cc: Oil Conservation Division - Aztec
Oil & Gas Engineering Committee - Hobbs
Minerals Management Service - Farmington



Woosley Oil Company

303 - 565-8245

Post Office Box 1227

Cortez, Colorado 81321

NMOCD
P.O. Box 2088
Santa Fe, NM 87501

Att: Mr. Dick Stamets

June 12, 1982

Re: NSL : in the
North Many Rocks
Lower Gallup Field
Loc: 766 FEL & ~~3278~~ FSL 1982 FUL
Sec 20: T32N R17W NMPM
San Juan County, NM

Dear Sir;

Due to the very rough and rocky terrain, I am requesting approval of an NSL because of topographical reasons.

Enclosed please find plats showing the proposed location and the topographical area around the location.

Although I have no operators closer than 3278 feet of this proposed location, I have also enclosed a map showing the operators' lease.

This is a demand well and needs to be spudded very soon.

I appreciate your help.

cc: Mr. Tom Dugan

Very truly yours,

James P. Woosley
Mr. James P. Woosley



526
3278
1982

NEW MEXICO OIL CONSERVATION COMMISSION
WELL LOCATION AND ACREAGE DEDICATION PLAT

Supersedes C-129
Effective 1-1-65

All distances must be from the outer boundaries of the Section.

Operator James P. Woosley			Lease Navajo		Well No. 27
Map Letter H	Section 20	Township 32N.	Range 17W.	County San Juan County	
Actual Postage Location of Well: 766' feet from the east line and 3278' 1902 feet from the North South line					
Ground Level Elev. 5839.3	Producing Formation Lower Gallup SS	Pool North Many Rocks		Dedicated Acreage: 40 160 Acres	

- Outline the acreage dedicated to the subject well by colored pencil or hatchure marks on the plat below.
- If more than one lease is dedicated to the well, outline each and identify the ownership thereof (both as to working interest and royalty).
- If more than one lease of different ownership is dedicated to the well, have the interests of all owners been consolidated by communitization, unitization, force-pooling, etc?

☐ Yes ☐ No If answer is "yes," type of consolidation _____

If answer is "no," list the owners and tract descriptions which have actually been consolidated. (Use reverse side of this form if necessary.) _____

No allowable will be assigned to the well until all interests have been consolidated (by communitization, unitization, forced-pooling, or otherwise) or until a non-standard unit, eliminating such interests, has been approved by the Commission.

CERTIFICATION

I hereby certify that the information contained herein is true and complete to the best of my knowledge and belief.

Name
James P. Woosley
Position
Operator
Company
Woosley Oil Co.
Date
May 21, 1982

I hereby certify that the well location shown on this plat was plotted from field notes of actual surveys made by me or under my supervision, and that the same is true and correct to the best of my knowledge and belief.

May 17, 1982
Date Surveyed
Richard O. Morris
Registered Professional Engineer
and or Land Surveyor
Colo. Reg. No. 6728
Utah Reg. No. 4346

Certificate No.

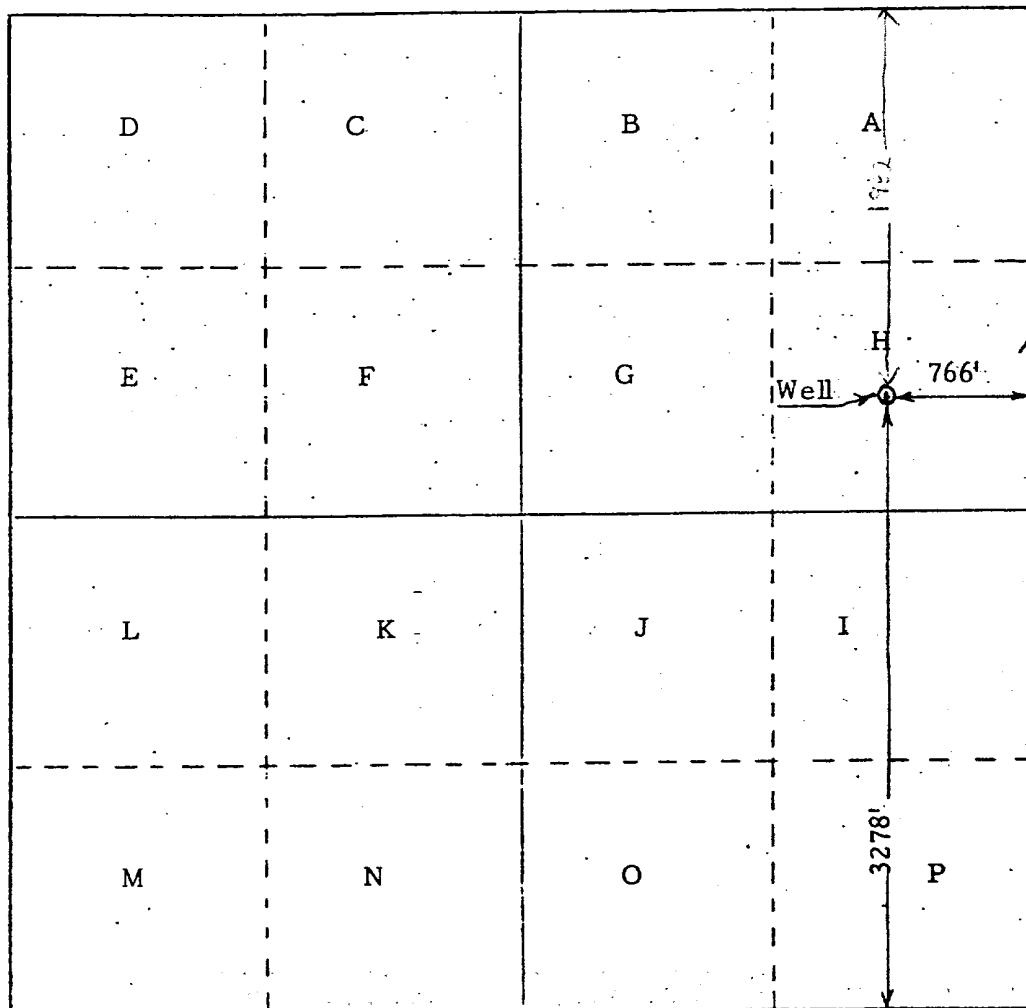

330 660 990 1320 1650 1980 2310 2640 2970 3300 3630 3960 4290 4620 4950 5280 5610 5940 6270 6600

North

Ry Marsh

1" = 50'

Rocky cliffs

Rocky cliffs

Access Road

cliff

gully

bluff

Rock

Archaeological find

bluff

Rock

Rock ledge

bluff

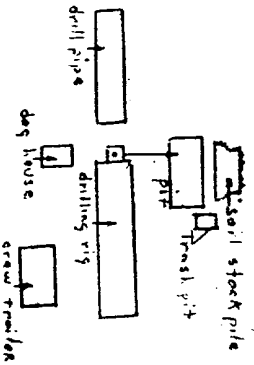

R 16

R 17 W

NORTH MANY ROCKS
LOWER Gallup Field

Proposed
Location

Woosley

MANY ROCKS GALLUP
FIELD

HORSESHOE GALLUP
FIELD

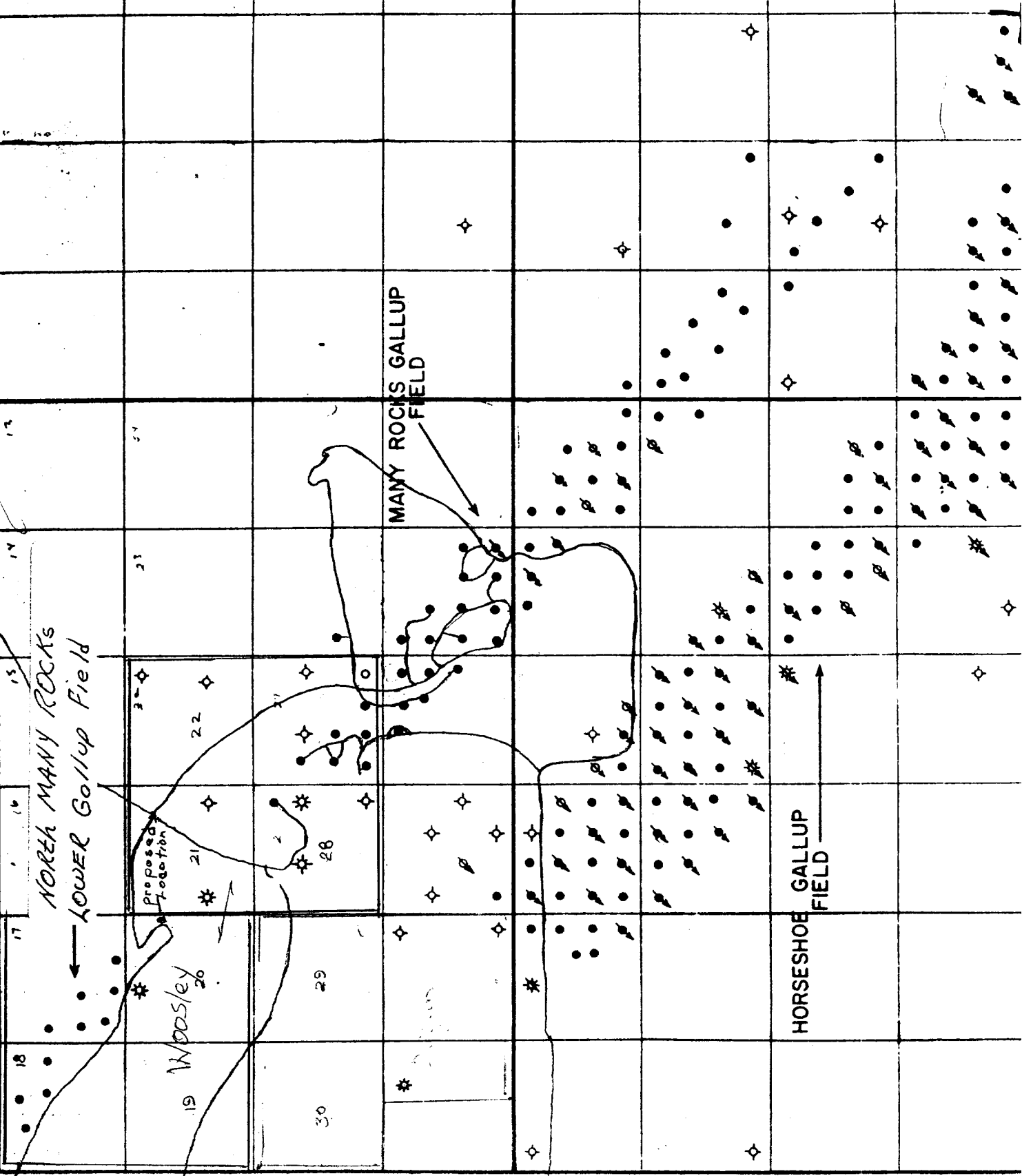

existing improved road (bladed)

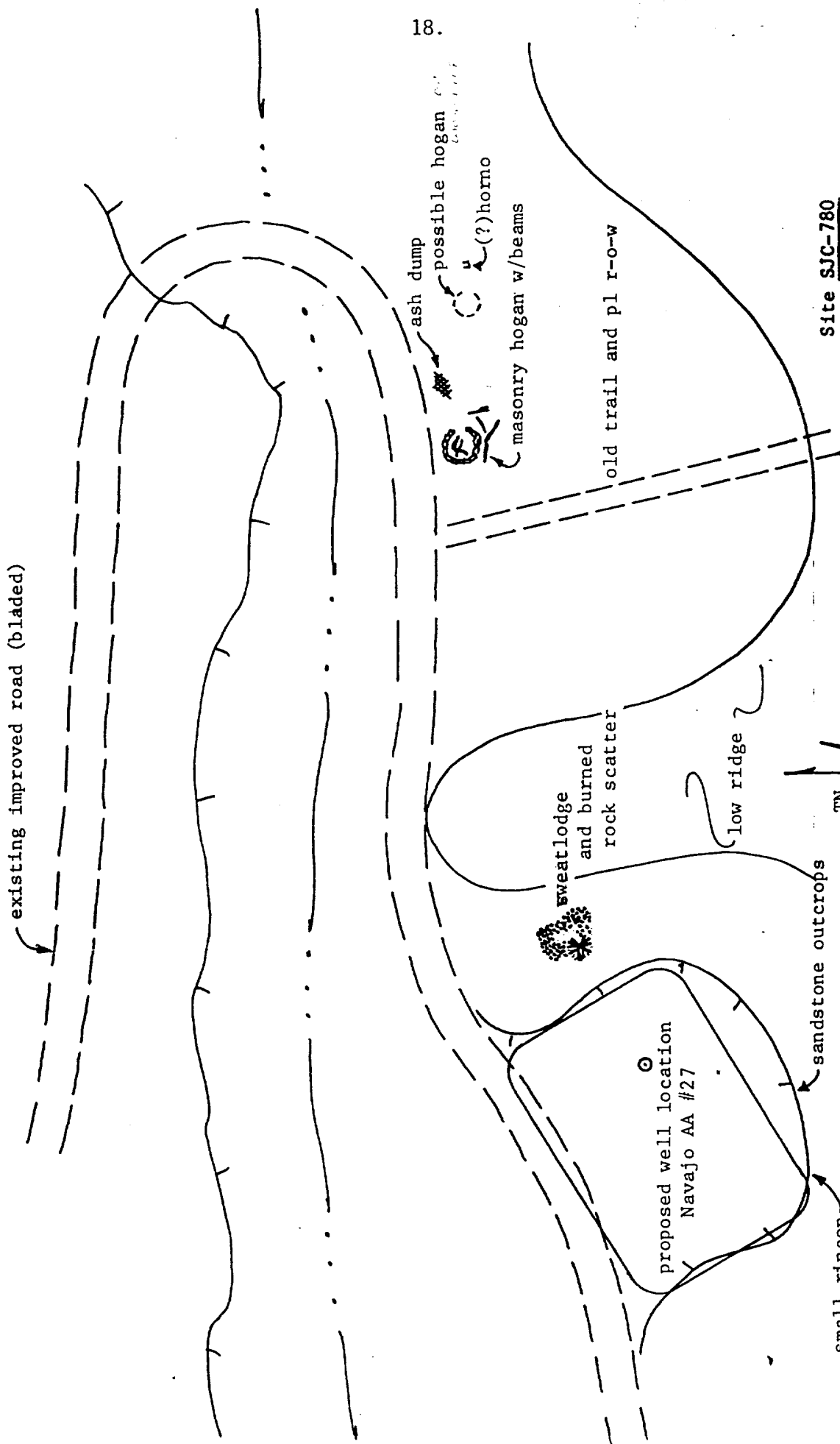

18.

Site SJC-780
 South $\frac{1}{2}$, SE $\frac{1}{4}$, NE $\frac{1}{4}$
 Section 20
 T 32N, R 17W
 San Juan County
 New Mexico
 (unplatted land)

