

Submit to Appropriate
District Office
State Lease - 6 copies
Fee Lease - 5 copies

State of New Mexico
Energy, Minerals and Natural Resources Department

Form C-101
Revised 1-1-89

OIL CONSERVATION DIVISION

DISTRICT I
P.O. Box 1980, Hobbs, NM 88240

DISTRICT II
P.O. Drawer DD, Artesia, NM 88210

DISTRICT III
1000 Rio Brazos Rd., Aztec, NM 87410

P.O. Box 2088
Santa Fe, New Mexico 87504-2088

JUN 25 1990

API NO. (assigned by OCD on New Wells)

30-045-27910

5. Indicate Type of Lease

STATE ☐

FEE ☒

6. State Oil & Gas Lease No.

7. Lease Name or Unit Agreement Name

FC FEE COM

8. Well No.

4

W/320

9. Pool name or Wildcat

Basin Fruitland Coal

APPLICATION FOR PERMIT TO DRILL, DEEPEN OR PLUG BACK

1a. Type of Work:

DRILL ☒

RE-ENTER ☐

DEEPEN ☐

DIST. 3

PLUG BACK ☐

b. Type of Well:

OIL
WELL ☐

GAS
WELL ☒

OTHER

SINGLE
ZONE ☒

MULTIPLE
ZONE ☐

2. Name of Operator

Mesa Operating Limited Partnership

3. Address of Operator

P.O. Box 2009, Amarillo, Texas 79189

4. Well Location

Unit Letter K

: 1475

Feet From The South

Line and 1725'

Feet From The West

Line

Section 31

Township 32N

Range

11W

NMPM

San Juan

County

10. Proposed Depth
3150'

11. Formation
Fruitland Coal

12. Rotary or C.T.
Rotary

13. Elevations (Show whether DF, RT, GR, etc.)
6390' GR

14. Kind & Status Plug. Bond
Blanket

15. Drilling Contractor
Not Yet Determined

16. Approx. Date Work will start

PROPOSED CASING AND CEMENT PROGRAM

SIZE OF HOLE	SIZE OF CASING	WEIGHT PER FOOT	SETTING DEPTH	SACKS OF CEMENT	EST. TOP
12 1/4"	8 5/8"	24#	200'	150 sx 'B'/2% CC	Surface
7 7/8"	5 1/2"	17#	3150'	400 Poz/250 'B'	Surface
	2 3/8"	4.7#	3075'		

Propose to spud well with 12 1/4" hole and drill to 200' and set 8 5/8" surface casing. Will cement with 150 sx (yield = 1.18 Ft³, 177 Ft³) of Class "B" and raise cement to surface. Will nipple up 3000 psi BOP assembly and drill 7 7/8" hole to TD of 3150' with fresh water mud system. Will then log well and evaluate for possible commercial production. If successful, will then run 5 1/2" casing to 3150' and cement with 400 sx Pozmix (yield - 1.8 Ft³, 720 Ft³) followed by 250 sx Class "B" cement (yield - 1.18 Ft³, 295 Ft³). Will move off drilling rig and move in completion unit.

xc: NMOCD-Aztec (0+5), WF, Reg, Land, Expl., Drlg.

IN ABOVE SPACE DESCRIBE PROPOSED PROGRAM: IF PROPOSAL IS TO DEEPEN OR PLUG BACK, GIVE DATA ON PRESENT PRODUCTIVE ZONE AND PROPOSED NEW PRODUCTIVE ZONE. GIVE BLOWOUT PREVENTER PROGRAM, IF ANY.

I hereby certify that the information above is true and complete to the best of my knowledge and belief.

SIGNATURE

Charles R. McKee

TITLE

Regulatory Analyst

DATE

6/21/90

TYPE OR PRINT NAME

APPROVAL EXPIRES

UNLESS DRILLING IS COMMENCED

TELEPHONE NO.

(This space for State Use)

SPUD NOTICE MUST BE SUBMITTED
WITHIN 10 DAYS

APPROVED BY

Francis J. Bussell

TITLE

DEPUTY OIL & GAS INSPECTOR, DIST. #3

DATE

JUN 26 1990

CONDITIONS OF APPROVAL, IF ANY:

OIL CONSERVATION DIVISION

P.O. Box 2088

Santa Fe, New Mexico 87504-2088

DISTRICT I

P.O. Box 1980, Hobbs, NM 88240

DISTRICT II

P.O. Drawer DD, Artesia, NM 88210

DISTRICT III

1000 Rio Brazos Rd., Aztec, NM 87410

WELL LOCATION AND ACREAGE DEDICATION PLAT

All Distances must be from the outer boundaries of the section

Operator Mesa Operating Limited Partnership			Lease FC Fee Com		Well No. 4
Unit Letter K	Section 31	Township 32N	Range 11W	County NMPM San Juan	
Actual Footage Location of Well: 1475 feet from the South line and 1725 feet from the West line					
Ground level Elev. 6390'	Producing Formation Fruitland Coal		Pool Basin Fruitland Coal		Dedicated Acreage: W/2 320 Acres

- Outline the acreage dedicated to the subject well by colored pencil or hatchure marks on the plat below.
- If more than one lease is dedicated to the well, outline each and identify the ownership thereof (both as to working interest and royalty).
- If more than one lease of different ownership is dedicated to the well, have the interest of all owners been consolidated by communitization, unitization, force-pooling, etc.?
☒ Yes ☐ No If answer is "yes" type of consolidation Communitization
If answer is "no" list the owners and tract descriptions which have actually been consolidated. (Use reverse side of this form if necessary.)
No allowable will be assigned to the well until all interests have been consolidated (by communitization, unitization, forced-pooling, or otherwise) or until a non-standard unit, eliminating such interest, has been approved by the Division.

0 330 660 990 1320 1650 1980 2310 2640 2970 3300 3630 3960 4290 4620 4950 5280 5610 5940 6270 6600 6930 7260 7590 7920 8250 8580 8910 9240 9570 9900

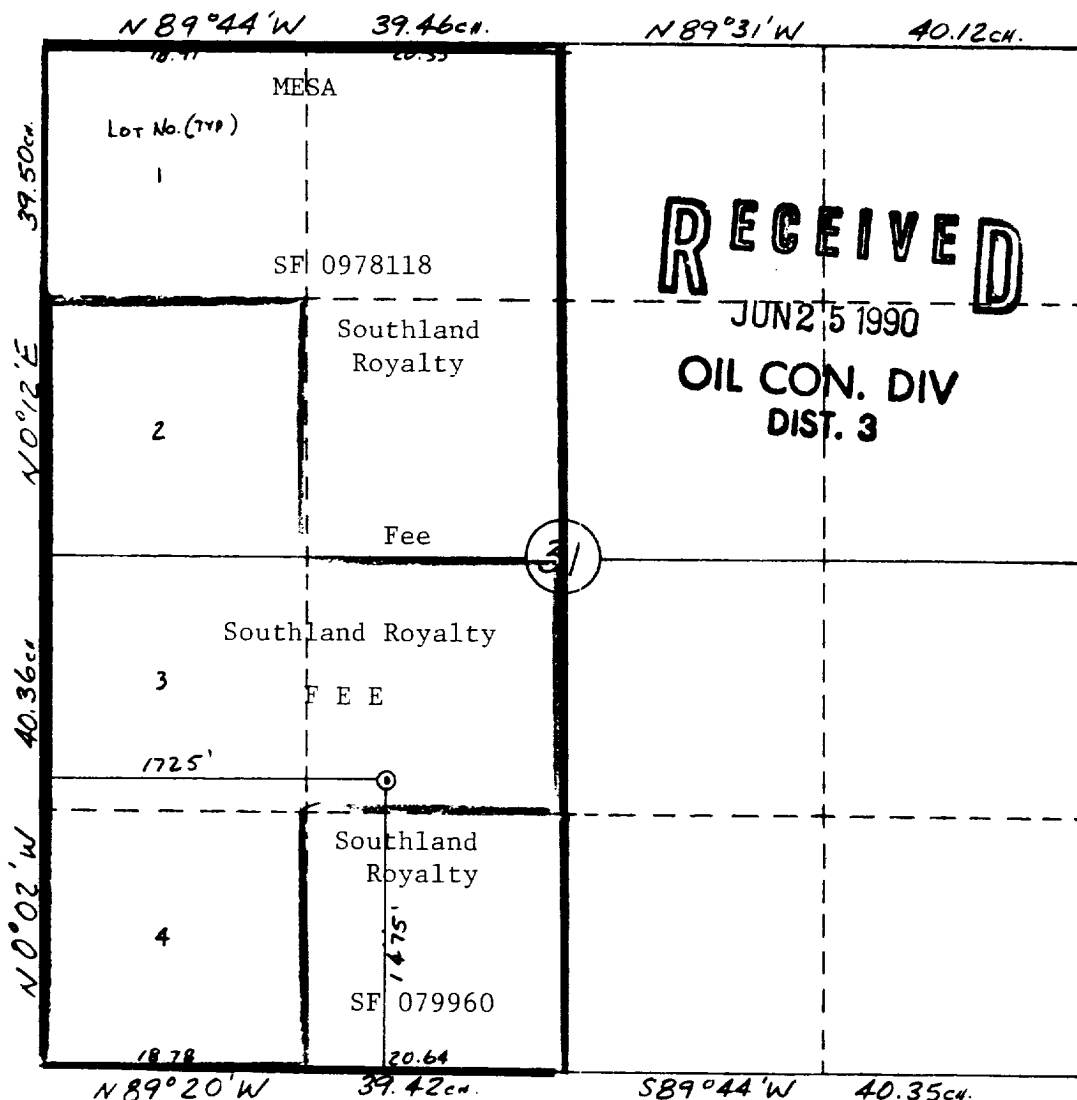

OPERATOR CERTIFICATION

I hereby certify that the information contained herein is true and complete to the best of my knowledge and belief.

Signature
Carolyn L. McKee

Printed Name
Carolyn L. McKee

Position
Regulatory Analyst

Company
Mesa Ltd Partnership

Date
6/21/90

SURVEYOR CERTIFICATION

I hereby certify that the well location shown on this plat was plotted from field notes of actual surveys made by me or under my supervision, and that the same is true and correct to the best of my knowledge and belief. **6-12-90**

Date Surveyed
William A. Mahanke II

Signature & Seal of Professional Surveyor

Professional Surveyor
#8466

Certificate No.
55086