

UNITED STATES
DEPARTMENT OF THE INTERIOR
BUREAU OF LAND MANAGEMENT

APPLICATION FOR PERMIT TO DRILL, DEEPEN, OR PLUG BACK

1A. TYPE OF WORK

DRILL ☒

DEEPEN ☐

PLUG BACK ☐

1B. TYPE OF WELL

OIL
WELL ☐

GAS
WELL ☒

OTHER

Coal Seam

SINGLE
ZONE ☐

MULTIPLE
ZONE ☐

2. NAME OF OPERATOR

Amoco Production Company

ATTN: J. L. Hampton

3. ADDRESS OF OPERATOR

P. O. Box 800 Denver, Colorado 80201

4. LOCATION OF WELL (Report location clearly and in accordance with any State requirements.)

At surface

1570' FSL, 830' FWL, NW/SW

At proposed prod. zone

Same

14. DISTANCE IN MILES AND DIRECTION FROM NEAREST TOWN OR POST OFFICE*

15. DISTANCE FROM PROPOSED*

LOCATION TO NEAREST
PROPERTY OR LEASE LINE, FT.
(Also to nearest diag. unit line, if any)

830'

16. NO. OF ACRES IN LEASE

2,240.00

17. NO. OF ACRES ASSIGNED
TO THIS WELL

320 acres W/2

18. DISTANCE FROM PROPOSED LOCATION*

TO NEAREST WELL, DRILLING, COMPLETED,
OR APPLIED FOR, ON THIS LEASE, FT.

19. PROPOSED DEPTH

2768' TD

20. ROTARY OR CARLIS TOOLS

Rotary

21. ELEVATIONS (Show whether DE, RT, GR, etc.)

6096'

GR

This action is subject to technical and
procedural review pursuant to 43 CFR 3165.3
and appeal pursuant to 43 CFR 3165.4

22. APPROX. DATE WORK WILL START*

As soon as permitted

23.

PROPOSED CASING AND CEMENTING PROGRAM

DRILLING OPERATIONS AUTHORIZED ARE

SUBJECT TO COMPLIANCE WITH ATTACHED

"GENERAL REQUIREMENTS"

250 cf (cement to surface)

775 cf (cement to surface)

SIZE OF HOLE	SIZE OF CASING	WEIGHT PER FOOT	SETTING DEPTH
12 1/4"	8 5/8"	24#	250'
7 7/8"	5 1/2"	17#	2768' (TD)

Notice of Staking was submitted: 6/28/90

Lease Description:

See Attached

RECEIVED
AUG 3 1990
OIL CON. DIV.
DIST. 3

IN ABOVE SPACE DESCRIBE PROPOSED PROGRAM: If proposal is to deepen or plug back, give data on present productive zone and proposed new productive zone. If proposal is to drill or deepen directionally, give pertinent data on subsurface locations and measured and true vertical depths. Give blowout preventer program, if any.

24.

J. L. Hampton

SIGNED

J. L. Hampton/CUB

TITLE Sr. Staff Admin. Supv.

DATE

7/9/90

(This space for Federal or State office use)

PERMIT NO.

APPROVAL DATE

APPROVED BY

CONDITIONS OF APPROVAL, IF ANY:

TITLE

DATE

*See Instructions On Reverse Side

Title 18 U.S.C. Section 1001, makes it a crime for any person knowingly and willfully to make to any department or agency of the United States any false, fictitious or fraudulent statements or representations as to any matter within its jurisdiction.

Submit to Appropriate
District Office
State Lease - 4 copies
Fee Lease - 3 copies

State of New Mexico
Energy, Minerals and Natural Resources Department

Form C-102
Revised 1-1-89

OIL CONSERVATION DIVISION

DISTRICT I
P.O. Box 1980, Hobbs, NM 88240

P.O. Box 2088
Santa Fe, New Mexico 87504-2088

DISTRICT II
P.O. Drawer DD, Artesia, NM 88210

DISTRICT III
1000 Rio Brazos Rd., Aztec, NM 87410

WELL LOCATION AND ACREAGE DEDICATION PLAT

All Distances must be from the outer boundaries of the section

Operator AMOCO PRODUCTION COMPANY			Lease NEWBERRY /A/		Well No. # 8
Unit Letter L	Section 34	Township 32 NORTH	Range 12 WEST	County SAN JUAN	NMPM

Actual Footage Location of Well:

1570 feet from the **SOUTH** line and 830 feet from the **WEST** line
Ground level Elev. **6096** Producing Formation **Fruitland Coal** Pool **Basin Fruitland Coal Gas** Dedicated Acreage: **W/2 320 Acres**

1. Outline the acreage dedicated to the subject well by colored pencil or hatchure marks on the plat below.

2. If more than one lease is dedicated to the well, outline each and identify the ownership thereof (both as to working interest and royalty).

3. If more than one lease of different ownership is dedicated to the well, have the interest of all owners been consolidated by communitization, unitization, force-pooling, etc.?

☐ Yes ☐ No If answer is "yes" type of consolidation

If answer is "no" list the owners and tract descriptions which have actually been consolidated. (Use reverse side of this form if necessary.)

No allowable will be assigned to the well until all interests have been consolidated (by communitization, unitization, forced-pooling, or otherwise) or until a non-standard unit, eliminating such interest, has been approved by the Division.

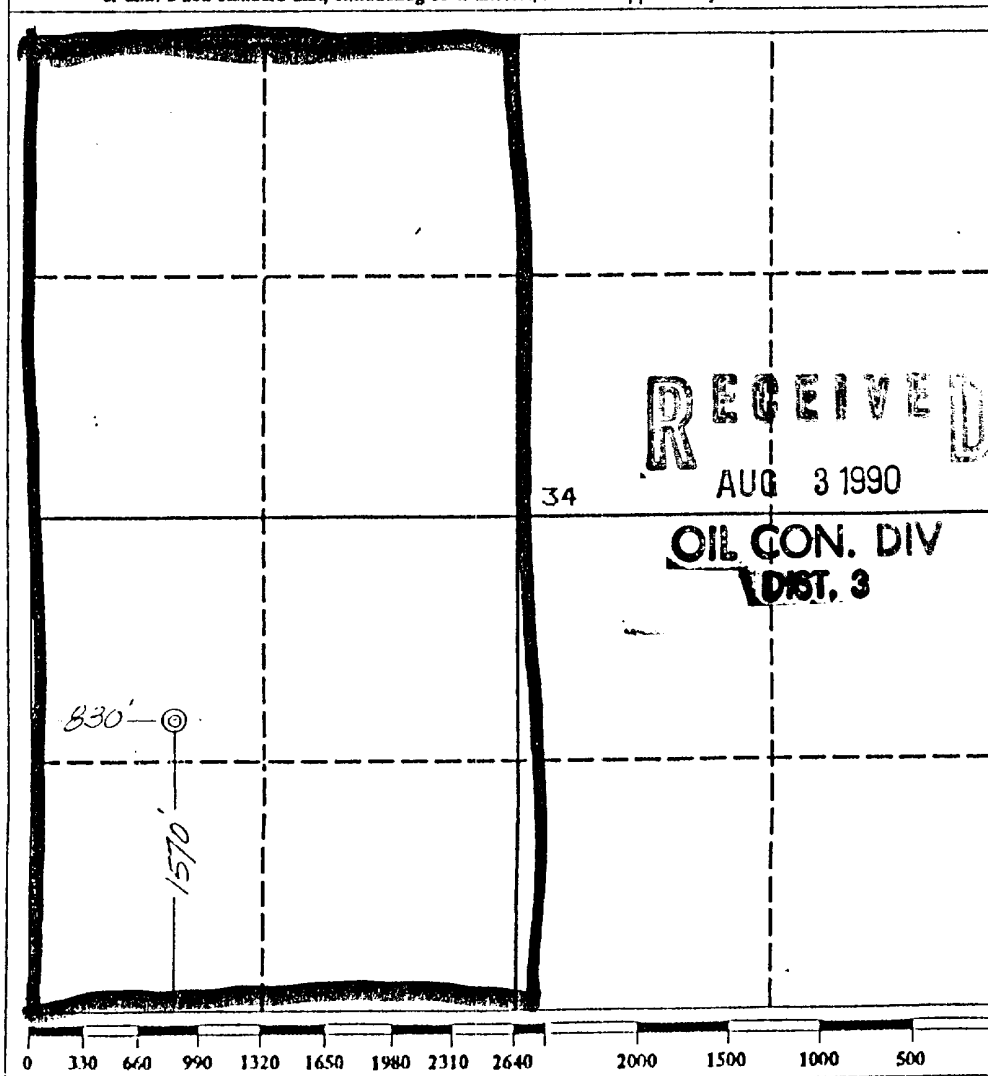

OPERATOR CERTIFICATION

I hereby certify that the information contained herein is true and complete to the best of my knowledge and belief.

Signature *[Signature]*
Printed Name **JL Hampton**
Position **Sr Staff Admin Supr**
Company **Amoco Prod**
Date **6-15-90**

SURVEYOR CERTIFICATION

I hereby certify that the well location shown on this plat was plotted from field notes of actual surveys made by me or under my supervision, and that the same is true and correct to the best of my knowledge and belief.

Date Surveyed **June 6, 1990**

Signature & Seal of Professional Surveyor
GARY D. VANN
Registered Professional Land Surveyor
7016

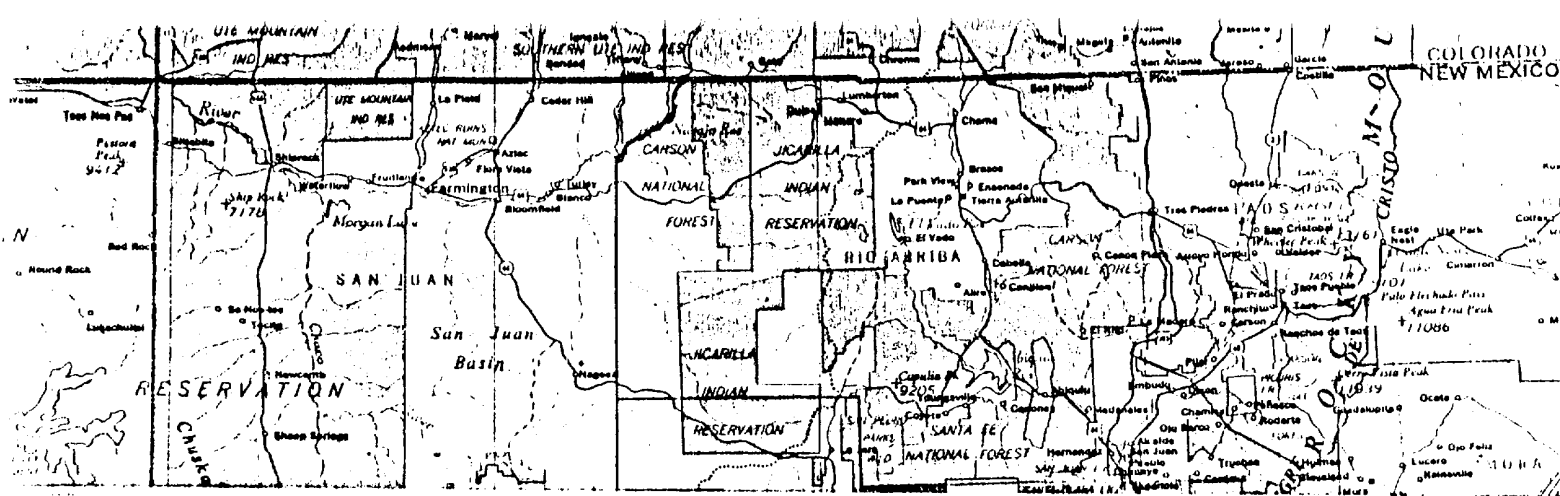

NEWBERRY 1A/ # 8
 1570' F/SL B30' F/WL
 SEC. 34, T32N, R12W, NMPM
 RAIL POINT: 153 miles - Montrose, Co.
 MUD POINT: 10 miles - Aztec, NM
 CEMENT POINT: 24 " Farmington NM

