

District I
P.O. Box 1980, Hobbs, NM

District II
P.O. Drawer 1222, Hobbs, NM

District III
1000 Rio Brazos Rd, Aztec, NM 87410

State of New Mexico
Energy, Minerals and Natural Resources Department

OIL CONSERVATION DIVISION

2040 South Pacheco Street
Santa Fe, New Mexico 87505

SUBMIT 1 COPY TO
APPROPRIATE
DISTRICT OFFICE
AND 1 COPY TO
SANTA FE OFFICE

RECEIVED
JUL 30 1999

CON. DIV.
DIST. 3

PIT REMEDIATION AND CLOSURE REPORT

Operator: PNM Gas Services (Burlington) Telephone: 324-3764

Address: 603 W. Elm Street Farmington, NM 87401

Facility or Well Name: Culpepper Martin #8

Location: Unit N Sec 19 T 32 N R 12 W County San Juan

Pit Type: Separator ☐ Dehydrator ☒ Other

Land Type: BLM ☐ State ☐ Fee ☒ Other

Pit Location: Pit dimensions: length 44 ' width 23 ' depth 5 '

(Attach diagram) Reference: wellhead ☒ other

Footage from reference: 80'

Direction from reference: 80 Degrees ☒ East North ☐
of ☐ West South ☒

Depth to Ground Water:

(Vertical distance from contaminants to
seasonal high water elevation of ground
water)

Less than 50 feet	(20 points)	
50 feet to 99 feet	(10 points)	
Greater than 100 feet	(0 points)	0

Wellhead Protection Area:

(Less than 200 feet from a private
domestic water source, or; less than 1,000
feet from all other water sources)

Yes	(20 points)	
No	(0 points)	0

Distance to Surface Water:

(Horizontal distance to perennial lakes,
ponds, rivers, streams, creeks, irrigation
canals and ditches)

Less than 200 feet	(20 points)	
200 feet to 1,000 feet	(10 points)	
Greater than 1,000 feet	(0 points)	0

RANKING SCORE (TOTAL POINTS): 0

Culpepper Martin #8

Date Remediation Started: 04/29/1999

Date Completed: 05/03/1999

Remediation Method:

Excavation ☒

Approx. Cubic Yard 907

(Check all appropriate sections)

Landfarmed ☒

Amount Landfarmed (cubic yds) 907

Other _____

Remediation Location:

Onsite ☒

Offsite _____

(i.e., landfarmed onsite, name and location of offsite facility)

Backfill Material Location: _____

General Description of Remedial Action:

Excavated contaminated soil to a pit size of 32' X 42.5' X 18' and landfarmed soil onsite within a bermed area at a depth of 6" to 12". Soil was aerated by disking/plowing until soil met regulatory levels.

Ground Water Encountered:

No ☒

Yes ☐

Depth _____

Final Pit Closure Sampling:

Sample Location 5 pt. composite - bottom.

(if multiple samples, attach sample result and diagram of sample locations and depths.)

Sample depth 18'

Sample date 05/03/1999

Sample time 9:45:00 AM

Sample Results

Benzene (ppm) 0.41

Total BTEX (ppm) 47.81

Field headspace (ppm) _____

TPH (ppm) 3260.00

Method 8015B

Vertical Extent (ft) _____

Risk Analysis form attached Yes ☐ No ☒

Ground Water Sample:

Yes ☐

No ☒

(If yes, see attached Groundwater Site Summary Report)

I HEREBY CERTIFY THAT THE INFORMATION ABOVE IS TRUE AND COMPLETE TO THE BEST OF MY KNOWLEDGE AND MY BELIEF

DATE July 27, 1999

SIGNATURE _____

PRINTED NAME Maureen Gannon
AND TITLE Project Manager

Culpper Martin #8
(N) 19-32N-12W
Burlington
4-29-99

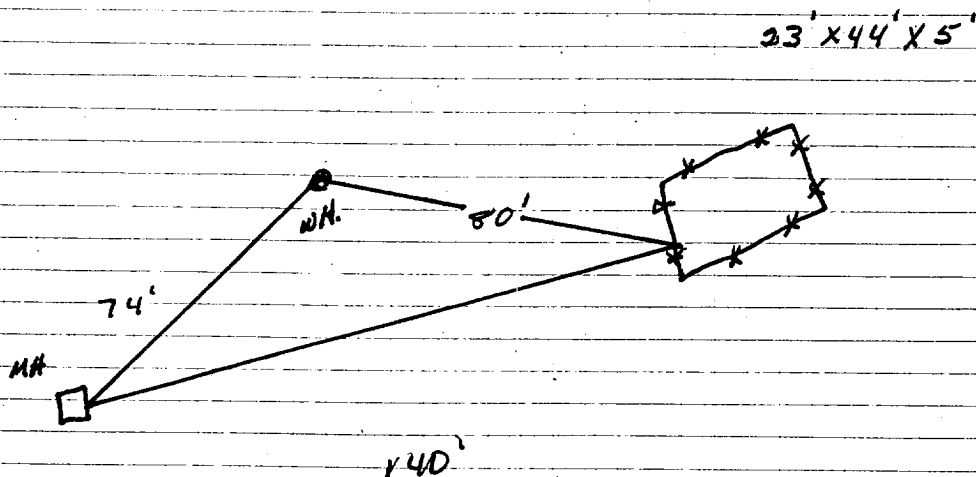

Excavation Sampling

32'(N+5) x 42.5'(E+W) x 18'(D)

PHD readings

8' 1261 ppm
10' 2504 ppm
15' 1769 ppm
18' 1561 ppm

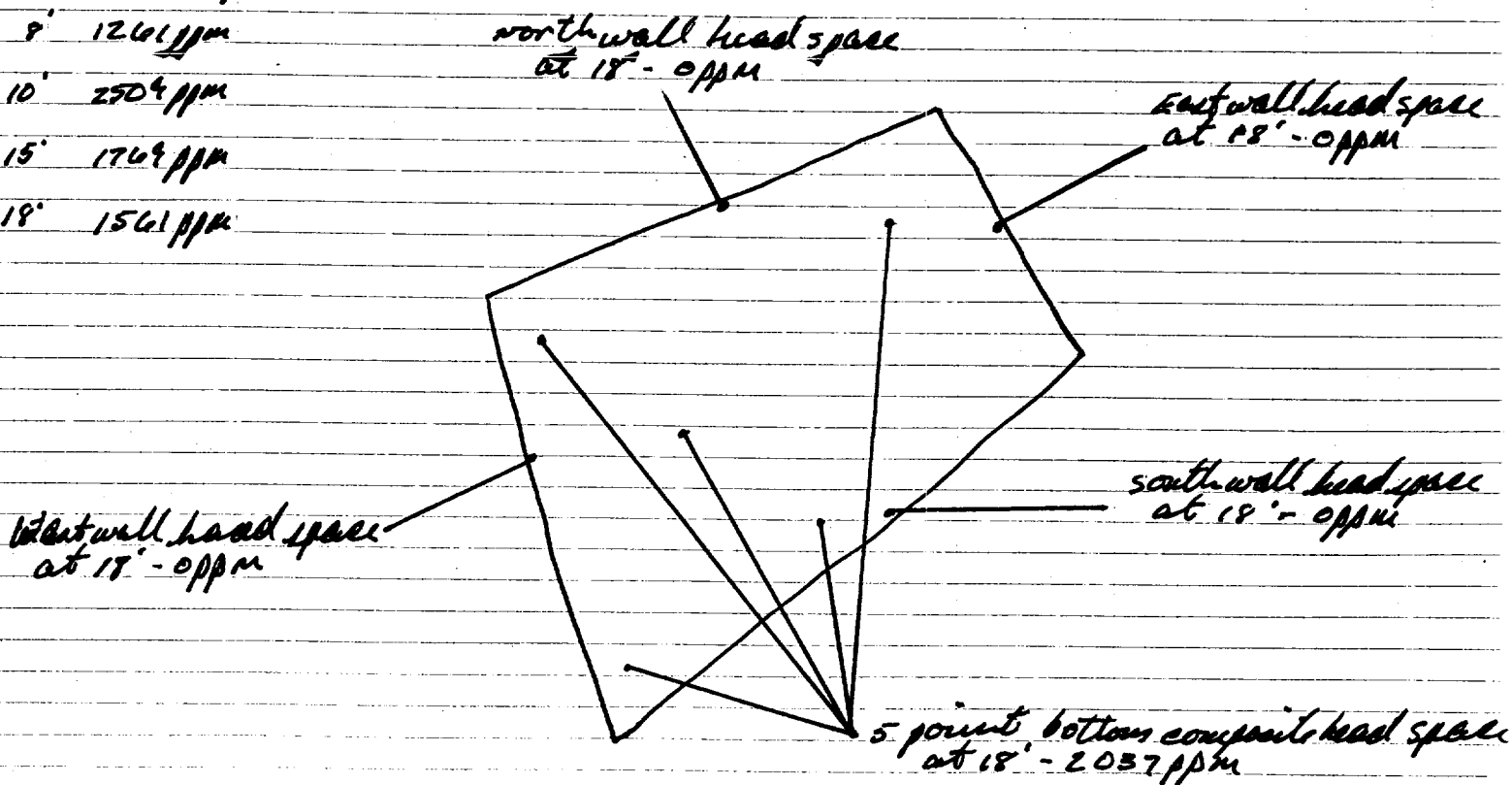

OFF: (505) 325-5667



LAB: (505) 325-1556

On Site Technologies, LTD.

Date: 14-May-99

CLIENT: PNM - Public Service Company of NM
Project: Culpepper Martin #8
Lab Order: 9905013

CASE NARRATIVE

Samples were analyzed using the methods outlined in the following references:

Test Methods for Evaluating Solid Waste, Physical/Chemical Methods, SW846, 3rd Edition

All method blanks, laboratory spikes, and/or matrix spikes met quality assurance objectives.

RH

OFF: (505) 325-5667



LAB: (505) 325-1556

ANALYTICAL REPORT

Date: 14-May-99

Client:	PNM - Public Service Company of NM	Client Sample Info:	Culpepper Martin #8
Work Order:	9905013	Client Sample ID:	9905030945; 5pt. Bottom Comp
Lab ID:	9905013-01A	Matrix:	SOIL
Project:	Culpepper Martin #8	Collection Date:	5/3/99 9:45:00 AM
		COC Record:	5796

Parameter	Result	PQL	Qual	Units	DF	Date Analyzed
DIESEL RANGE ORGANICS		SW8015B				Analyst: DC
T/R Hydrocarbons: C10-C28	3260	25		mg/Kg	1	5/13/99
AROMATIC VOLATILES BY GC/PID		SW8021B				Analyst: DC
Benzene	410	250		µg/Kg	250	5/11/99
Toluene	ND	1000		µg/Kg	500	5/10/99
Ethylbenzene	5000	500		µg/Kg	500	5/10/99
m,p-Xylene	39000	1000		µg/Kg	500	5/10/99
o-Xylene	3400	500		µg/Kg	500	5/10/99

47810
47.81 ppm

Qualifiers:

PQL - Practical Quantitation Limit

S - Spike Recovery outside accepted recovery limits

ND - Not Detected at Practical Quantitation Limit

R - RPD outside accepted recovery limits

J - Analyte detected below Practical Quantitation Limit

E - Value above quantitation range

B - Analyte detected in the associated Method Blank

Surr: - Surrogate

P.O. BOX 2606 • FARMINGTON, NM 87499

1 of 1

OFF: (505) 325-5667



LAB: (505) 325-1556

ANALYTICAL REPORT

Date: 14-May-99

Client:	PNM - Public Service Company of NM	Client Sample Info:	Culpepper Martin #8
Work Order:	9905013	Client Sample ID:	9905030950; 4 Wall Comp
Lab ID:	9905013-02A	Matrix:	SOIL
Project:	Culpepper Martin #8	Collection Date:	5/3/99 9:50:00 AM
		COC Record:	5796

Parameter	Result	PQL	Qual	Units	DF	Date Analyzed
DIESEL RANGE ORGANICS		SW8015B				Analyst: DC
T/R Hydrocarbons: C10-C28	190	25		mg/Kg	1	5/7/99

Qualifiers:

PQL - Practical Quantitation Limit

ND - Not Detected at Practical Quantitation Limit

J - Analyte detected below Practical Quantitation Limit

B - Analyte detected in the associated Method Blank

S - Spike Recovery outside accepted recovery limits

R - RPD outside accepted recovery limits

E - Value above quantitation range

Surr: - Surrogate

P.O. BOX 2606 • FARMINGTON, NM 87499

1 of 1

Culpepper Martin O
Sec-19 T-32N R-12W 44N
Burlington

LAND FARM DRAWING

App 906 cu yds

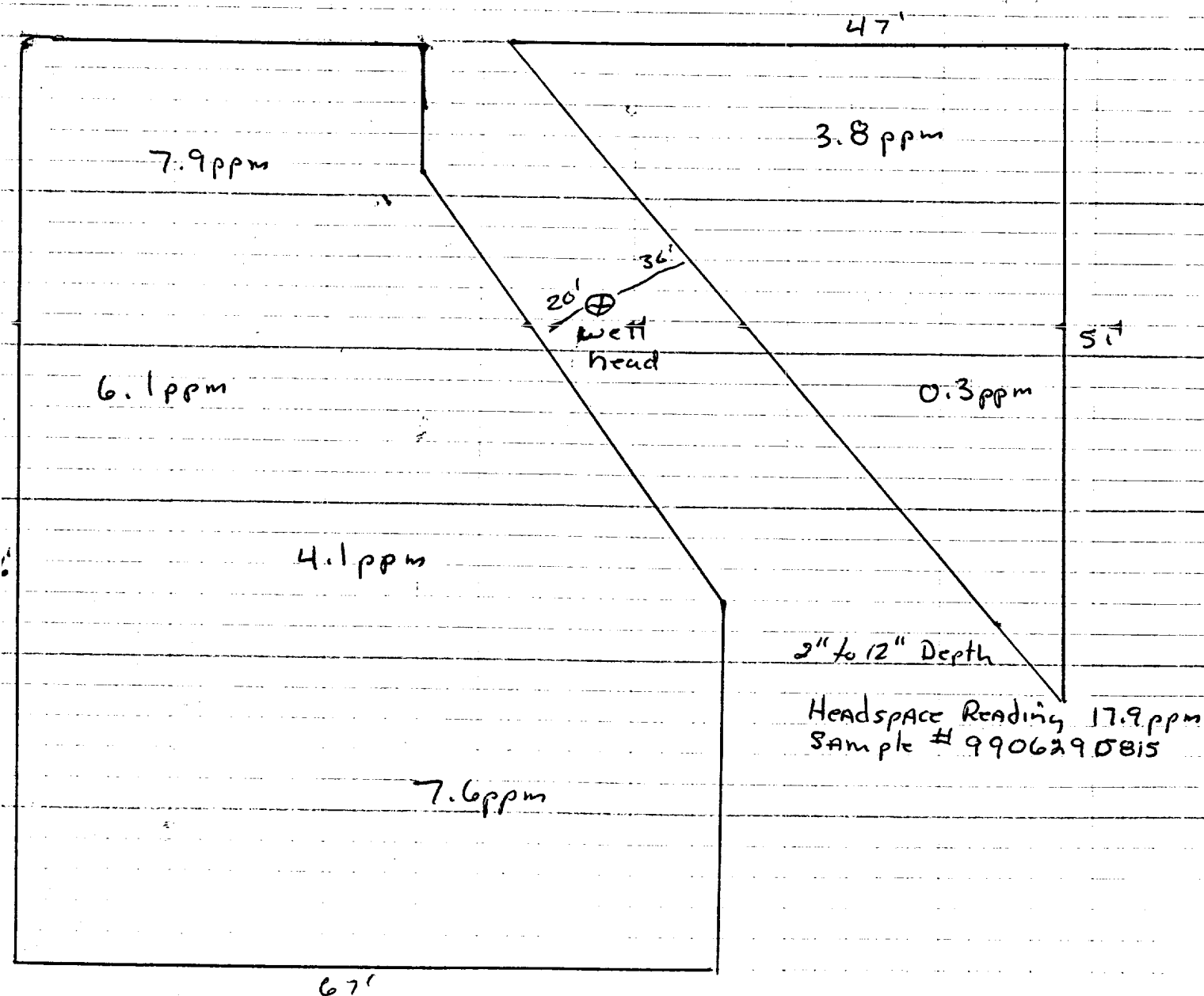

OFF: (505) 325-5667



LAB: (505) 325-1556

On Site Technologies, LTD.

Date: 15-Jul-99

CLIENT: PNM - Public Service Company of NM
Project: Culpepper Martin #8 LF
Lab Order: 9906080

CASE NARRATIVE

Samples were analyzed using the methods outlined in the following references:

Test Methods for Evaluating Solid Waste, Physical/Chemical Methods, SW846, 3rd Edition

All method blanks, laboratory spikes, and/or matrix spikes met quality assurance objectives.

OFF: (505) 325-5667



LAB: (505) 325-1556

ANALYTICAL REPORT

Date: 15-Jul-99

Client:	PNM - Public Service Company of NM	Client Sample Info:	Culpepper Martin #8 LF
Work Order:	9906080	Client Sample ID:	9906290815; 6pt. Comp
Lab ID:	9906080-01A	Matrix:	SOIL
Project:	Culpepper Martin #8 LF	Collection Date:	6/29/99 8:15:00 AM
		COC Record:	7724

Parameter	Result	PQL	Qual	Units	DF	Date Analyzed
DIESEL RANGE ORGANICS		SW8015B				Analyst: DC
T/R Hydrocarbons: C10-C28	2790	25		mg/Kg	1	7/9/99

Qualifiers:

- PQL - Practical Quantitation Limit
- ND - Not Detected at Practical Quantitation Limit
- J - Analyte detected below Practical Quantitation Limit
- B - Analyte detected in the associated Method Blank

- S - Spike Recovery outside accepted recovery limits
- R - RPD outside accepted recovery limits
- E - Value above quantitation range
- Surr: - Surrogate

1 of 1

P.O. BOX 2606 • FARMINGTON, NM 87499

TECHNOLOGIES, LTD. SERVING INDUSTRY WITH THE ENVIRONMENT

