

(SUBMIT IN TRIPLICATE)

UNITED STATES
DEPARTMENT OF THE INTERIOR
GEOLOGICAL SURVEY

Budget Bureau No. 42-R368.4.
Approval expires 12-31-60.

Land Office Santa Fe
Lease No. 078147
Unit Moore

SUNDRY NOTICES AND REPORTS ON WELLS

NOTICE OF INTENTION TO DRILL	<input checked="" type="checkbox"/>	SUBSEQUENT REPORT OF WATER SHUT-OFF	
NOTICE OF INTENTION TO CHANGE PLANS		SUBSEQUENT REPORT OF SHOOTING OR ACIDIZING	
NOTICE OF INTENTION TO TEST WATER SHUT-OFF		SUBSEQUENT REPORT OF ALTERING CASING	
NOTICE OF INTENTION TO RE-DRILL OR REPAIR WELL		SUBSEQUENT REPORT OF RE-DRILLING OR REPAIR	
NOTICE OF INTENTION TO SHOOT OR ACIDIZE		SUBSEQUENT REPORT OF ABANDONMENT	
NOTICE OF INTENTION TO PULL OR ALTER CASING		SUPPLEMENTARY WELL HISTORY	<u>Feb 23 1957</u>
NOTICE OF INTENTION TO ABANDON WELL			

(INDICATE ABOVE BY CHECK MARK NATURE OF REPORT, NOTICE, OR OTHER DATA)

February 26, 1957

Well No. 6 is located 1460 ft. from S line and 1750 ft. from W line of sec. 25

SW Section 25 32N 12W 10PM
(1/4 Sec. and Sec. No.) (Twp.) (Range) (Meridian)
Blanco San Juan New Mexico
(Field) (County or Subdivision) (State or Territory)

The elevation of the derrick floor above sea level is 6464 ft.

DETAILS OF WORK

(State names of and expected depths to objective sands; show sizes, weights, and lengths of proposed casings; indicate mudding jobs, cementing points, and all other important proposed work)

It is intended to drill a well with rotary tools thru the Mesa Verde formation. Mud circulation will be used thru the Pictured Cliffs and set intermediate casing. Gas circulation will be used thru the Mesa Verde and a liner will be set. Possible productive intervals will be perforated and fractured. Estimated T.D. 5470'.

Casing Program:

9 5/8" at 170' with 125 sacks cement circulated to the surface
7" at 5159' with 250 sacks cement.
5 1/2" at 5470' with 150 sacks cement.

The 3/2 of Section 25 is dedicated to this well.

S/2 SW 078147 (N/2SW/4), E. A. Hubbard et ux (N/2SE/4), Artec Oil Co. ON-CON.COM.

I understand that this plan of work must receive approval in writing by the Geological Survey before operations may be commenced.

Company El Paso Natural Gas Company

Address Box 997

Farmington, New Mexico

By ORIGINAL SIGNED E. S. OBERLY

Title Petroleum Engineer

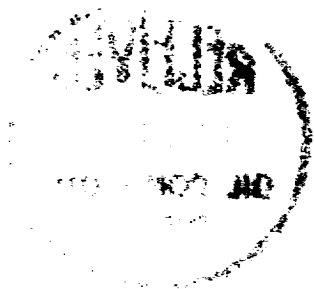

ORIGINAL SIGNATURE REQUIRED

NEW MEXICO
OIL CONSERVATION COMMISSION

WELL LOCATION AND PLAS INFORMATION PLAT

FEBRUARY 20, 1957

EL PASO NATURAL GAS COMPANY

MOORE

SF 078147

6

25

32 N

12 W

1460

SOUTH

1750

WEST

SAN JUAN

6454

MESA VERDE

BLANCO

320 AC.
(1881 PLAT)

Note: All distances are in feet unless otherwise noted.

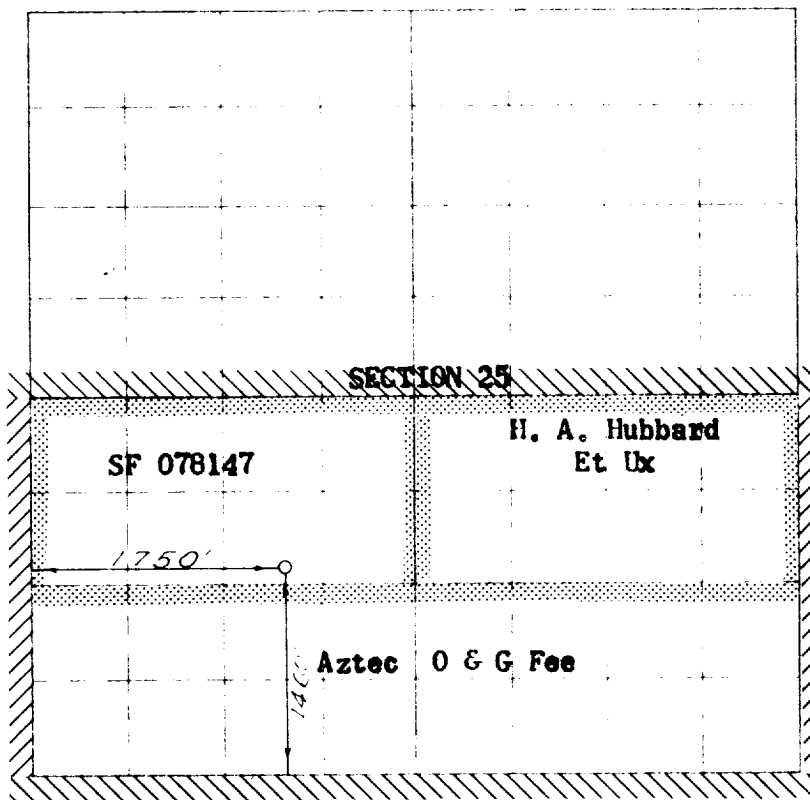

FEB 20 1957

NOTE

This section of
plat is to be used
only for the well only



This is to certify that the above plat was prepared from
field notes of actual survey made under my personal
supervision and that the same are true and correct to the
best of my knowledge and belief.

Date Surveyed **FEBRUARY 19, 1957**

E. O. Walker
Registered Professional Engineer and of Land Surveyor

1. Is this well a Dual Completion?
Yes _____ No _____
2. If the answer to Question 1
is Yes, are there any other fairly
completed wells within the
retreated acreage?
Yes _____ No _____

Name **ORIGINAL SIGNED E. S. OBERLY**

Petroleum Engineer

Position _____
El Paso Natural Gas Co.
representing _____

Address **Box 997, Farmington, N.M.**

(Seal)