

Subject to administrative approval as injection well prior to injection.

## NEW MEXICO OIL CONSERVATION COMMISSION

## Well Location and Acreage Dedication Plat

## Section A.

Date 6-7-65

Operator WORLDWIDE PETROLEUM CORPORATION Lease Santa Fe  
 Well No. 3 Unit Letter B Section 19 Township 18 NORTH, Range 10 WEST, NMPM  
 Located 330 Feet From THE NORTH Line, 1650 Feet From THE EAST Line  
 County MCKINLEY G. L. Elevation 6537.8 Dedicated Acreage \_\_\_\_\_ Acres  
 Name of Producing Formation Monkton Pool \_\_\_\_\_

1. Is the Operator the only owner in the dedicated acreage outlined on the plat below?

Yes X No \_\_\_\_\_

2. If the answer to question one is "no", have the interests of all the owners been consolidated by communitization agreement or otherwise? Yes \_\_\_\_\_ No \_\_\_\_\_. If answer is "yes", Type of Consolidation.

3. If the answer to question two is "no", list all the owners and their respective interests below:

OwnerLand Description

\_\_\_\_\_  
 \_\_\_\_\_  
 \_\_\_\_\_

\_\_\_\_\_  
 \_\_\_\_\_  
 \_\_\_\_\_

RECEIVED

JUN 8 1965

OIL CON. COM.  
DIST. 3

## Section B.

This is to certify that the information  
 in Section A above is true and complete  
 to the best of my knowledge and belief.

Worldwide Petroleum Corp.

(Operator)

Clyde Phillips

(Representative)

4170 East Marion Ave.

(Address)

Denver 22, Colorado

Note: All distances must be from outer boundaries of section

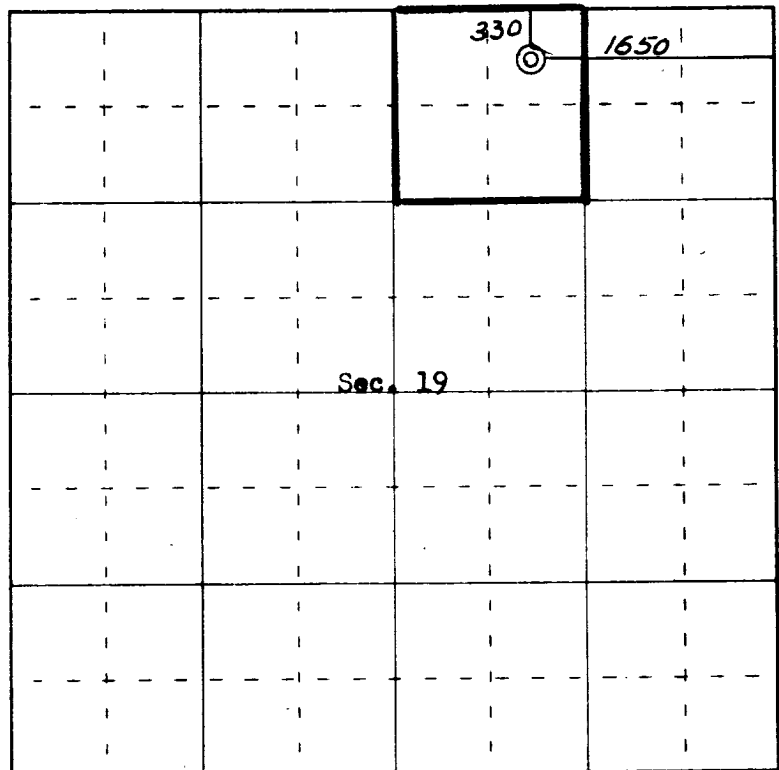

0 330 660 990 1320 1650 1980 2310 2640 2000 1500 1000 500 0

Scale 4 inches equal 1 mile

This is to certify that the above plat was prepared from field notes of actual surveys  
 made by me or under my supervision and that the same are true and correct to the best  
 of my knowledge and belief.

Date Surveyed June 5, 1965

James P. Leese  
 Registered Professional Engineer and/or Land Surveyor  
 James P. Leese, N. Mex. Reg. No. 1463

Farmington, New Mexico



