

(SUBMIT IN TRIPLICATE)

UNITED STATES
DEPARTMENT OF THE INTERIOR
GEOLOGICAL SURVEY

Land Office Santa Fe
Lease No. 001171-4
Unit _____

SUNDRY NOTICES AND REPORTS ON WELLS

NOTICE OF INTENTION TO DRILL	<input checked="" type="checkbox"/>	SUBSEQUENT REPORT OF WATER SHUT-OFF	
NOTICE OF INTENTION TO CHANGE PLANS		SUBSEQUENT REPORT OF SHOOTING OR ACIDIZING	
NOTICE OF INTENTION TO TEST WATER SHUT-OFF		SUBSEQUENT REPORT OF ALTERING CASING	
NOTICE OF INTENTION TO RE-DRILL OR REPAIR WELL		SUBSEQUENT REPORT OF RE-DRILLING OR REPAIR	
NOTICE OF INTENTION TO SHOOT OR ACIDIZE		SUBSEQUENT REPORT OF ABANDONMENT	
NOTICE OF INTENTION TO PULL OR ALTER CASING		SUPPLEMENTARY WELL HISTORY	
NOTICE OF INTENTION TO ABANDON WELL			

(INDICATE ABOVE BY CHECK MARK NATURE OF REPORT, NOTICE, OR OTHER DATA)

Clyde B. Harvey

October 13, 1961

Well No. 1-4 is located 1155 ft. from N line and 1105 ft. from E line of sec. 10

Sec. 10 (1/4 Sec. and Sec. No.) 10 (Range) 10 (Meridian)
Subdivision (Field) Subdivision (County) New Mexico or Territory)

The elevation of the surface above sea level is 6992 ft.

DETAILS OF WORK

(State names of and expected depths to objective sands; show sizes, weights, and lengths of proposed casings; indicate mudding jobs, cementing points, and all other important proposed work)

We intend to drill to a total depth of 1000' feet, unless production is reached at a lesser depth, in the Navajo formation. Will set 30' of 12-3/4" casing, cement circulated. Will set 1/2" casing if well is commercial. Will use rotary tools.

I understand that this plan of work must receive approval in writing by the Geological Survey before operations may be commenced.

Company J. I. Harvey

Address 435 Camino del Sol

Santa Fe, New Mexico

By James W. Collins

Title Representative

NEW MEXICO OIL CONSERVATION COMMISSION
Well Location and Acreage Dedication Plat

SECTION A.

Date _____

Operator James W. Rollins Lease State A. Henry, et al
 Well No. 244 Unit Letter 0 Section 33 Township 18 North Range 3 West NMPM
 Located 1155 Feet From South Line, 1485 Feet From East Line
 County Sandoval G. L. Elevation 6392 Dedicated Acreage 40 Acres
 Name of Producing Formation San Juan Pool San Luis ex

1. Is the Operator the only owner* in the dedicated acreage outlined on the plat below? Yes _____ No _____
2. If the answer to question One is "No," have the interests of all the owners been consolidated by communitization agreement or otherwise? Yes _____ No _____. If answer is "Yes," Type of Consolidation _____
3. If the answer to question Two is "No," list all the owners and their respective interests below:

OWNER

LAND DESCRIPTION

SECTION B.

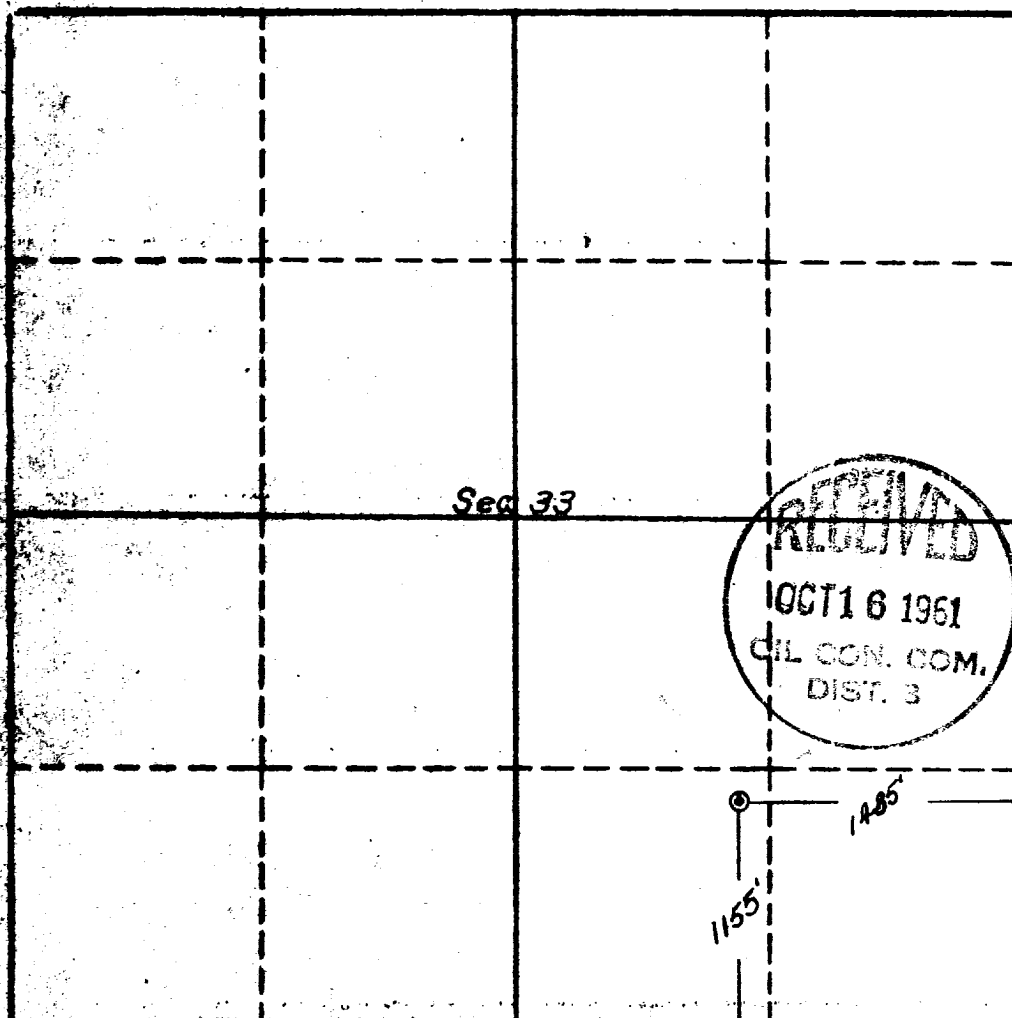

This is to certify that the information in Section A above is true and complete to the best of my knowledge and belief.

James W. Rollins

(OPERATOR)

James W. Rollins

(REPRESENTATIVE)

(ADDRESS)

This is to certify that the information shown on the plat in Section B was plotted from field notes of actual survey made by me or under my supervision and that the information is true and correct to the best of my knowledge and belief.

Date Surveyed Oct. 5, 1961

Four States Engineering Co.
FARMINGTON, NEW MEXICO

E. L. PotatREGISTERED ENGINEER OR
LAND SURVEYORCertificate No 3084

NEW MEXICO OIL CONSERVATION COMMISSION **Well Location and Acreage Dedication Plat**

SECTION A.

Date _____

Operator ~~INDIVIDUAL~~ J. I. Harvey Lease ~~State A. Harvey, et al~~ J. I. Harvey
 Well No. 1155 Unit Letter 0 Section 33 Township 18 North Range 3 West NMPM
 Located 1155 Feet From South Line, 1185 Feet From East Line
 County Sandoval G. L. Elevation 6392 Dedicated Acreage 40 Acres
 Name of Producing Formation Sandoval Pool ~~Undesignated~~ San Luis ex

1. Is the Operator the only owner* in the dedicated acreage outlined on the plat below? Yes _____ No _____
2. If the answer to question One is "No," have the interests of all the owners been consolidated by communization agreement or otherwise? Yes _____ No _____. If answer is "Yes," Type of Consolidation _____
3. If the answer to question Two is "No," list all the owners and their respective interests below

OWNER

LAND DESCRIPTION

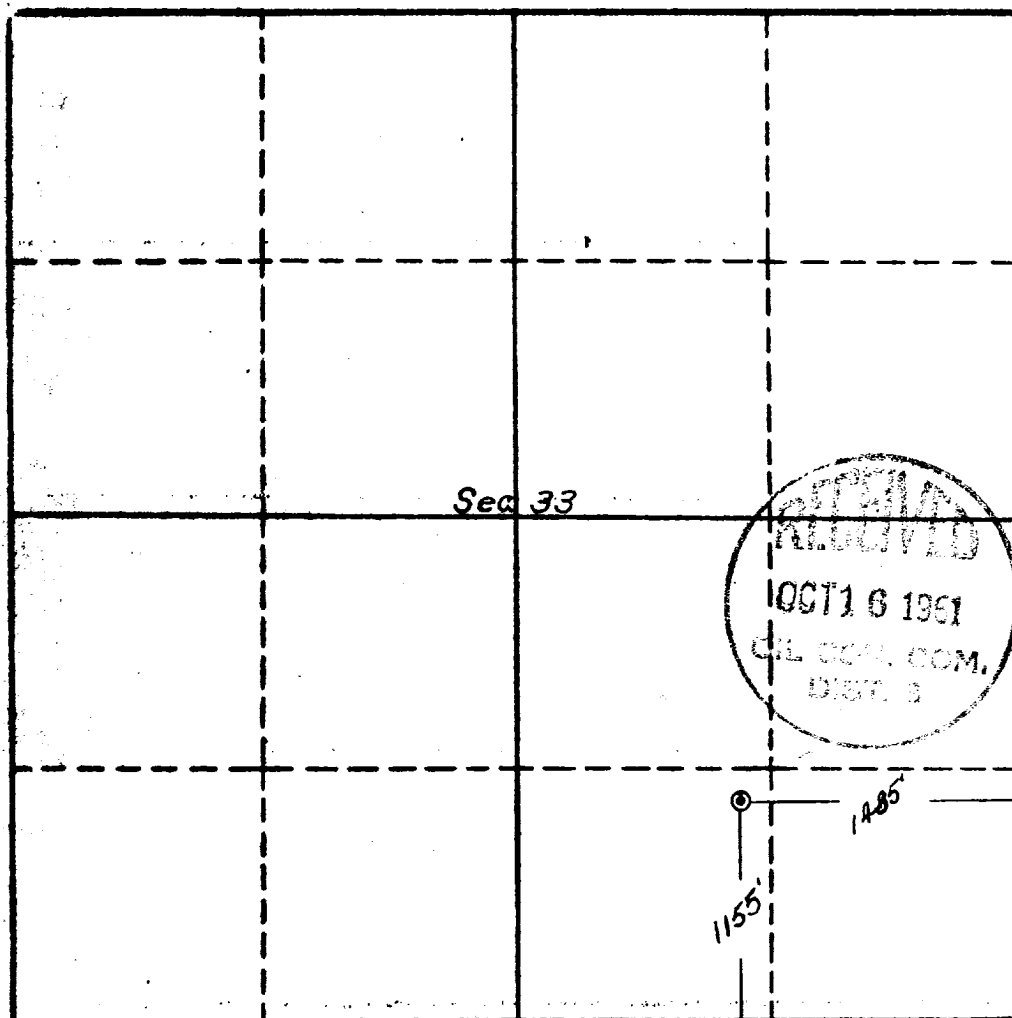
SECTION B.

This is to certify that the information in Section A above is true and complete to the best of my knowledge and belief.

J. I. Harvey

(OPERATOR)

James W. Rollins

(REPRESENTATIVE)

(ADDRESS)

This is to certify that the well location shown on the plat in Section B was plotted from field notes of a true survey made for and under my supervision and that the same is true and correct to the best of my knowledge and belief.

Date Surveyed Oct. 5, 1961

Four States Engineering Co.
 FARMINGTON, NEW MEXICO

E. L. Poter
 REGISTERED ENGINEER OR
 LAND SURVEYOR

Certificate No. 3084