

(SUBMIT IN TRIPLICATE)

UNITED STATES
DEPARTMENT OF THE INTERIOR
GEOLOGICAL SURVEY

Land Office Window Rock

Lease No. I-149 Ind. 7178

Unit SE/4

SUNDRY NOTICES AND REPORTS ON WELLS

NOTICE OF INTENTION TO DRILL	<input checked="" type="checkbox"/>	SUBSEQUENT REPORT OF WATER SHUT-OFF	
NOTICE OF INTENTION TO CHANGE PLANS		SUBSEQUENT REPORT OF SHOOTING OR ACIDIZING	
NOTICE OF INTENTION TO TEST WATER SHUT-OFF		SUBSEQUENT REPORT OF ALTERING CASING	
NOTICE OF INTENTION TO RE-DRILL OR REPAIR WELL		SUBSEQUENT REPORT OF RE-DRILLING OR REPAIR	
NOTICE OF INTENTION TO SHOOT OR ACIDIZE		SUBSEQUENT REPORT OF ABANDONMENT	
NOTICE OF INTENTION TO PULL OR ALTER CASING		SUPPLEMENTARY WELL HISTORY	
NOTICE OF INTENTION TO ABANDON WELL			

(INDICATE ABOVE BY CHECK MARK NATURE OF REPORT, NOTICE, OR OTHER DATA)

February 1, 1954

Well No. 6 Navajo is located 338 ft. from N line and 930 ft. from E line of sec. 36

SE/4, Sec. 36 22N 14W N.M.P.M.
(1/4 Sec. and Sec. No.) (Twp.) (Range) (Meridian)
Stony Butte San Juan New Mexico
(Field) (County or Subdivision) (State or Territory)

The elevation of the derrick floor above sea level is _____ ft.

DETAILS OF WORK

(State names of and expected depths to objective sands; show sizes, weights, and lengths of proposed casings; indicate mudding jobs, cementing points, and all other important proposed work)

It is proposed to drill a well to test the oil pay from the Allison member of the Mesaverde formation at a depth of approximately 350 feet. Well will be drilled with the use of cable tools, and the 5 $\frac{1}{2}$ -inch producing string will be cemented near the top of the pay should testing indicate favorable production for a commercial well.

I understand that this plan of work must receive approval in writing by the Geological Survey before operations may be commenced.

Company L. G. Stearns, et al

Address Aztec, New Mexico

By _____

Title Agent

Company..... L. G. STEARNS, et al.....

Lease..... Navajo..... Well No. 6.....

Sec. 36, T. 22 N., R. 14 W., N.M.P.....

Location 338' from the South line and 930' from the East line.

Elevation 6065, Graded ground.....

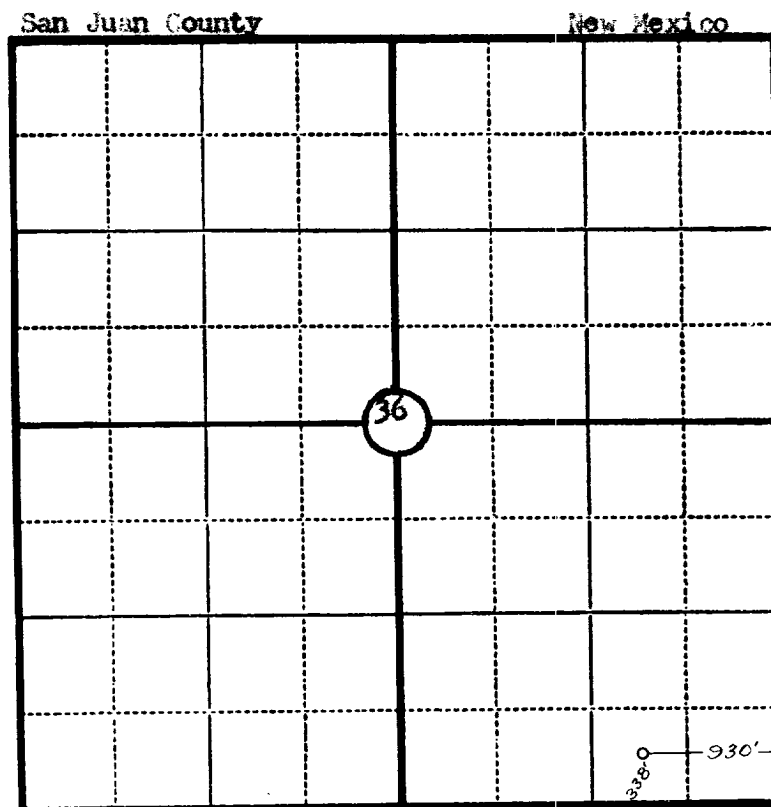

Scale—4 inches equal 1 mile.

This is to certify that the above plat was prepared from field notes of actual surveys made by me or under my supervision and that the same are true and correct to the best of my knowledge and belief.

Seal:

James P. Leese

Registered Professional Engineer and Land Surveyor. N. Mex. Reg. No. 1463

James P. Leese

Surveyed 26 January, 1954