

5 1506

1 Redfern 2 Hand (SUBMIT IN TRIPLICATE)

1 Pioneer Prod. LIMITED STARTED

1 Christiaan

1 741a DEPARTMENT OF THE INTERIOR

GEOLOGICAL SURVEY

Land Office ~~San Francisco~~-----

Lease No. **12010063**-----

Unit _____

SUNDRY NOTICES AND REPORTS ON WELLS

NOTICE OF INTENTION TO DRILL	<input checked="" type="checkbox"/>	SUBSEQUENT REPORT OF WATER SHUT-OFF
NOTICE OF INTENTION TO CHANGE PLANS		SUBSEQUENT REPORT OF SHOOTING OR ACIDIZING
NOTICE OF INTENTION TO TEST WATER SHUT-OFF		SUBSEQUENT REPORT OF ALTERING CASING
NOTICE OF INTENTION TO RE-DRILL OR REPAIR WELL		SUBSEQUENT REPORT OF RE-DRILLING OR REPAIR
NOTICE OF INTENTION TO SHOOT OR ACIDIZE		SUBSEQUENT REPORT OF ABANDONMENT
NOTICE OF INTENTION TO PULL OR ALTER CASING		SUPPLEMENTARY WELL HISTORY
NOTICE OF INTENTION TO ABANDON WELL		

(INDICATE ABOVE BY CHECK MARK NATURE OF REPORT, NOTICE, OR OTHER DATA)

April 22, 1962

Well No. 1-D is located 945 ft. from N line and 870 ft. from E line of sec. 21

SE/4 SE/4 Sec. 21 28N 11W 18M
(1/4 Sec. and Sec. No.) (Twp.) (Range) (Meridian)

Basin - Dakota San Juan New Mexico
(County of Subdivision) (State of Idaho)

The elevation of the ~~derrick floor~~^{ground} above sea level is 5807 ft.

DETAILS OF WORK

(State names of and expected depths to objective sands; show sizes, weights, and lengths of proposed casings; indicate mudding job, cementing points, and all other important proposed work)

Plan to drill a 12 1/8" hole to approx. 200' and run 8 5/8" Csg cemented with sufficient cement to circulate, approx. 125 sz. A 6 3/4" hole will then be drilled to a total depth of approximately 6300' and 4 1/2", 10.5# Csg will be run and cemented with sufficient cement to cover the Gallup formation. The Dakota formation will then be selectively perforated and sand, water fractured.

I understand that this plan of work must receive approval in writing by the Geological Survey before operations may be commenced.

Company Redfern & Hard, Inc.

Address 1007 N. Dustin

Farmington, New Mexico

Original signed by T. A. Dugan

By _____

Title Consulting Engineer

NEW MEXICO OIL CONSERVATION COMMISSION

Well Location and Acreage Dedication Plat

SECTION A.

Date April 12, 1962

Operator Redfern and Ford Lease Successor
Well No. 1 Unit Letter 3 Section 21 Township 28 North Range 11 West NMPM
Located 945 Feet From South Line, 870 Feet From East Line
County San Juan G. L. Elevation 5807 Dedicated Acreage 3.00 Acres
Name of Producing Formation Saltwater Pool Redfern

1. Is the Operator the only owner* in the dedicated acreage outlined on the plat below? Yes 1 No
2. If the answer to question One is "No," have the interests of all the owners been consolidated by communitization agreement or otherwise? Yes No If answer is "Yes," Type of Consolidation
3. If the answer to question Two is "No," list all the owners and their respective interests below:

OWNER

LAND DESCRIPTION

ILLEGIBLE

SECTION B.

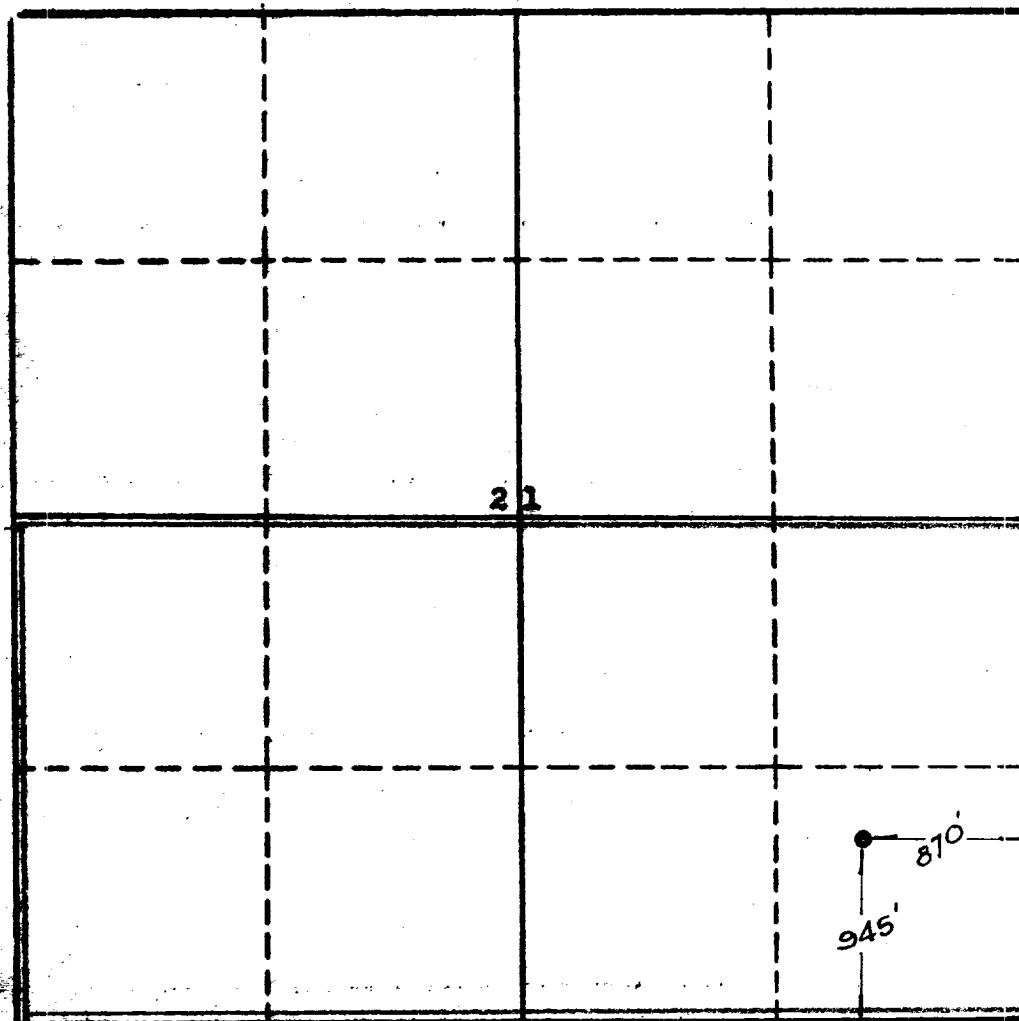

This is to certify that the information in Section A above is true and complete to the best of my knowledge and belief.

Redfern & Ford, Inc.
(OPERATOR)

Original signed by T. A. Dugan

(REPRESENTATIVE)

1807 E. Durkin
Farmington, New Mexico
(ADDRESS)

This is to certify that the well location shown on the plat in Section B was plotted from field notes of actual surveys made by me or under my supervision and that the same is true and correct to the best of my knowledge and belief.

Date Surveyed April 12, 1962
Four States Engineering Co.
FARMINGTON, NEW MEXICO

Emmett J. Caldwell
REGISTERED ENGINEER OR
LAND SURVEYOR

Certificate No. 3602

