

COPY TO O. G. C.

36-045-10614

X

STATE OF NEW MEXICO
OIL CONSERVATION
COMMISSION
DISTRICT NO. 3
Phone 99 P. O. Box 697
AZTEC, NEW MEXICO

(SUBMIT IN TRIPLICATE)

UNITED STATES
DEPARTMENT OF THE INTERIOR
GEOLOGICAL SURVEY

Santa Fe
Land Office 078243
Lease No. 1111 Sec. 20, 31N-12W.
Unit

RECEIVED

JAN 8 1953

SUNDRY NOTICES AND REPORTS ON WELLS

U. S. GEOLOGICAL SURVEY
FARMINGTON, N. M.

NOTICE OF INTENTION TO DRILL	SUBSEQUENT REPORT OF WATER SHUT-OFF
NOTICE OF INTENTION TO CHANGE PLANS	SUBSEQUENT REPORT OF SHOOTING OR ACIDIZING
NOTICE OF INTENTION TO TEST WATER SHUT-OFF	SUBSEQUENT REPORT OF ALTERING CASING
NOTICE OF INTENTION TO RE-DRILL OR REPAIR WELL	SUBSEQUENT REPORT OF REDRILLING OR REPAIR
NOTICE OF INTENTION TO SHOOT OR ACIDIZE	SUBSEQUENT REPORT OF ABANDONMENT
NOTICE OF INTENTION TO PULL OR ALTER CASING	SUPPLEMENTARY WELL HISTORY
NOTICE OF INTENTION TO ABANDON WELL	

(INDICATE ABOVE BY CHECK MARK NATURE OF REPORT, NOTICE, OR OTHER DATA)

January 5, 1953

Well No. 1 Over is located 990 ft. from [N] line and 1650 ft. from [E] line of sec. 20
[W] of Sec. 20 31 North 12 West N.M.P.M.
Wildcat (Field) San Juan County (County or Subdivision) New Mexico (State or Territory)

The elevation of the derrick floor above sea level is _____ ft. - To be furnished

DETAILS OF WORK

(State names of and expected depths to objective sands; show sizes, weights, and lengths of proposed casings; indicate mudding jobs, cementing points, and all other important proposed work)

The objective sand is the Pictured Cliffs, the top of which is expected at about 2400 feet.

The casing program is as follows: 150' of 8-5/8" O.D. cemented to surface
2400' of 5 1/2" O.D. cemented with 100 sacks.

Well will be drilled with rotary to top of Pictured Cliffs and 5 1/2" casing set.
Well will then be drilled in with cable tools to a total depth of about 2500'.

Well will be shot with approximately 300 quarts of nitro glycerine.

I understand that this plan of work must receive approval in writing by the Geological Survey before operations may be commenced.

Company SOUTHERN UNION GAS COMPANY

Address Bart Building

Dallas 1, Texas

By A. M. Wiederkehr
Title Reservoir Engineer

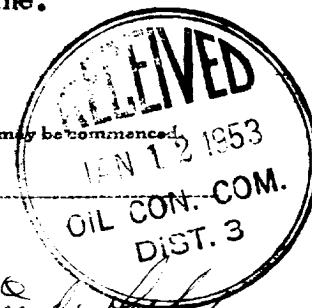

Company.....Southern Union Gas Company.....

Lease.....E. H. Owen.....Well No. 1.....

Sec. 20....., T. 31 N......, R. 12 W., N.M.P.M.....

Location 990' from the North line and 1650' from
the West line.

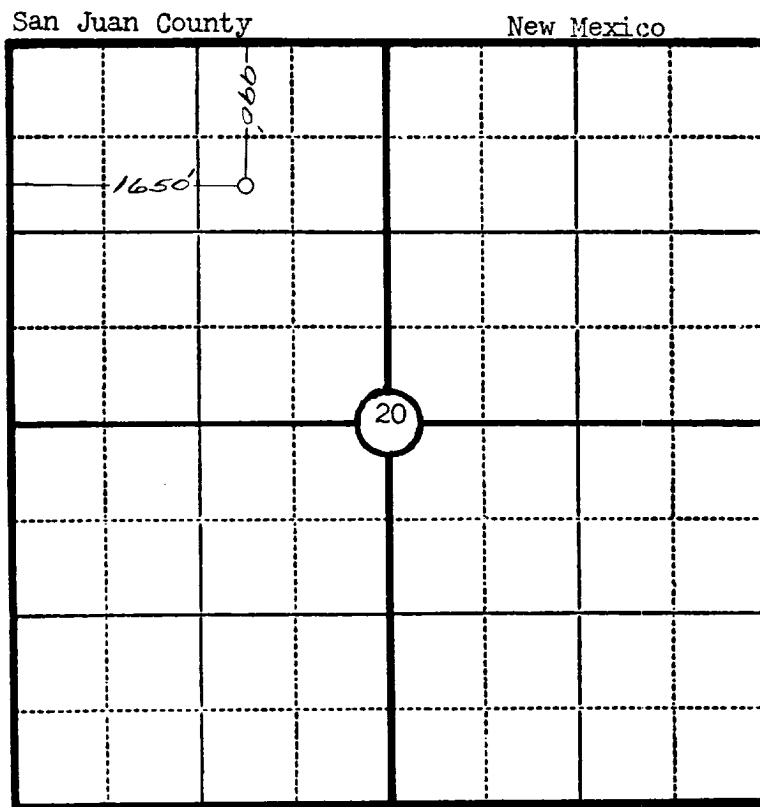

Scale—4 inches equal 1 mile.

This is to certify that the above plat was prepared from field notes of actual surveys made by me or under my supervision and that the same are true and correct to the best of my knowledge and belief.

Charles J. Finklea

Seal:

Registered Professional
Engineer and Land Surveyor.

RECEIVED

JAN 8 1953

U. S. GEOLOGICAL SURVEY
FARMINGTON, N. M.

Charles J. Finklea
Reg. No. 1302

Surveyed November 29

