

(SUBMIT IN TRIPLICATE)

UNITED STATES  
DEPARTMENT OF THE INTERIOR  
GEOLOGICAL SURVEY

Land Office **Santa Fe**  
Lease No. **SF 078765**  
Unit **Rosa Unit**

SUNDRY NOTICES AND REPORTS ON WELLS

NOTICE OF INTENTION TO DRILL	<input checked="" type="checkbox"/>	SUBSEQUENT REPORT OF WATER SHUT-OFF	
NOTICE OF INTENTION TO CHANGE PLANS		SUBSEQUENT REPORT OF SHOOTING OR ACIDIZING	
NOTICE OF INTENTION TO TEST WATER SHUT-OFF		SUBSEQUENT REPORT OF ALTERING CASING	
NOTICE OF INTENTION TO RE-DRILL OR REPAIR WELL		SUBSEQUENT REPORT OF RE-DRILLING OR REPAIR	
NOTICE OF INTENTION TO SHOOT OR ACIDIZE		SUBSEQUENT REPORT OF ABANDONMENT	
NOTICE OF INTENTION TO PULL OR ALTER CASING		SUPPLEMENTARY WELL HISTORY	
NOTICE OF INTENTION TO ABANDON WELL			

RECEIVED

JUL 31 1959

U.S. GEOLOGICAL SURVEY  
FARMINGTON, NEW MEXICO

(INDICATE ABOVE BY CHECK MARK NATURE OF REPORT, NOTICE, OR OTHER DATA)

Rosa Unit Farmington, New Mexico July 30, 1959

Well No. **35-5** is located **1850** ft. from **S** line and **1850** ft. from **W** line of sec. **5**  
SW/4 Section 5 T-31-N R-6-W N.M.P.M.  
(1/4 Sec. and Sec. No.) (Twp.) (Range) (Meridian)  
Undesignated Dakota San Juan New Mexico  
(Field) (County or Subdivision) (State or Territory)

The elevation of the derrick floor above sea level is \_\_\_\_\_ ft. (To be reported later.)

DETAILS OF WORK

(State names of and expected depths to objective sands; show sizes, weights, and lengths of proposed casings; indicate mudlogging jobs, cementing points, and all other important proposed work)

We propose to drill Rosa Unit 35-5 to an approximate total depth of 8300' with rotary tools to evaluate Mesaverde and Dakota prospects. Stimulation and completion will be as indicated upon reaching total depth.

The following casing program is proposed:

SIZE	DEPTH	CEMENT	REMARKS
13-3/8"	300'	—	Heat-circulate.
9-5/8"	3700'	220	41 gal cement.
7"	7960'		7" casing will be set on top of Dakota and cemented by stage method with tool set approximately 200' below base of Point lookout. First stage, sufficient cement to fill to stage tool and second stage sufficient cement to fill 300' above top of Cliffhouse.
5"	8300'		Heat - 5" liner will be set from 100' above casing set to total depth and cemented with sufficient cement to fill to hanger. (See reverse side.)

I understand that this plan of work must receive approval in writing by the Geological Survey before operations may be commenced.

Company **Pan American Petroleum Corporation**

Address **Box 487**

**Farmington, New Mexico**

Attn: **L. O. Speer, Jr.**

ORIGINAL SIGNED BY  
**R. M. Bauer, Jr.**

By \_\_\_\_\_  
Title **Area Engineer**



Copies of location plat are attached. A copy of any survey taken upon completion of well.

## NEW MEXICO OIL CONSERVATION COMMISSION

## Well Location and Acreage Dedication Plat

Section A.

Date JULY 28, 1959

Operator PAN AMERICAN PETROLEUM CORPORATION Lease ROSA UNIT  
 Well No. 35-5 Unit Letter K Section 5 Township 31 NORTH Range 6 WEST NMPM  
 Located 1850 Feet From THE SOUTH Line, 1850 Feet From THE WEST Line  
 County SAN JUAN G. L. Elevation 6333.4 Dedicated Acreage 350.16 Acres  
 Name of Producing Formation DAKOTA Pool UNDESIGNATED DAKOTA

1. Is the Operator the only owner in the dedicated acreage outlined on the plat below?  
 Yes \_\_\_\_\_ No X
2. If the answer to question one is "no", have the interests of all the owners been consolidated by communitization agreement or otherwise? Yes X No \_\_\_\_\_. If answer is "yes", Type of Consolidation,  
COMMITTED TO ROSA UNIT

3. If the answer to question two is "no", list all the owners and their respective interests below:

Owner

Land Description

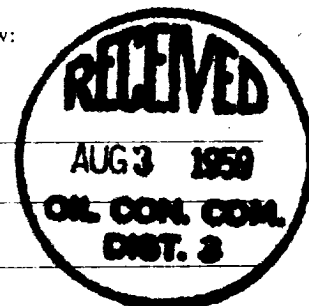

Section B.

This is to certify that the information in Section A above is true and complete to the best of my knowledge and belief.

PAN AMERICAN PETROLEUM CORPORATION

(Operator)

R. M. BAUER, JR. *RMBauer*

(Representative)

BOX 487, FARMINGTON, NEW MEXICO

(Address)

- Note: All distances must be from outer boundaries of section.
- (a) Pacific Northwest Pipeline Corporation as Unit Operator of the Rosa Unit included on the Plan of Development for 1959 two Dakota wildcats. Pacific Northwest has filed a temporary Designation of Agent for Pan American operations on these wells with regard to drilling, testing, and completing Mesaverde-Dakota dual formation tests.
- (b) Application for non-standard proration unit comprising 350.16 acres due to variation in the legal subdivision and size of section of the United States Public Land Survey will be filed at a subsequent date if commercial production is obtained.

Ref. G.L.O. Plat dated:  
August 27, 1919

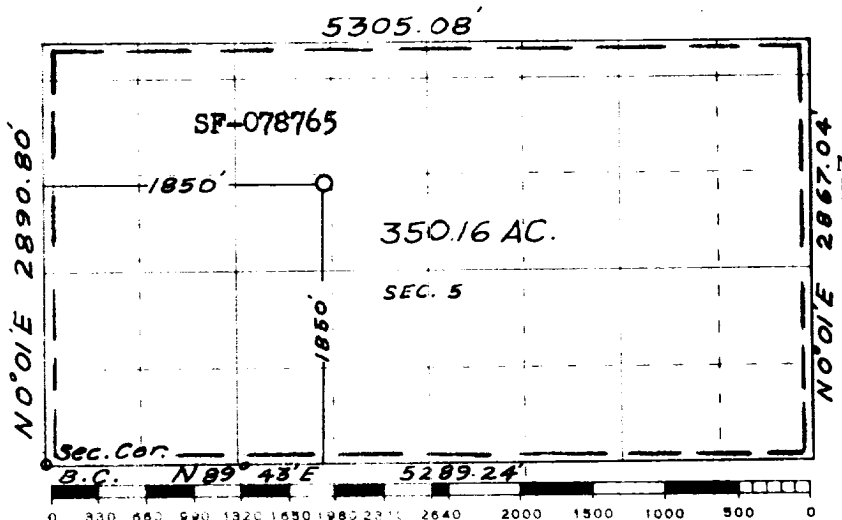

Scale 4 inches equal 1 mile



(Seal)

Farmington, New Mexico

This is to certify that the above plat was prepared from field notes of actual surveys made by me or under my supervision and that the same are true and correct to the best of my knowledge and belief.

Date Surveyed July 22, 1959

*James P. Lease*  
 Registered Professional Engineer and/or Land Surveyor  
 JAMES P. LEASE N. M. REG. NO. 1463