

Company.....Phillips Petroleum Company.....

Lease..... Well No.....

Sec.....22....., T.....32 N......, R.....7 W...... N.M.P.M.....

Location.....890' from the South line and 1650' from the West line......

Elevation.....6522 Ungraded ground......

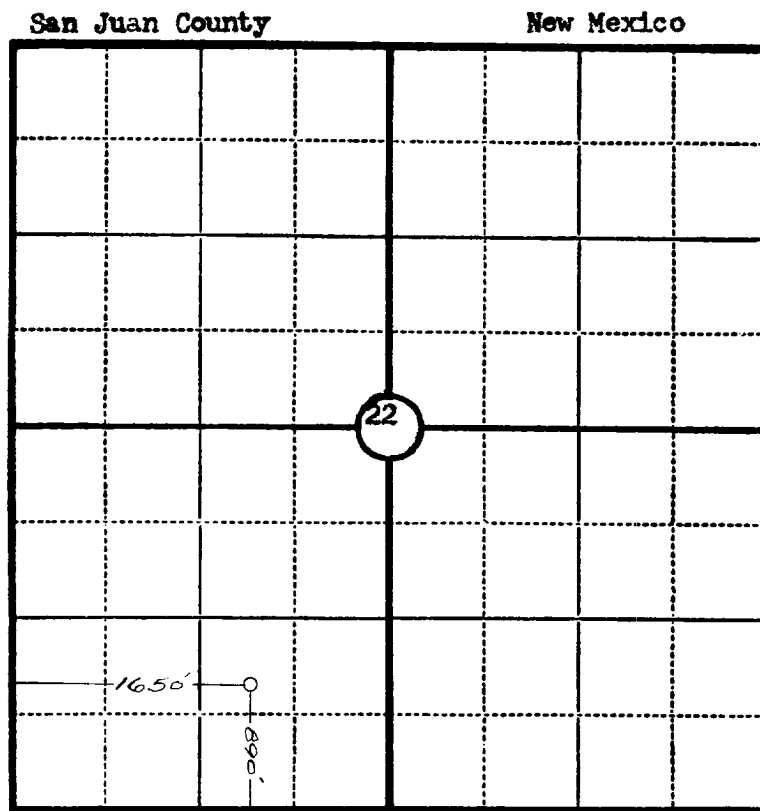

Scale—4 inches equal 1 mile.

This is to certify that the above plat was prepared from field notes of actual surveys made by me or under my supervision and that the same are true and correct to the best of my knowledge and belief.

Ernest V. Echohawk

Seal:

Registered Professional
Engineer and Land Surveyor.

Ernest V. Echohawk
N. Mex. Reg. No. 1545

SurveyedMay 22....., 19...53.....