

UNITED STATES
DEPARTMENT OF THE INTERIOR
GEOLOGICAL SURVEY

APPLICATION FOR PERMIT TO DRILL, DEEPEN, OR PLUG BACK

1a. TYPE OF WORK DRILL ☒ DEEPEN ☐ PLUG BACK ☐

b. TYPE OF WELL

OIL WELL ☐ GAS WELL ☒ OTHER ☐SINGLE ZONE ☒MULTIPLE ZONE ☐

2. NAME OF OPERATOR

AMOCO PRODUCTION COMPANY

3. ADDRESS OF OPERATOR

501 Airport Drive, Farmington, New Mexico 87401

4. LOCATION OF WELL (Report location clearly and in accordance with any State requirements.)

At surface

840' FSL and 1850' FWL

At proposed prod. zone

Same

Same

14. DISTANCE IN MILES AND DIRECTION FROM NEAREST TOWN OR POST OFFICE*

6 1/4 miles SE of Farmington, New Mexico

15. DISTANCE FROM PROPOSED*

LOCATION TO NEAREST
PROPERTY OR LEASE LINE, FT.

840'

(Also to nearest drilg. unit line, if any)

18. DISTANCE FROM PROPOSED LOCATION*
TO NEAREST WELL, DRILLING, COMPLETED
OR APPLIED FOR, ON THIS LEASE, FT.

2050'

16. NO. OF ACRES IN LEASE

320

17. NO. OF ACRES ASSIGNED
TO THIS WELL

W/ 320

19. PROPOSED DEPTH

6078'

20. ROTARY OR CABLE TOOLS

Rotary

21. ELEVATIONS (Show whether DF, RT, GR, etc.)

5551' GL

DRILLING OPERATIONS AUTHORIZED ARE
SUBJECT TO COMPLIANCE WITH ATTACHED
"GENERAL REQUIREMENTS"

22.

PROPOSED CASING AND CEMENTING PROGRAM

22. APPROX. DATE WORK WILL START*

As soon as permitted
This action is subject to administrative
appeal pursuant to 30 CFR 290.

SIZE OF HOLE	SIZE OF CASING	WEIGHT PER FOOT	SETTING DEPTH	QUANTITY OF CEMENT
12 1/4"	8 5/8" (New)	24# K-55	300'	300 sx Class "B" w/2% CaCl ₂ =circ.
7 7/8"	4 1/2" (New)	10.5# K-55	6078'	Stage 1-355 sx Class "B" 50/50 POZ 6% gel, 2# med tuf plug/sx, and 0.8% FLA. Tail in w/100 sx Class "B" Neat-circ. Stage 2-980 sx Class "B" 65/35 POZ, 6% gel, 2# med tuf plug/sx, and 0.8% FLA. Tail in w/100 sx Class "B" Neat-circ.

This application to drill an Infill Basin Dakota well is pursuant to Order No. R-1670-V approved by the NMOC on May 22, 1979. This well will qualify under Section 103 of the Natural Gas Policy Act under Order No. R-1670-V. The gas from this well is not dedicated to a gas sales Contract.

DV Tool Set at 3950'.

RECEIVED

JUN 14 1984

OIL CON. DIV.

DIST. 3

23. ADVISE SERVICE CONCERNING PROPOSED PROGRAM. If proposal is to deepen or plug back, give data on present productive zone and proposed new productive zone. If proposal is to drill or deepen directionally, give pertinent data on subsurface locations and measured and true vertical depths. Give blowout prevention program, if any.

24. Original Signed By
D. H. SHOEMAKER

SIGNED

TITLE District Engineer

(This space for Federal or State office use)

PERMIT NO.

SECRETAL DATE

APPROVED BY

CONDITIONS OF APPROVAL, IF ANY

APPROVED

AS AMENDED

JUN 13 1984

DATE

AREA MANAGER
FARMINGTON RESOURCE AREA

NMOC

OIL CONSERVATION DIVISION

STATE OF NEW MEXICO
ENERGY AND MINERALS DEPARTMENT

P. O. BOX 2088

SANTA FE, NEW MEXICO 87501

Form C-107
Revised 10-1-78

All distances must be from the outer boundaries of the Section.

Operator AMOCO PRODUCTION COMPANY			Lease GALLEGOS CANYON UNIT		Well No. 241E
Unit Letter N	Section 29	Township 28N	Range 12W	County SAN JUAN	
Actual Footage Location of Well:					
840	feet from the	South	line and	1350	feet from the West line
Ground Level Elev: 5551	Producing Formation Dakota		Pool Basin Dakota		Dedicated Acreage: 320 Acres

1. Outline the acreage dedicated to the subject well by colored pencil or hachure marks on the plat below.
2. If more than one lease is dedicated to the well, outline each and identify the ownership thereof (both as to working interest and royalty).
3. If more than one lease of different ownership is dedicated to the well, have the interests of all owners been consolidated by communitization, unitization, force-pooling, etc?

☒ Yes ☐ No If answer is "yes," type of consolidation Unitization

If answer is "no," list the owners and tract descriptions which have actually been consolidated. (Use reverse side of this form if necessary.) _____

No allowable will be assigned to the well until all interests have been consolidated (by communitization, unitization, forced-pooling, or otherwise) or until a non-standard unit, eliminating such interests, has been approved by the Commission.

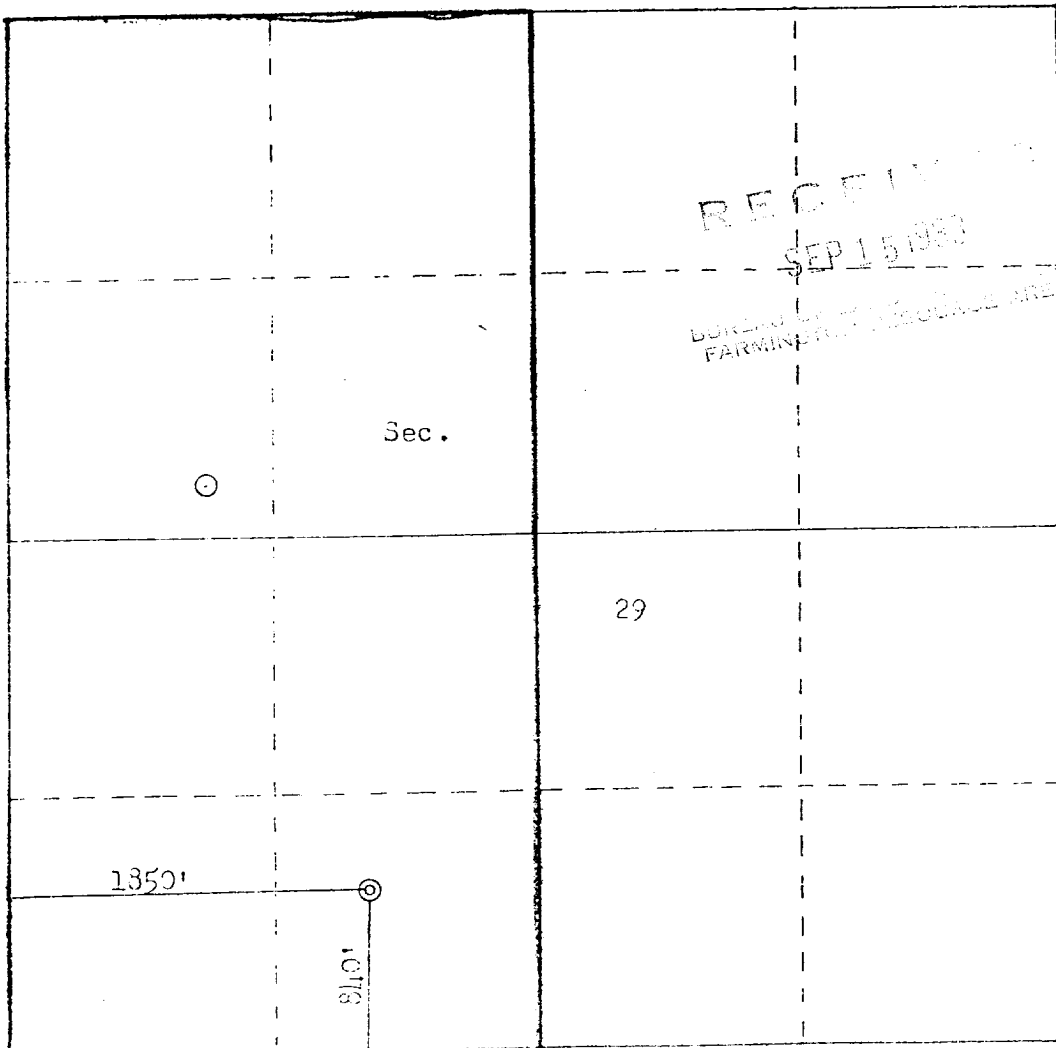

CERTIFICATION

I hereby certify that the information contained herein is true and complete to the best of my knowledge and belief.
D. H. SHOEMAKER

Name
D. H. Shoemaker
Position
DISTRICT ENGINEER
Company
AMOCO PRODUCTION COMPANY
Date
9/12/83

I hereby certify that the well location shown on this plat was plotted from field notes of actual surveys made by me or under my supervision, and that the same is true and correct to the best of my knowledge and belief.

Date Surveyed
January 20, 1981
Registered Professional Engineer
and Land Surveyor
Fred B. Kerr Jr.
Certificate No.
3950

Scale: 1"=1000'

