

UNITED STATES  
DEPARTMENT OF THE INTERIOR  
GEOLOGICAL SURVEY

## APPLICATION FOR PERMIT TO DRILL, DEEPEN, OR PLUG BACK

## 1a. TYPE OF WORK

DRILL ☒DEEPEN ☐PLUG BACK ☐

## b. TYPE OF WELL

OIL  
WELL ☐GAS  
WELL ☒

OTHER

SINGLE  
ZONE ☒MULTIPLE  
ZONE ☐

## 2. NAME OF OPERATOR

Tenneco Oil Company

## 3. ADDRESS OF OPERATOR

P.O. Box 3249, Englewood, CO 80155

## 4. LOCATION OF WELL (Report location clearly and in accordance with any State requirements.)\*

At surface

SW/4 Sec. 26, 1154' FWL, 1443' FSL

At proposed prod. zone

Same

## 14. DISTANCE IN MILES AND DIRECTION FROM NEAREST TOWN OR POST OFFICE\*

3 miles SE of Archuleta

## 15. DISTANCE FROM PROPOSED\*

LOCATION TO NEAREST  
PROPERTY OR LEASE LINE, FT.  
(Also to nearest drlg. unit line, if any)

1154'

18. DISTANCE FROM PROPOSED LOCATION\*  
TO NEAREST WELL, DRILLING, COMPLETED,  
OR APPLIED FOR, ON THIS LEASE, FT.

350'

## 16. NO. OF ACRES IN LEASE

2549.29

## 19. PROPOSED DEPTH

2750'

17. NO. OF ACRES ASSIGNED  
TO THIS WELL

320

## 20. ROTARY OR CABLE TOOLS

Rotary

## 21. ELEVATIONS (Show whether DF, RT, GR, etc.)

5914' GR

DRILLING OPERATIONS AUTHORIZED ARE  
SUBJECT TO COMPLIANCE WITH ATTACHED  
"GENERAL REQUIREMENTS"

## 22. APPROX. DATE WORK WILL START\*

8/26/88

## 23.

## PROPOSED CASING AND CEMENTING PROGRAM

This action is subject to technical and  
procedural review pursuant to 43 CFR 3165.3  
and appeal pursuant to 43 CFR 3165.4.

SIZE OF HOLE	SIZE OF CASING	WEIGHT PER FOOT	SETTING DEPTH	QUANTITY OF CEMENT
12 1/4"	9 5/8"	36#	± 200	200 cu.ft. - Circ. to Surface
8 3/4"	7"	23#	±2300	675 cu.ft. - Circ. to Surface
6 1/2"	5 1/2" Liner	23#	±2200-2750	None

See Attached Drilling Procedure.

See Item 1.B in Surface Use Plan and Map 2 for BLM Right-of-Way Application.

RECEIVED  
AUG 18 1988  
OIL CON. DIV  
DIST. 3

IN ABOVE SPACE DESCRIBE PROPOSED PROGRAM: If proposal is to deepen or plug back, give data on present productive zone and proposed new productive zone. If proposal is to drill or deepen directionally, give pertinent data on subsurface locations and measured and true vertical depths. Give blowout preventer program, if any.

24.

SIGNED

Larry Bell

TITLE Administrative Supervisor

DATE 7/5/88

(This space for Federal or State office use)

PERMIT NO.

APPROVAL DATE

APPROVED BY

TITLE

CONDITIONS OF APPROVAL, IF ANY:

APPROVED  
AS AEA  
DATE  
8/15/88  
R. L. L. L.

NMCCO

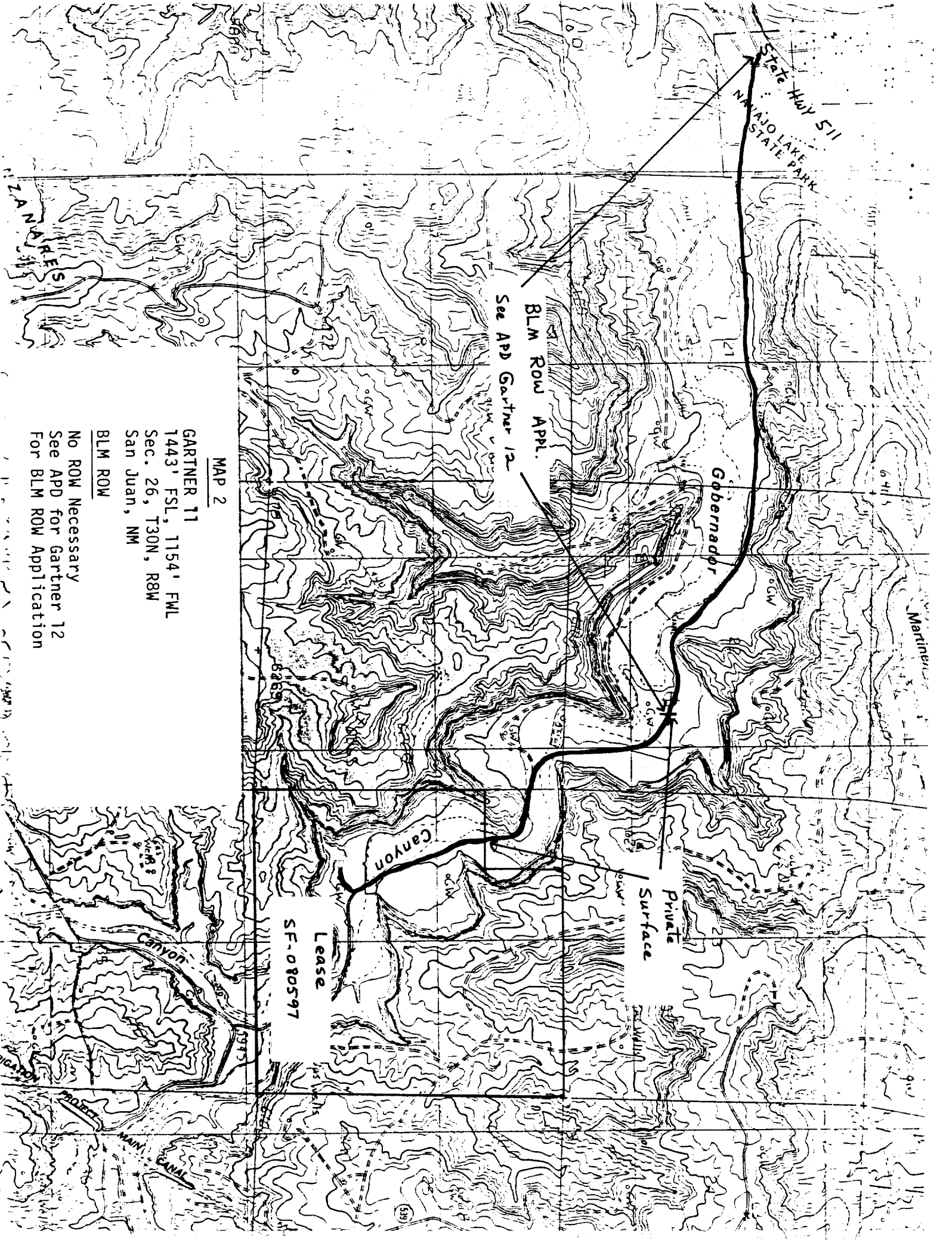

State Hwy 511  
NIAJALO LAKE  
STATE PARK

Gobernador

Martinez

Surface  
Private

Canyon

Lease

SF-080597

MAP 2

GARTNER 11  
1443' FSL, 1154' FWL  
Sec. 26, T30N, R8W  
San Juan, NM

BLM ROW

No ROW Necessary  
See APD for Gartner 12  
For BLM ROW Application

See APD Gartner 12  
BLM ROW APPL.

ZANADES