

UNITED STATES  
DEPARTMENT OF THE INTERIOR  
GEOLOGICAL SURVEY

APPLICATION FOR PERMIT TO DRILL, DEEPEN, OR PLUG BACK

1a. TYPE OF WORK

DRILL ☒

DEEPEN ☐

PLUG BACK ☐

b. TYPE OF WELL

OIL  
WELL ☐

GAS  
WELL ☒

OTHER

SINGLE  
ZONE ☒

MULTIPLE  
ZONE ☐

2. NAME OF OPERATOR

Tenneco Oil Company

3. ADDRESS OF OPERATOR

P.O. Box 3249, Englewood, CO 80155

4. LOCATION OF WELL (Report location clearly and in accordance with any State requirements.)

At surface

1105' FSL, 1117' FEL

At proposed prod. zone

Same as above

14. DISTANCE IN MILES AND DIRECTION FROM NEAREST TOWN OR POST OFFICE\*

5 1/2 miles east of Turley, NM

15. DISTANCE FROM PROPOSED\*

LOCATION TO NEAREST  
PROPERTY OR LEASE LINE, FT.  
(Also to nearest drig. unit line, if any)

1105'

16. NO. OF ACRES IN LEASE

2549.29

17. NO. OF ACRES ASSIGNED  
TO THIS WELL

320 160

18. DISTANCE FROM PROPOSED LOCATION\*  
TO NEAREST WELL, DRILLING, COMPLETED,  
OR APPLIED FOR, ON THIS LEASE, FT.

741'

19. PROPOSED DEPTH

2845'

20. ROTARY OR CABLE TOOLS

Rotary

21. ELEVATIONS (Show whether DF, RT, GR, etc.)

6138' GL

DRILLING OPERATIONS AUTHORIZED ARE  
SUBJECT TO COMPLIANCE WITH ATTACHED

22. APPROX. DATE WORK WILL START\*

ASAP

23.

PROPOSED CASING AND CEMENTING PROGRAM

This action is subject to technical and  
procedural review pursuant to 43 CFR 3165.3  
and appeal pursuant to 43 CFR 3165.4.

SIZE OF HOLE	SIZE OF CASING	WEIGHT PER FOOT	SETTING DEPTH	QUANTITY OF CEMENT
12 1/4"	9 5/8"	36#	± 200'	
8 3/4"	7"	23#	±2404'	
6 1/2"	5 1/2"	23#	±2845'	

See attached Drilling Procedure.

RECEIVED

SEP 26 1988

OIL CON. DIV.  
DIST. 3

IN ABOVE SPACE DESCRIBE PROPOSED PROGRAM: If proposal is to deepen or plug back, give data on present productive zone and proposed new productive zone. If proposal is to drill or deepen directionally, give pertinent data on subsurface locations and measured and true vertical depths. Give blowout preventer program, if any.

24.

SIGNED Niles V. Jokela

TITLE Staff Analyst

DATE 8/18/88

(This space for Federal or State office use)

PERMIT NO. \_\_\_\_\_

APPROVAL DATE \_\_\_\_\_

APPROVED BY \_\_\_\_\_

CONDITIONS OF APPROVAL, IF ANY:

TITLE \_\_\_\_\_

APPROVED *ick*  
AS AMENDED

DATE

SEP 23 1988

*James E. Edwards Jr.*  
AREA MANAGER

*OK*

Supersedeas *granted*  
 Judgment *affirmed*

Operator TENNECO OIL COMPANY		Lease GARTNER		Well No. 16	
Unit Letter P	Section 28	Township 30 N	Range 8 W	County SAN JUAN	
Actual Footage Location of Well:					
1105		feet from the South line and		1117 feet from the East line	
Ground Level Elev. 6138	Producing Formation Blanco		Pool Fruitland Coal		Dedicated Acreage: 320 Acres

- No allowable will be assigned to the well until all interests have been consolidated (by communitization, unitization, forced-pooling, or otherwise) or until a non-standard unit, eliminating such interests, has been approved by the Commission.

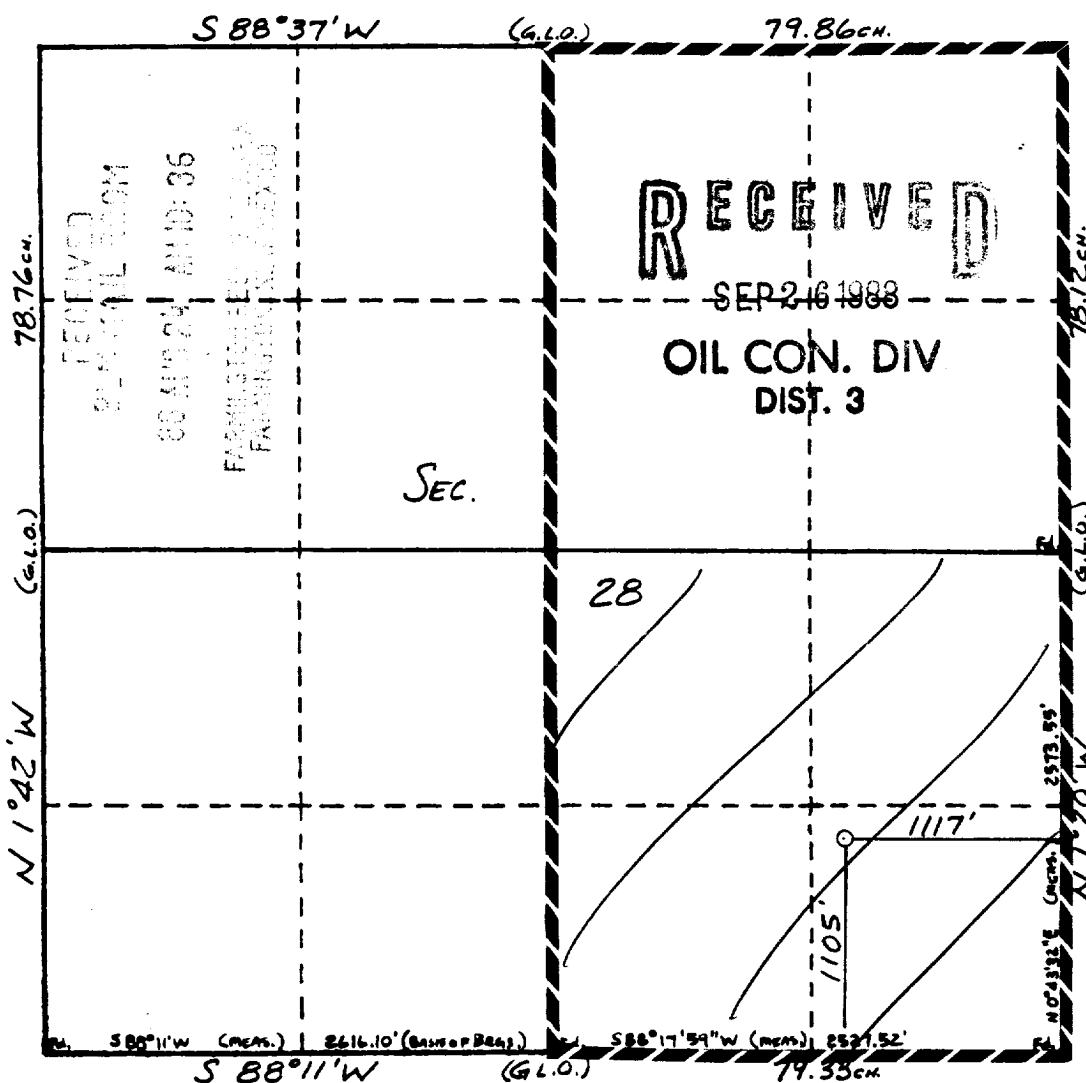

Date Surveyed \_\_\_\_\_  
 Registered Professional Engineer  
 and Land Surveyor #3466  
 Certificate No. \_\_\_\_\_

FORM 24-11