

(SUBMIT IN TRIPLICATE)

UNITED STATES
DEPARTMENT OF THE INTERIOR
GEOLOGICAL SURVEY

Land Office **USA - 078056**
Lease No. _____
Unit **K**

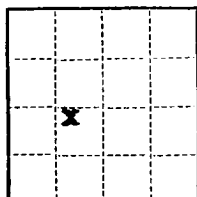

SUNDRY NOTICES AND REPORTS ON WELLS

NOTICE OF INTENTION TO DRILL	<input checked="" type="checkbox"/>	SUBSEQUENT REPORT OF WATER SHUT-OFF	
NOTICE OF INTENTION TO CHANGE PLANS		SUBSEQUENT REPORT OF SHOOTING OR ACIDIZING	
NOTICE OF INTENTION TO TEST WATER SHUT-OFF		SUBSEQUENT REPORT OF ALTERING CASING	
NOTICE OF INTENTION TO RE-DRILL OR REPAIR WELL		SUBSEQUENT REPORT OF RE-DRILLING OR REPAIR	
NOTICE OF INTENTION TO SHOOT OR ACIDIZE		SUBSEQUENT REPORT OF ABANDONMENT	
NOTICE OF INTENTION TO PULL OR ALTER CASING		SUPPLEMENTARY WELL HISTORY	
NOTICE OF INTENTION TO ABANDON WELL			

(INDICATE ABOVE BY CHECK MARK NATURE OF REPORT, NOTICE, OR OTHER DATA)

May 23, 1956

N. M. Federal "C" Lease

Well No. 8 is located 1980 ft. from N line and 1980 ft. from E line of sec. 31

NE/4 of SW/4 26N 12W New Mexico
(1/4 Sec. and Sec. No.) (Twp.) (Range) (Meridian)
Bisti-Gallup San Juan
(Field) (County or Subdivision) (State or Territory)

The elevation of the ~~drill hole~~ ^{ground} above sea level is 6134 ft.

DETAILS OF WORK

(State names of and expected depths to objective sands; show sizes, weights, and lengths of proposed casings; indicate mudding jobs, cementing points, and all other important proposed work)

We propose to drill this well with rotary tools to a sufficient depth to test the Gallup Sand expected at 4650'.

We propose to set 200' of 905/8" OD 32.30# J-55 surface casing and cement to surface.

We propose to drill through the Gallup Sand section to a depth of approximately 5000' and if productive, to set 7" OD casing through the zone. We intend to use scratchers and centralizers and enough cement to cement at least 300' above the top of the pay zone.

We propose to gun perforate the casing and sand oil frac the formation during completion.

I understand that this plan of work must receive approval in writing by the Geological Survey before operations may be commenced.

Company Sunray Mid-Continent Oil Company

Address Box 128

Hobbs, New Mexico

By J. A. Paery
Title Hobbs Area Superintendent

NEW MEXICO
OIL CONSERVATION COMMISSION

Form C-128

Well Location and/or Gas Proration Plat

Date **May 23, 1956**

Operator **Sunray Mid-Continent Oil Company**

Lease **N. M. Federal "C"**

Well No. **Fed. C # 8** Section **31** Township **26 North** Range **12 West** NMPM

Located **1980** Feet From **South** Line, **1980** Feet From **West** Line,

San Juan County, New Mexico. G. L. Elevation **6134**

Name of Producing Formation **Gallup Sand** Pool **Bisti-Gallup** Dedicated Acreage **40**

(Note: All distances must be from outer boundaries of Section)

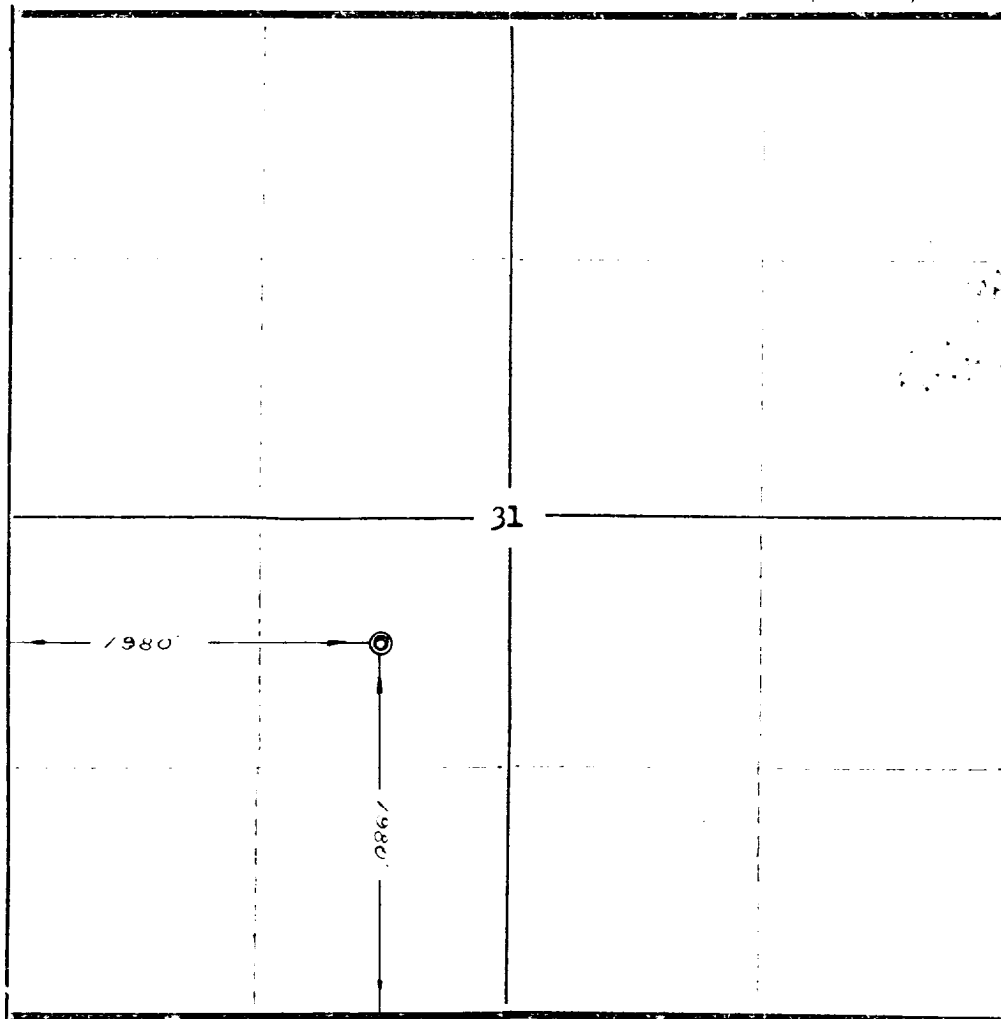

NOTE

This section of form is to be used for gas wells only.

SCALE: 1" 1000'

1. Is this Well a Dual Comp. ? Yes No **X**
2. If the answer to Question 1 is yes, are there any other dually completed wells within the dedicated acreage?

Yes No

Name **J. A. Parry**
Position **Hobbs Area Superintendent**
Representing **Sunray Mid-Continent Oil Co.**
Address **Box 128 - Hobbs, New Mexico**

This is to certify that the above plat was prepared from field notes of actual surveys made by me or under my supervision and that the same are true and correct to the best of my knowledge and belief.

Date Surveyed **May 16, 1956**

Ernest V. Echobawk
Ernest V. Echobawk
Reg. Land Surveyor, N. Mex., Reg. No. 1545