

(SUBMIT IN TRIPLICATE)

UNITED STATES  
DEPARTMENT OF THE INTERIOR  
GEOLOGICAL SURVEY

Land Office Santa Fe  
Lease No. 078046  
Unit Rugheo

SUNDRY NOTICES AND REPORTS ON WELLS

NOTICE OF INTENTION TO DRILL	<input checked="" type="checkbox"/>	SUBSEQUENT REPORT OF WATER SHUT-OFF	
NOTICE OF INTENTION TO CHANGE PLANS		SUBSEQUENT REPORT OF SHOOTING OR ACIDIZING	
NOTICE OF INTENTION TO TEST WATER SHUT-OFF		SUBSEQUENT REPORT OF ALTERING CASING	
NOTICE OF INTENTION TO RE-DRILL OR REPAIR WELL		SUBSEQUENT REPORT OF RE-DRILLING OR REPAIR	
NOTICE OF INTENTION TO SHOOT OR ACIDIZE		SUBSEQUENT REPORT OF ABANDONMENT	
NOTICE OF INTENTION TO PULL OR ALTER CASING		SUPPLEMENTARY WELL HISTORY	
NOTICE OF INTENTION TO ABANDON WELL			

(INDICATE ABOVE BY CHECK MARK NATURE OF REPORT, NOTICE, OR OTHER DATA)

Well No. 1-29 is located 1350 ft. from TH line and 790 ft. from W line of sec. 29  
SW/4 of Sec. 29 29N 8W MTM  
 (1/4 Sec. and Sec. No.) (Twp.) (Range) (Meridian)  
Basin Dakota San Juan New Mexico  
 (Field) (County or Subdivision) (State or Territory)

The elevation of the derrick floor above sea level is 6441 ft.

DETAILS OF WORK

(State names of and expected depths to objective sands; show sizes, weights, and lengths of proposed casings; indicate mudlogging jobs, cementing points, and all other important proposed work)

It is intended to drill a well with rotary tools thru the Dakota formation. Mud circulation will be used thru 100' of Lewis and set 7-5/8" intermediate casing. Gas circulation will be used thru the Dakota and set 4-1/2" casing. Possible productive Dakota intervals will be perforated and fractured. Estimated Depth 7550'

Casing Program:

10-3/4" Surface @ 175' w/150 sks cement to surface  
 7-5/8" @ 3200' w/200 sks cement  
 4-1/2" @ 7550' w/100 sks 40 % Balical "D" followed by 50 sks 2% gel cement.

The W/2 of Sec. 29 is dedicated to this well.

I understand that this plan of work must receive approval in writing by the Geological Survey before operations may be commenced.

Company DELHI-TAYLOR OIL CORPORATION

Address P. O. Box 1198

Farmington, New Mexico

Original signed  
by E. W. Guyon

By E. W. Guyon  
Title District Engineer

## NEW MEXICO OIL CONSERVATION COMMISSION

## Well Location and Acreage Dedication Plat

Section A.

Date September 26, 1962

Operator DELHI TAYLOR OIL CORPORATION Lease HUGHES  
 Well No. 1 - 29 Unit Letter L Section 29 Township 29 NORTH Range 8 WEST NMPM  
 Located 1350' Feet From the SOUTH Line, 790' Feet From the WEST Line  
 County SAN JUAN G. L. Elevation 6423.0' Dedicated Acreage 320 Acres  
 Name of Producing Formation Santa Fe Pool main school

1. Is the Operator the only owner in the dedicated acreage outlined on the plat below?  
 Yes XXX No \_\_\_\_\_
2. If the answer to question one is "no", have the interests of all the owners been consolidated by communitization agreement or otherwise? Yes \_\_\_\_\_ No \_\_\_\_\_ If answer is "yes", Type of Consolidation.
3. If the answer to question two is "no", list all the owners and their respective interests below:

Owner

Land Description

RECEIVED

RECEIVED

SEP 27 1962

SEP 27 1962

OIL CON. COM.  
DIST. 3U. S. GEOLOGICAL SURVEY  
FARMINGTON, NEW MEXICO

## Section B.

This is to certify that the information in Section A above is true and complete to the best of my knowledge and belief.

Delhi-Taylor Oil Corporation

(Operator)

(Representative)

G. A. Ford

(Address)

P. O. Drawer 1198

Farmington, New Mexico

Ref: BLM plat dated 18 April 1958

Note: All distances must be from outer boundaries of section.

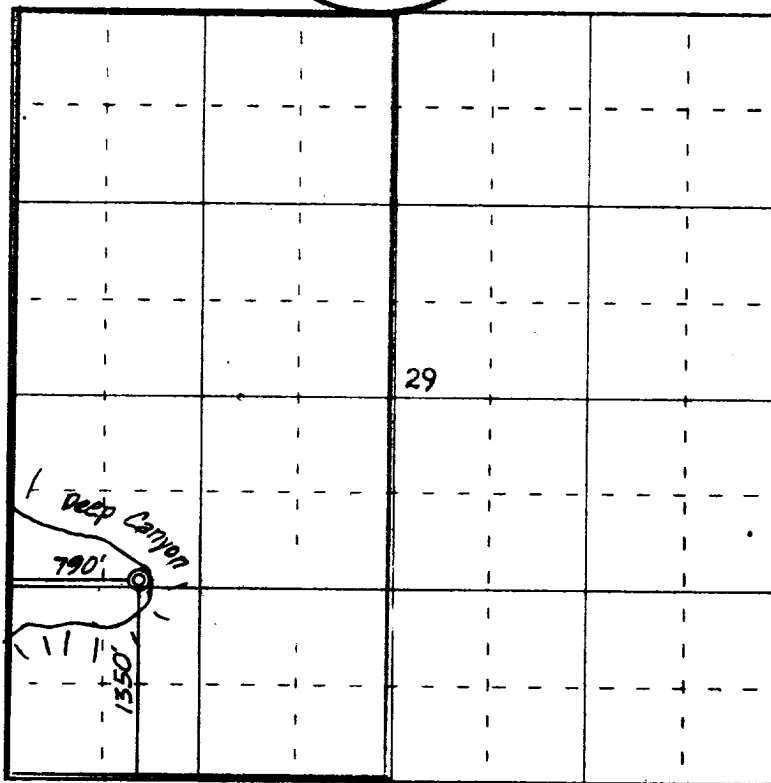

0 330 660 990 1320 1650 1980 2310 2640 2000 1800 1600 1400 1200 1000 800 600 400 200 0

Scale 4 inches equal 1 mile



(Seal)

Farmington, New Mexico

This is to certify that the above plat was prepared from field notes of actual surveys made by me or under my supervision and that the same are true and correct to the best of my knowledge and belief.

Date Surveyed 18 September 1962

Registered Professional Engineer and/or Land Surveyor  
 James P. Lease, N. Mex. Reg. No. 11,663