

(SUBMIT IN TRIPLICATE)

UNITED STATES
DEPARTMENT OF THE INTERIOR
GEOLOGICAL SURVEY

Land Office **Santa Fe**
Lease No. **078049**
Unit **Highway**

SUNDRY NOTICES AND REPORTS ON WELLS

NOTICE OF INTENTION TO DRILL	<input checked="" type="checkbox"/>	SUBSEQUENT REPORT OF WATER SHUT-OFF	
NOTICE OF INTENTION TO CHANGE PLANS		SUBSEQUENT REPORT OF SHOOTING OR ACIDIZING	
NOTICE OF INTENTION TO TEST WATER SHUT-OFF		SUBSEQUENT REPORT OF ALTERING CASING	
NOTICE OF INTENTION TO RE-DRILL OR REPAIR WELL		SUBSEQUENT REPORT OF RE-DRILLING OR REPAIR	
NOTICE OF INTENTION TO SHOOT OR ACIDIZE		SUBSEQUENT REPORT OF ABANDONMENT	
NOTICE OF INTENTION TO PULL OR ALTER CASING		SUPPLEMENTARY WELL HISTORY	
NOTICE OF INTENTION TO ABANDON WELL			

(INDICATE ABOVE BY CHECK MARK NATURE OF REPORT, NOTICE, OR OTHER DATA)

September 10, 1962

Well No. **2-33** is located ¹⁰¹⁷~~1150~~ ft. from **N** line and ¹⁰²⁰~~1150~~ ft. from **E** line of sec. **33**
NE/4 Sec. 33 **29 N** **8W** **MRM**
(1/4 Sec. and Sec. No.) (Twp.) (Range) (Meridian)
Basin **San Juan** **New Mexico**
(Field) (County or Subdivision) (State or Territory)

The elevation of the derrick floor above sea level is **6413** ft.

DETAILS OF WORK

(State names of and expected depths to objective sands; show sizes, weights, and lengths of proposed casings; indicate mudding jobs, cementing points, and all other important proposed work)

It is intended to drill a well with rotary tools thru the Dakota formation. Mud circulation will be used thru 100' of Lewis and set 7-5/8" intermediate casing. Gas circulation will be used thru the Dakota and set 4-1/2" casing. Possible productive Dakota intervals will be perforated and fractured. Estimated Total Depth 7340'

Casing Program:

10-3/4" Surface @ 170' w/140 lbs cement to surface
 7-5/8" @ 3200' w/200 lbs cement
 4-1/2" @ 7340' w/100 lbs 40% Biscel 'D' followed by 50 lbs 2% gal cement

The E/2 of Sec. 33 is dedicated to this well.

I understand that this plan of work must receive approval in writing by the Geological Survey before operations may be commenced.

Company **DELM-TAYLOR OIL CORPORATION**

Address **P. O. Box 2098 1198**

Farmington, New Mexico

Original signed
by E. W. Guyne

By **E. W. Guyne**
Title **District Engineer**

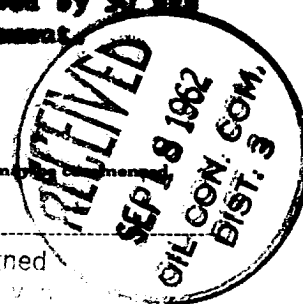

NEW MEXICO OIL CONSERVATION COMMISSION

el

edication

Section A.

Date September 13, 1962

Operator DELHI TAYLOR OIL CORPORATION Lease HUGHES SF 078049
 Well No. 2 - 33 Unit Letter A Section 33 Township 29 NORTH Range 8 WEST NMPM
 Located 1017 Feet From the NORTH Line, 1020 Feet From the EAST Line
 County SAN JUAN G. L. Elevation 6377.0 Dedicated Acreage 320 Acres
 Name of Producing Formation _____ Pool Basin Dakota

1. Is the Operator the only owner in the dedicated acreage outlined on the plat below?

Yes _____ No _____

2. If the answer to question one is "no", have the interests of all the owners been consolidated by communitization agreement or otherwise? Yes _____ No _____. If answer is "yes", Type of Consolidation.

3. If the answer to question two is "no", list all the owners and their respective interests below:

Owner

Land Description

RECEIVED
 SEP 17 1962

Section B.

This is to certify that the information
 in Section A above is true and complete
 to the best of my knowledge and belief.
Delhi-Taylor Oil Corporation

(Operator)

E. W. Gaym

(Representative)

E. W. Gaym

(Address)

P. O. Box 1198**Farmington, New Mexico**

Ref: GLO plat dated 23 June 1919

Note: All distances must be from outer boundaries of section.

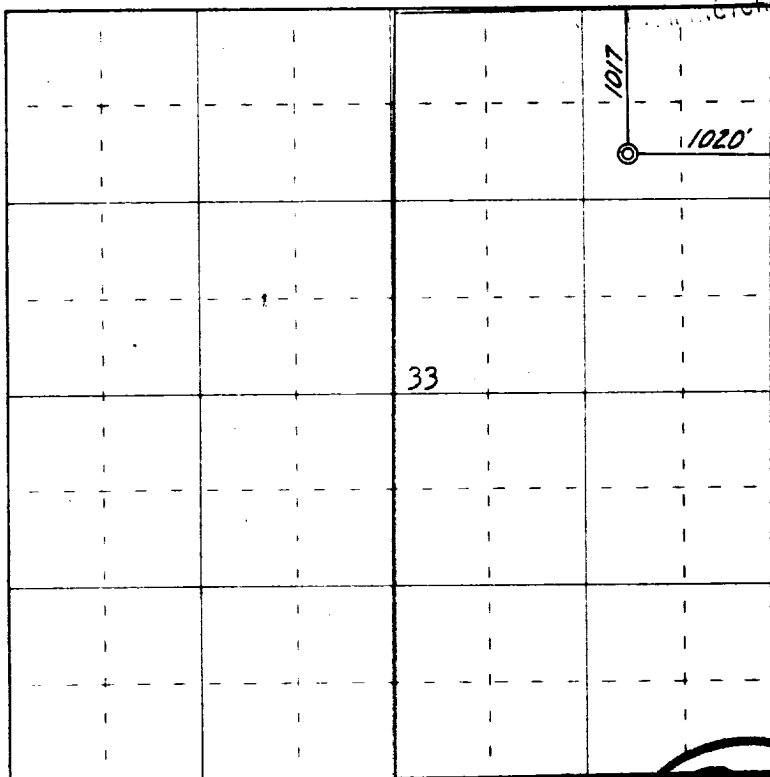

0 330 660 990 1320 1650 1980 2310 2640 2000 1500 1000 500 0

Scale 4 inches equal 1 mile

This is to certify that the above plat was prepared from field notes of _____
 made by me or under my supervision and that the same are true and correct to the best
 of my knowledge and belief.

(Seal)

Date Surveyed 13 September 1962

James P. Lane
 Registered Professional Engineer and/or Land Surveyor
 James P. Lane, N. Mex. Reg. No. 1463

Farmington, New Mexico