

ILLEGIBLE

	X	

(SUBMIT IN TRIPLICATE)

UNITED STATES
DEPARTMENT OF THE INTERIOR
GEOLOGICAL SURVEY

Land Office Santa Fe
Lease No. SP 077092-3
Unit Houck Gas Unit B

SUNDRY NOTICES AND REPORTS ON WELLS

NOTICE OF INTENTION TO DRILL	<input checked="" type="checkbox"/>	SUBSEQUENT REPORT OF WATER SHUT-OFF	
NOTICE OF INTENTION TO CHANGE PLANS		SUBSEQUENT REPORT OF SHOOTING OR ACIDIZING	
NOTICE OF INTENTION TO TEST WATER SHUT-OFF		SUBSEQUENT REPORT OF ALTERING CASING	
NOTICE OF INTENTION TO RE-DRILL OR REPAIR WELL		SUBSEQUENT REPORT OF RE-DRILLING OR REPAIR	
NOTICE OF INTENTION TO SHOOT OR ACIDIZE		SUBSEQUENT REPORT OF ABANDONMENT	
NOTICE OF INTENTION TO PULL OR ALTER CASING		SUPPLEMENTARY WELL HISTORY	
NOTICE OF INTENTION TO ABANDON WELL			

(INDICATE ABOVE BY CHECK MARK NATURE OF REPORT, NOTICE, OR OTHER DATA)

Houck Gas Unit "B"

Farmington, New Mexico July 14, 1959

Well No. 1 is located 1070 ft. from N line and 1450 ft. from E line of sec. 6

NE 1/4 of Section 6 T-29-N R-9-W MPM
(1/4 Sec. and Sec. No.) (Twp.) (Range) (Meridian)
Blanco Pictured Cliffs San Juan New Mexico
(Field) (County or Subdivision) (State or Territory)

The elevation of the derrick floor above sea level is _____ ft. (To be reported later)

DETAILS OF WORK

(State names of and expected depths to objective sands; show sizes, weights, and lengths of proposed casings; indicate mudding jobs, cementing points, and all other important proposed work)

We propose to drill the Houck Gas Unit "B" Well No. 1 with rotary tools to an approximate total depth of 2400' and complete in the Pictured Cliffs formation. Stimulation will be as indicated on reaching total depth.

The following casing program is proposed:

Size	Depth	Cement	Remarks
8-5/8"	200'	—	Circulate
4-1/2"	2400'	—	Circulate to surface if possible

Copies of location plats are attached. A copy of any survey taken will be submitted upon completion of well.

I understand that this plan of work must receive approval in writing by the Geological Survey before operations may be commenced.

Company PAN AMERICAN PETROLEUM CORPORATION

Address Box 487

Farmington, New Mexico

Attention: L. O. Speer, Jr.

By M. Bauer, Jr.

Title Area Engineer

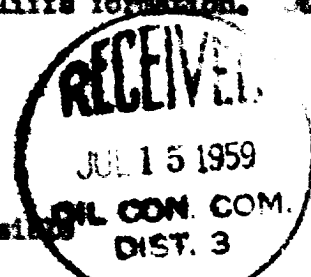

Note This well not drilled

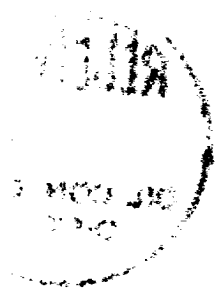

NEW MEXICO OIL CONSERVATION COMMISSION

Well Location and Acreage Dedication Plat

Section A.

Date July 13, 1959

Operator PAN AMERICAN PETROLEUM CORPORATION Lease HOUCK GAS UNIT "B"
Well No. 1 Unit Letter C Section 6 Township 29 NORTH Range 9 WEST NMPM
Located 1450' Feet From NORTH Line, 1450' Feet From EAST Line
County SAN JUAN G. L. Elevation * Dedicated Acreage 160 Acres
Name of Producing Formation PICTURED CLIFFS Pool BLANCO PICTURED CLIFFS

1. Is the Operator the only owner* in the dedicated acreage outlined on the plat below?
Yes X No * To be reported later
2. If the answer to question one is "no," have the interests of all the owners been consolidated by communitization agreement or otherwise? Yes No . If answer is "yes,"
Type of Consolidation
3. If the answer to question two is "no," list all the owners and their respective interests below:

100

Owner

Land Description

NOTE: REVISED FORM C-128 TO SHOW CHANGE IN WELL LOCATION FROM WHERE ORIGINALLY

STAKED AS TERAN GAS UNIT NO. 1 AT 795' FROM NORTH AND 1600' FROM EAST LINES

OF SECTION 6.

Section B

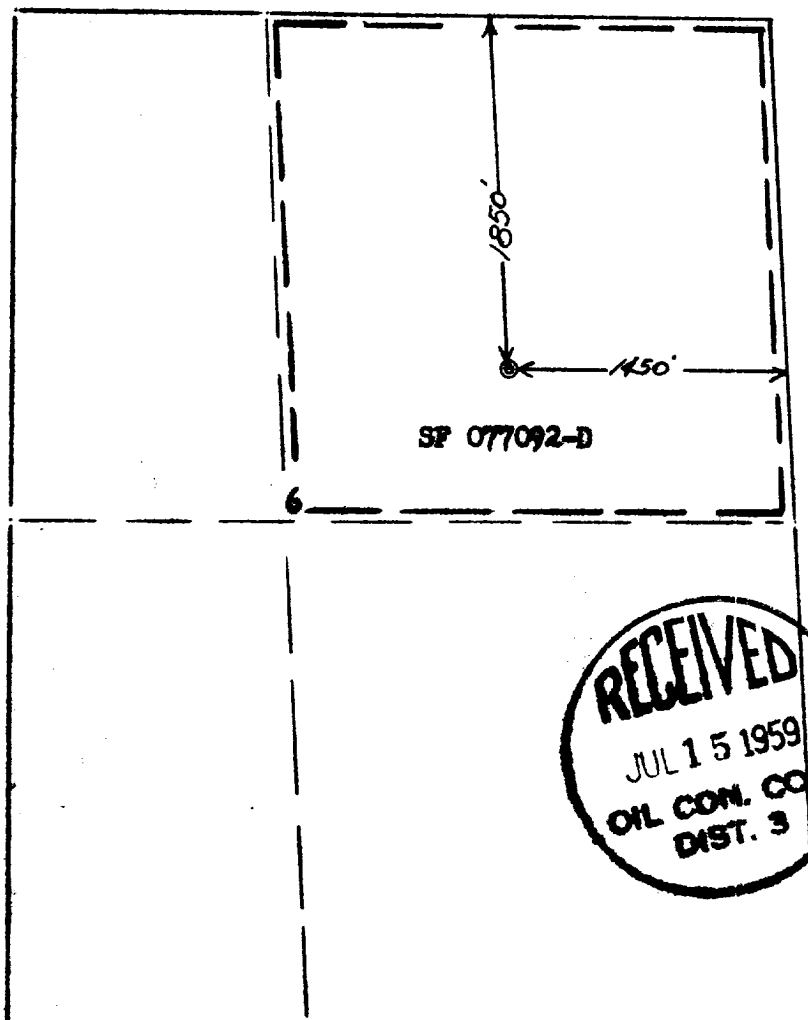

This is to certify that the information in Section A above is true and complete to the best of my knowledge and belief.

Pan American Petroleum Corp.
(Operator)

R.M. Bauer Jr.
(Representative)

Box 487
Farmington, New Mexico
Address

This is to certify that the well location shown on the plat in Section A was located from a true and correct survey made by me or under my supervision and that the same is true and correct to the best of my knowledge and belief.

Date Surveyed July 10, 1959

Ernest V. Echobawk
Registered Land Surveyor.

