

(SUBMIT IN TRIPLICATE)

Indian Agency

UNITED STATES
DEPARTMENT OF THE INTERIOR
GEOLOGICAL SURVEY

Allottee

Lease No.

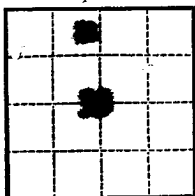

SUNDRY NOTICES AND REPORTS ON WELLS

NOTICE OF INTENTION TO DRILL	<input checked="" type="checkbox"/>	SUBSEQUENT REPORT OF WATER SHUT-OFF	<input type="checkbox"/>
NOTICE OF INTENTION TO CHANGE PLANS	<input type="checkbox"/>	SUBSEQUENT REPORT OF SHOOTING OR ACIDIZING	<input type="checkbox"/>
NOTICE OF INTENTION TO TEST WATER SHUT-OFF	<input type="checkbox"/>	SUBSEQUENT REPORT OF ALTERING CASING	<input type="checkbox"/>
NOTICE OF INTENTION TO REDRILL OR REPAIR WELL	<input type="checkbox"/>	SUBSEQUENT REPORT OF REDRILLING OR REPAIR	<input type="checkbox"/>
NOTICE OF INTENTION TO SHOOT OR ACIDIZE	<input type="checkbox"/>	SUBSEQUENT REPORT OF ABANDONMENT	<input type="checkbox"/>
NOTICE OF INTENTION TO PULL OR ALTER CASING	<input type="checkbox"/>	SUPPLEMENTARY WELL HISTORY	<input type="checkbox"/>
NOTICE OF INTENTION TO ABANDON WELL	<input type="checkbox"/>		

(INDICATE ABOVE BY CHECK MARK NATURE OF REPORT, NOTICE, OR OTHER DATA)

RECEIVED
NOV 13 1961
U. S. GEOLOGICAL SURVEY
FARMINGTON, NEW MEXICO

Well No. 7 is located 300 ft. from N line and 300 ft. from W line of sec. 32

32 (14 Sec. and Sec. No.) 300 (Twp.) 300 (Range) 300 (Meridian)

32 (Field) 300 (County or Subdivision) 300 (State or Territory)

The elevation of the derrick floor above sea level is 300 ft. 300 suggested ground

DETAILS OF WORK

(State names of and expected depths to objective sands; show sizes, weights, and lengths of proposed casings; indicate mudding jobs, cementing points, and all other important proposed work)

Rotary drilling equipment will be used to drill to approximately 630' to the Sumner Formation. If production is found, casing will be set and cemented with regular amount of cement. Solids and gas water will be used in drilling. Slime will be treated and chloride bags will be run prior to getting casing or abandonment. Stimulation treatments may be employed in completion.

ILLEGIBLE

RECEIVED
NOV 14 1961
IL CON. COM
DIST. 3

I understand that this plan of work must receive approval in writing by the Geological Survey before operations may be commenced.

Company Mobile Oil & Refining Company

Address P. O. Box 7000
Durango, Colorado

By COPY (ORIGINAL) B. M. BRADLEY
L. H. Bradley

Title Dist. Eng.

NUMBER OF COPIES RECEIVED	
DISTRIBUTION	
SANTA FE	
ILE	
U.S.G.S	
LAND OFFICE	
TRANSPORTER	OIL GAS
PRODUCTION OFFICE	
OPERATOR	

NEW MEXICO OIL CONSERVATION COMMISSION
WELL LOCATION AND ACREAGE DEDICATION PLAT
 SEE INSTRUCTIONS FOR COMPLETING THIS FORM ON THE REVERSE SIDE

FORM C-128
 Revised 5/1/57

SECTION A

Operator Phillips 66 Refining Company		Lease Cerro Hondo		Well No. 7
Unit Letter C	Section 33	Township 31N	Range 18W	County San Juan
Actual Footage Location of Well: 508' feet from the North line and 2360' feet from the West line				
Ground Level Elev. 6711'	Producing Formation		Pool Elk Horn	Dedicated Acreage: 1.0 Acres

1. Is the Operator the only owner in the dedicated acreage outlined on the plat below? YES ☒ NO ☐ ("Owner" means the person who has the right to drill into and to produce from any pool and to appropriate the production either for himself or for himself and another. (65-3-29 (e) NMSA 1935 Comp.)
2. If the answer to question one is "no," have the interests of all the owners been consolidated by communitization agreement or otherwise? YES ☐ NO ☐ If answer is "yes," Type of Consolidation _____
3. If the answer to question two is "no," list all the owners and their respective interests below:

Owner	Land Description

SECTION B

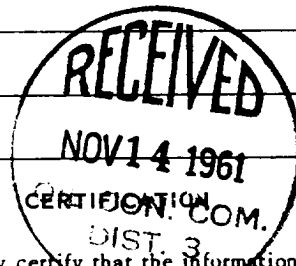
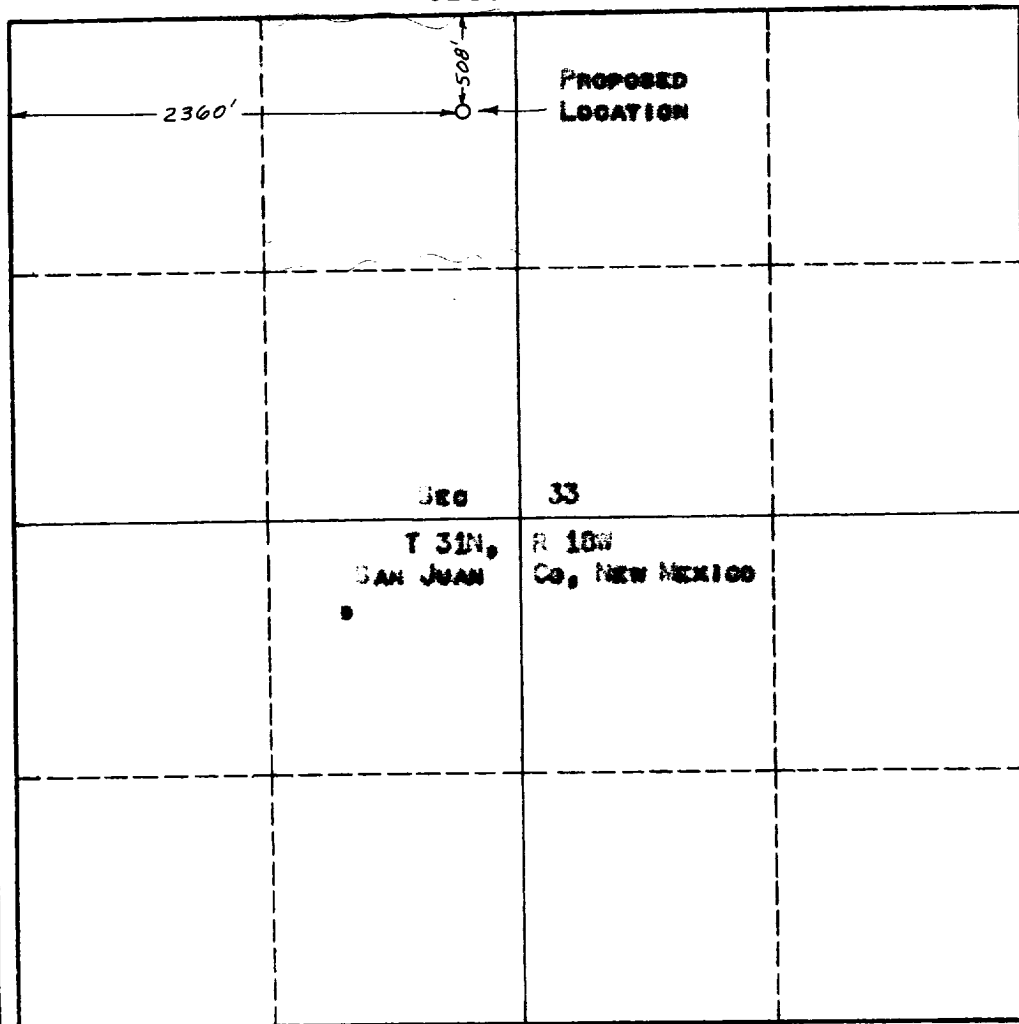

I hereby certify that the information in SECTION A above is true and complete to the best of my knowledge and belief.

COPY (ORIGINAL) R. M. BRADLEY
 Name (SIGNED) **Dist. Supr.**

Position
Phillips 66 Refining Co.
 Company
November 8, 1961
 Date

ILLEGIBLE

I hereby certify that the well location shown on the plat in SECTION B was plotted from field notes of actual surveys made by me or under my supervision, and that the same is true and correct to the best of my knowledge and belief.

Date Surveyed
11-1-61
 Registered Professional Engineer and/or Land Surveyor
E. M. Clark
 Certificate No.
NEW Mexico 3189

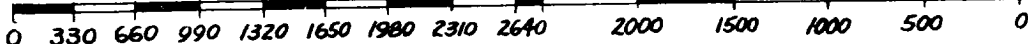

INSTRUCTIONS FOR COMPLETION OF FORM C-128

1. Operator shall furnish and certify to the information called for in Section A.
2. Operator shall outline the dedicated acreage for *both* oil and gas wells on the plat in Section B.
3. A registered professional engineer or land surveyor registered in the State of New Mexico or approved by the Commission shall show on the plat the location of the well and certify this information in the space provided.
4. All distances shown on the plat must be from the outer boundaries of the Section.
5. If additional space is needed for listing owners and their respective interests as required in question 3 of Section A, please use space below.