

Form 9-231 b  
(April 1962)

(SUBMIT IN TRIPLICATE)

Indian Agency Navajo Tribe

Window Rock, Arizona

Allottee Navajo

Lease No. 14-20-401-204

UNITED STATES  
DEPARTMENT OF THE INTERIOR  
GEOLOGICAL SURVEY

	23	
		0

SUNDRY NOTICES AND REPORTS ON WELLS

NOTICE OF INTENTION TO DRILL	<input checked="" type="checkbox"/>	SUBSEQUENT REPORT OF WATER SHUT-OFF	
NOTICE OF INTENTION TO CHANGE PLANS		SUBSEQUENT REPORT OF SHOOTING OR ACIDIZING	
NOTICE OF INTENTION TO TEST WATER SHUT-OFF		SUBSEQUENT REPORT OF ALTERING CASING	
NOTICE OF INTENTION TO REDRILL OR REPAIR WELL		SUBSEQUENT REPORT OF REDRILLING OR REPAIR	
NOTICE OF INTENTION TO SHOOT OR ACIDIZE		SUBSEQUENT REPORT OF ABANDONMENT	
NOTICE OF INTENTION TO PULL OR ALTER CASING		SUPPLEMENTARY WELL HISTORY	
NOTICE OF INTENTION TO ABANDON WELL			

(INDICATE ABOVE BY CHECK MARK NATURE OF REPORT, NOTICE, OR OTHER DATA)

January 9, 1962

Well No. 69 Navajo is located 2310 ft. from S line and 330 ft. from E line of sec. 23

SE1 Section 23 32N 10W MTN  
(1/4 Sec. and Sec. No.) (Twp.) (Range) (Meridian)  
Undesignated San Juan County New Mexico  
(Field) (County or Subdivision) (State or Territory)

The elevation of the derrick floor above sea level is 5434 ft.

DETAILS OF WORK

(State names of and expected depths to objective sands; show sizes, weights, and lengths of proposed casings; indicate mudlogging jobs, cementing points, and all other important proposed work)

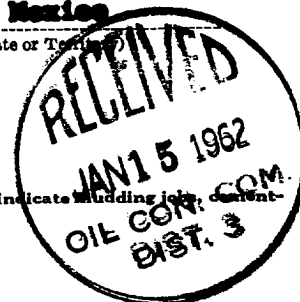

Set approximately 30 feet of 7" - 23# surface pipe with six sacks cement. Pilot drill ahead to 100 feet with 6-1/4" bit to see if air drilling possible. Drill with either air or drilling mud to test Tootie sandstone at about 1235 feet, drill ahead to 1300 feet and run electric log, plug and abandon or run 4-1/2" production string on results of Tootie core or electric log analysis.

If 4-1/2" production string is run, will cement with 30 sacks.

I understand that this plan of work must receive approval in writing by the Geological Survey before operations may be commenced.

Company Exploration Drilling Company

Address 910 Petroleum Club Building

Denver 2, Colorado

By Ross E. Wells  
Title Exploration Manager

# NEW MEXICO OIL CONSERVATION COMMISSION

## Well Location and Acreage Dedication Plat

### SECTION A.

Date December 27, 1961

Operator Exploration Drilling Company Lease \_\_\_\_\_  
Well No. #9 Unit Letter \_\_\_\_\_ Section 23 Township 32 North Range 18 West NMPM  
Located 2310 Feet From South Line, 330 Feet From East Line  
County San Juan G. L. Elevation 5430 Dedicated Acreage 4.90 Acres  
Name of Producing Formation Gallup-Teaite Sand Pool Undesignated

1. Is the Operator the only owner\* in the dedicated acreage outlined on the plat below? Yes \_\_\_\_\_ No X
2. If the answer to question One is "No," have the interests of all the owners been consolidated by communitization agreement or otherwise? Yes X No \_\_\_\_\_. If answer is "Yes," Type of Consolidation Assignment of Operating Rights (100%) above Section from Texas Fuel Co and Murphy Corporation.
3. If the answer to question Two is "No," list all the owners and their respective interests below:

OWNER

LAND DESCRIPTION

### SECTION B.

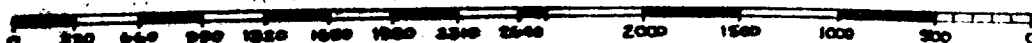
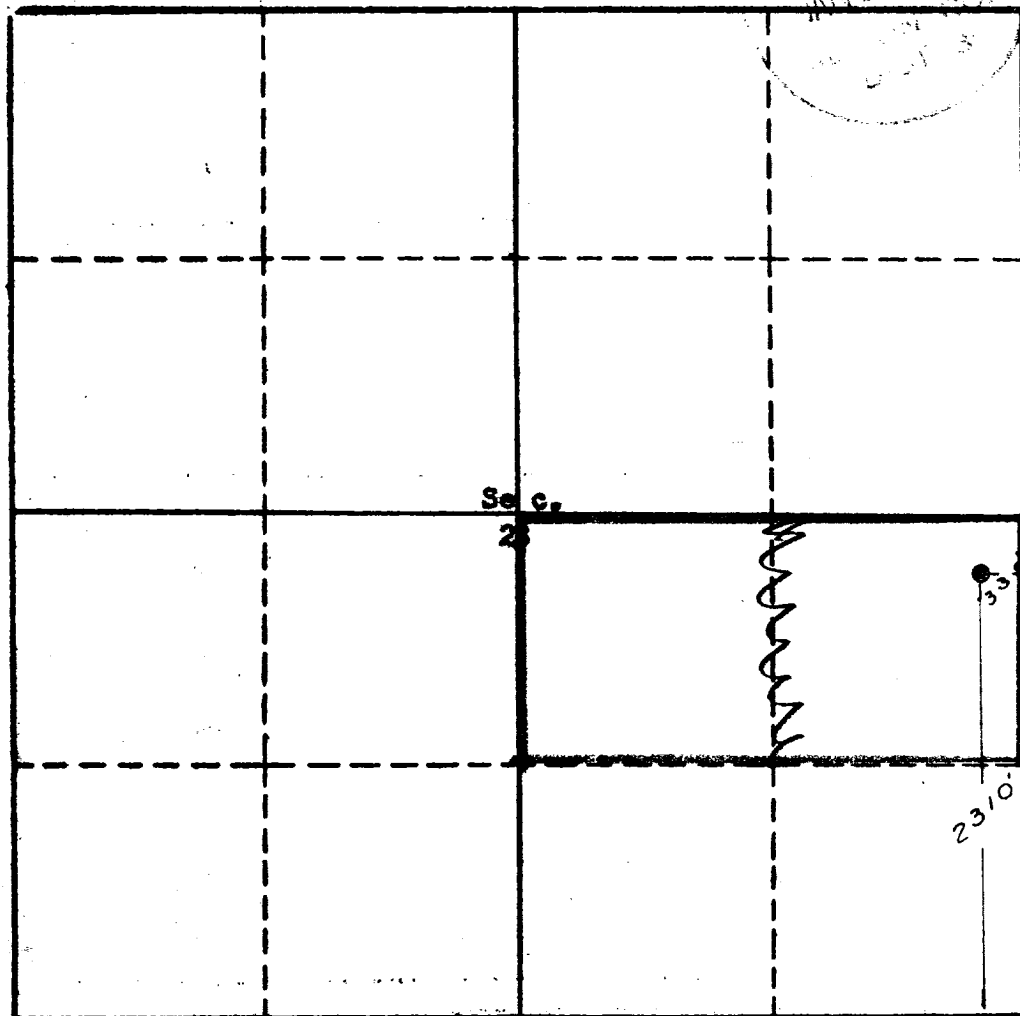

RECEIVED

JAN 1 1962

This is to certify that the information in Section A above is true and complete to the best of my knowledge and belief.

Exploration Drilling Company  
(OPERATOR)

Ross E. Wells  
(REPRESENTATIVE)

Ross E. Wells  
910 Petroleum Club Building  
Denver 2, Colorado  
(ADDRESS)

This is to certify that the well location shown on the plat in Section B was plotted from field notes of actual surveys made by me or under my supervision and that the same is true and correct to the best of my knowledge and belief.

Date Surveyed Dec. 27, 1961

Four States Engineering Co.  
FARMINGTON, NEW MEXICO

John E. Wells  
REGISTERED ENGINEER  
LAND SURVEYING

Certificate No. 578