

copy  
Y

Form 9-331b  
(April 1952)

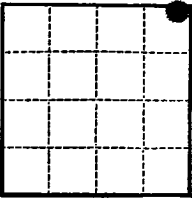

(SUBMIT IN TRIPLICATE)

UNITED STATES  
DEPARTMENT OF THE INTERIOR  
GEOLOGICAL SURVEY

Indian Agency \_\_\_\_\_  
Contract No. **I-149-Ind-7000**

Allottee \_\_\_\_\_  
Lease No. \_\_\_\_\_

SUNDRY NOTICES AND REPORTS ON WELLS

NOTICE OF INTENTION TO DRILL	<input checked="" type="checkbox"/>	SUBSEQUENT REPORT OF WATER SHUT-OFF	<input type="checkbox"/>
NOTICE OF INTENTION TO CHANGE PLANS	<input type="checkbox"/>	SUBSEQUENT REPORT OF SHOOTING OR ACIDIZING	<input type="checkbox"/>
NOTICE OF INTENTION TO TEST WATER SHUT-OFF	<input type="checkbox"/>	SUBSEQUENT REPORT OF ALTERING CASING	<input type="checkbox"/>
NOTICE OF INTENTION TO REDRILL OR REPAIR WELL	<input type="checkbox"/>	SUBSEQUENT REPORT OF REDRILLING OR REPAIR	<input type="checkbox"/>
NOTICE OF INTENTION TO SHOOT OR ACIDIZE	<input type="checkbox"/>	SUBSEQUENT REPORT OF ABANDONMENT	<input type="checkbox"/>
NOTICE OF INTENTION TO PULL OR ALTER CASING	<input type="checkbox"/>	SUPPLEMENTARY WELL HISTORY	<input type="checkbox"/>
NOTICE OF INTENTION TO ABANDON WELL	<input type="checkbox"/>		

RECEIVED  
DEC 1 1961

Lease No. **154308**  
**Ashee-Navaajo**

(INDICATE ABOVE BY CHECK MARK NATURE OF REPORT, NOTICE, OR OTHER DATA)

**November 28**, 19**61**

Well No. **7** is located **600** ft. from **N** line and **600** ft. from **E** line of sec. **23**  
**NE/4 NE/4 Sec. 23 T-32-S R-18-W**  
(1/4 Sec. and Sec. No.) (Twp.) (Range) (Meridian)  
**Undesignated-Gallup** **San Juan** **New Mexico**  
(Field) (County or Subdivision) (State or Territory)

The elevation of the derrick floor above sea level is **2203** ft.

DETAILS OF WORK

(State names of and expected depths to objective sands; show sizes, weights, and lengths of proposed casings; indicate mudding jobs, cementing points, and all other important proposed work)

FORMATION ENCOUNTERED	SIZE CASING	CASING PROGRAM
Top of Gallup 1055'		
Total Depth 1120'	7-5/8 15.850 New	100' 50 cu
	3-1/2 9.750 New	1055' 100 cu



I understand that this plan of work must receive approval in writing by the Geological Survey before operations may be commenced.

Company **TEXACO Inc.** **TEXACO Inc.**

Address **P. O. Box 3109**  
**Midland, Texas**

By **J. J. Volton**  
Title **Division Civil Engineer**

**NEW MEXICO OIL CONSERVATION COMMISSION**  
**WELL LOCATION AND PLAT INFORMATION PLAT**

FORM 5-107  
 REV. 12/57

SEE INSTRUCTIONS FOR COMPLETION OF THIS PLAT

Operator <b>TEXACO Inc.</b>		Lease <b>Aztec-Navajo "A"</b>	
Unit Letter <b>A</b>	Section <b>25</b>	Township <b>32 North</b>	Range <b>10 East</b>
Actual Footage Location of Well: <b>660'</b> feet from the <b>North</b> line and <b>660'</b> feet from the <b>East</b> line		Dedicated Acreage: <b>40</b> Acres	
Ground Level Elev. <b>5494'</b>	Producing Formation <b>Gallup</b>	Pool <b>Undesignated Gallup</b>	

- Is the Operator the only owner in the dedicated acreage outlined on the plat below? YES ☒ NO ☐ ("Owner" means the person who has the right to drill into and to produce from any pool and to appropriate the production either for himself or for himself and another. (65-3-29 (e) NMSA 1935 Comp.)
- If the answer to question one is "no," have the interests of all the owners been consolidated by communication agreement or otherwise? YES ☐ NO ☐ If answer is "yes," Type of Consolidation \_\_\_\_\_
- If the answer to question two is "no," list all the owners and their respective interests below:

Owner	Land Description

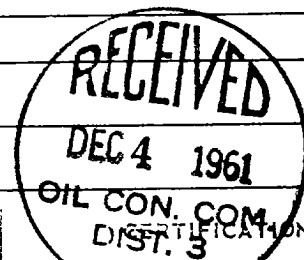
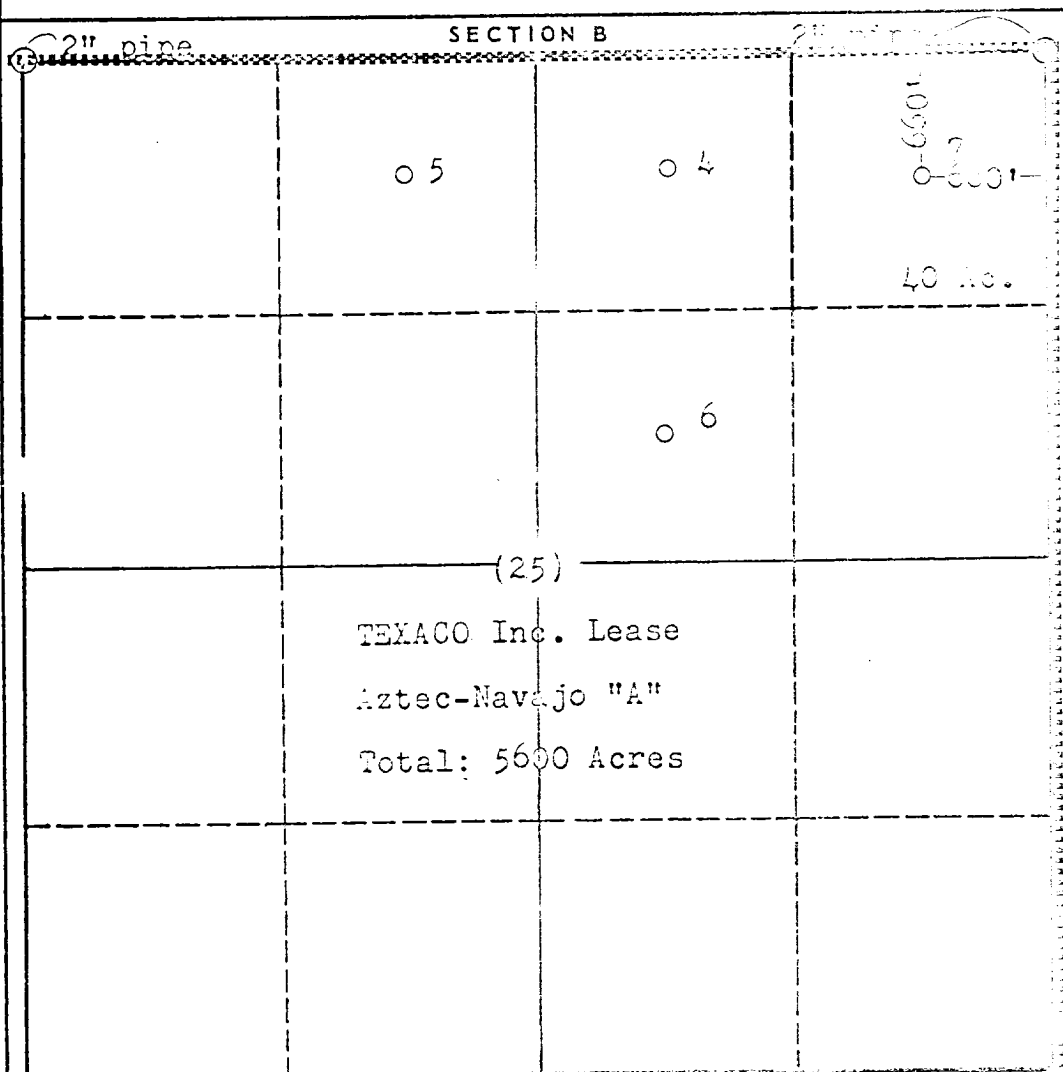

I hereby certify that the information in SECTION A above is true and complete to the best of my knowledge and belief.

Name J. J. Velten  
 Position Division Civil Engineer  
 Company TEXACO Inc.  
 Date 11/27/61

I hereby certify that the well location shown on the plat in SECTION B was plotted from field notes of actual surveys made by me or under my supervision, and that the same is true and correct to the best of my knowledge and belief.

Date Surveyed 11/25/61  
 Registered Professional Engineer and/or Land Surveyor J. J. Velten  
 Certificate No. 8174

0 330 660 990 1320 1650 1980 2310 2640 2000 1500 1000 500 0