

**Clay Cooper #7 Closure Report
Duke Energy Field Services
Lea County, New Mexico**

JANUARY 25, 2002

Prepared For:

**Duke Energy Field Services
P. O. Box 5493
Denver, CO 80217**

Site Name:

CLAY COOPER #7 (CC#7)

Site Location:

T20S, R36 E, SECTION 24, UNIT J

Prepared By:



**PO Box 7624
Midland, Texas 79708**

*1 RP-215
10.26.05*



January 25, 2002

Mr. Steve Weathers
Duke Energy Field Services, LP
P. O. Box 5493
Denver, Colorado 80217

Re: Removal of Hydrocarbon-Impacted Soils from the CC #7 site
Township 20 South, Range 36 East, Section 24, Unit J

Dear Mr. Weathers:

Trident Environmental (Trident) was retained by Duke Energy Field Services, LP. (DEFS) to oversee the removal of hydrocarbon-impacted soil from an area along a pipeline right-of-way operated by DEFS near Monument, New Mexico in Lea County. The site (CC #7) is located in Section 24 (Unit J), Township 20 South, Range 36 East on property owned by Dale Cooper and managed by Clay Cooper. The location of the CC #7 site is shown on the topographic map in Attachment A. The work was conducted in accordance with the work plan submitted to the New Mexico Oil Conservation Division (OCD). Trident personnel periodically collected soil samples to characterize the extent of hydrocarbon-impact and to verify when cleanup target levels had been achieved. This letter report describes the methods and results of the excavation, sampling, waste disposition, and backfilling operations for documentation that closure requirements have been satisfied.

Excavation and Sampling Procedures

Walton Construction Company, Inc. (Hobbs, New Mexico) performed excavation. Walton Construction used one trackhoe, one dozer, one loader, and 12 yd³ dump trucks for earthmoving services. An area was excavated where Mr. Cooper identified indications of hydrocarbon-impacted soils. During excavation operations, subsurface soil samples were collected and submitted to an analytical laboratory to characterize the approximate lateral and vertical extent of hydrocarbon-impacted soil in each area. Samples were collected by Trident with stainless steel trowels. Grab samples were collected from the floor and walls (north, south, east, and west), as specified in the site data form in Attachment A. During the course of excavation activities, samples were also collected for headspace analysis using an organic vapor meter (OVM), which was calibrated to assume a benzene response factor. All soil sampling, headspace analysis, and laboratory analysis were performed in accordance with OCD "Guidelines for Remediation of Leaks, Spills, and Releases" (August 13, 1993). Excavation operations were completed when laboratory analysis of collected samples indicated the extent of hydrocarbon-impacted soils remaining in the excavation were below the following concentrations:

- 100 milligrams per kilogram (mg/kg) of total petroleum hydrocarbons (TPH),
- 10 mg/kg benzene,
- 50 mg/kg total benzene, toluene, ethylbenzene, and xylenes (BTEX)

Soil samples were submitted to Environmental Laboratory of Texas (Odessa, Texas) and analyzed for gas and diesel range organics (GRO and DRO) using EPA Method 8015 to determine TPH concentrations. BTEX analyses were not conducted for the soil samples since none of the OVM readings exceeded 100 ppm and all GRO and/or DRO concentrations were below 100 mg/kg.

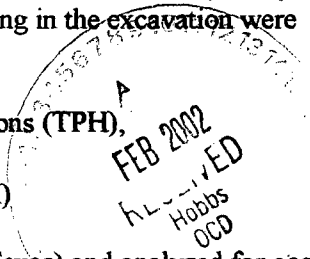

Soil Stockpiling, Waste Disposition, and Backfilling

An effort to segregate clean versus impacted soil during excavation was made. Only hydrocarbon-impacted soil that exceeded 100 mg/kg GRO/DRO, 10 mg/kg benzene, and/or 50 mg/kg total BTEX was transported to the South Monument Landfarm. These target cleanup levels are based on the ranking criteria in the OCD "*Guidelines for Remediation of Leaks, Spills, and Releases*". A total ranking score of greater than 19 points was assumed since groundwater is less than 50 feet below ground surface based on landowner's claims and well records from the Office of the State Engineer.

Approximately 1,620 cubic yards of hydrocarbon-impacted soils were transported by Walton Construction to cell B-6 at the South Monument Landfarm, which is owned and operated by Ms. Kena Kay Cooper (OCD Rule 711 Permit Approval NM-01-0032). Completed *Generator Certificate of Waste Status* (C-143) and *Release Notification and Corrective Action* (C-141) forms are included in Attachment A.

Excavated soils below the remediation action levels and as agreed upon by Mr. Cooper were returned to the excavation after ~~sampling and analysis verification~~. Also, ~~native soil~~ from adjacent sand dunes in the area was provided by Mr. Cooper and used as additional backfill in the excavation to restore the excavation to a level grade.

Results

At the completion of excavation activities all areas had petroleum hydrocarbon concentrations below the OCD standards listed above. Soil sample locations and a summary of the analytical results are depicted on the Site Data Form in Attachment A. Photo documentation is also provided in Attachment A. Laboratory analytical reports, and chain-of-custody documentation for the samples collected are provided in Attachment B. Copies of the field logbook are in Attachment C.

Sincerely,

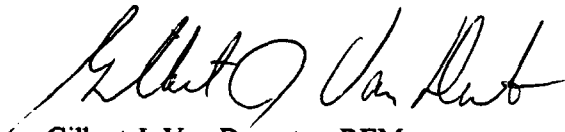

Gilbert J. Van Deventer, REM
Project Manager

Attachments

cc: Clay Cooper, landowner – Hobbs, NM

ATTACHMENT A

TOPOGRAPHIC MAP

SITE DATA FORM

C-141 AND C-143 FORMS

PHOTODOCUMENTATION





Site Data Form

TRW Technician: JMF/GJV Excavation Crew Names: Walton Construction Site ID: Clay Cooper # 7
Site Location: Latitude 32° 33' 23" N Longitude 103° 18' 19" W County: Lea State: New Mexico
Township 20 South Range 36 East Section 24 Unit J
Begin Excavation (Date/Time) 11/5/01 Complete Excavation (Date/Time) 11/9/01

LAND USE: ☐ Residential ☐ Recreational ☐ Farm land
(Check all that apply) ☐ Industrial ☐ School/Daycare ☒ Range land
☒ Oil & Gas ☐ Rural ☐ Other: _____

Depth to Groundwater: ☐ > 100 feet ☐ 50 - 99 ☒ < 50 feet
Wellhead Protection Area: ☒ > 1,000 feet from a water source ☐ < 200 feet from private domestic water source
Distance to Nearest Surface Water Body: ☒ > 1,000 feet ☐ 200 - 1,000 feet ☐ < 200 feet

SURFACE SOILS: ☒ Sand ☐ Gravel ☐ Silt
☐ Caliche ☐ Clay ☒ Other Sandy silty clay at depth

EXCAVATION DIMENSIONS Length ~160 feet Width 10 - 28 feet Average Depth 16 feet Maximum Depth 23 feet

VOLUME EXCAVATED: ~3,000 yd³ VOLUME HAULED TO LANDFARM: 1,620 yd³

SITE MAP AND SUMMARY OF OVM, GRO, & DRO CONCENTRATIONS

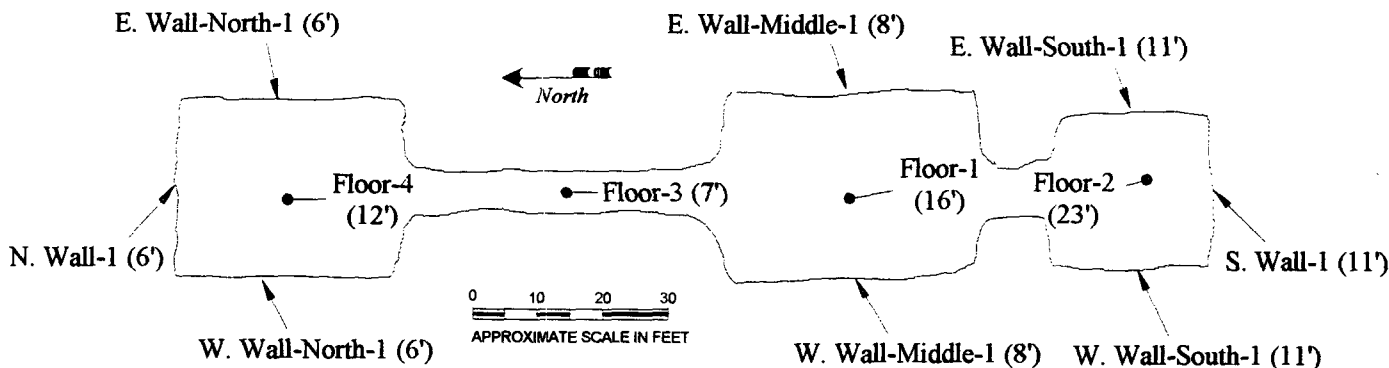

| Sample ID (Depth) | Sample Type | Sample Date | OVM (ppm) | GRO (mg/kg) | DRO (mg/kg) |
|-----------------------|-------------|-------------|-----------|-------------|-------------|
| Floor-1 (16') | Grab | 11-08-01 | 0.0 | < 10 | < 10 |
| Floor-2 (23') | Grab | 11-08-01 | 1.4 | < 10 | 12 |
| Floor-3 (7') | Grab | 11-09-01 | 0.0 | < 10 | < 10 |
| Floor-4 (12') | Grab | 11-09-01 | 0.0 | < 10 | < 10 |
| N. Wall-1 (6') | Grab | 11-09-01 | 0.0 | < 10 | < 10 |
| W. Wall-North-1 (6') | Grab | 11-09-01 | 0.0 | < 10 | < 10 |
| E. Wall-North-1 (6') | Grab | 11-09-01 | 0.0 | < 10 | < 10 |
| W. Wall-Middle-1 (8') | Grab | 11-09-01 | 0.0 | < 10 | < 10 |
| E. Wall-Middle-1 (8') | Grab | 11-09-01 | 0.0 | < 10 | < 10 |
| S. Wall-1 (11') | Grab | 11-09-01 | 0.0 | < 10 | < 10 |
| W. Wall-South-1 (11') | Grab | 11-09-01 | 0.0 | < 10 | < 10 |
| E. Wall-South-1 (11') | Grab | 11-09-01 | 0.0 | < 10 | < 10 |
| Backfill-1 | Grab | 12-05-01 | 0.0 | < 10 | 17 |

District I
1625 N. French Dr., Hobbs, NM 88240
District II
811 South First, Artesia, NM 88210
District III
1000 Rio Brazos Road, Aztec, NM 87410
District IV
2040 South Pacheco, Santa Fe, NM 87505

State of New Mexico
Energy Minerals and Natural Resources

Oil Conservation Division
2040 South Pacheco
Santa Fe, NM 87505

Form C-141
Revised March 17, 1999

Submit 2 Copies to appropriate
District Office in accordance
with Rule 116 on back
side of form

Release Notification and Corrective Action

OPERATOR

☐ Initial Report ☒ Final Report

| | |
|--|---------------------------------------|
| Name of Company Duke Energy Field Services Inc. | Contact Mr. Steve Weathers |
| Address P. O. Box 5493, Denver, Colorado 80217 | Telephone No. (303) 605-1718 |
| Facility Name Site Name: CC-#7 | Facility Type Natural Gas Pipeline |

| | | |
|------------------------------|--------------------------|-------------------|
| Surface Owner Dale Cooper | Mineral Owner Unknown | Lease No. EMSU |
|------------------------------|--------------------------|-------------------|

LOCATION OF RELEASE

| | | | | | | | | |
|------------------|---------------|-----------------|--------------|--------------------------------|------------------|---------------------------------|----------------|---------------|
| Unit Letter J | Section 24 | Township 20S | Range 36E | Feet from the 32° 33' 23" N | North/South Line | Feet from the 103° 18' 19" W | East/West Line | County Lea |
|------------------|---------------|-----------------|--------------|--------------------------------|------------------|---------------------------------|----------------|---------------|

NATURE OF RELEASE

| | | |
|--|--|---|
| Type of Release Condensate | Volume of Release Unknown | Volume Recovered ~1,620 yd ³ soil removed |
| Source of Release Pipeline | Date and Hour of Occurrence Unknown | Date and Hour of Discovery Unknown |
| Was Immediate Notice Given? <input type="checkbox"/> Yes <input type="checkbox"/> No <input checked="" type="checkbox"/> Not Required | If YES, To Whom? Paul Sheeley, NMOCD District 1 | |
| By Whom? Steve Weathers | Date and Hour | |
| Was a Watercourse Reached? <input type="checkbox"/> Yes <input checked="" type="checkbox"/> No | If YES, Volume Impacting the Watercourse N/A | |

If a Watercourse was Impacted, Describe Fully.*

N/A

Describe Cause of Problem and Remedial Action Taken.*

Historical condensate release caused by subsurface external corrosion. 10" steel pipeline was replaced with 10" plastic line prior to initiation of over-excavation work. Removal of impacted soil requested by landowner (Clay Cooper).

Describe Area Affected and Cleanup Action Taken.*

On 11/5/01 over-excavation was initiated. Excavation continued until 11/9/01 when total petroleum hydrocarbons on floor and walls were below 100 mg/kg. Final excavation dimensions were approx. ~10-28 ft wide x ~160 long x 7-23 ft deep. Approximately 1,620 cu yds of soil was transported to cell B-6 at the South Monument Land Farm. Backfilling of excavation was completed on 11/28/01. Closure report, analytical results, photographs, and site map are attached.

I hereby certify that the information given above is true and complete to the best of my knowledge and understand that pursuant to NMOCD rules and regulations all operators are required to report and/or file certain release notifications and perform corrective actions for releases which may endanger public health or the environment. The acceptance of a C-141 report by the NMOCD marked as "Final Report" does not relieve the operator of liability should their operations have failed to adequately investigate and remediate contamination that pose a threat to ground water, surface water, human health or the environment. In addition, NMOCD acceptance of a C-141 report does not relieve the operator of responsibility for compliance with any other federal, state, or local laws and/or regulations.

| | | | |
|---------------------------------|-----------------------|-------------------------------------|-----------------------------------|
| Signature: | | OIL CONSERVATION DIVISION | |
| Printed Name: Stephen Weathers | | Approved by District Supervisor: | |
| Title: Environmental Specialist | Approval Date: | Expiration Date: | |
| Date: | Phone: (303) 605-1718 | Conditions of Approval: | Attached <input type="checkbox"/> |

* Attach Additional Sheets If Necessary

Site Data Form

TRW Technician: JMF/GJV Excavation Crew Names: Walton Construction Site ID: Clay Cooper # 7
 Site Location: Latitude 32° 33' 23" N Longitude 103° 18' 19" W County: Lea State: New Mexico
 Township 20 South Range 36 East Section 24 Unit J
 Begin Excavation (Date/Time) 11/5/01 Complete Excavation (Date/Time) 11/9/01

LAND USE: (Check all that apply)
☐ Residential ☐ Recreational ☐ Farm land
☐ Industrial ☐ School/Daycare ☒ Range land
☒ Oil & Gas ☐ Rural ☐ Other: _____

Depth to Groundwater: ☐ > 100 feet ☐ 50 - 99 ☒ < 50 feet
 Wellhead Protection Area: ☒ > 1,000 feet from a water source ☐ < 200 feet from private domestic water source
 Distance to Nearest Surface Water Body: ☒ > 1,000 feet ☐ 200 - 1,000 feet ☐ < 200 feet

SURFACE SOILS: ☒ Sand ☐ Gravel ☐ Silt
☐ Caliche ☐ Clay ☒ Other: Sandy silty clay at depth

EXCAVATION DIMENSIONS
 Length ~160 feet Width 10 - 28 feet Average Depth 16 feet Maximum Depth 23 feet

VOLUME EXCAVATED: ~3,000 yd³ **VOLUME HAULED TO LANDFARM:** 1,620 yd³

SITE MAP AND SUMMARY OF OVM, GRO, & DRO CONCENTRATIONS

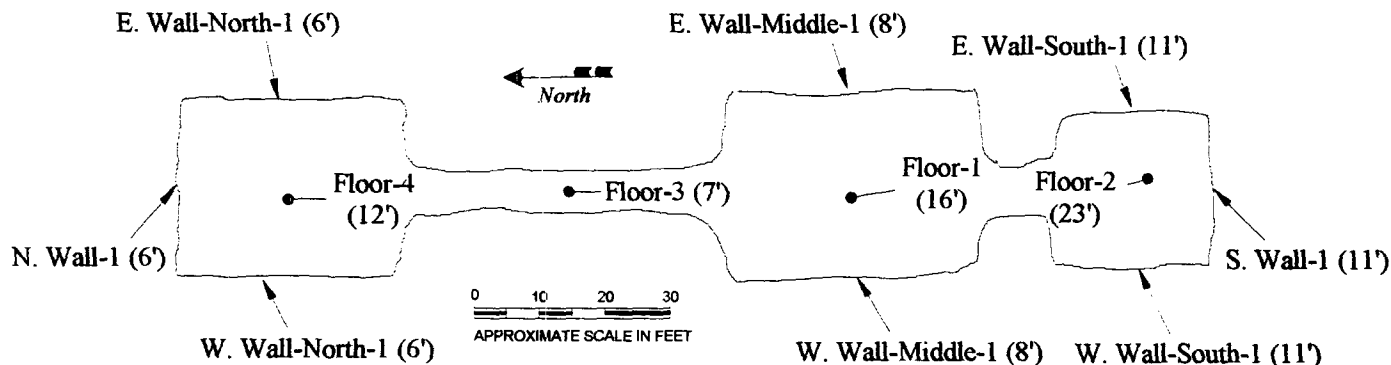

| Sample ID (Depth) | Sample Type | Sample Date | OVM (ppm) | GRO (mg/kg) | DRO (mg/kg) |
|-----------------------|-------------|-------------|-----------|-------------|-------------|
| Floor-1 (16') | Grab | 11-08-01 | 0.0 | < 10 | < 10 |
| Floor-2 (23') | Grab | 11-08-01 | 1.4 | < 10 | 12 |
| Floor-3 (7') | Grab | 11-09-01 | 0.0 | < 10 | < 10 |
| Floor-4 (12') | Grab | 11-09-01 | 0.0 | < 10 | < 10 |
| N. Wall-1 (6') | Grab | 11-09-01 | 0.0 | < 10 | < 10 |
| W. Wall-North-1 (6') | Grab | 11-09-01 | 0.0 | < 10 | < 10 |
| E. Wall-North-1 (6') | Grab | 11-09-01 | 0.0 | < 10 | < 10 |
| W. Wall-Middle-1 (8') | Grab | 11-09-01 | 0.0 | < 10 | < 10 |
| E. Wall-Middle-1 (8') | Grab | 11-09-01 | 0.0 | < 10 | < 10 |
| S. Wall-1 (11') | Grab | 11-09-01 | 0.0 | < 10 | < 10 |
| W. Wall-South-1 (11') | Grab | 11-09-01 | 0.0 | < 10 | < 10 |
| E. Wall-South-1 (11') | Grab | 11-09-01 | 0.0 | < 10 | < 10 |
| Backfill-1 | Grab | 12-05-01 | 0.0 | < 10 | 17 |

District I - (505) 393-6161
1625 N. French Dr
Hobbs, NM 88240
District II - (505) 748-1283
811 S. First
Artesia, NM 88210
District III - (505) 334-6178
1000 Rio Brazos Road
Aztec, NM 87410
District IV - (505) 827-7131
2040 S. Pacheco
Santa Fe, NM 87505

New Mexico
Energy Minerals and Natural Resources Department
Oil Conservation Division
2040 South Pacheco Street
Santa Fe, New Mexico 87505
(505) 827-7131

2001
Form C-143
3/15/00

Submit to OCD
Permitted Surface
Waste Management
Facility

GENERATOR CERTIFICATE OF WASTE STATUS

1. Waste Generator Name and Address:

Duke Energy Field Services Inc.
P. O. Box 5493
Denver, Colorado 80217

2. Permit Number (if waste generated at an OCD permitted facility)

3. Description of Waste and Generating Process:

Exempt oilfield waste
Hydrocarbon-impacted soil from pipeline leak

4. Location of Waste (Street address &/or ULSTR):

Sec 24 T20S R36E Unit J
Site Name: Clay Cooper #7

5. Destination (Surface Waste Management Facility):
South Monument Landfarm (Permit NM-01-0032)

6. Transporter: Walton Construction

7. Estimated Volume 1000 cy/bbls

For NON-EXEMPT waste only, the following documentation is attached (check appropriate items):

_____ MSDS information

_____ RCRA Hazardous Waste Analysis (With Chain of Custody).

_____ Other (Description)

Generator certifies that, according to the Resource Conservation and Recovery Act (RCRA) and the Environmental Protection Agency's 1990 regulatory determination, the above described waste is: (check appropriate classification)

☒ EXEMPT oilfield waste.

☐ NON-EXEMPT oilfield waste that is non-hazardous pursuant to 40 CFR Part 261. (Attach appropriate documentation)

In addition, Generator certifies that nothing has been added to this exempt or non-exempt non-hazardous waste and that this waste does not contain Naturally Occurring Radioactive Material (NORM) regulated pursuant to 20 NMAC 3.1 Subpart 1403.

Generator Signature: _____

Date: 11/8/01

Print Name: Steve Weathers

Title: Environmental Specialist



dcp_1571 View showing hydrocarbon-impacted soil at beginning of excavation operation.

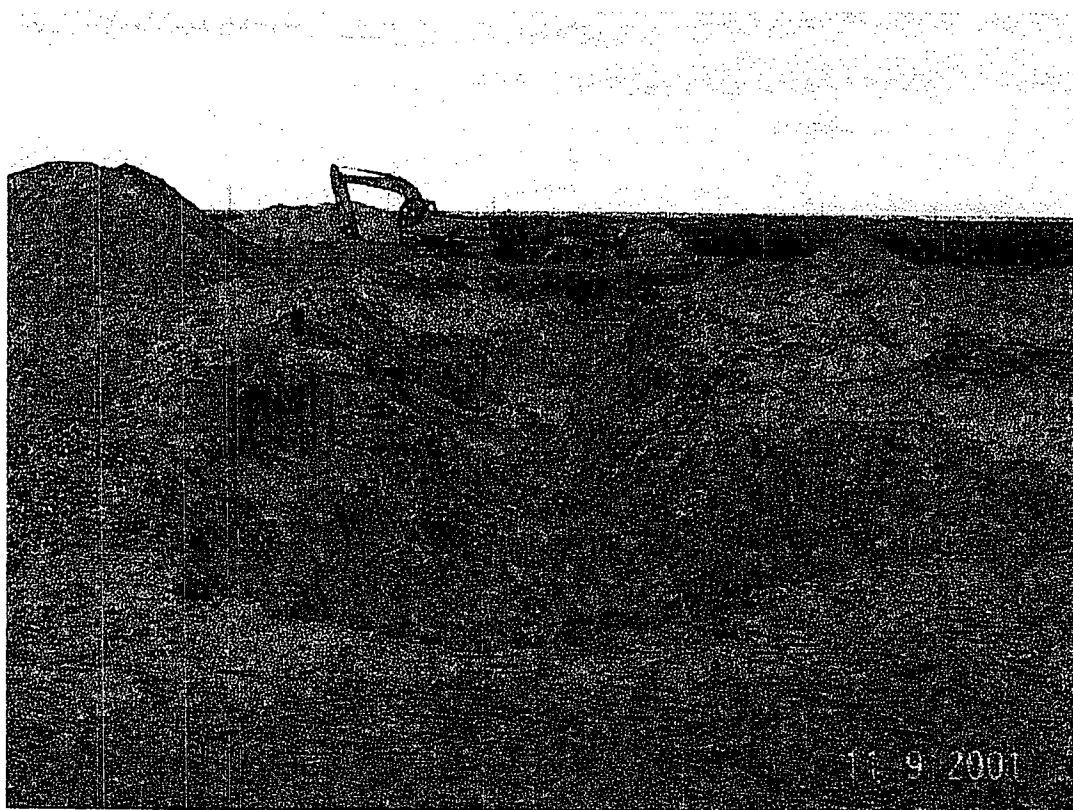

dcp_1593 View facing north showing all of excavation at completion.



dcp_1594 View facing south showing middle (foreground) and southern (background) portions at completion of excavation activities.



dcp_1595 View facing north showing the west wall (left center) and north wall (background) of northernmost excavation at end of excavation activities.



dcp_1596 View facing southeast showing floor (foreground), east wall (left center) and south trench (upper right) of northernmost excavation.



Dcp_1597 View facing south showing completion of excavation operations.

ATTACHMENT B

**LABORATORY ANALYTICAL REPORTS
AND
CHAIN-OF-CUSTODY DOCUMENTATION**

ENVIRONMENTAL LAB OF , INC.

"Don't Treat Your Soil Like Dirt!"

TRIDENT ENVIRONMENTAL
ATTN: GILBERT VAN DEVENTER
P.O. BOX 7624
MIDLAND, TEXAS 79708
FAX: 682-0727

Sample Type: Soil
Sample Condition: Intact/ Iced/ -1.0 deg C
Project Name: Duke Energy Field Services
Project #: V-106
Project Location: CC#7

Sampling Date: See Below
Receiving Date: 11/08/01
Analysis Date: 11/09/01

| ELT# | FIELD CODE | GRO C6-C10 mg/kg | DRO >C10-C28 mg/kg | SAMPLE DATE |
|------------|---------------|------------------------|--------------------------|----------------|
| 0101978-01 | Floor-1 (16') | <10 | <10 | 11/05/01 |
| 0101978-02 | Floor-2 (23') | <10 | 12 | 11/08/01 |

| | | |
|-----------------------|------|------|
| QUALITY CONTROL | 450 | 546 |
| TRUE VALUE | 500 | 500 |
| % INSTRUMENT ACCURACY | 90 | 109 |
| SPIKED AMOUNT | 244 | 244 |
| ORIGINAL SAMPLE | <10 | <10 |
| SPIKE | 292 | 269 |
| SPIKE DUP | 290 | 263 |
| % EXTRACTION ACCURACY | 119 | 108 |
| BLANK | <10 | <10 |
| RPD | 0.69 | 2.26 |

Methods: SW 846-8015M

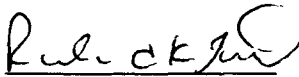
Raland K. Tuttle

11-10-01
Date

ENVIRONMENTAL LAB OF , INC.

"Don't Treat Your Soil Like Dirt!"

TRIDENT ENVIRONMENTAL
ATTN: GILBERT VAN DEVENTER
P.O. BOX 7624
MIDLAND, TEXAS 79708
FAX: 682-0727

Sample Type: Soil
Sample Condition: Intact/ Iced/ 3.0 deg C
Project Name: Duke Energy Field Services
Project #: V-106
Project Location: CC#7

Sampling Date: 11/09/01
Receiving Date: 11/09/01
Analysis Date: 11/11/01

| ELT # | FIELD CODE | GRO C6-C10 mg/kg | DRO >C10-C28 mg/kg |
|-----------------------|-----------------------|------------------------|--------------------------|
| 0101986-01 | Floor-4 (12') | <10 | <10 |
| 0101986-02 | W. Wall-North-1 (6') | <10 | <10 |
| 0101986-03 | N. Wall-1 (6') | <10 | <10 |
| 0101986-04 | E. Wall-North-1 (6') | <10 | <10 |
| 0101986-05 | Floor-3 (7') | <10 | <10 |
| 0101986-06 | W. Wall-South-1 (11') | <10 | <10 |
| 0101986-07 | South Wall-1 (11') | <10 | <10 |
| 0101986-08 | E. Wall-South-1 (11') | <10 | <10 |
| 0101986-09 | E. Wall-Middle-1 (8') | <10 | <10 |
| 0101986-10 | W. Wall-Middle-1 (8') | <10 | <10 |
| QUALITY CONTROL | | 455 | 538 |
| TRUE VALUE | | 500 | 500 |
| % INSTRUMENT ACCURACY | | 91 | 108 |
| SPIKED AMOUNT | | 476 | 476 |
| ORIGINAL SAMPLE | | <10 | <10 |
| SPIKE | | 486 | 489 |
| SPIKE DUP | | 457 | 499 |
| % EXTRACTION ACCURACY | | 102 | 103 |
| BLANK | | <10 | <10 |
| RPD | | 6.15 | 2.02 |

Methods: SW 846-8015M

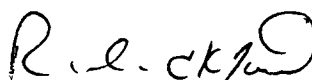

Raland K. Tuttle

11-12-01
Date



Trident Environmental
P.O. Box 7624
Midland, Texas 79708
(915) 682-0808
(915) 682-0727 (Fax)

553-632-3106

V-106-CC7-02

Chain of Custody

Date 11-9-01 Page 1 of 1

| Lab Name: Environmental Lab of Texas, Inc. Address: 12600 West I-20 East Odessa, TX 79763 Telephone: (915) 563-1800 Fax: (915) 563-1713 | | | | Sample Type: G - Grab, C - Composite | Analysis Request | | | | | | | | | | | | | | | | Number of Containers |
|--|--------|---------|------|---|------------------|---|-----------------|----------------|----------------|-----------------------------------|---------------|---------------|-----------------|-----------------------------------|-----------------|----------------|--------------|-------------|---|--|----------------------|
| Sample Identification | Matrix | Date | Time | | BTEX (EPA 8021B) | MTBE (EPA 8021B) | SVOC (EPA 8270) | PAH (EPA 8270) | VOC (EPA 8260) | TPH (EPA 418.1) | TPH (TX-1005) | TPH (TX-1006) | GRO (EPA 8015G) | DRO (EPA 8015D) | TDS (EPA 160.1) | Anions/Cations | Total Metals | TCLP Metals | | | |
| Floor-4 (12') | Soil | 11-9-01 | 1245 | | | | | | | | | | ✓ | ✓ | | | | | 1 | | |
| W. Wall-North-1 (6') | Soil | 11-9-01 | 1250 | | | | | | | | | | ✓ | ✓ | | | | | 1 | | |
| N. Wall-1 (6') | Soil | 11-9-01 | 1255 | | | | | | | | | | ✓ | ✓ | | | | | 1 | | |
| E. Wall-North-1 (6') | Soil | 11-9-01 | 1300 | | | | | | | | | | ✓ | ✓ | | | | | 1 | | |
| Floor-3 (7') | Soil | 11-9-01 | 1302 | | | | | | | | | | ✓ | ✓ | | | | | 1 | | |
| W. Wall-South-1 (11') | Soil | 11-9-01 | 1304 | | | | | | | | | | ✓ | ✓ | | | | | 1 | | |
| South Wall-1 (11') | Soil | 11-9-01 | 1306 | | | | | | | | | | ✓ | ✓ | | | | | 1 | | |
| E. Wall-South-1 (11') | Soil | 11-9-01 | 1308 | | | | | | | | | | ✓ | ✓ | | | | | 1 | | |
| E. Wall-Middle-1 (8') | Soil | 11-9-01 | 1310 | | | | | | | | | | ✓ | ✓ | | | | | 1 | | |
| W. Wall-Middle-1 (8') | Soil | 11-9-01 | 1314 | | | | | | | | | | ✓ | ✓ | | | | | 1 | | |
| Project Information | | | | Sample Receipt | | Relinquished By: (1) (Company) Trident Environmental | | | | Relinquished By: (2) (Company) | | | | Relinquished By: (3) (Company) | | | | | | | |
| Project Name: Duke Energy Field Services | | | | Total Containers: 10 | | (Printed Name) Gil Van Deventer | | | | (Printed Name) | | | | (Printed Name) | | | | | | | |
| Project Location: CC#7 | | | | COC Seals: | | (Signature) <i>[Signature]</i> | | | | (Signature) | | | | (Signature) | | | | | | | |
| Project Manager: Gil Van Deventer | | | | Rec'd Good Cond/Cold: 3.0°C | | (Date) 11-9-01 (Time) 1625 | | | | (Date) (Time) | | | | (Date) (Time) | | | | | | | |
| Cost Center No.: V-106 | | | | Conforms to Records: | | Received By: (1) (Company) Environmental Lab of Texas | | | | Received By: (2) (Company) | | | | Received By: (3) (Company) | | | | | | | |
| Shipping ID No.: | | | | Lab No.: | | (Printed Name) <i>[Signature]</i> | | | | (Printed Name) | | | | (Printed Name) | | | | | | | |
| Bill to (see below): Duke Energy Field Services | | | | | | (Signature) <i>[Signature]</i> | | | | (Signature) | | | | (Signature) | | | | | | | |
| Special Instructions: Attn: Steve Weathers PO Box 5493 Denver, CO 80217 | | | | | | (Date) 11/9/01 (Time) 16:25 | | | | (Date) (Time) | | | | (Date) (Time) | | | | | | | |

ENVIRONMENTAL LAB OF , INC.

"Don't Treat Your Soil Like Dirt!"

TRIDENT ENVIRONMENTAL
ATTN: GILBERT VAN DEVENTER
P.O. BOX 7624
MIDLAND, TEXAS 79708
FAX: 682-0727

Sample Type: Soil
Sample Condition: Intact/Iced/ -1.5 deg C
Project #: V-106
Project Name: Duke Energy Field Services
Project Location: CC#7

Sampling Date: 12/05/01
Receiving Date: 12/06/01
Analysis Date: 12/06/01

| ELT# | FIELD CODE | GRO C6-C10 mg/kg | DRO >C10-C28 mg/kg |
|------------|------------|------------------------|--------------------------|
| 0102157-01 | Backfill-1 | <10 | 17 |

| | | |
|-----------------------|------|------|
| QUALITY CONTROL | 483 | 556 |
| TRUE VALUE | 500 | 500 |
| % INSTRUMENT ACCURACY | 97 | 111 |
| SPIKED AMOUNT | 476 | 476 |
| ORIGINAL SAMPLE | <10 | 17 |
| SPIKE | 504 | 596 |
| SPIKE DUP | 529 | 582 |
| % EXTRACTION ACCURACY | 111 | 119 |
| BLANK | <10 | <10 |
| RPD | 4.84 | 2.38 |

Methods: EPA SW 846-8015M GRO/DRO

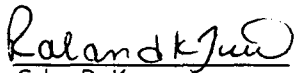
Celey D. Keene
Ralanda K. Tuttle

12-07-01
Date

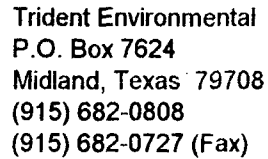

Chain of Custody

Copy signed original form for Trident Environmental records

ATTACHMENT C

FIELD BOOK NOTES

9-18-01

CCA6

Finished backfilling 9/17/01
Just needs leveling (should
be done today).

Hauled 2820 yd³ to Cell B-6
+ 2-4 loads

11-5-01

Objective: Begin CC#17 excavation
Left Midland at 0700 MST

On site at 0845 MST

Gil Van Denter (Trident)

Mike Nagley (Walton Const.)

Equipment: Trackhoe & pickup

Trident pickup, OVM, sampling equip

Started digging where there was
obvious hydrocarbon stained soil at
pipeline level (4') down to about
10' bgs. Took baggie sample for OVM
(56 ppm)

0925 (calibrated OVM before sample reading)
OVM read 99.5 ppm w/ 100 ppm calib. gas

Waiting on dozer or loader to
move soil/level area west of pipeline
so trackhoe can get in position to
excavate.

11/8/01

0530 Left Hobbs For

Project Location

- Stopped For Field Supplies

0600 Arrive Clay Cooper

#7 (CC#7) Site

Objective: Site Investigation

+ Collect Soil Samples

Equipment: PPE, Pecon,

PEP, Sampling Equipment

Weather: Mostly Sunny +

Clear, Cool (Temp ~ 45°F)

Strong N. Winds + Blowing

Dust

Personnel: John Ferguson +

Trident

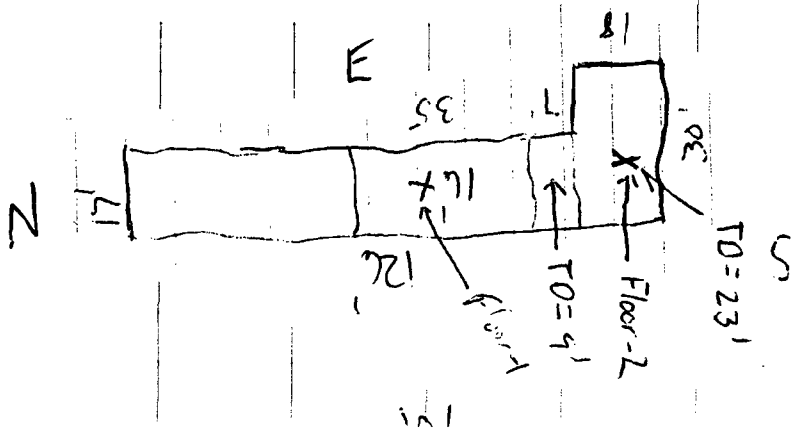

11/8/01

Walton Equipment

- 850C John Deere Dozer

- SE210 Samsung Tractor

- L90C Volvo Loader

0800 Roy (Walton)

Arrived @ Location

0810 Mike (Walton)

Arrived @ Location

- Discussion w/ Roy + Mike indicated that excavation is not ready for sampling

- Mike Believes Wall of Excavation are Clean But are Not Ready for Sampling.

- Strong Wind Overnight

- has blown sand into

Excavation

0820 Took Grab Floor Sample (Floor-2) @ 23'

- Sample #01108 0820

- Taken From Southermost

Excavation

- PID Reading = 1.4 ppm

0845 Left Location For Hobbs

11-9-01
1030 MST
Left Midland for CC#7 site.

Left Midland for CC #7 site -

equipment: OVM, digital camera, wonder wheel, sampling tools etc.

Arrive at CC#7 site

159) View facing SE showing east & south walls of southernmost excavation.

1592 View facing NW showing west & north walls of southernmost room.

1543 View facing north showing all of exc.

194 12 12 50th Spring Initial Countdown
PCC

1598 View facing north showing northern
most ex. (west & north walls)

1396 V. in long ^{box} ~~SA~~ shangs east wall &
south trench at northernmost exc.

1597 View facing south showing complete ex.

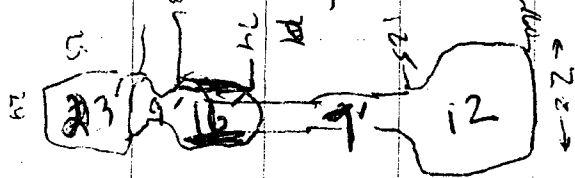

Hand-drawn floor plan of a building, oriented with South at the top and North at the bottom. The plan shows four floors with various dimensions and wall locations.

Dimensions and Layout:

- Overall Width:** 28' (indicated at the bottom).
- Floor 4 (12'):** The top floor, with a width of 28'.
- Floor 3 (7'):** The third floor, with a width of 28'.
- Floor 2 (23'):** The second floor, with a width of 23'.
- Floor 1 (16'):** The first floor, with a width of 16'.
- Vertical Dimensions:**
 - From the top of Floor 4 to the top of Floor 3: 51'.
 - From the top of Floor 3 to the top of Floor 2: 35'.
 - From the top of Floor 2 to the top of Floor 1: 38'.
 - From the top of Floor 1 to the top of Floor 4: 25'.

Wall Locations and Dimensions:

- South Wall:** Located at the top of the plan, with a width of 24'.
- West Wall South:** Located on the right side of the plan, with a width of 11'.
- West Wall Middle:** Located on the right side of the plan, with a width of 8'.
- West Wall North:** Located on the right side of the plan, with a width of 6'.
- East Wall Middle:** Located on the left side of the plan, with a width of 8'.
- East Wall North:** Located on the left side of the plan, with a width of 6'.

Other Labels:

- South:** Indicated at the top of the plan.
- North:** Indicated at the bottom of the plan.
- East:** Indicated on the left side of the plan.
- West:** Indicated on the right side of the plan.
- Scale:** A scale bar at the top left indicates 0, 20, and 40 feet.

More pictures:

1398 South stockpile (clean)
&
~~1399~~ Middle stockpile (dirty)

~~1400 North stockpile (clean)~~

Grab Samples Collected:

| Sample ID | Time | OVM |
|-----------------------|------|-----|
| MM-Floor-4 (12') | 1245 | 0.0 |
| W. Wall North (6') | 1250 | 0.0 |
| N. Wall-1 (6') | 1255 | 0.0 |
| E. Wall North-1 (6') | 1300 | 0.0 |
| Floor-3 (7') | 1302 | 0.0 |
| W. Wall-South (11') | 1304 | 0.0 |
| South Wall (11') | 1306 | 0.0 |
| E. Wall-South (11') | 1308 | 0.0 |
| E. Wall-Middle (8') | 1310 | 0.0 |
| W. Wall-Middle-1 (8') | 1314 | 0.0 |

OVM calibrat. on 103ppm before sampling
" " " " after " "

11-28-01

Ray with Walton called to say that 1620 yd³ (135 loads) of soil was transported to S. Monument land farm from CC#7

He said they probably would start the next site CC#8 late next week