



CONOCOPHILLIPS

P.O. Box 2197
Houston, TX 77252-2197
Phone 281.293.1000

MCA Well #417

Termination Request

API No. 3002538985

Release Date: December 27th, 2013

Unit Letter M, Section 27, Township 17S, Range 32E

May 21st, 2014

Geoffrey Leking

New Mexico Energy, Minerals, & Natural Resources
Oil Conservation Division, Environmental Bureau – District 1
1625 N. French Dr.
Hobbs, NM 88240-9273

**RE: Termination Request
ConocoPhillips – MCA Well #417
UL/M sec. 27 T17S R32E
API No. 3002538985**

Mr. Leking:

ConocoPhillips (CoP) has retained Rice Environmental Consulting and Safety (RECS) to address potential environmental concerns at the above-referenced site.

Background and Previous Work

The site is located approximately 4 miles south of Maljamar, New Mexico at UL/M sec. 27 T17S R32E. NM OSE records indicate that groundwater will likely be encountered at a depth of approximately 81 +/- feet.

On December 27th, 2013, CoP discovered a release from a 3 inch flex line. A small hole developed in the line releasing 16 barrels of produced water over 2,912 square feet of lease pad. A vacuum truck was called to the site and recovered 14 barrels of produced water. CoP notified BLM and NMOCD of the release on December 27th, 2013 and submitted an initial C-141 to NMOCD for their approval (Appendix A).

RECS personnel were on site beginning on January 3rd, 2014 to assess the release. Two points were sampled within the release area at the surface and with depth, and representative samples were taken to a commercial laboratory for analysis (Figure 1). Laboratory analysis showed elevated chloride levels at Point 1 to 1 ft and at Point 2 to 6 inches. Gasoline Range Organics (GRO) readings, Diesel Range Organics (DRO) readings and BTEX readings were non-detect at all depth at both points (Appendix B).

Based on the laboratory analysis, a Corrective Action Plan (CAP) for the release was developed and submitted to NMOCD and BLM on February 11th, 2014. BLM approved the CAP on February 14th, 2014, and NMOCD approved the CAP on April 10th, 2014. The CAP said that the release area would be excavated to a depth of 1 - 1.5 ft bgs. All excavated soil would be taken to a NMOCD approved facility for disposal. At the base of the excavation, a 5 point bottom composite sample would be taken and sent to a commercial laboratory for analysis to prove that

all constituents were below regulatory standards. Clean caliche would be imported to the site to serve as backfill. The excavation would be backfilled with the caliche and contoured to the surrounding location.

NMOCD approved the CAP with a stipulation. The stipulation requested that after the excavation was completed, a confirmation sample at Point 2 and a composite sample of the entire excavation needed to be completed.

CAP activities began at the site on April 24th, 2014. The site was scraped down to 1 ft bgs on the west side of the release and to 1.5 ft bgs on the east side of the release (Figure 2). A total of 160 cubic yards of contaminated soil was taken to a NMOCD approved facility for disposal. At the base of the scrape a 5 point bottom composite was taken and field tested for chlorides and organic vapors. The sample was then taken to a commercial laboratory for field verification. The 5 point bottom composite returned a laboratory chloride reading of 16 mg/kg and non-detect for GRO, DRO and BTEX (Appendix C). As requested by NMOCD, grab samples were taken at Point 1 and Point 2 and field tested for chlorides and hydrocarbons. The samples were then taken to a commercial laboratory for field verification. Point 1 returned a laboratory chloride reading of 32 mg/kg and Point 2 returned a laboratory chloride reading of non-detect. Both samples returned GRO, DRO and BTEX readings of non-detect.

NMOCD approved the site to be backfilled on May 1st, 2014. A total of 160 yards of clean caliche was imported to the site to serve as backfill. The site was backfilled with the caliche, and the area was contoured to the surrounding location.

Photo documentation of all activities can be found in Appendix D.

Given that CoP has scraped the site per the approved CAP and backfilled the site with clean, imported caliche, CoP respectfully requests 'remediation termination' and site closure. A final C-141 for this site can be found in Appendix E.

RECS appreciates the opportunity to work with you on this project. Please call Hack Conder at (575) 393-2967 or me if you have any questions or wish to discuss the site.

Sincerely,

A handwritten signature in cursive script, appearing to read 'Lara Weinheimer'.

Lara Weinheimer
Project Scientist
RECS
(575) 441-0431

Attachments:

Figure 1 – Initial Sampling Data

Figure 2 – Excavation Data

Appendix A – Initial C-141
Appendix B – Initial Sampling Lab
Appendix C – CAP Sampling Lab
Appendix D – Photo Documentation
Appendix E – Final C-141

Figures

Initial Sampling Data

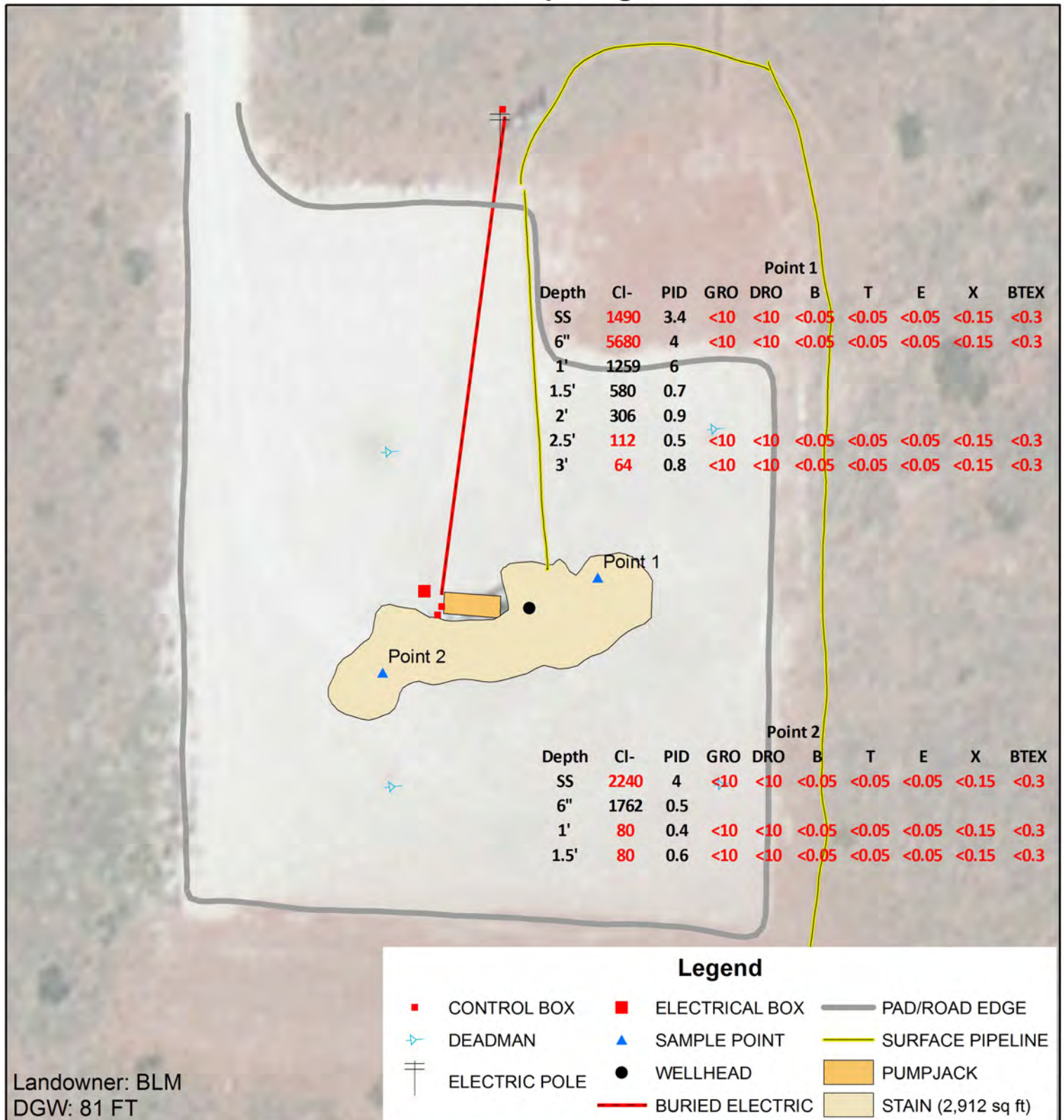

CONOCO PHILLIPS MCA WELL #417

UL M SECTION 27
T-17-S R-32-E
LEA COUNTY, NM

Figure 1



0 25 50
Feet

GPS date: 1/3/14 CF
Drawing date: 1/14/14
Drafted by: L. Weinheimer

Excavation Data

Pt. 1 Bottom @ 1.5 FT

CI-	PID	GRO	DRO	B	T	E	X	BTEX
32	1.2	<10	<10	<0.05	<0.05	<0.05	<0.15	<0.3

Pt. 2 Bottom @ 1 FT

CI-	PID	GRO	DRO	B	T	E	X	BTEX
<16	3	<10	<10	<0.05	<0.05	<0.05	<0.15	<0.3

5 Pt. Bottom Comp. @ 1 - 1.5 FT

CI-	PID	GRO	DRO	B	T	E	X	BTEX
16	1.4	<10	<10	<0.05	<0.05	<0.05	<0.15	<0.3

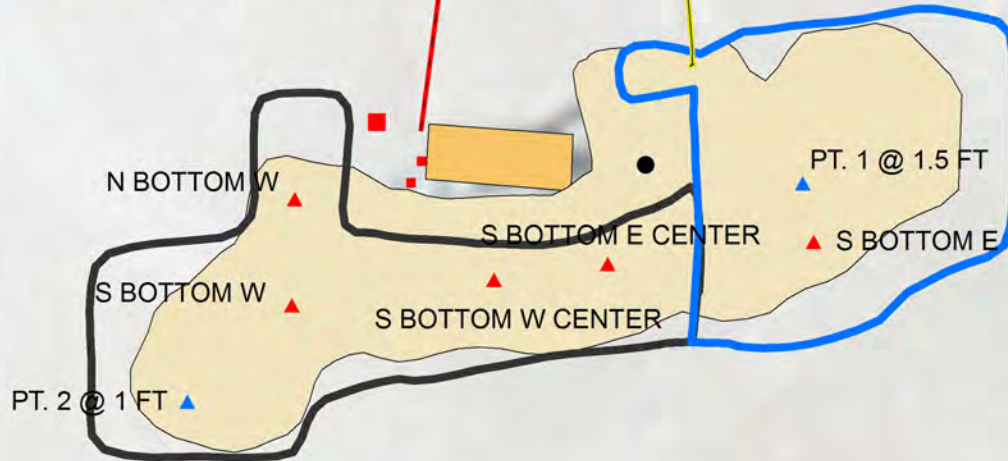

Legend

- | | | |
|----------------------------|-------------------|-----------------------|
| ▲ 5 PT. COMP SAMPLE POINTS | ⚡ ELECTRIC POLE | — PAD/ROAD EDGE |
| ▲ GRAB SAMPLE POINTS | ■ ELECTRICAL BOX | — SURFACE PIPELINE |
| ■ CONTROL BOX | ● WELLHEAD | ▭ EXCAVATION @ 1.5 FT |
| ⚡ DEADMAN | — BURIED ELECTRIC | ▭ EXCAVATION @ 1 FT |
| | | ■ PUMPJACK |
| | | ■ STAIN (2,912 sq ft) |

Landowner: BLM
DGW: 81 FT



CONOCO PHILLIPS MCA WELL #417

UL M SECTION 27
T-17-S R-32-E
LEA COUNTY, NM

Figure 2



0 10 20
Feet

GPS date: 4/24/14 CF
Drawing date: 4/28/14
Drafted by: L. Weinheimer

Appendix A

Initial C-141

District I
1625 N. French Dr., Hobbs, NM 88240
District II
811 S. First St., Artesia, NM 88210
District III
1000 Rio Brazos Road, Aztec, NM 87410
District IV
1220 S. St. Francis Dr., Santa Fe, NM 87505

State of New Mexico
Energy Minerals and Natural Resources

Form C-141
Revised August 8, 2011

Oil Conservation Division
1220 South St. Francis Dr.
Santa Fe, NM 87505

Submit 1 Copy to appropriate District Office in
accordance with 19.15.29 NMAC.

Release Notification and Corrective Action

OPERATOR

☒ Initial Report ☐ Final Report

Name of Company: ConocoPhillips	Contact: David May	
Address: 29 Vacuum Complex Lane	Telephone No. 575-391-3106/575-631-5907	
Facility Name: MCA well #417	Facility Type: oil Well	
Surface Owner: BLM	Mineral Owner BLM	API No. 3002538985

LOCATION OF RELEASE

Unit Letter M	Section 27	Township 17S	Range 32E	Feet from the 90	North/South Line South	Feet from the 1660	East/West Line West	County LEA
------------------	---------------	-----------------	--------------	---------------------	---------------------------	-----------------------	------------------------	---------------

Latitude 32.7985274628581

Longitude - 103.76068793867

NATURE OF RELEASE

Type of Release: Spill	Volume of Release: 16 BBLS	Volume Recovered: 14 BBLS
Source of Release: 3 inch Flex Line	Date and Hour of Occurrence 12/27/13 9:00 am	Date and Hour of Discovery SAME
Was Immediate Notice Given? <input checked="" type="checkbox"/> Yes <input type="checkbox"/> No <input type="checkbox"/> Not Required	If YES, To Whom? Jim Amos/Geoffrey Leking	
By Whom? David May	Date and Hour: 12/27/13 1:30 pm	
Was a Watercourse Reached? <input type="checkbox"/> Yes <input checked="" type="checkbox"/> No	If YES, Volume Impacting the Watercourse.	
If a Watercourse was Impacted, Describe Fully.*		
Describe Cause of Problem and Remedial Action Taken.* MSO responded to a leak on a 3 inch flex flow line for the MCA well # 417 due to a small hole in the line. MSO shut in and isolated well and submitted work order for repairs.		
Describe Area Affected and Cleanup Action Taken.* Affected area was 170 Ft X 15 Ft all on caliche pad and will be remediated according to BLM and NMOCD guidelines		
I hereby certify that the information given above is true and complete to the best of my knowledge and understand that pursuant to NMOCD rules and regulations all operators are required to report and/or file certain release notifications and perform corrective actions for releases which may endanger public health or the environment. The acceptance of a C-141 report by the NMOCD marked as "Final Report" does not relieve the operator of liability should their operations have failed to adequately investigate and remediate contamination that pose a threat to ground water, surface water, human health or the environment. In addition, NMOCD acceptance of a C-141 report does not relieve the operator of responsibility for compliance with any other federal, state, or local laws and/or regulations.		

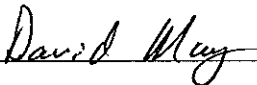
Signature: 		<u>OIL CONSERVATION DIVISION</u>	
Printed Name: David May		Approved by Environmental Specialist:	
Title: LEAD HSE	Approval Date:	Expiration Date:	
E-mail Address: david.d.may@conocophillips.com	Conditions of Approval:		Attached <input type="checkbox"/>
Date: 12/27/2013	Phone: 575-391-3106		

* Attach Additional Sheets If Necessary

Appendix B

Initial Sampling Lab

RICE Environmental Consulting and Safety (RECS)
P.O. Box 2948 Hobbs, NM 88241
Phone 575.393.2967



PHONE (575) 393-2326 ° 101 E. MARLAND ° HOBBS, NM 88240

January 14, 2014

JACOB KAMPLAIN

RICE ENVIRONMENTAL CONSULTING & SAFETY LLC

419 W. CAIN

HOBBS, NM 88240

RE: MCA #417

Enclosed are the results of analyses for samples received by the laboratory on 01/08/14 16:35.

Cardinal Laboratories is accredited through Texas NELAP under certificate number T104704398-13-5. Accreditation applies to drinking water, non-potable water and solid and chemical materials. All accredited analytes are denoted by an asterisk (*). For a complete list of accredited analytes and matrices visit the TCEQ website at www.tceq.texas.gov/field/qa/lab_accred_certif.html.

Cardinal Laboratories is accredited through the State of Colorado Department of Public Health and Environment for:

Method EPA 552.2	Haloacetic Acids (HAA-5)
Method EPA 524.2	Total Trihalomethanes (TTHM)
Method EPA 524.4	Regulated VOCs (V1, V2, V3)

Accreditation applies to public drinking water matrices.

This report meets NELAP requirements and is made up of a cover page, analytical results, and a copy of the original chain-of-custody. If you have any questions concerning this report, please feel free to contact me.

Sincerely,

A handwritten signature in black ink that reads "Celey D. Keene". The signature is written in a cursive, flowing style.

Celey D. Keene

Lab Director/Quality Manager

Analytical Results For:

RICE ENVIRONMENTAL CONSULTING & SAFETY
JACOB KAMPLAIN
419 W. CAIN
HOBBS NM, 88240
Fax To: (575) 397-1471

Received: 01/08/2014
Reported: 01/14/2014
Project Name: MCA #417
Project Number: NONE GIVEN
Project Location: CONOCO PHILLIPS

Sampling Date: 01/03/2014
Sampling Type: Soil
Sampling Condition: Cool & Intact
Sample Received By: Jodi Henson

Sample ID: POINT 1 @ SURFACE (H400064-01)

BTX 8021B		mg/kg		Analyzed By: MS					
Analyte	Result	Reporting Limit	Analyzed	Method Blank	BS	% Recovery	True Value QC	RPD	Qualifier
Benzene*	<0.050	0.050	01/13/2014	ND	2.09	105	2.00	3.68	
Toluene*	<0.050	0.050	01/13/2014	ND	2.06	103	2.00	3.76	
Ethylbenzene*	<0.050	0.050	01/13/2014	ND	2.10	105	2.00	3.52	
Total Xylenes*	<0.150	0.150	01/13/2014	ND	6.12	102	6.00	3.11	
Total BTX	<0.300	0.300	01/13/2014	ND					

Surrogate: 4-Bromofluorobenzene (PID) 105 % 89.4-126

Chloride, SM4500Cl-B		mg/kg		Analyzed By: AP					
Analyte	Result	Reporting Limit	Analyzed	Method Blank	BS	% Recovery	True Value QC	RPD	Qualifier
Chloride	1490	16.0	01/13/2014	ND	416	104	400	0.00	

TPH 8015M		mg/kg		Analyzed By: ms					
Analyte	Result	Reporting Limit	Analyzed	Method Blank	BS	% Recovery	True Value QC	RPD	Qualifier
GRO C6-C10	<10.0	10.0	01/11/2014	ND	190	94.8	200	1.69	
DRO >C10-C28	<10.0	10.0	01/11/2014	ND	195	97.7	200	2.06	

Surrogate: 1-Chlorooctane 115 % 65.2-140

Surrogate: 1-Chlorooctadecane 115 % 63.6-154

Cardinal Laboratories

*=Accredited Analyte

PLEASE NOTE: Liability and Damages. Cardinal's liability and client's exclusive remedy for any claim arising, whether based in contract or tort, shall be limited to the amount paid by client for analyses. All claims, including those for negligence and any other cause whatsoever shall be deemed waived unless made in writing and received by Cardinal within thirty (30) days after completion of the applicable service. In no event shall Cardinal be liable for incidental or consequential damages, including, without limitation, business interruptions, loss of use, or loss of profits incurred by client, its subsidiaries, affiliates or successors arising out of or related to the performance of the services hereunder by Cardinal, regardless of whether such claim is based upon any of the above stated reasons or otherwise. Results relate only to the samples identified above. This report shall not be reproduced except in full with written approval of Cardinal Laboratories.



Celey D. Keene, Lab Director/Quality Manager

Analytical Results For:

 RICE ENVIRONMENTAL CONSULTING & SAFETY
 JACOB KAMPLAIN
 419 W. CAIN
 HOBBS NM, 88240
 Fax To: (575) 397-1471

 Received: 01/08/2014
 Reported: 01/14/2014
 Project Name: MCA #417
 Project Number: NONE GIVEN
 Project Location: CONOCO PHILLIPS

 Sampling Date: 01/03/2014
 Sampling Type: Soil
 Sampling Condition: Cool & Intact
 Sample Received By: Jodi Henson

Sample ID: POINT 1 @ 6" (H400064-02)

BTX 8021B		mg/kg		Analyzed By: MS					
Analyte	Result	Reporting Limit	Analyzed	Method Blank	BS	% Recovery	True Value QC	RPD	Qualifier
Benzene*	<0.050	0.050	01/10/2014	ND	1.92	96.1	2.00	2.06	
Toluene*	<0.050	0.050	01/10/2014	ND	1.89	94.6	2.00	2.20	
Ethylbenzene*	<0.050	0.050	01/10/2014	ND	1.93	96.4	2.00	2.32	
Total Xylenes*	<0.150	0.150	01/10/2014	ND	5.63	93.8	6.00	2.42	
Total BTX	<0.300	0.300	01/10/2014	ND					

Surrogate: 4-Bromofluorobenzene (PID) 103 % 89.4-126

Chloride, SM4500CI-B		mg/kg		Analyzed By: AP					
Analyte	Result	Reporting Limit	Analyzed	Method Blank	BS	% Recovery	True Value QC	RPD	Qualifier
Chloride	5680	16.0	01/13/2014	ND	416	104	400	0.00	

TPH 8015M		mg/kg		Analyzed By: ms					
Analyte	Result	Reporting Limit	Analyzed	Method Blank	BS	% Recovery	True Value QC	RPD	Qualifier
GRO C6-C10	<10.0	10.0	01/11/2014	ND	190	94.8	200	1.69	
DRO >C10-C28	<10.0	10.0	01/11/2014	ND	195	97.7	200	2.06	

Surrogate: 1-Chlorooctane 91.8 % 65.2-140

Surrogate: 1-Chlorooctadecane 91.8 % 63.6-154

Cardinal Laboratories

*=Accredited Analyte

PLEASE NOTE: Liability and Damages. Cardinal's liability and client's exclusive remedy for any claim arising, whether based in contract or tort, shall be limited to the amount paid by client for analyses. All claims, including those for negligence and any other cause whatsoever shall be deemed waived unless made in writing and received by Cardinal within thirty (30) days after completion of the applicable service. In no event shall Cardinal be liable for incidental or consequential damages, including, without limitation, business interruptions, loss of use, or loss of profits incurred by client, its subsidiaries, affiliates or successors arising out of or related to the performance of the services hereunder by Cardinal, regardless of whether such claim is based upon any of the above stated reasons or otherwise. Results relate only to the samples identified above. This report shall not be reproduced except in full with written approval of Cardinal Laboratories.



Celey D. Keene, Lab Director/Quality Manager

Analytical Results For:

 RICE ENVIRONMENTAL CONSULTING & SAFETY
 JACOB KAMPLAIN
 419 W. CAIN
 HOBBS NM, 88240
 Fax To: (575) 397-1471

 Received: 01/08/2014
 Reported: 01/14/2014
 Project Name: MCA #417
 Project Number: NONE GIVEN
 Project Location: CONOCO PHILLIPS

 Sampling Date: 01/03/2014
 Sampling Type: Soil
 Sampling Condition: Cool & Intact
 Sample Received By: Jodi Henson

Sample ID: POINT 1 @ 2.5' (H400064-03)

BTX 8021B		mg/kg		Analyzed By: MS					
Analyte	Result	Reporting Limit	Analyzed	Method Blank	BS	% Recovery	True Value QC	RPD	Qualifier
Benzene*	<0.050	0.050	01/10/2014	ND	1.92	96.1	2.00	2.06	
Toluene*	<0.050	0.050	01/10/2014	ND	1.89	94.6	2.00	2.20	
Ethylbenzene*	<0.050	0.050	01/10/2014	ND	1.93	96.4	2.00	2.32	
Total Xylenes*	<0.150	0.150	01/10/2014	ND	5.63	93.8	6.00	2.42	
Total BTX	<0.300	0.300	01/10/2014	ND					

Surrogate: 4-Bromofluorobenzene (PID) 104 % 89.4-126

Chloride, SM4500Cl-B		mg/kg		Analyzed By: AP					
Analyte	Result	Reporting Limit	Analyzed	Method Blank	BS	% Recovery	True Value QC	RPD	Qualifier
Chloride	112	16.0	01/13/2014	ND	416	104	400	0.00	

TPH 8015M		mg/kg		Analyzed By: ms					
Analyte	Result	Reporting Limit	Analyzed	Method Blank	BS	% Recovery	True Value QC	RPD	Qualifier
GRO C6-C10	<10.0	10.0	01/11/2014	ND	190	94.8	200	1.69	
DRO >C10-C28	<10.0	10.0	01/11/2014	ND	195	97.7	200	2.06	

Surrogate: 1-Chlorooctane 79.6 % 65.2-140

Surrogate: 1-Chlorooctadecane 87.8 % 63.6-154

Cardinal Laboratories

*=Accredited Analyte

PLEASE NOTE: Liability and Damages. Cardinal's liability and client's exclusive remedy for any claim arising, whether based in contract or tort, shall be limited to the amount paid by client for analyses. All claims, including those for negligence and any other cause whatsoever shall be deemed waived unless made in writing and received by Cardinal within thirty (30) days after completion of the applicable service. In no event shall Cardinal be liable for incidental or consequential damages, including, without limitation, business interruptions, loss of use, or loss of profits incurred by client, its subsidiaries, affiliates or successors arising out of or related to the performance of the services hereunder by Cardinal, regardless of whether such claim is based upon any of the above stated reasons or otherwise. Results relate only to the samples identified above. This report shall not be reproduced except in full with written approval of Cardinal Laboratories.



Celey D. Keene, Lab Director/Quality Manager

Analytical Results For:

 RICE ENVIRONMENTAL CONSULTING & SAFETY
 JACOB KAMPLAIN
 419 W. CAIN
 HOBBS NM, 88240
 Fax To: (575) 397-1471

 Received: 01/08/2014
 Reported: 01/14/2014
 Project Name: MCA #417
 Project Number: NONE GIVEN
 Project Location: CONOCO PHILLIPS

 Sampling Date: 01/03/2014
 Sampling Type: Soil
 Sampling Condition: Cool & Intact
 Sample Received By: Jodi Henson

Sample ID: POINT 1 @ 3' (H400064-04)

BTX 8021B		mg/kg		Analyzed By: MS					
Analyte	Result	Reporting Limit	Analyzed	Method Blank	BS	% Recovery	True Value QC	RPD	Qualifier
Benzene*	<0.050	0.050	01/10/2014	ND	1.92	96.1	2.00	2.06	
Toluene*	<0.050	0.050	01/10/2014	ND	1.89	94.6	2.00	2.20	
Ethylbenzene*	<0.050	0.050	01/10/2014	ND	1.93	96.4	2.00	2.32	
Total Xylenes*	<0.150	0.150	01/10/2014	ND	5.63	93.8	6.00	2.42	
Total BTX	<0.300	0.300	01/10/2014	ND					

Surrogate: 4-Bromofluorobenzene (PID) 104 % 89.4-126

Chloride, SM4500Cl-B		mg/kg		Analyzed By: AP					
Analyte	Result	Reporting Limit	Analyzed	Method Blank	BS	% Recovery	True Value QC	RPD	Qualifier
Chloride	64.0	16.0	01/13/2014	ND	416	104	400	0.00	

TPH 8015M		mg/kg		Analyzed By: ms					
Analyte	Result	Reporting Limit	Analyzed	Method Blank	BS	% Recovery	True Value QC	RPD	Qualifier
GRO C6-C10	<10.0	10.0	01/13/2014	ND	185	92.4	200	6.28	
DRO >C10-C28	<10.0	10.0	01/13/2014	ND	192	96.2	200	8.34	

Surrogate: 1-Chlorooctane 91.0 % 65.2-140

Surrogate: 1-Chlorooctadecane 103 % 63.6-154

Cardinal Laboratories

*=Accredited Analyte

PLEASE NOTE: Liability and Damages. Cardinal's liability and client's exclusive remedy for any claim arising, whether based in contract or tort, shall be limited to the amount paid by client for analyses. All claims, including those for negligence and any other cause whatsoever shall be deemed waived unless made in writing and received by Cardinal within thirty (30) days after completion of the applicable service. In no event shall Cardinal be liable for incidental or consequential damages, including, without limitation, business interruptions, loss of use, or loss of profits incurred by client, its subsidiaries, affiliates or successors arising out of or related to the performance of the services hereunder by Cardinal, regardless of whether such claim is based upon any of the above stated reasons or otherwise. Results relate only to the samples identified above. This report shall not be reproduced except in full with written approval of Cardinal Laboratories.



Celey D. Keene, Lab Director/Quality Manager

Analytical Results For:

RICE ENVIRONMENTAL CONSULTING & SAFETY
JACOB KAMPLAIN
419 W. CAIN
HOBBS NM, 88240
Fax To: (575) 397-1471

Received: 01/08/2014
Reported: 01/14/2014
Project Name: MCA #417
Project Number: NONE GIVEN
Project Location: CONOCO PHILLIPS

Sampling Date: 01/03/2014
Sampling Type: Soil
Sampling Condition: Cool & Intact
Sample Received By: Jodi Henson

Sample ID: POINT 2 @ SURFACE (H400064-05)

BTEx 8021B		mg/kg		Analyzed By: MS					
Analyte	Result	Reporting Limit	Analyzed	Method Blank	BS	% Recovery	True Value QC	RPD	Qualifier
Benzene*	<0.050	0.050	01/13/2014	ND	2.09	105	2.00	3.68	
Toluene*	<0.050	0.050	01/13/2014	ND	2.06	103	2.00	3.76	
Ethylbenzene*	<0.050	0.050	01/13/2014	ND	2.10	105	2.00	3.52	
Total Xylenes*	<0.150	0.150	01/13/2014	ND	6.12	102	6.00	3.11	
Total BTEx	<0.300	0.300	01/13/2014	ND					

Surrogate: 4-Bromofluorobenzene (PID) 104 % 89.4-126

Chloride, SM4500Cl-B		mg/kg		Analyzed By: AP					
Analyte	Result	Reporting Limit	Analyzed	Method Blank	BS	% Recovery	True Value QC	RPD	Qualifier
Chloride	2240	16.0	01/13/2014	ND	416	104	400	0.00	

TPH 8015M		mg/kg		Analyzed By: ms					
Analyte	Result	Reporting Limit	Analyzed	Method Blank	BS	% Recovery	True Value QC	RPD	Qualifier
GRO C6-C10	<10.0	10.0	01/14/2014	ND	185	92.4	200	6.28	
DRO >C10-C28	<10.0	10.0	01/14/2014	ND	192	96.2	200	8.34	

Surrogate: 1-Chlorooctane 94.6 % 65.2-140

Surrogate: 1-Chlorooctadecane 95.3 % 63.6-154

Cardinal Laboratories

*=Accredited Analyte

PLEASE NOTE: Liability and Damages. Cardinal's liability and client's exclusive remedy for any claim arising, whether based in contract or tort, shall be limited to the amount paid by client for analyses. All claims, including those for negligence and any other cause whatsoever shall be deemed waived unless made in writing and received by Cardinal within thirty (30) days after completion of the applicable service. In no event shall Cardinal be liable for incidental or consequential damages, including, without limitation, business interruptions, loss of use, or loss of profits incurred by client, its subsidiaries, affiliates or successors arising out of or related to the performance of the services hereunder by Cardinal, regardless of whether such claim is based upon any of the above stated reasons or otherwise. Results relate only to the samples identified above. This report shall not be reproduced except in full with written approval of Cardinal Laboratories.



Celey D. Keene, Lab Director/Quality Manager

Analytical Results For:

RICE ENVIRONMENTAL CONSULTING & SAFETY
JACOB KAMPLAIN
419 W. CAIN
HOBBS NM, 88240
Fax To: (575) 397-1471

Received: 01/08/2014
Reported: 01/14/2014
Project Name: MCA #417
Project Number: NONE GIVEN
Project Location: CONOCO PHILLIPS

Sampling Date: 01/03/2014
Sampling Type: Soil
Sampling Condition: Cool & Intact
Sample Received By: Jodi Henson

Sample ID: POINT 2 @ 1' (H400064-06)

BTX 8021B		mg/kg		Analyzed By: MS					
Analyte	Result	Reporting Limit	Analyzed	Method Blank	BS	% Recovery	True Value QC	RPD	Qualifier
Benzene*	<0.050	0.050	01/10/2014	ND	1.92	96.1	2.00	2.06	
Toluene*	<0.050	0.050	01/10/2014	ND	1.89	94.6	2.00	2.20	
Ethylbenzene*	<0.050	0.050	01/10/2014	ND	1.93	96.4	2.00	2.32	
Total Xylenes*	<0.150	0.150	01/10/2014	ND	5.63	93.8	6.00	2.42	
Total BTX	<0.300	0.300	01/10/2014	ND					

Surrogate: 4-Bromofluorobenzene (PID) 103 % 89.4-126

Chloride, SM4500CI-B		mg/kg		Analyzed By: AP					
Analyte	Result	Reporting Limit	Analyzed	Method Blank	BS	% Recovery	True Value QC	RPD	Qualifier
Chloride	80.0	16.0	01/13/2014	ND	416	104	400	0.00	

TPH 8015M		mg/kg		Analyzed By: ms					
Analyte	Result	Reporting Limit	Analyzed	Method Blank	BS	% Recovery	True Value QC	RPD	Qualifier
GRO C6-C10	<10.0	10.0	01/12/2014	ND	170	84.8	200	9.62	
DRO >C10-C28	<10.0	10.0	01/12/2014	ND	170	84.8	200	13.1	

Surrogate: 1-Chlorooctane 103 % 65.2-140

Surrogate: 1-Chlorooctadecane 106 % 63.6-154

Cardinal Laboratories

*=Accredited Analyte

PLEASE NOTE: Liability and Damages. Cardinal's liability and client's exclusive remedy for any claim arising, whether based in contract or tort, shall be limited to the amount paid by client for analyses. All claims, including those for negligence and any other cause whatsoever shall be deemed waived unless made in writing and received by Cardinal within thirty (30) days after completion of the applicable service. In no event shall Cardinal be liable for incidental or consequential damages, including, without limitation, business interruptions, loss of use, or loss of profits incurred by client, its subsidiaries, affiliates or successors arising out of or related to the performance of the services hereunder by Cardinal, regardless of whether such claim is based upon any of the above stated reasons or otherwise. Results relate only to the samples identified above. This report shall not be reproduced except in full with written approval of Cardinal Laboratories.



Celey D. Keene, Lab Director/Quality Manager

Analytical Results For:

 RICE ENVIRONMENTAL CONSULTING & SAFETY
 JACOB KAMPLAIN
 419 W. CAIN
 HOBBS NM, 88240
 Fax To: (575) 397-1471

 Received: 01/08/2014
 Reported: 01/14/2014
 Project Name: MCA #417
 Project Number: NONE GIVEN
 Project Location: CONOCO PHILLIPS

 Sampling Date: 01/03/2014
 Sampling Type: Soil
 Sampling Condition: Cool & Intact
 Sample Received By: Jodi Henson

Sample ID: POINT 2 @ 1.5' (H400064-07)

BTEx 8021B		mg/kg		Analyzed By: MS					
Analyte	Result	Reporting Limit	Analyzed	Method Blank	BS	% Recovery	True Value QC	RPD	Qualifier
Benzene*	<0.050	0.050	01/13/2014	ND	2.09	105	2.00	3.68	
Toluene*	<0.050	0.050	01/13/2014	ND	2.06	103	2.00	3.76	
Ethylbenzene*	<0.050	0.050	01/13/2014	ND	2.10	105	2.00	3.52	
Total Xylenes*	<0.150	0.150	01/13/2014	ND	6.12	102	6.00	3.11	
Total BTEx	<0.300	0.300	01/13/2014	ND					

Surrogate: 4-Bromofluorobenzene (PID) 104 % 89.4-126

Chloride, SM4500Cl-B		mg/kg		Analyzed By: AP					
Analyte	Result	Reporting Limit	Analyzed	Method Blank	BS	% Recovery	True Value QC	RPD	Qualifier
Chloride	80.0	16.0	01/13/2014	ND	416	104	400	0.00	

TPH 8015M		mg/kg		Analyzed By: ms					
Analyte	Result	Reporting Limit	Analyzed	Method Blank	BS	% Recovery	True Value QC	RPD	Qualifier
GRO C6-C10	<10.0	10.0	01/12/2014	ND	170	84.8	200	9.62	
DRO >C10-C28	<10.0	10.0	01/12/2014	ND	170	84.8	200	13.1	

Surrogate: 1-Chlorooctane 93.3 % 65.2-140

Surrogate: 1-Chlorooctadecane 106 % 63.6-154

Cardinal Laboratories

*=Accredited Analyte

PLEASE NOTE: Liability and Damages. Cardinal's liability and client's exclusive remedy for any claim arising, whether based in contract or tort, shall be limited to the amount paid by client for analyses. All claims, including those for negligence and any other cause whatsoever shall be deemed waived unless made in writing and received by Cardinal within thirty (30) days after completion of the applicable service. In no event shall Cardinal be liable for incidental or consequential damages, including, without limitation, business interruptions, loss of use, or loss of profits incurred by client, its subsidiaries, affiliates or successors arising out of or related to the performance of the services hereunder by Cardinal, regardless of whether such claim is based upon any of the above stated reasons or otherwise. Results relate only to the samples identified above. This report shall not be reproduced except in full with written approval of Cardinal Laboratories.



Celey D. Keene, Lab Director/Quality Manager

Notes and Definitions

ND	Analyte NOT DETECTED at or above the reporting limit
RPD	Relative Percent Difference
**	Samples not received at proper temperature of 6°C or below.
***	Insufficient time to reach temperature.
-	Chloride by SM4500Cl-B does not require samples be received at or below 6°C Samples reported on an as received basis (wet) unless otherwise noted on report

Cardinal Laboratories

*=Accredited Analyte

PLEASE NOTE: Liability and Damages. Cardinal's liability and client's exclusive remedy for any claim arising, whether based in contract or tort, shall be limited to the amount paid by client for analyses. All claims, including those for negligence and any other cause whatsoever shall be deemed waived unless made in writing and received by Cardinal within thirty (30) days after completion of the applicable service. In no event shall Cardinal be liable for incidental or consequential damages, including, without limitation, business interruptions, loss of use, or loss of profits incurred by client, its subsidiaries, affiliates or successors arising out of or related to the performance of the services hereunder by Cardinal, regardless of whether such claim is based upon any of the above stated reasons or otherwise. Results relate only to the samples identified above. This report shall not be reproduced except in full with written approval of Cardinal Laboratories.



Celey D. Keene, Lab Director/Quality Manager



CHAIN-OF-CUSTODY AND ANALYSIS REQUEST

Company Name: RECS				BILL TO				ANALYSIS REQUEST																			
Project Manager: Jacob Kamplain				P.O. #:				<div style="display: flex; justify-content: space-around; align-items: center;"> <div style="text-align: center;">Chlorides</div> <div style="text-align: center;">TPH 8015 M</div> <div style="text-align: center;">BTEX</div> <div style="text-align: center;">Texas TPH</div> <div style="text-align: center;">Complete Cations/Anions</div> <div style="text-align: center;">TDS</div> </div>																			
Address:				Company:																							
City: Hobbs State: NM Zip: 88240				Attn:																							
Phone #: Fax #:				Address:																							
Project #: Project Owner:				City:																							
Project Name: Conoco Phillips				State: Zip:																							
Project Location: MCA #417				Phone #:																							
Sampler Name: Chris Flores				Fax #:																							
FOR LAB USE ONLY																											
Lab I.D.		Sample I.D.		G/RAB OR (C)OMP.		# CONTAINERS		MATRIX				PRESERV.		SAMPLING													
								GROUNDWATER WASTEWATER SOIL OIL SLUDGE OTHER:				ACID/BASE: ICE / COOL OTHER:		DATE TIME													
H400014				G		1								1-3-2014 10:40 AM		X X X											
1		Point 1 @ Surface		G		1								11:00 AM		X X X											
2		Point 1 @ 6"		G		1								11:30 AM		X X X											
3		Point 1 @ 2.5'		G		1								11:35 AM		X X X											
4		Point 1 @ 3'		G		1								10:45 AM		X X X											
5		Point 2 @ Surface		G		1								12:45 PM		X X X											
6		Point 2 @ 1'		G		1								12:55 PM		X X X											
7		Point 2 @ 1.5'		G		1																					

PLEASE NOTE: Liability and Damages. Cardinal's liability and client's exclusive remedy for any claim arising whether based in contract or tort, shall be limited to the amount paid by the client for the analyses. All claims including those for negligence and any other cause whatsoever shall be deemed waived unless made in writing and received by Cardinal within 30 days after completion of the applicable service. In no event shall Cardinal be liable for incidental or consequential damages, including without limitation, business interruptions, loss of use, or loss of profits incurred by client, its subsidiaries, affiliates or successors arising out of or related to the performance of services hereunder by Cardinal, regardless of whether such claim is based upon any of the above stated reasons or otherwise.

Relinquished By:		Date:	Received By:		Phone Result:		<input type="checkbox"/> Yes	<input checked="" type="checkbox"/> No	Add'l Phone #:
<i>Chris Flores</i>		Time:	<i>Jodi Benson</i>		Fax Result:		<input type="checkbox"/> Yes	<input checked="" type="checkbox"/> No	Add'l Fax #:
Relinquished By:		Date:	Received By:		REMARKS:				
		Time:			email results				
Delivered By: (Circle One)			Sample Condition		CHECKED BY:				
Sampler - UPS - Bus - Other:			Cool Intact		(Initials)				
			<input checked="" type="checkbox"/> Yes <input checked="" type="checkbox"/> Yes		<i>J. Kamplain</i>				
			<input type="checkbox"/> No <input type="checkbox"/> No		<i>Knorman</i>				
					<i>Weinheimer</i>				
					<i>iflores</i>				
					<i>cflores</i>				

† Cardinal cannot accept verbal changes. Please fax written changes to 505-393-2476

#54

Appendix C

CAP Sampling Lab

RICE Environmental Consulting and Safety (RECS)
P.O. Box 2948 Hobbs, NM 88241
Phone 575.393.2967

April 25, 2014

JACOB KAMPLAIN

RICE ENVIRONMENTAL CONSULTING & SAFETY LLC

419 W. CAIN

HOBBS, NM 88240

RE: MCA #417

Enclosed are the results of analyses for samples received by the laboratory on 04/24/14 16:00.

Cardinal Laboratories is accredited through Texas NELAP under certificate number T104704398-13-5. Accreditation applies to drinking water, non-potable water and solid and chemical materials. All accredited analytes are denoted by an asterisk (*). For a complete list of accredited analytes and matrices visit the TCEQ website at www.tceq.texas.gov/field/qa/lab_accred_certif.html.

Cardinal Laboratories is accredited through the State of Colorado Department of Public Health and Environment for:

Method EPA 552.2	Haloacetic Acids (HAA-5)
Method EPA 524.2	Total Trihalomethanes (TTHM)
Method EPA 524.4	Regulated VOCs (V1, V2, V3)

Accreditation applies to public drinking water matrices.

This report meets NELAP requirements and is made up of a cover page, analytical results, and a copy of the original chain-of-custody. If you have any questions concerning this report, please feel free to contact me.

Sincerely,



Celey D. Keene

Lab Director/Quality Manager

Analytical Results For:

RICE ENVIRONMENTAL CONSULTING & SAFETY
JACOB KAMPLAIN
419 W. CAIN
HOBBS NM, 88240
Fax To: (575) 397-1471

Received: 04/24/2014
Reported: 04/25/2014
Project Name: MCA #417
Project Number: NONE GIVEN
Project Location: CONOCO PHILLIPS

Sampling Date: 04/24/2014
Sampling Type: Soil
Sampling Condition: Cool & Intact
Sample Received By: Jodi Henson

Sample ID: PT. 1 BOTTOM @ 1.5' (H401242-01)

BTEX 8021B			mg/kg		Analyzed By: CK				
Analyte	Result	Reporting Limit	Analyzed	Method Blank	BS	% Recovery	True Value QC	RPD	Qualifier
Benzene*	<0.050	0.050	04/25/2014	ND	1.87	93.4	2.00	3.05	
Toluene*	<0.050	0.050	04/25/2014	ND	1.86	92.9	2.00	2.87	
Ethylbenzene*	<0.050	0.050	04/25/2014	ND	1.87	93.4	2.00	2.27	
Total Xylenes*	<0.150	0.150	04/25/2014	ND	5.67	94.4	6.00	1.26	
Total BTEX	<0.300	0.300	04/25/2014	ND					

Surrogate: 4-Bromofluorobenzene (PID) 101 % 89.4-126

Chloride, SM4500Cl-B			mg/kg		Analyzed By: AP				
Analyte	Result	Reporting Limit	Analyzed	Method Blank	BS	% Recovery	True Value QC	RPD	Qualifier
Chloride	32.0	16.0	04/25/2014	ND	432	108	400	3.64	

TPH 8015M			mg/kg		Analyzed By: CK				
Analyte	Result	Reporting Limit	Analyzed	Method Blank	BS	% Recovery	True Value QC	RPD	Qualifier
GRO C6-C10	<10.0	10.0	04/25/2014	ND	187	93.6	200	2.79	
DRO >C10-C28	<10.0	10.0	04/25/2014	ND	202	101	200	2.79	

Surrogate: 1-Chlorooctane 115 % 65.2-140

Surrogate: 1-Chlorooctadecane 113 % 63.6-154

Cardinal Laboratories

*=Accredited Analyte

PLEASE NOTE: Liability and Damages. Cardinal's liability and client's exclusive remedy for any claim arising, whether based in contract or tort, shall be limited to the amount paid by client for analyses. All claims, including those for negligence and any other cause whatsoever shall be deemed waived unless made in writing and received by Cardinal within thirty (30) days after completion of the applicable service. In no event shall Cardinal be liable for incidental or consequential damages, including, without limitation, business interruptions, loss of use, or loss of profits incurred by client, its subsidiaries, affiliates or successors arising out of or related to the performance of the services hereunder by Cardinal, regardless of whether such claim is based upon any of the above stated reasons or otherwise. Results relate only to the samples identified above. This report shall not be reproduced except in full with written approval of Cardinal Laboratories.



Celey D. Keene, Lab Director/Quality Manager

Analytical Results For:

RICE ENVIRONMENTAL CONSULTING & SAFETY
JACOB KAMPLAIN
419 W. CAIN
HOBBS NM, 88240
Fax To: (575) 397-1471

Received: 04/24/2014
Reported: 04/25/2014
Project Name: MCA #417
Project Number: NONE GIVEN
Project Location: CONOCO PHILLIPS

Sampling Date: 04/24/2014
Sampling Type: Soil
Sampling Condition: Cool & Intact
Sample Received By: Jodi Henson

Sample ID: PT. 2 BOTTOM @ 1' (H401242-02)

BTEx 8021B		mg/kg		Analyzed By: CK						
Analyte	Result	Reporting Limit	Analyzed	Method Blank	BS	% Recovery	True Value QC	RPD	Qualifier	
Benzene*	<0.050	0.050	04/25/2014	ND	1.87	93.4	2.00	3.05		
Toluene*	<0.050	0.050	04/25/2014	ND	1.86	92.9	2.00	2.87		
Ethylbenzene*	<0.050	0.050	04/25/2014	ND	1.87	93.4	2.00	2.27		
Total Xylenes*	<0.150	0.150	04/25/2014	ND	5.67	94.4	6.00	1.26		
Total BTEx	<0.300	0.300	04/25/2014	ND						

Surrogate: 4-Bromofluorobenzene (PID) 102 % 89.4-126

Chloride, SM4500Cl-B		mg/kg		Analyzed By: AP					
Analyte	Result	Reporting Limit	Analyzed	Method Blank	BS	% Recovery	True Value QC	RPD	Qualifier
Chloride	<16.0	16.0	04/25/2014	ND	432	108	400	3.64	

TPH 8015M		mg/kg		Analyzed By: CK					
Analyte	Result	Reporting Limit	Analyzed	Method Blank	BS	% Recovery	True Value QC	RPD	Qualifier
GRO C6-C10	<10.0	10.0	04/25/2014	ND	187	93.6	200	2.79	
DRO >C10-C28	<10.0	10.0	04/25/2014	ND	202	101	200	2.79	

Surrogate: 1-Chlorooctane 118 % 65.2-140

Surrogate: 1-Chlorooctadecane 116 % 63.6-154

Cardinal Laboratories

*=Accredited Analyte

PLEASE NOTE: Liability and Damages. Cardinal's liability and client's exclusive remedy for any claim arising, whether based in contract or tort, shall be limited to the amount paid by client for analyses. All claims, including those for negligence and any other cause whatsoever shall be deemed waived unless made in writing and received by Cardinal within thirty (30) days after completion of the applicable service. In no event shall Cardinal be liable for incidental or consequential damages, including, without limitation, business interruptions, loss of use, or loss of profits incurred by client, its subsidiaries, affiliates or successors arising out of or related to the performance of the services hereunder by Cardinal, regardless of whether such claim is based upon any of the above stated reasons or otherwise. Results relate only to the samples identified above. This report shall not be reproduced except in full with written approval of Cardinal Laboratories.



Celey D. Keene, Lab Director/Quality Manager

Analytical Results For:

RICE ENVIRONMENTAL CONSULTING & SAFETY
JACOB KAMPLAIN
419 W. CAIN
HOBBS NM, 88240
Fax To: (575) 397-1471

Received: 04/24/2014
Reported: 04/25/2014
Project Name: MCA #417
Project Number: NONE GIVEN
Project Location: CONOCO PHILLIPS

Sampling Date: 04/24/2014
Sampling Type: Soil
Sampling Condition: Cool & Intact
Sample Received By: Jodi Henson

Sample ID: 5 PT. BOTTOM COMP @ 1'-1.5' (H401242-03)

BTEx 8021B		mg/kg		Analyzed By: CK						
Analyte	Result	Reporting Limit	Analyzed	Method Blank	BS	% Recovery	True Value QC	RPD	Qualifier	
Benzene*	<0.050	0.050	04/25/2014	ND	1.87	93.4	2.00	3.05		
Toluene*	<0.050	0.050	04/25/2014	ND	1.86	92.9	2.00	2.87		
Ethylbenzene*	<0.050	0.050	04/25/2014	ND	1.87	93.4	2.00	2.27		
Total Xylenes*	<0.150	0.150	04/25/2014	ND	5.67	94.4	6.00	1.26		
Total BTEx	<0.300	0.300	04/25/2014	ND						

Surrogate: 4-Bromofluorobenzene (PID) 102 % 89.4-126

Chloride, SM4500Cl-B		mg/kg		Analyzed By: AP					
Analyte	Result	Reporting Limit	Analyzed	Method Blank	BS	% Recovery	True Value QC	RPD	Qualifier
Chloride	16.0	16.0	04/25/2014	ND	432	108	400	3.64	

TPH 8015M		mg/kg		Analyzed By: CK					
Analyte	Result	Reporting Limit	Analyzed	Method Blank	BS	% Recovery	True Value QC	RPD	Qualifier
GRO C6-C10	<10.0	10.0	04/25/2014	ND	187	93.6	200	2.79	
DRO >C10-C28	<10.0	10.0	04/25/2014	ND	202	101	200	2.79	

Surrogate: 1-Chlorooctane 113 % 65.2-140

Surrogate: 1-Chlorooctadecane 115 % 63.6-154

Cardinal Laboratories

*=Accredited Analyte

PLEASE NOTE: Liability and Damages. Cardinal's liability and client's exclusive remedy for any claim arising, whether based in contract or tort, shall be limited to the amount paid by client for analyses. All claims, including those for negligence and any other cause whatsoever shall be deemed waived unless made in writing and received by Cardinal within thirty (30) days after completion of the applicable service. In no event shall Cardinal be liable for incidental or consequential damages, including, without limitation, business interruptions, loss of use, or loss of profits incurred by client, its subsidiaries, affiliates or successors arising out of or related to the performance of the services hereunder by Cardinal, regardless of whether such claim is based upon any of the above stated reasons or otherwise. Results relate only to the samples identified above. This report shall not be reproduced except in full with written approval of Cardinal Laboratories.



Celey D. Keene, Lab Director/Quality Manager

Notes and Definitions

ND	Analyte NOT DETECTED at or above the reporting limit
RPD	Relative Percent Difference
**	Samples not received at proper temperature of 6°C or below.
***	Insufficient time to reach temperature.
-	Chloride by SM4500Cl-B does not require samples be received at or below 6°C Samples reported on an as received basis (wet) unless otherwise noted on report

Cardinal Laboratories

*=Accredited Analyte

PLEASE NOTE: Liability and Damages. Cardinal's liability and client's exclusive remedy for any claim arising, whether based in contract or tort, shall be limited to the amount paid by client for analyses. All claims, including those for negligence and any other cause whatsoever shall be deemed waived unless made in writing and received by Cardinal within thirty (30) days after completion of the applicable service. In no event shall Cardinal be liable for incidental or consequential damages, including, without limitation, business interruptions, loss of use, or loss of profits incurred by client, its subsidiaries, affiliates or successors arising out of or related to the performance of the services hereunder by Cardinal, regardless of whether such claim is based upon any of the above stated reasons or otherwise. Results relate only to the samples identified above. This report shall not be reproduced except in full with written approval of Cardinal Laboratories.



Celey D. Keene, Lab Director/Quality Manager

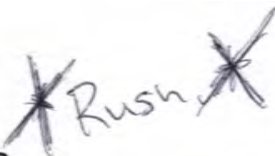



CHAIN-OF-CUSTODY AND ANALYSIS REQUEST

Page 6 of 6

[illegible]

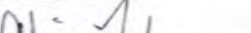
PLEASE NOTE: Liability and Damages. Cardinal's liability and client's exclusive remedy for any claim arising whether based in contract or tort, shall be limited to the amount paid by the client for the analyses. All claims including those for negligence and any other cause whatsoever shall be deemed waived unless made in writing and received by Cardinal within 30 days after completion of the applicable service. In no event shall Cardinal be liable for incidental or consequential damages, including without limitation, business interruptions, loss of use, or loss of profits incurred by client, its subsidiaries, affiliate or successors arising out of or related to the performance of services hereunder by Cardinal, regardless of whether such claim is based upon any of the above stated reasons or otherwise.

<small>PLEASE NOTE: Liability and Damages, including consequential damages, shall be deemed waived unless made in writing and result of use, or loss of profits incurred by client, its subsidiaries, affiliates or successors arising out of or related to the performance of services hereunder by Cardinal, regardless of whether such claim is based upon any of the above stated reasons or otherwise.</small>			
Relinquished By: 		Date: 4-24-14 Time: 4:00	
Relinquished By:		Received By: 	
Delivered By: (Circle One) Sampler - UPS - Bus - Other:		Received By: Date: Time:	
		Sample Condition Cool Intact <input checked="" type="checkbox"/> Yes <input type="checkbox"/> No <input type="checkbox"/> Yes <input type="checkbox"/> No	
		CHECKED BY: (Initials) 	
		Phone Result: <input type="checkbox"/> Yes <input checked="" type="checkbox"/> No Add'l Phone #: Fax Result: <input type="checkbox"/> Yes <input checked="" type="checkbox"/> No Add'l Fax #: REMARKS: email: hconder@riceswd.com; lflores@rice-ecs.com; lweinheimer@rice-ecs.com; knorman@rice-ecs.com; jkamplain@rice-ecs.com; sedwards@rice-ecs.com; cursanic@rice-ecs.com Environmental Tech: cFlores @rice-ecs.com	

† Cardinal cannot accept verbal changes. Please fax written changes to 505-393-2476

#54

Appendix D

Photo Documentation

RICE Environmental Consulting and Safety (RECS)
P.O. Box 2948 Hobbs, NM 88241
Phone 575.393.2967

ConocoPhillips MCA Well #417

Unit Letter M, Section 27, T17S, R32E



Initial site photo, facing north

1/3/14



Sampling the surface of the release, facing northeast

1/3/14



Hand auguring for depth, facing southwest

1/3/14



Beginning excavating site, facing west

4/24/14



Sampling scrape, facing northwest

4/24/14



Exporting soil, facing north

4/24/14



Excavation completed, facing west

4/24/14



Excavation completed, facing northeast

4/24/14



Watering pad, facing northeast

5/1/14



Importing soil, facing south

5/1/14



Backfilling excavation, facing north

5/1/14



Site completed, facing northwest

5/5/14



Site completed, facing west

5/5/14



Site completed, facing southwest

5/5/14

Appendix E

Final C-141

District I
1625 N. French Dr., Hobbs, NM 88240
District II
811 S. First St., Artesia, NM 88210
District III
1000 Rio Brazos Road, Aztec, NM 87410
District IV
1220 S. St. Francis Dr., Santa Fe, NM 87505

State of New Mexico
Energy Minerals and Natural Resources

Oil Conservation Division
1220 South St. Francis Dr.
Santa Fe, NM 87505

Form C-141
Revised August 8, 2011

Submit 1 Copy to appropriate District Office in
accordance with 19.15.29 NMAC.

Release Notification and Corrective Action

OPERATOR

☐ Initial Report ☒ Final Report

Name of Company	ConocoPhillips	Contact	Sean Robinson
Address	29 Vacuum Complex Lane	Telephone No.	(575) 390-8873
Facility Name	MCA Well #417	Facility Type	Oil Well

Surface Owner	BLM	Mineral Owner	BLM	API No.	3002538985
---------------	-----	---------------	-----	---------	------------

LOCATION OF RELEASE

Unit Letter	Section	Township	Range	Feet from the	North/South Line	Feet from the	East/West Line	County
M	27	17S	32E	90	South	1660	West	Lea

Latitude 32.7985274628581 Longitude -103.76068793867

NATURE OF RELEASE

Type of Release	Spill	Volume of Release	16 BBLS	Volume Recovered	14 BBLS
Source of Release	3 in Flex Line	Date and Hour of Occurrence	12/27/13 9:00 am	Date and Hour of Discovery	SAME
Was Immediate Notice Given?	<input checked="" type="checkbox"/> Yes <input type="checkbox"/> No <input type="checkbox"/> Not Required	If YES, To Whom?	Jim Amos/Geoffrey Leking		
By Whom?	David May	Date and Hour	12/27/13 1:30 pm		
Was a Watercourse Reached?	<input type="checkbox"/> Yes <input checked="" type="checkbox"/> No	If YES, Volume Impacting the Watercourse.			

If a Watercourse was Impacted, Describe Fully.*

Describe Cause of Problem and Remedial Action Taken.*☐MSO responded to a leak on a 3 inch flex flow line for the MCA well #417 due to a small hole in the line. MSO shut in and isolated well and submitted work order for repairs.

Describe Area Affected and Cleanup Action Taken.*The release affected 2,912 square feet of lease pad. RECS personnel were on site beginning on January 3rd, 2014 to assess the release. Two points were sampled within the release area at the surface and with depth, and representative samples were taken to a commercial laboratory for analysis. Laboratory analysis showed elevated chloride levels at Point 1 to 1 ft and at Point 2 to 6 inches. Gasoline Range Organics (GRO) readings, Diesel Range Organics (DRO) readings and BTEX readings were non-detect at all depth at both points. Based on the laboratory analysis, a Corrective Action Plan (CAP) for the release was developed and submitted to NMOCD and BLM on February 11th, 2014. BLM approved the CAP on February 14th, 2014, and NMOCD approved the CAP on April 10th, 2014. NMOCD approved the CAP with a stipulation. The stipulation requested that after the excavation was completed, a confirmation sample at Point 2 and a composite sample of the entire excavation needed to be completed. CAP activities began at the site on April 24th, 2014. The site was scraped down to 1 ft bgs on the west side of the release and to 1.5 ft bgs on the east side of the release. A total of 160 cubic yards of contaminated soil was taken to a NMOCD approved facility for disposal. At the base of the scrape a 5 point bottom composite was taken and field tested for chlorides and organic vapors. The sample was then taken to a commercial laboratory for field verification. The 5 point bottom composite returned a laboratory chloride reading of 16 mg/kg and non-detect for GRO, DRO and BTEX. As requested by NMOCD, grab samples were taken at Point 1 and Point 2 and field tested for chlorides and hydrocarbons. The samples were then taken to a commercial laboratory for field verification. Point 1 returned a laboratory chloride reading of 32 mg/kg and Point 2 returned a laboratory chloride reading of non-detect. Both samples returned GRO, DRO and BTEX readings of non-detect. NMOCD approved the site to be backfilled on May 1st, 2014. A total of 160 cubic yards of clean caliche was imported to the site to serve as backfill. The site was backfilled with the caliche, and the area was contoured to the surrounding location.

I hereby certify that the information given above is true and complete to the best of my knowledge and understand that pursuant to NMOCD rules and regulations all operators are required to report and/or file certain release notifications and perform corrective actions for releases which may endanger public health or the environment. The acceptance of a C-141 report by the NMOCD marked as "Final Report" does not relieve the operator of liability should their operations have failed to adequately investigate and remediate contamination that pose a threat to ground water, surface water, human health or the environment. In addition, NMOCD acceptance of a C-141 report does not relieve the operator of responsibility for compliance with any other federal, state, or local laws and/or regulations.

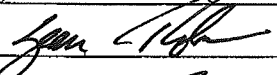
Signature:			
Printed Name:	SEAN ROBINSON		
Title:	OPERATIONS SUPERVISOR		
E-mail Address:	strobin @ Cop. com		
Date:	5-21-14	Phone:	575 390 8873
		OIL CONSERVATION DIVISION	
		Approved by Environmental Specialist:	
		Approval Date:	Expiration Date:
		Conditions of Approval:	Attached <input type="checkbox"/>

* Attach Additional Sheets If Necessary