



APPROVED

By Olivia Yu at 9:01 am, May 12, 2017

NMOCD grants
closure for
1RP-3461.

CONOCOPHILLIPS

Wyatt #13
1RP-3461

Site Closure Report

API No. 30-025-01363

Release Date: December 14th, 2014

Unit Letter E, Section 33, Township 17S, Range 33E



February 27, 2017

Kellie Jones

Environmental Specialist – New Mexico Oil Conservation Division
Energy, Minerals and Natural Resources Department
1625 N. French Dr.
Hobbs, NM 88240

**RE: Site Closure Report
ConocoPhillips Wyatt #13 (1RP-3461)
UL/E sec. 33 T17S R33E
API No. 30-025-01363**

Ms. Jones:

After the Corrective Action Plan was submitted and approval was received from the BLM and NMOCD on October 21, 2015, final excavation was conducted November 10 through 13, 2015.

The release area around Point 1 was excavated down to 2 ft bgs, the release area around Point 2 was excavated down to 3.5 ft bgs and the release area around Point 3 were excavated to 1 ft bgs (Figure 1, Appendix D). One additional sample was collected on November 11, 2015 at Point 3 and sent to a commercial lab for analysis. At 1 ft bgs, Point 3 returned a chloride value of 128 mg/kg, a GRO, DRO and BTEX values of non-detect (Appendix B). Clean soil was imported to the site to backfill the excavation; sample analysis can be found in Appendix B.

In Appendix C, you will find photo documentation of the cleanup progress. ConocoPhillips would like to request a remediation termination and site closure. Should you have any questions, please do not hesitate to contact me via email or by phone.

Sincerely,

A handwritten signature in black ink that reads "Wendy Acosta Q." with a stylized flourish at the end.

Wendy S. Acosta Quintero
Environmental Coordinator
ConocoPhillips Lower 48 – MCBU
3300 North A Street, Building 3-278, Midland, Texas 79705
T: 432.688.9162 | M: 432.234.8050 | Wendy.AcostaQuintero@cop.com

Attachments:

Figure 1 – Samples Collected Summary
Appendix A – Initial C-141
Appendix B – Laboratory Analysis
Appendix C – Photo Documentation

Figures

Samples Collected Summary

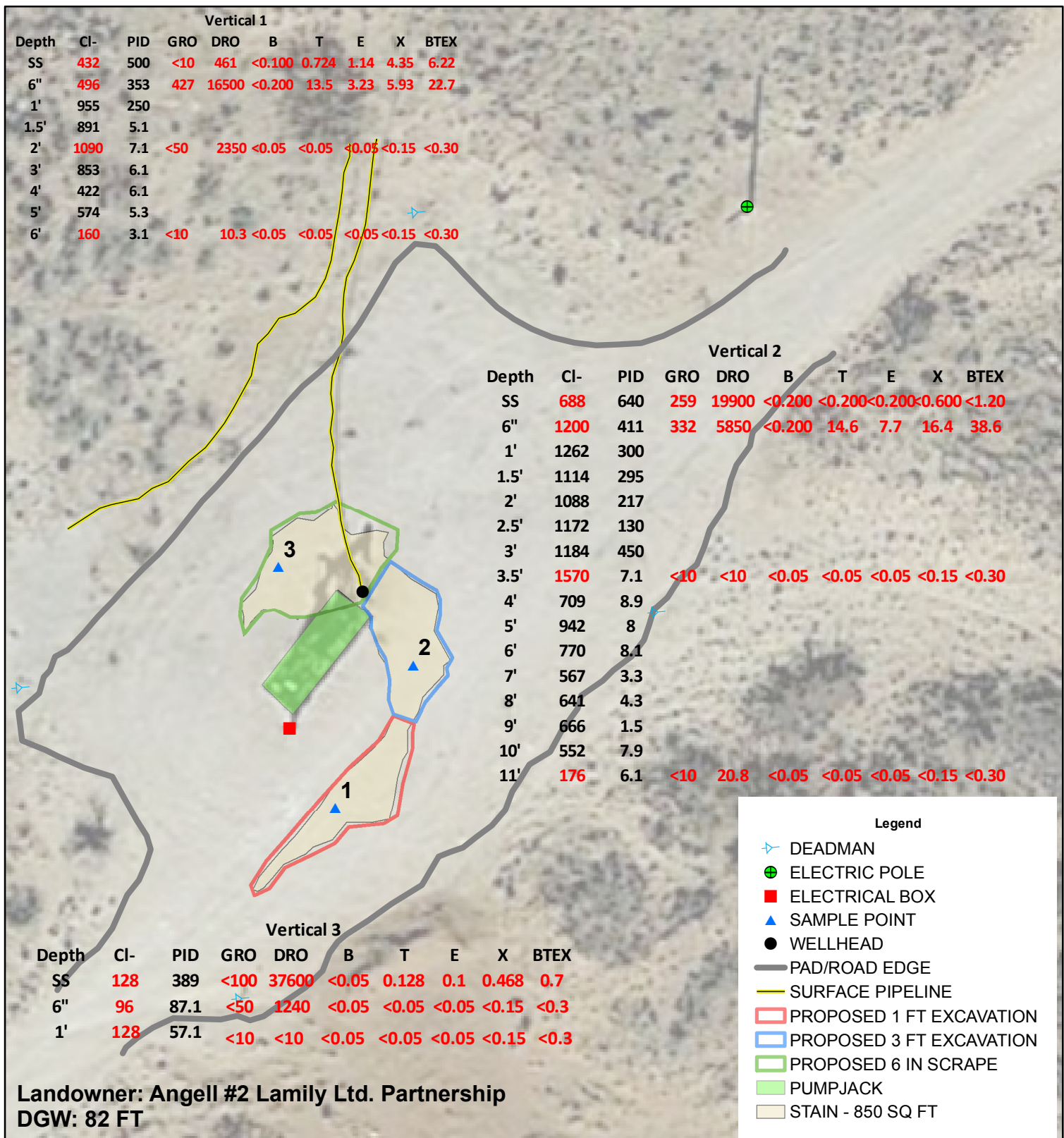

CONOCOPHILLIPS
WYATT #13

UL E SECTION 33
T-17-S R-33-E
LEA COUNTY, NM

Figure 1

0 10 20
 Feet

GPS date: 8/11/15 JK
 Drawing date: 8/11/15
 Drafted by: T. Grieco



Appendix A

Intial C-141

District I
1625 N. French Dr., Hobbs, NM 88240
District II
811 S. First St., Artesia, NM 88210
District III
1000 Rio Brazos Road, Aztec, NM 87410
District IV
1220 S. St. Francis Dr., Santa Fe, NM 87505

State of New Mexico
Energy Minerals and Natural Resources
Oil Conservation Division
1220 South St. Francis Dr.
Santa Fe, NM 87505

Form C-141
Revised August 8, 2011

Submit 1 Copy to appropriate District Office in
accordance with 19.15.29 NMAC.

Release Notification and Corrective Action

RECEIVED

OPERATOR

☒ Initial Report ☐ Final Report

Name of Company: ConocoPhillips	Contact: Jay Garcia	
Address: 29 Vacuum Complex Lane	Telephone No. 575-704-2455	
Facility Name: Wyatt #13	Facility Type: Well	
Surface Owner: BLM	Mineral Owner: NMOCD	API No. 30-025-01363

LOCATION OF RELEASE

Unit Letter	Section	Township	Range	Feet from the	North/South Line	Feet from the	East/West Line	County
E	33	17S	33E	1980	North	660	West	LEA

Latitude 32.7928604322935 Longitude 103.674562565072

NATURE OF RELEASE

Type of Release: Spill	Volume of Release: 16.10 BBLS	Volume Recovered: 15 BBLS
Source of Release: Stuffing Box	Date and Hour of Occurrence 12/14/2014 2:25 pm	Date and Hour of Discovery 12/14/2014 2:25 pm
Was Immediate Notice Given? <input type="checkbox"/> Yes <input checked="" type="checkbox"/> No <input type="checkbox"/> Not Required	If YES, To Whom? Tomas Oberding	
By Whom? Jay Garcia	Date and Hour: 12/16/2014 7:30 am	
Was a Watercourse Reached? <input type="checkbox"/> Yes <input checked="" type="checkbox"/> No	If YES, Volume Impacting the Watercourse.	

If a Watercourse was Impacted, Describe Fully.*

Describe Cause of Problem and Remedial Action Taken.*

On Sunday December 14th, 2014 @ 1425 Hrs. MST, A discharge occurred at the Wyatt #13. MSO found a leak originating from a stuffing box. The leak resulted in 8.05 BO and 8.05 BPW being released. MSO immediately shut in well. Supervisor and HSE lead were notified. Affected area was 44 foot x 26 foot x 1 inch deep with 8.0 BO and 7.0 BPW were recovered. The affected area will be remediated according to NMOCD and COPC guidelines, this is not a PSE.

Describe Area Affected and Cleanup Action Taken.*

The leak resulted in 8.05 BO and 8.05 BPW being released. MSO immediately shut in well. Supervisor and HSE lead were notified. Affected area was 44 foot x 26 foot x 1 inch deep with 8.0 BO and 7.0 BPW were recovered. The affected area will be remediated according to NMOCD and COPC guidelines

I hereby certify that the information given above is true and complete to the best of my knowledge and understand that pursuant to NMOCD rules and regulations all operators are required to report and/or file certain release notifications and perform corrective actions for releases which may endanger public health or the environment. The acceptance of a C-141 report by the NMOCD marked as "Final Report" does not relieve the operator of liability should their operations have failed to adequately investigate and remediate contamination that pose a threat to ground water, surface water, human health or the environment. In addition, NMOCD acceptance of a C-141 report does not relieve the operator of responsibility for compliance with any other federal, state, or local laws and/or regulations.

Signature: <i>Jay Garcia</i>		OIL CONSERVATION DIVISION	
Printed Name: Jay Garcia		Approved by Environmental Specialist:	
Title: LEAD HSE	Approval Date: 12-18-14	Expiration Date: 2-18-15	
E-mail Address: jay.c.garcia@conocophillips.com	Conditions of Approval: <i>Site Supervisor Debuta & monitor new area NMOCD guide - Submit final C-141 by 2-18-15</i>		Attached <input type="checkbox"/> 1 RP-3461
Date: 12/16/2014	Phone: 575-704-2455		

DEC 18 2014

217917
701435040877
701435041067

Appendix B

Laboratory Analysis



PHONE (575) 393-2326 ° 101 E. MARLAND ° HOBBS, NM 88240

November 12, 2015

KYLE NORMAN

Basin Environmental Service

P.O. Box 301

Lovington, NM 88260

RE: WYATT #13

Enclosed are the results of analyses for samples received by the laboratory on 11/11/15 16:43.

Cardinal Laboratories is accredited through Texas NELAP under certificate number T104704398-13-5. Accreditation applies to drinking water, non-potable water and solid and chemical materials. All accredited analytes are denoted by an asterisk (*). For a complete list of accredited analytes and matrices visit the TCEQ website at www.tceq.texas.gov/field/qa/lab_accred_certif.html.

Cardinal Laboratories is accredited through the State of Colorado Department of Public Health and Environment for:

Method EPA 552.2	Haloacetic Acids (HAA-5)
Method EPA 524.2	Total Trihalomethanes (TTHM)
Method EPA 524.4	Regulated VOCs (V1, V2, V3)

Accreditation applies to public drinking water matrices.

This report meets NELAP requirements and is made up of a cover page, analytical results, and a copy of the original chain-of-custody. If you have any questions concerning this report, please feel free to contact me.

Sincerely,

A handwritten signature in black ink that reads "Celey D. Keene". The signature is written in a cursive style with a large, stylized 'C' and 'K'.

Celey D. Keene

Lab Director/Quality Manager

Analytical Results For:

Basin Environmental Service
KYLE NORMAN
P.O. Box 301
Lovington NM, 88260
Fax To: (575) 396-1429

Received: 11/11/2015
Reported: 11/12/2015
Project Name: WYATT #13
Project Number: NONE GIVEN
Project Location: NOT GIVEN

Sampling Date: 11/11/2015
Sampling Type: Soil
Sampling Condition: Cool & Intact
Sample Received By: Judy Garcia

Sample ID: PT. 3 @ 1' (H502999-01)

BTX 8021B			mg/kg		Analyzed By: MS				
Analyte	Result	Reporting Limit	Analyzed	Method Blank	BS	% Recovery	True Value QC	RPD	Qualifier
Benzene*	<0.050	0.050	11/12/2015	ND	2.06	103	2.00	13.7	
Toluene*	<0.050	0.050	11/12/2015	ND	2.27	113	2.00	12.0	
Ethylbenzene*	<0.050	0.050	11/12/2015	ND	2.06	103	2.00	10.2	
Total Xylenes*	<0.150	0.150	11/12/2015	ND	6.46	108	6.00	10.1	
Total BTX	<0.300	0.300	11/12/2015	ND					

Surrogate: 4-Bromofluorobenzene (PID) 101 % 73.6-140

Chloride, SM4500Cl-B			mg/kg		Analyzed By: AP				
Analyte	Result	Reporting Limit	Analyzed	Method Blank	BS	% Recovery	True Value QC	RPD	Qualifier
Chloride	128	16.0	11/12/2015	ND	432	108	400	7.69	

TPH 8015M			mg/kg		Analyzed By: MS				
Analyte	Result	Reporting Limit	Analyzed	Method Blank	BS	% Recovery	True Value QC	RPD	Qualifier
GRO C6-C10	<10.0	10.0	11/12/2015	ND	189	94.3	200	0.676	
DRO >C10-C28	<10.0	10.0	11/12/2015	ND	186	92.9	200	2.24	

Surrogate: 1-Chlorooctane 83.6 % 35-147

Surrogate: 1-Chlorooctadecane 90.6 % 28-171

Cardinal Laboratories

*=Accredited Analyte

PLEASE NOTE: Liability and Damages. Cardinal's liability and client's exclusive remedy for any claim arising, whether based in contract or tort, shall be limited to the amount paid by client for analyses. All claims, including those for negligence and any other cause whatsoever shall be deemed waived unless made in writing and received by Cardinal within thirty (30) days after completion of the applicable service. In no event shall Cardinal be liable for incidental or consequential damages, including, without limitation, business interruptions, loss of use, or loss of profits incurred by client, its subsidiaries, affiliates or successors arising out of or related to the performance of the services hereunder by Cardinal, regardless of whether such claim is based upon any of the above stated reasons or otherwise. Results relate only to the samples identified above. This report shall not be reproduced except in full with written approval of Cardinal Laboratories.



Celey D. Keene, Lab Director/Quality Manager

Notes and Definitions

ND	Analyte NOT DETECTED at or above the reporting limit
RPD	Relative Percent Difference
**	Samples not received at proper temperature of 6°C or below.
***	Insufficient time to reach temperature.
-	Chloride by SM4500Cl-B does not require samples be received at or below 6°C Samples reported on an as received basis (wet) unless otherwise noted on report

Cardinal Laboratories

*=Accredited Analyte

PLEASE NOTE: Liability and Damages. Cardinal's liability and client's exclusive remedy for any claim arising, whether based in contract or tort, shall be limited to the amount paid by client for analyses. All claims, including those for negligence and any other cause whatsoever shall be deemed waived unless made in writing and received by Cardinal within thirty (30) days after completion of the applicable service. In no event shall Cardinal be liable for incidental or consequential damages, including, without limitation, business interruptions, loss of use, or loss of profits incurred by client, its subsidiaries, affiliates or successors arising out of or related to the performance of the services hereunder by Cardinal, regardless of whether such claim is based upon any of the above stated reasons or otherwise. Results relate only to the samples identified above. This report shall not be reproduced except in full with written approval of Cardinal Laboratories.



Celey D. Keene, Lab Director/Quality Manager



ARDINAL LABORATORIES
101 East Marland, Hobbs, NM 88240 2111 Beechwood, Abilene, TX 79603
(505) 393-2326 FAX (505) 393-2476 (325) 673-7001 FAX (325) 673-7020

CHAIN-OF-CUSTODY AND ANALYSIS REQUEST

[illegible]



PHONE (575) 393-2326 ° 101 E. MARLAND ° HOBBS, NM 88240

November 13, 2015

KYLE NORMAN

BASIN ENVIRONMENTAL - HOBBS

419 W. CAIN

HOBBS, NM 88240

RE: WYATT #13

Enclosed are the results of analyses for samples received by the laboratory on 11/11/15 16:43.

Cardinal Laboratories is accredited through Texas NELAP under certificate number T104704398-13-5. Accreditation applies to drinking water, non-potable water and solid and chemical materials. All accredited analytes are denoted by an asterisk (*). For a complete list of accredited analytes and matrices visit the TCEQ website at www.tceq.texas.gov/field/qa/lab_accred_certif.html.

Cardinal Laboratories is accredited through the State of Colorado Department of Public Health and Environment for:

Method EPA 552.2	Haloacetic Acids (HAA-5)
Method EPA 524.2	Total Trihalomethanes (TTHM)
Method EPA 524.4	Regulated VOCs (V1, V2, V3)

Accreditation applies to public drinking water matrices.

This report meets NELAP requirements and is made up of a cover page, analytical results, and a copy of the original chain-of-custody. If you have any questions concerning this report, please feel free to contact me.

Sincerely,

A handwritten signature in black ink that reads "Celey D. Keene". The signature is written in a cursive, flowing style.

Celey D. Keene

Lab Director/Quality Manager

Analytical Results For:

BASIN ENVIRONMENTAL - HOBBS
KYLE NORMAN
419 W. CAIN
HOBBS NM, 88240
Fax To: (575) 393-0293

Received: 11/11/2015
Reported: 11/13/2015
Project Name: WYATT #13
Project Number: NONE GIVEN
Project Location: NOT GIVEN

Sampling Date: 11/11/2015
Sampling Type: Soil
Sampling Condition: Cool & Intact
Sample Received By: Judy Garcia

Sample ID: IMPORT SOIL (H503000-01)**Chloride, SM4500Cl-B****mg/kg****Analyzed By: AP**

Analyte	Result	Reporting Limit	Analyzed	Method Blank	BS	% Recovery	True Value QC	RPD	Qualifier
Chloride	112	16.0	11/13/2015	ND	416	104	400	3.92	

Cardinal Laboratories

*=Accredited Analyte

PLEASE NOTE: Liability and Damages. Cardinal's liability and client's exclusive remedy for any claim arising, whether based in contract or tort, shall be limited to the amount paid by client for analyses. All claims, including those for negligence and any other cause whatsoever shall be deemed waived unless made in writing and received by Cardinal within thirty (30) days after completion of the applicable service. In no event shall Cardinal be liable for incidental or consequential damages, including, without limitation, business interruptions, loss of use, or loss of profits incurred by client, its subsidiaries, affiliates or successors arising out of or related to the performance of the services hereunder by Cardinal, regardless of whether such claim is based upon any of the above stated reasons or otherwise. Results relate only to the samples identified above. This report shall not be reproduced except in full with written approval of Cardinal Laboratories.



Celey D. Keene, Lab Director/Quality Manager

Notes and Definitions

ND	Analyte NOT DETECTED at or above the reporting limit
RPD	Relative Percent Difference
**	Samples not received at proper temperature of 6°C or below.
***	Insufficient time to reach temperature.
-	Chloride by SM4500Cl-B does not require samples be received at or below 6°C Samples reported on an as received basis (wet) unless otherwise noted on report

Cardinal Laboratories

*=Accredited Analyte

PLEASE NOTE: Liability and Damages. Cardinal's liability and client's exclusive remedy for any claim arising, whether based in contract or tort, shall be limited to the amount paid by client for analyses. All claims, including those for negligence and any other cause whatsoever shall be deemed waived unless made in writing and received by Cardinal within thirty (30) days after completion of the applicable service. In no event shall Cardinal be liable for incidental or consequential damages, including, without limitation, business interruptions, loss of use, or loss of profits incurred by client, its subsidiaries, affiliates or successors arising out of or related to the performance of the services hereunder by Cardinal, regardless of whether such claim is based upon any of the above stated reasons or otherwise. Results relate only to the samples identified above. This report shall not be reproduced except in full with written approval of Cardinal Laboratories.



Celey D. Keene, Lab Director/Quality Manager



CHAIN-OF-CUSTODY AND ANALYSIS REQUEST

101 East Marland, Hobbs, NM 88240 2111 Beechwood, Abilene, TX 79603
(505) 393-2326 FAX (505) 393-2476 (325) 673-7001 FAX (325) 673-7020

Page 4 of 4

Appendix C

Photo Documentation

ConocoPhillips Wyatt #13

Unit Letter E, Section 33, T17S, R33E



EXCAVATING FACING SOUTH 11-10-15



EXCAVATION FACING EAST 11-11-15



FINAL PHOTO FACING EAST 11-13-15



FINAL PHOTO FACING SOUTH 11-13-15