

PRELIMINARY RESULTS

Linam Gathering M Ext Line
Lea County, New Mexico
1RP 4605

Prepared for:



370 17th St., Suite 2500
Denver, CO 80202

Prepared by:



2620 W. Marland
Hobbs, NM 88240

September 28, 2017

Summary

Tasman Geosciences, Inc. (Tasman) has prepared this Project Summary on behalf of DCP Midstream, LP (DCP) to document the results of field activities that were conducted at the Linam Gathering M Ext Line. The site is located approximately 10.5 miles south east of Loco Hills, New Mexico at sec. 4 T19S R31E. NMOSE well records indicate that groundwater will likely be encountered at a depth of approximately 180 +/- feet.

DCP Midstream operator discovered leak while completing daily rounds on January 23, 2017 approximately 8bbbls released. The line was shut in and blown down. NMOCD was notified of the release on February 1, 2017 and an initial C-141 was approved by NMOCD on February 15, 2017 (Appendix A). Tasman personnel were on site on January 25, 2017 to assess the release. The release area was GPS mapped (Figure 1) and samples were collected, the samples were field tested for chlorides and organic vapors, and representative samples were taken to a commercial laboratory for analysis (Appendix B) and photographed (Appendix C).

Excavated soil was exported and disposed of at a NMOCD approved facility.

Corrective Action Plan

Based on the assessment and laboratory analysis, we propose a 20-mil reinforced poly liner that will be installed and properly seated at nine feet (figure 1). The area around Pt. 7 and South wall on nine foot excavation will be delineated, once the entire excavation is completed, discrete samples from Pt.7 and South Wall of the excavation will be collected and field tested for organic vapors. If the field data indicates that the wall samples will not achieve readings below regulatory standards, the walls of the excavation will be extended until field testing indicates that all constituents from the samples will return values below regulatory standards. The samples will then be taken to a commercial laboratory to confirm that all constituents return readings are below regulatory standards.. The excavation will then be backfilled with clean soil.

Revegetation of the site will be performed as follows:

Disturbed areas associated with the remediation efforts will be reseeded. The seed will be spread using a hand-held broadcaster and the area raked or dragged to cover the seed. Because the seed will be broadcast, the pounds per acre will be doubled.

The seed mixture will be planted in the amounts specified in pounds of pure live seed (PLS) per acre. Commercially sold seed will be either certified or registered. The area will be seeded following backfilling of the excavated area.

Once these activities have been completed, a report will be sent to NMOCD and BLM requesting 'remediation termination' and site closure.

Tasman appreciates the opportunity to work with you on this project. Please contact me if you have any questions or wish to discuss the site.

Sincerely,

Kyle Norman Project Manager Tasman Geosciences (575) 318-5017

Attachments:

Figure 1 – Excavation and samples

Appendix A – Initial C-141

Appendix B –Laboratory Analyses

Appendix C - Photo Documentation

Appendix D – NMOSE DGW

Figures

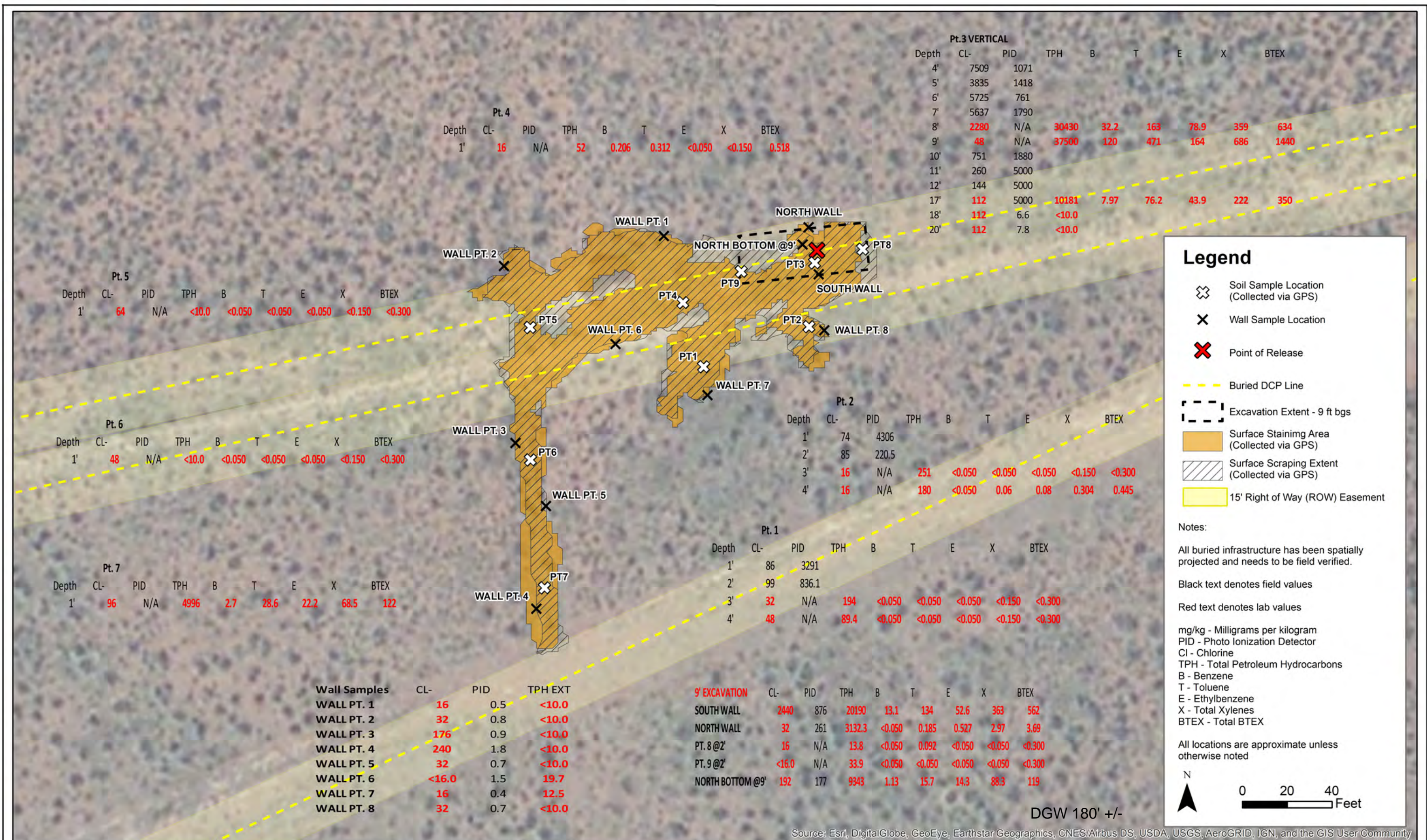

DATE:
September 2017

DESIGNED BY:
K. Norman

DRAWN BY:
D. Cavinder

TASMAN
GEOSCIENCES

Tasman Geosciences Inc.
6899 Pecos Street - Unit C
Denver, CO 80221

DCP Midstream
M Extension Line Leak 1RP-4605
NENE Section 4, Township 19 South, Range 31 East
Eddy County, New Mexico

Soil Sample Location
Figure

Figure
1

Appendix A

District I
1625 N. French Dr., Hobbs, NM 88240
District II
811 S. First St., Artesia, NM 88210
District III
1000 Rio Brazos Road, Aztec, NM 87410
District IV
1220 S. St. Francis Dr., Santa Fe, NM 87505

State of New Mexico
Energy Minerals and Natural Resources

Oil Conservation Division
1220 South St. Francis Dr.
Santa Fe, NM 87505

Form C-141
Revised August 8, 2011

Submit 1 Copy to appropriate District Office in
accordance with 19.15.29 NMAC.

Release Notification and Corrective Action

OPERATOR

☒ Initial Report ☐ Final Report

Name of Company DCP	Contact Haskell Conder	
Address 10 Desta Drive, Suite 400 West	Telephone No. cell 432-557-1127	
Facility Name Linam Gathering	Facility Type Natural Gas Gathering Pipeline	
Surface Owner BLM	Mineral Owner	API No.

LOCATION OF RELEASE

Unit Letter	Section 4	Township 19S	Range 31E	Feet from the	North/South Line	Feet from the	East/West Line	County Lea
-------------	--------------	-----------------	--------------	---------------	------------------	---------------	----------------	---------------

Latitude 32.69655 Longitude -103.86820

NATURE OF RELEASE

Type of Release: condensate	Volume of Release 8 bbl	Volume Recovered 0
Source of Release M Ext Line	Date and Hour of Occurrence	Date and Hour of Discovery 01-23-17
Was Immediate Notice Given? <input checked="" type="checkbox"/> Yes <input type="checkbox"/> No <input type="checkbox"/> Not Required	If YES, To Whom? NMOCD	
By Whom? Haskell Conder	Date and Hour 01-23-17 15:30	
Was a Watercourse Reached? <input type="checkbox"/> Yes <input checked="" type="checkbox"/> No	If YES, Volume Impacting the Watercourse.	
If a Watercourse was Impacted, Describe Fully.* N / A		
Describe Cause of Problem and Remedial Action Taken.* DCP operator discovered leak while completing daily rounds.		
Describe Area Affected and Cleanup Action Taken.* A cleanup plan will be submitted for BLM and OCD Approval		
I hereby certify that the information given above is true and complete to the best of my knowledge and understand that pursuant to NMOCD rules and regulations all operators are required to report and/or file certain release notifications and perform corrective actions for releases which may endanger public health or the environment. The acceptance of a C-141 report by the NMOCD marked as "Final Report" does not relieve the operator of liability should their operations have failed to adequately investigate and remediate contamination that pose a threat to ground water, surface water, human health or the environment. In addition, NMOCD acceptance of a C-141 report does not relieve the operator of responsibility for compliance with any other federal, state, or local laws and/or regulations.		
Signature: <i>Haskell Conder</i>		OIL CONSERVATION DIVISION
Printed Name: Haskell Conder		Approved by Environmental Specialist: 
Title: Compliance Coordinator		Approval Date: 2/15/2017 Expiration Date:
E-mail Address: hconder@dcpmidstream.com		Conditions of Approval: see attached directive
Date: 02-01-17 Phone: 432-557-1127		Attached <input checked="" type="checkbox"/>

* Attach Additional Sheets If Necessary

1RP-4605

fOY1704639477

pOY1704640472

nOY1704640119

Appendix B



PHONE (575) 393-2326 ° 101 E. MARLAND ° HOBBS, NM 88240

February 08, 2017

HACK CONDER

DCP Midstream - Midland

10 Desta Dr., #400-W

Midland, TX 79705

RE: M EXTENSION LINE

Enclosed are the results of analyses for samples received by the laboratory on 02/07/17 16:41.

Cardinal Laboratories is accredited through Texas NELAP under certificate number T104704398-16-8. Accreditation applies to drinking water, non-potable water and solid and chemical materials. All accredited analytes are denoted by an asterisk (*). For a complete list of accredited analytes and matrices visit the TCEQ website at www.tceq.texas.gov/field/qa/lab_accred_certif.html.

Cardinal Laboratories is accredited through the State of Colorado Department of Public Health and Environment for:

Method EPA 552.2	Haloacetic Acids (HAA-5)
Method EPA 524.2	Total Trihalomethanes (TTHM)
Method EPA 524.4	Regulated VOCs (V1, V2, V3)

Accreditation applies to public drinking water matrices.

This report meets NELAP requirements and is made up of a cover page, analytical results, and a copy of the original chain-of-custody. If you have any questions concerning this report, please feel free to contact me.

Sincerely,

A handwritten signature in black ink that reads "Celey D. Keene". The signature is written in a cursive, flowing style.

Celey D. Keene

Lab Director/Quality Manager

Analytical Results For:

DCP Midstream - Midland
HACK CONDER
10 Desta Dr., #400-W
Midland TX, 79705
Fax To: None

Received: 02/07/2017
Reported: 02/08/2017
Project Name: M EXTENSION LINE
Project Number: NONE GIVEN
Project Location: NOT GIVEN

Sampling Date: 02/07/2017
Sampling Type: Soil
Sampling Condition: Cool & Intact
Sample Received By: Celey D. Keene

Sample ID: PT 1 @3' (H700315-01)

BTEX 8021B		mg/kg		Analyzed By: MS					
Analyte	Result	Reporting Limit	Analyzed	Method Blank	BS	% Recovery	True Value QC	RPD	Qualifier
Benzene*	<0.050	0.050	02/08/2017	ND	2.23	112	2.00	0.753	
Toluene*	<0.050	0.050	02/08/2017	ND	2.18	109	2.00	0.516	
Ethylbenzene*	<0.050	0.050	02/08/2017	ND	2.17	108	2.00	0.0492	
Total Xylenes*	<0.150	0.150	02/08/2017	ND	6.16	103	6.00	0.258	
Total BTEX	<0.300	0.300	02/08/2017	ND					

Surrogate: 4-Bromofluorobenzene (PID) 106 % 73.6-140

Chloride, SM4500Cl-B		mg/kg		Analyzed By: HM						
Analyte	Result	Reporting Limit	Analyzed	Method Blank	BS	% Recovery	True Value QC	RPD	Qualifier	
Chloride	32.0	16.0	02/08/2017	ND	448	112	400	3.64		

TPH 8015M		mg/kg		Analyzed By: MS					
Analyte	Result	Reporting Limit	Analyzed	Method Blank	BS	% Recovery	True Value QC	RPD	Qualifier
GRO C6-C10	<10.0	10.0	02/08/2017	ND	184	91.9	200	0.449	
DRO >C10-C28	194	10.0	02/08/2017	ND	193	96.3	200	4.05	

Surrogate: 1-Chlorooctadecane 96.1 % 28-171

Cardinal Laboratories

*=Accredited Analyte

PLEASE NOTE: Liability and Damages. Cardinal's liability and client's exclusive remedy for any claim arising, whether based in contract or tort, shall be limited to the amount paid by client for analyses. All claims, including those for negligence and any other cause whatsoever shall be deemed waived unless made in writing and received by Cardinal within thirty (30) days after completion of the applicable service. In no event shall Cardinal be liable for incidental or consequential damages, including, without limitation, business interruptions, loss of use, or loss of profits incurred by client, its subsidiaries, affiliates or successors arising out of or related to the performance of the services hereunder by Cardinal, regardless of whether such claim is based upon any of the above stated reasons or otherwise. Results relate only to the samples identified above. This report shall not be reproduced except in full with written approval of Cardinal Laboratories.



Celey D. Keene, Lab Director/Quality Manager

Analytical Results For:

DCP Midstream - Midland
HACK CONDER
10 Desta Dr., #400-W
Midland TX, 79705
Fax To: None

Received: 02/07/2017
Reported: 02/08/2017
Project Name: M EXTENSION LINE
Project Number: NONE GIVEN
Project Location: NOT GIVEN

Sampling Date: 02/07/2017
Sampling Type: Soil
Sampling Condition: Cool & Intact
Sample Received By: Celey D. Keene

Sample ID: PT 2 @3' (H700315-02)

BTEx 8021B		mg/kg		Analyzed By: MS					
Analyte	Result	Reporting Limit	Analyzed	Method Blank	BS	% Recovery	True Value QC	RPD	Qualifier
Benzene*	<0.050	0.050	02/08/2017	ND	2.23	112	2.00	0.753	
Toluene*	<0.050	0.050	02/08/2017	ND	2.18	109	2.00	0.516	
Ethylbenzene*	<0.050	0.050	02/08/2017	ND	2.17	108	2.00	0.0492	
Total Xylenes*	<0.150	0.150	02/08/2017	ND	6.16	103	6.00	0.258	
Total BTEx	<0.300	0.300	02/08/2017	ND					

Surrogate: 4-Bromofluorobenzene (PID) 106 % 73.6-140

Chloride, SM4500CI-B		mg/kg		Analyzed By: HM					
Analyte	Result	Reporting Limit	Analyzed	Method Blank	BS	% Recovery	True Value QC	RPD	Qualifier
Chloride	16.0	16.0	02/08/2017	ND	448	112	400	3.64	

TPH 8015M		mg/kg		Analyzed By: MS					
Analyte	Result	Reporting Limit	Analyzed	Method Blank	BS	% Recovery	True Value QC	RPD	Qualifier
GRO C6-C10	<10.0	10.0	02/08/2017	ND	184	91.9	200	0.449	
DRO >C10-C28	251	10.0	02/08/2017	ND	193	96.3	200	4.05	

Surrogate: 1-Chlorooctane 75.5 % 35-147

Surrogate: 1-Chlorooctadecane 89.7 % 28-171

Cardinal Laboratories

*=Accredited Analyte

PLEASE NOTE: Liability and Damages. Cardinal's liability and client's exclusive remedy for any claim arising, whether based in contract or tort, shall be limited to the amount paid by client for analyses. All claims, including those for negligence and any other cause whatsoever shall be deemed waived unless made in writing and received by Cardinal within thirty (30) days after completion of the applicable service. In no event shall Cardinal be liable for incidental or consequential damages, including, without limitation, business interruptions, loss of use, or loss of profits incurred by client, its subsidiaries, affiliates or successors arising out of or related to the performance of the services hereunder by Cardinal, regardless of whether such claim is based upon any of the above stated reasons or otherwise. Results relate only to the samples identified above. This report shall not be reproduced except in full with written approval of Cardinal Laboratories.



Celey D. Keene, Lab Director/Quality Manager

Analytical Results For:

DCP Midstream - Midland
HACK CONDER
10 Desta Dr., #400-W
Midland TX, 79705
Fax To: None

Received: 02/07/2017
Reported: 02/08/2017
Project Name: M EXTENSION LINE
Project Number: NONE GIVEN
Project Location: NOT GIVEN

Sampling Date: 02/07/2017
Sampling Type: Soil
Sampling Condition: Cool & Intact
Sample Received By: Celey D. Keene

Sample ID: PT 2 @ 4' (H700315-03)

BTX 8021B		mg/kg		Analyzed By: MS					
Analyte	Result	Reporting Limit	Analyzed	Method Blank	BS	% Recovery	True Value QC	RPD	Qualifier
Benzene*	<0.050	0.050	02/08/2017	ND	2.23	112	2.00	0.753	
Toluene*	0.060	0.050	02/08/2017	ND	2.18	109	2.00	0.516	
Ethylbenzene*	0.080	0.050	02/08/2017	ND	2.17	108	2.00	0.0492	
Total Xylenes*	0.304	0.150	02/08/2017	ND	6.16	103	6.00	0.258	
Total BTX	0.445	0.300	02/08/2017	ND					

Surrogate: 4-Bromofluorobenzene (PID) 106 % 73.6-140

Chloride, SM4500CI-B		mg/kg		Analyzed By: HM					
Analyte	Result	Reporting Limit	Analyzed	Method Blank	BS	% Recovery	True Value QC	RPD	Qualifier
Chloride	16.0	16.0	02/08/2017	ND	448	112	400	3.64	

TPH 8015M		mg/kg		Analyzed By: MS					
Analyte	Result	Reporting Limit	Analyzed	Method Blank	BS	% Recovery	True Value QC	RPD	Qualifier
GRO C6-C10	<10.0	10.0	02/08/2017	ND	184	91.9	200	0.449	
DRO >C10-C28	180	10.0	02/08/2017	ND	193	96.3	200	4.05	

Surrogate: 1-Chlorooctane 76.7 % 35-147

Surrogate: 1-Chlorooctadecane 92.3 % 28-171

Cardinal Laboratories

*=Accredited Analyte

PLEASE NOTE: Liability and Damages. Cardinal's liability and client's exclusive remedy for any claim arising, whether based in contract or tort, shall be limited to the amount paid by client for analyses. All claims, including those for negligence and any other cause whatsoever shall be deemed waived unless made in writing and received by Cardinal within thirty (30) days after completion of the applicable service. In no event shall Cardinal be liable for incidental or consequential damages, including, without limitation, business interruptions, loss of use, or loss of profits incurred by client, its subsidiaries, affiliates or successors arising out of or related to the performance of the services hereunder by Cardinal, regardless of whether such claim is based upon any of the above stated reasons or otherwise. Results relate only to the samples identified above. This report shall not be reproduced except in full with written approval of Cardinal Laboratories.



Celey D. Keene, Lab Director/Quality Manager

Analytical Results For:

DCP Midstream - Midland
HACK CONDER
10 Desta Dr., #400-W
Midland TX, 79705
Fax To: None

Received: 02/07/2017
Reported: 02/08/2017
Project Name: M EXTENSION LINE
Project Number: NONE GIVEN
Project Location: NOT GIVEN

Sampling Date: 02/07/2017
Sampling Type: Soil
Sampling Condition: Cool & Intact
Sample Received By: Celey D. Keene

Sample ID: PT 3 @ 8' (H700315-04)

BTEx 8021B		mg/kg		Analyzed By: MS					
Analyte	Result	Reporting Limit	Analyzed	Method Blank	BS	% Recovery	True Value QC	RPD	Qualifier
Benzene*	32.2	5.00	02/08/2017	ND	2.23	112	2.00	0.753	
Toluene*	163	5.00	02/08/2017	ND	2.18	109	2.00	0.516	
Ethylbenzene*	78.9	5.00	02/08/2017	ND	2.17	108	2.00	0.0492	
Total Xylenes*	359	15.0	02/08/2017	ND	6.16	103	6.00	0.258	
Total BTEX	634	30.0	02/08/2017	ND					

Surrogate: 4-Bromofluorobenzene (PID) 113 % 73.6-140

Chloride, SM4500Cl-B		mg/kg		Analyzed By: HM					
Analyte	Result	Reporting Limit	Analyzed	Method Blank	BS	% Recovery	True Value QC	RPD	Qualifier
Chloride	2280	16.0	02/08/2017	ND	448	112	400	3.64	

TPH 8015M		mg/kg		Analyzed By: MS						S-06
Analyte	Result	Reporting Limit	Analyzed	Method Blank	BS	% Recovery	True Value QC	RPD	Qualifier	
GRO C6-C10	8730	100	02/08/2017	ND	184	91.9	200	0.449		
DRO >C10-C28	21700	100	02/08/2017	ND	193	96.3	200	4.05		

Surrogate: 1-Chlorooctane 473 % 35-147

Surrogate: 1-Chlorooctadecane 244 % 28-171

Cardinal Laboratories

*=Accredited Analyte

PLEASE NOTE: Liability and Damages. Cardinal's liability and client's exclusive remedy for any claim arising, whether based in contract or tort, shall be limited to the amount paid by client for analyses. All claims, including those for negligence and any other cause whatsoever shall be deemed waived unless made in writing and received by Cardinal within thirty (30) days after completion of the applicable service. In no event shall Cardinal be liable for incidental or consequential damages, including, without limitation, business interruptions, loss of use, or loss of profits incurred by client, its subsidiaries, affiliates or successors arising out of or related to the performance of the services hereunder by Cardinal, regardless of whether such claim is based upon any of the above stated reasons or otherwise. Results relate only to the samples identified above. This report shall not be reproduced except in full with written approval of Cardinal Laboratories.



Celey D. Keene, Lab Director/Quality Manager

Analytical Results For:

DCP Midstream - Midland
HACK CONDER
10 Desta Dr., #400-W
Midland TX, 79705
Fax To: None

Received: 02/07/2017
Reported: 02/08/2017
Project Name: M EXTENSION LINE
Project Number: NONE GIVEN
Project Location: NOT GIVEN

Sampling Date: 02/07/2017
Sampling Type: Soil
Sampling Condition: Cool & Intact
Sample Received By: Celey D. Keene

Sample ID: PT 3 @ 9' (H700315-05)

BTEx 8021B		mg/kg		Analyzed By: MS					
Analyte	Result	Reporting Limit	Analyzed	Method Blank	BS	% Recovery	True Value QC	RPD	Qualifier
Benzene*	120	10.0	02/08/2017	ND	2.23	112	2.00	0.753	
Toluene*	471	10.0	02/08/2017	ND	2.18	109	2.00	0.516	
Ethylbenzene*	164	10.0	02/08/2017	ND	2.17	108	2.00	0.0492	
Total Xylenes*	686	30.0	02/08/2017	ND	6.16	103	6.00	0.258	
Total BTEX	1440	60.0	02/08/2017	ND					

Surrogate: 4-Bromofluorobenzene (PID) 112 % 73.6-140

Chloride, SM4500Cl-B		mg/kg		Analyzed By: HM					
Analyte	Result	Reporting Limit	Analyzed	Method Blank	BS	% Recovery	True Value QC	RPD	Qualifier
Chloride	48.0	16.0	02/08/2017	ND	448	112	400	3.64	

TPH 8015M		mg/kg		Analyzed By: MS					S-06	
Analyte	Result	Reporting Limit	Analyzed	Method Blank	BS	% Recovery	True Value QC	RPD	Qualifier	
GRO C6-C10	12600	100	02/08/2017	ND	184	91.9	200	0.449		
DRO >C10-C28	24900	100	02/08/2017	ND	193	96.3	200	4.05		

Surrogate: 1-Chlorooctane 527 % 35-147

Surrogate: 1-Chlorooctadecane 264 % 28-171

Cardinal Laboratories

*=Accredited Analyte

PLEASE NOTE: Liability and Damages. Cardinal's liability and client's exclusive remedy for any claim arising, whether based in contract or tort, shall be limited to the amount paid by client for analyses. All claims, including those for negligence and any other cause whatsoever shall be deemed waived unless made in writing and received by Cardinal within thirty (30) days after completion of the applicable service. In no event shall Cardinal be liable for incidental or consequential damages, including, without limitation, business interruptions, loss of use, or loss of profits incurred by client, its subsidiaries, affiliates or successors arising out of or related to the performance of the services hereunder by Cardinal, regardless of whether such claim is based upon any of the above stated reasons or otherwise. Results relate only to the samples identified above. This report shall not be reproduced except in full with written approval of Cardinal Laboratories.



Celey D. Keene, Lab Director/Quality Manager

Analytical Results For:

DCP Midstream - Midland
HACK CONDER
10 Desta Dr., #400-W
Midland TX, 79705
Fax To: None

Received: 02/07/2017
Reported: 02/08/2017
Project Name: M EXTENSION LINE
Project Number: NONE GIVEN
Project Location: NOT GIVEN

Sampling Date: 02/07/2017
Sampling Type: Soil
Sampling Condition: Cool & Intact
Sample Received By: Celey D. Keene

Sample ID: PT 4 @ 1' (H700315-06)

BTEx 8021B		mg/kg		Analyzed By: MS					
Analyte	Result	Reporting Limit	Analyzed	Method Blank	BS	% Recovery	True Value QC	RPD	Qualifier
Benzene*	0.206	0.050	02/08/2017	ND	2.23	112	2.00	0.753	
Toluene*	0.312	0.050	02/08/2017	ND	2.18	109	2.00	0.516	
Ethylbenzene*	<0.050	0.050	02/08/2017	ND	2.17	108	2.00	0.0492	
Total Xylenes*	<0.150	0.150	02/08/2017	ND	6.16	103	6.00	0.258	
Total BTEX	0.518	0.300	02/08/2017	ND					

Surrogate: 4-Bromofluorobenzene (PID) 106 % 73.6-140

Chloride, SM4500CI-B		mg/kg		Analyzed By: HM						
Analyte	Result	Reporting Limit	Analyzed	Method Blank	BS	% Recovery	True Value QC	RPD	Qualifier	
Chloride	16.0	16.0	02/08/2017	ND	400	100	400	11.3		

TPH 8015M		mg/kg		Analyzed By: MS					
Analyte	Result	Reporting Limit	Analyzed	Method Blank	BS	% Recovery	True Value QC	RPD	Qualifier
GRO C6-C10	<10.0	10.0	02/08/2017	ND	184	91.9	200	0.449	
DRO >C10-C28	52.0	10.0	02/08/2017	ND	193	96.3	200	4.05	

Surrogate: 1-Chlorooctane 82.5 % 35-147

Surrogate: 1-Chlorooctadecane 98.1 % 28-171

Cardinal Laboratories

*=Accredited Analyte

PLEASE NOTE: Liability and Damages. Cardinal's liability and client's exclusive remedy for any claim arising, whether based in contract or tort, shall be limited to the amount paid by client for analyses. All claims, including those for negligence and any other cause whatsoever shall be deemed waived unless made in writing and received by Cardinal within thirty (30) days after completion of the applicable service. In no event shall Cardinal be liable for incidental or consequential damages, including, without limitation, business interruptions, loss of use, or loss of profits incurred by client, its subsidiaries, affiliates or successors arising out of or related to the performance of the services hereunder by Cardinal, regardless of whether such claim is based upon any of the above stated reasons or otherwise. Results relate only to the samples identified above. This report shall not be reproduced except in full with written approval of Cardinal Laboratories.



Celey D. Keene, Lab Director/Quality Manager

Analytical Results For:

DCP Midstream - Midland
HACK CONDER
10 Desta Dr., #400-W
Midland TX, 79705
Fax To: None

Received: 02/07/2017
Reported: 02/08/2017
Project Name: M EXTENSION LINE
Project Number: NONE GIVEN
Project Location: NOT GIVEN

Sampling Date: 02/07/2017
Sampling Type: Soil
Sampling Condition: Cool & Intact
Sample Received By: Celey D. Keene

Sample ID: PT 5 @ 1' (H700315-07)

BTEx 8021B		mg/kg		Analyzed By: MS					
Analyte	Result	Reporting Limit	Analyzed	Method Blank	BS	% Recovery	True Value QC	RPD	Qualifier
Benzene*	<0.050	0.050	02/08/2017	ND	2.23	112	2.00	0.753	
Toluene*	<0.050	0.050	02/08/2017	ND	2.18	109	2.00	0.516	
Ethylbenzene*	<0.050	0.050	02/08/2017	ND	2.17	108	2.00	0.0492	
Total Xylenes*	<0.150	0.150	02/08/2017	ND	6.16	103	6.00	0.258	
Total BTEx	<0.300	0.300	02/08/2017	ND					

Surrogate: 4-Bromofluorobenzene (PID) 105 % 73.6-140

Chloride, SM4500CI-B		mg/kg		Analyzed By: HM					
Analyte	Result	Reporting Limit	Analyzed	Method Blank	BS	% Recovery	True Value QC	RPD	Qualifier
Chloride	64.0	16.0	02/08/2017	ND	400	100	400	11.3	

TPH 8015M		mg/kg		Analyzed By: MS					
Analyte	Result	Reporting Limit	Analyzed	Method Blank	BS	% Recovery	True Value QC	RPD	Qualifier
GRO C6-C10	<10.0	10.0	02/08/2017	ND	184	91.9	200	0.449	
DRO >C10-C28	<10.0	10.0	02/08/2017	ND	193	96.3	200	4.05	

Surrogate: 1-Chlorooctane 82.4 % 35-147

Surrogate: 1-Chlorooctadecane 94.1 % 28-171

Cardinal Laboratories

*=Accredited Analyte

PLEASE NOTE: Liability and Damages. Cardinal's liability and client's exclusive remedy for any claim arising, whether based in contract or tort, shall be limited to the amount paid by client for analyses. All claims, including those for negligence and any other cause whatsoever shall be deemed waived unless made in writing and received by Cardinal within thirty (30) days after completion of the applicable service. In no event shall Cardinal be liable for incidental or consequential damages, including, without limitation, business interruptions, loss of use, or loss of profits incurred by client, its subsidiaries, affiliates or successors arising out of or related to the performance of the services hereunder by Cardinal, regardless of whether such claim is based upon any of the above stated reasons or otherwise. Results relate only to the samples identified above. This report shall not be reproduced except in full with written approval of Cardinal Laboratories.



Celey D. Keene, Lab Director/Quality Manager

Analytical Results For:

DCP Midstream - Midland
HACK CONDER
10 Desta Dr., #400-W
Midland TX, 79705
Fax To: None

Received: 02/07/2017
Reported: 02/08/2017
Project Name: M EXTENSION LINE
Project Number: NONE GIVEN
Project Location: NOT GIVEN

Sampling Date: 02/07/2017
Sampling Type: Soil
Sampling Condition: Cool & Intact
Sample Received By: Celey D. Keene

Sample ID: PT 6 @ 1' (H700315-08)

BTEx 8021B		mg/kg		Analyzed By: MS						
Analyte	Result	Reporting Limit	Analyzed	Method Blank	BS	% Recovery	True Value QC	RPD	Qualifier	
Benzene*	<0.050	0.050	02/08/2017	ND	2.23	112	2.00	0.753		
Toluene*	<0.050	0.050	02/08/2017	ND	2.18	109	2.00	0.516		
Ethylbenzene*	<0.050	0.050	02/08/2017	ND	2.17	108	2.00	0.0492		
Total Xylenes*	<0.150	0.150	02/08/2017	ND	6.16	103	6.00	0.258		
Total BTEx	<0.300	0.300	02/08/2017	ND						

Surrogate: 4-Bromofluorobenzene (PID) 106 % 73.6-140

Chloride, SM4500CI-B		mg/kg		Analyzed By: HM					
Analyte	Result	Reporting Limit	Analyzed	Method Blank	BS	% Recovery	True Value QC	RPD	Qualifier
Chloride	48.0	16.0	02/08/2017	ND	400	100	400	11.3	

TPH 8015M		mg/kg		Analyzed By: MS					
Analyte	Result	Reporting Limit	Analyzed	Method Blank	BS	% Recovery	True Value QC	RPD	Qualifier
GRO C6-C10	<10.0	10.0	02/08/2017	ND	184	91.9	200	0.449	
DRO >C10-C28	<10.0	10.0	02/08/2017	ND	193	96.3	200	4.05	

Surrogate: 1-Chlorooctane 76.1 % 35-147

Surrogate: 1-Chlorooctadecane 91.7 % 28-171

Cardinal Laboratories

*=Accredited Analyte

PLEASE NOTE: Liability and Damages. Cardinal's liability and client's exclusive remedy for any claim arising, whether based in contract or tort, shall be limited to the amount paid by client for analyses. All claims, including those for negligence and any other cause whatsoever shall be deemed waived unless made in writing and received by Cardinal within thirty (30) days after completion of the applicable service. In no event shall Cardinal be liable for incidental or consequential damages, including, without limitation, business interruptions, loss of use, or loss of profits incurred by client, its subsidiaries, affiliates or successors arising out of or related to the performance of the services hereunder by Cardinal, regardless of whether such claim is based upon any of the above stated reasons or otherwise. Results relate only to the samples identified above. This report shall not be reproduced except in full with written approval of Cardinal Laboratories.



Celey D. Keene, Lab Director/Quality Manager

Analytical Results For:

DCP Midstream - Midland
HACK CONDER
10 Desta Dr., #400-W
Midland TX, 79705
Fax To: None

Received: 02/07/2017
Reported: 02/08/2017
Project Name: M EXTENSION LINE
Project Number: NONE GIVEN
Project Location: NOT GIVEN

Sampling Date: 02/07/2017
Sampling Type: Soil
Sampling Condition: Cool & Intact
Sample Received By: Celey D. Keene

Sample ID: PT 7 @ 2' (H700315-09)

BTX 8021B		mg/kg		Analyzed By: MS					
Analyte	Result	Reporting Limit	Analyzed	Method Blank	BS	% Recovery	True Value QC	RPD	Qualifier
Benzene*	2.70	1.00	02/08/2017	ND	2.23	112	2.00	0.753	
Toluene*	28.6	1.00	02/08/2017	ND	2.18	109	2.00	0.516	
Ethylbenzene*	22.2	1.00	02/08/2017	ND	2.17	108	2.00	0.0492	
Total Xylenes*	68.5	3.00	02/08/2017	ND	6.16	103	6.00	0.258	
Total BTX	122	6.00	02/08/2017	ND					

Surrogate: 4-Bromofluorobenzene (PID) 116 % 73.6-140

Chloride, SM4500CI-B		mg/kg		Analyzed By: HM					
Analyte	Result	Reporting Limit	Analyzed	Method Blank	BS	% Recovery	True Value QC	RPD	Qualifier
Chloride	96.0	16.0	02/08/2017	ND	400	100	400	11.3	

TPH 8015M		mg/kg		Analyzed By: MS					
Analyte	Result	Reporting Limit	Analyzed	Method Blank	BS	% Recovery	True Value QC	RPD	Qualifier
GRO C6-C10	946	10.0	02/08/2017	ND	184	91.9	200	0.449	
DRO >C10-C28	4050	10.0	02/08/2017	ND	193	96.3	200	4.05	

Surrogate: 1-Chlorooctane 115 % 35-147

Surrogate: 1-Chlorooctadecane 144 % 28-171

Cardinal Laboratories

*=Accredited Analyte

PLEASE NOTE: Liability and Damages. Cardinal's liability and client's exclusive remedy for any claim arising, whether based in contract or tort, shall be limited to the amount paid by client for analyses. All claims, including those for negligence and any other cause whatsoever shall be deemed waived unless made in writing and received by Cardinal within thirty (30) days after completion of the applicable service. In no event shall Cardinal be liable for incidental or consequential damages, including, without limitation, business interruptions, loss of use, or loss of profits incurred by client, its subsidiaries, affiliates or successors arising out of or related to the performance of the services hereunder by Cardinal, regardless of whether such claim is based upon any of the above stated reasons or otherwise. Results relate only to the samples identified above. This report shall not be reproduced except in full with written approval of Cardinal Laboratories.



Celey D. Keene, Lab Director/Quality Manager

Analytical Results For:

DCP Midstream - Midland
HACK CONDER
10 Desta Dr., #400-W
Midland TX, 79705
Fax To: None

Received: 02/07/2017
Reported: 02/08/2017
Project Name: M EXTENSION LINE
Project Number: NONE GIVEN
Project Location: NOT GIVEN

Sampling Date: 02/07/2017
Sampling Type: Soil
Sampling Condition: Cool & Intact
Sample Received By: Celey D. Keene

Sample ID: PT 8 @ 2' (H700315-10)

BTEx 8021B		mg/kg		Analyzed By: MS					
Analyte	Result	Reporting Limit	Analyzed	Method Blank	BS	% Recovery	True Value QC	RPD	Qualifier
Benzene*	<0.050	0.050	02/08/2017	ND	2.23	112	2.00	0.753	
Toluene*	0.092	0.050	02/08/2017	ND	2.18	109	2.00	0.516	
Ethylbenzene*	<0.050	0.050	02/08/2017	ND	2.17	108	2.00	0.0492	
Total Xylenes*	<0.150	0.150	02/08/2017	ND	6.16	103	6.00	0.258	
Total BTEx	<0.300	0.300	02/08/2017	ND					

Surrogate: 4-Bromofluorobenzene (PID) 106 % 73.6-140

Chloride, SM4500CI-B		mg/kg		Analyzed By: HM					
Analyte	Result	Reporting Limit	Analyzed	Method Blank	BS	% Recovery	True Value QC	RPD	Qualifier
Chloride	16.0	16.0	02/08/2017	ND	400	100	400	11.3	

TPH 8015M		mg/kg		Analyzed By: MS					
Analyte	Result	Reporting Limit	Analyzed	Method Blank	BS	% Recovery	True Value QC	RPD	Qualifier
GRO C6-C10	<10.0	10.0	02/08/2017	ND	184	91.9	200	0.449	
DRO >C10-C28	13.8	10.0	02/08/2017	ND	193	96.3	200	4.05	

Surrogate: 1-Chlorooctane 79.3 % 35-147

Surrogate: 1-Chlorooctadecane 94.4 % 28-171

Cardinal Laboratories

*=Accredited Analyte

PLEASE NOTE: Liability and Damages. Cardinal's liability and client's exclusive remedy for any claim arising, whether based in contract or tort, shall be limited to the amount paid by client for analyses. All claims, including those for negligence and any other cause whatsoever shall be deemed waived unless made in writing and received by Cardinal within thirty (30) days after completion of the applicable service. In no event shall Cardinal be liable for incidental or consequential damages, including, without limitation, business interruptions, loss of use, or loss of profits incurred by client, its subsidiaries, affiliates or successors arising out of or related to the performance of the services hereunder by Cardinal, regardless of whether such claim is based upon any of the above stated reasons or otherwise. Results relate only to the samples identified above. This report shall not be reproduced except in full with written approval of Cardinal Laboratories.



Celey D. Keene, Lab Director/Quality Manager

Analytical Results For:

DCP Midstream - Midland
HACK CONDER
10 Desta Dr., #400-W
Midland TX, 79705
Fax To: None

Received: 02/07/2017
Reported: 02/08/2017
Project Name: M EXTENSION LINE
Project Number: NONE GIVEN
Project Location: NOT GIVEN

Sampling Date: 02/07/2017
Sampling Type: Soil
Sampling Condition: Cool & Intact
Sample Received By: Celey D. Keene

Sample ID: PT 1 @ 4' (H700315-11)

BTEx 8021B		mg/kg		Analyzed By: MS					
Analyte	Result	Reporting Limit	Analyzed	Method Blank	BS	% Recovery	True Value QC	RPD	Qualifier
Benzene*	<0.050	0.050	02/08/2017	ND	2.23	112	2.00	0.753	
Toluene*	<0.050	0.050	02/08/2017	ND	2.18	109	2.00	0.516	
Ethylbenzene*	<0.050	0.050	02/08/2017	ND	2.17	108	2.00	0.0492	
Total Xylenes*	<0.150	0.150	02/08/2017	ND	6.16	103	6.00	0.258	
Total BTEx	<0.300	0.300	02/08/2017	ND					

Surrogate: 4-Bromofluorobenzene (PID) 104 % 73.6-140

Chloride, SM4500CI-B		mg/kg		Analyzed By: HM					
Analyte	Result	Reporting Limit	Analyzed	Method Blank	BS	% Recovery	True Value QC	RPD	Qualifier
Chloride	48.0	16.0	02/08/2017	ND	400	100	400	11.3	

TPH 8015M		mg/kg		Analyzed By: MS					
Analyte	Result	Reporting Limit	Analyzed	Method Blank	BS	% Recovery	True Value QC	RPD	Qualifier
GRO C6-C10	<10.0	10.0	02/08/2017	ND	184	91.9	200	0.449	
DRO >C10-C28	89.4	10.0	02/08/2017	ND	193	96.3	200	4.05	

Surrogate: 1-Chlorooctane 81.2 % 35-147

Surrogate: 1-Chlorooctadecane 96.7 % 28-171

Cardinal Laboratories

*=Accredited Analyte

PLEASE NOTE: Liability and Damages. Cardinal's liability and client's exclusive remedy for any claim arising, whether based in contract or tort, shall be limited to the amount paid by client for analyses. All claims, including those for negligence and any other cause whatsoever shall be deemed waived unless made in writing and received by Cardinal within thirty (30) days after completion of the applicable service. In no event shall Cardinal be liable for incidental or consequential damages, including, without limitation, business interruptions, loss of use, or loss of profits incurred by client, its subsidiaries, affiliates or successors arising out of or related to the performance of the services hereunder by Cardinal, regardless of whether such claim is based upon any of the above stated reasons or otherwise. Results relate only to the samples identified above. This report shall not be reproduced except in full with written approval of Cardinal Laboratories.



Celey D. Keene, Lab Director/Quality Manager

Analytical Results For:

DCP Midstream - Midland
HACK CONDER
10 Desta Dr., #400-W
Midland TX, 79705
Fax To: None

Received: 02/07/2017
Reported: 02/08/2017
Project Name: M EXTENSION LINE
Project Number: NONE GIVEN
Project Location: NOT GIVEN

Sampling Date: 02/07/2017
Sampling Type: Soil
Sampling Condition: Cool & Intact
Sample Received By: Celey D. Keene

Sample ID: PT 9 @ 2' (H700315-12)

BTEx 8021B		mg/kg		Analyzed By: MS					
Analyte	Result	Reporting Limit	Analyzed	Method Blank	BS	% Recovery	True Value QC	RPD	Qualifier
Benzene*	<0.050	0.050	02/08/2017	ND	2.23	112	2.00	0.753	
Toluene*	<0.050	0.050	02/08/2017	ND	2.18	109	2.00	0.516	
Ethylbenzene*	<0.050	0.050	02/08/2017	ND	2.17	108	2.00	0.0492	
Total Xylenes*	<0.150	0.150	02/08/2017	ND	6.16	103	6.00	0.258	
Total BTEx	<0.300	0.300	02/08/2017	ND					

Surrogate: 4-Bromofluorobenzene (PID) 106 % 73.6-140

Chloride, SM4500CI-B		mg/kg		Analyzed By: HM						
Analyte	Result	Reporting Limit	Analyzed	Method Blank	BS	% Recovery	True Value QC	RPD	Qualifier	
Chloride	<16.0	16.0	02/08/2017	ND	400	100	400	11.3		

TPH 8015M		mg/kg		Analyzed By: MS					
Analyte	Result	Reporting Limit	Analyzed	Method Blank	BS	% Recovery	True Value QC	RPD	Qualifier
GRO C6-C10	<10.0	10.0	02/08/2017	ND	184	91.9	200	0.449	
DRO >C10-C28	33.9	10.0	02/08/2017	ND	193	96.3	200	4.05	

Surrogate: 1-Chlorooctane 80.0 % 35-147

Surrogate: 1-Chlorooctadecane 94.5 % 28-171

Cardinal Laboratories

*=Accredited Analyte

PLEASE NOTE: Liability and Damages. Cardinal's liability and client's exclusive remedy for any claim arising, whether based in contract or tort, shall be limited to the amount paid by client for analyses. All claims, including those for negligence and any other cause whatsoever shall be deemed waived unless made in writing and received by Cardinal within thirty (30) days after completion of the applicable service. In no event shall Cardinal be liable for incidental or consequential damages, including, without limitation, business interruptions, loss of use, or loss of profits incurred by client, its subsidiaries, affiliates or successors arising out of or related to the performance of the services hereunder by Cardinal, regardless of whether such claim is based upon any of the above stated reasons or otherwise. Results relate only to the samples identified above. This report shall not be reproduced except in full with written approval of Cardinal Laboratories.



Celey D. Keene, Lab Director/Quality Manager

Notes and Definitions

S-06	The recovery of this surrogate is outside control limits due to sample dilution required from high analyte concentration and/or matrix interference's.
QM-07	The spike recovery was outside acceptance limits for the MS and/or MSD. The batch was accepted based on acceptable LCS recovery.
ND	Analyte NOT DETECTED at or above the reporting limit
RPD	Relative Percent Difference
**	Samples not received at proper temperature of 6°C or below.
***	Insufficient time to reach temperature.
-	Chloride by SM4500Cl-B does not require samples be received at or below 6°C Samples reported on an as received basis (wet) unless otherwise noted on report

Cardinal Laboratories

*=Accredited Analyte

PLEASE NOTE: Liability and Damages. Cardinal's liability and client's exclusive remedy for any claim arising, whether based in contract or tort, shall be limited to the amount paid by client for analyses. All claims, including those for negligence and any other cause whatsoever shall be deemed waived unless made in writing and received by Cardinal within thirty (30) days after completion of the applicable service. In no event shall Cardinal be liable for incidental or consequential damages, including, without limitation, business interruptions, loss of use, or loss of profits incurred by client, its subsidiaries, affiliates or successors arising out of or related to the performance of the services hereunder by Cardinal, regardless of whether such claim is based upon any of the above stated reasons or otherwise. Results relate only to the samples identified above. This report shall not be reproduced except in full with written approval of Cardinal Laboratories.



Celey D. Keene, Lab Director/Quality Manager

CHAIN-OF-CUSTODY AND ANALYSIS REQUEST

101 East Marland, Hobbs, NM 88240
(575) 393-2326 FAX (575) 393-2476

Company Name: <u>DCP Midstream</u>				BILL TO				ANALYSIS REQUEST			
Project Manager: <u>Hack Corder</u>				P.O. #:							
Address:				Company: <u>DCP</u>							
City:				Attn:							
State:				Address:							
Phone #:				City:							
Project #:				State:							
Project Name:				Zip:							
Project Location: <u>M Extension Line</u>				Phone #:							
Sample Name: <u>Kyle Norman</u>				Fax #:							

Lab I.D.	Sample I.D.	(G)RAB OR (C)OMP	# CONTAINERS	MATRIX						DATE	TIME	CL	TPH	BTEX	
				GROUNDWATER	WASTEWATER	SOIL	OIL	SLUDGE	OTHER :						ACID/BASE:
11700315-															
01	P41 @ 3'	G1	1	✓						2-7-17	8:30	✓	✓	✓	
02	P42 @ 3'	G1	1	✓							8:40	✓	✓	✓	
03	P42 @ 4'	G1	1	✓							3:00	✓	✓	✓	
04	P43 @ 8'	G1	1	✓							10:00	✓	✓	✓	
05	P43 @ 9'	G1	1	✓							2:45	✓	✓	✓	
06	P44 @ 1'	G1	1	✓							9:45	✓	✓	✓	
07	P45 @ 1'	G1	1	✓							10:00	✓	✓	✓	
08	P46 @ 1'	G1	1	✓							10:40	✓	✓	✓	
09	P47 @ 2'	G1	1	✓							12:00	✓	✓	✓	
10	P48 @ 2'	G1	1	✓							12:40	✓	✓	✓	

Relinquished By: <u>Kyle Norman</u>		Date: <u>2-7-17</u>		Received By: <u>Hack Corder</u>		Date: <u>2-7-17</u>	
Time: <u>4:41p</u>		Time: <u>4:41p</u>		Time: <u>4:41p</u>		Time: <u>4:41p</u>	
Relinquished By:		Received By:		Received By:		Received By:	

Delivered By: (Circle One) Sample - UPS - Bus - Other: <u>2.10</u>		Sample Condition Cool <input checked="" type="checkbox"/> Intact <input checked="" type="checkbox"/> Yes <input checked="" type="checkbox"/> No <input checked="" type="checkbox"/>		CHECKED BY: (Initials) <u>ca #75</u>	
REMARKS: <u>Hack Corder</u> <u>K Norman</u> <u>DUSTH!</u>					



101 East Marland, Hobbs, NM 88240
(575) 393-2326 FAX (575) 393-2476

[illegible]



PHONE (575) 393-2326 ° 101 E. MARLAND ° HOBBS, NM 88240

September 21, 2017

HACK CONDER

DCP Midstream - Midland

10 Desta Dr., #400-W

Midland, TX 79705

RE: M EXTENSION LINE

Enclosed are the results of analyses for samples received by the laboratory on 09/15/17 15:32.

Cardinal Laboratories is accredited through Texas NELAP under certificate number T104704398-16-8. Accreditation applies to drinking water, non-potable water and solid and chemical materials. All accredited analytes are denoted by an asterisk (*). For a complete list of accredited analytes and matrices visit the TCEQ website at www.tceq.texas.gov/field/qa/lab_accred_certif.html.

Cardinal Laboratories is accredited through the State of Colorado Department of Public Health and Environment for:

Method EPA 552.2	Haloacetic Acids (HAA-5)
Method EPA 524.2	Total Trihalomethanes (TTHM)
Method EPA 524.4	Regulated VOCs (V1, V2, V3)

Accreditation applies to public drinking water matrices.

This report meets NELAP requirements and is made up of a cover page, analytical results, and a copy of the original chain-of-custody. If you have any questions concerning this report, please feel free to contact me.

Sincerely,

A handwritten signature in black ink that reads "Celey D. Keene". The signature is written in a cursive style with a large, stylized 'C' and 'K'.

Celey D. Keene

Lab Director/Quality Manager

Analytical Results For:

DCP Midstream - Midland
HACK CONDER
10 Desta Dr., #400-W
Midland TX, 79705
Fax To: None

Received: 09/15/2017
Reported: 09/21/2017
Project Name: M EXTENSION LINE
Project Number: NONE GIVEN
Project Location: NOT GIVEN

Sampling Date: 09/15/2017
Sampling Type: Soil
Sampling Condition: ** (See Notes)
Sample Received By: Tamara Oldaker

Sample ID: WALL PT. 1 (H702498-01)

Chloride, SM4500Cl-B		mg/kg		Analyzed By: AC					
Analyte	Result	Reporting Limit	Analyzed	Method Blank	BS	% Recovery	True Value QC	RPD	Qualifier
Chloride	16.0	16.0	09/18/2017	ND	416	104	400	3.77	
TPH 8015M		mg/kg		Analyzed By: MS					
Analyte	Result	Reporting Limit	Analyzed	Method Blank	BS	% Recovery	True Value QC	RPD	Qualifier
GRO C6-C10	<10.0	10.0	09/19/2017	ND	178	88.9	200	0.398	
DRO >C10-C28	<10.0	10.0	09/19/2017	ND	185	92.3	200	1.18	
EXT DRO >C28-C36	<10.0	10.0	09/19/2017	ND					
Surrogate: 1-Chlorooctane		96.8 %	28.3-164						
Surrogate: 1-Chlorooctadecane		103 %	34.7-157						

Sample ID: WALL PT. 2 (H702498-02)

Chloride, SM4500Cl-B		mg/kg		Analyzed By: AC					
Analyte	Result	Reporting Limit	Analyzed	Method Blank	BS	% Recovery	True Value QC	RPD	Qualifier
Chloride	32.0	16.0	09/18/2017	ND	416	104	400	3.77	
TPH 8015M		mg/kg		Analyzed By: MS					
Analyte	Result	Reporting Limit	Analyzed	Method Blank	BS	% Recovery	True Value QC	RPD	Qualifier
GRO C6-C10	<10.0	10.0	09/19/2017	ND	178	88.9	200	0.398	
DRO >C10-C28	<10.0	10.0	09/19/2017	ND	185	92.3	200	1.18	
EXT DRO >C28-C36	<10.0	10.0	09/19/2017	ND					
Surrogate: 1-Chlorooctane		97.4 %	28.3-164						
Surrogate: 1-Chlorooctadecane		109 %	34.7-157						

Cardinal Laboratories

*=Accredited Analyte

PLEASE NOTE: Liability and Damages. Cardinal's liability and client's exclusive remedy for any claim arising, whether based in contract or tort, shall be limited to the amount paid by client for analyses. All claims, including those for negligence and any other cause whatsoever shall be deemed waived unless made in writing and received by Cardinal within thirty (30) days after completion of the applicable service. In no event shall Cardinal be liable for incidental or consequential damages, including, without limitation, business interruptions, loss of use, or loss of profits incurred by client, its subsidiaries, affiliates or successors arising out of or related to the performance of the services hereunder by Cardinal, regardless of whether such claim is based upon any of the above stated reasons or otherwise. Results relate only to the samples identified above. This report shall not be reproduced except in full with written approval of Cardinal Laboratories.



Celey D. Keene, Lab Director/Quality Manager

Analytical Results For:

DCP Midstream - Midland
HACK CONDER
10 Desta Dr., #400-W
Midland TX, 79705
Fax To: None

Received: 09/15/2017
Reported: 09/21/2017
Project Name: M EXTENSION LINE
Project Number: NONE GIVEN
Project Location: NOT GIVEN

Sampling Date: 09/15/2017
Sampling Type: Soil
Sampling Condition: ** (See Notes)
Sample Received By: Tamara Oldaker

Sample ID: WALL PT. 3 (H702498-03)

Chloride, SM4500CI-B		mg/kg		Analyzed By: AC					
Analyte	Result	Reporting Limit	Analyzed	Method Blank	BS	% Recovery	True Value QC	RPD	Qualifier
Chloride	176	16.0	09/18/2017	ND	416	104	400	3.77	
TPH 8015M		mg/kg		Analyzed By: MS					
Analyte	Result	Reporting Limit	Analyzed	Method Blank	BS	% Recovery	True Value QC	RPD	Qualifier
GRO C6-C10	<10.0	10.0	09/19/2017	ND	178	88.9	200	0.398	
DRO >C10-C28	<10.0	10.0	09/19/2017	ND	185	92.3	200	1.18	
EXT DRO >C28-C36	<10.0	10.0	09/19/2017	ND					
Surrogate: 1-Chlorooctane		93.8 %	28.3-164						
Surrogate: 1-Chlorooctadecane		109 %	34.7-157						

Sample ID: WALL PT. 4 (H702498-04)

Chloride, SM4500Cl-B		mg/kg		Analyzed By: AC					
Analyte	Result	Reporting Limit	Analyzed	Method Blank	BS	% Recovery	True Value QC	RPD	Qualifier
Chloride	240	16.0	09/18/2017	ND	416	104	400	3.77	
TPH 8015M		mg/kg		Analyzed By: MS					
Analyte	Result	Reporting Limit	Analyzed	Method Blank	BS	% Recovery	True Value QC	RPD	Qualifier
GRO C6-C10	<10.0	10.0	09/19/2017	ND	178	88.9	200	0.398	
DRO >C10-C28	<10.0	10.0	09/19/2017	ND	185	92.3	200	1.18	
EXT DRO >C28-C36	<10.0	10.0	09/19/2017	ND					
Surrogate: 1-Chlorooctane		103 %	28.3-164						
Surrogate: 1-Chlorooctadecane		106 %	34.7-157						

Cardinal Laboratories

*=Accredited Analyte

PLEASE NOTE: Liability and Damages. Cardinal's liability and client's exclusive remedy for any claim arising, whether based in contract or tort, shall be limited to the amount paid by client for analyses. All claims, including those for negligence and any other cause whatsoever shall be deemed waived unless made in writing and received by Cardinal within thirty (30) days after completion of the applicable service. In no event shall Cardinal be liable for incidental or consequential damages, including, without limitation, business interruptions, loss of use, or loss of profits incurred by client, its subsidiaries, affiliates or successors arising out of or related to the performance of the services hereunder by Cardinal, regardless of whether such claim is based upon any of the above stated reasons or otherwise. Results relate only to the samples identified above. This report shall not be reproduced except in full with written approval of Cardinal Laboratories.



Celey D. Keene, Lab Director/Quality Manager

Analytical Results For:

DCP Midstream - Midland
HACK CONDER
10 Desta Dr., #400-W
Midland TX, 79705
Fax To: None

Received: 09/15/2017
Reported: 09/21/2017
Project Name: M EXTENSION LINE
Project Number: NONE GIVEN
Project Location: NOT GIVEN

Sampling Date: 09/15/2017
Sampling Type: Soil
Sampling Condition: ** (See Notes)
Sample Received By: Tamara Oldaker

Sample ID: WALL PT. 5 (H702498-05)

Chloride, SM4500Cl-B		mg/kg		Analyzed By: AC					
Analyte	Result	Reporting Limit	Analyzed	Method Blank	BS	% Recovery	True Value QC	RPD	Qualifier
Chloride	32.0	16.0	09/18/2017	ND	416	104	400	3.77	
TPH 8015M		mg/kg		Analyzed By: MS					
Analyte	Result	Reporting Limit	Analyzed	Method Blank	BS	% Recovery	True Value QC	RPD	Qualifier
GRO C6-C10	<10.0	10.0	09/19/2017	ND	178	88.9	200	0.398	
DRO >C10-C28	<10.0	10.0	09/19/2017	ND	185	92.3	200	1.18	
EXT DRO >C28-C36	<10.0	10.0	09/19/2017	ND					
Surrogate: 1-Chlorooctane		100 %	28.3-164						
Surrogate: 1-Chlorooctadecane		110 %	34.7-157						

Sample ID: WALL PT. 6 (H702498-06)

Chloride, SM4500Cl-B		mg/kg		Analyzed By: AC					
Analyte	Result	Reporting Limit	Analyzed	Method Blank	BS	% Recovery	True Value QC	RPD	Qualifier
Chloride	<16.0	16.0	09/18/2017	ND	416	104	400	3.77	
TPH 8015M		mg/kg		Analyzed By: MS					
Analyte	Result	Reporting Limit	Analyzed	Method Blank	BS	% Recovery	True Value QC	RPD	Qualifier
GRO C6-C10	<10.0	10.0	09/19/2017	ND	178	88.9	200	0.398	
DRO >C10-C28	19.7	10.0	09/19/2017	ND	185	92.3	200	1.18	
EXT DRO >C28-C36	<10.0	10.0	09/19/2017	ND					
Surrogate: 1-Chlorooctane		90.8 %	28.3-164						
Surrogate: 1-Chlorooctadecane		93.8 %	34.7-157						

Cardinal Laboratories

*=Accredited Analyte

PLEASE NOTE: Liability and Damages. Cardinal's liability and client's exclusive remedy for any claim arising, whether based in contract or tort, shall be limited to the amount paid by client for analyses. All claims, including those for negligence and any other cause whatsoever shall be deemed waived unless made in writing and received by Cardinal within thirty (30) days after completion of the applicable service. In no event shall Cardinal be liable for incidental or consequential damages, including, without limitation, business interruptions, loss of use, or loss of profits incurred by client, its subsidiaries, affiliates or successors arising out of or related to the performance of the services hereunder by Cardinal, regardless of whether such claim is based upon any of the above stated reasons or otherwise. Results relate only to the samples identified above. This report shall not be reproduced except in full with written approval of Cardinal Laboratories.



Celey D. Keene, Lab Director/Quality Manager

Analytical Results For:

DCP Midstream - Midland
HACK CONDER
10 Desta Dr., #400-W
Midland TX, 79705
Fax To: None

Received: 09/15/2017
Reported: 09/21/2017
Project Name: M EXTENSION LINE
Project Number: NONE GIVEN
Project Location: NOT GIVEN

Sampling Date: 09/15/2017
Sampling Type: Soil
Sampling Condition: ** (See Notes)
Sample Received By: Tamara Oldaker

Sample ID: WALL PT. 7 (H702498-07)

Chloride, SM4500Cl-B		mg/kg		Analyzed By: AC					
Analyte	Result	Reporting Limit	Analyzed	Method Blank	BS	% Recovery	True Value QC	RPD	Qualifier
Chloride	16.0	16.0	09/18/2017	ND	432	108	400	0.00	
TPH 8015M		mg/kg		Analyzed By: MS					
Analyte	Result	Reporting Limit	Analyzed	Method Blank	BS	% Recovery	True Value QC	RPD	Qualifier
GRO C6-C10	<10.0	10.0	09/19/2017	ND	178	88.9	200	0.398	
DRO >C10-C28	12.5	10.0	09/19/2017	ND	185	92.3	200	1.18	
EXT DRO >C28-C36	<10.0	10.0	09/19/2017	ND					
Surrogate: 1-Chlorooctane	93.1 %	28.3-164							
Surrogate: 1-Chlorooctadecane	102 %	34.7-157							

Sample ID: WALL PT. 8 (H702498-08)

Chloride, SM4500Cl-B		mg/kg		Analyzed By: AC					
Analyte	Result	Reporting Limit	Analyzed	Method Blank	BS	% Recovery	True Value QC	RPD	Qualifier
Chloride	32.0	16.0	09/18/2017	ND	432	108	400	0.00	
TPH 8015M		mg/kg		Analyzed By: MS					
Analyte	Result	Reporting Limit	Analyzed	Method Blank	BS	% Recovery	True Value QC	RPD	Qualifier
GRO C6-C10	<10.0	10.0	09/20/2017	ND	178	88.9	200	0.398	
DRO >C10-C28	<10.0	10.0	09/20/2017	ND	185	92.3	200	1.18	
EXT DRO >C28-C36	<10.0	10.0	09/20/2017	ND					
Surrogate: 1-Chlorooctane	95.1 %	28.3-164							
Surrogate: 1-Chlorooctadecane	97.6 %	34.7-157							

Cardinal Laboratories

*=Accredited Analyte

PLEASE NOTE: Liability and Damages. Cardinal's liability and client's exclusive remedy for any claim arising, whether based in contract or tort, shall be limited to the amount paid by client for analyses. All claims, including those for negligence and any other cause whatsoever shall be deemed waived unless made in writing and received by Cardinal within thirty (30) days after completion of the applicable service. In no event shall Cardinal be liable for incidental or consequential damages, including, without limitation, business interruptions, loss of use, or loss of profits incurred by client, its subsidiaries, affiliates or successors arising out of or related to the performance of the services hereunder by Cardinal, regardless of whether such claim is based upon any of the above stated reasons or otherwise. Results relate only to the samples identified above. This report shall not be reproduced except in full with written approval of Cardinal Laboratories.



Celey D. Keene, Lab Director/Quality Manager

Notes and Definitions

QM-07	The spike recovery was outside acceptance limits for the MS and/or MSD. The batch was accepted based on acceptable LCS recovery.
ND	Analyte NOT DETECTED at or above the reporting limit
RPD	Relative Percent Difference
**	Samples not received at proper temperature of 6°C or below.
***	Insufficient time to reach temperature.
-	Chloride by SM4500Cl-B does not require samples be received at or below 6°C Samples reported on an as received basis (wet) unless otherwise noted on report

Cardinal Laboratories

*=Accredited Analyte

PLEASE NOTE: Liability and Damages. Cardinal's liability and client's exclusive remedy for any claim arising, whether based in contract or tort, shall be limited to the amount paid by client for analyses. All claims, including those for negligence and any other cause whatsoever shall be deemed waived unless made in writing and received by Cardinal within thirty (30) days after completion of the applicable service. In no event shall Cardinal be liable for incidental or consequential damages, including, without limitation, business interruptions, loss of use, or loss of profits incurred by client, its subsidiaries, affiliates or successors arising out of or related to the performance of the services hereunder by Cardinal, regardless of whether such claim is based upon any of the above stated reasons or otherwise. Results relate only to the samples identified above. This report shall not be reproduced except in full with written approval of Cardinal Laboratories.



Celey D. Keene, Lab Director/Quality Manager



CARDINAL LABORATORIES

101 East Marland, Hobbs, NM 88240 2111 Beechwood, Abilene, TX 79603
(505) 393-2326 FAX (505) 393-2476 (325) 673-7001 FAX (325) 673-7020

CHAIN-OF-CUSTODY AND ANALYSIS REQUEST

Company Name: DCP Midstream		P.O. #:		BILL TO																			
Project Manager: Hack Conder		Company:		ANALYSIS REQUEST																			
Address:		Attn:																					
City:		Address:																					
Phone #:		City:																					
Project #:		State:																					
Project Name:		Zip:																					
Project Location: M Extension Line		Phone #:																					
Sampler Name: Kyle Norman		Fax #:																					
FOR LAB USE ONLY																							
Lab I.D.	Sample I.D.	(G)RAB OR (C)OMP.	# CONTAINERS	MATRIX		PRESERV.		SAMPLING															
HT20498	Wall P+1	G	1	GROUNDWATER				DATE	TIME	Chlorides	TPH 8015 M EXT	BTEX	Texas TPH	Complete Cations/Anions	TDS								
1	P+1			WASTEWATER				9-15#	1300	✓	✓	✓											
2	P+2			SOIL				1330	✓	✓	✓												
3	P+3			OIL				1345	✓	✓	✓												
4	P+4			SLUDGE				1400	✓	✓	✓												
5	P+5			OTHER :				1415	✓	✓	✓												
6	P+6			ACID/BASE:				1425	✓	✓	✓												
7	P+7			ICE / COOL				1445	✓	✓	✓												
8	P+8			OTHER :				1500	✓	✓	✓												
REINQUISHED BY: [Signature]		Date: 9-15-17		Received By: [Signature]		Time: 3:23		Date: 9-15-17		Time: 1300		Chlorides		TPH 8015 M EXT		BTEX		Texas TPH		Complete Cations/Anions		TDS	
Relinquished By: [Signature]		Date: 9-15-17		Received By: [Signature]		Time: 3:23		Date: 9-15-17		Time: 1300		Chlorides		TPH 8015 M EXT		BTEX		Texas TPH		Complete Cations/Anions		TDS	
Delivered By: (Circle One) 8.0°C / 8.25°C		Sample Condition		Cool Intact		Yes No		Yes No		Yes No		Yes No		Yes No		Yes No		Yes No		Yes No		Yes No	
Sampler - UPS - Bus - Other: HC		CHECKED BY: (Initials)		HC		HC		HC		HC		HC		HC		HC		HC		HC		HC	
Cardinal cannot accept verbal changes. Please fax written changes to 505-393-2476		Corrected to 8.25°C		Corrected to 8.25°C		Corrected to 8.25°C		Corrected to 8.25°C		Corrected to 8.25°C		Corrected to 8.25°C		Corrected to 8.25°C		Corrected to 8.25°C		Corrected to 8.25°C		Corrected to 8.25°C		Corrected to 8.25°C	



PHONE (575) 393-2326 ° 101 E. MARLAND ° HOBBS, NM 88240

September 25, 2017

HACK CONDER

DCP Midstream - Midland

10 Desta Dr., #400-W

Midland, TX 79705

RE: M EXTENSION LINE

Enclosed are the results of analyses for samples received by the laboratory on 09/15/17 15:23.

Cardinal Laboratories is accredited through Texas NELAP under certificate number T104704398-16-8. Accreditation applies to drinking water, non-potable water and solid and chemical materials. All accredited analytes are denoted by an asterisk (*). For a complete list of accredited analytes and matrices visit the TCEQ website at www.tceq.texas.gov/field/qa/lab_accred_certif.html.

Cardinal Laboratories is accredited through the State of Colorado Department of Public Health and Environment for:

Method EPA 552.2	Haloacetic Acids (HAA-5)
Method EPA 524.2	Total Trihalomethanes (TTHM)
Method EPA 524.4	Regulated VOCs (V1, V2, V3)

Accreditation applies to public drinking water matrices.

This report meets NELAP requirements and is made up of a cover page, analytical results, and a copy of the original chain-of-custody. If you have any questions concerning this report, please feel free to contact me.

Sincerely,

A handwritten signature in black ink that reads "Celey D. Keene". The signature is written in a cursive, flowing style.

Celey D. Keene

Lab Director/Quality Manager

Analytical Results For:

DCP Midstream - Midland
HACK CONDER
10 Desta Dr., #400-W
Midland TX, 79705
Fax To: None

Received: 09/15/2017
Reported: 09/25/2017
Project Name: M EXTENSION LINE
Project Number: NONE GIVEN
Project Location: NOT GIVEN

Sampling Date: 09/15/2017
Sampling Type: Soil
Sampling Condition: ** (See Notes)
Sample Received By: Tamara Oldaker

Sample ID: PT 3 VERTICAL @ 17' (H702499-01)

BTEX 8021B		mg/kg		Analyzed By: MS					
Analyte	Result	Reporting Limit	Analyzed	Method Blank	BS	% Recovery	True Value QC	RPD	Qualifier
Benzene*	7.97	2.00	09/21/2017	ND	1.90	95.2	2.00	0.810	
Toluene*	76.2	2.00	09/21/2017	ND	1.77	88.6	2.00	1.97	
Ethylbenzene*	43.9	2.00	09/21/2017	ND	1.85	92.4	2.00	1.18	
Total Xylenes*	222	6.00	09/21/2017	ND	5.59	93.2	6.00	1.42	
Total BTEX	350	12.0	09/21/2017	ND					

Surrogate: 4-Bromofluorobenzene (PID) 112 % 72-148

Chloride, SM4500Cl-B		mg/kg		Analyzed By: AC					
Analyte	Result	Reporting Limit	Analyzed	Method Blank	BS	% Recovery	True Value QC	RPD	Qualifier
Chloride	112	16.0	09/18/2017	ND	432	108	400	0.00	

TPH 8015M		mg/kg		Analyzed By: MS						S-04
Analyte	Result	Reporting Limit	Analyzed	Method Blank	BS	% Recovery	True Value QC	RPD	Qualifier	
GRO C6-C10	3570	10.0	09/20/2017	ND	178	88.9	200	0.398		
DRO >C10-C28	6460	10.0	09/20/2017	ND	185	92.3	200	1.18		
EXT DRO >C28-C36	151	10.0	09/20/2017	ND						

Surrogate: 1-Chlorooctane 180 % 28.3-164

Surrogate: 1-Chlorooctadecane 131 % 34.7-157

Cardinal Laboratories

*=Accredited Analyte

PLEASE NOTE: Liability and Damages. Cardinal's liability and client's exclusive remedy for any claim arising, whether based in contract or tort, shall be limited to the amount paid by client for analyses. All claims, including those for negligence and any other cause whatsoever shall be deemed waived unless made in writing and received by Cardinal within thirty (30) days after completion of the applicable service. In no event shall Cardinal be liable for incidental or consequential damages, including, without limitation, business interruptions, loss of use, or loss of profits incurred by client, its subsidiaries, affiliates or successors arising out of or related to the performance of the services hereunder by Cardinal, regardless of whether such claim is based upon any of the above stated reasons or otherwise. Results relate only to the samples identified above. This report shall not be reproduced except in full with written approval of Cardinal Laboratories.



Celey D. Keene, Lab Director/Quality Manager

Analytical Results For:

DCP Midstream - Midland
HACK CONDER
10 Desta Dr., #400-W
Midland TX, 79705
Fax To: None

Received: 09/15/2017
Reported: 09/25/2017
Project Name: M EXTENSION LINE
Project Number: NONE GIVEN
Project Location: NOT GIVEN

Sampling Date: 09/15/2017
Sampling Type: Soil
Sampling Condition: ** (See Notes)
Sample Received By: Tamara Oldaker

Sample ID: PT 3 VERTICAL @ 18' (H702499-02)

Chloride, SM4500Cl-B		mg/kg		Analyzed By: AC					
Analyte	Result	Reporting Limit	Analyzed	Method Blank	BS	% Recovery	True Value QC	RPD	Qualifier
Chloride	112	16.0	09/18/2017	ND	432	108	400	0.00	
TPH 8015M		mg/kg		Analyzed By: MS					
Analyte	Result	Reporting Limit	Analyzed	Method Blank	BS	% Recovery	True Value QC	RPD	Qualifier
GRO C6-C10	<10.0	10.0	09/20/2017	ND	178	88.9	200	0.398	
DRO >C10-C28	<10.0	10.0	09/20/2017	ND	185	92.3	200	1.18	
EXT DRO >C28-C36	<10.0	10.0	09/20/2017	ND					
Surrogate: 1-Chlorooctane	101 %	28.3-164							
Surrogate: 1-Chlorooctadecane	101 %	34.7-157							

Sample ID: PT 3 VERTICAL @ 20' (H702499-03)

Chloride, SM4500Cl-B		mg/kg		Analyzed By: AC					
Analyte	Result	Reporting Limit	Analyzed	Method Blank	BS	% Recovery	True Value QC	RPD	Qualifier
Chloride	112	16.0	09/18/2017	ND	432	108	400	0.00	
TPH 8015M		mg/kg		Analyzed By: MS					
Analyte	Result	Reporting Limit	Analyzed	Method Blank	BS	% Recovery	True Value QC	RPD	Qualifier
GRO C6-C10	<10.0	10.0	09/20/2017	ND	178	88.9	200	0.398	
DRO >C10-C28	<10.0	10.0	09/20/2017	ND	185	92.3	200	1.18	
EXT DRO >C28-C36	<10.0	10.0	09/20/2017	ND					
Surrogate: 1-Chlorooctane	92.9 %	28.3-164							
Surrogate: 1-Chlorooctadecane	106 %	34.7-157							

Cardinal Laboratories

*=Accredited Analyte

PLEASE NOTE: Liability and Damages. Cardinal's liability and client's exclusive remedy for any claim arising, whether based in contract or tort, shall be limited to the amount paid by client for analyses. All claims, including those for negligence and any other cause whatsoever shall be deemed waived unless made in writing and received by Cardinal within thirty (30) days after completion of the applicable service. In no event shall Cardinal be liable for incidental or consequential damages, including, without limitation, business interruptions, loss of use, or loss of profits incurred by client, its subsidiaries, affiliates or successors arising out of or related to the performance of the services hereunder by Cardinal, regardless of whether such claim is based upon any of the above stated reasons or otherwise. Results relate only to the samples identified above. This report shall not be reproduced except in full with written approval of Cardinal Laboratories.



Celey D. Keene, Lab Director/Quality Manager

Analytical Results For:

DCP Midstream - Midland
HACK CONDER
10 Desta Dr., #400-W
Midland TX, 79705
Fax To: None

Received: 09/15/2017
Reported: 09/25/2017
Project Name: M EXTENSION LINE
Project Number: NONE GIVEN
Project Location: NOT GIVEN

Sampling Date: 09/15/2017
Sampling Type: Soil
Sampling Condition: ** (See Notes)
Sample Received By: Tamara Oldaker

Sample ID: SOUTH WALL (H702499-04)

BTEx 8021B		mg/kg		Analyzed By: MS					
Analyte	Result	Reporting Limit	Analyzed	Method Blank	BS	% Recovery	True Value QC	RPD	Qualifier
Benzene*	13.1	5.00	09/21/2017	ND	1.90	95.2	2.00	0.810	
Toluene*	134	5.00	09/21/2017	ND	1.77	88.6	2.00	1.97	
Ethylbenzene*	52.6	5.00	09/21/2017	ND	1.85	92.4	2.00	1.18	
Total Xylenes*	363	15.0	09/21/2017	ND	5.59	93.2	6.00	1.42	
Total BTEX	562	30.0	09/21/2017	ND					

Surrogate: 4-Bromofluorobenzene (PID) 108 % 72-148

Chloride, SM4500Cl-B		mg/kg		Analyzed By: AC						
Analyte	Result	Reporting Limit	Analyzed	Method Blank	BS	% Recovery	True Value QC	RPD	Qualifier	
Chloride	2440	16.0	09/18/2017	ND	432	108	400	0.00		

TPH 8015M		mg/kg		Analyzed By: MS				S-06	
Analyte	Result	Reporting Limit	Analyzed	Method Blank	BS	% Recovery	True Value QC	RPD	Qualifier
GRO C6-C10	5690	50.0	09/20/2017	ND	178	88.9	200	0.398	
DRO >C10-C28	13500	50.0	09/20/2017	ND	185	92.3	200	1.18	
EXT DRO >C28-C36	1000	50.0	09/20/2017	ND					

Surrogate: 1-Chlorooctane 206 % 28.3-164

Surrogate: 1-Chlorooctadecane 105 % 34.7-157

Cardinal Laboratories

*=Accredited Analyte

PLEASE NOTE: Liability and Damages. Cardinal's liability and client's exclusive remedy for any claim arising, whether based in contract or tort, shall be limited to the amount paid by client for analyses. All claims, including those for negligence and any other cause whatsoever shall be deemed waived unless made in writing and received by Cardinal within thirty (30) days after completion of the applicable service. In no event shall Cardinal be liable for incidental or consequential damages, including, without limitation, business interruptions, loss of use, or loss of profits incurred by client, its subsidiaries, affiliates or successors arising out of or related to the performance of the services hereunder by Cardinal, regardless of whether such claim is based upon any of the above stated reasons or otherwise. Results relate only to the samples identified above. This report shall not be reproduced except in full with written approval of Cardinal Laboratories.



Celey D. Keene, Lab Director/Quality Manager

Analytical Results For:

DCP Midstream - Midland
HACK CONDER
10 Desta Dr., #400-W
Midland TX, 79705
Fax To: None

Received: 09/15/2017
Reported: 09/25/2017
Project Name: M EXTENSION LINE
Project Number: NONE GIVEN
Project Location: NOT GIVEN

Sampling Date: 09/15/2017
Sampling Type: Soil
Sampling Condition: ** (See Notes)
Sample Received By: Tamara Oldaker

Sample ID: NORTH WALL (H702499-05)

BTX 8021B		mg/kg		Analyzed By: MS					
Analyte	Result	Reporting Limit	Analyzed	Method Blank	BS	% Recovery	True Value QC	RPD	Qualifier
Benzene*	<0.050	0.050	09/21/2017	ND	1.90	95.2	2.00	0.810	
Toluene*	0.185	0.050	09/21/2017	ND	1.77	88.6	2.00	1.97	
Ethylbenzene*	0.527	0.050	09/21/2017	ND	1.85	92.4	2.00	1.18	
Total Xylenes*	2.97	0.150	09/21/2017	ND	5.59	93.2	6.00	1.42	
Total BTX	3.69	0.300	09/21/2017	ND					

Surrogate: 4-Bromofluorobenzene (PID) 132 % 72-148

Chloride, SM4500CI-B		mg/kg		Analyzed By: AC						
Analyte	Result	Reporting Limit	Analyzed	Method Blank	BS	% Recovery	True Value QC	RPD	Qualifier	
Chloride	32.0	16.0	09/18/2017	ND	432	108	400	0.00		

TPH 8015M		mg/kg		Analyzed By: MS					
Analyte	Result	Reporting Limit	Analyzed	Method Blank	BS	% Recovery	True Value QC	RPD	Qualifier
GRO C6-C10	98.3	10.0	09/20/2017	ND	178	89.2	200	0.0320	
DRO >C10-C28	2900	10.0	09/20/2017	ND	186	92.8	200	1.62	
EXT DRO >C28-C36	134	10.0	09/20/2017	ND					

Surrogate: 1-Chlorooctane 121 % 28.3-164

Surrogate: 1-Chlorooctadecane 130 % 34.7-157

Cardinal Laboratories

*=Accredited Analyte

PLEASE NOTE: Liability and Damages. Cardinal's liability and client's exclusive remedy for any claim arising, whether based in contract or tort, shall be limited to the amount paid by client for analyses. All claims, including those for negligence and any other cause whatsoever shall be deemed waived unless made in writing and received by Cardinal within thirty (30) days after completion of the applicable service. In no event shall Cardinal be liable for incidental or consequential damages, including, without limitation, business interruptions, loss of use, or loss of profits incurred by client, its subsidiaries, affiliates or successors arising out of or related to the performance of the services hereunder by Cardinal, regardless of whether such claim is based upon any of the above stated reasons or otherwise. Results relate only to the samples identified above. This report shall not be reproduced except in full with written approval of Cardinal Laboratories.



Celey D. Keene, Lab Director/Quality Manager

Analytical Results For:

DCP Midstream - Midland
HACK CONDER
10 Desta Dr., #400-W
Midland TX, 79705
Fax To: None

Received: 09/15/2017
Reported: 09/25/2017
Project Name: M EXTENSION LINE
Project Number: NONE GIVEN
Project Location: NOT GIVEN

Sampling Date: 09/15/2017
Sampling Type: Soil
Sampling Condition: ** (See Notes)
Sample Received By: Tamara Oldaker

Sample ID: NORTH BOTTOM @ 9' (H702499-06)

BTEx 8021B		mg/kg		Analyzed By: MS					
Analyte	Result	Reporting Limit	Analyzed	Method Blank	BS	% Recovery	True Value QC	RPD	Qualifier
Benzene*	1.13	1.00	09/21/2017	ND	1.90	95.2	2.00	0.810	
Toluene*	15.7	1.00	09/21/2017	ND	1.77	88.6	2.00	1.97	
Ethylbenzene*	14.3	1.00	09/21/2017	ND	1.85	92.4	2.00	1.18	
Total Xylenes*	88.3	3.00	09/21/2017	ND	5.59	93.2	6.00	1.42	
Total BTEX	119	6.00	09/21/2017	ND					

Surrogate: 4-Bromofluorobenzene (PID) 115 % 72-148

Chloride, SM4500Cl-B		mg/kg		Analyzed By: AC					
Analyte	Result	Reporting Limit	Analyzed	Method Blank	BS	% Recovery	True Value QC	RPD	Qualifier
Chloride	192	16.0	09/18/2017	ND	432	108	400	0.00	

TPH 8015M		mg/kg		Analyzed By: MS					
Analyte	Result	Reporting Limit	Analyzed	Method Blank	BS	% Recovery	True Value QC	RPD	Qualifier
GRO C6-C10	1770	10.0	09/20/2017	ND	178	89.2	200	0.0320	
DRO >C10-C28	7440	10.0	09/20/2017	ND	186	92.8	200	1.62	
EXT DRO >C28-C36	133	10.0	09/20/2017	ND					

Surrogate: 1-Chlorooctane 148 % 28.3-164

Surrogate: 1-Chlorooctadecane 131 % 34.7-157

Cardinal Laboratories

*=Accredited Analyte

PLEASE NOTE: Liability and Damages. Cardinal's liability and client's exclusive remedy for any claim arising, whether based in contract or tort, shall be limited to the amount paid by client for analyses. All claims, including those for negligence and any other cause whatsoever shall be deemed waived unless made in writing and received by Cardinal within thirty (30) days after completion of the applicable service. In no event shall Cardinal be liable for incidental or consequential damages, including, without limitation, business interruptions, loss of use, or loss of profits incurred by client, its subsidiaries, affiliates or successors arising out of or related to the performance of the services hereunder by Cardinal, regardless of whether such claim is based upon any of the above stated reasons or otherwise. Results relate only to the samples identified above. This report shall not be reproduced except in full with written approval of Cardinal Laboratories.



Celey D. Keene, Lab Director/Quality Manager

Notes and Definitions

S-06	The recovery of this surrogate is outside control limits due to sample dilution required from high analyte concentration and/or matrix interference's.
S-04	The surrogate recovery for this sample is outside of established control limits due to a sample matrix effect.
ND	Analyte NOT DETECTED at or above the reporting limit
RPD	Relative Percent Difference
**	Samples not received at proper temperature of 6°C or below.
***	Insufficient time to reach temperature.
-	Chloride by SM4500Cl-B does not require samples be received at or below 6°C Samples reported on an as received basis (wet) unless otherwise noted on report



Celey D. Keene, Lab Director/Quality Manager



CARDINAL LABORATORIES

101 East Marland, Hobbs, NM 88240 2111 Beechwood, Abilene, TX 79603
(505) 393-2326 FAX (505) 393-2476 (325) 673-7001 FAX (325) 673-7020

CHAIN-OF-CUSTODY AND ANALYSIS REQUEST

Company Name: DCP Midstream		P.O. #:		BILL TO		ANALYSIS REQUEST	
Project Manager: Hack Conder		Company:					
Address:		Attn:					
City:		Address:					
Phone #:		City:					
Project #:		State:					
Project Name:		Zip:					
Project Location: M Extension Line		Phone #:					
Sampler Name: Kyle Norman		Fax #:					
FOR LAB USE ONLY		PRESERV		SAMPLING			
Lab I.D.		DATE		TIME			
Sample I.D.							
H7024199		9/15/17		0900			
1 P3 Vertical @ 17'				0930			
2 ↓ 18'				0950			
3 ↓ 20'				1010			
4 South Wall				1030			
5 North Wall				1100			
6 North Bottom @ 9'							
(G)RAB OR (C)OMP.							
# CONTAINERS							
GROUNDWATER							
WASTEWATER							
SOIL							
OIL							
SLUDGE							
OTHER :							
ACID/BASE:							
ICE / COOL							
OTHER :							
Chlorides							
TPH 8015 M EXT							
BTEX							
Texas TPH							
Complete Cations/Anions							
TDS							

PLEASE NOTE: Liability and Damages. Cardinal's liability and client's exclusive remedy for any claim arising whether based in contract or tort shall be limited to the amount paid by the client for the analyses. All claims, including those for negligence and any other cause whatsoever shall be deemed waived unless made in writing and received by Cardinal within 30 days after completion of the applicable service. In no event shall Cardinal be liable for incidental or consequential damages, including without limitation, business interruptions, loss of use, or loss of profits incurred by client, its subsidiaries, affiliates or successors arising out of or related to the performance of services rendered by Cardinal, regardless of whether such claim is based upon any of the above stated reasons or otherwise.

Relinquished By:	Date: 9/15/17	Received By: Kelly Carbow	Phone Result: <input type="checkbox"/> Yes <input checked="" type="checkbox"/> No	Add'l Phone #:
Relinquished By:	Time: 3:03		Fax Result: <input type="checkbox"/> Yes <input checked="" type="checkbox"/> No	Add'l Fax #:
Time:			REMARKS:	
email results: hpconder@dcpmidstream.com				
yblair@dcpmidstream.com				
knorman@tiasman-geo.com:				

Delivered By: (Circle One) 8.0°C / 8.25°C

Sampler - UPS - Bus - Other: ☐ Yes ☒ No

CHECKED BY: (Initials) HC

† Cardinal cannot accept verbal changes. Please fax written changes to 505-393-2476

Corrected + 0.25°C

Appendix C

DCP Midstream Linam Gathering M Extension Line

1RP-4605



Initial release

1/24/17



Initial release

1/24/17



Scraping soil

1/24/17



Scraping soil

1/24/17



Soil excavated

2/7/17



Vertical at Pt. 3

9/15/17



Excavating vertical at Pt. 3

9/15/17

Appendix D



New Mexico Office of the State Engineer

Water Column/Average Depth to Water

(A CLW##### in the POD suffix indicates the POD has been replaced & no longer serves a water right file.)

(R=POD has been replaced,
O=orphaned,
C=the file is closed)

(quarters are 1=NW 2=NE 3=SW 4=SE)

(quarters are smallest to largest)

(NAD83 UTM in meters)

(In feet)

POD Number	POD Sub-Code	basin	County	Q 64	Q 16	Q 4	Sec	Tws	Rng	X	Y	Distance	Depth Well	Depth Water	Water Column
CP 00849 POD1	CP	LE		3	1	3	35	18S	31E	608012	3618757*	1987	300		
CP 00829 POD1	CP	LE			2	4	16	19S	31E	606165	3614009*	4187	120		
CP 01554 POD1	CP	LE		2	2	1	22	19S	31E	607166	3613354	4955	400		
CP 01554 POD2	CP	LE		2	2	1	22	19S	31E	607165	3613322	4987	400		
CP 00873 POD1	CP	LE			1	1	19	19S	31E	601772	3613147*	6653	340	180	160
CP 00767 POD1	CP	ED			3	2	35	18S	30E	599300	3619158*	6872	500		

Average Depth to Water: **180 feet**

Minimum Depth: **180 feet**

Maximum Depth: **180 feet**

Record Count: 6

UTMNAD83 Radius Search (in meters):

Easting (X): 606105.11

Northing (Y): 3618195.63

Radius: 7000

*UTM location was derived from PLSS - see Help

The data is furnished by the NMOSE/ISC and is accepted by the recipient with the expressed understanding that the OSE/ISC make no warranties, expressed or implied, concerning the accuracy, completeness, reliability, usability, or suitability for any particular purpose of the data.