

APPROVED

By Olivia Yu at 4:25 pm, Apr 19, 2018

NMOCD approves of the delineation completed and remedial activities. Backfill approval is granted for 1RP-4605.

Figures

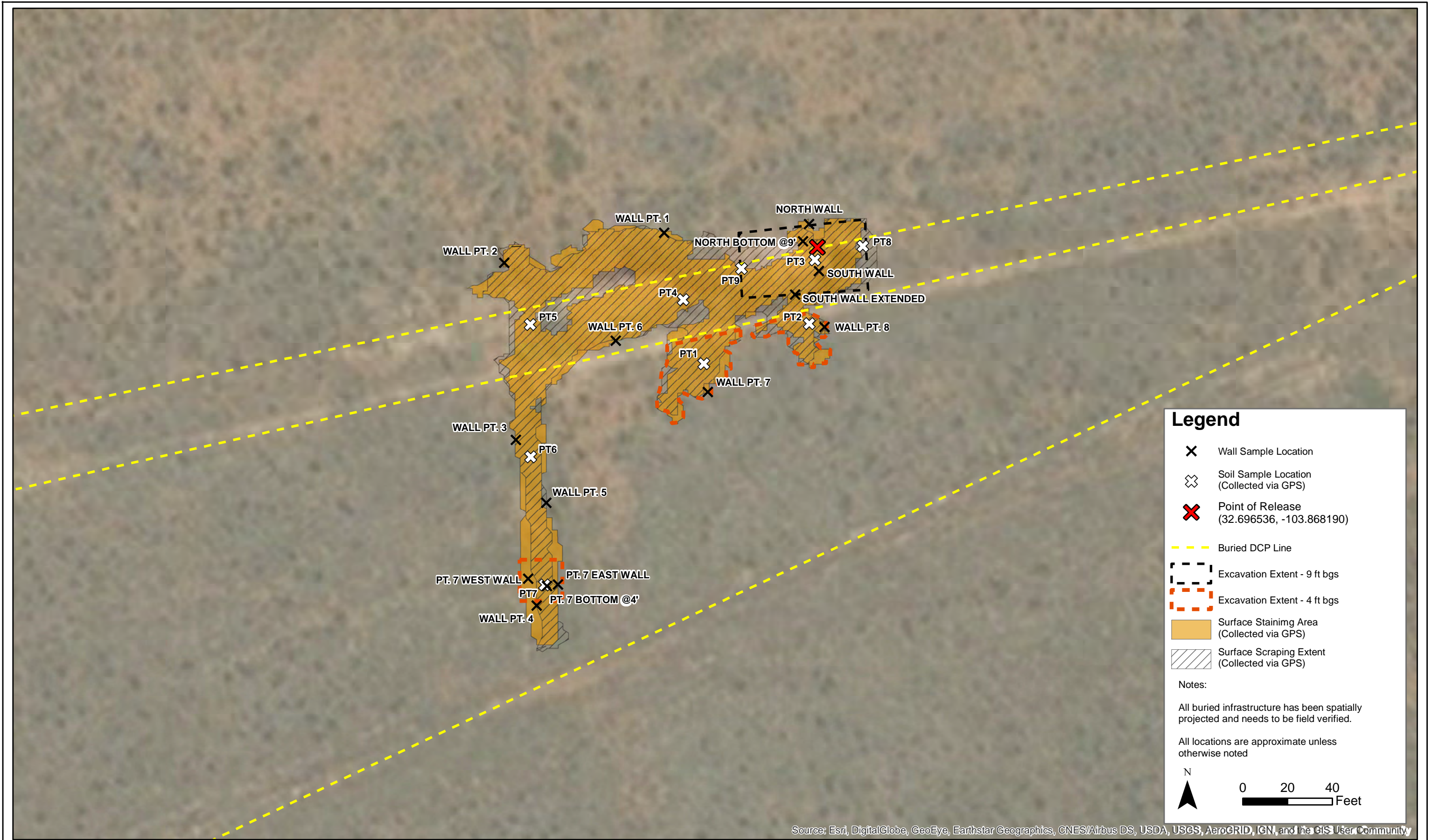

DATE:	November 2017
DESIGNED BY:	K. Norman
DRAWN BY:	D. Cavinder



TASMAN
GEOSCIENCES

Tasman Geosciences Inc.
6899 Pecos Street - Unit C
Denver, CO 80221

DCP Midstream
M Extension Line Leak (1RP-4605)
NENE Section 4, Township 19 South, Range 31 East
Eddy County, New Mexico

Excavation Overview
Figure

Figure
1

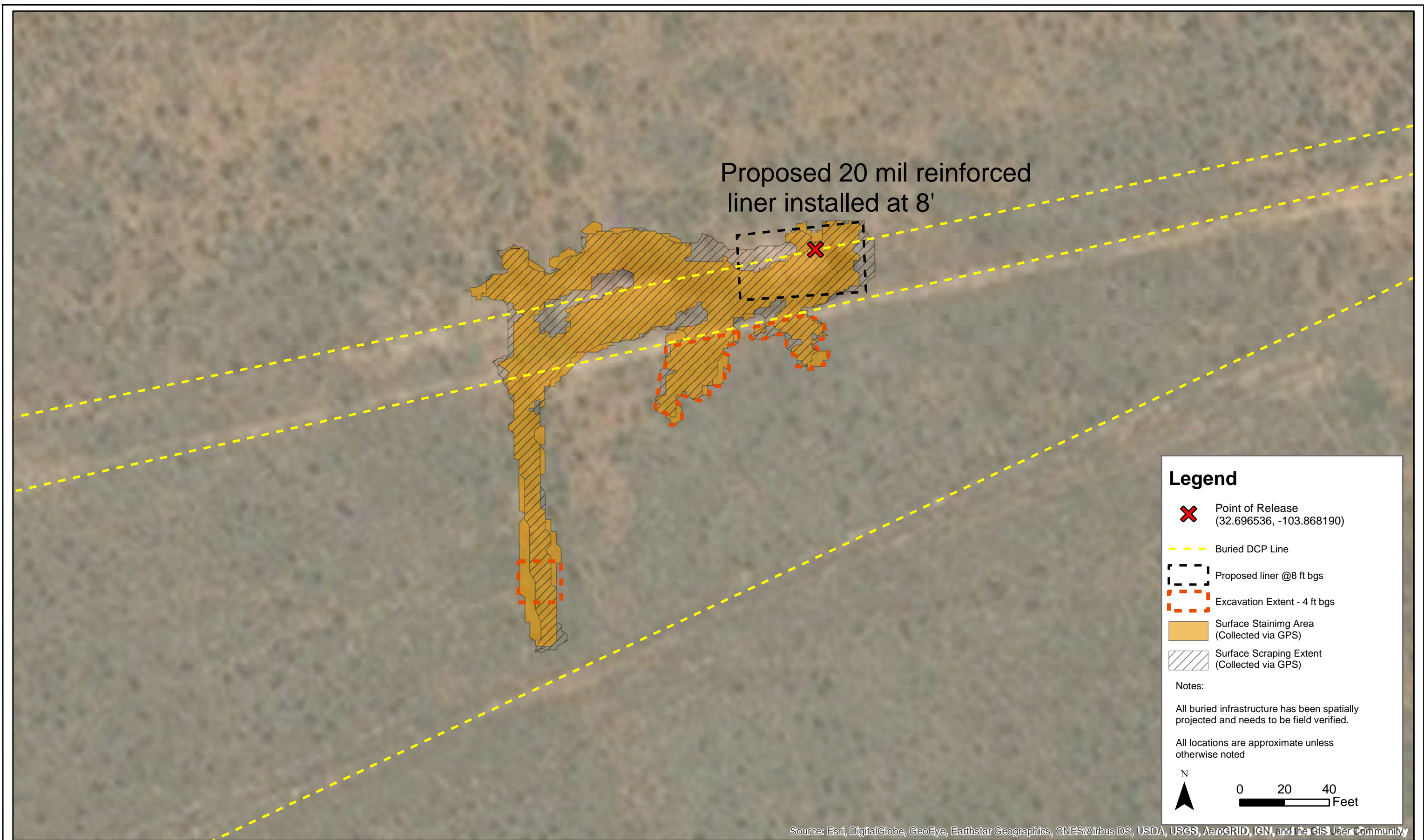

DATE:
November 2017

DESIGNED BY:
K. Norman

DRAWN BY:
D. Cavinder



DCP Midstream
M Extension Line Leak (1RP-4605)
NENE Section 4, Township 19 South, Range 31 East
Eddy County, New Mexico

Proposed 20 mil
reinforced liner
Figure

Figure
2

Tables

TABLE 1
DCP MIDSTREAM
Linam Gathering M Ext Line 1RP-4605
4' and 1' EXCAVATION SOIL SAMPLE ANALYTICAL RESULTS SUMMARY TABLE

Sample ID	Date Sampled	PID Readings (ppm)	Field Chloride (mg/kg)	Benzene (mg/kg)	Toluene (mg/kg)	Ethylbenzene (mg/kg)	Total Xylenes (mg/kg)	Total BTEX (mg/kg)	TPH - GRO (mg/kg)	TPH - DRO (mg/kg)	TPH ⁽³⁾ GRO/DRO (mg/kg)	Lab Chloride (mg/kg)
EXCAVATION @ 4'												
PT 1 @ 1'	2/7/2017	3,291.0	86.0	NA	NA	NA	NA	NA	NA	NA	NA	NA
PT 1 @ 2'	2/7/2017	836.1	99.0	NA	NA	NA	NA	NA	NA	NA	NA	NA
PT 1 @ 3'	2/7/2017	NA	NA	<0.050	<0.050	<0.050	<0.150	<0.300	<10.0	194	194	32
PT 1 @ 4'	2/7/2017	NA	NA	<0.050	<0.050	<0.050	<0.150	<0.300	<10.0	89.4	89.4	48
EXCAVATION @ 4'												
PT 2 @ 1'	2/7/2017	4306	74	NA	NA	NA	NA	NA	NA	NA	NA	NA
PT 2 @ 2'	2/7/2017	220.5	85	NA	NA	NA	NA	NA	NA	NA	NA	NA
PT 2 @ 3'	2/7/2017	NA	NA	<0.050	<0.050	<0.050	<0.150	<0.300	<10.0	251	251	16
PT 2 @ 4'	2/7/2017	NA	NA	<0.050	0.06	0.08	0.304	0.445	<10.0	180	180	16
EXCAVATION @ 1'												
PT 4 @ 1'	2/7/2017	NA	NA	0.206	0.312	<0.050	<0.150	0.518	<10.0	52	52	16
PT 5 @ 1'	2/7/2017	NA	NA	<0.050	<0.050	<0.050	<0.150	<0.300	<10.0	<10.0	<10.0	64
PT 6 @ 1'	2/7/2017	NA	NA	<0.050	<0.050	<0.050	<0.150	<0.300	<10.0	<10.0	<10.0	48
NMOCD Action Levels - Soil (mg/kg) ⁽¹⁾				10	NA	NA	NA	50	NA	NA	5,000	250

Notes:

1). Standards for Soil are taken from NMOCD Guidelines for Remediation of Leaks, Spills and Releases, 1993, total ranking >19

2). TPH - Total volatile and extractable petroleum hydrocarbons. Value calculated by adding GRO and DRO concentrations.

Bold indicates concentration exceeds NMOCD Action Levels.

GRO - Gasoline range organics.

mg/kg= Milligrams per kilogram.

ppm - Parts per million

TABLE 2
DCP MIDSTREAM
Linam Gathering M Ext Line 1RP-4605
PT.7 EXCAVATION AND 9' EXCAVATION SOIL SAMPLE ANALYTICAL RESULTS SUMMARY TABLE

Sample ID	Date Sampled	PID Readings (ppm)	Field Chloride (mg/kg)	Benzene (mg/kg)	Toluene (mg/kg)	Ethylbenzene (mg/kg)	Total Xylenes (mg/kg)	Total BTEX (mg/kg)	TPH - GRO (mg/kg)	TPH - DRO (mg/kg)	TPH - EXT DRO (mg/kg)	TPH ⁽³⁾ GRO/DRO/EXT DRO (mg/kg)	Chloride (mg/kg)
EXCAVATION @ 4'													
PT 7 @ 2'	2/7/2017	NA	NA	2.7	28.6	22.2	68.5	122	946	4,050	NA	4996	96
PT 7 BOTTOM @ 4'	10/27/2017	NA	25	<0.050	<0.050	0.085	0.43	0.515	<10.0	436	63.8	499.8	NA
PT 7 WEST WALL	10/27/2017	NA	2.8	NA	NA	NA	NA	NA	<10.0	12.9	<10.0	12.9	NA
PT 7 EAST WALL	10/27/2017	NA	4	NA	NA	NA	NA	NA	<10.0	<10.0	<10.0	<10.0	NA
EXCAVATION @ 9'													
SOUTH WALL	9/15/2017	876	NA	13.1	134	52.6	363	562	5690	13500	1000	20190	2,440
SOUTH WALL EXT	10/27/2017	115	NA	<0.050	0.133	0.384	2.27	2.79	112	2030	71	2213	176
NORTH WALL	9/15/2017	261	NA	<0.050	0.185	0.527	2.97	3.69	98.3	2900	134	3132.3	32
WALL PT 8 @ 2'	2/7/2017	NA	NA	<0.050	0.092	<0.050	<0.150	<0.300	<10.0	13.8	NA	13.8	16
WALL PT 9 @ 2'	2/7/2017	NA	NA	<0.050	<0.050	<0.050	<0.150	<0.300	<10.0	33.9	NA	33.9	<16.0
NORTH BOTTOM @ 9'	9/15/2017	177	NA	1.13	15.7	14.3	88.3	119	1770	7440	133	9343	192
N BOTTOM Vertical @12'	4/5/2018	4444	197	NA	NA	NA	NA	NA	NA	NA	NA	NA	NA
N BOTTOM Vertical @15'	4/5/2018	2090	200	NA	NA	NA	NA	NA	NA	NA	NA	NA	NA
N BOTTOM Vertical @18'	4/5/2018	60.8	185	<0.050	0.092	<0.050	<0.150	<0.300	<10.0	18.4	<10.0	18.4	NA
N BOTTOM Vertical @20'	4/5/2018	3.2	175	<0.050	0.092	<0.050	<0.150	<0.300	<10.0	<10.0	<10.0	<10.0	160
NMOCD Action Levels - Soil (mg/kg) ⁽¹⁾				10	NA	NA	NA	50	NA	NA	NA	5,000	250

Notes:

1). Standards for Soil are taken from NMOCD Guidelines for Remediation of Leaks, Spills and Releases, 1993, total ranking >19

2). TPH - Total volatile and extractable petroleum hydrocarbons. Value calculated by adding GRO and DRO concentrations.

Bold indicates concentration exceeds NMOCD Action Levels.

GRO - Gasoline range organics.

mg/kg= Milligrams per kilogram.

ppm - Parts per million

TABLE 3
DCP MIDSTREAM
N-1 Ext pipeline (1RP-4982) Leak 3
EXCAVATION Pt.3 VERTICAL SOIL SAMPLE ANALYTICAL RESULTS SUMMARY TABLE

Sample ID	Date Sampled	PID Readings (ppm)	Field Chloride (mg/kg)	Benzene (mg/kg)	Toluene (mg/kg)	Ethylbenzene (mg/kg)	Total Xylenes (mg/kg)	Total BTEX (mg/kg)	TPH - GRO (mg/kg)	TPH - DRO (mg/kg)	TPH - EXT DRO (mg/kg)	TPH ⁽³⁾ GRO/DRO/EXT DRO (mg/kg)	Chloride (mg/kg)
EXCAVATION @ 9'													
PT 3 @ 4'	2/7/2017	1071	7509	NA	NA	NA	NA	NA	NA	NA	NA	NA	NA
PT 3 @ 5'	2/7/2017	1418	3835	NA	NA	NA	NA	NA	NA	NA	NA	NA	NA
PT 3 @ 6'	2/7/2017	761	5725	NA	NA	NA	NA	NA	NA	NA	NA	NA	NA
PT 3 @ 7'	2/7/2017	1790	5637	NA	NA	NA	NA	NA	NA	NA	NA	NA	NA
PT 3 @ 8'	2/7/2017	NA	NA	32.2	163	78.9	359	634	8730	<10.0	21700	30430	2,280
PT 3 @ 9'	2/7/2017	NA	NA	120	471	1645	686	1440	12600	422	24900	37500	48
PT 3 VERTICAL @10'	9/15/2017	1880	751	NA	NA	NA	NA	NA	NA	NA	NA	NA	NA
PT 3 VERTICAL @11'	9/15/2017	5000	260	NA	NA	NA	NA	NA	NA	NA	NA	NA	NA
PT 3 VERTICAL @12'	9/15/2017	5000	144	NA	NA	NA	NA	NA	NA	NA	NA	NA	NA
PT 3 VERTICAL @17'	9/15/2017	5000	NA	7.97	76.2	43.9	222	350	3570	6460	151	10181	112
PT 3 VERTICAL @18'	9/15/2017	6.6	NA	NA	NA	NA	NA	NA	<10.0	<10.0	<10.0	<10.0	112
PT 3 VERTICAL @18'	4/5/2018	4.2	NA	<0.050	<0.050	<0.050	<0.150	<0.300	NA	NA	NA	NA	NA
PT 3 VERTICAL @20'	9/15/2017	7.8	NA	NA	NA	NA	NA	NA	<10.0	<10.0	<10.0	<10.0	112
PT 3 VERTICAL @20'	4/5/2018	3.9	NA	<0.050	<0.050	<0.050	<0.150	<0.300	NA	NA	NA	NA	NA
NMOCD Action Levels - Soil (mg/kg)⁽¹⁾				10	NA	NA	NA	50	NA	NA	NA	5,000	250

Notes:

1). Standards for Soil are taken from NMOCD Guidelines for Remediation of Leaks, Spills and Releases, 1993, total ranking >19

2). TPH - Total volatile and extractable petroleum hydrocarbons. Value calculated by adding GRO and DRO concentrations.

Bold indicates concentration exceeds NMOCD Action Levels.

GRO - Gasoline range organics.

mg/kg= Milligrams per kilogram.

ppm - Parts per million

TABLE 4
DCP MIDSTREAM
Linam Gathering M Ext Line 1RP-4605
WALL SOIL SAMPLE ANALYTICAL RESULTS SUMMARY TABLE

Sample ID Wall Samples	Date Sampled	PID Readings (ppm)	TPH - GRO (mg/kg)	TPH - DRO (mg/kg)	TPH - EXT DRO (mg/kg)	TPH ⁽³⁾ GRO/DRO/EXT DRO (mg/kg)	Lab Chloride (mg/kg)
WALL PT. 1	9/15/2017	0.5	<10.0	<10.0	<10.0	<10.0	16
WALL PT. 2	9/15/2017	0.8	<10.0	<10.0	<10.0	<10.0	32
WALL PT. 3	9/15/2017	0.9	<10.0	<10.0	<10.0	<10.0	176
WALL PT. 4	9/15/2017	1.8	<10.0	<10.0	<10.0	<10.0	240
WALL PT. 5	9/15/2017	0.7	<10.0	<10.0	<10.0	<10.0	32
WALL PT. 6	9/15/2017	1.5	<10.0	19.7	<10.0	19.7	<16.0
WALL PT. 7	9/15/2017	0.4	<10.0	12.5	<10.0	12.5	16
WALL PT. 8	9/15/2017	0.7	<10.0	<10.0	<10.0	<10.0	32
NMOCD Action Levels - Soil (mg/kg) ⁽¹⁾			NA	NA	NA	5,000	250

Notes:

1). Standards for Soil are taken from NMOCD Guidelines for Remediation of Leaks, Spills and Releases, 1993, total ranking >19

2). TPH - Total volatile and extractable petroleum

Bold indicates concentration exceeds NMOCD Action Levels.

GRO - Gasoline range organics.

mg/kg= Milligrams per kilogram.

ppm - Parts per million

Appendix A

District I
1625 N. French Dr., Hobbs, NM 88240
District II
811 S. First St., Artesia, NM 88210
District III
1000 Rio Brazos Road, Aztec, NM 87410
District IV
1220 S. St. Francis Dr., Santa Fe, NM 87505

State of New Mexico
Energy Minerals and Natural Resources

Oil Conservation Division
1220 South St. Francis Dr.
Santa Fe, NM 87505

Form C-141
Revised August 8, 2011

Submit 1 Copy to appropriate District Office in
accordance with 19.15.29 NMAC.

Release Notification and Corrective Action

OPERATOR

☒ Initial Report ☐ Final Report

Name of Company DCP	Contact Haskell Conder	
Address 10 Desta Drive, Suite 400 West	Telephone No. cell 432-557-1127	
Facility Name Linam Gathering	Facility Type Natural Gas Gathering Pipeline	
Surface Owner BLM	Mineral Owner	API No.

LOCATION OF RELEASE

Unit Letter	Section 4	Township 19S	Range 31E	Feet from the	North/South Line	Feet from the	East/West Line	County Lea
-------------	--------------	-----------------	--------------	---------------	------------------	---------------	----------------	---------------

Latitude 32.69655 Longitude -103.86820

NATURE OF RELEASE

Type of Release: condensate	Volume of Release 8 bbl	Volume Recovered 0
Source of Release M Ext Line	Date and Hour of Occurrence	Date and Hour of Discovery 01-23-17
Was Immediate Notice Given? <input checked="" type="checkbox"/> Yes <input type="checkbox"/> No <input type="checkbox"/> Not Required	If YES, To Whom? NMOCD	
By Whom? Haskell Conder	Date and Hour 01-23-17 15:30	
Was a Watercourse Reached? <input type="checkbox"/> Yes <input checked="" type="checkbox"/> No	If YES, Volume Impacting the Watercourse.	
If a Watercourse was Impacted, Describe Fully.* N / A		
Describe Cause of Problem and Remedial Action Taken.* DCP operator discovered leak while completing daily rounds.		
Describe Area Affected and Cleanup Action Taken.* A cleanup plan will be submitted for BLM and OCD Approval		
I hereby certify that the information given above is true and complete to the best of my knowledge and understand that pursuant to NMOCD rules and regulations all operators are required to report and/or file certain release notifications and perform corrective actions for releases which may endanger public health or the environment. The acceptance of a C-141 report by the NMOCD marked as "Final Report" does not relieve the operator of liability should their operations have failed to adequately investigate and remediate contamination that pose a threat to ground water, surface water, human health or the environment. In addition, NMOCD acceptance of a C-141 report does not relieve the operator of responsibility for compliance with any other federal, state, or local laws and/or regulations.		
Signature: <i>Haskell Conder</i>	OIL CONSERVATION DIVISION	
Printed Name: Haskell Conder	Approved by Environmental Specialist: 	
Title: Compliance Coordinator	Approval Date: 2/15/2017	Expiration Date:
E-mail Address: hconder@dcpmidstream.com	Conditions of Approval: see attached directive	Attached <input checked="" type="checkbox"/>
Date: 02-01-17	Phone: 432-557-1127	

* Attach Additional Sheets If Necessary

1RP-4605

fOY1704639477

pOY1704640472

nOY1704640119

Appendix B

February 08, 2017

HACK CONDER

DCP Midstream - Midland

10 Desta Dr., #400-W

Midland, TX 79705

RE: M EXTENSION LINE

Enclosed are the results of analyses for samples received by the laboratory on 02/07/17 16:41.

Cardinal Laboratories is accredited through Texas NELAP under certificate number T104704398-16-8. Accreditation applies to drinking water, non-potable water and solid and chemical materials. All accredited analytes are denoted by an asterisk (*). For a complete list of accredited analytes and matrices visit the TCEQ website at www.tceq.texas.gov/field/qa/lab_accred_certif.html.

Cardinal Laboratories is accredited through the State of Colorado Department of Public Health and Environment for:

Method EPA 552.2	Haloacetic Acids (HAA-5)
Method EPA 524.2	Total Trihalomethanes (TTHM)
Method EPA 524.4	Regulated VOCs (V1, V2, V3)

Accreditation applies to public drinking water matrices.

This report meets NELAP requirements and is made up of a cover page, analytical results, and a copy of the original chain-of-custody. If you have any questions concerning this report, please feel free to contact me.

Sincerely,



Celey D. Keene

Lab Director/Quality Manager

Analytical Results For:

DCP Midstream - Midland
HACK CONDER
10 Desta Dr., #400-W
Midland TX, 79705
Fax To: None

Received: 02/07/2017
Reported: 02/08/2017
Project Name: M EXTENSION LINE
Project Number: NONE GIVEN
Project Location: NOT GIVEN

Sampling Date: 02/07/2017
Sampling Type: Soil
Sampling Condition: Cool & Intact
Sample Received By: Celey D. Keene

Sample ID: PT 1 @3' (H700315-01)

BTEX 8021B		mg/kg		Analyzed By: MS					
Analyte	Result	Reporting Limit	Analyzed	Method Blank	BS	% Recovery	True Value QC	RPD	Qualifier
Benzene*	<0.050	0.050	02/08/2017	ND	2.23	112	2.00	0.753	
Toluene*	<0.050	0.050	02/08/2017	ND	2.18	109	2.00	0.516	
Ethylbenzene*	<0.050	0.050	02/08/2017	ND	2.17	108	2.00	0.0492	
Total Xylenes*	<0.150	0.150	02/08/2017	ND	6.16	103	6.00	0.258	
Total BTEX	<0.300	0.300	02/08/2017	ND					

Surrogate: 4-Bromofluorobenzene (PID) 106 % 73.6-140

Chloride, SM4500Cl-B		mg/kg		Analyzed By: HM					
Analyte	Result	Reporting Limit	Analyzed	Method Blank	BS	% Recovery	True Value QC	RPD	Qualifier
Chloride	32.0	16.0	02/08/2017	ND	448	112	400	3.64	

TPH 8015M		mg/kg		Analyzed By: MS					
Analyte	Result	Reporting Limit	Analyzed	Method Blank	BS	% Recovery	True Value QC	RPD	Qualifier
GRO C6-C10	<10.0	10.0	02/08/2017	ND	184	91.9	200	0.449	
DRO >C10-C28	194	10.0	02/08/2017	ND	193	96.3	200	4.05	

Surrogate: 1-Chlorooctadecane 96.1 % 28-171

Cardinal Laboratories

*=Accredited Analyte

PLEASE NOTE: Liability and Damages. Cardinal's liability and client's exclusive remedy for any claim arising, whether based in contract or tort, shall be limited to the amount paid by client for analyses. All claims, including those for negligence and any other cause whatsoever shall be deemed waived unless made in writing and received by Cardinal within thirty (30) days after completion of the applicable service. In no event shall Cardinal be liable for incidental or consequential damages, including, without limitation, business interruptions, loss of use, or loss of profits incurred by client, its subsidiaries, affiliates or successors arising out of or related to the performance of the services hereunder by Cardinal, regardless of whether such claim is based upon any of the above stated reasons or otherwise. Results relate only to the samples identified above. This report shall not be reproduced except in full with written approval of Cardinal Laboratories.



Celey D. Keene, Lab Director/Quality Manager

Analytical Results For:

DCP Midstream - Midland
HACK CONDER
10 Desta Dr., #400-W
Midland TX, 79705
Fax To: None

Received: 02/07/2017
Reported: 02/08/2017
Project Name: M EXTENSION LINE
Project Number: NONE GIVEN
Project Location: NOT GIVEN

Sampling Date: 02/07/2017
Sampling Type: Soil
Sampling Condition: Cool & Intact
Sample Received By: Celey D. Keene

Sample ID: PT 2 @3' (H700315-02)

BTEx 8021B		mg/kg		Analyzed By: MS					
Analyte	Result	Reporting Limit	Analyzed	Method Blank	BS	% Recovery	True Value QC	RPD	Qualifier
Benzene*	<0.050	0.050	02/08/2017	ND	2.23	112	2.00	0.753	
Toluene*	<0.050	0.050	02/08/2017	ND	2.18	109	2.00	0.516	
Ethylbenzene*	<0.050	0.050	02/08/2017	ND	2.17	108	2.00	0.0492	
Total Xylenes*	<0.150	0.150	02/08/2017	ND	6.16	103	6.00	0.258	
Total BTEx	<0.300	0.300	02/08/2017	ND					

Surrogate: 4-Bromofluorobenzene (PID) 106 % 73.6-140

Chloride, SM4500CI-B		mg/kg		Analyzed By: HM					
Analyte	Result	Reporting Limit	Analyzed	Method Blank	BS	% Recovery	True Value QC	RPD	Qualifier
Chloride	16.0	16.0	02/08/2017	ND	448	112	400	3.64	

TPH 8015M		mg/kg		Analyzed By: MS					
Analyte	Result	Reporting Limit	Analyzed	Method Blank	BS	% Recovery	True Value QC	RPD	Qualifier
GRO C6-C10	<10.0	10.0	02/08/2017	ND	184	91.9	200	0.449	
DRO >C10-C28	251	10.0	02/08/2017	ND	193	96.3	200	4.05	

Surrogate: 1-Chlorooctane 75.5 % 35-147

Surrogate: 1-Chlorooctadecane 89.7 % 28-171

Cardinal Laboratories

*=Accredited Analyte

PLEASE NOTE: Liability and Damages. Cardinal's liability and client's exclusive remedy for any claim arising, whether based in contract or tort, shall be limited to the amount paid by client for analyses. All claims, including those for negligence and any other cause whatsoever shall be deemed waived unless made in writing and received by Cardinal within thirty (30) days after completion of the applicable service. In no event shall Cardinal be liable for incidental or consequential damages, including, without limitation, business interruptions, loss of use, or loss of profits incurred by client, its subsidiaries, affiliates or successors arising out of or related to the performance of the services hereunder by Cardinal, regardless of whether such claim is based upon any of the above stated reasons or otherwise. Results relate only to the samples identified above. This report shall not be reproduced except in full with written approval of Cardinal Laboratories.



Celey D. Keene, Lab Director/Quality Manager

Analytical Results For:

DCP Midstream - Midland
HACK CONDER
10 Desta Dr., #400-W
Midland TX, 79705
Fax To: None

Received: 02/07/2017
Reported: 02/08/2017
Project Name: M EXTENSION LINE
Project Number: NONE GIVEN
Project Location: NOT GIVEN

Sampling Date: 02/07/2017
Sampling Type: Soil
Sampling Condition: Cool & Intact
Sample Received By: Celey D. Keene

Sample ID: PT 2 @ 4' (H700315-03)

BTX 8021B		mg/kg		Analyzed By: MS					
Analyte	Result	Reporting Limit	Analyzed	Method Blank	BS	% Recovery	True Value QC	RPD	Qualifier
Benzene*	<0.050	0.050	02/08/2017	ND	2.23	112	2.00	0.753	
Toluene*	0.060	0.050	02/08/2017	ND	2.18	109	2.00	0.516	
Ethylbenzene*	0.080	0.050	02/08/2017	ND	2.17	108	2.00	0.0492	
Total Xylenes*	0.304	0.150	02/08/2017	ND	6.16	103	6.00	0.258	
Total BTX	0.445	0.300	02/08/2017	ND					

Surrogate: 4-Bromofluorobenzene (PID) 106 % 73.6-140

Chloride, SM4500CI-B		mg/kg		Analyzed By: HM					
Analyte	Result	Reporting Limit	Analyzed	Method Blank	BS	% Recovery	True Value QC	RPD	Qualifier
Chloride	16.0	16.0	02/08/2017	ND	448	112	400	3.64	

TPH 8015M		mg/kg		Analyzed By: MS					
Analyte	Result	Reporting Limit	Analyzed	Method Blank	BS	% Recovery	True Value QC	RPD	Qualifier
GRO C6-C10	<10.0	10.0	02/08/2017	ND	184	91.9	200	0.449	
DRO >C10-C28	180	10.0	02/08/2017	ND	193	96.3	200	4.05	

Surrogate: 1-Chlorooctane 76.7 % 35-147

Surrogate: 1-Chlorooctadecane 92.3 % 28-171

Cardinal Laboratories

*=Accredited Analyte

PLEASE NOTE: Liability and Damages. Cardinal's liability and client's exclusive remedy for any claim arising, whether based in contract or tort, shall be limited to the amount paid by client for analyses. All claims, including those for negligence and any other cause whatsoever shall be deemed waived unless made in writing and received by Cardinal within thirty (30) days after completion of the applicable service. In no event shall Cardinal be liable for incidental or consequential damages, including, without limitation, business interruptions, loss of use, or loss of profits incurred by client, its subsidiaries, affiliates or successors arising out of or related to the performance of the services hereunder by Cardinal, regardless of whether such claim is based upon any of the above stated reasons or otherwise. Results relate only to the samples identified above. This report shall not be reproduced except in full with written approval of Cardinal Laboratories.



Celey D. Keene, Lab Director/Quality Manager

Analytical Results For:

DCP Midstream - Midland
HACK CONDER
10 Desta Dr., #400-W
Midland TX, 79705
Fax To: None

Received: 02/07/2017
Reported: 02/08/2017
Project Name: M EXTENSION LINE
Project Number: NONE GIVEN
Project Location: NOT GIVEN

Sampling Date: 02/07/2017
Sampling Type: Soil
Sampling Condition: Cool & Intact
Sample Received By: Celey D. Keene

Sample ID: PT 3 @ 8' (H700315-04)

BTEx 8021B		mg/kg		Analyzed By: MS					
Analyte	Result	Reporting Limit	Analyzed	Method Blank	BS	% Recovery	True Value QC	RPD	Qualifier
Benzene*	32.2	5.00	02/08/2017	ND	2.23	112	2.00	0.753	
Toluene*	163	5.00	02/08/2017	ND	2.18	109	2.00	0.516	
Ethylbenzene*	78.9	5.00	02/08/2017	ND	2.17	108	2.00	0.0492	
Total Xylenes*	359	15.0	02/08/2017	ND	6.16	103	6.00	0.258	
Total BTEX	634	30.0	02/08/2017	ND					

Surrogate: 4-Bromofluorobenzene (PID) 113 % 73.6-140

Chloride, SM4500Cl-B		mg/kg		Analyzed By: HM					
Analyte	Result	Reporting Limit	Analyzed	Method Blank	BS	% Recovery	True Value QC	RPD	Qualifier
Chloride	2280	16.0	02/08/2017	ND	448	112	400	3.64	

TPH 8015M		mg/kg		Analyzed By: MS					S-06	
Analyte	Result	Reporting Limit	Analyzed	Method Blank	BS	% Recovery	True Value QC	RPD	Qualifier	
GRO C6-C10	8730	100	02/08/2017	ND	184	91.9	200	0.449		
DRO >C10-C28	21700	100	02/08/2017	ND	193	96.3	200	4.05		

Surrogate: 1-Chlorooctane 473 % 35-147

Surrogate: 1-Chlorooctadecane 244 % 28-171

Cardinal Laboratories

*=Accredited Analyte

PLEASE NOTE: Liability and Damages. Cardinal's liability and client's exclusive remedy for any claim arising, whether based in contract or tort, shall be limited to the amount paid by client for analyses. All claims, including those for negligence and any other cause whatsoever shall be deemed waived unless made in writing and received by Cardinal within thirty (30) days after completion of the applicable service. In no event shall Cardinal be liable for incidental or consequential damages, including, without limitation, business interruptions, loss of use, or loss of profits incurred by client, its subsidiaries, affiliates or successors arising out of or related to the performance of the services hereunder by Cardinal, regardless of whether such claim is based upon any of the above stated reasons or otherwise. Results relate only to the samples identified above. This report shall not be reproduced except in full with written approval of Cardinal Laboratories.



Celey D. Keene, Lab Director/Quality Manager

Analytical Results For:

DCP Midstream - Midland
HACK CONDER
10 Desta Dr., #400-W
Midland TX, 79705
Fax To: None

Received: 02/07/2017
Reported: 02/08/2017
Project Name: M EXTENSION LINE
Project Number: NONE GIVEN
Project Location: NOT GIVEN

Sampling Date: 02/07/2017
Sampling Type: Soil
Sampling Condition: Cool & Intact
Sample Received By: Celey D. Keene

Sample ID: PT 3 @ 9' (H700315-05)

BTEx 8021B		mg/kg		Analyzed By: MS					
Analyte	Result	Reporting Limit	Analyzed	Method Blank	BS	% Recovery	True Value QC	RPD	Qualifier
Benzene*	120	10.0	02/08/2017	ND	2.23	112	2.00	0.753	
Toluene*	471	10.0	02/08/2017	ND	2.18	109	2.00	0.516	
Ethylbenzene*	164	10.0	02/08/2017	ND	2.17	108	2.00	0.0492	
Total Xylenes*	686	30.0	02/08/2017	ND	6.16	103	6.00	0.258	
Total BTEX	1440	60.0	02/08/2017	ND					

Surrogate: 4-Bromofluorobenzene (PID) 112 % 73.6-140

Chloride, SM4500CI-B		mg/kg		Analyzed By: HM						
Analyte	Result	Reporting Limit	Analyzed	Method Blank	BS	% Recovery	True Value QC	RPD	Qualifier	
Chloride	48.0	16.0	02/08/2017	ND	448	112	400	3.64		
TPH 8015M		mg/kg		Analyzed By: MS						S-06

TPH 8015M		mg/kg		Analyzed By: MS				S-06	
Analyte	Result	Reporting Limit	Analyzed	Method Blank	BS	% Recovery	True Value QC	RPD	Qualifier
GRO C6-C10	12600	100	02/08/2017	ND	184	91.9	200	0.449	
DRO >C10-C28	24900	100	02/08/2017	ND	193	96.3	200	4.05	

Surrogate: 1-Chlorooctane 527 % 35-147

Surrogate: 1-Chlorooctadecane 264 % 28-171

Cardinal Laboratories

*=Accredited Analyte

PLEASE NOTE: Liability and Damages. Cardinal's liability and client's exclusive remedy for any claim arising, whether based in contract or tort, shall be limited to the amount paid by client for analyses. All claims, including those for negligence and any other cause whatsoever shall be deemed waived unless made in writing and received by Cardinal within thirty (30) days after completion of the applicable service. In no event shall Cardinal be liable for incidental or consequential damages, including, without limitation, business interruptions, loss of use, or loss of profits incurred by client, its subsidiaries, affiliates or successors arising out of or related to the performance of the services hereunder by Cardinal, regardless of whether such claim is based upon any of the above stated reasons or otherwise. Results relate only to the samples identified above. This report shall not be reproduced except in full with written approval of Cardinal Laboratories.



Celey D. Keene, Lab Director/Quality Manager

Analytical Results For:

DCP Midstream - Midland
HACK CONDER
10 Desta Dr., #400-W
Midland TX, 79705
Fax To: None

Received: 02/07/2017
Reported: 02/08/2017
Project Name: M EXTENSION LINE
Project Number: NONE GIVEN
Project Location: NOT GIVEN

Sampling Date: 02/07/2017
Sampling Type: Soil
Sampling Condition: Cool & Intact
Sample Received By: Celey D. Keene

Sample ID: PT 4 @ 1' (H700315-06)

BTX 8021B		mg/kg		Analyzed By: MS					
Analyte	Result	Reporting Limit	Analyzed	Method Blank	BS	% Recovery	True Value QC	RPD	Qualifier
Benzene*	0.206	0.050	02/08/2017	ND	2.23	112	2.00	0.753	
Toluene*	0.312	0.050	02/08/2017	ND	2.18	109	2.00	0.516	
Ethylbenzene*	<0.050	0.050	02/08/2017	ND	2.17	108	2.00	0.0492	
Total Xylenes*	<0.150	0.150	02/08/2017	ND	6.16	103	6.00	0.258	
Total BTX	0.518	0.300	02/08/2017	ND					

Surrogate: 4-Bromofluorobenzene (PID) 106 % 73.6-140

Chloride, SM4500CI-B		mg/kg		Analyzed By: HM					
Analyte	Result	Reporting Limit	Analyzed	Method Blank	BS	% Recovery	True Value QC	RPD	Qualifier
Chloride	16.0	16.0	02/08/2017	ND	400	100	400	11.3	

TPH 8015M		mg/kg		Analyzed By: MS					
Analyte	Result	Reporting Limit	Analyzed	Method Blank	BS	% Recovery	True Value QC	RPD	Qualifier
GRO C6-C10	<10.0	10.0	02/08/2017	ND	184	91.9	200	0.449	
DRO >C10-C28	52.0	10.0	02/08/2017	ND	193	96.3	200	4.05	

Surrogate: 1-Chlorooctane 82.5 % 35-147

Surrogate: 1-Chlorooctadecane 98.1 % 28-171

Cardinal Laboratories

*=Accredited Analyte

PLEASE NOTE: Liability and Damages. Cardinal's liability and client's exclusive remedy for any claim arising, whether based in contract or tort, shall be limited to the amount paid by client for analyses. All claims, including those for negligence and any other cause whatsoever shall be deemed waived unless made in writing and received by Cardinal within thirty (30) days after completion of the applicable service. In no event shall Cardinal be liable for incidental or consequential damages, including, without limitation, business interruptions, loss of use, or loss of profits incurred by client, its subsidiaries, affiliates or successors arising out of or related to the performance of the services hereunder by Cardinal, regardless of whether such claim is based upon any of the above stated reasons or otherwise. Results relate only to the samples identified above. This report shall not be reproduced except in full with written approval of Cardinal Laboratories.



Celey D. Keene, Lab Director/Quality Manager

Analytical Results For:

DCP Midstream - Midland
HACK CONDER
10 Desta Dr., #400-W
Midland TX, 79705
Fax To: None

Received: 02/07/2017
Reported: 02/08/2017
Project Name: M EXTENSION LINE
Project Number: NONE GIVEN
Project Location: NOT GIVEN

Sampling Date: 02/07/2017
Sampling Type: Soil
Sampling Condition: Cool & Intact
Sample Received By: Celey D. Keene

Sample ID: PT 5 @ 1' (H700315-07)

BTEx 8021B		mg/kg		Analyzed By: MS					
Analyte	Result	Reporting Limit	Analyzed	Method Blank	BS	% Recovery	True Value QC	RPD	Qualifier
Benzene*	<0.050	0.050	02/08/2017	ND	2.23	112	2.00	0.753	
Toluene*	<0.050	0.050	02/08/2017	ND	2.18	109	2.00	0.516	
Ethylbenzene*	<0.050	0.050	02/08/2017	ND	2.17	108	2.00	0.0492	
Total Xylenes*	<0.150	0.150	02/08/2017	ND	6.16	103	6.00	0.258	
Total BTEx	<0.300	0.300	02/08/2017	ND					

Surrogate: 4-Bromofluorobenzene (PID) 105 % 73.6-140

Chloride, SM4500CI-B		mg/kg		Analyzed By: HM					
Analyte	Result	Reporting Limit	Analyzed	Method Blank	BS	% Recovery	True Value QC	RPD	Qualifier
Chloride	64.0	16.0	02/08/2017	ND	400	100	400	11.3	

TPH 8015M		mg/kg		Analyzed By: MS					
Analyte	Result	Reporting Limit	Analyzed	Method Blank	BS	% Recovery	True Value QC	RPD	Qualifier
GRO C6-C10	<10.0	10.0	02/08/2017	ND	184	91.9	200	0.449	
DRO >C10-C28	<10.0	10.0	02/08/2017	ND	193	96.3	200	4.05	

Surrogate: 1-Chlorooctane 82.4 % 35-147

Surrogate: 1-Chlorooctadecane 94.1 % 28-171

Cardinal Laboratories

*=Accredited Analyte

PLEASE NOTE: Liability and Damages. Cardinal's liability and client's exclusive remedy for any claim arising, whether based in contract or tort, shall be limited to the amount paid by client for analyses. All claims, including those for negligence and any other cause whatsoever shall be deemed waived unless made in writing and received by Cardinal within thirty (30) days after completion of the applicable service. In no event shall Cardinal be liable for incidental or consequential damages, including, without limitation, business interruptions, loss of use, or loss of profits incurred by client, its subsidiaries, affiliates or successors arising out of or related to the performance of the services hereunder by Cardinal, regardless of whether such claim is based upon any of the above stated reasons or otherwise. Results relate only to the samples identified above. This report shall not be reproduced except in full with written approval of Cardinal Laboratories.



Celey D. Keene, Lab Director/Quality Manager

Analytical Results For:

 DCP Midstream - Midland
 HACK CONDER
 10 Desta Dr., #400-W
 Midland TX, 79705
 Fax To: None

 Received: 02/07/2017
 Reported: 02/08/2017
 Project Name: M EXTENSION LINE
 Project Number: NONE GIVEN
 Project Location: NOT GIVEN

 Sampling Date: 02/07/2017
 Sampling Type: Soil
 Sampling Condition: Cool & Intact
 Sample Received By: Celey D. Keene

Sample ID: PT 6 @ 1' (H700315-08)

BTX 8021B		mg/kg		Analyzed By: MS					
Analyte	Result	Reporting Limit	Analyzed	Method Blank	BS	% Recovery	True Value QC	RPD	Qualifier
Benzene*	<0.050	0.050	02/08/2017	ND	2.23	112	2.00	0.753	
Toluene*	<0.050	0.050	02/08/2017	ND	2.18	109	2.00	0.516	
Ethylbenzene*	<0.050	0.050	02/08/2017	ND	2.17	108	2.00	0.0492	
Total Xylenes*	<0.150	0.150	02/08/2017	ND	6.16	103	6.00	0.258	
Total BTX	<0.300	0.300	02/08/2017	ND					

Surrogate: 4-Bromofluorobenzene (PID) 106 % 73.6-140

Chloride, SM4500CI-B		mg/kg		Analyzed By: HM					
Analyte	Result	Reporting Limit	Analyzed	Method Blank	BS	% Recovery	True Value QC	RPD	Qualifier
Chloride	48.0	16.0	02/08/2017	ND	400	100	400	11.3	

TPH 8015M		mg/kg		Analyzed By: MS					
Analyte	Result	Reporting Limit	Analyzed	Method Blank	BS	% Recovery	True Value QC	RPD	Qualifier
GRO C6-C10	<10.0	10.0	02/08/2017	ND	184	91.9	200	0.449	
DRO >C10-C28	<10.0	10.0	02/08/2017	ND	193	96.3	200	4.05	

Surrogate: 1-Chlorooctane 76.1 % 35-147

Surrogate: 1-Chlorooctadecane 91.7 % 28-171

Cardinal Laboratories

*=Accredited Analyte

PLEASE NOTE: Liability and Damages. Cardinal's liability and client's exclusive remedy for any claim arising, whether based in contract or tort, shall be limited to the amount paid by client for analyses. All claims, including those for negligence and any other cause whatsoever shall be deemed waived unless made in writing and received by Cardinal within thirty (30) days after completion of the applicable service. In no event shall Cardinal be liable for incidental or consequential damages, including, without limitation, business interruptions, loss of use, or loss of profits incurred by client, its subsidiaries, affiliates or successors arising out of or related to the performance of the services hereunder by Cardinal, regardless of whether such claim is based upon any of the above stated reasons or otherwise. Results relate only to the samples identified above. This report shall not be reproduced except in full with written approval of Cardinal Laboratories.



Celey D. Keene, Lab Director/Quality Manager

Analytical Results For:

DCP Midstream - Midland
HACK CONDER
10 Desta Dr., #400-W
Midland TX, 79705
Fax To: None

Received: 02/07/2017
Reported: 02/08/2017
Project Name: M EXTENSION LINE
Project Number: NONE GIVEN
Project Location: NOT GIVEN

Sampling Date: 02/07/2017
Sampling Type: Soil
Sampling Condition: Cool & Intact
Sample Received By: Celey D. Keene

Sample ID: PT 7 @ 2' (H700315-09)

BTX 8021B		mg/kg		Analyzed By: MS					
Analyte	Result	Reporting Limit	Analyzed	Method Blank	BS	% Recovery	True Value QC	RPD	Qualifier
Benzene*	2.70	1.00	02/08/2017	ND	2.23	112	2.00	0.753	
Toluene*	28.6	1.00	02/08/2017	ND	2.18	109	2.00	0.516	
Ethylbenzene*	22.2	1.00	02/08/2017	ND	2.17	108	2.00	0.0492	
Total Xylenes*	68.5	3.00	02/08/2017	ND	6.16	103	6.00	0.258	
Total BTX	122	6.00	02/08/2017	ND					

Surrogate: 4-Bromofluorobenzene (PID) 116 % 73.6-140

Chloride, SM4500CI-B		mg/kg		Analyzed By: HM					
Analyte	Result	Reporting Limit	Analyzed	Method Blank	BS	% Recovery	True Value QC	RPD	Qualifier
Chloride	96.0	16.0	02/08/2017	ND	400	100	400	11.3	

TPH 8015M		mg/kg		Analyzed By: MS					
Analyte	Result	Reporting Limit	Analyzed	Method Blank	BS	% Recovery	True Value QC	RPD	Qualifier
GRO C6-C10	946	10.0	02/08/2017	ND	184	91.9	200	0.449	
DRO >C10-C28	4050	10.0	02/08/2017	ND	193	96.3	200	4.05	

Surrogate: 1-Chlorooctane 115 % 35-147

Surrogate: 1-Chlorooctadecane 144 % 28-171

Cardinal Laboratories

*=Accredited Analyte

PLEASE NOTE: Liability and Damages. Cardinal's liability and client's exclusive remedy for any claim arising, whether based in contract or tort, shall be limited to the amount paid by client for analyses. All claims, including those for negligence and any other cause whatsoever shall be deemed waived unless made in writing and received by Cardinal within thirty (30) days after completion of the applicable service. In no event shall Cardinal be liable for incidental or consequential damages, including, without limitation, business interruptions, loss of use, or loss of profits incurred by client, its subsidiaries, affiliates or successors arising out of or related to the performance of the services hereunder by Cardinal, regardless of whether such claim is based upon any of the above stated reasons or otherwise. Results relate only to the samples identified above. This report shall not be reproduced except in full with written approval of Cardinal Laboratories.



Celey D. Keene, Lab Director/Quality Manager

Analytical Results For:

DCP Midstream - Midland
HACK CONDER
10 Desta Dr., #400-W
Midland TX, 79705
Fax To: None

Received: 02/07/2017
Reported: 02/08/2017
Project Name: M EXTENSION LINE
Project Number: NONE GIVEN
Project Location: NOT GIVEN

Sampling Date: 02/07/2017
Sampling Type: Soil
Sampling Condition: Cool & Intact
Sample Received By: Celey D. Keene

Sample ID: PT 8 @ 2' (H700315-10)

BTEx 8021B		mg/kg		Analyzed By: MS					
Analyte	Result	Reporting Limit	Analyzed	Method Blank	BS	% Recovery	True Value QC	RPD	Qualifier
Benzene*	<0.050	0.050	02/08/2017	ND	2.23	112	2.00	0.753	
Toluene*	0.092	0.050	02/08/2017	ND	2.18	109	2.00	0.516	
Ethylbenzene*	<0.050	0.050	02/08/2017	ND	2.17	108	2.00	0.0492	
Total Xylenes*	<0.150	0.150	02/08/2017	ND	6.16	103	6.00	0.258	
Total BTEx	<0.300	0.300	02/08/2017	ND					

Surrogate: 4-Bromofluorobenzene (PID) 106 % 73.6-140

Chloride, SM4500CI-B		mg/kg		Analyzed By: HM					
Analyte	Result	Reporting Limit	Analyzed	Method Blank	BS	% Recovery	True Value QC	RPD	Qualifier
Chloride	16.0	16.0	02/08/2017	ND	400	100	400	11.3	

TPH 8015M		mg/kg		Analyzed By: MS					
Analyte	Result	Reporting Limit	Analyzed	Method Blank	BS	% Recovery	True Value QC	RPD	Qualifier
GRO C6-C10	<10.0	10.0	02/08/2017	ND	184	91.9	200	0.449	
DRO >C10-C28	13.8	10.0	02/08/2017	ND	193	96.3	200	4.05	

Surrogate: 1-Chlorooctane 79.3 % 35-147

Surrogate: 1-Chlorooctadecane 94.4 % 28-171

Cardinal Laboratories

*=Accredited Analyte

PLEASE NOTE: Liability and Damages. Cardinal's liability and client's exclusive remedy for any claim arising, whether based in contract or tort, shall be limited to the amount paid by client for analyses. All claims, including those for negligence and any other cause whatsoever shall be deemed waived unless made in writing and received by Cardinal within thirty (30) days after completion of the applicable service. In no event shall Cardinal be liable for incidental or consequential damages, including, without limitation, business interruptions, loss of use, or loss of profits incurred by client, its subsidiaries, affiliates or successors arising out of or related to the performance of the services hereunder by Cardinal, regardless of whether such claim is based upon any of the above stated reasons or otherwise. Results relate only to the samples identified above. This report shall not be reproduced except in full with written approval of Cardinal Laboratories.



Celey D. Keene, Lab Director/Quality Manager

Analytical Results For:

DCP Midstream - Midland
HACK CONDER
10 Desta Dr., #400-W
Midland TX, 79705
Fax To: None

Received: 02/07/2017
Reported: 02/08/2017
Project Name: M EXTENSION LINE
Project Number: NONE GIVEN
Project Location: NOT GIVEN

Sampling Date: 02/07/2017
Sampling Type: Soil
Sampling Condition: Cool & Intact
Sample Received By: Celey D. Keene

Sample ID: PT 1 @ 4' (H700315-11)

BTEx 8021B		mg/kg		Analyzed By: MS					
Analyte	Result	Reporting Limit	Analyzed	Method Blank	BS	% Recovery	True Value QC	RPD	Qualifier
Benzene*	<0.050	0.050	02/08/2017	ND	2.23	112	2.00	0.753	
Toluene*	<0.050	0.050	02/08/2017	ND	2.18	109	2.00	0.516	
Ethylbenzene*	<0.050	0.050	02/08/2017	ND	2.17	108	2.00	0.0492	
Total Xylenes*	<0.150	0.150	02/08/2017	ND	6.16	103	6.00	0.258	
Total BTEX	<0.300	0.300	02/08/2017	ND					

Surrogate: 4-Bromofluorobenzene (PID) 104 % 73.6-140

Chloride, SM4500Cl-B		mg/kg		Analyzed By: HM					
Analyte	Result	Reporting Limit	Analyzed	Method Blank	BS	% Recovery	True Value QC	RPD	Qualifier
Chloride	48.0	16.0	02/08/2017	ND	400	100	400	11.3	

TPH 8015M		mg/kg		Analyzed By: MS					
Analyte	Result	Reporting Limit	Analyzed	Method Blank	BS	% Recovery	True Value QC	RPD	Qualifier
GRO C6-C10	<10.0	10.0	02/08/2017	ND	184	91.9	200	0.449	
DRO >C10-C28	89.4	10.0	02/08/2017	ND	193	96.3	200	4.05	

Surrogate: 1-Chlorooctane 81.2 % 35-147

Surrogate: 1-Chlorooctadecane 96.7 % 28-171

Cardinal Laboratories

*=Accredited Analyte

PLEASE NOTE: Liability and Damages. Cardinal's liability and client's exclusive remedy for any claim arising, whether based in contract or tort, shall be limited to the amount paid by client for analyses. All claims, including those for negligence and any other cause whatsoever shall be deemed waived unless made in writing and received by Cardinal within thirty (30) days after completion of the applicable service. In no event shall Cardinal be liable for incidental or consequential damages, including, without limitation, business interruptions, loss of use, or loss of profits incurred by client, its subsidiaries, affiliates or successors arising out of or related to the performance of the services hereunder by Cardinal, regardless of whether such claim is based upon any of the above stated reasons or otherwise. Results relate only to the samples identified above. This report shall not be reproduced except in full with written approval of Cardinal Laboratories.



Celey D. Keene, Lab Director/Quality Manager

Analytical Results For:

DCP Midstream - Midland
HACK CONDER
10 Desta Dr., #400-W
Midland TX, 79705
Fax To: None

Received: 02/07/2017
Reported: 02/08/2017
Project Name: M EXTENSION LINE
Project Number: NONE GIVEN
Project Location: NOT GIVEN

Sampling Date: 02/07/2017
Sampling Type: Soil
Sampling Condition: Cool & Intact
Sample Received By: Celey D. Keene

Sample ID: PT 9 @ 2' (H700315-12)

BTX 8021B		mg/kg		Analyzed By: MS					
Analyte	Result	Reporting Limit	Analyzed	Method Blank	BS	% Recovery	True Value QC	RPD	Qualifier
Benzene*	<0.050	0.050	02/08/2017	ND	2.23	112	2.00	0.753	
Toluene*	<0.050	0.050	02/08/2017	ND	2.18	109	2.00	0.516	
Ethylbenzene*	<0.050	0.050	02/08/2017	ND	2.17	108	2.00	0.0492	
Total Xylenes*	<0.150	0.150	02/08/2017	ND	6.16	103	6.00	0.258	
Total BTX	<0.300	0.300	02/08/2017	ND					

Surrogate: 4-Bromofluorobenzene (PID) 106 % 73.6-140

Chloride, SM4500CI-B		mg/kg		Analyzed By: HM					
Analyte	Result	Reporting Limit	Analyzed	Method Blank	BS	% Recovery	True Value QC	RPD	Qualifier
Chloride	<16.0	16.0	02/08/2017	ND	400	100	400	11.3	

TPH 8015M		mg/kg		Analyzed By: MS					
Analyte	Result	Reporting Limit	Analyzed	Method Blank	BS	% Recovery	True Value QC	RPD	Qualifier
GRO C6-C10	<10.0	10.0	02/08/2017	ND	184	91.9	200	0.449	
DRO >C10-C28	33.9	10.0	02/08/2017	ND	193	96.3	200	4.05	

Surrogate: 1-Chlorooctane 80.0 % 35-147

Surrogate: 1-Chlorooctadecane 94.5 % 28-171

Cardinal Laboratories

*=Accredited Analyte

PLEASE NOTE: Liability and Damages. Cardinal's liability and client's exclusive remedy for any claim arising, whether based in contract or tort, shall be limited to the amount paid by client for analyses. All claims, including those for negligence and any other cause whatsoever shall be deemed waived unless made in writing and received by Cardinal within thirty (30) days after completion of the applicable service. In no event shall Cardinal be liable for incidental or consequential damages, including, without limitation, business interruptions, loss of use, or loss of profits incurred by client, its subsidiaries, affiliates or successors arising out of or related to the performance of the services hereunder by Cardinal, regardless of whether such claim is based upon any of the above stated reasons or otherwise. Results relate only to the samples identified above. This report shall not be reproduced except in full with written approval of Cardinal Laboratories.



Celey D. Keene, Lab Director/Quality Manager

Notes and Definitions

S-06	The recovery of this surrogate is outside control limits due to sample dilution required from high analyte concentration and/or matrix interference's.
QM-07	The spike recovery was outside acceptance limits for the MS and/or MSD. The batch was accepted based on acceptable LCS recovery.
ND	Analyte NOT DETECTED at or above the reporting limit
RPD	Relative Percent Difference
**	Samples not received at proper temperature of 6°C or below.
***	Insufficient time to reach temperature.
-	Chloride by SM4500Cl-B does not require samples be received at or below 6°C Samples reported on an as received basis (wet) unless otherwise noted on report

Cardinal Laboratories

*=Accredited Analyte

PLEASE NOTE: Liability and Damages. Cardinal's liability and client's exclusive remedy for any claim arising, whether based in contract or tort, shall be limited to the amount paid by client for analyses. All claims, including those for negligence and any other cause whatsoever shall be deemed waived unless made in writing and received by Cardinal within thirty (30) days after completion of the applicable service. In no event shall Cardinal be liable for incidental or consequential damages, including, without limitation, business interruptions, loss of use, or loss of profits incurred by client, its subsidiaries, affiliates or successors arising out of or related to the performance of the services hereunder by Cardinal, regardless of whether such claim is based upon any of the above stated reasons or otherwise. Results relate only to the samples identified above. This report shall not be reproduced except in full with written approval of Cardinal Laboratories.



Celey D. Keene, Lab Director/Quality Manager

CHAIN-OF-CUSTODY AND ANALYSIS REQUEST

101 East Marland, Hobbs, NM 88240
(575) 393-2326 FAX (575) 393-2476

Company Name: <u>DCP Midstream</u>				BILL TO				ANALYSIS REQUEST			
Project Manager: <u>Hack Corder</u>				P.O. #:							
Address:				Company: <u>DCP</u>							
City:				Attn:							
State:				Address:							
Phone #:				City:							
Project #:				State:							
Project Name:				Zip:							
Project Location: <u>M Extension Line</u>				Phone #:							
Sample Name: <u>Kyle Norman</u>				Fax #:							

Lab I.D.	Sample I.D.	(G)RAB OR (C)OMP	# CONTAINERS	MATRIX						DATE	TIME	CL	TPH	BTEX	
				GROUNDWATER	WASTEWATER	SOIL	OIL	SLUDGE	OTHER :						ACID/BASE:
11700315-															
01	P41 @ 3'	G1	1	✓						2-7-17	8:30	✓	✓	✓	
02	P42 @ 3'	G1	1	✓							8:40	✓	✓	✓	
03	P42 @ 4'	G1	1	✓							3:00	✓	✓	✓	
04	P43 @ 8'	G1	1	✓							10:00	✓	✓	✓	
05	P43 @ 9'	G1	1	✓							2:45	✓	✓	✓	
06	P44 @ 1'	G1	1	✓							9:45	✓	✓	✓	
07	P45 @ 1'	G1	1	✓							10:00	✓	✓	✓	
08	P46 @ 1'	G1	1	✓							10:40	✓	✓	✓	
09	P47 @ 2'	G1	1	✓							12:00	✓	✓	✓	
10	P48 @ 2'	G1	1	✓							12:40	✓	✓	✓	

Relinquished By: <u>Kyle Norman</u>		Date: <u>2-7-17</u>		Received By: <u>Hack Corder</u>		Date: <u>2-7-17</u>	
Time: <u>4:41p</u>		Time: <u>4:41p</u>		Time: <u>4:41p</u>		Time: <u>4:41p</u>	
Delivered By: (Circle One) Sampler - UPS - Bus - Other: <u>2.10</u>		Sample Condition Cool <input checked="" type="checkbox"/> Intact <input checked="" type="checkbox"/> Yes <input checked="" type="checkbox"/> No <input checked="" type="checkbox"/>		CHECKED BY: (Initials) <u>ca #75</u>		REMARKS: <u>Hack Corder</u> <u>K Norman</u> <u>DUSTH!</u>	



101 East Marland, Hobbs, NM 88240
(575) 393-2326 FAX (575) 393-2476

[illegible]



PHONE (575) 393-2326 ° 101 E. MARLAND ° HOBBS, NM 88240

September 21, 2017

HACK CONDER

DCP Midstream - Midland

10 Desta Dr., #400-W

Midland, TX 79705

RE: M EXTENSION LINE

Enclosed are the results of analyses for samples received by the laboratory on 09/15/17 15:32.

Cardinal Laboratories is accredited through Texas NELAP under certificate number T104704398-16-8. Accreditation applies to drinking water, non-potable water and solid and chemical materials. All accredited analytes are denoted by an asterisk (*). For a complete list of accredited analytes and matrices visit the TCEQ website at www.tceq.texas.gov/field/qa/lab_accred_certif.html.

Cardinal Laboratories is accredited through the State of Colorado Department of Public Health and Environment for:

Method EPA 552.2	Haloacetic Acids (HAA-5)
Method EPA 524.2	Total Trihalomethanes (TTHM)
Method EPA 524.4	Regulated VOCs (V1, V2, V3)

Accreditation applies to public drinking water matrices.

This report meets NELAP requirements and is made up of a cover page, analytical results, and a copy of the original chain-of-custody. If you have any questions concerning this report, please feel free to contact me.

Sincerely,

A handwritten signature in black ink that reads "Celey D. Keene". The signature is written in a cursive, flowing style.

Celey D. Keene

Lab Director/Quality Manager

Analytical Results For:

DCP Midstream - Midland
HACK CONDER
10 Desta Dr., #400-W
Midland TX, 79705
Fax To: None

Received: 09/15/2017
Reported: 09/21/2017
Project Name: M EXTENSION LINE
Project Number: NONE GIVEN
Project Location: NOT GIVEN

Sampling Date: 09/15/2017
Sampling Type: Soil
Sampling Condition: ** (See Notes)
Sample Received By: Tamara Oldaker

Sample ID: WALL PT. 1 (H702498-01)

Chloride, SM4500Cl-B		mg/kg	Analyzed By: AC						
Analyte	Result	Reporting Limit	Analyzed	Method Blank	BS	% Recovery	True Value QC	RPD	Qualifier
Chloride	16.0	16.0	09/18/2017	ND	416	104	400	3.77	
TPH 8015M		mg/kg	Analyzed By: MS						
Analyte	Result	Reporting Limit	Analyzed	Method Blank	BS	% Recovery	True Value QC	RPD	Qualifier
GRO C6-C10	<10.0	10.0	09/19/2017	ND	178	88.9	200	0.398	
DRO >C10-C28	<10.0	10.0	09/19/2017	ND	185	92.3	200	1.18	
EXT DRO >C28-C36	<10.0	10.0	09/19/2017	ND					
<i>Surrogate: 1-Chlorooctane</i>		96.8 %	28.3-164						
<i>Surrogate: 1-Chlorooctadecane</i>		103 %	34.7-157						

Sample ID: WALL PT. 2 (H702498-02)

Chloride, SM4500Cl-B		mg/kg	Analyzed By: AC						
Analyte	Result	Reporting Limit	Analyzed	Method Blank	BS	% Recovery	True Value QC	RPD	Qualifier
Chloride	32.0	16.0	09/18/2017	ND	416	104	400	3.77	
TPH 8015M		mg/kg	Analyzed By: MS						
Analyte	Result	Reporting Limit	Analyzed	Method Blank	BS	% Recovery	True Value QC	RPD	Qualifier
GRO C6-C10	<10.0	10.0	09/19/2017	ND	178	88.9	200	0.398	
DRO >C10-C28	<10.0	10.0	09/19/2017	ND	185	92.3	200	1.18	
EXT DRO >C28-C36	<10.0	10.0	09/19/2017	ND					
<i>Surrogate: 1-Chlorooctane</i>		97.4 %	28.3-164						
<i>Surrogate: 1-Chlorooctadecane</i>		109 %	34.7-157						

Cardinal Laboratories

*=Accredited Analyte

PLEASE NOTE: Liability and Damages. Cardinal's liability and client's exclusive remedy for any claim arising, whether based in contract or tort, shall be limited to the amount paid by client for analyses. All claims, including those for negligence and any other cause whatsoever shall be deemed waived unless made in writing and received by Cardinal within thirty (30) days after completion of the applicable service. In no event shall Cardinal be liable for incidental or consequential damages, including, without limitation, business interruptions, loss of use, or loss of profits incurred by client, its subsidiaries, affiliates or successors arising out of or related to the performance of the services hereunder by Cardinal, regardless of whether such claim is based upon any of the above stated reasons or otherwise. Results relate only to the samples identified above. This report shall not be reproduced except in full with written approval of Cardinal Laboratories.



Celey D. Keene, Lab Director/Quality Manager

Analytical Results For:

DCP Midstream - Midland
HACK CONDER
10 Desta Dr., #400-W
Midland TX, 79705
Fax To: None

Received: 09/15/2017
Reported: 09/21/2017
Project Name: M EXTENSION LINE
Project Number: NONE GIVEN
Project Location: NOT GIVEN

Sampling Date: 09/15/2017
Sampling Type: Soil
Sampling Condition: ** (See Notes)
Sample Received By: Tamara Oldaker

Sample ID: WALL PT. 3 (H702498-03)

Chloride, SM4500CI-B		mg/kg		Analyzed By: AC					
Analyte	Result	Reporting Limit	Analyzed	Method Blank	BS	% Recovery	True Value QC	RPD	Qualifier
Chloride	176	16.0	09/18/2017	ND	416	104	400	3.77	
TPH 8015M		mg/kg		Analyzed By: MS					
Analyte	Result	Reporting Limit	Analyzed	Method Blank	BS	% Recovery	True Value QC	RPD	Qualifier
GRO C6-C10	<10.0	10.0	09/19/2017	ND	178	88.9	200	0.398	
DRO >C10-C28	<10.0	10.0	09/19/2017	ND	185	92.3	200	1.18	
EXT DRO >C28-C36	<10.0	10.0	09/19/2017	ND					
Surrogate: 1-Chlorooctane		93.8 %	28.3-164						
Surrogate: 1-Chlorooctadecane		109 %	34.7-157						

Sample ID: WALL PT. 4 (H702498-04)

Chloride, SM4500Cl-B		mg/kg		Analyzed By: AC					
Analyte	Result	Reporting Limit	Analyzed	Method Blank	BS	% Recovery	True Value QC	RPD	Qualifier
Chloride	240	16.0	09/18/2017	ND	416	104	400	3.77	
TPH 8015M		mg/kg		Analyzed By: MS					
Analyte	Result	Reporting Limit	Analyzed	Method Blank	BS	% Recovery	True Value QC	RPD	Qualifier
GRO C6-C10	<10.0	10.0	09/19/2017	ND	178	88.9	200	0.398	
DRO >C10-C28	<10.0	10.0	09/19/2017	ND	185	92.3	200	1.18	
EXT DRO >C28-C36	<10.0	10.0	09/19/2017	ND					
Surrogate: 1-Chlorooctane		103 %	28.3-164						
Surrogate: 1-Chlorooctadecane		106 %	34.7-157						

Cardinal Laboratories

*=Accredited Analyte

PLEASE NOTE: Liability and Damages. Cardinal's liability and client's exclusive remedy for any claim arising, whether based in contract or tort, shall be limited to the amount paid by client for analyses. All claims, including those for negligence and any other cause whatsoever shall be deemed waived unless made in writing and received by Cardinal within thirty (30) days after completion of the applicable service. In no event shall Cardinal be liable for incidental or consequential damages, including, without limitation, business interruptions, loss of use, or loss of profits incurred by client, its subsidiaries, affiliates or successors arising out of or related to the performance of the services hereunder by Cardinal, regardless of whether such claim is based upon any of the above stated reasons or otherwise. Results relate only to the samples identified above. This report shall not be reproduced except in full with written approval of Cardinal Laboratories.



Celey D. Keene, Lab Director/Quality Manager

Analytical Results For:

 DCP Midstream - Midland
 HACK CONDER
 10 Desta Dr., #400-W
 Midland TX, 79705
 Fax To: None

 Received: 09/15/2017
 Reported: 09/21/2017
 Project Name: M EXTENSION LINE
 Project Number: NONE GIVEN
 Project Location: NOT GIVEN

 Sampling Date: 09/15/2017
 Sampling Type: Soil
 Sampling Condition: ** (See Notes)
 Sample Received By: Tamara Oldaker

Sample ID: WALL PT. 5 (H702498-05)

Chloride, SM4500Cl-B		mg/kg		Analyzed By: AC					
Analyte	Result	Reporting Limit	Analyzed	Method Blank	BS	% Recovery	True Value QC	RPD	Qualifier
Chloride	32.0	16.0	09/18/2017	ND	416	104	400	3.77	
TPH 8015M		mg/kg		Analyzed By: MS					
Analyte	Result	Reporting Limit	Analyzed	Method Blank	BS	% Recovery	True Value QC	RPD	Qualifier
GRO C6-C10	<10.0	10.0	09/19/2017	ND	178	88.9	200	0.398	
DRO >C10-C28	<10.0	10.0	09/19/2017	ND	185	92.3	200	1.18	
EXT DRO >C28-C36	<10.0	10.0	09/19/2017	ND					
Surrogate: 1-Chlorooctane		100 %	28.3-164						
Surrogate: 1-Chlorooctadecane		110 %	34.7-157						

Sample ID: WALL PT. 6 (H702498-06)

Chloride, SM4500Cl-B		mg/kg		Analyzed By: AC					
Analyte	Result	Reporting Limit	Analyzed	Method Blank	BS	% Recovery	True Value QC	RPD	Qualifier
Chloride	<16.0	16.0	09/18/2017	ND	416	104	400	3.77	
TPH 8015M		mg/kg		Analyzed By: MS					
Analyte	Result	Reporting Limit	Analyzed	Method Blank	BS	% Recovery	True Value QC	RPD	Qualifier
GRO C6-C10	<10.0	10.0	09/19/2017	ND	178	88.9	200	0.398	
DRO >C10-C28	19.7	10.0	09/19/2017	ND	185	92.3	200	1.18	
EXT DRO >C28-C36	<10.0	10.0	09/19/2017	ND					
Surrogate: 1-Chlorooctane		90.8 %	28.3-164						
Surrogate: 1-Chlorooctadecane		93.8 %	34.7-157						

Cardinal Laboratories

* = Accredited Analyte

PLEASE NOTE: Liability and Damages. Cardinal's liability and client's exclusive remedy for any claim arising, whether based in contract or tort, shall be limited to the amount paid by client for analyses. All claims, including those for negligence and any other cause whatsoever shall be deemed waived unless made in writing and received by Cardinal within thirty (30) days after completion of the applicable service. In no event shall Cardinal be liable for incidental or consequential damages, including, without limitation, business interruptions, loss of use, or loss of profits incurred by client, its subsidiaries, affiliates or successors arising out of or related to the performance of the services hereunder by Cardinal, regardless of whether such claim is based upon any of the above stated reasons or otherwise. Results relate only to the samples identified above. This report shall not be reproduced except in full with written approval of Cardinal Laboratories.



Celey D. Keene, Lab Director/Quality Manager

Analytical Results For:

DCP Midstream - Midland
HACK CONDER
10 Desta Dr., #400-W
Midland TX, 79705
Fax To: None

Received: 09/15/2017
Reported: 09/21/2017
Project Name: M EXTENSION LINE
Project Number: NONE GIVEN
Project Location: NOT GIVEN

Sampling Date: 09/15/2017
Sampling Type: Soil
Sampling Condition: ** (See Notes)
Sample Received By: Tamara Oldaker

Sample ID: WALL PT. 7 (H702498-07)

Chloride, SM4500Cl-B		mg/kg		Analyzed By: AC					
Analyte	Result	Reporting Limit	Analyzed	Method Blank	BS	% Recovery	True Value QC	RPD	Qualifier
Chloride	16.0	16.0	09/18/2017	ND	432	108	400	0.00	
TPH 8015M		mg/kg		Analyzed By: MS					
Analyte	Result	Reporting Limit	Analyzed	Method Blank	BS	% Recovery	True Value QC	RPD	Qualifier
GRO C6-C10	<10.0	10.0	09/19/2017	ND	178	88.9	200	0.398	
DRO >C10-C28	12.5	10.0	09/19/2017	ND	185	92.3	200	1.18	
EXT DRO >C28-C36	<10.0	10.0	09/19/2017	ND					
Surrogate: 1-Chlorooctane	93.1 %	28.3-164							
Surrogate: 1-Chlorooctadecane	102 %	34.7-157							

Sample ID: WALL PT. 8 (H702498-08)

Chloride, SM4500Cl-B		mg/kg		Analyzed By: AC					
Analyte	Result	Reporting Limit	Analyzed	Method Blank	BS	% Recovery	True Value QC	RPD	Qualifier
Chloride	32.0	16.0	09/18/2017	ND	432	108	400	0.00	
TPH 8015M		mg/kg		Analyzed By: MS					
Analyte	Result	Reporting Limit	Analyzed	Method Blank	BS	% Recovery	True Value QC	RPD	Qualifier
GRO C6-C10	<10.0	10.0	09/20/2017	ND	178	88.9	200	0.398	
DRO >C10-C28	<10.0	10.0	09/20/2017	ND	185	92.3	200	1.18	
EXT DRO >C28-C36	<10.0	10.0	09/20/2017	ND					
Surrogate: 1-Chlorooctane	95.1 %	28.3-164							
Surrogate: 1-Chlorooctadecane	97.6 %	34.7-157							

Cardinal Laboratories

*=Accredited Analyte

PLEASE NOTE: Liability and Damages. Cardinal's liability and client's exclusive remedy for any claim arising, whether based in contract or tort, shall be limited to the amount paid by client for analyses. All claims, including those for negligence and any other cause whatsoever shall be deemed waived unless made in writing and received by Cardinal within thirty (30) days after completion of the applicable service. In no event shall Cardinal be liable for incidental or consequential damages, including, without limitation, business interruptions, loss of use, or loss of profits incurred by client, its subsidiaries, affiliates or successors arising out of or related to the performance of the services hereunder by Cardinal, regardless of whether such claim is based upon any of the above stated reasons or otherwise. Results relate only to the samples identified above. This report shall not be reproduced except in full with written approval of Cardinal Laboratories.



Celey D. Keene, Lab Director/Quality Manager

Notes and Definitions

QM-07	The spike recovery was outside acceptance limits for the MS and/or MSD. The batch was accepted based on acceptable LCS recovery.
ND	Analyte NOT DETECTED at or above the reporting limit
RPD	Relative Percent Difference
**	Samples not received at proper temperature of 6°C or below.
***	Insufficient time to reach temperature.
-	Chloride by SM4500Cl-B does not require samples be received at or below 6°C Samples reported on an as received basis (wet) unless otherwise noted on report

Cardinal Laboratories

*=Accredited Analyte

PLEASE NOTE: Liability and Damages. Cardinal's liability and client's exclusive remedy for any claim arising, whether based in contract or tort, shall be limited to the amount paid by client for analyses. All claims, including those for negligence and any other cause whatsoever shall be deemed waived unless made in writing and received by Cardinal within thirty (30) days after completion of the applicable service. In no event shall Cardinal be liable for incidental or consequential damages, including, without limitation, business interruptions, loss of use, or loss of profits incurred by client, its subsidiaries, affiliates or successors arising out of or related to the performance of the services hereunder by Cardinal, regardless of whether such claim is based upon any of the above stated reasons or otherwise. Results relate only to the samples identified above. This report shall not be reproduced except in full with written approval of Cardinal Laboratories.



Celey D. Keene, Lab Director/Quality Manager

ORDINAL LABORATORIES

101 East Marland, Hobbs, NM 88240 2111 Beechwood, Abilene, TX 79603
(505) 393-2326 FAX (505) 393-2476 (325) 673-7001 FAX (325) 673-7020

CHAIN-OF-CUSTODY AND ANALYSIS REQUEST

Company Name: DCP Midstream Project Manager: Hack Conder Address: City: State: Zip: Phone #: Fax #: Project #: Project Owner: Project Name: Project Location: M Extension Line Sample Name: Kyle Norman				P.O. #: Company: Attn: Address: City: State: Zip: Phone #: Fax #:	
BILL TO				ANALYSIS REQUEST	
Lab I.D. H2024198		Sample I.D.		<div style="display: flex; justify-content: space-around;"> <div>Chlorides</div> <div>TPH 8015 M EXT</div> <div>BTEX</div> <div>Texas TPH</div> <div>Complete Cations/Anions</div> <div>TDS</div> </div>	
FOR LAB USE ONLY		Matrix			
<div style="display: flex; justify-content: space-between;"> <div> Call P+1 P+2 P+3 P+4 P+5 P+6 P+7 P+8 </div> <div> 1 2 3 4 5 6 7 8 </div> </div>		<div style="display: flex; justify-content: space-between;"> <div> (G)RAB OR (C)OMP. # CONTAINERS GROUNDWATER WASTEWATER SOIL OIL SLUDGE OTHER : ACID/BASE: ICE / COOL OTHER : </div> <div> DATE TIME </div> </div>		<div style="display: flex; justify-content: space-between;"> <div> PRESERV SAMPLING </div> <div> 9-15#1300 1330 1345 1400 1415 1425 1445 1500 </div> </div>	
Delivered By: (Circle One) 8.0°C / 8.25°C Sampler - UPS - Bus - Other:		Sample Condition <input checked="" type="checkbox"/> Cool <input checked="" type="checkbox"/> Intact <input type="checkbox"/> Yes <input checked="" type="checkbox"/> No <input type="checkbox"/> No <input type="checkbox"/> No		CHECKED BY: HC	
REMARKS: email results: hpconder@dcpmidstream.com yblair@dcpmidstream.com knorman@tasman-geo.com:					



PHONE (575) 393-2326 ° 101 E. MARLAND ° HOBBS, NM 88240

September 25, 2017

HACK CONDER

DCP Midstream - Midland

10 Desta Dr., #400-W

Midland, TX 79705

RE: M EXTENSION LINE

Enclosed are the results of analyses for samples received by the laboratory on 09/15/17 15:23.

Cardinal Laboratories is accredited through Texas NELAP under certificate number T104704398-16-8. Accreditation applies to drinking water, non-potable water and solid and chemical materials. All accredited analytes are denoted by an asterisk (*). For a complete list of accredited analytes and matrices visit the TCEQ website at www.tceq.texas.gov/field/qa/lab_accred_certif.html.

Cardinal Laboratories is accredited through the State of Colorado Department of Public Health and Environment for:

Method EPA 552.2	Haloacetic Acids (HAA-5)
Method EPA 524.2	Total Trihalomethanes (TTHM)
Method EPA 524.4	Regulated VOCs (V1, V2, V3)

Accreditation applies to public drinking water matrices.

This report meets NELAP requirements and is made up of a cover page, analytical results, and a copy of the original chain-of-custody. If you have any questions concerning this report, please feel free to contact me.

Sincerely,

A handwritten signature in black ink that reads "Celey D. Keene". The signature is written in a cursive, flowing style.

Celey D. Keene

Lab Director/Quality Manager

Analytical Results For:

DCP Midstream - Midland
HACK CONDER
10 Desta Dr., #400-W
Midland TX, 79705
Fax To: None

Received: 09/15/2017
Reported: 09/25/2017
Project Name: M EXTENSION LINE
Project Number: NONE GIVEN
Project Location: NOT GIVEN

Sampling Date: 09/15/2017
Sampling Type: Soil
Sampling Condition: ** (See Notes)
Sample Received By: Tamara Oldaker

Sample ID: PT 3 VERTICAL @ 17' (H702499-01)

BTEX 8021B		mg/kg		Analyzed By: MS					
Analyte	Result	Reporting Limit	Analyzed	Method Blank	BS	% Recovery	True Value QC	RPD	Qualifier
Benzene*	7.97	2.00	09/21/2017	ND	1.90	95.2	2.00	0.810	
Toluene*	76.2	2.00	09/21/2017	ND	1.77	88.6	2.00	1.97	
Ethylbenzene*	43.9	2.00	09/21/2017	ND	1.85	92.4	2.00	1.18	
Total Xylenes*	222	6.00	09/21/2017	ND	5.59	93.2	6.00	1.42	
Total BTEX	350	12.0	09/21/2017	ND					

Surrogate: 4-Bromofluorobenzene (PID) 112 % 72-148

Chloride, SM4500Cl-B		mg/kg		Analyzed By: AC					
Analyte	Result	Reporting Limit	Analyzed	Method Blank	BS	% Recovery	True Value QC	RPD	Qualifier
Chloride	112	16.0	09/18/2017	ND	432	108	400	0.00	

TPH 8015M		mg/kg		Analyzed By: MS						S-04
Analyte	Result	Reporting Limit	Analyzed	Method Blank	BS	% Recovery	True Value QC	RPD	Qualifier	
GRO C6-C10	3570	10.0	09/20/2017	ND	178	88.9	200	0.398		
DRO >C10-C28	6460	10.0	09/20/2017	ND	185	92.3	200	1.18		
EXT DRO >C28-C36	151	10.0	09/20/2017	ND						

Surrogate: 1-Chlorooctane 180 % 28.3-164

Surrogate: 1-Chlorooctadecane 131 % 34.7-157

Cardinal Laboratories

*=Accredited Analyte

PLEASE NOTE: Liability and Damages. Cardinal's liability and client's exclusive remedy for any claim arising, whether based in contract or tort, shall be limited to the amount paid by client for analyses. All claims, including those for negligence and any other cause whatsoever shall be deemed waived unless made in writing and received by Cardinal within thirty (30) days after completion of the applicable service. In no event shall Cardinal be liable for incidental or consequential damages, including, without limitation, business interruptions, loss of use, or loss of profits incurred by client, its subsidiaries, affiliates or successors arising out of or related to the performance of the services hereunder by Cardinal, regardless of whether such claim is based upon any of the above stated reasons or otherwise. Results relate only to the samples identified above. This report shall not be reproduced except in full with written approval of Cardinal Laboratories.



Celey D. Keene, Lab Director/Quality Manager

Analytical Results For:

DCP Midstream - Midland
HACK CONDER
10 Desta Dr., #400-W
Midland TX, 79705
Fax To: None

Received: 09/15/2017
Reported: 09/25/2017
Project Name: M EXTENSION LINE
Project Number: NONE GIVEN
Project Location: NOT GIVEN

Sampling Date: 09/15/2017
Sampling Type: Soil
Sampling Condition: ** (See Notes)
Sample Received By: Tamara Oldaker

Sample ID: PT 3 VERTICAL @ 18' (H702499-02)

Chloride, SM4500Cl-B			mg/kg		Analyzed By: AC				
Analyte	Result	Reporting Limit	Analyzed	Method Blank	BS	% Recovery	True Value QC	RPD	Qualifier
Chloride	112	16.0	09/18/2017	ND	432	108	400	0.00	
TPH 8015M			mg/kg		Analyzed By: MS				
Analyte	Result	Reporting Limit	Analyzed	Method Blank	BS	% Recovery	True Value QC	RPD	Qualifier
GRO C6-C10	<10.0	10.0	09/20/2017	ND	178	88.9	200	0.398	
DRO >C10-C28	<10.0	10.0	09/20/2017	ND	185	92.3	200	1.18	
EXT DRO >C28-C36	<10.0	10.0	09/20/2017	ND					
Surrogate: 1-Chlorooctane	101 %	28.3-164							
Surrogate: 1-Chlorooctadecane	101 %	34.7-157							

Sample ID: PT 3 VERTICAL @ 20' (H702499-03)

Chloride, SM4500Cl-B		mg/kg		Analyzed By: AC					
Analyte	Result	Reporting Limit	Analyzed	Method Blank	BS	% Recovery	True Value QC	RPD	Qualifier
Chloride	112	16.0	09/18/2017	ND	432	108	400	0.00	
TPH 8015M		mg/kg		Analyzed By: MS					
Analyte	Result	Reporting Limit	Analyzed	Method Blank	BS	% Recovery	True Value QC	RPD	Qualifier
GRO C6-C10	<10.0	10.0	09/20/2017	ND	178	88.9	200	0.398	
DRO >C10-C28	<10.0	10.0	09/20/2017	ND	185	92.3	200	1.18	
EXT DRO >C28-C36	<10.0	10.0	09/20/2017	ND					
Surrogate: 1-Chlorooctane	92.9 %	28.3-164							
Surrogate: 1-Chlorooctadecane	106 %	34.7-157							

Cardinal Laboratories

*=Accredited Analyte

PLEASE NOTE: Liability and Damages. Cardinal's liability and client's exclusive remedy for any claim arising, whether based in contract or tort, shall be limited to the amount paid by client for analyses. All claims, including those for negligence and any other cause whatsoever shall be deemed waived unless made in writing and received by Cardinal within thirty (30) days after completion of the applicable service. In no event shall Cardinal be liable for incidental or consequential damages, including, without limitation, business interruptions, loss of use, or loss of profits incurred by client, its subsidiaries, affiliates or successors arising out of or related to the performance of the services hereunder by Cardinal, regardless of whether such claim is based upon any of the above stated reasons or otherwise. Results relate only to the samples identified above. This report shall not be reproduced except in full with written approval of Cardinal Laboratories.



Celey D. Keene, Lab Director/Quality Manager

Analytical Results For:

DCP Midstream - Midland
HACK CONDER
10 Desta Dr., #400-W
Midland TX, 79705
Fax To: None

Received: 09/15/2017
Reported: 09/25/2017
Project Name: M EXTENSION LINE
Project Number: NONE GIVEN
Project Location: NOT GIVEN

Sampling Date: 09/15/2017
Sampling Type: Soil
Sampling Condition: ** (See Notes)
Sample Received By: Tamara Oldaker

Sample ID: SOUTH WALL (H702499-04)

BTEx 8021B		mg/kg		Analyzed By: MS					
Analyte	Result	Reporting Limit	Analyzed	Method Blank	BS	% Recovery	True Value QC	RPD	Qualifier
Benzene*	13.1	5.00	09/21/2017	ND	1.90	95.2	2.00	0.810	
Toluene*	134	5.00	09/21/2017	ND	1.77	88.6	2.00	1.97	
Ethylbenzene*	52.6	5.00	09/21/2017	ND	1.85	92.4	2.00	1.18	
Total Xylenes*	363	15.0	09/21/2017	ND	5.59	93.2	6.00	1.42	
Total BTEX	562	30.0	09/21/2017	ND					

Surrogate: 4-Bromofluorobenzene (PID) 108 % 72-148

Chloride, SM4500Cl-B		mg/kg		Analyzed By: AC					
Analyte	Result	Reporting Limit	Analyzed	Method Blank	BS	% Recovery	True Value QC	RPD	Qualifier
Chloride	2440	16.0	09/18/2017	ND	432	108	400	0.00	
TPH 8015M	mg/kg		Analyzed By: MS						S-06

Analyte	Result	Reporting Limit	Analyzed	Method Blank	BS	% Recovery	True Value QC	RPD	Qualifier
GRO C6-C10	5690	50.0	09/20/2017	ND	178	88.9	200	0.398	
DRO >C10-C28	13500	50.0	09/20/2017	ND	185	92.3	200	1.18	
EXT DRO >C28-C36	1000	50.0	09/20/2017	ND					

Surrogate: 1-Chlorooctane 206 % 28.3-164

Surrogate: 1-Chlorooctadecane 105 % 34.7-157

Cardinal Laboratories

*=Accredited Analyte

PLEASE NOTE: Liability and Damages. Cardinal's liability and client's exclusive remedy for any claim arising, whether based in contract or tort, shall be limited to the amount paid by client for analyses. All claims, including those for negligence and any other cause whatsoever shall be deemed waived unless made in writing and received by Cardinal within thirty (30) days after completion of the applicable service. In no event shall Cardinal be liable for incidental or consequential damages, including, without limitation, business interruptions, loss of use, or loss of profits incurred by client, its subsidiaries, affiliates or successors arising out of or related to the performance of the services hereunder by Cardinal, regardless of whether such claim is based upon any of the above stated reasons or otherwise. Results relate only to the samples identified above. This report shall not be reproduced except in full with written approval of Cardinal Laboratories.



Celey D. Keene, Lab Director/Quality Manager

Analytical Results For:

DCP Midstream - Midland
HACK CONDER
10 Desta Dr., #400-W
Midland TX, 79705
Fax To: None

Received: 09/15/2017
Reported: 09/25/2017
Project Name: M EXTENSION LINE
Project Number: NONE GIVEN
Project Location: NOT GIVEN

Sampling Date: 09/15/2017
Sampling Type: Soil
Sampling Condition: ** (See Notes)
Sample Received By: Tamara Oldaker

Sample ID: NORTH WALL (H702499-05)

BTEx 8021B		mg/kg	Analyzed By: MS						
Analyte	Result	Reporting Limit	Analyzed	Method Blank	BS	% Recovery	True Value QC	RPD	Qualifier
Benzene*	<0.050	0.050	09/21/2017	ND	1.90	95.2	2.00	0.810	
Toluene*	0.185	0.050	09/21/2017	ND	1.77	88.6	2.00	1.97	
Ethylbenzene*	0.527	0.050	09/21/2017	ND	1.85	92.4	2.00	1.18	
Total Xylenes*	2.97	0.150	09/21/2017	ND	5.59	93.2	6.00	1.42	
Total BTEX	3.69	0.300	09/21/2017	ND					

Surrogate: 4-Bromofluorobenzene (PID) 132 % 72-148

Chloride, SM4500Cl-B		mg/kg	Analyzed By: AC						
Analyte	Result	Reporting Limit	Analyzed	Method Blank	BS	% Recovery	True Value QC	RPD	Qualifier
Chloride	32.0	16.0	09/18/2017	ND	432	108	400	0.00	

TPH 8015M		mg/kg	Analyzed By: MS						
Analyte	Result	Reporting Limit	Analyzed	Method Blank	BS	% Recovery	True Value QC	RPD	Qualifier
GRO C6-C10	98.3	10.0	09/20/2017	ND	178	89.2	200	0.0320	
DRO >C10-C28	2900	10.0	09/20/2017	ND	186	92.8	200	1.62	
EXT DRO >C28-C36	134	10.0	09/20/2017	ND					

Surrogate: 1-Chlorooctane 121 % 28.3-164

Surrogate: 1-Chlorooctadecane 130 % 34.7-157

Cardinal Laboratories

*=Accredited Analyte

PLEASE NOTE: Liability and Damages. Cardinal's liability and client's exclusive remedy for any claim arising, whether based in contract or tort, shall be limited to the amount paid by client for analyses. All claims, including those for negligence and any other cause whatsoever shall be deemed waived unless made in writing and received by Cardinal within thirty (30) days after completion of the applicable service. In no event shall Cardinal be liable for incidental or consequential damages, including, without limitation, business interruptions, loss of use, or loss of profits incurred by client, its subsidiaries, affiliates or successors arising out of or related to the performance of the services hereunder by Cardinal, regardless of whether such claim is based upon any of the above stated reasons or otherwise. Results relate only to the samples identified above. This report shall not be reproduced except in full with written approval of Cardinal Laboratories.



Celey D. Keene, Lab Director/Quality Manager

Analytical Results For:

DCP Midstream - Midland
HACK CONDER
10 Desta Dr., #400-W
Midland TX, 79705
Fax To: None

Received: 09/15/2017
Reported: 09/25/2017
Project Name: M EXTENSION LINE
Project Number: NONE GIVEN
Project Location: NOT GIVEN

Sampling Date: 09/15/2017
Sampling Type: Soil
Sampling Condition: ** (See Notes)
Sample Received By: Tamara Oldaker

Sample ID: NORTH BOTTOM @ 9' (H702499-06)

BTEx 8021B		mg/kg		Analyzed By: MS					
Analyte	Result	Reporting Limit	Analyzed	Method Blank	BS	% Recovery	True Value QC	RPD	Qualifier
Benzene*	1.13	1.00	09/21/2017	ND	1.90	95.2	2.00	0.810	
Toluene*	15.7	1.00	09/21/2017	ND	1.77	88.6	2.00	1.97	
Ethylbenzene*	14.3	1.00	09/21/2017	ND	1.85	92.4	2.00	1.18	
Total Xylenes*	88.3	3.00	09/21/2017	ND	5.59	93.2	6.00	1.42	
Total BTEX	119	6.00	09/21/2017	ND					

Surrogate: 4-Bromofluorobenzene (PID) 115 % 72-148

Chloride, SM4500Cl-B		mg/kg		Analyzed By: AC						
Analyte	Result	Reporting Limit	Analyzed	Method Blank	BS	% Recovery	True Value QC	RPD	Qualifier	
Chloride	192	16.0	09/18/2017	ND	432	108	400	0.00		

TPH 8015M		mg/kg		Analyzed By: MS					
Analyte	Result	Reporting Limit	Analyzed	Method Blank	BS	% Recovery	True Value QC	RPD	Qualifier
GRO C6-C10	1770	10.0	09/20/2017	ND	178	89.2	200	0.0320	
DRO >C10-C28	7440	10.0	09/20/2017	ND	186	92.8	200	1.62	
EXT DRO >C28-C36	133	10.0	09/20/2017	ND					

Surrogate: 1-Chlorooctane 148 % 28.3-164

Surrogate: 1-Chlorooctadecane 131 % 34.7-157

Cardinal Laboratories

*=Accredited Analyte

PLEASE NOTE: Liability and Damages. Cardinal's liability and client's exclusive remedy for any claim arising, whether based in contract or tort, shall be limited to the amount paid by client for analyses. All claims, including those for negligence and any other cause whatsoever shall be deemed waived unless made in writing and received by Cardinal within thirty (30) days after completion of the applicable service. In no event shall Cardinal be liable for incidental or consequential damages, including, without limitation, business interruptions, loss of use, or loss of profits incurred by client, its subsidiaries, affiliates or successors arising out of or related to the performance of the services hereunder by Cardinal, regardless of whether such claim is based upon any of the above stated reasons or otherwise. Results relate only to the samples identified above. This report shall not be reproduced except in full with written approval of Cardinal Laboratories.



Celey D. Keene, Lab Director/Quality Manager

Notes and Definitions

S-06	The recovery of this surrogate is outside control limits due to sample dilution required from high analyte concentration and/or matrix interference's.
S-04	The surrogate recovery for this sample is outside of established control limits due to a sample matrix effect.
ND	Analyte NOT DETECTED at or above the reporting limit
RPD	Relative Percent Difference
**	Samples not received at proper temperature of 6°C or below.
***	Insufficient time to reach temperature.
-	Chloride by SM4500Cl-B does not require samples be received at or below 6°C Samples reported on an as received basis (wet) unless otherwise noted on report



Celey D. Keene, Lab Director/Quality Manager

ORDINAL LABORATORIES

101 East Marland, Hobbs, NM 88240 2111 Beechwood, Abilene, TX 79603
(505) 393-2326 FAX (505) 393-2476 (325) 673-7001 FAX (325) 673-7020

CHAIN-OF-CUSTODY AND ANALYSIS REQUEST

Company Name: DCP Midstream		P.O. #:		BILL TO		ANALYSIS REQUEST	
Project Manager: Hack Conder		Company:					
Address:		Attn:					
City:		Address:					
State:		City:					
Zip:		State:					
Phone #:		Fax #:					
Project #:		Project Owner:					
Project Name:		City:					
Project Location: M Extension Line		State:					
Sample Name: Kyle Norman		Phone #:					
FOR LAB USE ONLY		Fax #:					
Lab I.D.		Sample I.D.					
H7084109		P43 Vertical @ 17'					
1		↓					
2		↓					
3		↓					
4		↓					
5		↓					
6		↓					
South Wall							
North Wall							
North Bottom @ 9'							
(G)RAB OR (C)OMP.		# CONTAINERS					
GROUNDWATER		WASTEWATER					
SOIL		OIL					
SLUDGE		OTHER :					
ACID/BASE:		ICE / COOL					
OTHER :		DATE		TIME			
9-15# 0900		0930		0950			
1010		1030		1100			
Chlorides		TPH 8015 M EXT		BTEX		Texas TPH	
Complete Cations/Anions		TDS					
Relinquished By:		Date:		Received By:			
Relinquished By:		Time:		Received By:			
Delivered By: (Circle One)		Sample Condition		CHECKED BY: (Initials)			
UPS - Bus - Other:		Cool Intact		Yes No			
8.0°C / 8.25°C		Yes No		Yes No			
email results: hpconder@dcpmidstream.com		yblair@dcpmidstream.com		knorman@tasman-geo.com			



PHONE (575) 393-2326 ° 101 E. MARLAND ° HOBBS, NM 88240

November 03, 2017

YVONNE BLAIR

DCP Midstream - Midland

10 Desta Dr., #400-W

Midland, TX 79705

RE: M EXTENSION LINE

Enclosed are the results of analyses for samples received by the laboratory on 10/31/17 12:45.

Cardinal Laboratories is accredited through Texas NELAP under certificate number T104704398-16-8. Accreditation applies to drinking water, non-potable water and solid and chemical materials. All accredited analytes are denoted by an asterisk (*). For a complete list of accredited analytes and matrices visit the TCEQ website at www.tceq.texas.gov/field/qa/lab_accred_certif.html.

Cardinal Laboratories is accredited through the State of Colorado Department of Public Health and Environment for:

Method EPA 552.2	Haloacetic Acids (HAA-5)
Method EPA 524.2	Total Trihalomethanes (TTHM)
Method EPA 524.4	Regulated VOCs (V1, V2, V3)

Accreditation applies to public drinking water matrices.

This report meets NELAP requirements and is made up of a cover page, analytical results, and a copy of the original chain-of-custody. If you have any questions concerning this report, please feel free to contact me.

Sincerely,

A handwritten signature in black ink that reads "Celey D. Keene". The signature is written in a cursive style with a large, stylized 'C' and 'K'.

Celey D. Keene

Lab Director/Quality Manager

Analytical Results For:

DCP Midstream - Midland
YVONNE BLAIR
10 Desta Dr., #400-W
Midland TX, 79705
Fax To: None

Received: 10/31/2017
Reported: 11/03/2017
Project Name: M EXTENSION LINE
Project Number: F-231
Project Location: NOT GIVEN

Sampling Date: 10/27/2017
Sampling Type: Soil
Sampling Condition: Cool & Intact
Sample Received By: Jodi Henson

Sample ID: SOUTH WALL EXTENDED (H702981-01)

BTX 8021B		mg/kg		Analyzed By: MS					
Analyte	Result	Reporting Limit	Analyzed	Method Blank	BS	% Recovery	True Value QC	RPD	Qualifier
Benzene*	<0.050	0.050	11/02/2017	ND	2.06	103	2.00	0.991	
Toluene*	0.133	0.050	11/02/2017	ND	2.10	105	2.00	1.89	
Ethylbenzene*	0.384	0.050	11/02/2017	ND	2.12	106	2.00	1.22	
Total Xylenes*	2.27	0.150	11/02/2017	ND	6.78	113	6.00	1.32	
Total BTX	2.79	0.300	11/02/2017	ND					

Surrogate: 4-Bromofluorobenzene (PID) 129 % 72-148

Chloride, SM4500Cl-B		mg/kg		Analyzed By: HM					
Analyte	Result	Reporting Limit	Analyzed	Method Blank	BS	% Recovery	True Value QC	RPD	Qualifier
Chloride	176	16.0	11/01/2017	ND	432	108	400	3.77	

TPH 8015M		mg/kg		Analyzed By: MS					
Analyte	Result	Reporting Limit	Analyzed	Method Blank	BS	% Recovery	True Value QC	RPD	Qualifier
GRO C6-C10	112	10.0	11/01/2017	ND	198	98.8	200	3.65	
DRO >C10-C28	2030	10.0	11/01/2017	ND	194	97.1	200	1.15	
EXT DRO >C28-C36	71.0	10.0	11/01/2017	ND					

Surrogate: 1-Chlorooctane 112 % 28.3-164

Surrogate: 1-Chlorooctadecane 94.3 % 34.7-157

Cardinal Laboratories

*=Accredited Analyte

PLEASE NOTE: Liability and Damages. Cardinal's liability and client's exclusive remedy for any claim arising, whether based in contract or tort, shall be limited to the amount paid by client for analyses. All claims, including those for negligence and any other cause whatsoever shall be deemed waived unless made in writing and received by Cardinal within thirty (30) days after completion of the applicable service. In no event shall Cardinal be liable for incidental or consequential damages, including, without limitation, business interruptions, loss of use, or loss of profits incurred by client, its subsidiaries, affiliates or successors arising out of or related to the performance of the services hereunder by Cardinal, regardless of whether such claim is based upon any of the above stated reasons or otherwise. Results relate only to the samples identified above. This report shall not be reproduced except in full with written approval of Cardinal Laboratories.



Celey D. Keene, Lab Director/Quality Manager

Analytical Results For:

DCP Midstream - Midland
YVONNE BLAIR
10 Desta Dr., #400-W
Midland TX, 79705
Fax To: None

Received: 10/31/2017
Reported: 11/03/2017
Project Name: M EXTENSION LINE
Project Number: F-231
Project Location: NOT GIVEN

Sampling Date: 10/27/2017
Sampling Type: Soil
Sampling Condition: Cool & Intact
Sample Received By: Jodi Henson

Sample ID: PT.7 BOTTOM @4' (H702981-02)

BTEX 8021B		mg/kg		Analyzed By: MS					
Analyte	Result	Reporting Limit	Analyzed	Method Blank	BS	% Recovery	True Value QC	RPD	Qualifier
Benzene*	<0.050	0.050	11/02/2017	ND	2.06	103	2.00	0.991	
Toluene*	<0.050	0.050	11/02/2017	ND	2.10	105	2.00	1.89	
Ethylbenzene*	0.085	0.050	11/02/2017	ND	2.12	106	2.00	1.22	
Total Xylenes*	0.430	0.150	11/02/2017	ND	6.78	113	6.00	1.32	
Total BTEX	0.515	0.300	11/02/2017	ND					

Surrogate: 4-Bromofluorobenzene (PID) 112 % 72-148

TPH 8015M		mg/kg		Analyzed By: MS					
Analyte	Result	Reporting Limit	Analyzed	Method Blank	BS	% Recovery	True Value QC	RPD	Qualifier
GRO C6-C10	<10.0	10.0	11/01/2017	ND	198	98.8	200	3.65	
DRO >C10-C28	436	10.0	11/01/2017	ND	194	97.1	200	1.15	
EXT DRO >C28-C36	63.8	10.0	11/01/2017	ND					

Surrogate: 1-Chlorooctane 87.6 % 28.3-164

Surrogate: 1-Chlorooctadecane 104 % 34.7-157

Cardinal Laboratories

*=Accredited Analyte

PLEASE NOTE: Liability and Damages. Cardinal's liability and client's exclusive remedy for any claim arising, whether based in contract or tort, shall be limited to the amount paid by client for analyses. All claims, including those for negligence and any other cause whatsoever shall be deemed waived unless made in writing and received by Cardinal within thirty (30) days after completion of the applicable service. In no event shall Cardinal be liable for incidental or consequential damages, including, without limitation, business interruptions, loss of use, or loss of profits incurred by client, its subsidiaries, affiliates or successors arising out of or related to the performance of the services hereunder by Cardinal, regardless of whether such claim is based upon any of the above stated reasons or otherwise. Results relate only to the samples identified above. This report shall not be reproduced except in full with written approval of Cardinal Laboratories.



Celey D. Keene, Lab Director/Quality Manager

Analytical Results For:

DCP Midstream - Midland
YVONNE BLAIR
10 Desta Dr., #400-W
Midland TX, 79705
Fax To: None

Received: 10/31/2017
Reported: 11/03/2017
Project Name: M EXTENSION LINE
Project Number: F-231
Project Location: NOT GIVEN

Sampling Date: 10/27/2017
Sampling Type: Soil
Sampling Condition: Cool & Intact
Sample Received By: Jodi Henson

Sample ID: PT.7 WEST WALL (H702981-03)

TPH 8015M	mg/kg	Analyzed By: MS							
Analyte	Result	Reporting Limit	Analyzed	Method Blank	BS	% Recovery	True Value QC	RPD	Qualifier
GRO C6-C10	<10.0	10.0	11/01/2017	ND	198	98.8	200	3.65	
DRO >C10-C28	12.9	10.0	11/01/2017	ND	194	97.1	200	1.15	
EXT DRO >C28-C36	<10.0	10.0	11/01/2017	ND					
<hr/>									
Surrogate: 1-Chlorooctane	88.1 %	28.3-164							
Surrogate: 1-Chlorooctadecane	89.5 %	34.7-157							

Sample ID: PT.7 EAST WALL (H702981-04)

TPH 8015M	mg/kg	Analyzed By: MS							
Analyte	Result	Reporting Limit	Analyzed	Method Blank	BS	% Recovery	True Value QC	RPD	Qualifier
GRO C6-C10	<10.0	10.0	11/01/2017	ND	198	98.8	200	3.65	
DRO >C10-C28	<10.0	10.0	11/01/2017	ND	194	97.1	200	1.15	
EXT DRO >C28-C36	<10.0	10.0	11/01/2017	ND					
<hr/>									
Surrogate: 1-Chlorooctane	76.6 %	28.3-164							
Surrogate: 1-Chlorooctadecane	86.6 %	34.7-157							

Cardinal Laboratories

*=Accredited Analyte

PLEASE NOTE: Liability and Damages. Cardinal's liability and client's exclusive remedy for any claim arising, whether based in contract or tort, shall be limited to the amount paid by client for analyses. All claims, including those for negligence and any other cause whatsoever shall be deemed waived unless made in writing and received by Cardinal within thirty (30) days after completion of the applicable service. In no event shall Cardinal be liable for incidental or consequential damages, including, without limitation, business interruptions, loss of use, or loss of profits incurred by client, its subsidiaries, affiliates or successors arising out of or related to the performance of the services hereunder by Cardinal, regardless of whether such claim is based upon any of the above stated reasons or otherwise. Results relate only to the samples identified above. This report shall not be reproduced except in full with written approval of Cardinal Laboratories.



Celey D. Keene, Lab Director/Quality Manager

Notes and Definitions

ND	Analyte NOT DETECTED at or above the reporting limit
RPD	Relative Percent Difference
**	Samples not received at proper temperature of 6°C or below.
***	Insufficient time to reach temperature.
-	Chloride by SM4500Cl-B does not require samples be received at or below 6°C Samples reported on an as received basis (wet) unless otherwise noted on report

Cardinal Laboratories

*=Accredited Analyte

PLEASE NOTE: Liability and Damages. Cardinal's liability and client's exclusive remedy for any claim arising, whether based in contract or tort, shall be limited to the amount paid by client for analyses. All claims, including those for negligence and any other cause whatsoever shall be deemed waived unless made in writing and received by Cardinal within thirty (30) days after completion of the applicable service. In no event shall Cardinal be liable for incidental or consequential damages, including, without limitation, business interruptions, loss of use, or loss of profits incurred by client, its subsidiaries, affiliates or successors arising out of or related to the performance of the services hereunder by Cardinal, regardless of whether such claim is based upon any of the above stated reasons or otherwise. Results relate only to the samples identified above. This report shall not be reproduced except in full with written approval of Cardinal Laboratories.



Celey D. Keene, Lab Director/Quality Manager



101 East Marland, Hobbs, NM 88240 2111 Beechwood, Abilene, TX 79603
(505) 393-2326 FAX (505) 393-2476 (325) 673-7001 FAX (325) 673-7020

RV5#

CHAIN-OF-CUSTODY AND ANALYSIS REQUEST

Company Name: DCP Midstream Project Manager: Yvonne Blair / Kyle Norman Address: City: State: Zip: Phone #: Fax #: Project #: Project Name: Project Location: M Extension Line Sampler Name: Kyle Norman				P.O. #: Company: Attn: Address: City: State: Zip: Phone #: Fax #:					
FOR LAB USE ONLY				BILL TO					
Lab I.D. HT02981		Sample I.D.		MATRIX		PRESERV		SAMPLING	
South Wall Extended Pt. 7 Bottom @4' Pt. 7 West Wall Pt. 7 East Wall		(G)RAB OR (C)OMP. # CONTAINERS GROUNDWATER WASTEWATER SOIL OIL SLUDGE OTHER : ACID/BASE: ICE / COOL OTHER :		DATE TIME		Chlorides TPH 8015 M EXT BTEX *added 11/21/17 Texas TPH Complete Cations/Anions TDS			
		10/27/17 0940 0915 0920 0930		✓ ✓ ✓ ✓		✓ ✓ ✓ ✓			
Relinquished By: [Signature]		Date: 10/31/17		Received By: [Signature]		Phone Result:		ADD'l Phone #:	
Relinquished By: [Signature]		Date: 12:45		Received By: [Signature]		Fax Result:		Add'l Fax #:	
Delivered By: (Circle One) Sampler - UPS - Bus - Other:		Sample Condition Cool <input checked="" type="checkbox"/> Intact <input checked="" type="checkbox"/> Yes <input checked="" type="checkbox"/> No <input type="checkbox"/>		CHECKED BY: (Initials)		email results: hpconder@dcpmidstream.com yblair@dcpmidstream.com knorman@tasman-geo.com: klewis@tasman-geo.com			



PHONE (575) 393-2326 ° 101 E. MARLAND ° HOBBS, NM 88240

April 09, 2018

YVONNE BLAIR

DCP Midstream - Midland

10 Desta Dr., #400-W

Midland, TX 79705

RE: M EXTENSION LINE

Enclosed are the results of analyses for samples received by the laboratory on 04/06/18 12:05.

Cardinal Laboratories is accredited through Texas NELAP under certificate number T104704398-17-10. Accreditation applies to drinking water, non-potable water and solid and chemical materials. All accredited analytes are denoted by an asterisk (*). For a complete list of accredited analytes and matrices visit the TCEQ website at www.tceq.texas.gov/field/qa/lab_accred_certif.html.

Cardinal Laboratories is accredited through the State of Colorado Department of Public Health and Environment for:

Method EPA 552.2	Haloacetic Acids (HAA-5)
Method EPA 524.2	Total Trihalomethanes (TTHM)
Method EPA 524.4	Regulated VOCs (V1, V2, V3)

Accreditation applies to public drinking water matrices.

This report meets NELAP requirements and is made up of a cover page, analytical results, and a copy of the original chain-of-custody. If you have any questions concerning this report, please feel free to contact me.

Sincerely,

A handwritten signature in black ink that reads "Celey D. Keene". The signature is written in a cursive, flowing style.

Celey D. Keene

Lab Director/Quality Manager

Analytical Results For:

DCP Midstream - Midland
YVONNE BLAIR
10 Desta Dr., #400-W
Midland TX, 79705
Fax To: None

Received: 04/06/2018
Reported: 04/09/2018
Project Name: M EXTENSION LINE
Project Number: F-250 - 710001947
Project Location: NOT GIVEN

Sampling Date: 04/05/2018
Sampling Type: Soil
Sampling Condition: Cool & Intact
Sample Received By: Tamara Oldaker

Sample ID: PT. 3 VERTICAL @ 18' (H800954-01)

BTX 8021B		mg/kg		Analyzed By: MS					
Analyte	Result	Reporting Limit	Analyzed	Method Blank	BS	% Recovery	True Value QC	RPD	Qualifier
Benzene*	<0.050	0.050	04/06/2018	ND	2.15	107	2.00	3.20	
Toluene*	<0.050	0.050	04/06/2018	ND	2.14	107	2.00	2.98	
Ethylbenzene*	<0.050	0.050	04/06/2018	ND	2.13	107	2.00	2.34	
Total Xylenes*	<0.150	0.150	04/06/2018	ND	6.63	110	6.00	2.49	
Total BTX	<0.300	0.300	04/06/2018	ND					

Surrogate: 4-Bromofluorobenzene (PID) 103 % 72-148

Sample ID: PT. 3 VERTICAL @ 20' (H800954-02)

BTEx 8021B		mg/kg		Analyzed By: MS					
Analyte	Result	Reporting Limit	Analyzed	Method Blank	BS	% Recovery	True Value QC	RPD	Qualifier
Benzene*	<0.050	0.050	04/06/2018	ND	2.15	107	2.00	3.20	
Toluene*	<0.050	0.050	04/06/2018	ND	2.14	107	2.00	2.98	
Ethylbenzene*	<0.050	0.050	04/06/2018	ND	2.13	107	2.00	2.34	
Total Xylenes*	<0.150	0.150	04/06/2018	ND	6.63	110	6.00	2.49	
Total BTEx	<0.300	0.300	04/06/2018	ND					

Surrogate: 4-Bromofluorobenzene (PID) 101 % 72-148

Cardinal Laboratories

*=Accredited Analyte

PLEASE NOTE: Liability and Damages. Cardinal's liability and client's exclusive remedy for any claim arising, whether based in contract or tort, shall be limited to the amount paid by client for analyses. All claims, including those for negligence and any other cause whatsoever shall be deemed waived unless made in writing and received by Cardinal within thirty (30) days after completion of the applicable service. In no event shall Cardinal be liable for incidental or consequential damages, including, without limitation, business interruptions, loss of use, or loss of profits incurred by client, its subsidiaries, affiliates or successors arising out of or related to the performance of the services hereunder by Cardinal, regardless of whether such claim is based upon any of the above stated reasons or otherwise. Results relate only to the samples identified above. This report shall not be reproduced except in full with written approval of Cardinal Laboratories.



Celey D. Keene, Lab Director/Quality Manager

Notes and Definitions

ND	Analyte NOT DETECTED at or above the reporting limit
RPD	Relative Percent Difference
**	Samples not received at proper temperature of 6°C or below.
***	Insufficient time to reach temperature.
-	Chloride by SM4500Cl-B does not require samples be received at or below 6°C Samples reported on an as received basis (wet) unless otherwise noted on report

Cardinal Laboratories

*=Accredited Analyte

PLEASE NOTE: Liability and Damages. Cardinal's liability and client's exclusive remedy for any claim arising, whether based in contract or tort, shall be limited to the amount paid by client for analyses. All claims, including those for negligence and any other cause whatsoever shall be deemed waived unless made in writing and received by Cardinal within thirty (30) days after completion of the applicable service. In no event shall Cardinal be liable for incidental or consequential damages, including, without limitation, business interruptions, loss of use, or loss of profits incurred by client, its subsidiaries, affiliates or successors arising out of or related to the performance of the services hereunder by Cardinal, regardless of whether such claim is based upon any of the above stated reasons or otherwise. Results relate only to the samples identified above. This report shall not be reproduced except in full with written approval of Cardinal Laboratories.



Celey D. Keene, Lab Director/Quality Manager

101 East Marland, Hobbs, NM 88240 2111 Beechwood, Abilene, TX 79603
(505) 393-2326 FAX (505) 393-2476 (325) 673-7001 FAX (325) 673-7020

CHAIN-OF-CUSTODY AND ANALYSIS REQUEST

+ Cardinal cannot accept verbal changes. Please fax written changes to 505-393-2476



PHONE (575) 393-2326 ° 101 E. MARLAND ° HOBBS, NM 88240

April 09, 2018

YVONNE BLAIR

DCP Midstream - Midland

10 Desta Dr., #400-W

Midland, TX 79705

RE: M EXTENSION LINE

Enclosed are the results of analyses for samples received by the laboratory on 04/06/18 12:05.

Cardinal Laboratories is accredited through Texas NELAP under certificate number T104704398-17-10. Accreditation applies to drinking water, non-potable water and solid and chemical materials. All accredited analytes are denoted by an asterisk (*). For a complete list of accredited analytes and matrices visit the TCEQ website at www.tceq.texas.gov/field/qa/lab_accred_certif.html.

Cardinal Laboratories is accredited through the State of Colorado Department of Public Health and Environment for:

Method EPA 552.2	Haloacetic Acids (HAA-5)
Method EPA 524.2	Total Trihalomethanes (TTHM)
Method EPA 524.4	Regulated VOCs (V1, V2, V3)

Accreditation applies to public drinking water matrices.

This report meets NELAP requirements and is made up of a cover page, analytical results, and a copy of the original chain-of-custody. If you have any questions concerning this report, please feel free to contact me.

Sincerely,

A handwritten signature in black ink that reads "Celey D. Keene". The signature is written in a cursive, flowing style.

Celey D. Keene

Lab Director/Quality Manager

Analytical Results For:

DCP Midstream - Midland
YVONNE BLAIR
10 Desta Dr., #400-W
Midland TX, 79705
Fax To: None

Received: 04/06/2018
Reported: 04/09/2018
Project Name: M EXTENSION LINE
Project Number: F-250 - 710001947
Project Location: NOT GIVEN

Sampling Date: 04/05/2018
Sampling Type: Soil
Sampling Condition: Cool & Intact
Sample Received By: Tamara Oldaker

Sample ID: NORTH BOTTOM VERTICAL @ 18' (H800955-01)

BTEX 8021B		mg/kg		Analyzed By: MS					
Analyte	Result	Reporting Limit	Analyzed	Method Blank	BS	% Recovery	True Value QC	RPD	Qualifier
Benzene*	<0.050	0.050	04/06/2018	ND	2.15	107	2.00	3.20	
Toluene*	<0.050	0.050	04/06/2018	ND	2.14	107	2.00	2.98	
Ethylbenzene*	<0.050	0.050	04/06/2018	ND	2.13	107	2.00	2.34	
Total Xylenes*	<0.150	0.150	04/06/2018	ND	6.63	110	6.00	2.49	
Total BTEX	<0.300	0.300	04/06/2018	ND					

Surrogate: 4-Bromofluorobenzene (PID) 102 % 72-148

TPH 8015M		mg/kg		Analyzed By: MS					
Analyte	Result	Reporting Limit	Analyzed	Method Blank	BS	% Recovery	True Value QC	RPD	Qualifier
GRO C6-C10*	<10.0	10.0	04/06/2018	ND	213	106	200	2.47	
DRO >C10-C28*	18.4	10.0	04/06/2018	ND	214	107	200	0.117	
EXT DRO >C28-C36	<10.0	10.0	04/06/2018	ND					

Surrogate: 1-Chlorooctane 83.6 % 41-142

Surrogate: 1-Chlorooctadecane 81.6 % 37.6-147

Cardinal Laboratories

*=Accredited Analyte

PLEASE NOTE: Liability and Damages. Cardinal's liability and client's exclusive remedy for any claim arising, whether based in contract or tort, shall be limited to the amount paid by client for analyses. All claims, including those for negligence and any other cause whatsoever shall be deemed waived unless made in writing and received by Cardinal within thirty (30) days after completion of the applicable service. In no event shall Cardinal be liable for incidental or consequential damages, including, without limitation, business interruptions, loss of use, or loss of profits incurred by client, its subsidiaries, affiliates or successors arising out of or related to the performance of the services hereunder by Cardinal, regardless of whether such claim is based upon any of the above stated reasons or otherwise. Results relate only to the samples identified above. This report shall not be reproduced except in full with written approval of Cardinal Laboratories.



Celey D. Keene, Lab Director/Quality Manager

Analytical Results For:

DCP Midstream - Midland
YVONNE BLAIR
10 Desta Dr., #400-W
Midland TX, 79705
Fax To: None

Received: 04/06/2018
Reported: 04/09/2018
Project Name: M EXTENSION LINE
Project Number: F-250 - 710001947
Project Location: NOT GIVEN

Sampling Date: 04/05/2018
Sampling Type: Soil
Sampling Condition: Cool & Intact
Sample Received By: Tamara Oldaker

Sample ID: NORTH BOTTOM VERTICAL @ 20' (H800955-02)

BTEx 8021B		mg/kg		Analyzed By: MS						
Analyte	Result	Reporting Limit	Analyzed	Method Blank	BS	% Recovery	True Value QC	RPD	Qualifier	
Benzene*	<0.050	0.050	04/06/2018	ND	2.15	107	2.00	3.20		
Toluene*	<0.050	0.050	04/06/2018	ND	2.14	107	2.00	2.98		
Ethylbenzene*	<0.050	0.050	04/06/2018	ND	2.13	107	2.00	2.34		
Total Xylenes*	<0.150	0.150	04/06/2018	ND	6.63	110	6.00	2.49		
Total BTEx	<0.300	0.300	04/06/2018	ND						

Surrogate: 4-Bromofluorobenzene (PID) 101 % 72-148

Chloride, SM4500CI-B		mg/kg		Analyzed By: AC						
Analyte	Result	Reporting Limit	Analyzed	Method Blank	BS	% Recovery	True Value QC	RPD	Qualifier	
Chloride	160	16.0	04/06/2018	ND	416	104	400	0.00		

TPH 8015M		mg/kg		Analyzed By: MS					
Analyte	Result	Reporting Limit	Analyzed	Method Blank	BS	% Recovery	True Value QC	RPD	Qualifier
GRO C6-C10*	<10.0	10.0	04/06/2018	ND	213	106	200	2.47	
DRO >C10-C28*	<10.0	10.0	04/06/2018	ND	214	107	200	0.117	
EXT DRO >C28-C36	<10.0	10.0	04/06/2018	ND					

Surrogate: 1-Chlorooctane 80.9 % 41-142

Surrogate: 1-Chlorooctadecane 70.1 % 37.6-147

Cardinal Laboratories

*=Accredited Analyte

PLEASE NOTE: Liability and Damages. Cardinal's liability and client's exclusive remedy for any claim arising, whether based in contract or tort, shall be limited to the amount paid by client for analyses. All claims, including those for negligence and any other cause whatsoever shall be deemed waived unless made in writing and received by Cardinal within thirty (30) days after completion of the applicable service. In no event shall Cardinal be liable for incidental or consequential damages, including, without limitation, business interruptions, loss of use, or loss of profits incurred by client, its subsidiaries, affiliates or successors arising out of or related to the performance of the services hereunder by Cardinal, regardless of whether such claim is based upon any of the above stated reasons or otherwise. Results relate only to the samples identified above. This report shall not be reproduced except in full with written approval of Cardinal Laboratories.



Celey D. Keene, Lab Director/Quality Manager

Notes and Definitions

QM-07	The spike recovery was outside acceptance limits for the MS and/or MSD. The batch was accepted based on acceptable LCS recovery.
ND	Analyte NOT DETECTED at or above the reporting limit
RPD	Relative Percent Difference
**	Samples not received at proper temperature of 6°C or below.
***	Insufficient time to reach temperature.
-	Chloride by SM4500Cl-B does not require samples be received at or below 6°C Samples reported on an as received basis (wet) unless otherwise noted on report

Cardinal Laboratories

*=Accredited Analyte

PLEASE NOTE: Liability and Damages. Cardinal's liability and client's exclusive remedy for any claim arising, whether based in contract or tort, shall be limited to the amount paid by client for analyses. All claims, including those for negligence and any other cause whatsoever shall be deemed waived unless made in writing and received by Cardinal within thirty (30) days after completion of the applicable service. In no event shall Cardinal be liable for incidental or consequential damages, including, without limitation, business interruptions, loss of use, or loss of profits incurred by client, its subsidiaries, affiliates or successors arising out of or related to the performance of the services hereunder by Cardinal, regardless of whether such claim is based upon any of the above stated reasons or otherwise. Results relate only to the samples identified above. This report shall not be reproduced except in full with written approval of Cardinal Laboratories.



Celey D. Keene, Lab Director/Quality Manager



ARDINAL LABORATORIES

101 East Marland, Hobbs, NM 88240 2111 Beechwood, Abilene, TX 79603
(505) 393-2326 FAX (505) 393-2476 (325) 673-7001 FAX (325) 673-7020

RUSH

CHAIN-OF-CUSTODY AND ANALYSIS REQUEST

Company Name: DCP Midstream		P.O. #: 0000420682		ANALYSIS REQUEST	
Project Manager: Yvonne Blair/ Kyle Norman		Company: DCP MIDSTREAM			
Address: 5301 Sierra Vista Dr		Attn: YVONNE BLAIR			
City: Carlsbad		Address: 5301 SIERRA VISTA Dr			
Phone #: 575-361-2406		City: CARLSBAD			
Fax #: 575-361-2406		State: NM Zip: 88220			
Project #: 710001947		Project Owner:			
Project Name: M EXTENSION LINE		State: NM Zip: 88220			
Project Location: F231 F210 F250 F261		Phone #: 575-234-6401			
Sampler Name: Kyle Norman		Fax #:			
FOR LAB USE ONLY		PRESERV		SAMPLING	
Lab I.D. Sample I.D. #800955	(G)RAB OR (C)OMP.	# CONTAINERS			
	GROUNDWATER	WASTEWATER			
	SOIL	OIL			
	SLUDGE	OTHER :			
	ACID/BASE:	ICE / COOL			
	OTHER :	DATE		TIME	
	DATE	TIME			
	DATE	TIME			
	DATE	TIME			
	DATE	TIME			
Chlorides		TPH 8015 M EXT		BTEX	
Texas TPH		Complete Cations/Anions		TDS	

PLEASE NOTE: Liability and Damages. Cardinal's liability and clients exclusive remedy for any claim arising whether based in contract or tort, shall be limited to the amount paid by the client for the analyses. All claims including those for negligence and any other cause whatsoever shall be deemed waived unless made in writing and received by Cardinal within 30 days after completion of the applicable service. In no event shall Cardinal be liable for incidental or consequential damages, including without limitation, business interruptions, loss of use, or loss of profits incurred by client, its subsidiaries, affiliates or successors arising out of or related to the performance of services hereunder by Cardinal, regardless of whether such claim is based upon any of the above stated reasons or otherwise.

Relinquished By: Yvonne Blair Date: 4/6/18 Received By: Yvonne Blair Date: 4/6/18

Relinquished By: Yvonne Blair Date: 4/6/18 Received By: Yvonne Blair Date: 4/6/18

Delivered By: (Circle One) 3.1c Sample Condition ☒ Cool ☐ Intact ☐ Yes ☐ No ☐ Yes ☐ No

Sampler - UPS - Bus - Other: Consolidated 305c CHECKED BY: Yvonne Blair (Initials)

REMARKS: email results: ybblair@dcpmidstream.com
honder@dcpmidstream.com
knorman@tasman-geo.com

Appendix C



New Mexico Office of the State Engineer

Water Column/Average Depth to Water

(A CLW##### in the POD suffix indicates the POD has been replaced & no longer serves a water right file.)

(R=POD has been replaced,
O=orphaned,
C=the file is closed)

(quarters are 1=NW 2=NE 3=SW 4=SE)

(quarters are smallest to largest)

(NAD83 UTM in meters)

(In feet)

POD Number	POD Sub-Code	basin	County	Q 64	Q 16	Q 4	Sec	Tws	Rng	X	Y	Distance	Depth Well	Depth Water	Water Column
CP 00849 POD1	CP	LE		3	1	3	35	18S	31E	608012	3618757*	1987	300		
CP 00829 POD1	CP	LE			2	4	16	19S	31E	606165	3614009*	4187	120		
CP 01554 POD1	CP	LE		2	2	1	22	19S	31E	607166	3613354	4955	400		
CP 01554 POD2	CP	LE		2	2	1	22	19S	31E	607165	3613322	4987	400		
CP 00873 POD1	CP	LE			1	1	19	19S	31E	601772	3613147*	6653	340	180	160
CP 00767 POD1	CP	ED		3	2		35	18S	30E	599300	3619158*	6872	500		

Average Depth to Water: **180 feet**

Minimum Depth: **180 feet**

Maximum Depth: **180 feet**

Record Count: 6

UTMNAD83 Radius Search (in meters):

Easting (X): 606105.11

Northing (Y): 3618195.63

Radius: 7000

*UTM location was derived from PLSS - see Help

The data is furnished by the NMOSE/ISC and is accepted by the recipient with the expressed understanding that the OSE/ISC make no warranties, expressed or implied, concerning the accuracy, completeness, reliability, usability, or suitability for any particular purpose of the data.

Appendix D

DCP Midstream Linam Gathering M Extension Line

1RP-4605



Initial release

1/24/17



Initial release

1/24/17



Scraping soil

1/24/17



Scraping soil

1/24/17



Soil excavated

2/7/17



Vertical at Pt. 3

9/15/17



Excavating vertical at Pt. 3

9/15/17



Excavating vertical at Pt.3

4/5/2018



Excavating vertical Pt. 3

4/5/2018



Excavating north bottom vertical

4/5/2018