



REVIEWED

By CHernandez at 10:39 am, Oct 25, 2018

September 20, 2018

Olivia Yu

NMOCD District 1

1625 N. French Drive

Hobbs, New Mexico 88240

See email
correspondence.

Re: Work Plan

Red Hills Water Management System

NMOCD Reference #: 1RP-5086

Ms. Olivia Yu:

RXSoil, Inc. is pleased to submit the work plan summarizing the on-site remediation of treated water impacted soil at the Red Hills Water Management System located in Lea County, New Mexico. Remediation work plan follows in the attached report.

Sincerely,

A handwritten signature in black ink, appearing to read 'Jace Caraway'.

Jace Caraway
Chief Operating Officer
RXSoil, Inc.
(940) 210-2051

A handwritten signature in black ink, appearing to read 'Zach Robbins'.

Zach Robbins
Technical and Engineering Analyst
RXSoil, Inc.
(210) 400-7645

Table of Contents

I.	Introduction.....	3
II.	Regulatory Guidelines	3
III.	Delineation Report	4
IV.	Soil Remediation Work Plan	4

Figures

1.	Vicinity Map.....	7
2.	Hydrology Map	8
3.	Site Map	9

Appendix

A.	C-141, Release Notification and Corrective Action Documents.....	10
B.	Water Column/Average Depth to Water	12
C.	Delineation Report	
	1. Delineation Summary Table	14
	2. Delineation Laboratory Reports	16

I. Introduction

On behalf of Mewbourne Oil Company (“Mewbourne”), RXSoil, Inc. (“RXSoil”) has prepared this work plan that describes the assessment and action plan for remediation of the release of 1RP-5086.

The release occurred in Unit Letters L&E, Section 6, Township 26S, Range 32E (see *Figure 1* for Vicinity Map) at coordinates (32.07229, -103.71884). The Release Notification and Corrective Action document (C-141, *Appendix A*), approved June 8, 2018, indicates a line failure occurred on June 6, 2018. It was reported that 200 barrels of treated water were released, and 130 barrels were recovered during the initial response. This was reported to have flowed south parallel to the lease road, approximately 750’.

II. Regulatory Guidelines

The New Mexico Office of the State Engineer Water Column/Average Depth to Water lists the depth to water of the closest well (approximately 961’ west of release, shown in *Figure 2*) to be 350’ (See *Appendix B*). Readings on this well have not been reported since October of 2015. All other wells within a 1000-meter radius list depth to water between 155’ and 365’.

Figure 2 displays the location of the release on the NM OCD Oil and Gas Map with Hydrology Layer, with no surface water within a 1000’ radius. The location of release did not occur within areas specified in 19.15.29.12.A.4 NMAC.

The target cleanup levels are determined using *Table I* in 19.15.29 NMAC for depth to groundwater greater than 100 feet are **10** parts per million (ppm) benzene, **50** ppm combined benzene, toluene, ethyl benzene, and total xylenes (BTEX), **1,000** ppm GRO + DRO, **2,500** ppm total petroleum hydrocarbons (TPH) and **20,000** ppm chlorides. The reclamation will contain at least four feet of earthen material with chloride concentrations less than 600 ppm.

As discussed in the later portion of **Section IV**, post-remediation discrete confirmation samples will be taken and properly packaged, preserved and transported to a third-party laboratory by chain of custody, and analyzed for chlorides. The results will be included in the closure report along with chain of custody and quality control.

III. Delineation Report

Based on a spill map and visual evidence, seven borehole locations were selected throughout the affected area. These locations, as well as a spill map, can be seen in *Figure 3*.

RXSoil contracted Atkins Engineering to drill boreholes for vertical delineation. RXSoil had personnel present during the drilling of boreholes to guide delineation. Drilling occurred at each borehole until 10’ of clean soil was discovered, with intervals of depth not exceeding 5’. Samples were field screened for chlorides to guide the delineation activity. Many of the samples were then transported in glass jars on ice to Cardinal Laboratories in Hobbs, NM, to determine the plume of the spill.

One borehole location (BH3) was determined to be in an area too narrow for accurate vertical

delineation. A sample was taken from a depth of 1'. This area is still included in the excavation plan and will be confirmed via sidewall and bottom samples during excavation.

Because zero (0) of the samples tested above thresholds for benzene, BTEX and TPH, RXSoil is requesting no further testing for these contaminants.

Full results from vertical delineation can be found in *Appendix C*. This includes a data summary table, the laboratory reports, and a copy of the digital field notes.

Further horizontal delineation will be completed during excavation and is specified in **Section IV**.

IV. Soil Remediation Work Plan

RXSoil's core process of on-site remediation will be used to address the contamination. RXSoil will supervise all excavation with approval from area utilities owners via NM 811.

RXSoil will construct one in-ground treatment cell to the northeast of the contaminated area. This location has been selected to allow the combination of resources with remediation of release 1RP-5059 (separate Work Plan submitted). Once the final location of the treatment cell has been field verified, District 1 will be notified with coordinates of the four corners. This cell will be excavated to a depth of 4'. A 30-mil poly liner will be installed on the bottom and sides of the cell to contain treatment (to be demarcated on map in Closure Report). A proprietary drainage and collection system will be installed. The background material (not affected by the release) will be staged away from any contaminated material to avoid cross-contamination. The cell is planned to cover an area of 150' by 345'. Final dimensions will be included in the closure report and the area will be demarcated on a map.

Sidewall and bottom samples will be taken for the contaminated area using a stainless-steel hand shovel while remediation samples will be taken using a stainless-steel bucket auger. All tools will be decontaminated before each sample, as specified in *Field Equipment Cleaning and Decontamination* (EPA, 2015). This includes wiping the equipment clean, water-rinsing the equipment, washing the equipment in detergent and water, and rinsing the equipment in water. Samples will be temporarily transferred to a new plastic bag in the field. Once in a location safer for handling glass, the samples will be transferred to glass jars, supplied by an approved laboratory. The threads on all jars will be wiped clean to allow an air-tight seal. Samples will be placed on ice and transferred to a third-party laboratory within an appropriate time period never to exceed 28 days, as recommended in the EPA Method 300.0 handbook. RXSoil will make reasonable efforts to minimize this transfer time.

The affected material will be excavated and placed into the RXSoil treatment cell. Sidewall samples in each cardinal direction will be collected (with samples representing no more than 200 square feet) and transferred to a third-party lab for confirmation (via approved chloride tests) that all affected material has been excavated. Excavation will continue until all sidewall samples are below 600 ppm chlorides (via approved chloride tests) in the top four feet.

Throughout excavation bottom samples will be taken to determine the required excavation depth. Based on delineation data, excavation is planned go to the following depths near the corresponding

borehole locations:

BH1: 4'	BH3: 2'	BH5: 4'	BH7: N/A
BH2: 2'	BH4: 3'	BH6: 3'	

It has been requested by Energy Transfer that excavation remain 15' from the active pipeline that is buried along the easement through the west side of the release. This area is shown in *Figure 3*.

This data was used to project a total volume of 3,225 cubic yards of soil to be remediated.

Vertical excavation will continue until a clean bottom sample is gathered. A clean sample would be **600** ppm chlorides for the top four feet or **20,000** ppm chlorides below that. These samples will be appropriately transferred to a third-party lab for confirmation.

The clean material previously staged will be used to backfill the excavated area. A proprietary delivery system will be installed in the treatment cell to apply RXSoil chemicals for remediation of the soil. RXSoil chemicals and biological agents will go through the profile of the soil before entering the collection system. RXSoil will collect this leachate and properly dispose of it. No subsoil will be exposed to leachate from the treatment cells during remediation. No harmful or hazardous chemicals are used in the RXSoil Process.

Final discrete soil samples will be collected and tested for every 50 cubic yards of treated material at the end of treatment to confirm impacted soil has been remediated to required chloride levels directed by NMOCD standards, as specified in **Section II**. All samples will consist of enough material for at least one (1) field screening and two (2) laboratory tests. A portion of each sample will be field screened and no fewer than 50% of these samples will have a portion transferred to a third-party laboratory for confirmation that all soil passes NMOCD standards for chloride levels. Lab reports and a map with sample points from a GPS device will all be included in the final report.

The current proposed cell dimensions (for combined remediation of 1RP-5059 and 1RP-5086) are approximately 150' by 390' by 4' depth. This cell would hold up to 8,667 cubic yards, requiring no fewer than 174 samples. The planned sample grid will be an evenly spaced grid of 9 columns by 20 rows (180 samples) with samples taken at a depth of 36"-48".

Based on this cell size, 180 samples will be taken with 90 (50% of 180) duplicates being sent to a third-party laboratory for testing. All samples that are collected for lab analysis and not submitted will be preserved for future analysis if required with the understanding that the recommended hold time of 28 days may be exceeded.

If any sample points test for a chloride concentration greater than 600 ppm, RXSoil will continue treatment in that area of the treatment cell. Following re-treatment, samples will be redrawn from any location that initially tested above regulations. This will be done until all sample locations test below threshold. All sample points throughout the project will be GPS located and demarcated on a final sampling map, provided in the closure report.

After completion of the remedial phase of the project a minimum of two composite samples (one from the treatment cell and one from the restored area) will be collected for agricultural analysis (CEC,

SAR, ESP, anions and cations). These results will be provided to an agronomist so that proper soil amendments can be determined to provide for the landowner approved vegetative cover. The amendments and seed will be applied following the remediation project, at the discretion of the landowner.

A closure report summarizing all remediation activities, including scaled maps and all test results stated above, will be submitted upon completion of the project.

Figure 1. Vicinity Map

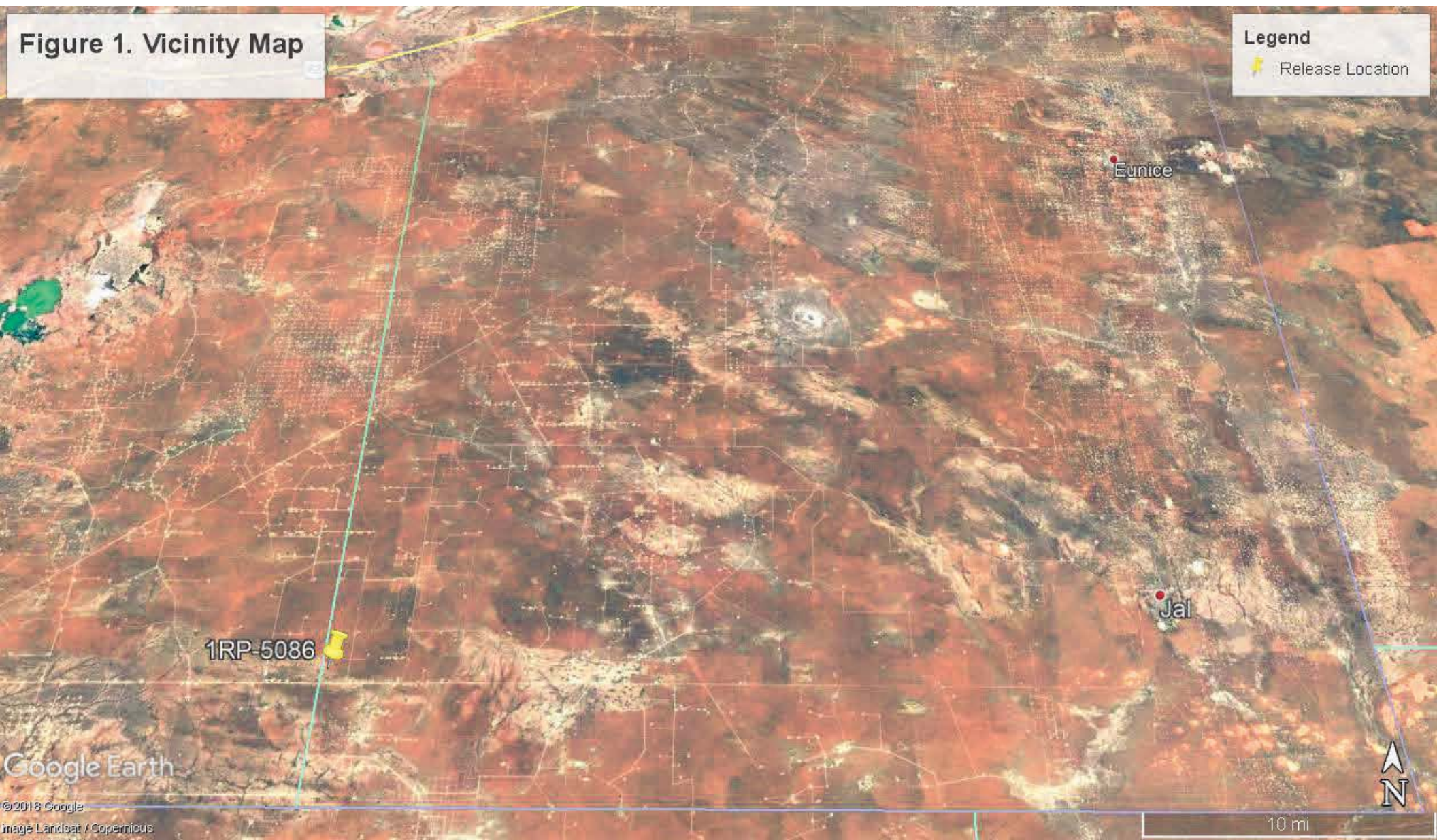
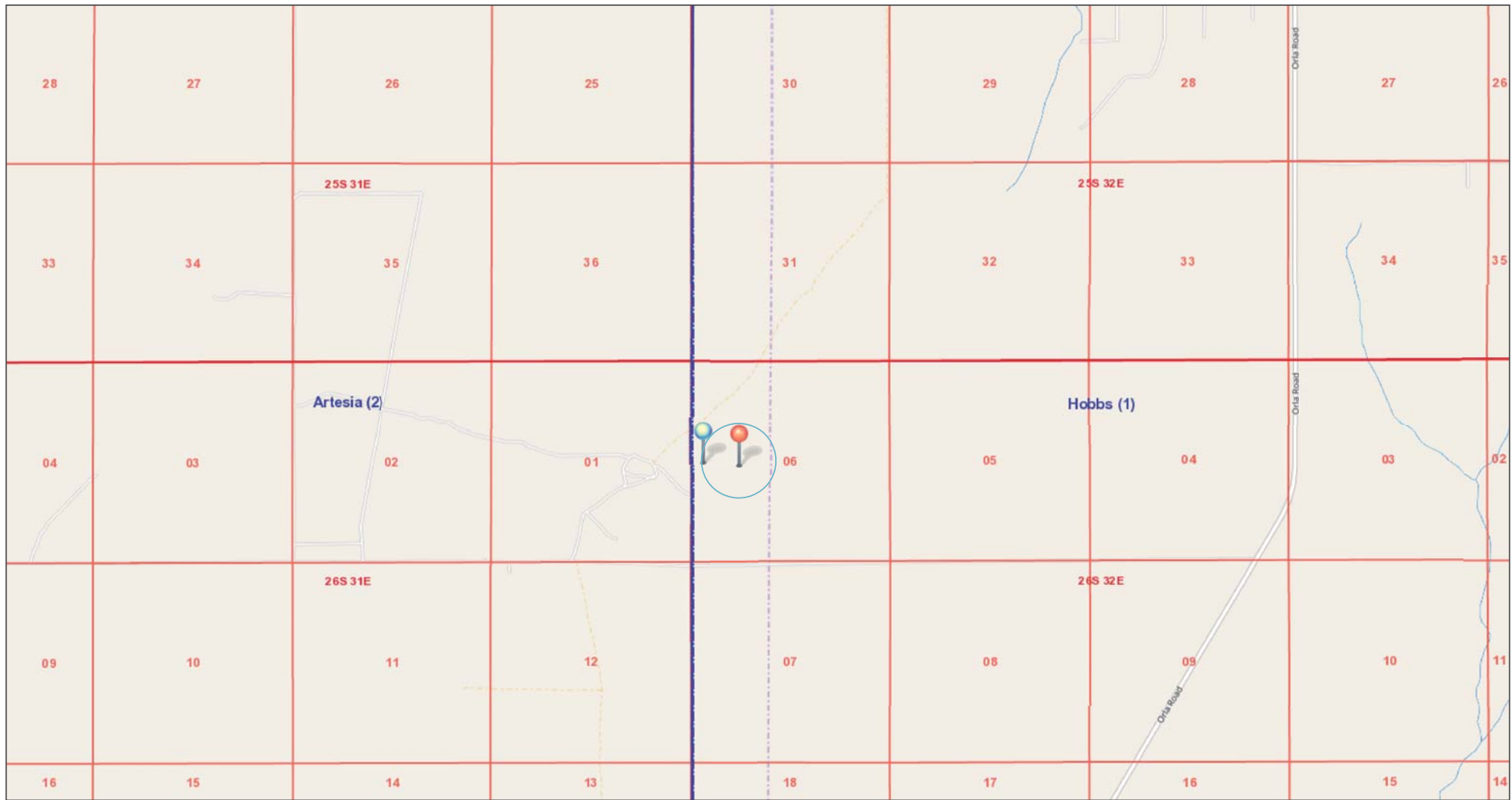
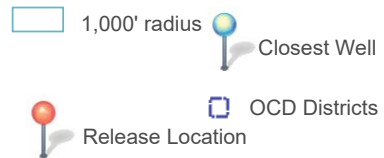

Figure 2. Hydrology Map



9/4/2018, 5:16:00 PM



- ★ OCD District Offices
- PLSS First Division
- PLSS Townships
- OSE Water-bodies
- PLJV Probable Playas
- OSE Streams

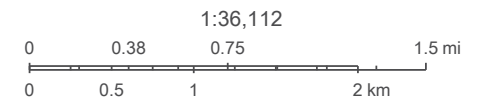

© OpenStreetMap (and) contributors, CC-BY-SA, OCD, BLM

Figure 3. Site Map



APPENDIX A

C-141, RELEASE NOTIFICATION AND CORRECTIVE ACTION DOCUMENT

RXSoil, Inc.

201 Main St. Ste. 1360, Fort Worth, TX 76102

District I
1625 N. French Dr., Hobbs, NM 88240
District II
811 S. First St., Artesia, NM 88210
District III
1000 Rio Brazos Road, Aztec, NM 87410
District IV
1220 S. St. Francis Dr., Santa Fe, NM 87505

State of New Mexico
Energy Minerals and Natural Resources

Form C-141
Revised August 8, 2011

Oil Conservation Division
1220 South St. Francis Dr.
Santa Fe, NM 87505

Submit 1 Copy to appropriate District Office in
accordance with 19.15.29 NMAC.

Release Notification and Corrective Action

OPERATOR

☒ Initial Report ☐ Final Report

Name of Company: Mewbourne Oil Company	Contact: Zack Thomas
Address: PO Box 5270 Hobbs NM 88240	Telephone No. 575-393-5905
Facility Name: Red Hills Water Management System	Facility Type: Water Transfer Line
Surface Owner: Private/BLM	Mineral Owner: BLM API No.

LOCATION OF RELEASE

Unit Letter L &E	Section 6	Township 26S	Range 32E	Feet from the 2600'	North/South Line South	Feet from the 1300'	East/West Line West	County Lea
--------------------------------	--------------	-----------------	--------------	------------------------	---------------------------	------------------------	------------------------	---------------

Latitude 32.072286 Longitude -103.718840

NATURE OF RELEASE

Type of Release: produced water	Volume of Release: 200 bbls	Volume Recovered: 130 bbls recovered
Source of Release: 4 inch Water Transfer Line	Date and Hour of Occurrence 6-6-18	Date and Hour of Discovery 6-6-18 3:30 pm
Was Immediate Notice Given? <input checked="" type="checkbox"/> Yes <input type="checkbox"/> No <input type="checkbox"/> Not Required	If YES, To Whom? Olivia Yu	
By Whom? Zack Thomas	Date and Hour 6-7-18 5:00 pm	
Was a Watercourse Reached? <input type="checkbox"/> Yes <input checked="" type="checkbox"/> No	If YES, Volume Impacting the Watercourse.	

If a Watercourse was Impacted, Describe Fully.*
N/A

RECEIVED

By Olivia Yu at 3:21 pm, Jun 08, 2018



Describe Cause of Problem and Remedial Action Taken.*

Line failure. Shut valves on both ends of the line to isolate failure point.

Describe Area Affected and Cleanup Action Taken.*

Affected area- Release flowed South parallel to lease road an estimated 750 feet.

I hereby certify that the information given above is true and complete to the best of my knowledge and understand that pursuant to NMOCD rules and regulations all operators are required to report and/or file certain release notifications and perform corrective actions for releases which may endanger public health or the environment. The acceptance of a C-141 report by the NMOCD marked as "Final Report" does not relieve the operator of liability should their operations have failed to adequately investigate and remediate contamination that pose a threat to ground water, surface water, human health or the environment. In addition, NMOCD acceptance of a C-141 report does not relieve the operator of responsibility for compliance with any other federal, state, or local laws and/or regulations.

Signature: 	OIL CONSERVATION DIVISION	
Printed Name: Zack Thomas	Approved by Environmental Specialist: 	
Title: Environmental Rep.	Approval Date: 6/8/2018	Expiration Date:
E-mail Address: zthomas@mewbourne.com	Conditions of Approval:	Attached <input checked="" type="checkbox"/>
Date: 6-7-18 Phone: 575-602-2188	see attached directive	

fOY1815955571

1RP-5086

nOY1815955832

pOY1815956053

APPENDIX B

WATER COLUMN/AVERAGE DEPTH TO WATER



(A CLW##### in the POD suffix indicates the POD has been replaced & no longer serves a water right file.)







(R=POD has been replaced,
O=orphaned,
C=the file is closed)

(quarters are 1=NW 2=NE 3=SW 4=SE)

(quarters are smallest to largest)

(NAD83 UTM in meters)

(In feet)

POD Number	Code	POD Sub-basin	County	Q Q Q							X	Y	Distance	Depth	Well	Depth	Water	
		64		16	4	Sec	Tws	Rng	Column									
C_03829 POD1		CUB	LE	3	3	1	06	26S	32E	620628	3549186		293	646		350	296	
C_03554 POD1		CUB	ED	2	1	4	01	26S	31E	620547	3549148		374	630		300	330	
C_04209 POD2		C	LE	2	3	3	06	26S	32E	620818	3548657		519	340		155	185	
C_04256 POD1		C	ED	4	4	2	01	26S	31E	620384	3549257		545	666		340	326	
C_04209 POD1		CUB	LE	2	3	3	06	26S	32E	620903	3548619		546	360		155	205	
C_03639 POD1		CUB	ED	3	4	2	01	26S	31E	620168	3549279		762	700		365	335	
C_02090		C	ED		4	4	01	26S	31E	620329	3548533*		867	350		335	15	

Average Depth to Water: 285 feet

Minimum Depth: **155 feet**

Maximum Depth: **365 feet**

Record Count: 7

UTMNAD83 Radius Search (in meters):

Easting (X): 620921.8

Northing (Y): 3549166

Radius: 1000

***UTM location was derived from PLSS - see Help**

The data is furnished by the NMOSE/ISC and is accepted by the recipient with the expressed understanding that the OSE/ISC make no warranties, expressed or implied, concerning the accuracy, completeness, reliability, usability, or suitability for any particular purpose of the data.

8/28/18 3:48 PM

WATER COLUMN/ AVERAGE DEPTH TO WATER

APPENDIX C.1

DELINEATION REPORT

DELINEATION SUMMARY TABLE

Delineation Data: 1RP-5086							
Sample Date: 08/22/2018			Reported Date: 08/28/2018		Laboratory: Cardinal Laboratories		
Borehole	Depth (ft)	Lab ID Sample	Chloride		Benzene	BTEX	TPH
			Field Screening	Method 4500	8021B		8015M
1	1	BH1-1'	4540	5,440	<0.050	<0.300	<30
1	2	BH1-2'	1568	-	-	-	-
1	3	BH1-3'	1040	-	-	-	-
1	4	BH1-4'	ND	80	<0.050	<0.300	<30
1	9	BH1-9'	ND	-	-	-	-
1	14	BH1-14'	ND	32	-	-	-
2	1	BH2-1'	660	768	<0.050	<0.300	<30
2	2	BH2-2'	332	464	<0.050	<0.300	<30
2	3	BH2-3'	168	-	-	-	-
2	4	BH2-4'	ND	16.0	-	-	-
2	9	BH2-9'	ND	-	-	-	-
2	14	BH2-14'	ND	80.0	-	-	-
3A	1	BH3A-1'	-	1,310	<0.050	<0.300	358
3B	1	BH3B-1'	-	2,200	<0.050	<0.300	2267
4	1	BH4-1'	3500	3,280	<0.050	<0.300	75
4	2	BH4-2'	4540	5,120	<0.050	<0.300	<30
4	3	BH4-3'	256	256	<0.050	<0.300	<30
4	4	BH4-4'	ND	64.0	<0.050	<0.300	<30
4	9	BH4-9'	256	-	-	-	-
4	14	BH4-14'	ND	80.0	-	-	-
5	1	BH5-1'	4940	5,440	<0.050	<0.300	<30
5	2	BH5-2'	1756	-	-	-	-
5	3	BH5-3'	2176	-	-	-	-
5	4	BH5-4'	ND	80.0	<0.050	<0.300	<30
5	9	BH5-9'	ND	-	-	-	-
5	14	BH5-14'	ND	16.0	-	-	-
6	1	BH6-1'	704	560	<0.050	<0.300	155
6	2	BH6-2'	1780	2,320	<0.050	<0.300	179
6	3	BH6-3'	588	592	<0.050	<0.300	<30
6	4	BH6-4'	ND	256	<0.050	<0.300	<30
6	9	BH6-9'	ND	-	-	-	-
6	14	BH6-14'	ND	<16.0	-	-	-
7	1	BH7-1'	536	464	<0.050	<0.300	105
7	2	BH7-2'	588	496	<0.050	<0.300	107
7	3	BH7-3'	344	432	<0.050	<0.300	631
7	8	BH7-8'	ND	-	-	-	-
7	13	BH7-13'	ND	32.0	-	-	-
NMOC thresholds			600	10	50	5000	

BOLD results indicate results above RRAL

- indicates tests were not ran

ND represents a non-detectable amount

APPENDIX C.2

DELINEATION REPORT

DELINEATION LABORATORY REPORT

RXSoil, Inc.

201 Main St. Ste. 1360, Fort Worth, TX 76102

August 28, 2018

ZACH THOMAS

RX-SOIL INC.

201 MAIN STREET, SUITE 1360

FORT WORTH, TX 76102

RE: MB #5

Enclosed are the results of analyses for samples received by the laboratory on 08/23/18 11:40.

Cardinal Laboratories is accredited through Texas NELAP under certificate number T104704398-18-11. Accreditation applies to drinking water, non-potable water and solid and chemical materials. All accredited analytes are denoted by an asterisk (*). For a complete list of accredited analytes and matrices visit the TCEQ website at www.tceq.texas.gov/field/qa/lab_accred_certif.html.

Cardinal Laboratories is accredited through the State of Colorado Department of Public Health and Environment for:

Method EPA 552.2	Haloacetic Acids (HAA-5)
Method EPA 524.2	Total Trihalomethanes (TTHM)
Method EPA 524.4	Regulated VOCs (V1, V2, V3)

Accreditation applies to public drinking water matrices.

This report meets NELAP requirements and is made up of a cover page, analytical results, and a copy of the original chain-of-custody. If you have any questions concerning this report, please feel free to contact me.

Sincerely,



Celey D. Keene

Lab Director/Quality Manager

Analytical Results For:

RX-SOIL INC.
ZACH THOMAS
201 MAIN STREET, SUITE 1360
FORT WORTH TX, 76102
Fax To: NA

Received: 08/23/2018
Reported: 08/28/2018
Project Name: MB #5
Project Number: NONE GIVEN
Project Location: NOT GIVEN

Sampling Date: 08/22/2018
Sampling Type: Soil
Sampling Condition: Cool & Intact
Sample Received By: Tamara Oldaker

Sample ID: BH1 - 1' (H802359-01)

BTEX 8021B		mg/kg		Analyzed By: ms					
Analyte	Result	Reporting Limit	Analyzed	Method Blank	BS	% Recovery	True Value QC	RPD	Qualifier
Benzene*	<0.050	0.050	08/24/2018	ND	1.90	95.0	2.00	1.48	
Toluene*	<0.050	0.050	08/24/2018	ND	1.83	91.4	2.00	1.15	
Ethylbenzene*	<0.050	0.050	08/24/2018	ND	1.85	92.6	2.00	1.44	
Total Xylenes*	<0.150	0.150	08/24/2018	ND	5.54	92.4	6.00	1.28	
Total BTEX	<0.300	0.300	08/24/2018	ND					

Surrogate: 4-Bromofluorobenzene (PID) 89.8 % 69.8-142

Chloride, SM4500Cl-B		mg/kg		Analyzed By: AC					
Analyte	Result	Reporting Limit	Analyzed	Method Blank	BS	% Recovery	True Value QC	RPD	Qualifier
Chloride	5440	16.0	08/28/2018	ND	416	104	400	0.00	

TPH 8015M		mg/kg		Analyzed By: MS					
Analyte	Result	Reporting Limit	Analyzed	Method Blank	BS	% Recovery	True Value QC	RPD	Qualifier
GRO C6-C10*	<10.0	10.0	08/24/2018	ND	219	109	200	0.105	
DRO >C10-C28*	<10.0	10.0	08/24/2018	ND	225	112	200	0.332	
EXT DRO >C28-C36	<10.0	10.0	08/24/2018	ND					

Surrogate: 1-Chlorooctane 89.2 % 41-142

Surrogate: 1-Chlorooctadecane 85.4 % 37.6-147

Cardinal Laboratories

*=Accredited Analyte

PLEASE NOTE: Liability and Damages. Cardinal's liability and client's exclusive remedy for any claim arising, whether based in contract or tort, shall be limited to the amount paid by client for analyses. All claims, including those for negligence and any other cause whatsoever shall be deemed waived unless made in writing and received by Cardinal within thirty (30) days after completion of the applicable service. In no event shall Cardinal be liable for incidental or consequential damages, including, without limitation, business interruptions, loss of use, or loss of profits incurred by client, its subsidiaries, affiliates or successors arising out of or related to the performance of the services hereunder by Cardinal, regardless of whether such claim is based upon any of the above stated reasons or otherwise. Results relate only to the samples identified above. This report shall not be reproduced except in full with written approval of Cardinal Laboratories.



Celey D. Keene, Lab Director/Quality Manager

Analytical Results For:

RX-SOIL INC.
ZACH THOMAS
201 MAIN STREET, SUITE 1360
FORT WORTH TX, 76102
Fax To: NA

Received: 08/23/2018
Reported: 08/28/2018
Project Name: MB #5
Project Number: NONE GIVEN
Project Location: NOT GIVEN

Sampling Date: 08/22/2018
Sampling Type: Soil
Sampling Condition: Cool & Intact
Sample Received By: Tamara Oldaker

Sample ID: BH1 - 4' (H802359-02)

BTEx 8021B		mg/kg		Analyzed By: ms					
Analyte	Result	Reporting Limit	Analyzed	Method Blank	BS	% Recovery	True Value QC	RPD	Qualifier
Benzene*	<0.050	0.050	08/24/2018	ND	1.90	95.0	2.00	1.48	
Toluene*	<0.050	0.050	08/24/2018	ND	1.83	91.4	2.00	1.15	
Ethylbenzene*	<0.050	0.050	08/24/2018	ND	1.85	92.6	2.00	1.44	
Total Xylenes*	<0.150	0.150	08/24/2018	ND	5.54	92.4	6.00	1.28	
Total BTEX	<0.300	0.300	08/24/2018	ND					

Surrogate: 4-Bromofluorobenzene (PID) 97.6 % 69.8-142

Chloride, SM4500Cl-B		mg/kg		Analyzed By: AC					
Analyte	Result	Reporting Limit	Analyzed	Method Blank	BS	% Recovery	True Value QC	RPD	Qualifier
Chloride	80.0	16.0	08/28/2018	ND	416	104	400	0.00	

TPH 8015M		mg/kg		Analyzed By: MS					
Analyte	Result	Reporting Limit	Analyzed	Method Blank	BS	% Recovery	True Value QC	RPD	Qualifier
GRO C6-C10*	<10.0	10.0	08/24/2018	ND	219	109	200	0.105	
DRO >C10-C28*	<10.0	10.0	08/24/2018	ND	225	112	200	0.332	
EXT DRO >C28-C36	<10.0	10.0	08/24/2018	ND					

Surrogate: 1-Chlorooctane 82.5 % 41-142

Surrogate: 1-Chlorooctadecane 80.2 % 37.6-147

Cardinal Laboratories

*=Accredited Analyte

PLEASE NOTE: Liability and Damages. Cardinal's liability and client's exclusive remedy for any claim arising, whether based in contract or tort, shall be limited to the amount paid by client for analyses. All claims, including those for negligence and any other cause whatsoever shall be deemed waived unless made in writing and received by Cardinal within thirty (30) days after completion of the applicable service. In no event shall Cardinal be liable for incidental or consequential damages, including, without limitation, business interruptions, loss of use, or loss of profits incurred by client, its subsidiaries, affiliates or successors arising out of or related to the performance of the services hereunder by Cardinal, regardless of whether such claim is based upon any of the above stated reasons or otherwise. Results relate only to the samples identified above. This report shall not be reproduced except in full with written approval of Cardinal Laboratories.



Celey D. Keene, Lab Director/Quality Manager

Analytical Results For:

RX-SOIL INC.
ZACH THOMAS
201 MAIN STREET, SUITE 1360
FORT WORTH TX, 76102
Fax To: NA

Received: 08/23/2018
Reported: 08/28/2018
Project Name: MB #5
Project Number: NONE GIVEN
Project Location: NOT GIVEN

Sampling Date: 08/22/2018
Sampling Type: Soil
Sampling Condition: Cool & Intact
Sample Received By: Tamara Oldaker

Sample ID: BH1 - 14' (H802359-03)

Chloride, SM4500Cl-B		mg/kg		Analyzed By: AC						
Analyte	Result	Reporting Limit	Analyzed	Method Blank	BS	% Recovery	True Value QC	RPD	Qualifier	
Chloride	32.0	16.0	08/28/2018	ND	416	104	400	0.00		

Cardinal Laboratories

*=Accredited Analyte

PLEASE NOTE: Liability and Damages. Cardinal's liability and client's exclusive remedy for any claim arising, whether based in contract or tort, shall be limited to the amount paid by client for analyses. All claims, including those for negligence and any other cause whatsoever shall be deemed waived unless made in writing and received by Cardinal within thirty (30) days after completion of the applicable service. In no event shall Cardinal be liable for incidental or consequential damages, including, without limitation, business interruptions, loss of use, or loss of profits incurred by client, its subsidiaries, affiliates or successors arising out of or related to the performance of the services hereunder by Cardinal, regardless of whether such claim is based upon any of the above stated reasons or otherwise. Results relate only to the samples identified above. This report shall not be reproduced except in full with written approval of Cardinal Laboratories.



Celey D. Keene, Lab Director/Quality Manager

Analytical Results For:

 RX-SOIL INC.
 ZACH THOMAS
 201 MAIN STREET, SUITE 1360
 FORT WORTH TX, 76102
 Fax To: NA

 Received: 08/23/2018
 Reported: 08/28/2018
 Project Name: MB #5
 Project Number: NONE GIVEN
 Project Location: NOT GIVEN

 Sampling Date: 08/22/2018
 Sampling Type: Soil
 Sampling Condition: Cool & Intact
 Sample Received By: Tamara Oldaker

Sample ID: BH2 - 1' (H802359-04)

BTX 8021B		mg/kg		Analyzed By: ms					
Analyte	Result	Reporting Limit	Analyzed	Method Blank	BS	% Recovery	True Value QC	RPD	Qualifier
Benzene*	<0.050	0.050	08/25/2018	ND	1.90	95.0	2.00	1.48	
Toluene*	<0.050	0.050	08/25/2018	ND	1.83	91.4	2.00	1.15	
Ethylbenzene*	<0.050	0.050	08/25/2018	ND	1.85	92.6	2.00	1.44	
Total Xylenes*	<0.150	0.150	08/25/2018	ND	5.54	92.4	6.00	1.28	
Total BTX	<0.300	0.300	08/25/2018	ND					

Surrogate: 4-Bromofluorobenzene (PID) 95.8 % 69.8-142

Chloride, SM4500CI-B		mg/kg		Analyzed By: AC					
Analyte	Result	Reporting Limit	Analyzed	Method Blank	BS	% Recovery	True Value QC	RPD	Qualifier
Chloride	768	16.0	08/28/2018	ND	416	104	400	0.00	

TPH 8015M		mg/kg		Analyzed By: MS					
Analyte	Result	Reporting Limit	Analyzed	Method Blank	BS	% Recovery	True Value QC	RPD	Qualifier
GRO C6-C10*	<10.0	10.0	08/24/2018	ND	219	109	200	0.105	
DRO >C10-C28*	<10.0	10.0	08/24/2018	ND	225	112	200	0.332	
EXT DRO >C28-C36	<10.0	10.0	08/24/2018	ND					

Surrogate: 1-Chlorooctane 99.7 % 41-142

Surrogate: 1-Chlorooctadecane 97.3 % 37.6-147

Cardinal Laboratories

*=Accredited Analyte

PLEASE NOTE: Liability and Damages. Cardinal's liability and client's exclusive remedy for any claim arising, whether based in contract or tort, shall be limited to the amount paid by client for analyses. All claims, including those for negligence and any other cause whatsoever shall be deemed waived unless made in writing and received by Cardinal within thirty (30) days after completion of the applicable service. In no event shall Cardinal be liable for incidental or consequential damages, including, without limitation, business interruptions, loss of use, or loss of profits incurred by client, its subsidiaries, affiliates or successors arising out of or related to the performance of the services hereunder by Cardinal, regardless of whether such claim is based upon any of the above stated reasons or otherwise. Results relate only to the samples identified above. This report shall not be reproduced except in full with written approval of Cardinal Laboratories.



Celey D. Keene, Lab Director/Quality Manager

Analytical Results For:

RX-SOIL INC.
ZACH THOMAS
201 MAIN STREET, SUITE 1360
FORT WORTH TX, 76102
Fax To: NA

Received: 08/23/2018
Reported: 08/28/2018
Project Name: MB #5
Project Number: NONE GIVEN
Project Location: NOT GIVEN

Sampling Date: 08/22/2018
Sampling Type: Soil
Sampling Condition: Cool & Intact
Sample Received By: Tamara Oldaker

Sample ID: BH2 - 2' (H802359-05)

BTX 8021B		mg/kg		Analyzed By: ms					
Analyte	Result	Reporting Limit	Analyzed	Method Blank	BS	% Recovery	True Value QC	RPD	Qualifier
Benzene*	<0.050	0.050	08/25/2018	ND	1.90	95.0	2.00	1.48	
Toluene*	<0.050	0.050	08/25/2018	ND	1.83	91.4	2.00	1.15	
Ethylbenzene*	<0.050	0.050	08/25/2018	ND	1.85	92.6	2.00	1.44	
Total Xylenes*	<0.150	0.150	08/25/2018	ND	5.54	92.4	6.00	1.28	
Total BTX	<0.300	0.300	08/25/2018	ND					

Surrogate: 4-Bromofluorobenzene (PID) 96.8 % 69.8-142

Chloride, SM4500CI-B		mg/kg		Analyzed By: AC					
Analyte	Result	Reporting Limit	Analyzed	Method Blank	BS	% Recovery	True Value QC	RPD	Qualifier
Chloride	464	16.0	08/28/2018	ND	416	104	400	0.00	

TPH 8015M		mg/kg		Analyzed By: MS					
Analyte	Result	Reporting Limit	Analyzed	Method Blank	BS	% Recovery	True Value QC	RPD	Qualifier
GRO C6-C10*	<10.0	10.0	08/24/2018	ND	219	109	200	0.105	
DRO >C10-C28*	<10.0	10.0	08/24/2018	ND	225	112	200	0.332	
EXT DRO >C28-C36	<10.0	10.0	08/24/2018	ND					

Surrogate: 1-Chlorooctane 71.4 % 41-142

Surrogate: 1-Chlorooctadecane 68.6 % 37.6-147

Cardinal Laboratories

*=Accredited Analyte

PLEASE NOTE: Liability and Damages. Cardinal's liability and client's exclusive remedy for any claim arising, whether based in contract or tort, shall be limited to the amount paid by client for analyses. All claims, including those for negligence and any other cause whatsoever shall be deemed waived unless made in writing and received by Cardinal within thirty (30) days after completion of the applicable service. In no event shall Cardinal be liable for incidental or consequential damages, including, without limitation, business interruptions, loss of use, or loss of profits incurred by client, its subsidiaries, affiliates or successors arising out of or related to the performance of the services hereunder by Cardinal, regardless of whether such claim is based upon any of the above stated reasons or otherwise. Results relate only to the samples identified above. This report shall not be reproduced except in full with written approval of Cardinal Laboratories.



Celey D. Keene, Lab Director/Quality Manager

Analytical Results For:

RX-SOIL INC.
ZACH THOMAS
201 MAIN STREET, SUITE 1360
FORT WORTH TX, 76102
Fax To: NA

Received: 08/23/2018
Reported: 08/28/2018
Project Name: MB #5
Project Number: NONE GIVEN
Project Location: NOT GIVEN

Sampling Date: 08/22/2018
Sampling Type: Soil
Sampling Condition: Cool & Intact
Sample Received By: Tamara Oldaker

Sample ID: BH2 - 4' (H802359-06)

Chloride, SM4500Cl-B		mg/kg		Analyzed By: AC						
Analyte	Result	Reporting Limit	Analyzed	Method Blank	BS	% Recovery	True Value QC	RPD	Qualifier	
Chloride	<16.0	16.0	08/28/2018	ND	416	104	400	0.00		

Sample ID: BH2 - 14' (H802359-07)

Chloride, SM4500Cl-B		mg/kg		Analyzed By: AC					
Analyte	Result	Reporting Limit	Analyzed	Method Blank	BS	% Recovery	True Value QC	RPD	Qualifier
Chloride	80.0	16.0	08/28/2018	ND	416	104	400	0.00	

Cardinal Laboratories

*=Accredited Analyte

PLEASE NOTE: Liability and Damages. Cardinal's liability and client's exclusive remedy for any claim arising, whether based in contract or tort, shall be limited to the amount paid by client for analyses. All claims, including those for negligence and any other cause whatsoever shall be deemed waived unless made in writing and received by Cardinal within thirty (30) days after completion of the applicable service. In no event shall Cardinal be liable for incidental or consequential damages, including, without limitation, business interruptions, loss of use, or loss of profits incurred by client, its subsidiaries, affiliates or successors arising out of or related to the performance of the services hereunder by Cardinal, regardless of whether such claim is based upon any of the above stated reasons or otherwise. Results relate only to the samples identified above. This report shall not be reproduced except in full with written approval of Cardinal Laboratories.



Celey D. Keene, Lab Director/Quality Manager

Analytical Results For:

RX-SOIL INC.
ZACH THOMAS
201 MAIN STREET, SUITE 1360
FORT WORTH TX, 76102
Fax To: NA

Received: 08/23/2018
Reported: 08/28/2018
Project Name: MB #5
Project Number: NONE GIVEN
Project Location: NOT GIVEN

Sampling Date: 08/22/2018
Sampling Type: Soil
Sampling Condition: Cool & Intact
Sample Received By: Tamara Oldaker

Sample ID: BH3A - 1' (H802359-08)

BTX 8021B		mg/kg		Analyzed By: ms					
Analyte	Result	Reporting Limit	Analyzed	Method Blank	BS	% Recovery	True Value QC	RPD	Qualifier
Benzene*	<0.050	0.050	08/25/2018	ND	1.90	95.0	2.00	1.48	
Toluene*	<0.050	0.050	08/25/2018	ND	1.83	91.4	2.00	1.15	
Ethylbenzene*	<0.050	0.050	08/25/2018	ND	1.85	92.6	2.00	1.44	
Total Xylenes*	<0.150	0.150	08/25/2018	ND	5.54	92.4	6.00	1.28	
Total BTX	<0.300	0.300	08/25/2018	ND					

Surrogate: 4-Bromofluorobenzene (PID) 93.6 % 69.8-142

Chloride, SM4500Cl-B		mg/kg		Analyzed By: AC					
Analyte	Result	Reporting Limit	Analyzed	Method Blank	BS	% Recovery	True Value QC	RPD	Qualifier
Chloride	1310	16.0	08/28/2018	ND	416	104	400	0.00	

TPH 8015M		mg/kg		Analyzed By: MS					
Analyte	Result	Reporting Limit	Analyzed	Method Blank	BS	% Recovery	True Value QC	RPD	Qualifier
GRO C6-C10*	<10.0	10.0	08/24/2018	ND	219	109	200	0.105	
DRO >C10-C28*	288	10.0	08/24/2018	ND	225	112	200	0.332	
EXT DRO >C28-C36	70.0	10.0	08/24/2018	ND					

Surrogate: 1-Chlorooctane 83.6 % 41-142

Surrogate: 1-Chlorooctadecane 99.7 % 37.6-147

Cardinal Laboratories

*=Accredited Analyte

PLEASE NOTE: Liability and Damages. Cardinal's liability and client's exclusive remedy for any claim arising, whether based in contract or tort, shall be limited to the amount paid by client for analyses. All claims, including those for negligence and any other cause whatsoever shall be deemed waived unless made in writing and received by Cardinal within thirty (30) days after completion of the applicable service. In no event shall Cardinal be liable for incidental or consequential damages, including, without limitation, business interruptions, loss of use, or loss of profits incurred by client, its subsidiaries, affiliates or successors arising out of or related to the performance of the services hereunder by Cardinal, regardless of whether such claim is based upon any of the above stated reasons or otherwise. Results relate only to the samples identified above. This report shall not be reproduced except in full with written approval of Cardinal Laboratories.



Celey D. Keene, Lab Director/Quality Manager

Analytical Results For:

RX-SOIL INC.
ZACH THOMAS
201 MAIN STREET, SUITE 1360
FORT WORTH TX, 76102
Fax To: NA

Received: 08/23/2018
Reported: 08/28/2018
Project Name: MB #5
Project Number: NONE GIVEN
Project Location: NOT GIVEN

Sampling Date: 08/22/2018
Sampling Type: Soil
Sampling Condition: Cool & Intact
Sample Received By: Tamara Oldaker

Sample ID: BH3B - 1' (H802359-09)

BTX 8021B		mg/kg		Analyzed By: ms					
Analyte	Result	Reporting Limit	Analyzed	Method Blank	BS	% Recovery	True Value QC	RPD	Qualifier
Benzene*	<0.050	0.050	08/25/2018	ND	1.90	95.0	2.00	1.48	
Toluene*	<0.050	0.050	08/25/2018	ND	1.83	91.4	2.00	1.15	
Ethylbenzene*	<0.050	0.050	08/25/2018	ND	1.85	92.6	2.00	1.44	
Total Xylenes*	<0.150	0.150	08/25/2018	ND	5.54	92.4	6.00	1.28	
Total BTX	<0.300	0.300	08/25/2018	ND					

Surrogate: 4-Bromofluorobenzene (PID) 96.7 % 69.8-142

Chloride, SM4500Cl-B		mg/kg		Analyzed By: AC						
Analyte	Result	Reporting Limit	Analyzed	Method Blank	BS	% Recovery	True Value QC	RPD	Qualifier	
Chloride	2200	16.0	08/28/2018	ND	448	112	400	7.41	QM-07	

TPH 8015M		mg/kg		Analyzed By: MS				S-04	
Analyte	Result	Reporting Limit	Analyzed	Method Blank	BS	% Recovery	True Value QC	RPD	Qualifier
GRO C6-C10*	<10.0	10.0	08/24/2018	ND	215	108	200	1.37	
DRO >C10-C28*	1710	10.0	08/24/2018	ND	224	112	200	1.61	QM-07
EXT DRO >C28-C36	557	10.0	08/24/2018	ND					

Surrogate: 1-Chlorooctane 96.1 % 41-142

Surrogate: 1-Chlorooctadecane 193 % 37.6-147

Cardinal Laboratories

*=Accredited Analyte

PLEASE NOTE: Liability and Damages. Cardinal's liability and client's exclusive remedy for any claim arising, whether based in contract or tort, shall be limited to the amount paid by client for analyses. All claims, including those for negligence and any other cause whatsoever shall be deemed waived unless made in writing and received by Cardinal within thirty (30) days after completion of the applicable service. In no event shall Cardinal be liable for incidental or consequential damages, including, without limitation, business interruptions, loss of use, or loss of profits incurred by client, its subsidiaries, affiliates or successors arising out of or related to the performance of the services hereunder by Cardinal, regardless of whether such claim is based upon any of the above stated reasons or otherwise. Results relate only to the samples identified above. This report shall not be reproduced except in full with written approval of Cardinal Laboratories.



Celey D. Keene, Lab Director/Quality Manager

Analytical Results For:

RX-SOIL INC.
ZACH THOMAS
201 MAIN STREET, SUITE 1360
FORT WORTH TX, 76102
Fax To: NA

Received: 08/23/2018
Reported: 08/28/2018
Project Name: MB #5
Project Number: NONE GIVEN
Project Location: NOT GIVEN

Sampling Date: 08/22/2018
Sampling Type: Soil
Sampling Condition: Cool & Intact
Sample Received By: Tamara Oldaker

Sample ID: BH4 - 1' (H802359-10)

BTX 8021B		mg/kg		Analyzed By: ms					
Analyte	Result	Reporting Limit	Analyzed	Method Blank	BS	% Recovery	True Value QC	RPD	Qualifier
Benzene*	<0.050	0.050	08/25/2018	ND	1.90	95.0	2.00	1.48	
Toluene*	<0.050	0.050	08/25/2018	ND	1.83	91.4	2.00	1.15	
Ethylbenzene*	<0.050	0.050	08/25/2018	ND	1.85	92.6	2.00	1.44	
Total Xylenes*	<0.150	0.150	08/25/2018	ND	5.54	92.4	6.00	1.28	
Total BTX	<0.300	0.300	08/25/2018	ND					

Surrogate: 4-Bromofluorobenzene (PID) 98.0 % 69.8-142

Chloride, SM4500Cl-B		mg/kg		Analyzed By: AC						
Analyte	Result	Reporting Limit	Analyzed	Method Blank	BS	% Recovery	True Value QC	RPD	Qualifier	
Chloride	3280	16.0	08/28/2018	ND	448	112	400	7.41		

TPH 8015M		mg/kg		Analyzed By: MS					
Analyte	Result	Reporting Limit	Analyzed	Method Blank	BS	% Recovery	True Value QC	RPD	Qualifier
GRO C6-C10*	<10.0	10.0	08/24/2018	ND	215	108	200	1.37	
DRO >C10-C28*	52.3	10.0	08/24/2018	ND	224	112	200	1.61	
EXT DRO >C28-C36	22.7	10.0	08/24/2018	ND					

Surrogate: 1-Chlorooctane 100 % 41-142

Surrogate: 1-Chlorooctadecane 98.7 % 37.6-147

Cardinal Laboratories

*=Accredited Analyte

PLEASE NOTE: Liability and Damages. Cardinal's liability and client's exclusive remedy for any claim arising, whether based in contract or tort, shall be limited to the amount paid by client for analyses. All claims, including those for negligence and any other cause whatsoever shall be deemed waived unless made in writing and received by Cardinal within thirty (30) days after completion of the applicable service. In no event shall Cardinal be liable for incidental or consequential damages, including, without limitation, business interruptions, loss of use, or loss of profits incurred by client, its subsidiaries, affiliates or successors arising out of or related to the performance of the services hereunder by Cardinal, regardless of whether such claim is based upon any of the above stated reasons or otherwise. Results relate only to the samples identified above. This report shall not be reproduced except in full with written approval of Cardinal Laboratories.



Celey D. Keene, Lab Director/Quality Manager

Analytical Results For:

 RX-SOIL INC.
 ZACH THOMAS
 201 MAIN STREET, SUITE 1360
 FORT WORTH TX, 76102
 Fax To: NA

 Received: 08/23/2018
 Reported: 08/28/2018
 Project Name: MB #5
 Project Number: NONE GIVEN
 Project Location: NOT GIVEN

 Sampling Date: 08/22/2018
 Sampling Type: Soil
 Sampling Condition: Cool & Intact
 Sample Received By: Tamara Oldaker

Sample ID: BH4 - 2' (H802359-11)

BTX 8021B		mg/kg		Analyzed By: ms					
Analyte	Result	Reporting Limit	Analyzed	Method Blank	BS	% Recovery	True Value QC	RPD	Qualifier
Benzene*	<0.050	0.050	08/25/2018	ND	1.90	95.0	2.00	1.48	
Toluene*	<0.050	0.050	08/25/2018	ND	1.83	91.4	2.00	1.15	
Ethylbenzene*	<0.050	0.050	08/25/2018	ND	1.85	92.6	2.00	1.44	
Total Xylenes*	<0.150	0.150	08/25/2018	ND	5.54	92.4	6.00	1.28	
Total BTX	<0.300	0.300	08/25/2018	ND					

Surrogate: 4-Bromofluorobenzene (PID) 96.2 % 69.8-142

Chloride, SM4500CI-B		mg/kg		Analyzed By: AC					
Analyte	Result	Reporting Limit	Analyzed	Method Blank	BS	% Recovery	True Value QC	RPD	Qualifier
Chloride	5120	16.0	08/28/2018	ND	448	112	400	7.41	

TPH 8015M		mg/kg		Analyzed By: MS					
Analyte	Result	Reporting Limit	Analyzed	Method Blank	BS	% Recovery	True Value QC	RPD	Qualifier
GRO C6-C10*	<10.0	10.0	08/24/2018	ND	215	108	200	1.37	
DRO >C10-C28*	<10.0	10.0	08/24/2018	ND	224	112	200	1.61	
EXT DRO >C28-C36	<10.0	10.0	08/24/2018	ND					

Surrogate: 1-Chlorooctane 104 % 41-142

Surrogate: 1-Chlorooctadecane 99.0 % 37.6-147

Cardinal Laboratories

*=Accredited Analyte

PLEASE NOTE: Liability and Damages. Cardinal's liability and client's exclusive remedy for any claim arising, whether based in contract or tort, shall be limited to the amount paid by client for analyses. All claims, including those for negligence and any other cause whatsoever shall be deemed waived unless made in writing and received by Cardinal within thirty (30) days after completion of the applicable service. In no event shall Cardinal be liable for incidental or consequential damages, including, without limitation, business interruptions, loss of use, or loss of profits incurred by client, its subsidiaries, affiliates or successors arising out of or related to the performance of the services hereunder by Cardinal, regardless of whether such claim is based upon any of the above stated reasons or otherwise. Results relate only to the samples identified above. This report shall not be reproduced except in full with written approval of Cardinal Laboratories.



Celey D. Keene, Lab Director/Quality Manager

Analytical Results For:

RX-SOIL INC.
ZACH THOMAS
201 MAIN STREET, SUITE 1360
FORT WORTH TX, 76102
Fax To: NA

Received: 08/23/2018
Reported: 08/28/2018
Project Name: MB #5
Project Number: NONE GIVEN
Project Location: NOT GIVEN

Sampling Date: 08/22/2018
Sampling Type: Soil
Sampling Condition: Cool & Intact
Sample Received By: Tamara Oldaker

Sample ID: BH4 - 3' (H802359-12)

BTX 8021B		mg/kg		Analyzed By: ms					
Analyte	Result	Reporting Limit	Analyzed	Method Blank	BS	% Recovery	True Value QC	RPD	Qualifier
Benzene*	<0.050	0.050	08/25/2018	ND	1.90	95.0	2.00	1.48	
Toluene*	<0.050	0.050	08/25/2018	ND	1.83	91.4	2.00	1.15	
Ethylbenzene*	<0.050	0.050	08/25/2018	ND	1.85	92.6	2.00	1.44	
Total Xylenes*	<0.150	0.150	08/25/2018	ND	5.54	92.4	6.00	1.28	
Total BTX	<0.300	0.300	08/25/2018	ND					

Surrogate: 4-Bromofluorobenzene (PID) 92.9 % 69.8-142

Chloride, SM4500Cl-B		mg/kg		Analyzed By: AC					
Analyte	Result	Reporting Limit	Analyzed	Method Blank	BS	% Recovery	True Value QC	RPD	Qualifier
Chloride	256	16.0	08/28/2018	ND	448	112	400	7.41	

TPH 8015M		mg/kg		Analyzed By: MS					
Analyte	Result	Reporting Limit	Analyzed	Method Blank	BS	% Recovery	True Value QC	RPD	Qualifier
GRO C6-C10*	<10.0	10.0	08/24/2018	ND	215	108	200	1.37	
DRO >C10-C28*	<10.0	10.0	08/24/2018	ND	224	112	200	1.61	
EXT DRO >C28-C36	<10.0	10.0	08/24/2018	ND					

Surrogate: 1-Chlorooctane 89.4 % 41-142

Surrogate: 1-Chlorooctadecane 86.7 % 37.6-147

Cardinal Laboratories

*=Accredited Analyte

PLEASE NOTE: Liability and Damages. Cardinal's liability and client's exclusive remedy for any claim arising, whether based in contract or tort, shall be limited to the amount paid by client for analyses. All claims, including those for negligence and any other cause whatsoever shall be deemed waived unless made in writing and received by Cardinal within thirty (30) days after completion of the applicable service. In no event shall Cardinal be liable for incidental or consequential damages, including, without limitation, business interruptions, loss of use, or loss of profits incurred by client, its subsidiaries, affiliates or successors arising out of or related to the performance of the services hereunder by Cardinal, regardless of whether such claim is based upon any of the above stated reasons or otherwise. Results relate only to the samples identified above. This report shall not be reproduced except in full with written approval of Cardinal Laboratories.



Celey D. Keene, Lab Director/Quality Manager

Analytical Results For:

RX-SOIL INC.
ZACH THOMAS
201 MAIN STREET, SUITE 1360
FORT WORTH TX, 76102
Fax To: NA

Received: 08/23/2018
Reported: 08/28/2018
Project Name: MB #5
Project Number: NONE GIVEN
Project Location: NOT GIVEN

Sampling Date: 08/22/2018
Sampling Type: Soil
Sampling Condition: Cool & Intact
Sample Received By: Tamara Oldaker

Sample ID: BH4 - 4' (H802359-13)

BTX 8021B		mg/kg		Analyzed By: ms					
Analyte	Result	Reporting Limit	Analyzed	Method Blank	BS	% Recovery	True Value QC	RPD	Qualifier
Benzene*	<0.050	0.050	08/27/2018	ND	2.10	105	2.00	1.57	
Toluene*	<0.050	0.050	08/27/2018	ND	2.06	103	2.00	0.954	
Ethylbenzene*	<0.050	0.050	08/27/2018	ND	2.06	103	2.00	1.53	
Total Xylenes*	<0.150	0.150	08/27/2018	ND	6.28	105	6.00	1.58	
Total BTX	<0.300	0.300	08/27/2018	ND					

Surrogate: 4-Bromofluorobenzene (PID) 95.4 % 69.8-142

Chloride, SM4500Cl-B		mg/kg		Analyzed By: AC					
Analyte	Result	Reporting Limit	Analyzed	Method Blank	BS	% Recovery	True Value QC	RPD	Qualifier
Chloride	64.0	16.0	08/28/2018	ND	448	112	400	7.41	

TPH 8015M		mg/kg		Analyzed By: MS					
Analyte	Result	Reporting Limit	Analyzed	Method Blank	BS	% Recovery	True Value QC	RPD	Qualifier
GRO C6-C10*	<10.0	10.0	08/24/2018	ND	215	108	200	1.37	
DRO >C10-C28*	<10.0	10.0	08/24/2018	ND	224	112	200	1.61	
EXT DRO >C28-C36	<10.0	10.0	08/24/2018	ND					

Surrogate: 1-Chlorooctane 81.2 % 41-142

Surrogate: 1-Chlorooctadecane 82.2 % 37.6-147

Cardinal Laboratories

*=Accredited Analyte

PLEASE NOTE: Liability and Damages. Cardinal's liability and client's exclusive remedy for any claim arising, whether based in contract or tort, shall be limited to the amount paid by client for analyses. All claims, including those for negligence and any other cause whatsoever shall be deemed waived unless made in writing and received by Cardinal within thirty (30) days after completion of the applicable service. In no event shall Cardinal be liable for incidental or consequential damages, including, without limitation, business interruptions, loss of use, or loss of profits incurred by client, its subsidiaries, affiliates or successors arising out of or related to the performance of the services hereunder by Cardinal, regardless of whether such claim is based upon any of the above stated reasons or otherwise. Results relate only to the samples identified above. This report shall not be reproduced except in full with written approval of Cardinal Laboratories.



Celey D. Keene, Lab Director/Quality Manager

Analytical Results For:

RX-SOIL INC.
ZACH THOMAS
201 MAIN STREET, SUITE 1360
FORT WORTH TX, 76102
Fax To: NA

Received: 08/23/2018
Reported: 08/28/2018
Project Name: MB #5
Project Number: NONE GIVEN
Project Location: NOT GIVEN

Sampling Date: 08/22/2018
Sampling Type: Soil
Sampling Condition: Cool & Intact
Sample Received By: Tamara Oldaker

Sample ID: BH4 - 14' (H802359-14)**Chloride, SM4500Cl-B****mg/kg****Analyzed By: AC**

Analyte	Result	Reporting Limit	Analyzed	Method Blank	BS	% Recovery	True Value QC	RPD	Qualifier
Chloride	80.0	16.0	08/28/2018	ND	448	112	400	7.41	

Cardinal Laboratories

*=Accredited Analyte

PLEASE NOTE: Liability and Damages. Cardinal's liability and client's exclusive remedy for any claim arising, whether based in contract or tort, shall be limited to the amount paid by client for analyses. All claims, including those for negligence and any other cause whatsoever shall be deemed waived unless made in writing and received by Cardinal within thirty (30) days after completion of the applicable service. In no event shall Cardinal be liable for incidental or consequential damages, including, without limitation, business interruptions, loss of use, or loss of profits incurred by client, its subsidiaries, affiliates or successors arising out of or related to the performance of the services hereunder by Cardinal, regardless of whether such claim is based upon any of the above stated reasons or otherwise. Results relate only to the samples identified above. This report shall not be reproduced except in full with written approval of Cardinal Laboratories.



Celey D. Keene, Lab Director/Quality Manager

Analytical Results For:

RX-SOIL INC.
ZACH THOMAS
201 MAIN STREET, SUITE 1360
FORT WORTH TX, 76102
Fax To: NA

Received: 08/23/2018
Reported: 08/28/2018
Project Name: MB #5
Project Number: NONE GIVEN
Project Location: NOT GIVEN

Sampling Date: 08/22/2018
Sampling Type: Soil
Sampling Condition: Cool & Intact
Sample Received By: Tamara Oldaker

Sample ID: BH5 - 1' (H802359-15)

BTX 8021B		mg/kg		Analyzed By: ms					
Analyte	Result	Reporting Limit	Analyzed	Method Blank	BS	% Recovery	True Value QC	RPD	Qualifier
Benzene*	<0.050	0.050	08/27/2018	ND	2.10	105	2.00	1.57	
Toluene*	<0.050	0.050	08/27/2018	ND	2.06	103	2.00	0.954	
Ethylbenzene*	<0.050	0.050	08/27/2018	ND	2.06	103	2.00	1.53	
Total Xylenes*	<0.150	0.150	08/27/2018	ND	6.28	105	6.00	1.58	
Total BTX	<0.300	0.300	08/27/2018	ND					

Surrogate: 4-Bromofluorobenzene (PID) 93.8 % 69.8-142

Chloride, SM4500CI-B		mg/kg		Analyzed By: AC						
Analyte	Result	Reporting Limit	Analyzed	Method Blank	BS	% Recovery	True Value QC	RPD	Qualifier	
Chloride	5440	16.0	08/28/2018	ND	448	112	400	7.41		

TPH 8015M		mg/kg		Analyzed By: MS					
Analyte	Result	Reporting Limit	Analyzed	Method Blank	BS	% Recovery	True Value QC	RPD	Qualifier
GRO C6-C10*	<10.0	10.0	08/24/2018	ND	215	108	200	1.37	
DRO >C10-C28*	<10.0	10.0	08/24/2018	ND	224	112	200	1.61	
EXT DRO >C28-C36	<10.0	10.0	08/24/2018	ND					

Surrogate: 1-Chlorooctane 103 % 41-142

Surrogate: 1-Chlorooctadecane 98.4 % 37.6-147

Cardinal Laboratories

*=Accredited Analyte

PLEASE NOTE: Liability and Damages. Cardinal's liability and client's exclusive remedy for any claim arising, whether based in contract or tort, shall be limited to the amount paid by client for analyses. All claims, including those for negligence and any other cause whatsoever shall be deemed waived unless made in writing and received by Cardinal within thirty (30) days after completion of the applicable service. In no event shall Cardinal be liable for incidental or consequential damages, including, without limitation, business interruptions, loss of use, or loss of profits incurred by client, its subsidiaries, affiliates or successors arising out of or related to the performance of the services hereunder by Cardinal, regardless of whether such claim is based upon any of the above stated reasons or otherwise. Results relate only to the samples identified above. This report shall not be reproduced except in full with written approval of Cardinal Laboratories.



Celey D. Keene, Lab Director/Quality Manager

Analytical Results For:

RX-SOIL INC.
ZACH THOMAS
201 MAIN STREET, SUITE 1360
FORT WORTH TX, 76102
Fax To: NA

Received: 08/23/2018
Reported: 08/28/2018
Project Name: MB #5
Project Number: NONE GIVEN
Project Location: NOT GIVEN

Sampling Date: 08/22/2018
Sampling Type: Soil
Sampling Condition: Cool & Intact
Sample Received By: Tamara Oldaker

Sample ID: BH5 - 4' (H802359-16)

BTEx 8021B		mg/kg		Analyzed By: ms					
Analyte	Result	Reporting Limit	Analyzed	Method Blank	BS	% Recovery	True Value QC	RPD	Qualifier
Benzene*	<0.050	0.050	08/27/2018	ND	2.10	105	2.00	1.57	
Toluene*	<0.050	0.050	08/27/2018	ND	2.06	103	2.00	0.954	
Ethylbenzene*	<0.050	0.050	08/27/2018	ND	2.06	103	2.00	1.53	
Total Xylenes*	<0.150	0.150	08/27/2018	ND	6.28	105	6.00	1.58	
Total BTEx	<0.300	0.300	08/27/2018	ND					

Surrogate: 4-Bromofluorobenzene (PID) 96.4 % 69.8-142

Chloride, SM4500CI-B		mg/kg		Analyzed By: AC						
Analyte	Result	Reporting Limit	Analyzed	Method Blank	BS	% Recovery	True Value QC	RPD	Qualifier	
Chloride	80.0	16.0	08/28/2018	ND	448	112	400	7.41		

TPH 8015M		mg/kg		Analyzed By: MS					
Analyte	Result	Reporting Limit	Analyzed	Method Blank	BS	% Recovery	True Value QC	RPD	Qualifier
GRO C6-C10*	<10.0	10.0	08/24/2018	ND	215	108	200	1.37	
DRO >C10-C28*	<10.0	10.0	08/24/2018	ND	224	112	200	1.61	
EXT DRO >C28-C36	<10.0	10.0	08/24/2018	ND					

Surrogate: 1-Chlorooctane 95.0 % 41-142

Surrogate: 1-Chlorooctadecane 90.8 % 37.6-147

Cardinal Laboratories

*=Accredited Analyte

PLEASE NOTE: Liability and Damages. Cardinal's liability and client's exclusive remedy for any claim arising, whether based in contract or tort, shall be limited to the amount paid by client for analyses. All claims, including those for negligence and any other cause whatsoever shall be deemed waived unless made in writing and received by Cardinal within thirty (30) days after completion of the applicable service. In no event shall Cardinal be liable for incidental or consequential damages, including, without limitation, business interruptions, loss of use, or loss of profits incurred by client, its subsidiaries, affiliates or successors arising out of or related to the performance of the services hereunder by Cardinal, regardless of whether such claim is based upon any of the above stated reasons or otherwise. Results relate only to the samples identified above. This report shall not be reproduced except in full with written approval of Cardinal Laboratories.



Celey D. Keene, Lab Director/Quality Manager

Analytical Results For:

RX-SOIL INC.
ZACH THOMAS
201 MAIN STREET, SUITE 1360
FORT WORTH TX, 76102
Fax To: NA

Received: 08/23/2018
Reported: 08/28/2018
Project Name: MB #5
Project Number: NONE GIVEN
Project Location: NOT GIVEN

Sampling Date: 08/22/2018
Sampling Type: Soil
Sampling Condition: Cool & Intact
Sample Received By: Tamara Oldaker

Sample ID: BH5 - 14' (H802359-17)**Chloride, SM4500Cl-B****mg/kg****Analyzed By: AC**

Analyte	Result	Reporting Limit	Analyzed	Method Blank	BS	% Recovery	True Value QC	RPD	Qualifier
Chloride	16.0	16.0	08/28/2018	ND	448	112	400	7.41	

Cardinal Laboratories

*=Accredited Analyte

PLEASE NOTE: Liability and Damages. Cardinal's liability and client's exclusive remedy for any claim arising, whether based in contract or tort, shall be limited to the amount paid by client for analyses. All claims, including those for negligence and any other cause whatsoever shall be deemed waived unless made in writing and received by Cardinal within thirty (30) days after completion of the applicable service. In no event shall Cardinal be liable for incidental or consequential damages, including, without limitation, business interruptions, loss of use, or loss of profits incurred by client, its subsidiaries, affiliates or successors arising out of or related to the performance of the services hereunder by Cardinal, regardless of whether such claim is based upon any of the above stated reasons or otherwise. Results relate only to the samples identified above. This report shall not be reproduced except in full with written approval of Cardinal Laboratories.



Celey D. Keene, Lab Director/Quality Manager

Analytical Results For:

RX-SOIL INC.
ZACH THOMAS
201 MAIN STREET, SUITE 1360
FORT WORTH TX, 76102
Fax To: NA

Received: 08/23/2018
Reported: 08/28/2018
Project Name: MB #5
Project Number: NONE GIVEN
Project Location: NOT GIVEN

Sampling Date: 08/22/2018
Sampling Type: Soil
Sampling Condition: Cool & Intact
Sample Received By: Tamara Oldaker

Sample ID: BH6 - 1' (H802359-18)

BTX 8021B		mg/kg		Analyzed By: ms					
Analyte	Result	Reporting Limit	Analyzed	Method Blank	BS	% Recovery	True Value QC	RPD	Qualifier
Benzene*	<0.050	0.050	08/27/2018	ND	2.10	105	2.00	1.57	
Toluene*	<0.050	0.050	08/27/2018	ND	2.06	103	2.00	0.954	
Ethylbenzene*	<0.050	0.050	08/27/2018	ND	2.06	103	2.00	1.53	
Total Xylenes*	<0.150	0.150	08/27/2018	ND	6.28	105	6.00	1.58	
Total BTX	<0.300	0.300	08/27/2018	ND					

Surrogate: 4-Bromofluorobenzene (PID) 97.4 % 69.8-142

Chloride, SM4500Cl-B		mg/kg		Analyzed By: AC					
Analyte	Result	Reporting Limit	Analyzed	Method Blank	BS	% Recovery	True Value QC	RPD	Qualifier
Chloride	560	16.0	08/28/2018	ND	448	112	400	7.41	

TPH 8015M		mg/kg		Analyzed By: MS					
Analyte	Result	Reporting Limit	Analyzed	Method Blank	BS	% Recovery	True Value QC	RPD	Qualifier
GRO C6-C10*	<10.0	10.0	08/24/2018	ND	215	108	200	1.37	
DRO >C10-C28*	135	10.0	08/24/2018	ND	224	112	200	1.61	
EXT DRO >C28-C36	20.2	10.0	08/24/2018	ND					

Surrogate: 1-Chlorooctane 95.0 % 41-142

Surrogate: 1-Chlorooctadecane 98.8 % 37.6-147

Cardinal Laboratories

*=Accredited Analyte

PLEASE NOTE: Liability and Damages. Cardinal's liability and client's exclusive remedy for any claim arising, whether based in contract or tort, shall be limited to the amount paid by client for analyses. All claims, including those for negligence and any other cause whatsoever shall be deemed waived unless made in writing and received by Cardinal within thirty (30) days after completion of the applicable service. In no event shall Cardinal be liable for incidental or consequential damages, including, without limitation, business interruptions, loss of use, or loss of profits incurred by client, its subsidiaries, affiliates or successors arising out of or related to the performance of the services hereunder by Cardinal, regardless of whether such claim is based upon any of the above stated reasons or otherwise. Results relate only to the samples identified above. This report shall not be reproduced except in full with written approval of Cardinal Laboratories.



Celey D. Keene, Lab Director/Quality Manager

Analytical Results For:

RX-SOIL INC.
ZACH THOMAS
201 MAIN STREET, SUITE 1360
FORT WORTH TX, 76102
Fax To: NA

Received: 08/23/2018
Reported: 08/28/2018
Project Name: MB #5
Project Number: NONE GIVEN
Project Location: NOT GIVEN

Sampling Date: 08/22/2018
Sampling Type: Soil
Sampling Condition: Cool & Intact
Sample Received By: Tamara Oldaker

Sample ID: BH6 - 2' (H802359-19)

BTX 8021B		mg/kg		Analyzed By: ms					
Analyte	Result	Reporting Limit	Analyzed	Method Blank	BS	% Recovery	True Value QC	RPD	Qualifier
Benzene*	<0.050	0.050	08/27/2018	ND	2.10	105	2.00	1.57	
Toluene*	<0.050	0.050	08/27/2018	ND	2.06	103	2.00	0.954	
Ethylbenzene*	<0.050	0.050	08/27/2018	ND	2.06	103	2.00	1.53	
Total Xylenes*	<0.150	0.150	08/27/2018	ND	6.28	105	6.00	1.58	
Total BTX	<0.300	0.300	08/27/2018	ND					

Surrogate: 4-Bromofluorobenzene (PID) 97.2 % 69.8-142

Chloride, SM4500Cl-B		mg/kg		Analyzed By: AC					
Analyte	Result	Reporting Limit	Analyzed	Method Blank	BS	% Recovery	True Value QC	RPD	Qualifier
Chloride	2320	16.0	08/28/2018	ND	448	112	400	7.41	

TPH 8015M		mg/kg		Analyzed By: MS					
Analyte	Result	Reporting Limit	Analyzed	Method Blank	BS	% Recovery	True Value QC	RPD	Qualifier
GRO C6-C10*	<10.0	10.0	08/24/2018	ND	215	108	200	1.37	
DRO >C10-C28*	148	10.0	08/24/2018	ND	224	112	200	1.61	
EXT DRO >C28-C36	30.7	10.0	08/24/2018	ND					

Surrogate: 1-Chlorooctane 103 % 41-142

Surrogate: 1-Chlorooctadecane 109 % 37.6-147

Cardinal Laboratories

*=Accredited Analyte

PLEASE NOTE: Liability and Damages. Cardinal's liability and client's exclusive remedy for any claim arising, whether based in contract or tort, shall be limited to the amount paid by client for analyses. All claims, including those for negligence and any other cause whatsoever shall be deemed waived unless made in writing and received by Cardinal within thirty (30) days after completion of the applicable service. In no event shall Cardinal be liable for incidental or consequential damages, including, without limitation, business interruptions, loss of use, or loss of profits incurred by client, its subsidiaries, affiliates or successors arising out of or related to the performance of the services hereunder by Cardinal, regardless of whether such claim is based upon any of the above stated reasons or otherwise. Results relate only to the samples identified above. This report shall not be reproduced except in full with written approval of Cardinal Laboratories.



Celey D. Keene, Lab Director/Quality Manager

Analytical Results For:

RX-SOIL INC.
ZACH THOMAS
201 MAIN STREET, SUITE 1360
FORT WORTH TX, 76102
Fax To: NA

Received: 08/23/2018
Reported: 08/28/2018
Project Name: MB #5
Project Number: NONE GIVEN
Project Location: NOT GIVEN

Sampling Date: 08/22/2018
Sampling Type: Soil
Sampling Condition: Cool & Intact
Sample Received By: Tamara Oldaker

Sample ID: BH6 - 3' (H802359-20)

BTX 8021B		mg/kg		Analyzed By: ms					
Analyte	Result	Reporting Limit	Analyzed	Method Blank	BS	% Recovery	True Value QC	RPD	Qualifier
Benzene*	<0.050	0.050	08/27/2018	ND	2.10	105	2.00	1.57	
Toluene*	<0.050	0.050	08/27/2018	ND	2.06	103	2.00	0.954	
Ethylbenzene*	<0.050	0.050	08/27/2018	ND	2.06	103	2.00	1.53	
Total Xylenes*	<0.150	0.150	08/27/2018	ND	6.28	105	6.00	1.58	
Total BTX	<0.300	0.300	08/27/2018	ND					

Surrogate: 4-Bromofluorobenzene (PID) 97.2 % 69.8-142

Chloride, SM4500CI-B		mg/kg		Analyzed By: AC					
Analyte	Result	Reporting Limit	Analyzed	Method Blank	BS	% Recovery	True Value QC	RPD	Qualifier
Chloride	592	16.0	08/28/2018	ND	448	112	400	7.41	

TPH 8015M		mg/kg		Analyzed By: MS					
Analyte	Result	Reporting Limit	Analyzed	Method Blank	BS	% Recovery	True Value QC	RPD	Qualifier
GRO C6-C10*	<10.0	10.0	08/24/2018	ND	215	108	200	1.37	
DRO >C10-C28*	<10.0	10.0	08/24/2018	ND	224	112	200	1.61	
EXT DRO >C28-C36	<10.0	10.0	08/24/2018	ND					

Surrogate: 1-Chlorooctane 92.3 % 41-142

Surrogate: 1-Chlorooctadecane 89.1 % 37.6-147

Cardinal Laboratories

*=Accredited Analyte

PLEASE NOTE: Liability and Damages. Cardinal's liability and client's exclusive remedy for any claim arising, whether based in contract or tort, shall be limited to the amount paid by client for analyses. All claims, including those for negligence and any other cause whatsoever shall be deemed waived unless made in writing and received by Cardinal within thirty (30) days after completion of the applicable service. In no event shall Cardinal be liable for incidental or consequential damages, including, without limitation, business interruptions, loss of use, or loss of profits incurred by client, its subsidiaries, affiliates or successors arising out of or related to the performance of the services hereunder by Cardinal, regardless of whether such claim is based upon any of the above stated reasons or otherwise. Results relate only to the samples identified above. This report shall not be reproduced except in full with written approval of Cardinal Laboratories.



Celey D. Keene, Lab Director/Quality Manager

Analytical Results For:

RX-SOIL INC.
ZACH THOMAS
201 MAIN STREET, SUITE 1360
FORT WORTH TX, 76102
Fax To: NA

Received: 08/23/2018
Reported: 08/28/2018
Project Name: MB #5
Project Number: NONE GIVEN
Project Location: NOT GIVEN

Sampling Date: 08/22/2018
Sampling Type: Soil
Sampling Condition: Cool & Intact
Sample Received By: Tamara Oldaker

Sample ID: BH6 - 4' (H802359-21)

BTX 8021B		mg/kg		Analyzed By: ms					
Analyte	Result	Reporting Limit	Analyzed	Method Blank	BS	% Recovery	True Value QC	RPD	Qualifier
Benzene*	<0.050	0.050	08/27/2018	ND	2.10	105	2.00	1.57	
Toluene*	<0.050	0.050	08/27/2018	ND	2.06	103	2.00	0.954	
Ethylbenzene*	<0.050	0.050	08/27/2018	ND	2.06	103	2.00	1.53	
Total Xylenes*	<0.150	0.150	08/27/2018	ND	6.28	105	6.00	1.58	
Total BTX	<0.300	0.300	08/27/2018	ND					

Surrogate: 4-Bromofluorobenzene (PID) 94.0 % 69.8-142

Chloride, SM4500Cl-B		mg/kg		Analyzed By: AC					
Analyte	Result	Reporting Limit	Analyzed	Method Blank	BS	% Recovery	True Value QC	RPD	Qualifier
Chloride	256	16.0	08/28/2018	ND	448	112	400	7.41	

TPH 8015M		mg/kg		Analyzed By: MS					
Analyte	Result	Reporting Limit	Analyzed	Method Blank	BS	% Recovery	True Value QC	RPD	Qualifier
GRO C6-C10*	<10.0	10.0	08/24/2018	ND	215	108	200	1.37	
DRO >C10-C28*	<10.0	10.0	08/24/2018	ND	224	112	200	1.61	
EXT DRO >C28-C36	<10.0	10.0	08/24/2018	ND					

Surrogate: 1-Chlorooctane 89.2 % 41-142

Surrogate: 1-Chlorooctadecane 85.1 % 37.6-147

Cardinal Laboratories

*=Accredited Analyte

PLEASE NOTE: Liability and Damages. Cardinal's liability and client's exclusive remedy for any claim arising, whether based in contract or tort, shall be limited to the amount paid by client for analyses. All claims, including those for negligence and any other cause whatsoever shall be deemed waived unless made in writing and received by Cardinal within thirty (30) days after completion of the applicable service. In no event shall Cardinal be liable for incidental or consequential damages, including, without limitation, business interruptions, loss of use, or loss of profits incurred by client, its subsidiaries, affiliates or successors arising out of or related to the performance of the services hereunder by Cardinal, regardless of whether such claim is based upon any of the above stated reasons or otherwise. Results relate only to the samples identified above. This report shall not be reproduced except in full with written approval of Cardinal Laboratories.



Celey D. Keene, Lab Director/Quality Manager

Analytical Results For:

RX-SOIL INC.
ZACH THOMAS
201 MAIN STREET, SUITE 1360
FORT WORTH TX, 76102
Fax To: NA

Received: 08/23/2018
Reported: 08/28/2018
Project Name: MB #5
Project Number: NONE GIVEN
Project Location: NOT GIVEN

Sampling Date: 08/22/2018
Sampling Type: Soil
Sampling Condition: Cool & Intact
Sample Received By: Tamara Oldaker

Sample ID: BH6 - 14' (H802359-22)**Chloride, SM4500Cl-B****mg/kg****Analyzed By: AC**

Analyte	Result	Reporting Limit	Analyzed	Method Blank	BS	% Recovery	True Value QC	RPD	Qualifier
Chloride	<16.0	16.0	08/28/2018	ND	448	112	400	7.41	

Cardinal Laboratories

*=Accredited Analyte

PLEASE NOTE: Liability and Damages. Cardinal's liability and client's exclusive remedy for any claim arising, whether based in contract or tort, shall be limited to the amount paid by client for analyses. All claims, including those for negligence and any other cause whatsoever shall be deemed waived unless made in writing and received by Cardinal within thirty (30) days after completion of the applicable service. In no event shall Cardinal be liable for incidental or consequential damages, including, without limitation, business interruptions, loss of use, or loss of profits incurred by client, its subsidiaries, affiliates or successors arising out of or related to the performance of the services hereunder by Cardinal, regardless of whether such claim is based upon any of the above stated reasons or otherwise. Results relate only to the samples identified above. This report shall not be reproduced except in full with written approval of Cardinal Laboratories.



Celey D. Keene, Lab Director/Quality Manager

Analytical Results For:

RX-SOIL INC.
ZACH THOMAS
201 MAIN STREET, SUITE 1360
FORT WORTH TX, 76102
Fax To: NA

Received: 08/23/2018
Reported: 08/28/2018
Project Name: MB #5
Project Number: NONE GIVEN
Project Location: NOT GIVEN

Sampling Date: 08/22/2018
Sampling Type: Soil
Sampling Condition: Cool & Intact
Sample Received By: Tamara Oldaker

Sample ID: BH7 - 1' (H802359-23)

BTX 8021B		mg/kg		Analyzed By: ms					
Analyte	Result	Reporting Limit	Analyzed	Method Blank	BS	% Recovery	True Value QC	RPD	Qualifier
Benzene*	<0.050	0.050	08/27/2018	ND	2.10	105	2.00	1.57	
Toluene*	<0.050	0.050	08/27/2018	ND	2.06	103	2.00	0.954	
Ethylbenzene*	<0.050	0.050	08/27/2018	ND	2.06	103	2.00	1.53	
Total Xylenes*	<0.150	0.150	08/27/2018	ND	6.28	105	6.00	1.58	
Total BTX	<0.300	0.300	08/27/2018	ND					

Surrogate: 4-Bromofluorobenzene (PID) 94.5 % 69.8-142

Chloride, SM4500Cl-B		mg/kg		Analyzed By: AC					
Analyte	Result	Reporting Limit	Analyzed	Method Blank	BS	% Recovery	True Value QC	RPD	Qualifier
Chloride	464	16.0	08/28/2018	ND	448	112	400	7.41	

TPH 8015M		mg/kg		Analyzed By: MS					
Analyte	Result	Reporting Limit	Analyzed	Method Blank	BS	% Recovery	True Value QC	RPD	Qualifier
GRO C6-C10*	<10.0	10.0	08/24/2018	ND	215	108	200	1.37	
DRO >C10-C28*	105	10.0	08/24/2018	ND	224	112	200	1.61	
EXT DRO >C28-C36	<10.0	10.0	08/24/2018	ND					

Surrogate: 1-Chlorooctane 96.7 % 41-142

Surrogate: 1-Chlorooctadecane 98.5 % 37.6-147

Cardinal Laboratories

*=Accredited Analyte

PLEASE NOTE: Liability and Damages. Cardinal's liability and client's exclusive remedy for any claim arising, whether based in contract or tort, shall be limited to the amount paid by client for analyses. All claims, including those for negligence and any other cause whatsoever shall be deemed waived unless made in writing and received by Cardinal within thirty (30) days after completion of the applicable service. In no event shall Cardinal be liable for incidental or consequential damages, including, without limitation, business interruptions, loss of use, or loss of profits incurred by client, its subsidiaries, affiliates or successors arising out of or related to the performance of the services hereunder by Cardinal, regardless of whether such claim is based upon any of the above stated reasons or otherwise. Results relate only to the samples identified above. This report shall not be reproduced except in full with written approval of Cardinal Laboratories.



Celey D. Keene, Lab Director/Quality Manager

Analytical Results For:

RX-SOIL INC.
ZACH THOMAS
201 MAIN STREET, SUITE 1360
FORT WORTH TX, 76102
Fax To: NA

Received: 08/23/2018
Reported: 08/28/2018
Project Name: MB #5
Project Number: NONE GIVEN
Project Location: NOT GIVEN

Sampling Date: 08/22/2018
Sampling Type: Soil
Sampling Condition: Cool & Intact
Sample Received By: Tamara Oldaker

Sample ID: BH7 - 2' (H802359-24)

BTX 8021B		mg/kg		Analyzed By: ms					
Analyte	Result	Reporting Limit	Analyzed	Method Blank	BS	% Recovery	True Value QC	RPD	Qualifier
Benzene*	<0.050	0.050	08/27/2018	ND	2.10	105	2.00	1.57	
Toluene*	<0.050	0.050	08/27/2018	ND	2.06	103	2.00	0.954	
Ethylbenzene*	<0.050	0.050	08/27/2018	ND	2.06	103	2.00	1.53	
Total Xylenes*	<0.150	0.150	08/27/2018	ND	6.28	105	6.00	1.58	
Total BTX	<0.300	0.300	08/27/2018	ND					

Surrogate: 4-Bromofluorobenzene (PID) 97.0 % 69.8-142

Chloride, SM4500CI-B		mg/kg		Analyzed By: AC					
Analyte	Result	Reporting Limit	Analyzed	Method Blank	BS	% Recovery	True Value QC	RPD	Qualifier
Chloride	496	16.0	08/28/2018	ND	448	112	400	7.41	

TPH 8015M		mg/kg		Analyzed By: MS					
Analyte	Result	Reporting Limit	Analyzed	Method Blank	BS	% Recovery	True Value QC	RPD	Qualifier
GRO C6-C10*	<10.0	10.0	08/24/2018	ND	214	107	200	1.38	
DRO >C10-C28*	85.0	10.0	08/24/2018	ND	202	101	200	2.21	
EXT DRO >C28-C36	22.0	10.0	08/24/2018	ND					

Surrogate: 1-Chlorooctane 90.0 % 41-142

Surrogate: 1-Chlorooctadecane 87.9 % 37.6-147

Cardinal Laboratories

*=Accredited Analyte

PLEASE NOTE: Liability and Damages. Cardinal's liability and client's exclusive remedy for any claim arising, whether based in contract or tort, shall be limited to the amount paid by client for analyses. All claims, including those for negligence and any other cause whatsoever shall be deemed waived unless made in writing and received by Cardinal within thirty (30) days after completion of the applicable service. In no event shall Cardinal be liable for incidental or consequential damages, including, without limitation, business interruptions, loss of use, or loss of profits incurred by client, its subsidiaries, affiliates or successors arising out of or related to the performance of the services hereunder by Cardinal, regardless of whether such claim is based upon any of the above stated reasons or otherwise. Results relate only to the samples identified above. This report shall not be reproduced except in full with written approval of Cardinal Laboratories.



Celey D. Keene, Lab Director/Quality Manager

Analytical Results For:

RX-SOIL INC.
ZACH THOMAS
201 MAIN STREET, SUITE 1360
FORT WORTH TX, 76102
Fax To: NA

Received: 08/23/2018
Reported: 08/28/2018
Project Name: MB #5
Project Number: NONE GIVEN
Project Location: NOT GIVEN

Sampling Date: 08/22/2018
Sampling Type: Soil
Sampling Condition: Cool & Intact
Sample Received By: Tamara Oldaker

Sample ID: BH7 - 3' (H802359-25)

BTEx 8021B		mg/kg		Analyzed By: ms					
Analyte	Result	Reporting Limit	Analyzed	Method Blank	BS	% Recovery	True Value QC	RPD	Qualifier
Benzene*	<0.050	0.050	08/27/2018	ND	2.10	105	2.00	1.57	
Toluene*	<0.050	0.050	08/27/2018	ND	2.06	103	2.00	0.954	
Ethylbenzene*	<0.050	0.050	08/27/2018	ND	2.06	103	2.00	1.53	
Total Xylenes*	<0.150	0.150	08/27/2018	ND	6.28	105	6.00	1.58	
Total BTEX	<0.300	0.300	08/27/2018	ND					

Surrogate: 4-Bromofluorobenzene (PID) 94.0 % 69.8-142

Chloride, SM4500Cl-B		mg/kg		Analyzed By: AC					
Analyte	Result	Reporting Limit	Analyzed	Method Blank	BS	% Recovery	True Value QC	RPD	Qualifier
Chloride	432	16.0	08/28/2018	ND	448	112	400	7.41	

TPH 8015M		mg/kg		Analyzed By: MS					
Analyte	Result	Reporting Limit	Analyzed	Method Blank	BS	% Recovery	True Value QC	RPD	Qualifier
GRO C6-C10*	<10.0	10.0	08/24/2018	ND	214	107	200	1.38	
DRO >C10-C28*	494	10.0	08/24/2018	ND	202	101	200	2.21	
EXT DRO >C28-C36	137	10.0	08/24/2018	ND					

Surrogate: 1-Chlorooctane 91.3 % 41-142

Surrogate: 1-Chlorooctadecane 93.6 % 37.6-147

Cardinal Laboratories

*=Accredited Analyte

PLEASE NOTE: Liability and Damages. Cardinal's liability and client's exclusive remedy for any claim arising, whether based in contract or tort, shall be limited to the amount paid by client for analyses. All claims, including those for negligence and any other cause whatsoever shall be deemed waived unless made in writing and received by Cardinal within thirty (30) days after completion of the applicable service. In no event shall Cardinal be liable for incidental or consequential damages, including, without limitation, business interruptions, loss of use, or loss of profits incurred by client, its subsidiaries, affiliates or successors arising out of or related to the performance of the services hereunder by Cardinal, regardless of whether such claim is based upon any of the above stated reasons or otherwise. Results relate only to the samples identified above. This report shall not be reproduced except in full with written approval of Cardinal Laboratories.



Celey D. Keene, Lab Director/Quality Manager

Analytical Results For:

RX-SOIL INC.
ZACH THOMAS
201 MAIN STREET, SUITE 1360
FORT WORTH TX, 76102
Fax To: NA

Received: 08/23/2018
Reported: 08/28/2018
Project Name: MB #5
Project Number: NONE GIVEN
Project Location: NOT GIVEN

Sampling Date: 08/22/2018
Sampling Type: Soil
Sampling Condition: Cool & Intact
Sample Received By: Tamara Oldaker

Sample ID: BH7 - 13' (H802359-26)

Chloride, SM4500Cl-B		mg/kg		Analyzed By: AC					
Analyte	Result	Reporting Limit	Analyzed	Method Blank	BS	% Recovery	True Value QC	RPD	Qualifier
Chloride	32.0	16.0	08/28/2018	ND	448	112	400	7.41	

Cardinal Laboratories

*=Accredited Analyte

PLEASE NOTE: Liability and Damages. Cardinal's liability and client's exclusive remedy for any claim arising, whether based in contract or tort, shall be limited to the amount paid by client for analyses. All claims, including those for negligence and any other cause whatsoever shall be deemed waived unless made in writing and received by Cardinal within thirty (30) days after completion of the applicable service. In no event shall Cardinal be liable for incidental or consequential damages, including, without limitation, business interruptions, loss of use, or loss of profits incurred by client, its subsidiaries, affiliates or successors arising out of or related to the performance of the services hereunder by Cardinal, regardless of whether such claim is based upon any of the above stated reasons or otherwise. Results relate only to the samples identified above. This report shall not be reproduced except in full with written approval of Cardinal Laboratories.



Celey D. Keene, Lab Director/Quality Manager

Notes and Definitions

S-04	The surrogate recovery for this sample is outside of established control limits due to a sample matrix effect.
QM-07	The spike recovery was outside acceptance limits for the MS and/or MSD. The batch was accepted based on acceptable LCS recovery.
ND	Analyte NOT DETECTED at or above the reporting limit
RPD	Relative Percent Difference
**	Samples not received at proper temperature of 6°C or below.
***	Insufficient time to reach temperature.
-	Chloride by SM4500Cl-B does not require samples be received at or below 6°C Samples reported on an as received basis (wet) unless otherwise noted on report

Cardinal Laboratories

*=Accredited Analyte

PLEASE NOTE: Liability and Damages. Cardinal's liability and client's exclusive remedy for any claim arising, whether based in contract or tort, shall be limited to the amount paid by client for analyses. All claims, including those for negligence and any other cause whatsoever shall be deemed waived unless made in writing and received by Cardinal within thirty (30) days after completion of the applicable service. In no event shall Cardinal be liable for incidental or consequential damages, including, without limitation, business interruptions, loss of use, or loss of profits incurred by client, its subsidiaries, affiliates or successors arising out of or related to the performance of the services hereunder by Cardinal, regardless of whether such claim is based upon any of the above stated reasons or otherwise. Results relate only to the samples identified above. This report shall not be reproduced except in full with written approval of Cardinal Laboratories.



Celey D. Keene, Lab Director/Quality Manager



Page 28 of 34

Company Name: RXSOIL				BILL TO				ANALYSIS REQUEST																																	
Project Manager: ZACH THOMAS				P.O. #:																																					
Address:				Company:																																					
City:		State:		Zip:		Attn:																																			
Phone #:		Fax #:		Address:																																					
Project #:		Project Owner:		City:																																					
Project Name:				State:		Zip:																																			
Project Location: MB#5				Phone #:																																					
Sampler Name: JACOB MICKLE				Fax #:				<div style="display: flex; justify-content: space-around;"> <div>CHLORIDES</div> <div>TPH</div> <div>BTEX</div> </div>																																	
FOR LAB USE ONLY				MATRIX		PRESERV.														SAMPLING																					
Lab I.D.		Sample I.D.		(G)RAB OR (C)OMP.		# CONTAINERS														GROUNDWATER		WASTEWATER		SOIL		OIL		SLUDGE		OTHER:		ACID/BASE:		ICE / COOL		OTHER:		DATE		TIME	
HB02359																																									
1		BH1-1'		9																				x								x		x		x					
2		BH1-4'		1																				1								1		1		x		x		x	
3		BH1-14'		1																				1								1		1		x					

Relinquished By: <i>[Signature]</i>		Date: <i>8-23-18</i> Time: <i>11:40</i>		Received By: <i>[Signature]</i>		Phone Result: <input type="checkbox"/> Yes <input type="checkbox"/> No Add'l Phone #: _____ Fax Result: <input type="checkbox"/> Yes <input type="checkbox"/> No Add'l Fax #: _____ REMARKS: _____	
Relinquished By: _____		Date: _____ Time: _____		Received By: _____			
Delivered By: (Circle One) Sampler - <i>UPS</i> - Bus - Other: <i>0.5c #97</i>				Sample Condition Cool Intact <input checked="" type="checkbox"/> Yes <input type="checkbox"/> Yes <input type="checkbox"/> No <input type="checkbox"/> No		CHECKED BY: (Initials) <i>TO.</i>	



Page 29 of 34

[illegible]

Relinquished By: <i>[Signature]</i>		Date: <i>8-23-18</i>		Received By: <i>[Signature]</i>		Phone Result: <input type="checkbox"/> Yes <input type="checkbox"/> No		Add'l Phone #:	
		Time: <i>11:40</i>				Fax Result: <input type="checkbox"/> Yes <input type="checkbox"/> No		Add'l Fax #:	
Relinquished By:		Date:		Received By:		REMARKS:			
		Time:							
Delivered By: (Circle One)		<i>0.5°C #97</i>		Sample Condition		CHECKED BY:			
Sampler - <i>45</i> PS - Bus - Other:				Cool <input checked="" type="checkbox"/> Yes <input type="checkbox"/> No		Intact <input checked="" type="checkbox"/> Yes <input type="checkbox"/> No			
						<i>TO</i>			



46

+ Cardinal cannot accept verbal changes. Please fax written changes to (575) 202-2226.

CHAIN-OF-CUSTODY AND ANALYSIS REQUEST

101 East Marland, Hobbs, NM 88240
(575) 393-2326 FAX (575) 393-2476

Company Name: <u>RXSOIL</u>		BILL TO		ANALYSIS REQUEST																											
Project Manager: <u>ZACH THOMAS</u>		P.O. #:																													
Address:		Company:																													
City:	State:	Zip:	Attn:																												
Phone #:	Fax #:	Address:																													
Project #:	Project Owner:		City:																												
Project Name:		State:												Zip:																	
Project Location: <u>MB#5</u>		Phone #:																													
Sampler Name: <u>JACOB MECKLE</u>		Fax #:																													
FOR LAB USE ONLY	Lab I.D.	Sample I.D.	(G)RAB OR (C)OMP.	# CONTAINERS	MATRIX				PRESERV.	SAMPLING		CHLORIDES	TPH	BTEX																	
					GROUNDWATER	WASTEWATER	SOIL	OIL	SLUDGE	OTHER:	ACID/BASE:				ICE / COOL	OTHER:	DATE	TIME													
	<u>H802359</u>																														
	<u>10</u>	<u>BH4-1'</u>	<u>a</u>				<u>x</u>				<u>x</u>						<u>6/22</u>	<u>1300</u>	<u>x</u>	<u>x</u>	<u>x</u>										
	<u>11</u>	<u>BH4-2'</u>	<u>1</u>								<u>1</u>						<u>1</u>	<u>1</u>	<u>x</u>	<u>x</u>	<u>x</u>										
	<u>12</u>	<u>BH4-3'</u>	<u>1</u>								<u>1</u>			<u>1</u>	<u>1</u>	<u>x</u>	<u>x</u>	<u>x</u>													
	<u>13</u>	<u>BH4-4'</u>	<u>1</u>								<u>1</u>			<u>1</u>	<u>1</u>	<u>x</u>	<u>x</u>	<u>x</u>													
	<u>14</u>	<u>DH4-14'</u>	<u>1</u>								<u>1</u>			<u>1</u>	<u>1</u>	<u>x</u>															

PLEASE NOTE: Liability and Damages. Cardinal's liability and client's exclusive remedy for any claim arising whether based in contract or tort, shall be limited to the amount paid by the client for the analyses. All claims, including those for negligence and any other cause whatsoever shall be deemed waived unless made in writing and received by Cardinal within 30 days after completion of the applicable service. In no event shall Cardinal be liable for incidental or consequential damages, including without limitation, business interruptions, loss of use, or loss of profits incurred by client, its subsidiaries, affiliates or successors arising out of or related to the performance of services hereunder by Cardinal, regardless of whether such claim is based upon any of the above stated reasons or otherwise.

Relinquished By: <u>[Signature]</u>	Date: <u>8-23-18</u>	Received By: <u>[Signature]</u>	Phone Result: <input type="checkbox"/> Yes <input type="checkbox"/> No	Add'l Phone #:
	Time: <u>11:40</u>		Fax Result: <input type="checkbox"/> Yes <input type="checkbox"/> No	Add'l Fax #:
Relinquished By:	Date:	Received By:	REMARKS:	
	Time:			
Delivered By: (Circle One)	Sample Condition	CHECKED BY: (Initials)		
Sampler <u>4</u> PS - Bus - Other:	Cool <input checked="" type="checkbox"/> Intact <input checked="" type="checkbox"/> Yes <input checked="" type="checkbox"/> No <input type="checkbox"/>	<u>TO</u>		



Page 32 of 34

[illegible]

Relinquished By: <i>gm</i>		Date: <i>8-23-18</i>		Received By: <i>Samara Aldridge</i>		Phone Result: <input type="checkbox"/> Yes <input type="checkbox"/> No		Add'l Phone #:	
		Time: <i>11:40</i>				Fax Result: <input type="checkbox"/> Yes <input type="checkbox"/> No		Add'l Fax #:	
Relinquished By:		Date:		Received By:		REMARKS:			
		Time:							
Delivered By: (Circle One)				Sample Condition		CHECKED BY:			
Sampler <i>48</i> GPS - Bus - Other: <i>0.5°C #97</i>				Cool Intact <input checked="" type="checkbox"/> Yes <input type="checkbox"/> No <input type="checkbox"/> Yes <input type="checkbox"/> No		(Initials) <i>VA</i>			

CHAIN-OF-CUSTODY AND ANALYSIS REQUEST

101 East Marland, Hobbs, NM 88240
 (575) 393-2326 FAX (575) 393-2476

Company Name: <u>RXSOIL</u>				BILL TO				ANALYSIS REQUEST																		
Project Manager: <u>ZACH THOMAS</u>				P.O. #:																						
Address:				Company:																						
City: State: Zip:				Attn:																						
Phone #: Fax #:				Address:																						
Project #: Project Owner:				City:																						
Project Name:				State: Zip:																						
Project Location: <u>MB#5</u>				Phone #:																						
Sampler Name: <u>JAKOB MICKLE</u>				Fax #:																						
FOR LAB USE ONLY				MATRIX		PRESERV.		SAMPLING		<div style="display: flex; justify-content: space-around;"> <div style="writing-mode: vertical-rl; transform: rotate(180deg);">CHLORIDES</div> <div style="writing-mode: vertical-rl; transform: rotate(180deg);">TPH</div> <div style="writing-mode: vertical-rl; transform: rotate(180deg);">BTEX</div> </div>																
Lab I.D.	Sample I.D.	(G)RAB OR (C)OMP.	# CONTAINERS	GROUNDWATER	WASTEWATER	SOIL	OIL	SLUDGE	OTHER:													ACID/BASE:	ICE / COOL	OTHER:	DATE	TIME
<u>H802359</u>																										
<u>18</u>	<u>BHG-1</u>	<u>9</u>				<u>5</u>																<u>2</u>			<u>08/22</u>	<u>1645</u>
<u>19</u>	<u>BHG-2</u>	<u>1</u>																								
<u>20</u>	<u>BHG-3</u>	<u>1</u>																								
<u>21</u>	<u>BHG-4</u>	<u>1</u>																								
<u>22</u>	<u>BHG-14</u>	<u>1</u>																								

PLEASE NOTE: Liability and Damages. Cardinal's liability and client's exclusive remedy for any claim arising whether based in contract or tort, shall be limited to the amount paid by the client for the analyses. All claims including those for negligence and any other cause whatsoever shall be deemed waived unless made in writing and received by Cardinal within 30 days after completion of the applicable service. In no event shall Cardinal be liable for incidental or consequential damages, including without limitation, business interruptions, loss of use, or loss of profits incurred by client, its subsidiaries, affiliates or successors arising out of or related to the performance of services hereunder by Cardinal, regardless of whether such claim is based upon any of the above stated reasons or otherwise.

Relinquished By: <u>[Signature]</u>		Date: <u>8-23-18</u>	Received By: <u>[Signature]</u>	Phone Result: <input type="checkbox"/> Yes <input type="checkbox"/> No	Add'l Phone #:
Time: <u>11:40</u>				Fax Result: <input type="checkbox"/> Yes <input type="checkbox"/> No	Add'l Fax #:
Relinquished By:		Date:	Received By:	REMARKS:	
Time:					
Delivered By: (Circle One)			Sample Condition	CHECKED BY: (Initials)	
Sampler <u>40PS</u> - Bus - Other: <u>0.5c #97</u>			Cool <input checked="" type="checkbox"/> Yes <input type="checkbox"/> No Intact <input type="checkbox"/> Yes <input type="checkbox"/> No	<u>TO.</u>	

CHAIN-OF-CUSTODY AND ANALYSIS REQUEST

101 East Marland, Hobbs, NM 88240
(575) 393-2326 FAX (575) 393-2476

Company Name: <u>RISOL</u>				BILL TO				ANALYSIS REQUEST																			
Project Manager: <u>EACH THOMAS</u>				P.O. #:																							
Address:				Company:																							
City: State: Zip:				Attn:																							
Phone #: Fax #:				Address:																							
Project #: Project Owner:				City:																							
Project Name:				State: Zip:																							
Project Location: <u>MB#5</u>				Phone #:																							
Sampler Name: <u>JACOB MICKLE</u>				Fax #:																							
FOR LAB USE ONLY						MATRIX		PRESERV.		SAMPLING																	
Lab I.D.	Sample I.D.	(GRAB OR C)OMP.	# CONTAINERS	GROUNDWATER	WASTEWATER	SOIL	OIL	SLUDGE	OTHER :	ACID/BASE:	ICE / COOL	OTHER :	DATE	TIME	CHLORIDES	TPH	BTEX										
<u>H802359</u>													<u>08/22</u>	<u>1500</u>													
<u>23</u>	<u>BH7-1'</u>	<u>9</u>				<u>x</u>							<u>1</u>	<u>1</u>	<u>x</u>	<u>x</u>	<u>x</u>										
<u>24</u>	<u>BH7-2'</u>	<u>1</u>				<u>1</u>							<u>1</u>	<u>1</u>	<u>x</u>	<u>x</u>	<u>x</u>										
<u>25</u>	<u>BH7-3'</u>	<u>1</u>				<u>1</u>							<u>1</u>	<u>1</u>	<u>x</u>	<u>x</u>	<u>x</u>										
<u>26</u>	<u>BH7-13'</u>	<u>1</u>				<u>1</u>							<u>1</u>	<u>1</u>	<u>x</u>												

PLEASE NOTE: Liability and Damages. Cardinal's liability and client's exclusive remedy for any claim arising whether based in contract or tort, shall be limited to the amount paid by the client for the analyses. All claims including those for negligence and any other cause whatsoever shall be deemed waived unless made in writing and received by Cardinal within 30 days after completion of the applicable service. In no event shall Cardinal be liable for incidental or consequential damages, including without limitation, business interruptions, loss of use, or loss of profits incurred by client, its subsidiaries, affiliates or successors arising out of or related to the performance of services hereunder by Cardinal, regardless of whether such claim is based upon any of the above stated reasons or otherwise.

Relinquished By: <u>gm</u>		Date: <u>8-23-18</u>	Received By: <u>Jamara Oldaker</u>		Phone Result: <input type="checkbox"/> Yes <input type="checkbox"/> No		Add'l Phone #:	
		Time: <u>11:40</u>			Fax Result: <input type="checkbox"/> Yes <input type="checkbox"/> No		Add'l Fax #:	
Relinquished By:		Date:	Received By:		REMARKS:			
		Time:						
Delivered By: (Circle One)			Sample Condition		CHECKED BY: (Initials)			
Sampler <u>50UPS</u> - Bus - Other: <u>0.5c #97</u>			Cool Intact <input checked="" type="checkbox"/> Yes <input type="checkbox"/> No		<u>70</u>			