



MGU #002

CLOSURE REPORT

API No. 30-025-42628

Release Date: October 25, 2015

Unit Letter O, Section 21, Township 17 South, Range 32 East

July 5, 2016

Prepared by:

Laura Flores

Environmental Department
Diversified Field Service, Inc.

206 W. Snyder

Hobbs, NM 88240

Phone: (575)964-8394

Fax: (575)393-8396

Table of Contents

- 1 Introduction
- 2 Site Activities
- 3 Conclusion

FIGURES

- 1 – Soil Delineation

APPENDICES

Appendix I – Initial C-141

Appendix II – Soil Bore Installation Laboratory Analysis

Appendix III – Confirmatory Bottom Laboratory Analysis

Appendix IV – Site Photos

Appendix V – Final C-141

MGU #002

1 INTRODUCTION

Linn Energy (Linn) has retained Diversified Environmental (DFSI) to address environmental issues for the site detailed herein.

The site is located east of Maljamar, NM, in Lea County. The release resulted from a pin hole developing in a 2" steel line, impacting a two-track lease road and pasture area east of the site. A total of approximately ½ barrel of oil and produced water was released with none recovered. The impacted area is located within the lease road. An initial C-141 was submitted to the NMOCD on October 30, 2015 (Appendix I).

2 SITE ACTIVITIES

On October 29, 2015, DFSI personnel were on site to scrape the visibly impacted area. On November 6, 2015, DFSI personnel returned to the site to obtain samples within the leak area (Figure 1). Seven samples were obtained and field sampled for chloride levels, as well as BTEX. The BTEX samples were performed using a Mini Rae Photoionization Detector (PID).

To further delineate the site, on November 19, 2015, DFSI personnel installed two soil bores to obtain confirmation samples. All clean field samples under NMOCD and BLM regulatory guidelines were submitted for laboratory analysis at Cardinal Laboratories of Hobbs, NM to obtain confirmation (Appendix II).

A work plan was submitted to BLM on January 19, 2016, and approved by BLM on January 20, 2016, with stipulations. Beginning June 9, 2016, DFSI personnel were on site to excavate the release area. Prior to backfilling, confirmatory samples taken at 1.5 ft at SP1 and 1 ft at the remaining six samples were submitted for analysis at Cardinal Laboratories of Hobbs, NM to obtain confirmation (Appendix III). The excavation was backfilled with clean, imported topsoil on the pasture area and caliche within the road to ground surface and contoured to the surrounding area (Appendix IV). Contaminated soil was properly disposed of at an NMOCD approved facility.

3 CONCLUSION

According to the U.S. Geological Survey and the NM Office of the State Engineer, depth to groundwater in the area averages 106 ft. bgs. Based on the report and work completed, any remaining chloride and BTEX components in the vadose zone will not affect groundwater beneath this site, with vegetation expected to return to normal; therefore, DFSI, on behalf of Linn, submits the final C-141 (Appendix V) and respectfully requests the closure of this regulatory file.

Soil Delineation

SP1										SP2										SP3									
Depth	CI-	PID	Lab CI-	GRO	DRO	B	T	E	X	Depth	CI-	PID	Lab CI-	GRO	DRO	B	T	E	X	Depth	CI-	PID	Lab CI-	GRO	DRO	B	T	E	X
SS	2,196	58.6								SS	88	0.4								SS	110	0.4							
1.5'	678	0	848	<10	<10	<0.05	<0.05	<0.05	<0.15	1'	209	10.7	256	<10	12.6	<0.05	<0.05	<0.05	<0.15	1'	173	0	176	<10	<10	<0.05	<0.05	<0.05	<0.15

SP4										SP5										SP6									
Depth	CI-	PID	Lab CI-	GRO	DRO	B	T	E	X	Depth	CI-	PID	Lab CI-	GRO	DRO	B	T	E	X	Depth	CI-	PID	Lab CI-	GRO	DRO	B	T	E	X
SS	7,062	35.4								SS	7,137	5								SS	174	1.5							
1'	117	0	48	<10	<10	<0.05	<0.05	<0.05	<0.15	1'	112	0	48	<10	<10	<0.05	<0.05	<0.05	<0.15	1'	266	0	160	<10	<10	<0.05	<0.05	<0.05	<0.15

SP7										SB1										SB2									
Depth	CI-	PID	Lab CI-	GRO	DRO	B	T	E	X	Depth	CI-	PID	Lab CI-	GRO	DRO	B	T	E	X	Depth	CI-	PID	Lab CI-	GRO	DRO	B	T	E	X
SS	8,995	115								SS	7,000	25.3								SS	8,500	15.5							
1'	87	0	<16	<10	<10	<0.05	<0.05	<0.05	<0.15	1'	570	0.5	576	<10	<10	<0.05	<0.05	<0.05	<0.15	1'	224	1.1	<16	<10	<10	<0.05	<0.05	<0.05	<0.15
										2'	503	0.8	448	<10	<10	<0.05	<0.05	<0.05	<0.15	2'	213	0.5	64	<10	<10	<0.05	<0.05	<0.05	<0.15

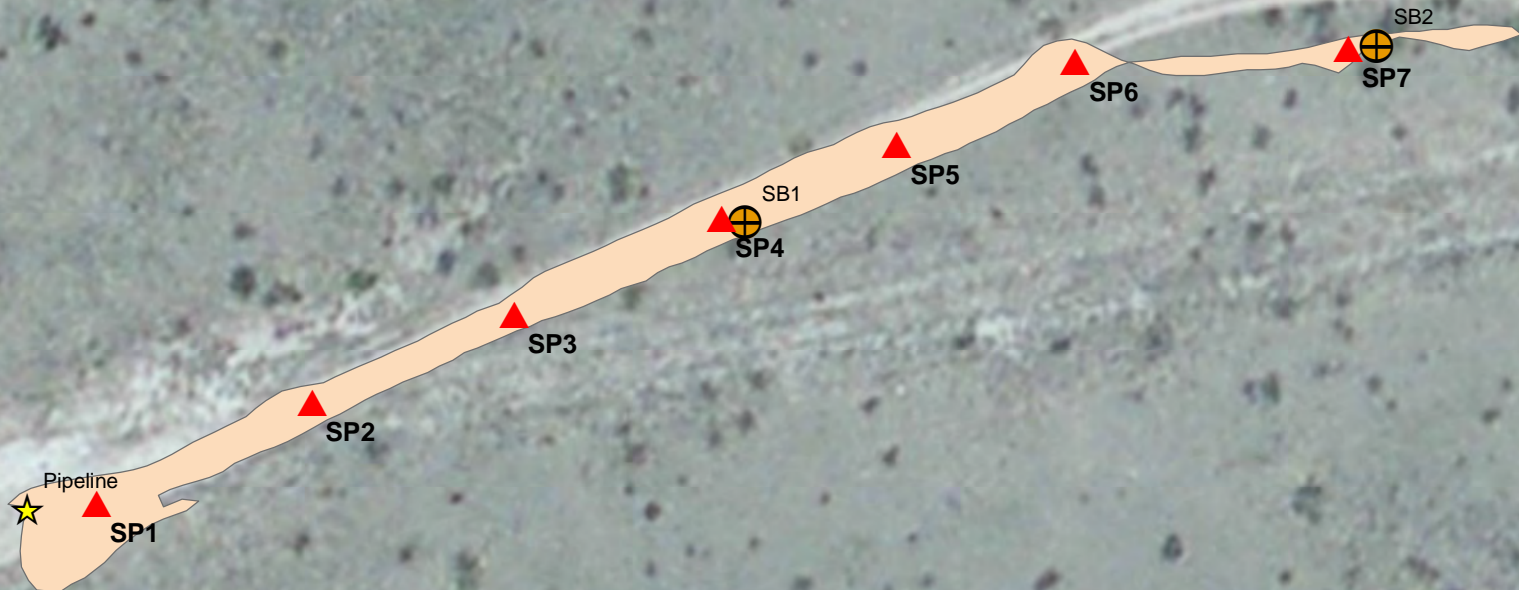

Legend

- ▲ Sample Points
- Soil Bores
- ★ Source
- Oil and Produced Water (4893 sq ft)

Source: Esri, DigitalGlobe, GeoEye, Earthstar Geographics, CNES/Airbus DS, USDA, USGS, AEX, Getmapping, Aerogrid, IGN, IGP, swisstopo, and the GIS User Community



Linn
MGU #002
Unit Letter O, Section 21, T17S, R32E
Lea County, NM
API #: 30-025-42628

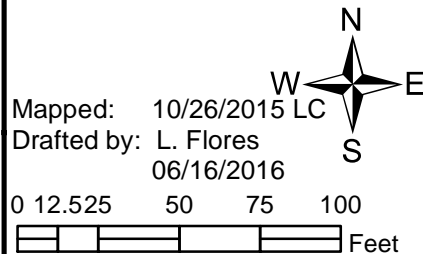

Appendix I

INITIAL C-141

Diversified Field Service, Inc.
206 W. Snyder
Hobbs, NM 88240
(575) 964-8394

District I
1625 N. French Dr., Hobbs, NM 88240
District II
811 S. First St., Artesia, NM 88210
District III
1000 Rio Brazos Road, Aztec, NM 87410
District IV
1220 S. St. Francis Dr., Santa Fe, NM 87505

State of New Mexico
Energy Minerals and Natural Resources

Oil Conservation Division
1220 South St. Francis Dr.
Santa Fe, NM 87505

Form C-141
Revised August 8, 2011

Submit 1 Copy to appropriate District Office in
accordance with 19.15.29 NMAC.

Release Notification and Corrective Action

OPERATOR

☒ Initial Report ☐ Final Report

Name of Company	Linn Operating Inc.	Contact	E.L. Gonzales
Address	2130 W Bender Blvd Hobbs, NM 88240	Telephone No.	575-738-1739
Facility Name	MGU #2	Facility Type	Injection
Surface Owner	Federal	Mineral Owner	API No. 30-025-42628

LOCATION OF RELEASE

Unit Letter	Section	Township	Range	Feet from the	North/South Line	Feet from the	East/West Line	County
O	21	17S	32E	400	South	2100	East	Lea

Latitude 32.8139238102197 Longitude -103.769739540332

NATURE OF RELEASE

Type of Release	Oil	Volume of Release	1/2 bbl	Volume Recovered	0
Source of Release	Steel Pipeline	Date and Hour of Occurrence	10/25/2015	Date and Hour of Discovery	10/25/2015 10:00am
Was Immediate Notice Given?	<input type="checkbox"/> Yes <input type="checkbox"/> No <input type="checkbox"/> Not Required	If YES, To Whom?			
By Whom?	Date and Hour				
Was a Watercourse Reached?	<input type="checkbox"/> Yes <input checked="" type="checkbox"/> No	If YES, Volume Impacting the Watercourse.			

If a Watercourse was Impacted, Describe Fully.*

Describe Cause of Problem and Remedial Action Taken.* Today while running route there was an apparent release of fluid that was 1000 ft. west of the MGU #2 wellhead+B6 alongside of the road coming from a 2 inch steel flow line. Once the line was traced we found that it belonged to Linn and we proceeded to shut in the wells that the line belonged to. Once shut off we were able to find that the 2 inch steel line and a small pin hole the fluid was coming out of.

Describe Area Affected and Cleanup Action Taken.* The release was approximately 15ft at the widest point and 10ft long. A small amount of fluid ran east downhill along the road that was no more than 10 ft. long but no longer than 4 inches wide. The release, for the most part stayed on the road with a small amount being in the pasture. The fluid released was oil and was about half a barrel in total with zero barrels being recovered.

I hereby certify that the information given above is true and complete to the best of my knowledge and understand that pursuant to NMOCD rules and regulations all operators are required to report and/or file certain release notifications and perform corrective actions for releases which may endanger public health or the environment. The acceptance of a C-141 report by the NMOCD marked as "Final Report" does not relieve the operator of liability should their operations have failed to adequately investigate and remediate contamination that pose a threat to ground water, surface water, human health or the environment. In addition, NMOCD acceptance of a C-141 report does not relieve the operator of responsibility for compliance with any other federal, state, or local laws and/or regulations.

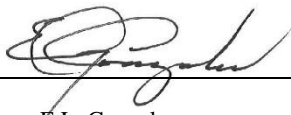
Signature: 	OIL CONSERVATION DIVISION		
Printed Name: E.L. Gonzales	Approved by Environmental Specialist:		
Title: Production Supervisor	Approval Date:	Expiration Date:	
E-mail Address: elgonzales@linenergy.com	Conditions of Approval:		Attached <input type="checkbox"/>
Date: 10/30/2015	Phone: 505-504-8002		

* Attach Additional Sheets If Necessary

Appendix II

SOIL BORE INSTALLATION LABORATORY ANALYSIS

Diversified Field Service, Inc.
206 W. Snyder
Hobbs, NM 88240
(575) 964-8394

January 12, 2016

JOE HERNANDEZ

LINN OPERATING-HOBBS

2130 W. BENDER

HOBBS, NM 88240

RE: MGU #2

Enclosed are the results of analyses for samples received by the laboratory on 01/06/16 8:25.

Cardinal Laboratories is accredited through Texas NELAP under certificate number T104704398-13-5. Accreditation applies to drinking water, non-potable water and solid and chemical materials. All accredited analytes are denoted by an asterisk (*). For a complete list of accredited analytes and matrices visit the TCEQ website at www.tceq.texas.gov/field/qa/lab_accred_certif.html.

Cardinal Laboratories is accredited through the State of Colorado Department of Public Health and Environment for:

Method EPA 552.2	Haloacetic Acids (HAA-5)
Method EPA 524.2	Total Trihalomethanes (TTHM)
Method EPA 524.4	Regulated VOCs (V1, V2, V3)

Accreditation applies to public drinking water matrices.

This report meets NELAP requirements and is made up of a cover page, analytical results, and a copy of the original chain-of-custody. If you have any questions concerning this report, please feel free to contact me.

Sincerely,



Celey D. Keene

Lab Director/Quality Manager

Analytical Results For:

LINN OPERATING-HOBBS
 JOE HERNANDEZ
 2130 W. BENDER
 HOBBS NM, 88240
 Fax To: (575) 738-1740

Received:	01/06/2016	Sampling Date:	01/05/2016
Reported:	01/12/2016	Sampling Type:	Soil
Project Name:	MGU #2	Sampling Condition:	Cool & Intact
Project Number:	NONE GIVEN	Sample Received By:	Jodi Henson
Project Location:	NOT GIVEN		

Sample ID: SOIL BORE 1 @ 1' (H600022-01)

BTX 8021B			mg/kg		Analyzed By: MS				
Analyte	Result	Reporting Limit	Analyzed	Method Blank	BS	% Recovery	True Value QC	RPD	Qualifier
Benzene*	<0.050	0.050	01/11/2016	ND	1.77	88.3	2.00	10.9	
Toluene*	<0.050	0.050	01/11/2016	ND	1.75	87.6	2.00	10.0	
Ethylbenzene*	<0.050	0.050	01/11/2016	ND	1.60	79.8	2.00	11.1	
Total Xylenes*	<0.150	0.150	01/11/2016	ND	4.93	82.1	6.00	10.1	
Total BTX	<0.300	0.300	01/11/2016	ND					

Surrogate: 4-Bromofluorobenzene (PID) 100 % 73.6-140

Chloride, SM4500Cl-B			mg/kg		Analyzed By: CK				
Analyte	Result	Reporting Limit	Analyzed	Method Blank	BS	% Recovery	True Value QC	RPD	Qualifier
Chloride	576	16.0	01/06/2016	ND	416	104	400	3.77	

TPH 8015M			mg/kg		Analyzed By: MS				
Analyte	Result	Reporting Limit	Analyzed	Method Blank	BS	% Recovery	True Value QC	RPD	Qualifier
GRO C6-C10	<10.0	10.0	01/09/2016	ND	187	93.4	200	6.06	
DRO >C10-C28	<10.0	10.0	01/09/2016	ND	198	99.1	200	2.98	

Surrogate: 1-Chlorooctane 65.7 % 35-147

Surrogate: 1-Chlorooctadecane 70.4 % 28-171

Cardinal Laboratories

*=Accredited Analyte

PLEASE NOTE: Liability and Damages. Cardinal's liability and client's exclusive remedy for any claim arising, whether based in contract or tort, shall be limited to the amount paid by client for analyses. All claims, including those for negligence and any other cause whatsoever shall be deemed waived unless made in writing and received by Cardinal within thirty (30) days after completion of the applicable service. In no event shall Cardinal be liable for incidental or consequential damages, including, without limitation, business interruptions, loss of use, or loss of profits incurred by client, its subsidiaries, affiliates or successors arising out of or related to the performance of the services hereunder by Cardinal, regardless of whether such claim is based upon any of the above stated reasons or otherwise. Results relate only to the samples identified above. This report shall not be reproduced except in full with written approval of Cardinal Laboratories.



Celey D. Keene, Lab Director/Quality Manager

Analytical Results For:

LINN OPERATING-HOBBS
 JOE HERNANDEZ
 2130 W. BENDER
 HOBBS NM, 88240
 Fax To: (575) 738-1740

Received: 01/06/2016
 Reported: 01/12/2016
 Project Name: MGU #2
 Project Number: NONE GIVEN
 Project Location: NOT GIVEN

Sampling Date: 01/05/2016
 Sampling Type: Soil
 Sampling Condition: Cool & Intact
 Sample Received By: Jodi Henson

Sample ID: SOIL BORE 1 @ 2' (H600022-02)

BTEx 8021B			mg/kg		Analyzed By: MS					
Analyte	Result	Reporting Limit	Analyzed	Method Blank	BS	% Recovery	True Value QC	RPD	Qualifier	
Benzene*	<0.050	0.050	01/11/2016	ND	1.77	88.3	2.00	10.9		
Toluene*	<0.050	0.050	01/11/2016	ND	1.75	87.6	2.00	10.0		
Ethylbenzene*	<0.050	0.050	01/11/2016	ND	1.60	79.8	2.00	11.1		
Total Xylenes*	<0.150	0.150	01/11/2016	ND	4.93	82.1	6.00	10.1		
Total BTEx	<0.300	0.300	01/11/2016	ND						

Surrogate: 4-Bromofluorobenzene (PID) 101 % 73.6-140

Chloride, SM4500CI-B		mg/kg		Analyzed By: CK					
Analyte	Result	Reporting Limit	Analyzed	Method Blank	BS	% Recovery	True Value QC	RPD	Qualifier
Chloride	448	16.0	01/06/2016	ND	416	104	400	3.77	

TPH 8015M		mg/kg		Analyzed By: MS					
Analyte	Result	Reporting Limit	Analyzed	Method Blank	BS	% Recovery	True Value QC	RPD	Qualifier
GRO C6-C10	<10.0	10.0	01/09/2016	ND	187	93.4	200	6.06	
DRO >C10-C28	<10.0	10.0	01/09/2016	ND	198	99.1	200	2.98	

Surrogate: 1-Chlorooctane 65.2 % 35-147

Surrogate: 1-Chlorooctadecane 69.5 % 28-171

Cardinal Laboratories

*=Accredited Analyte

PLEASE NOTE: Liability and Damages. Cardinal's liability and client's exclusive remedy for any claim arising, whether based in contract or tort, shall be limited to the amount paid by client for analyses. All claims, including those for negligence and any other cause whatsoever shall be deemed waived unless made in writing and received by Cardinal within thirty (30) days after completion of the applicable service. In no event shall Cardinal be liable for incidental or consequential damages, including, without limitation, business interruptions, loss of use, or loss of profits incurred by client, its subsidiaries, affiliates or successors arising out of or related to the performance of the services hereunder by Cardinal, regardless of whether such claim is based upon any of the above stated reasons or otherwise. Results relate only to the samples identified above. This report shall not be reproduced except in full with written approval of Cardinal Laboratories.



Celey D. Keene, Lab Director/Quality Manager

Analytical Results For:

LINN OPERATING-HOBBS
 JOE HERNANDEZ
 2130 W. BENDER
 HOBBS NM, 88240
 Fax To: (575) 738-1740

Received: 01/06/2016
 Reported: 01/12/2016
 Project Name: MGU #2
 Project Number: NONE GIVEN
 Project Location: NOT GIVEN

Sampling Date: 01/05/2016
 Sampling Type: Soil
 Sampling Condition: Cool & Intact
 Sample Received By: Jodi Henson

Sample ID: SOIL BORE 2 @ 1' (H600022-03)

BTEx 8021B			mg/kg		Analyzed By: MS					
Analyte	Result	Reporting Limit	Analyzed	Method Blank	BS	% Recovery	True Value QC	RPD	Qualifier	
Benzene*	<0.050	0.050	01/11/2016	ND	1.77	88.3	2.00	10.9		
Toluene*	<0.050	0.050	01/11/2016	ND	1.75	87.6	2.00	10.0		
Ethylbenzene*	<0.050	0.050	01/11/2016	ND	1.60	79.8	2.00	11.1		
Total Xylenes*	<0.150	0.150	01/11/2016	ND	4.93	82.1	6.00	10.1		
Total BTEx	<0.300	0.300	01/11/2016	ND						

Surrogate: 4-Bromofluorobenzene (PID) 101 % 73.6-140

Chloride, SM4500CI-B		mg/kg		Analyzed By: CK					
Analyte	Result	Reporting Limit	Analyzed	Method Blank	BS	% Recovery	True Value QC	RPD	Qualifier
Chloride	<16.0	16.0	01/06/2016	ND	416	104	400	3.77	

TPH 8015M		mg/kg		Analyzed By: MS					
Analyte	Result	Reporting Limit	Analyzed	Method Blank	BS	% Recovery	True Value QC	RPD	Qualifier
GRO C6-C10	<10.0	10.0	01/09/2016	ND	187	93.4	200	6.06	
DRO >C10-C28	<10.0	10.0	01/09/2016	ND	198	99.1	200	2.98	

Surrogate: 1-Chlorooctane 68.2 % 35-147

Surrogate: 1-Chlorooctadecane 73.1 % 28-171

Cardinal Laboratories

*=Accredited Analyte

PLEASE NOTE: Liability and Damages. Cardinal's liability and client's exclusive remedy for any claim arising, whether based in contract or tort, shall be limited to the amount paid by client for analyses. All claims, including those for negligence and any other cause whatsoever shall be deemed waived unless made in writing and received by Cardinal within thirty (30) days after completion of the applicable service. In no event shall Cardinal be liable for incidental or consequential damages, including, without limitation, business interruptions, loss of use, or loss of profits incurred by client, its subsidiaries, affiliates or successors arising out of or related to the performance of the services hereunder by Cardinal, regardless of whether such claim is based upon any of the above stated reasons or otherwise. Results relate only to the samples identified above. This report shall not be reproduced except in full with written approval of Cardinal Laboratories.



Celey D. Keene, Lab Director/Quality Manager

Analytical Results For:

 LINN OPERATING-HOBBS
 JOE HERNANDEZ
 2130 W. BENDER
 HOBBS NM, 88240
 Fax To: (575) 738-1740

 Received: 01/06/2016
 Reported: 01/12/2016
 Project Name: MGU #2
 Project Number: NONE GIVEN
 Project Location: NOT GIVEN

 Sampling Date: 01/05/2016
 Sampling Type: Soil
 Sampling Condition: Cool & Intact
 Sample Received By: Jodi Henson

Sample ID: SOIL BORE 2 @ 2' (H600022-04)

BTEx 8021B		mg/kg		Analyzed By: MS					
Analyte	Result	Reporting Limit	Analyzed	Method Blank	BS	% Recovery	True Value QC	RPD	Qualifier
Benzene*	<0.050	0.050	01/11/2016	ND	1.77	88.3	2.00	10.9	
Toluene*	<0.050	0.050	01/11/2016	ND	1.75	87.6	2.00	10.0	
Ethylbenzene*	<0.050	0.050	01/11/2016	ND	1.60	79.8	2.00	11.1	
Total Xylenes*	<0.150	0.150	01/11/2016	ND	4.93	82.1	6.00	10.1	
Total BTEx	<0.300	0.300	01/11/2016	ND					

Surrogate: 4-Bromofluorobenzene (PID) 99.5 % 73.6-140

Chloride, SM4500Cl-B		mg/kg		Analyzed By: CK					
Analyte	Result	Reporting Limit	Analyzed	Method Blank	BS	% Recovery	True Value QC	RPD	Qualifier
Chloride	64.0	16.0	01/06/2016	ND	416	104	400	3.77	

TPH 8015M		mg/kg		Analyzed By: MS					
Analyte	Result	Reporting Limit	Analyzed	Method Blank	BS	% Recovery	True Value QC	RPD	Qualifier
GRO C6-C10	<10.0	10.0	01/09/2016	ND	187	93.4	200	6.06	
DRO >C10-C28	<10.0	10.0	01/09/2016	ND	198	99.1	200	2.98	

Surrogate: 1-Chlorooctane 57.3 % 35-147

Surrogate: 1-Chlorooctadecane 61.0 % 28-171

Cardinal Laboratories

*=Accredited Analyte

PLEASE NOTE: Liability and Damages. Cardinal's liability and client's exclusive remedy for any claim arising, whether based in contract or tort, shall be limited to the amount paid by client for analyses. All claims, including those for negligence and any other cause whatsoever shall be deemed waived unless made in writing and received by Cardinal within thirty (30) days after completion of the applicable service. In no event shall Cardinal be liable for incidental or consequential damages, including, without limitation, business interruptions, loss of use, or loss of profits incurred by client, its subsidiaries, affiliates or successors arising out of or related to the performance of the services hereunder by Cardinal, regardless of whether such claim is based upon any of the above stated reasons or otherwise. Results relate only to the samples identified above. This report shall not be reproduced except in full with written approval of Cardinal Laboratories.



Celey D. Keene, Lab Director/Quality Manager

Notes and Definitions

ND	Analyte NOT DETECTED at or above the reporting limit
RPD	Relative Percent Difference
**	Samples not received at proper temperature of 6°C or below.
***	Insufficient time to reach temperature.
-	Chloride by SM4500Cl-B does not require samples be received at or below 6°C Samples reported on an as received basis (wet) unless otherwise noted on report

Cardinal Laboratories

*=Accredited Analyte

PLEASE NOTE: Liability and Damages. Cardinal's liability and client's exclusive remedy for any claim arising, whether based in contract or tort, shall be limited to the amount paid by client for analyses. All claims, including those for negligence and any other cause whatsoever shall be deemed waived unless made in writing and received by Cardinal within thirty (30) days after completion of the applicable service. In no event shall Cardinal be liable for incidental or consequential damages, including, without limitation, business interruptions, loss of use, or loss of profits incurred by client, its subsidiaries, affiliates or successors arising out of or related to the performance of the services hereunder by Cardinal, regardless of whether such claim is based upon any of the above stated reasons or otherwise. Results relate only to the samples identified above. This report shall not be reproduced except in full with written approval of Cardinal Laboratories.



Celey D. Keene, Lab Director/Quality Manager

Appendix III

CONFIRMATORY BOTTOM LABORATORY ANALYSIS

Diversified Field Service, Inc.
206 W. Snyder
Hobbs, NM 88240
(575) 964-8394



PHONE (575) 393-2326 ° 101 E. MARLAND ° HOBBS, NM 88240

June 15, 2016

RICK RICKMAN

LINN OPERATING-HOBBS

2130 W. BENDER

HOBBS, NM 88240

RE: MGU #2

Enclosed are the results of analyses for samples received by the laboratory on 06/14/16 12:35.

Cardinal Laboratories is accredited through Texas NELAP under certificate number T104704398-15-7. Accreditation applies to drinking water, non-potable water and solid and chemical materials. All accredited analytes are denoted by an asterisk (*). For a complete list of accredited analytes and matrices visit the TCEQ website at www.tceq.texas.gov/field/qa/lab_accred_certif.html.

Cardinal Laboratories is accredited through the State of Colorado Department of Public Health and Environment for:

Method EPA 552.2	Haloacetic Acids (HAA-5)
Method EPA 524.2	Total Trihalomethanes (TTHM)
Method EPA 524.4	Regulated VOCs (V1, V2, V3)

Accreditation applies to public drinking water matrices.

This report meets NELAP requirements and is made up of a cover page, analytical results, and a copy of the original chain-of-custody. If you have any questions concerning this report, please feel free to contact me.

Sincerely,

A handwritten signature in black ink that reads "Celey D. Keene". The signature is written in a cursive, flowing style.

Celey D. Keene

Lab Director/Quality Manager

Analytical Results For:

LINN OPERATING-HOBBS
 RICK RICKMAN
 2130 W. BENDER
 HOBBS NM, 88240
 Fax To: (575) 738-1740

Received:	06/14/2016	Sampling Date:	06/14/2016
Reported:	06/15/2016	Sampling Type:	Soil
Project Name:	MGU #2	Sampling Condition:	Cool & Intact
Project Number:	NONE GIVEN	Sample Received By:	Jodi Henson
Project Location:	NOT GIVEN		

Sample ID: SAMPLE PT. 1 @ 1.5' (H601299-01)

BTEX 8260B		mg/L		Analyzed By: MS					
Analyte	Result	Reporting Limit	Analyzed	Method Blank	BS	% Recovery	True Value QC	RPD	Qualifier
Benzene*	<0.050	0.050	06/14/2016	ND	1.73	86.4	2.00	6.97	
Toluene*	<0.050	0.050	06/14/2016	ND	2.22	111	2.00	6.28	
Ethylbenzene*	<0.050	0.050	06/14/2016	ND	2.18	109	2.00	6.23	
Total Xylenes*	<0.150	0.150	06/14/2016	ND	7.27	121	6.00	6.51	
Total BTEX	<0.300	0.300	06/14/2016	ND					

Surrogate: Dibromofluoromethane 96.8 % 86.5-122

Surrogate: Toluene-d8 108 % 85.7-112

Surrogate: 4-Bromofluorobenzene 90.3 % 86.3-117

Chloride, SM4500Cl-B		mg/kg		Analyzed By: AP					
Analyte	Result	Reporting Limit	Analyzed	Method Blank	BS	% Recovery	True Value QC	RPD	Qualifier
Chloride	848	16.0	06/14/2016	ND	416	104	400	3.77	

TPH 8015M		mg/kg		Analyzed By: MS					
Analyte	Result	Reporting Limit	Analyzed	Method Blank	BS	% Recovery	True Value QC	RPD	Qualifier
GRO C6-C10	<10.0	10.0	06/14/2016	ND	211	106	200	2.90	
DRO >C10-C28	<10.0	10.0	06/14/2016	ND	208	104	200	0.505	

Surrogate: 1-Chlorooctane 68.7 % 35-147

Surrogate: 1-Chlorooctadecane 73.8 % 28-171

Cardinal Laboratories

*=Accredited Analyte

PLEASE NOTE: Liability and Damages. Cardinal's liability and client's exclusive remedy for any claim arising, whether based in contract or tort, shall be limited to the amount paid by client for analyses. All claims, including those for negligence and any other cause whatsoever shall be deemed waived unless made in writing and received by Cardinal within thirty (30) days after completion of the applicable service. In no event shall Cardinal be liable for incidental or consequential damages, including, without limitation, business interruptions, loss of use, or loss of profits incurred by client, its subsidiaries, affiliates or successors arising out of or related to the performance of the services hereunder by Cardinal, regardless of whether such claim is based upon any of the above stated reasons or otherwise. Results relate only to the samples identified above. This report shall not be reproduced except in full with written approval of Cardinal Laboratories.



Celey D. Keene, Lab Director/Quality Manager

Analytical Results For:

LINN OPERATING-HOBBS
 RICK RICKMAN
 2130 W. BENDER
 HOBBS NM, 88240
 Fax To: (575) 738-1740

Received: 06/14/2016
 Reported: 06/15/2016
 Project Name: MGU #2
 Project Number: NONE GIVEN
 Project Location: NOT GIVEN

Sampling Date: 06/14/2016
 Sampling Type: Soil
 Sampling Condition: Cool & Intact
 Sample Received By: Jodi Henson

Sample ID: SAMPLE PT. 2 @ 1' (H601299-02)

BTX 8260B		mg/L		Analyzed By: MS					
Analyte	Result	Reporting Limit	Analyzed	Method Blank	BS	% Recovery	True Value QC	RPD	Qualifier
Benzene*	<0.050	0.050	06/15/2016	ND	1.73	86.4	2.00	6.97	
Toluene*	<0.050	0.050	06/15/2016	ND	2.22	111	2.00	6.28	
Ethylbenzene*	<0.050	0.050	06/15/2016	ND	2.18	109	2.00	6.23	
Total Xylenes*	<0.150	0.150	06/15/2016	ND	7.27	121	6.00	6.51	
Total BTX	<0.300	0.300	06/15/2016	ND					

Surrogate: Dibromofluoromethane 98.9 % 86.5-122
 Surrogate: Toluene-d8 106 % 85.7-112
 Surrogate: 4-Bromofluorobenzene 92.9 % 86.3-117

Chloride, SM4500Cl-B		mg/kg		Analyzed By: AP						
Analyte	Result	Reporting Limit	Analyzed	Method Blank	BS	% Recovery	True Value QC	RPD	Qualifier	
Chloride	256	16.0	06/14/2016	ND	416	104	400	3.77		

TPH 8015M		mg/kg		Analyzed By: MS					
Analyte	Result	Reporting Limit	Analyzed	Method Blank	BS	% Recovery	True Value QC	RPD	Qualifier
GRO C6-C10	<10.0	10.0	06/15/2016	ND	211	106	200	2.90	
DRO >C10-C28	12.6	10.0	06/15/2016	ND	208	104	200	0.505	

Surrogate: 1-Chlorooctane 85.5 % 35-147
 Surrogate: 1-Chlorooctadecane 88.9 % 28-171

Cardinal Laboratories

*=Accredited Analyte

PLEASE NOTE: Liability and Damages. Cardinal's liability and client's exclusive remedy for any claim arising, whether based in contract or tort, shall be limited to the amount paid by client for analyses. All claims, including those for negligence and any other cause whatsoever shall be deemed waived unless made in writing and received by Cardinal within thirty (30) days after completion of the applicable service. In no event shall Cardinal be liable for incidental or consequential damages, including, without limitation, business interruptions, loss of use, or loss of profits incurred by client, its subsidiaries, affiliates or successors arising out of or related to the performance of the services hereunder by Cardinal, regardless of whether such claim is based upon any of the above stated reasons or otherwise. Results relate only to the samples identified above. This report shall not be reproduced except in full with written approval of Cardinal Laboratories.



Celey D. Keene, Lab Director/Quality Manager

Analytical Results For:

LINN OPERATING-HOBBS
 RICK RICKMAN
 2130 W. BENDER
 HOBBS NM, 88240
 Fax To: (575) 738-1740

Received: 06/14/2016
 Reported: 06/15/2016
 Project Name: MGU #2
 Project Number: NONE GIVEN
 Project Location: NOT GIVEN

Sampling Date: 06/14/2016
 Sampling Type: Soil
 Sampling Condition: Cool & Intact
 Sample Received By: Jodi Henson

Sample ID: SAMPLE PT. 3 @ 1' (H601299-03)

BTEX 8260B		mg/L		Analyzed By: MS					
Analyte	Result	Reporting Limit	Analyzed	Method Blank	BS	% Recovery	True Value QC	RPD	Qualifier
Benzene*	<0.050	0.050	06/14/2016	ND	1.73	86.4	2.00	6.97	
Toluene*	<0.050	0.050	06/14/2016	ND	2.22	111	2.00	6.28	
Ethylbenzene*	<0.050	0.050	06/14/2016	ND	2.18	109	2.00	6.23	
Total Xylenes*	<0.150	0.150	06/14/2016	ND	7.27	121	6.00	6.51	
Total BTEX	<0.300	0.300	06/14/2016	ND					

Surrogate: Dibromofluoromethane 98.3 % 86.5-122
Surrogate: Toluene-d8 110 % 85.7-112
Surrogate: 4-Bromofluorobenzene 91.9 % 86.3-117

Chloride, SM4500Cl-B		mg/kg		Analyzed By: AP						
Analyte	Result	Reporting Limit	Analyzed	Method Blank	BS	% Recovery	True Value QC	RPD	Qualifier	
Chloride	176	16.0	06/14/2016	ND	416	104	400	3.77		

TPH 8015M		mg/kg		Analyzed By: MS					
Analyte	Result	Reporting Limit	Analyzed	Method Blank	BS	% Recovery	True Value QC	RPD	Qualifier
GRO C6-C10	<10.0	10.0	06/15/2016	ND	211	106	200	2.90	
DRO >C10-C28	<10.0	10.0	06/15/2016	ND	208	104	200	0.505	

Surrogate: 1-Chlorooctane 66.8 % 35-147
Surrogate: 1-Chlorooctadecane 64.3 % 28-171

Cardinal Laboratories

*=Accredited Analyte

PLEASE NOTE: Liability and Damages. Cardinal's liability and client's exclusive remedy for any claim arising, whether based in contract or tort, shall be limited to the amount paid by client for analyses. All claims, including those for negligence and any other cause whatsoever shall be deemed waived unless made in writing and received by Cardinal within thirty (30) days after completion of the applicable service. In no event shall Cardinal be liable for incidental or consequential damages, including, without limitation, business interruptions, loss of use, or loss of profits incurred by client, its subsidiaries, affiliates or successors arising out of or related to the performance of the services hereunder by Cardinal, regardless of whether such claim is based upon any of the above stated reasons or otherwise. Results relate only to the samples identified above. This report shall not be reproduced except in full with written approval of Cardinal Laboratories.



Celey D. Keene, Lab Director/Quality Manager

Analytical Results For:

LINN OPERATING-HOBBS
 RICK RICKMAN
 2130 W. BENDER
 HOBBS NM, 88240
 Fax To: (575) 738-1740

Received: 06/14/2016
 Reported: 06/15/2016
 Project Name: MGU #2
 Project Number: NONE GIVEN
 Project Location: NOT GIVEN

Sampling Date: 06/14/2016
 Sampling Type: Soil
 Sampling Condition: Cool & Intact
 Sample Received By: Jodi Henson

Sample ID: SAMPLE PT. 4 @ 1' (H601299-04)

BTEX 8260B		mg/L		Analyzed By: MS					
Analyte	Result	Reporting Limit	Analyzed	Method Blank	BS	% Recovery	True Value QC	RPD	Qualifier
Benzene*	<0.050	0.050	06/14/2016	ND	1.73	86.4	2.00	6.97	
Toluene*	<0.050	0.050	06/14/2016	ND	2.22	111	2.00	6.28	
Ethylbenzene*	<0.050	0.050	06/14/2016	ND	2.18	109	2.00	6.23	
Total Xylenes*	<0.150	0.150	06/14/2016	ND	7.27	121	6.00	6.51	
Total BTEX	<0.300	0.300	06/14/2016	ND					

Surrogate: Dibromofluoromethane 95.7 % 86.5-122
 Surrogate: Toluene-d8 110 % 85.7-112
 Surrogate: 4-Bromofluorobenzene 92.9 % 86.3-117

Chloride, SM4500Cl-B		mg/kg		Analyzed By: AP						
Analyte	Result	Reporting Limit	Analyzed	Method Blank	BS	% Recovery	True Value QC	RPD	Qualifier	
Chloride	48.0	16.0	06/14/2016	ND	416	104	400	3.77		

TPH 8015M		mg/kg		Analyzed By: MS					
Analyte	Result	Reporting Limit	Analyzed	Method Blank	BS	% Recovery	True Value QC	RPD	Qualifier
GRO C6-C10	<10.0	10.0	06/15/2016	ND	211	106	200	2.90	
DRO >C10-C28	<10.0	10.0	06/15/2016	ND	208	104	200	0.505	

Surrogate: 1-Chlorooctane 79.4 % 35-147
 Surrogate: 1-Chlorooctadecane 75.9 % 28-171

Cardinal Laboratories

*=Accredited Analyte

PLEASE NOTE: Liability and Damages. Cardinal's liability and client's exclusive remedy for any claim arising, whether based in contract or tort, shall be limited to the amount paid by client for analyses. All claims, including those for negligence and any other cause whatsoever shall be deemed waived unless made in writing and received by Cardinal within thirty (30) days after completion of the applicable service. In no event shall Cardinal be liable for incidental or consequential damages, including, without limitation, business interruptions, loss of use, or loss of profits incurred by client, its subsidiaries, affiliates or successors arising out of or related to the performance of the services hereunder by Cardinal, regardless of whether such claim is based upon any of the above stated reasons or otherwise. Results relate only to the samples identified above. This report shall not be reproduced except in full with written approval of Cardinal Laboratories.



Celey D. Keene, Lab Director/Quality Manager

Analytical Results For:

LINN OPERATING-HOBBS
 RICK RICKMAN
 2130 W. BENDER
 HOBBS NM, 88240
 Fax To: (575) 738-1740

Received: 06/14/2016
 Reported: 06/15/2016
 Project Name: MGU #2
 Project Number: NONE GIVEN
 Project Location: NOT GIVEN

Sampling Date: 06/14/2016
 Sampling Type: Soil
 Sampling Condition: Cool & Intact
 Sample Received By: Jodi Henson

Sample ID: SAMPLE PT. 5 @ 1' (H601299-05)

BTEX 8260B		mg/L		Analyzed By: MS					
Analyte	Result	Reporting Limit	Analyzed	Method Blank	BS	% Recovery	True Value QC	RPD	Qualifier
Benzene*	<0.050	0.050	06/14/2016	ND	1.73	86.4	2.00	6.97	
Toluene*	<0.050	0.050	06/14/2016	ND	2.22	111	2.00	6.28	
Ethylbenzene*	<0.050	0.050	06/14/2016	ND	2.18	109	2.00	6.23	
Total Xylenes*	<0.150	0.150	06/14/2016	ND	7.27	121	6.00	6.51	
Total BTEX	<0.300	0.300	06/14/2016	ND					

Surrogate: Dibromofluoromethane 96.7 % 86.5-122
 Surrogate: Toluene-d8 110 % 85.7-112
 Surrogate: 4-Bromofluorobenzene 92.5 % 86.3-117

Chloride, SM4500Cl-B		mg/kg		Analyzed By: AP						
Analyte	Result	Reporting Limit	Analyzed	Method Blank	BS	% Recovery	True Value QC	RPD	Qualifier	
Chloride	48.0	16.0	06/14/2016	ND	416	104	400	3.77		

TPH 8015M		mg/kg		Analyzed By: MS					
Analyte	Result	Reporting Limit	Analyzed	Method Blank	BS	% Recovery	True Value QC	RPD	Qualifier
GRO C6-C10	<10.0	10.0	06/15/2016	ND	211	106	200	2.90	
DRO >C10-C28	<10.0	10.0	06/15/2016	ND	208	104	200	0.505	

Surrogate: 1-Chlorooctane 77.5 % 35-147
 Surrogate: 1-Chlorooctadecane 82.2 % 28-171

Cardinal Laboratories

*=Accredited Analyte

PLEASE NOTE: Liability and Damages. Cardinal's liability and client's exclusive remedy for any claim arising, whether based in contract or tort, shall be limited to the amount paid by client for analyses. All claims, including those for negligence and any other cause whatsoever shall be deemed waived unless made in writing and received by Cardinal within thirty (30) days after completion of the applicable service. In no event shall Cardinal be liable for incidental or consequential damages, including, without limitation, business interruptions, loss of use, or loss of profits incurred by client, its subsidiaries, affiliates or successors arising out of or related to the performance of the services hereunder by Cardinal, regardless of whether such claim is based upon any of the above stated reasons or otherwise. Results relate only to the samples identified above. This report shall not be reproduced except in full with written approval of Cardinal Laboratories.



Celey D. Keene, Lab Director/Quality Manager

Analytical Results For:

LINN OPERATING-HOBBS
 RICK RICKMAN
 2130 W. BENDER
 HOBBS NM, 88240
 Fax To: (575) 738-1740

Received: 06/14/2016
 Reported: 06/15/2016
 Project Name: MGU #2
 Project Number: NONE GIVEN
 Project Location: NOT GIVEN

Sampling Date: 06/14/2016
 Sampling Type: Soil
 Sampling Condition: Cool & Intact
 Sample Received By: Jodi Henson

Sample ID: SAMPLE PT. 6 @ 1' (H601299-06)

BTEX 8260B		mg/L		Analyzed By: MS					
Analyte	Result	Reporting Limit	Analyzed	Method Blank	BS	% Recovery	True Value QC	RPD	Qualifier
Benzene*	<0.050	0.050	06/14/2016	ND	1.73	86.4	2.00	6.97	
Toluene*	<0.050	0.050	06/14/2016	ND	2.22	111	2.00	6.28	
Ethylbenzene*	<0.050	0.050	06/14/2016	ND	2.18	109	2.00	6.23	
Total Xylenes*	<0.150	0.150	06/14/2016	ND	7.27	121	6.00	6.51	
Total BTEX	<0.300	0.300	06/14/2016	ND					

Surrogate: Dibromofluoromethane 95.5 % 86.5-122

Surrogate: Toluene-d8 110 % 85.7-112

Surrogate: 4-Bromofluorobenzene 91.1 % 86.3-117

Chloride, SM4500Cl-B		mg/kg		Analyzed By: AP					
Analyte	Result	Reporting Limit	Analyzed	Method Blank	BS	% Recovery	True Value QC	RPD	Qualifier
Chloride	160	16.0	06/14/2016	ND	416	104	400	3.77	

TPH 8015M		mg/kg		Analyzed By: MS					
Analyte	Result	Reporting Limit	Analyzed	Method Blank	BS	% Recovery	True Value QC	RPD	Qualifier
GRO C6-C10	<10.0	10.0	06/15/2016	ND	211	106	200	2.90	
DRO >C10-C28	<10.0	10.0	06/15/2016	ND	208	104	200	0.505	

Surrogate: 1-Chlorooctane 87.7 % 35-147

Surrogate: 1-Chlorooctadecane 88.3 % 28-171

Cardinal Laboratories

*=Accredited Analyte

PLEASE NOTE: Liability and Damages. Cardinal's liability and client's exclusive remedy for any claim arising, whether based in contract or tort, shall be limited to the amount paid by client for analyses. All claims, including those for negligence and any other cause whatsoever shall be deemed waived unless made in writing and received by Cardinal within thirty (30) days after completion of the applicable service. In no event shall Cardinal be liable for incidental or consequential damages, including, without limitation, business interruptions, loss of use, or loss of profits incurred by client, its subsidiaries, affiliates or successors arising out of or related to the performance of the services hereunder by Cardinal, regardless of whether such claim is based upon any of the above stated reasons or otherwise. Results relate only to the samples identified above. This report shall not be reproduced except in full with written approval of Cardinal Laboratories.



Celey D. Keene, Lab Director/Quality Manager

Analytical Results For:

LINN OPERATING-HOBBS
 RICK RICKMAN
 2130 W. BENDER
 HOBBS NM, 88240
 Fax To: (575) 738-1740

Received: 06/14/2016
 Reported: 06/15/2016
 Project Name: MGU #2
 Project Number: NONE GIVEN
 Project Location: NOT GIVEN

Sampling Date: 06/14/2016
 Sampling Type: Soil
 Sampling Condition: Cool & Intact
 Sample Received By: Jodi Henson

Sample ID: SAMPLE PT. 7 @ 1' (H601299-07)

BTEX 8260B		mg/L		Analyzed By: MS					
Analyte	Result	Reporting Limit	Analyzed	Method Blank	BS	% Recovery	True Value QC	RPD	Qualifier
Benzene*	<0.050	0.050	06/14/2016	ND	1.73	86.4	2.00	6.97	
Toluene*	<0.050	0.050	06/14/2016	ND	2.22	111	2.00	6.28	
Ethylbenzene*	<0.050	0.050	06/14/2016	ND	2.18	109	2.00	6.23	
Total Xylenes*	<0.150	0.150	06/14/2016	ND	7.27	121	6.00	6.51	
Total BTEX	<0.300	0.300	06/14/2016	ND					

Surrogate: Dibromofluoromethane 97.7 % 86.5-122

Surrogate: Toluene-d8 109 % 85.7-112

Surrogate: 4-Bromofluorobenzene 90.3 % 86.3-117

Chloride, SM4500Cl-B		mg/kg		Analyzed By: AP						
Analyte	Result	Reporting Limit	Analyzed	Method Blank	BS	% Recovery	True Value QC	RPD	Qualifier	
Chloride	<16.0	16.0	06/14/2016	ND	416	104	400	3.77		

TPH 8015M		mg/kg		Analyzed By: MS					
Analyte	Result	Reporting Limit	Analyzed	Method Blank	BS	% Recovery	True Value QC	RPD	Qualifier
GRO C6-C10	<10.0	10.0	06/15/2016	ND	211	106	200	2.90	
DRO >C10-C28	<10.0	10.0	06/15/2016	ND	208	104	200	0.505	

Surrogate: 1-Chlorooctane 71.7 % 35-147

Surrogate: 1-Chlorooctadecane 77.1 % 28-171

Cardinal Laboratories

*=Accredited Analyte

PLEASE NOTE: Liability and Damages. Cardinal's liability and client's exclusive remedy for any claim arising, whether based in contract or tort, shall be limited to the amount paid by client for analyses. All claims, including those for negligence and any other cause whatsoever shall be deemed waived unless made in writing and received by Cardinal within thirty (30) days after completion of the applicable service. In no event shall Cardinal be liable for incidental or consequential damages, including, without limitation, business interruptions, loss of use, or loss of profits incurred by client, its subsidiaries, affiliates or successors arising out of or related to the performance of the services hereunder by Cardinal, regardless of whether such claim is based upon any of the above stated reasons or otherwise. Results relate only to the samples identified above. This report shall not be reproduced except in full with written approval of Cardinal Laboratories.



Celey D. Keene, Lab Director/Quality Manager

Notes and Definitions

ND	Analyte NOT DETECTED at or above the reporting limit
RPD	Relative Percent Difference
**	Samples not received at proper temperature of 6°C or below.
***	Insufficient time to reach temperature.
-	Chloride by SM4500Cl-B does not require samples be received at or below 6°C Samples reported on an as received basis (wet) unless otherwise noted on report

Cardinal Laboratories

*=Accredited Analyte

PLEASE NOTE: Liability and Damages. Cardinal's liability and client's exclusive remedy for any claim arising, whether based in contract or tort, shall be limited to the amount paid by client for analyses. All claims, including those for negligence and any other cause whatsoever shall be deemed waived unless made in writing and received by Cardinal within thirty (30) days after completion of the applicable service. In no event shall Cardinal be liable for incidental or consequential damages, including, without limitation, business interruptions, loss of use, or loss of profits incurred by client, its subsidiaries, affiliates or successors arising out of or related to the performance of the services hereunder by Cardinal, regardless of whether such claim is based upon any of the above stated reasons or otherwise. Results relate only to the samples identified above. This report shall not be reproduced except in full with written approval of Cardinal Laboratories.



Celey D. Keene, Lab Director/Quality Manager

RUSH

CHAIN-OF-CUSTODY AND ANALYSIS REQUEST

101 East Marland, Hobbs, NM 88240
(575) 393-2326 FAX (575) 393-2476

Company Name: <u>LINN</u>				BILL TO				ANALYSIS REQUEST																			
Project Manager: <u>Rick Rickman</u>				P.O. #:																							
Address:				Company:																							
City:		State:		Zip:		Attn:																					
Phone #:		Fax #:		Address:																							
Project #:		Project Owner:		City:																							
Project Name: <u>LINN</u>				State:																Zip:							
Project Location: <u>MGU #002</u>				Phone #:																							
Sampler Name: <u>Chris Flores</u>				Fax #:																							
FOR LAB USE ONLY																											
Lab I.D.		Sample I.D.		G/RAB OR C/COMP.		# CONTAINERS		MATRIX				PRESERV.		SAMPLING													
								GROUNDWATER WASTEWATER SOIL OIL SLUDGE OTHER:				ACID/BASE: ICE / COOL OTHER:		DATE TIME		Chloride TPH BTEX											
<u>H601299</u>																											
<u>1</u>		<u>Sample Point 1 @ 1.5'</u>		<u>G</u>		<u>1</u>						<u>✓</u>		<u>6/14/2016 11:30 AM</u>		<u>X</u> <u>X</u> <u>X</u>											
<u>2</u>		<u>Sample Point 2 @ 1'</u>		<u>G</u>		<u>1</u>						<u>✓</u>		<u>8:30 AM</u>		<u>X</u> <u>X</u> <u>X</u>											
<u>3</u>		<u>Sample Point 3 @ 1'</u>		<u>G</u>		<u>1</u>						<u>✓</u>		<u>9:00 AM</u>		<u>X</u> <u>X</u> <u>X</u>											
<u>4</u>		<u>Sample Point 4 @ 1'</u>		<u>G</u>		<u>1</u>						<u>✓</u>		<u>10:00 AM</u>		<u>X</u> <u>X</u> <u>X</u>											
<u>5</u>		<u>Sample Point 5 @ 1'</u>		<u>G</u>		<u>1</u>						<u>✓</u>		<u>10:20 AM</u>		<u>X</u> <u>X</u> <u>X</u>											
<u>6</u>		<u>Sample Point 6 @ 1'</u>		<u>G</u>		<u>1</u>						<u>✓</u>		<u>10:40 AM</u>		<u>X</u> <u>X</u> <u>X</u>											
<u>7</u>		<u>Sample Point 7 @ 1'</u>		<u>G</u>		<u>1</u>						<u>✓</u>		<u>11:00 AM</u>		<u>X</u> <u>X</u> <u>X</u>											
		<u>Sample Point 8</u>																									

PLEASE NOTE: Liability and Damages. Cardinal's liability and client's exclusive remedy for any claim arising whether based in contract or tort, shall be limited to the amount paid by the client for the analyses. All claims including those for negligence and any other cause whatsoever shall be deemed waived unless made in writing and received by Cardinal within 30 days after completion of the applicable service. In no event shall Cardinal be liable for incidental or consequential damages, including without limitation, business interruptions, loss of use, or loss of profits incurred by client, its subsidiaries, affiliates or successors arising out of or related to the performance of services hereunder by Cardinal, regardless of whether such claim is based upon any of the above stated reasons or otherwise.

Relinquished By: <u>Chris Flores</u>		Date: <u>6/14/2016</u>		Received By: <u>Jodi Benson</u>		Phone Result: <input type="checkbox"/> Yes <input type="checkbox"/> No		Add'l Phone #:	
Relinquished By:		Time: <u>12:35</u>		Received By:		Fax Result: <input type="checkbox"/> Yes <input type="checkbox"/> No		Add'l Fax #:	
Delivered By: (Circle One)		Time:		Sample Condition		CHECKED BY: (Initials)		REMARKS:	
Sampler - UPS - Bus - Other:		<u>5.3°C</u>		<input checked="" type="checkbox"/> Yes <input type="checkbox"/> No		<u>gfh</u>		Email to: <u>lflores@diversifiedfsi.com</u>	
				<input type="checkbox"/> No <input type="checkbox"/> No				<u>cflores @</u>	
								<u>mvalves @</u>	
								<u>mbenson @</u>	
								<u>mbenson @</u>	

† Cardinal cannot accept verbal changes. Please fax written changes to (575) 393-2326

#75

Appendix IV

SITE PHOTOS

MGU #002

Photo Page



Site prior



Site prior



Collecting samples



Installing soil bore



Excavating site



Backfill completed

Appendix V

FINAL C-141

Diversified Field Service, Inc.
206 W. Snyder
Hobbs, NM 88240
(575) 964-8394

District I
1625 N. French Dr., Hobbs, NM 88240
District II
811 S. First St., Artesia, NM 88210
District III
1000 Rio Brazos Road, Aztec, NM 87410
District IV
1220 S. St. Francis Dr., Santa Fe, NM 87505

State of New Mexico
Energy Minerals and Natural Resources

Form C-141
Revised August 8, 2011

Oil Conservation Division
1220 South St. Francis Dr.
Santa Fe, NM 87505

Submit 1 Copy to appropriate District Office in
accordance with 19.15.29 NMAC.

Release Notification and Corrective Action

OPERATOR

☐ Initial Report ☒ Final Report

Name of Company: Linn Energy	Contact: EL Gonzales	
Address: 2130 W Bender, Hobbs, NM 88240	Telephone No. 575-738-1739	
Facility Name: MGU #002	Facility Type: Injection	
Surface Owner: Federal	Mineral Owner: Federal	API No. 30-025-42628

LOCATION OF RELEASE

Unit Letter	Section	Township	Range	Feet from the	North/South Line	Feet from	East/West Line	County
O	21	17S	31E	400	South	2100	East	Lea

Latitude: 32.8139238102197 Longitude: -103.769739540332

NATURE OF RELEASE

Type of Release: Oil	Volume of Release: 1/2 bbl	Volume Recovered: 0
Source of Release: Steel pipeline	Date and Hour of Occurrence 10/25/2015	Date and Hour of Discovery 10/25/2015 10:00 am
Was Immediate Notice Given? <input type="checkbox"/> Yes <input type="checkbox"/> No <input type="checkbox"/> Not Required	If YES, To Whom?	
By Whom?	Date and Hour:	
Was a Watercourse Reached? <input type="checkbox"/> Yes <input checked="" type="checkbox"/> No	If YES, Volume Impacting the Watercourse.	

If a Watercourse was Impacted, Describe Fully.*

Describe Cause of Problem and Remedial Action Taken.*

While on route, notice a release of fluid that was 1000 ft west of the MGU #2 wellhead + B6, alongside of the road, coming from a 2 inch steel flow line. Once the line was traced, Linn shut in wells that line belonged to. Located the small pin hole the fluid was coming out of on the 2 inch steel line.

Describe Area Affected and Cleanup Action Taken.

On October 29, 2015, DFSI personnel were on site to scrape the visibly impacted area. On November 6, 2015, DFSI personnel returned to the site to obtain samples within the leak area. Seven samples were obtained and field sampled for chloride levels, as well as BTEX. The BTEX samples were performed using a Mini Rae Photoionization Detector (PID). All clean field samples under NMOCD and BLM regulatory guidelines were submitted for laboratory analysis at Cardinal Laboratories of Hobbs, NM to obtain confirmation. To further delineate the site, on November 19, 2015, DFSI personnel installed two soil bores to obtain confirmation samples. All clean field samples under NMOCD and BLM regulatory guidelines were submitted for laboratory analysis at Cardinal Laboratories of Hobbs, NM to obtain confirmation. A work plan was submitted to BLM on January 19, 2016, and approved by BLM on January 20, 2016, with stipulations. Beginning June 9, 2016, DFSI personnel were on site to excavate the release area. Prior to backfilling, confirmatory samples taken at 1.5' bgs at SP1 and 1' bgs at the remaining six samples were submitted for analysis at Cardinal Laboratories of Hobbs, NM to obtain confirmation. The excavation was backfilled with clean, imported topsoil on the pasture area and caliche within the road to ground surface and contoured to the surrounding area. Contaminated soil was properly disposed of at an NMOCD approved facility.

I hereby certify that the information given above is true and complete to the best of my knowledge and understand that pursuant to NMOCD rules and regulations all operators are required to report and/or file certain release notifications and perform corrective actions for releases which may endanger public health or the environment. The acceptance of a C-141 report by the NMOCD marked as "Final Report" does not relieve the operator of liability should their operations have failed to adequately investigate and remediate contamination that pose a threat to ground water, surface water, human health or the environment. In addition, NMOCD acceptance of a C-141 report does not relieve the operator of responsibility for compliance with any other federal, state, or local laws and/or regulations.

Signature: 		OIL CONSERVATION DIVISION	
Printed Name: EL Gonzales		Approved by Environmental Specialist:	
Title: Production Supervisor		Approval Date:	Expiration Date:
E-mail Address: elgonzaless@linenergy.com		Conditions of Approval:	Attached <input type="checkbox"/>
Date: 6/30/2016 Phone: 575-504-8002			

* Attach Additional Sheets If Necessary