

Submit to Appropriate
District Office
State Leases - 4 copies
Fee Leases - 3 copies

State of New Mexico
Energy, Minerals and Natural Resources Department

Form C-102
Revised 1-1-89

OIL CONSERVATION DIVISION
P.O. Box 2088
Santa Fe, New Mexico 87504-2088

DISTRICT I
P.O. Box 1990, Hobbs, NM 88240

DISTRICT II
P.O. Drawer DD, Aztec, NM 88210

DISTRICT III
1000 Rio Grande Rd., Aztec, NM 87410

WELL LOCATION AND ACREAGE DEDICATION PLAT

All Distances must be from the outer boundaries of the section

Operator DEVON ENERGY			Lease Kachina 8 Federal		Well No. 1
Unit Letter C	Section 8	Township 18 South	Range 33 East	County Lea	
Actual Footage Location of Well: 660 feet from the North line and 1830 feet from the West line					
Ground level Elev. 3931.2	Producing Formation BONE SPRING		Pool South Corbin	Dedicated Acreage: 40 Acres	

- Outline the acreage dedicated to the subject well by colored pencil or hectare marks on the plat below.
- If more than one lease is dedicated to the well, outline each and identify the ownership thereof (both as to working interest and royalty).
- If more than one lease of different ownership is dedicated to the well, have the interest of all owners been consolidated by communitization, unitization, force-pooling, etc.?
 - Yes No If answer is "yes" type of consolidation One lease
 If answer is "no" list the owners and tract descriptions which have actually been consolidated. (Use reverse side of this form if necessary.) One lease
 No allowances will be assigned to the well until all interests have been consolidated (by communitization, unitization, forced-pooling, or otherwise) or until a non-standard unit, eliminating such interest, has been approved by the Division.

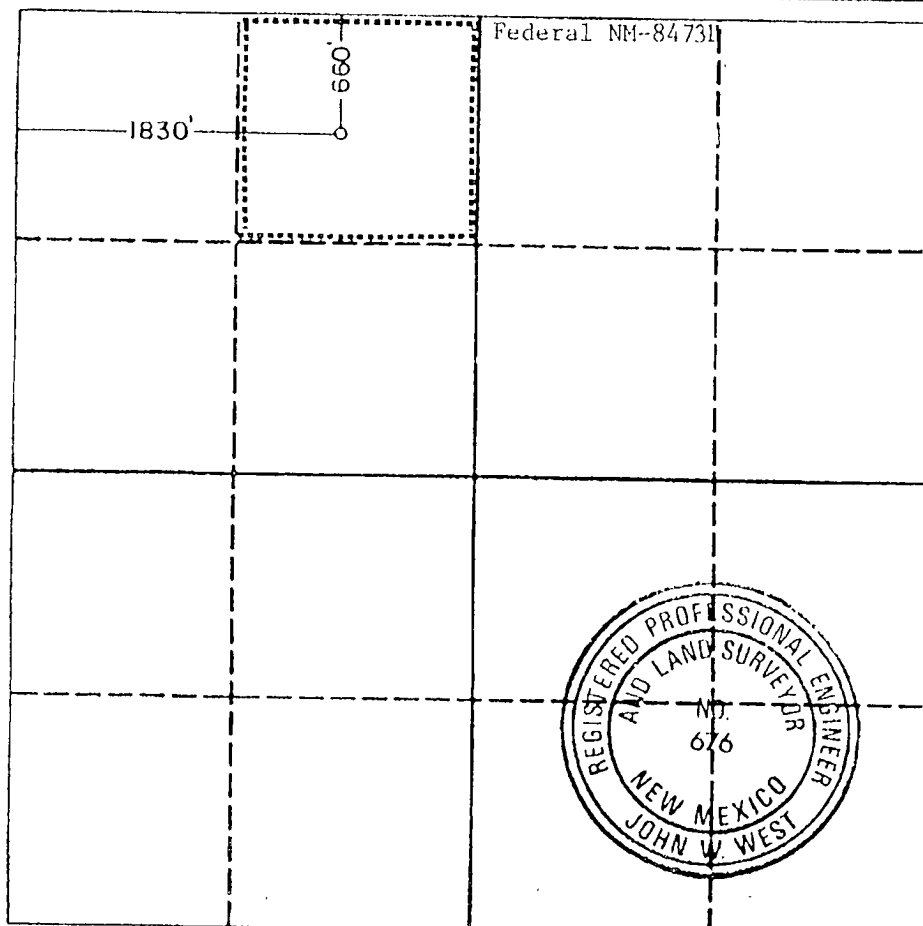

OPERATOR CERTIFICATION
I hereby certify that the information contained herein is true and complete to the best of my knowledge and belief.

Signature: *[Signature]*
 Printed Name: SPENCE LAIRD
 Position: REGULATORY ANALYST
 Company: DEVON ENERGY
 Date: 3/29/2011

SURVEYOR CERTIFICATION
I hereby certify that the well location shown on this plat was plotted from field notes of actual surveys made by me or under my supervision, and that the same is true and correct to the best of my knowledge and belief.

Date Surveyed: July 19, 1990

Signature & Seal of Professional Surveyor: *[Signature]*

Certificate No. JOHN W. WEST, 676
 RONALD J. EIDSON, 3239

128430

