

DISTRICT I  
1625 N. French Dr., Hobbs, NM 88240  
Phone (575) 393-6161 Fax: (575) 393-0720

DISTRICT II  
811 S. First St., Artesia, NM 88210  
Phone (575) 748-1283 Fax: (575) 748-9720

DISTRICT III  
1000 Rio Brazos Rd., Aztec, NM 87410  
Phone (505) 334-6178 Fax: (505) 334-6170

DISTRICT IV  
1220 S. St. Francis Dr., Santa Fe, NM 87505  
Phone (505) 476-3460 Fax: (505) 476-3462

State of New Mexico  
Energy, Minerals and Natural Resources Department

Form C-102  
Revised August 1, 2011

Submit one copy to appropriate  
District Office

OIL CONSERVATION DIVISION

1220 South St. Francis Dr.  
Santa Fe, New Mexico 87505

WELL LOCATION AND ACREAGE DEDICATION PLAT

AMENDED REPORT

API Number <b>30-025-42543</b>	Pool Code <b>5535</b>	Pool Name <b>BEARLY; POWE SPRING NORTH</b>	HOBBSON Spring
Property Code <b>40431</b>	Property Name <b>PERSIMMON BSS STATE COM</b>		Well Number <b>3H</b>
OGRID No. <b>025575</b>	Operator Name <b>YATES PETROLEUM CORPORATION</b>		Elevation <b>3755</b>

RECEIVED

Surface Location

UL or lot No.	Section	Township	Range	Lot Idn	Feet from the	North/South line	Feet from the	East/West line	County
G	24	21 S	33 E		2440'	NORTH	1980'	EAST	LEA

Bottom Hole Location If Different From Surface

UL or lot No.	Section	Township	Range	Lot Idn	Feet from the	North/South line	Feet from the	East/West line	County
O	25	21 S	33 E		330'	SOUTH	1980'	EAST	LEA

Dedicated Acres <b>280</b>	Joint or Infill	Consolidation Code	Order No.
-------------------------------	-----------------	--------------------	-----------

NO ALLOWABLE WILL BE ASSIGNED TO THIS COMPLETION UNTIL ALL INTERESTS HAVE BEEN CONSOLIDATED OR A NON-STANDARD UNIT HAS BEEN APPROVED BY THE DIVISION

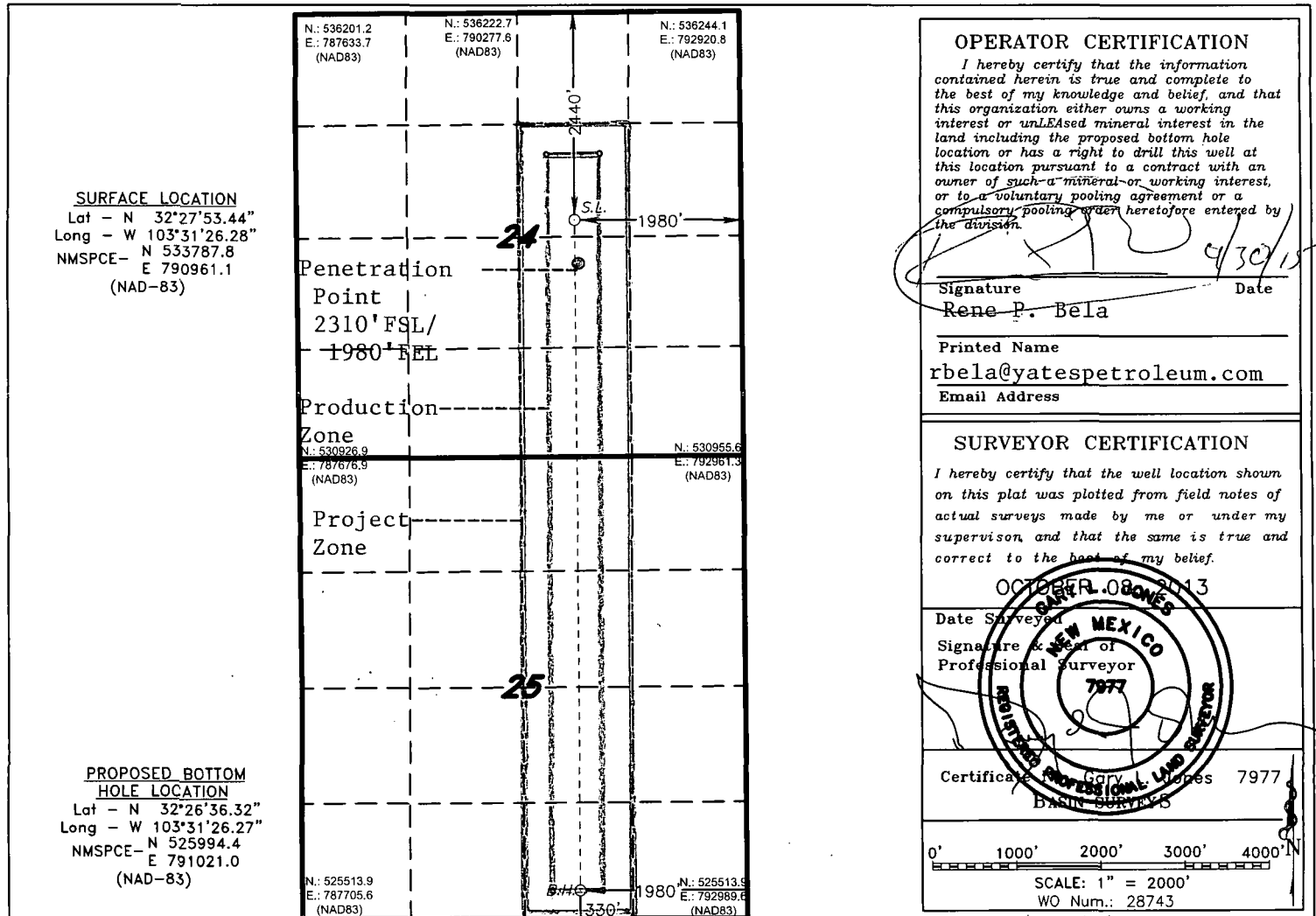

OPERATOR CERTIFICATION

I hereby certify that the information contained herein is true and complete to the best of my knowledge and belief, and that this organization either owns a working interest or unLEASED mineral interest in the land including the proposed bottom hole location or has a right to drill this well at this location pursuant to a contract with an owner of such a mineral or working interest, or to a voluntary pooling agreement or a compulsory pooling agreement heretofore entered by the division.

Signature *Rene P. Bela* Date *4/30/15*

Printed Name  
**Rene P. Bela**

Email Address  
**rbela@yatespetroleum.com**

Email Address

SURVEYOR CERTIFICATION

I hereby certify that the well location shown on this plat was plotted from field notes of actual surveys made by me or under my supervision and that the same is true and correct to the best of my belief.

OCTOBER 08 2013

Date Surveyed

Signature & Seal of Professional Surveyor

Certificate No. *7977*  
BASIN SURVEYS

0' 1000' 2000' 3000' 4000'

SCALE: 1" = 2000'  
WO Num.: 28743

MAY 05 2015

Well Name: Persimmon BSS State Com #3H	Tgt N/S: -7793.40	EOC TVD/MD: 10967.15 / 11234.51
Surface Location: Section 24 , Township 21S Range 33E	Tgt E/W: 59.90	
Bottom Hole Location: Section 25 , Township 21S Range 33E	VS: 7793.63	
	VS Az: 179.56	EOL TVD/MD: 11047.00 / 18555.88

MD	Inc.	Azi.	TVD	C/N/S	E/W	VS	DLS	Comments
0	0	0	0	0	0	0	0	
1892.00	0.00	0.00	1892.00	0.00	0.00	0.00	0.00	RUSTLER
2027.00	0.00	0.00	2027.00	0.00	0.00	0.00	0.00	TOS
3477.00	0.00	0.00	3477.00	0.00	0.00	0.00	0.00	BOS-TOP TANSILL
3707.00	0.00	0.00	3707.00	0.00	0.00	0.00	0.00	YATES
3992.00	0.00	0.00	3992.00	0.00	0.00	0.00	0.00	CAPITAN
6117.00	0.00	0.00	6117.00	0.00	0.00	0.00	0.00	CHERRY CANYON
7157.00	0.00	0.00	7157.00	0.00	0.00	0.00	0.00	BRUSHY CANYON
8832.00	0.00	0.00	8832.00	0.00	0.00	0.00	0.00	BONE SPRINGS LM
9047.00	0.00	0.00	9047.00	0.00	0.00	0.00	0.00	AVALON SAND
9372.00	0.00	0.00	9372.00	0.00	0.00	0.00	0.00	MIDDLE AVALON
9502.00	0.00	0.00	9502.00	0.00	0.00	0.00	0.00	LOWER AVALON
10002.00	0.00	0.00	10002.00	0.00	0.00	0.00	0.00	1ST BONE SPRINGS SAND
10489.71	0.00	0.00	10489.71	0.00	0.00	0.00	0.00	KOP
10500.00	1.23	179.56	10500.00	-0.11	0.00	0.11	12.00	
10525.00	4.23	179.56	10524.97	-1.30	0.01	1.30	12.00	
10550.00	7.23	179.56	10549.84	-3.80	0.03	3.80	12.00	
10575.00	10.23	179.56	10574.55	-7.60	0.06	7.60	12.00	
10600.00	13.23	179.56	10599.02	-12.68	0.10	12.68	12.00	
10625.00	16.23	179.56	10623.20	-19.04	0.15	19.04	12.00	
10650.00	19.23	179.56	10647.01	-26.65	0.20	26.65	12.00	
10675.00	22.23	179.56	10670.38	-35.50	0.27	35.50	12.00	
10698.60	25.06	179.56	10692.00	-44.96	0.35	44.96	12.00	2ND BONE SPRINGS SAND
10700.00	25.23	179.56	10693.27	-45.56	0.35	45.56	12.00	
10725.00	28.23	179.56	10715.59	-56.81	0.44	56.81	12.00	
10750.00	31.23	179.56	10737.30	-69.20	0.53	69.21	12.00	
10775.00	34.23	179.56	10758.33	-82.72	0.64	82.72	12.00	
10800.00	37.23	179.56	10778.62	-97.32	0.75	97.32	12.00	
10825.00	40.23	179.56	10798.12	-112.96	0.87	112.96	12.00	
10850.00	43.23	179.56	10816.77	-129.60	1.00	129.60	12.00	
10875.00	46.23	179.56	10834.53	-147.19	1.13	147.20	12.00	
10900.00	49.23	179.56	10851.34	-165.69	1.27	165.70	12.00	
10925.00	52.23	179.56	10867.16	-185.04	1.42	185.05	12.00	
10950.00	55.23	179.56	10881.95	-205.20	1.58	205.20	12.00	
10975.00	58.23	179.56	10895.66	-226.10	1.74	226.10	12.00	
11000.00	61.23	179.56	10908.26	-247.69	1.90	247.69	12.00	
11025.00	64.23	179.56	10919.71	-269.91	2.07	269.91	12.00	
11050.00	67.23	179.56	10929.98	-292.69	2.25	292.70	12.00	
11075.00	70.23	179.56	10939.05	-315.99	2.43	316.00	12.00	
11100.00	73.23	179.56	10946.88	-339.73	2.61	339.74	12.00	
11125.00	76.23	179.56	10953.46	-363.84	2.80	363.85	12.00	
11150.00	79.23	179.56	10958.78	-388.27	2.98	388.28	12.00	
11175.00	82.23	179.56	10962.80	-412.94	3.17	412.95	12.00	
11200.00	85.23	179.56	10965.53	-437.78	3.36	437.80	12.00	
11225.00	88.23	179.56	10966.95	-462.74	3.56	462.75	12.00	
11234.51	89.38	179.56	10967.15	-472.24	3.63	472.26	12.00	TARGET ZONE SBSG
18555.88	89.38	179.56	11047.00	-7793.40	59.90	7793.63	0.00	EOL

Persimmon BSS State Com #3H

